



**FREEZETECH
IOT BASED CRYOGENIC STIRLING FREEZER
ST0098765**

OPERATING USER MANUAL



CAUTION
THIS SYSTEM IS TO BE USED ONLY BY A TRAINED
SCREENTECH AUTHORIZED PERSONAL

CAUTION
 RISK OF ELECTRIC SHOCK
 DO NOT OPEN

CAUTION:
TO REDUCE THE RISK OF ELECTRIC SHOCK, DO NOT
REMOVE REAR COVER. NO USER SERVICEABLE
TS INSIDE. REFER SERVICING TO QUALIFIED
SERVICE PERSONNEL.



This symbol indicates that dangerous
Voltage which can cause electric shock
is present inside the unit



This symbol alerts you to important
Operating and maintenance instructions
accompanying the unit

WARNING

To reduce the risk of electric shock,
do not expose this machine to rain or
moisture

CAUTION

To reduce risk of Laser radiation
exposure do not open the machine lid
during its operation



This symbol alerts you that this machine
may crush your hands if not used correctly.



CE marking is an administrative marking that
indicates conformity with health, safety,
and environmental protection standards for
products sold within the European Economic Area (EEA)



FDA defines a radiation-emitting electronic product
as any electrically-powered product that can emit
any form of radiation on the electromagnetic spectrum.

— EUROPE ONLY —

This marking shown on the product or its literature, indicates that it should not
be disposed with other commercial wastes at the end of its working life.
To prevent possible harm to the environment or human health from uncon-
trolled waste disposal, please separate this from other types of wastes and
recycle it responsibly to promote the sustainable reuse of material resources.
Commercial users should contact their distributor where they purchased this
product from for details of where and how they can take this item for
environmentally safe recycling.
Business users should contact their supplier and check the terms and
conditions of the purchase contract.
This product should not be mixed with other commercial wastes for disposal.

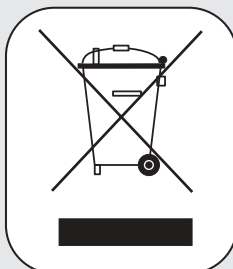

Index.....	PAGE 2
1. Safety	
1.1 Safety warnings.....	PAGE 3
1.2 Safety Precautions.....	PAGE 3
2. Introduction	
2.1 Front Panel.....	PAGE 4
2.2 LCD Display Main Menu.....	PAGE 4
2.3 LID.....	PAGE 4
2.4 Chamber.....	PAGE 4
2.5 Back View.....	PAGE 5
4. Power	
4.1 Power Connection.....	PAGE 6
5. IOT	
5.1 LAN IOT Connection.....	PAGE 7
6. Booting	
Booting Sequence.....	PAGE 8
7. IOT ScreenTech Platform (Brief Introduction)	
7.1 LOGIN.....	PAGE 9
7.2 Add Repair order.....	PAGE 10
7.3 Device Details.....	PAGE 11
7.4 Select repair and technician.....	PAGE 12
7.5 Image upload and machine section.....	PAGE 13
7.6 Run Process.....	PAGE 14
7.8 Process completed.....	PAGE 15
8. Shutdown sequence.....	PAGE 16
9. Technical Specifications.....	PAGE 17
10. Customer Care.....	PAGE 17

Ambient operating conditions:
Ambient temperature - 5°C-35°C
Humidity - 10-75%

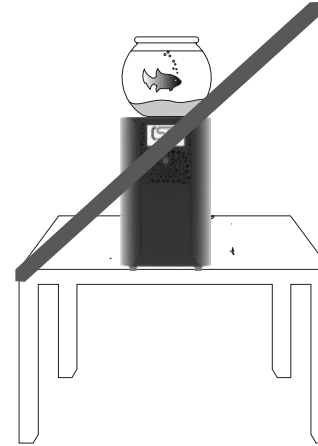
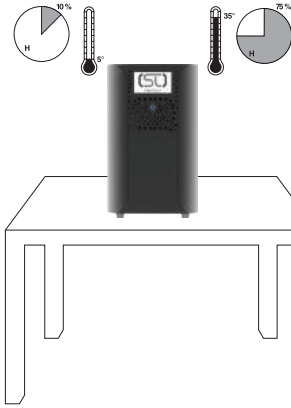

Do not place potted plants or Vases on top of the machine. Moisture entering the unit could lead to dangerous electric shock and can cause equipment damage. In such event immediately disconnect the main plug from the socket

Do not place heavy items on the main lead. Main cable damage can lead to damage of the equipment (fire hazard) and can cause electric shock

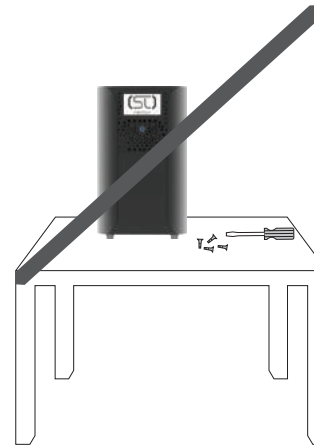
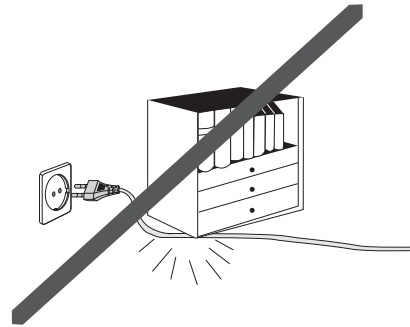

Do not remove any equipment panels. The inside of the unit contains sensitive components that may malfunction if interfered with.

During thunderstorms, disconnect the main plug from the socket. Main voltage peaks due to lightning could damage the unit.

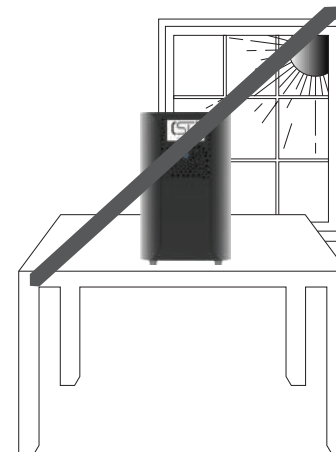
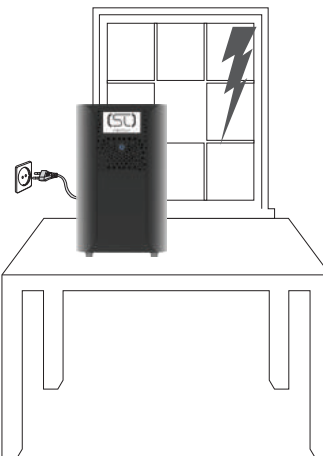

Do not expose the machine to direct sun radiation or other heat sources. This could lead to overheating and malfunction the Machine



1. LCD Touch screen Display
2. User interface button

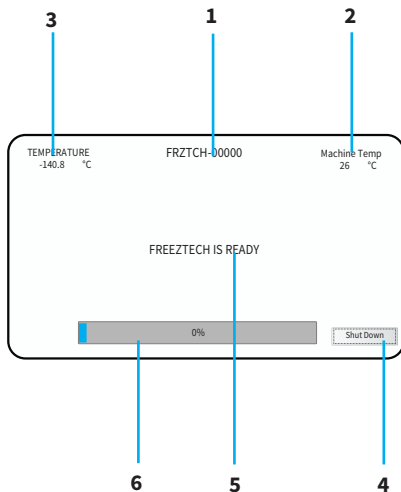

1. Machine ID and Serial number
2. Machine engine temperature
3. Cold plate temperature
4. Engine shutdown button
5. System status information
6. Percentage progress bar



1. Push center release Lid for auto LID opening

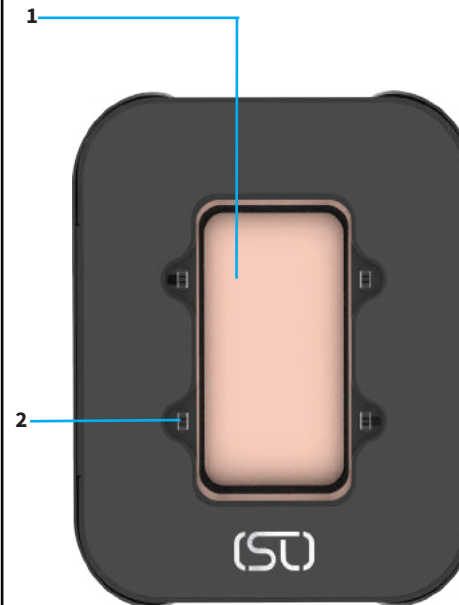

1. Copper cold plate
2. Push lock clips

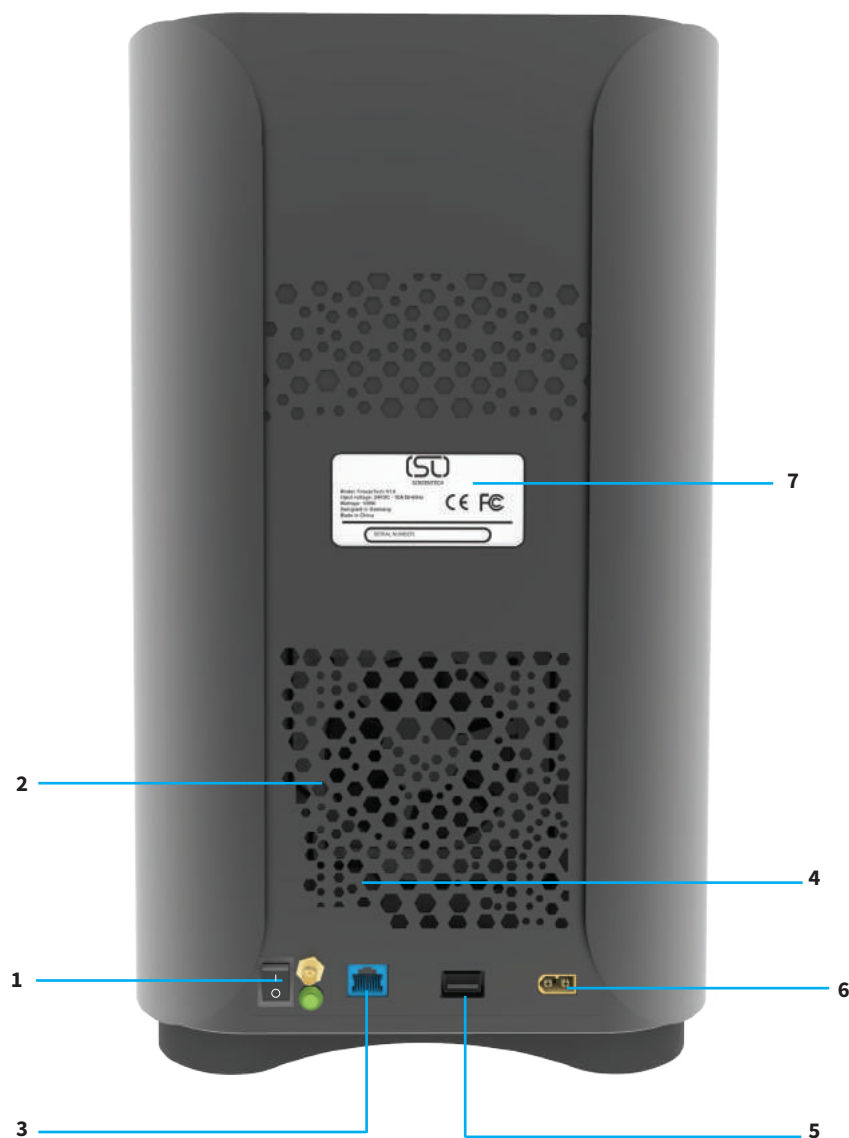

- 1.** Power switch
- 2.** WPS enable button
- 3.** LAN IOT Ethernet connection point
- 4.** System reset factory button
- 5.** USB interface connection point
- 6.** Power input socket
- 7.** Machine identification tag



THIS SYSTEM MUST BE CONNECTED
TO A POWER SURGE PROTECTION PLUG

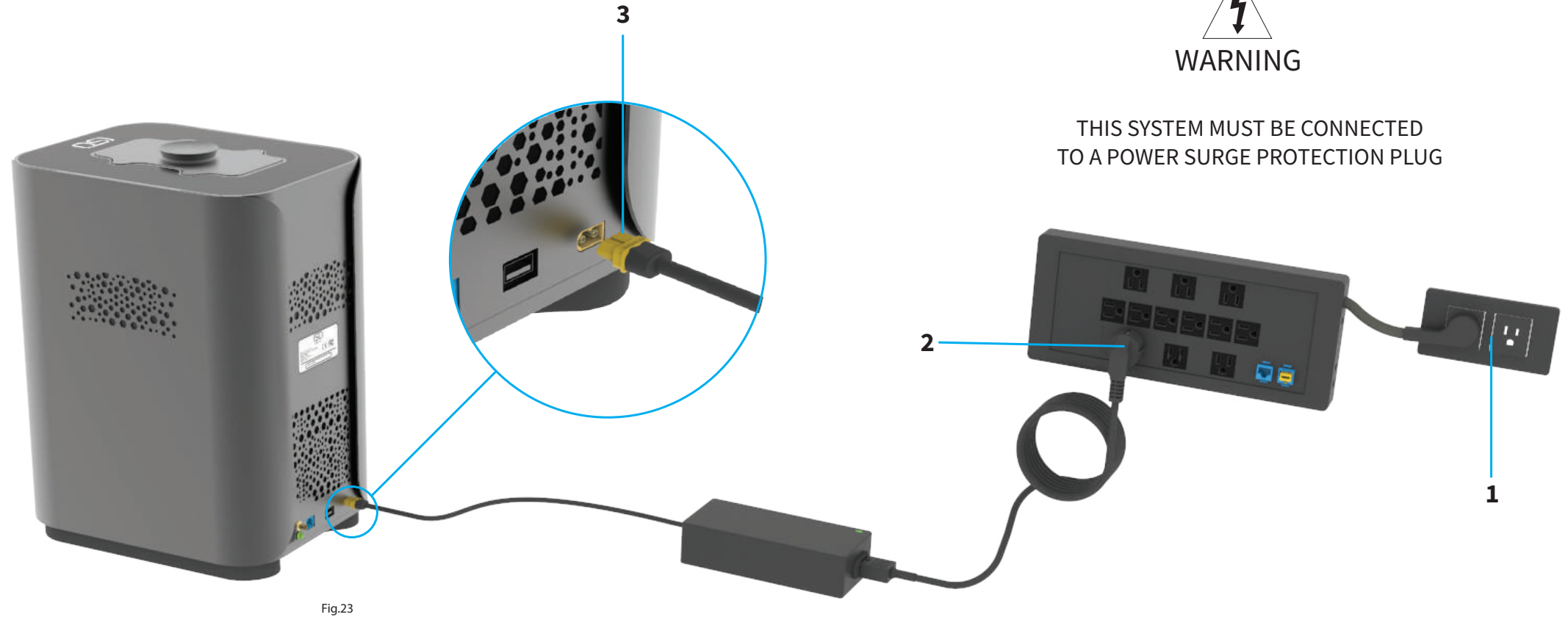

Fig.23

STEP 1 2 3

Connect the power cable
to the wall socket

Plug the C13 socket into the
power surge protection plug
point

Insert the DC jack into the FreezeTech
power inlet

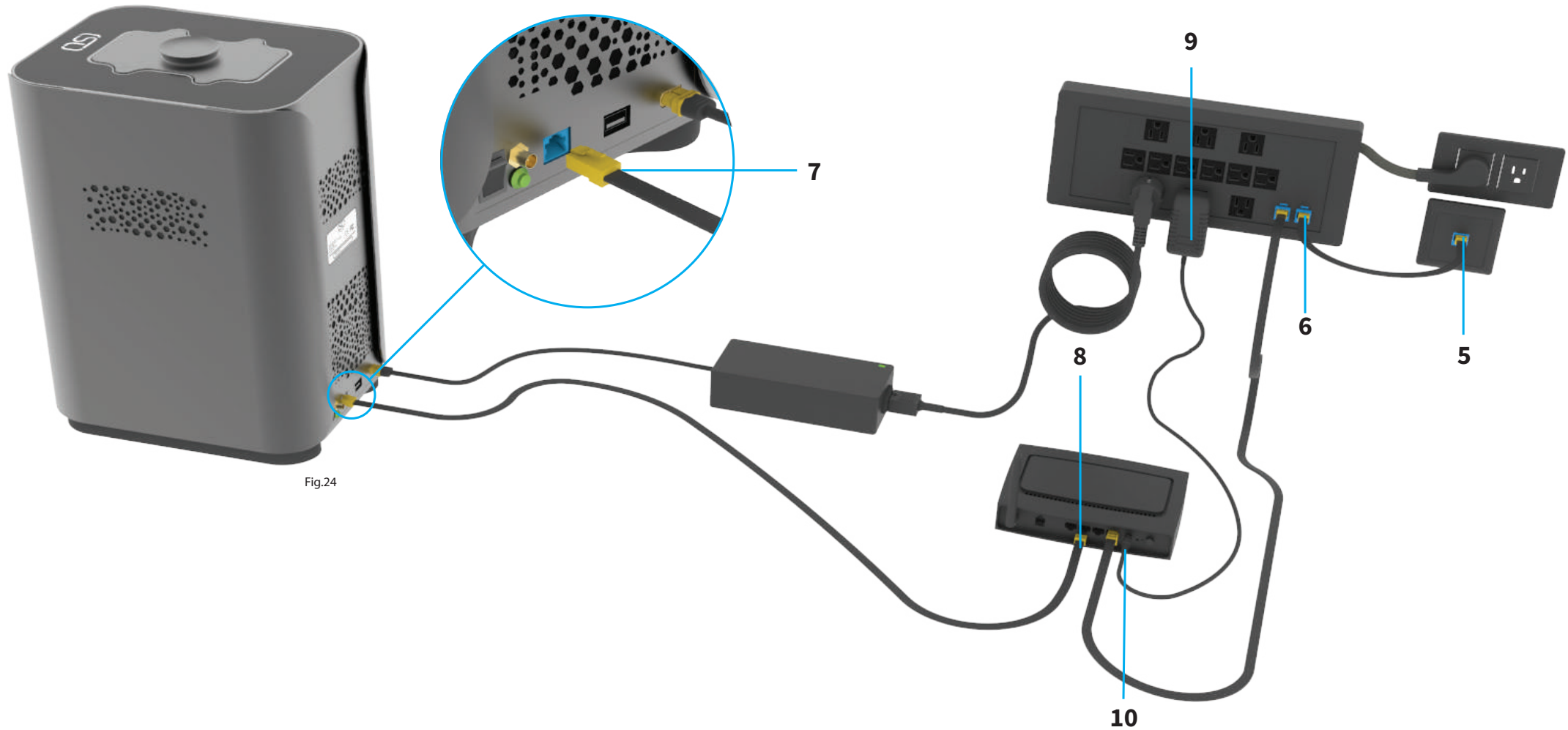

Fig.24

- 5
 - 6
 - 7
 - 8
 - 9
 - 10
- Connect the LAN cable into the ethernet wall socket port from the ISP
- Connect the LAN cable to the surge protector
- Connect the LAN cable into the ethernet port of the FreezeTech
- From the FreezeTech LAN connect to the modem directly
- Plug in the Switching power supply to the Surge Protector
- Power on the modem

11



Toggle the power switch to power the FreezeTech

12

Press to boot

Power on to boot

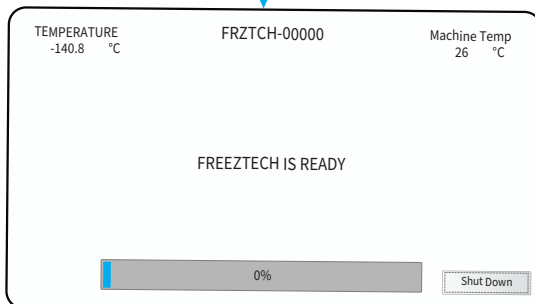
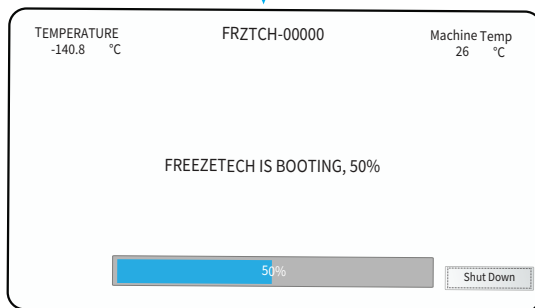

12



1

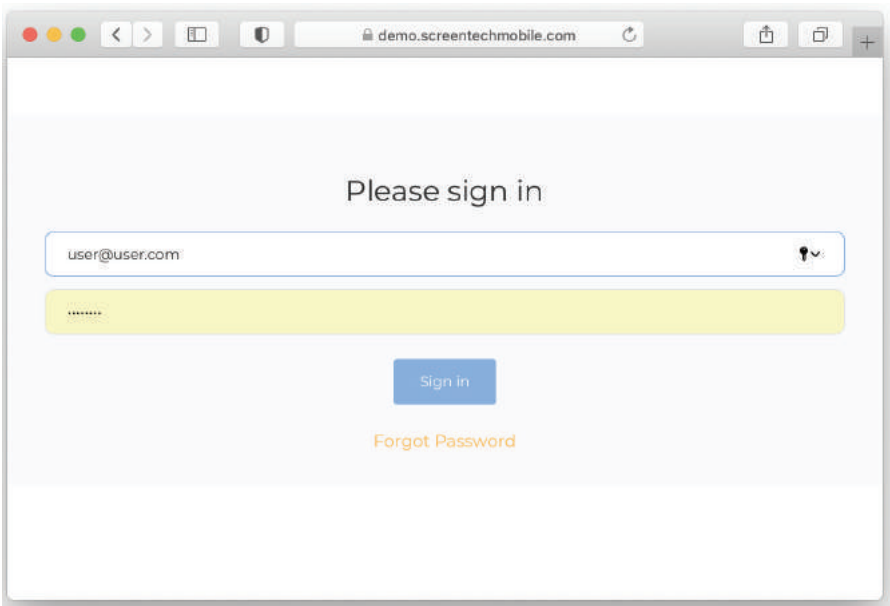

Open your browser and navigate to <https://demo.screentechmobile.com>

2

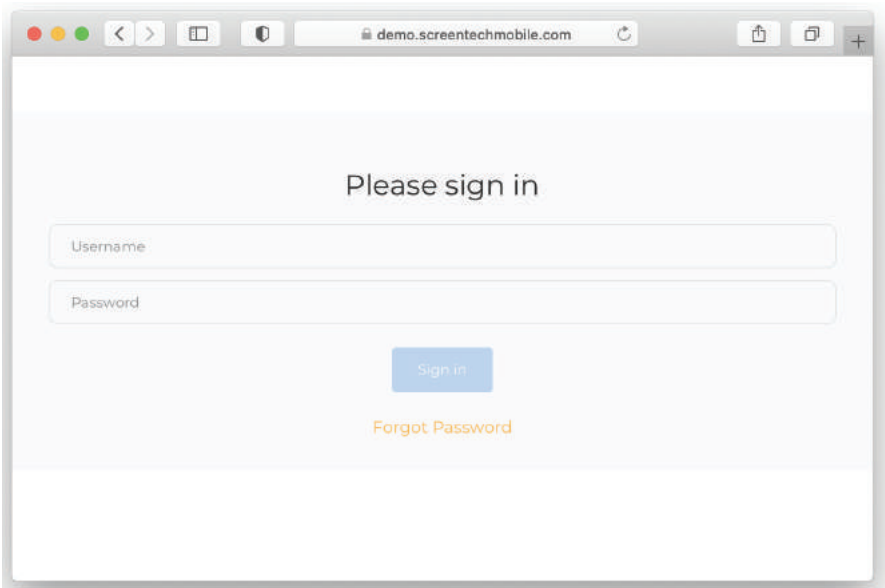

Input your username provided from your ScreenTech distributor

3

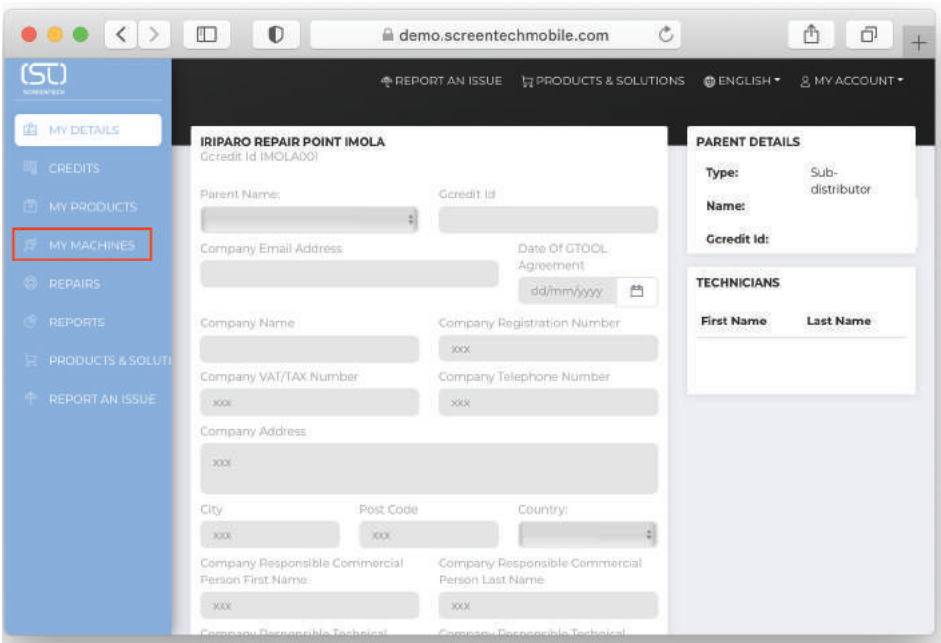

Select My Machines

4

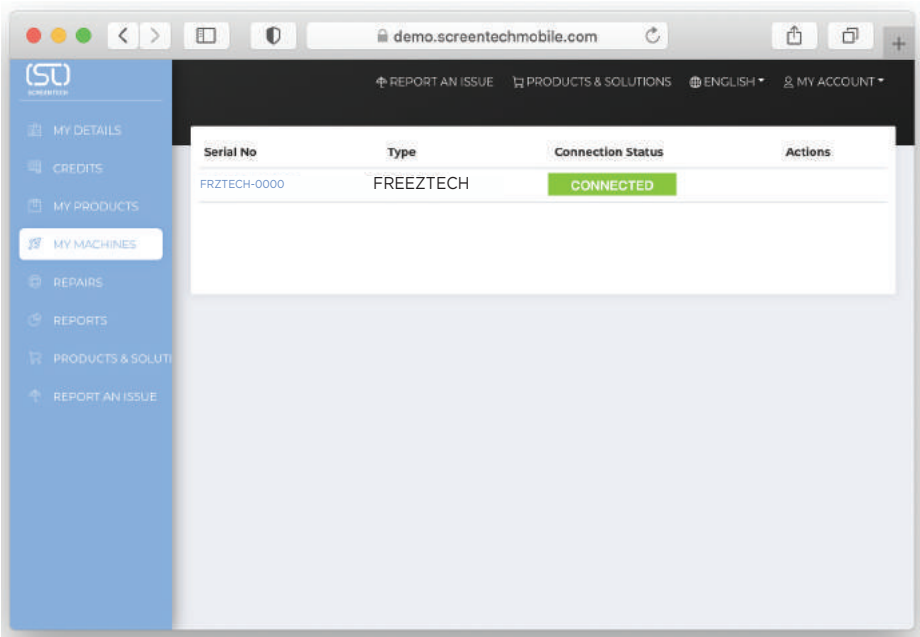

In this list the AirTech will show that its connected to the IOT platform

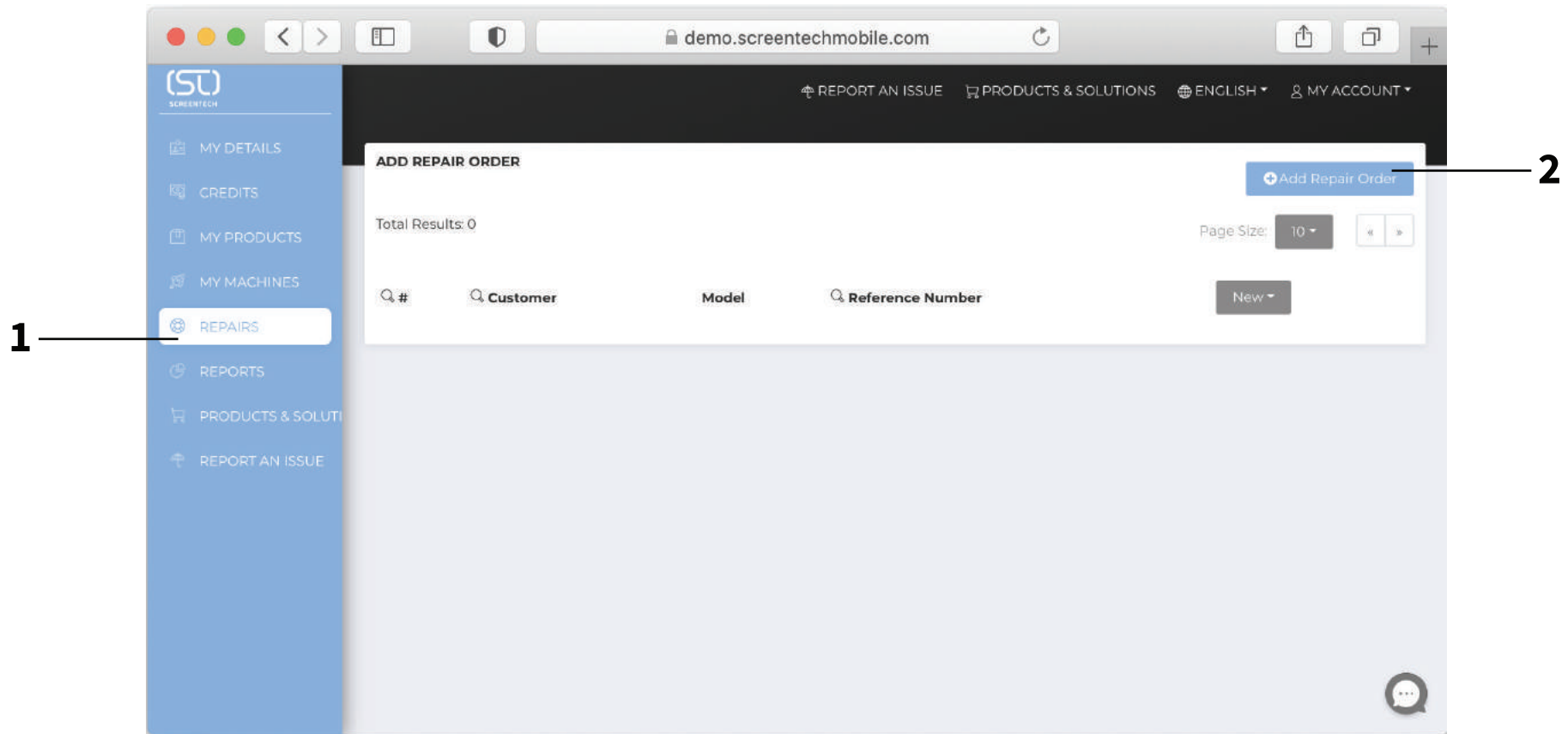

Select Repairs located in the main menu

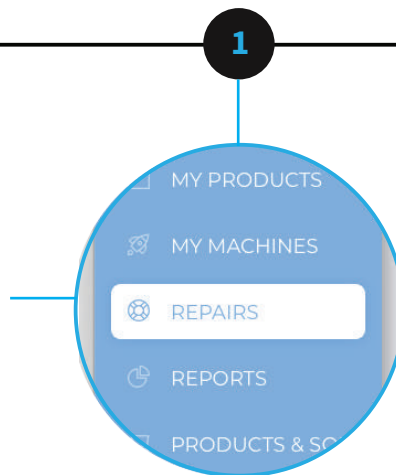

Select Add Repair Order located in the top right hand corner of the screen

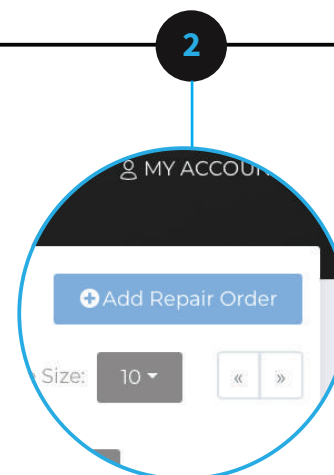

ADD REPAIR ORDER

Customer: Davide Rizzi

Due Date: 13/04/2021

Reference Number:

Phone Type: iPhone

Model: iPhone 6

Variant: glass-black

REPAIRS LIST

- ☒ Repair Screen
- ☐ Debbuble
- ☐ Sim Card
- ☐ Memory Card
- ☐ Charger

CHECK LIST

- ☐ Battery

NOTES

Diagnostic Notes

Internal Notes

Cancel Add repair order

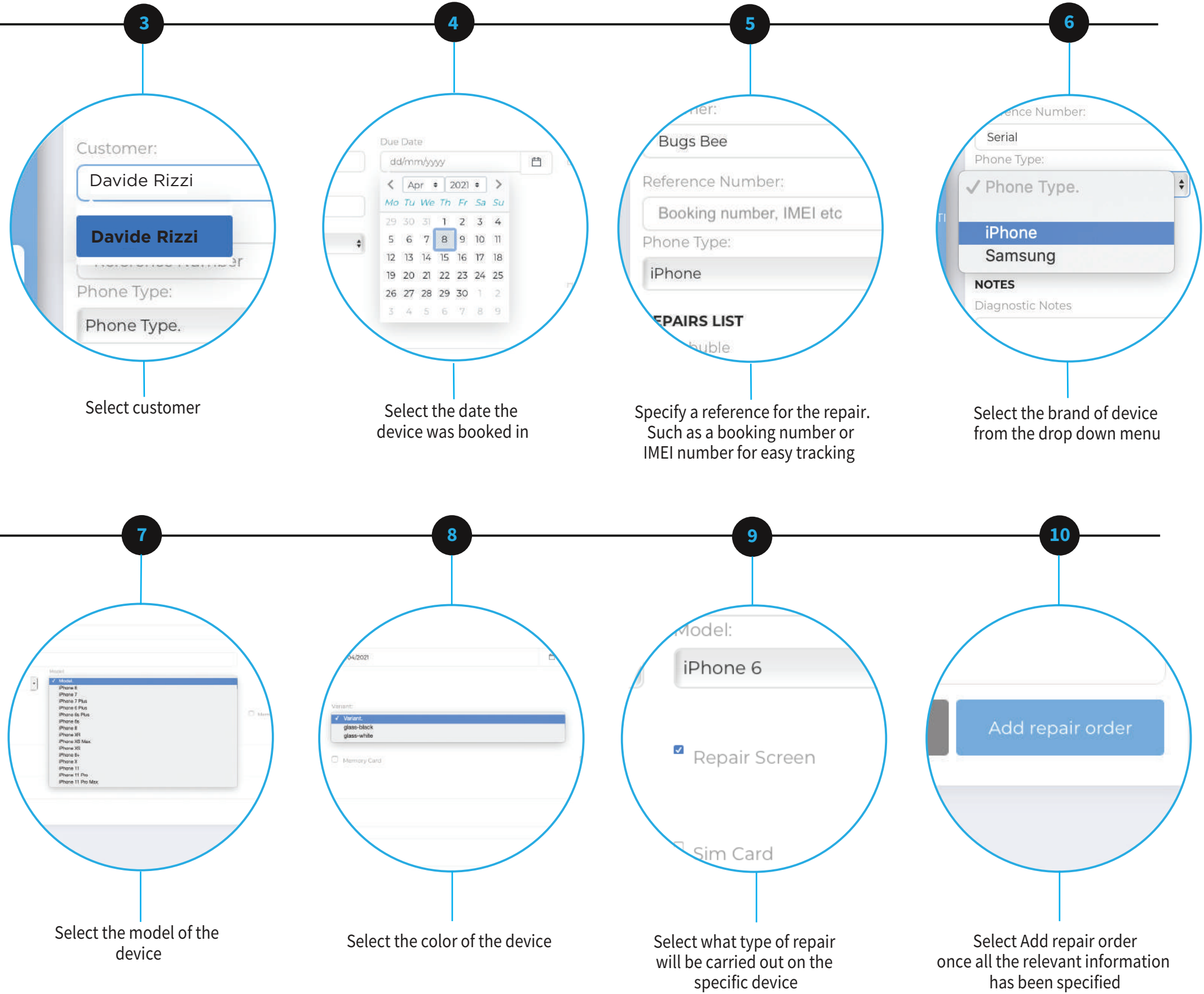

11

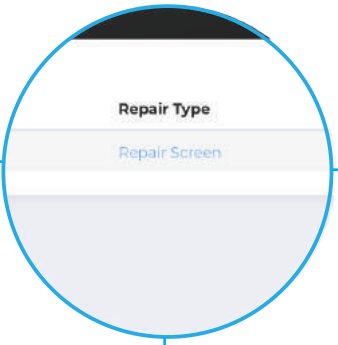

Select Repair Screen

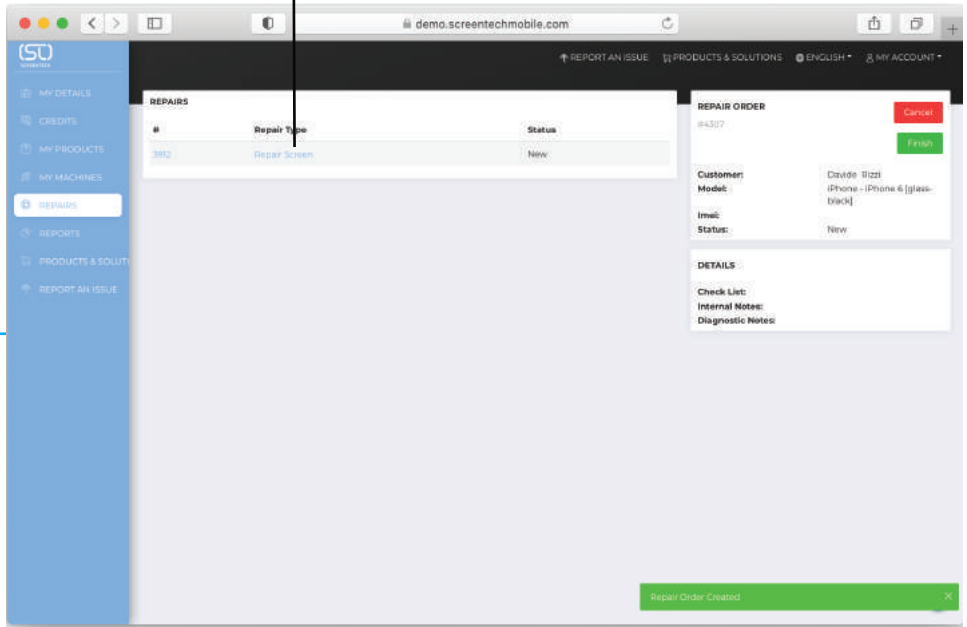

11

12

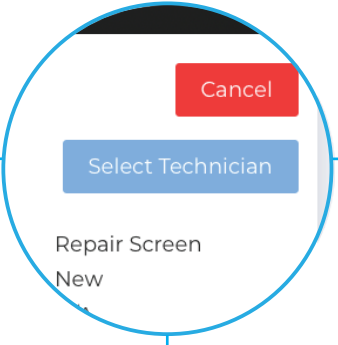

Select Technician

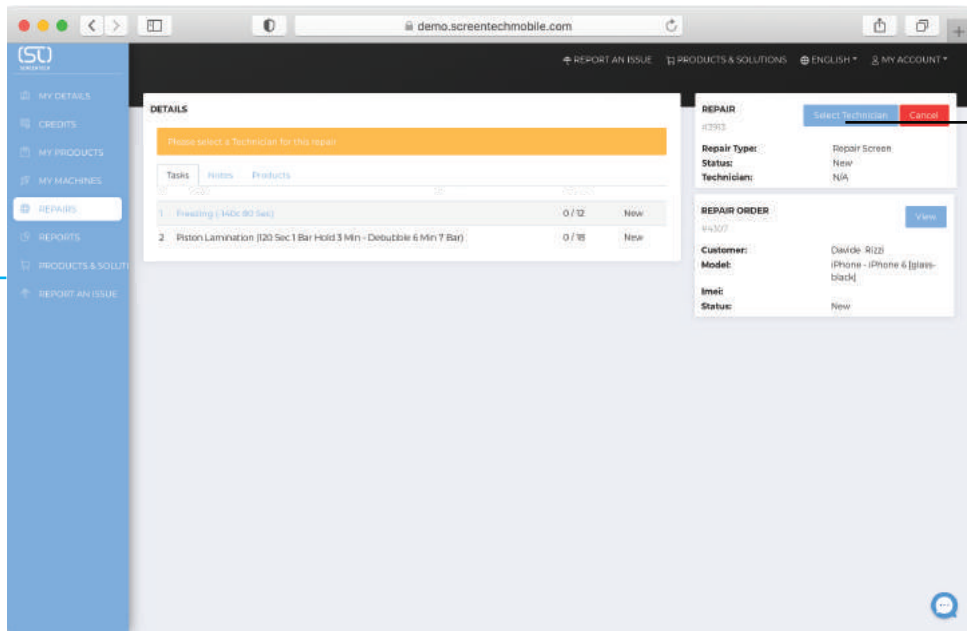

12

14

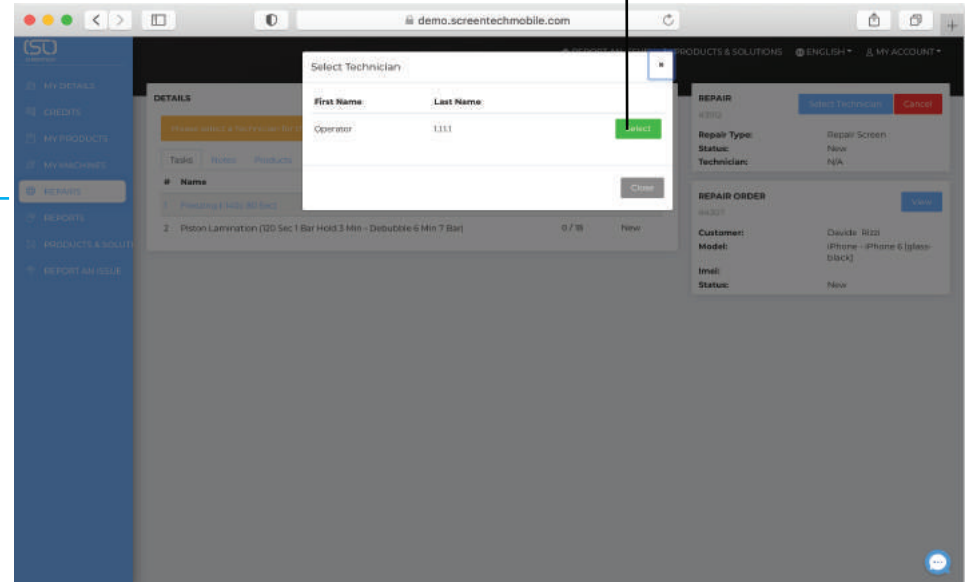
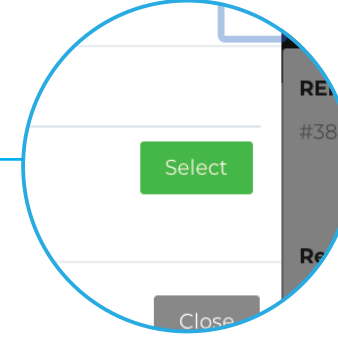

14

15



Select Freezing

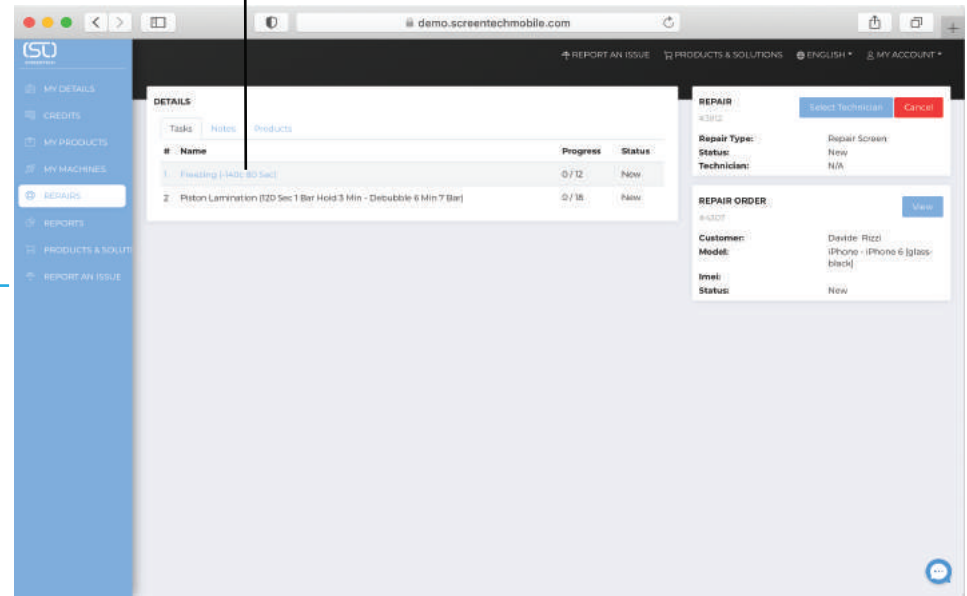

15

11

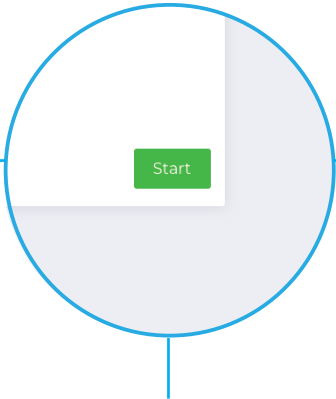

Make sure you have all the required tools. Press Start

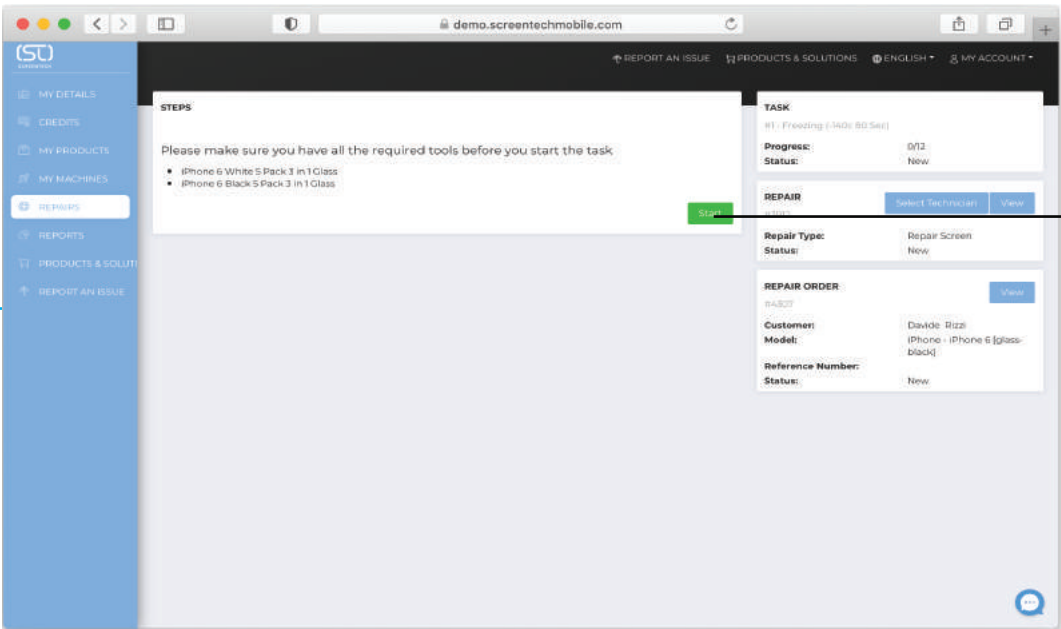

16

12

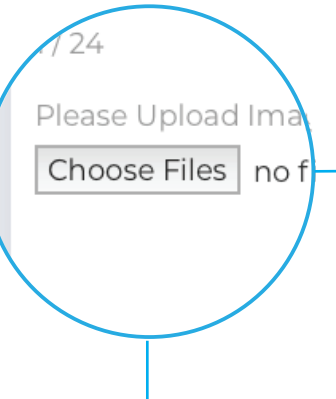

UPLOAD an image of the display

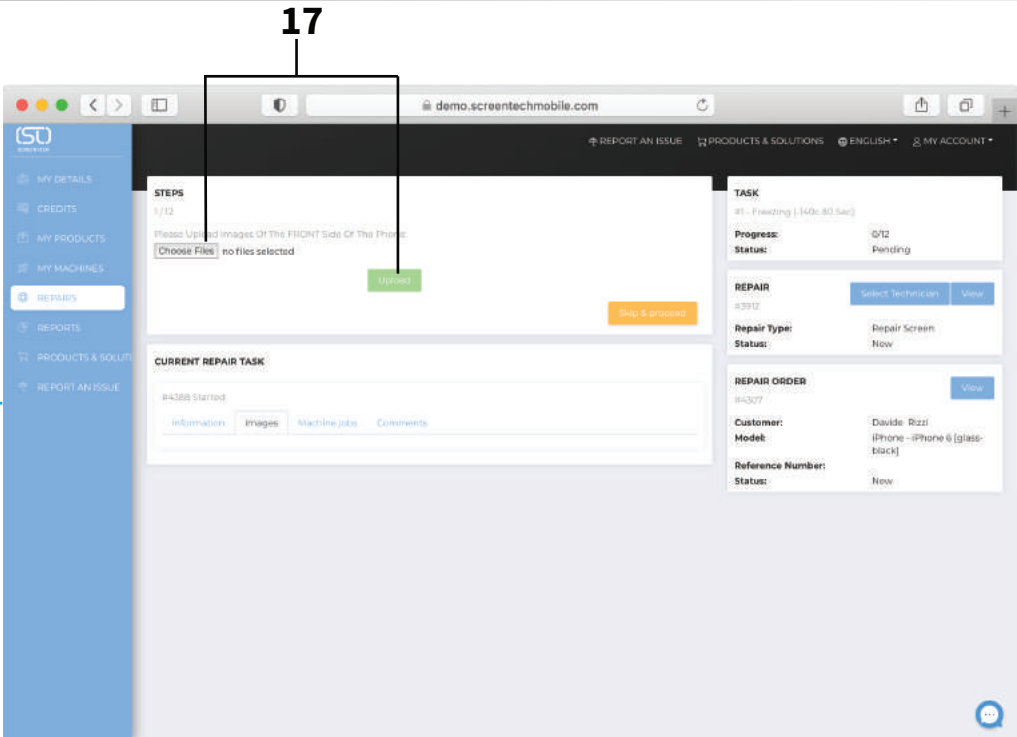

17

24

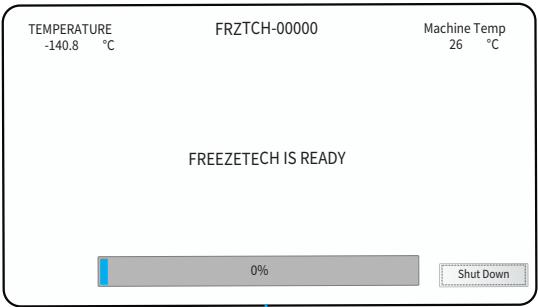

In order for the FreezeTech to be present in the list of machines it will need to be fully booted and ready

12

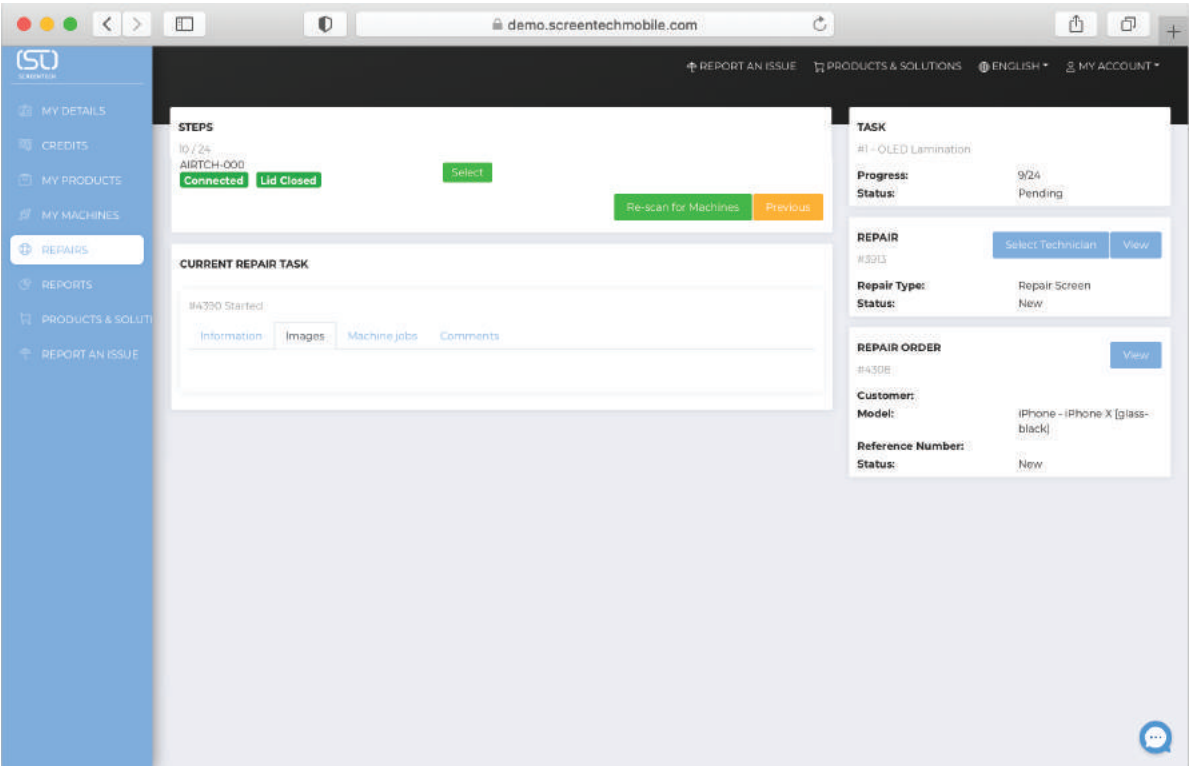
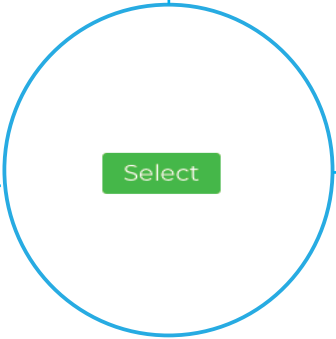

20

TEMPERATURE
-140.8 °C

FRZTCH-00000

Machine Temp
26 °C

-140 for 15 Minutes, Press to accept

0%

Shut Down

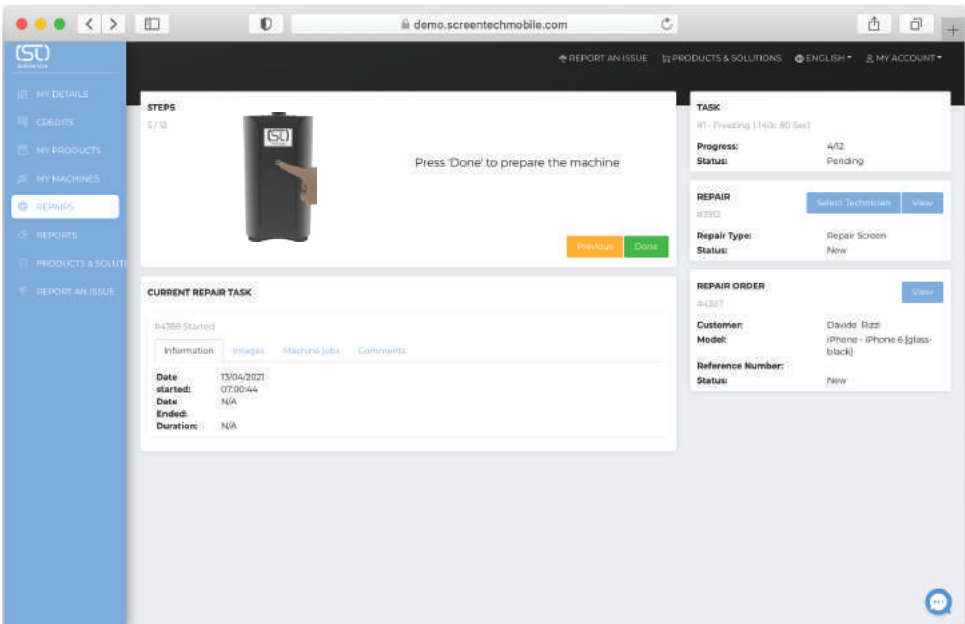

21

TEMPERATURE
-140.8 °C

FRZTCH-00000

Machine Temp
26 °C

System not ready, FreezeTech cooling
-140.00 for 15 Minutes

50%

Shut Down

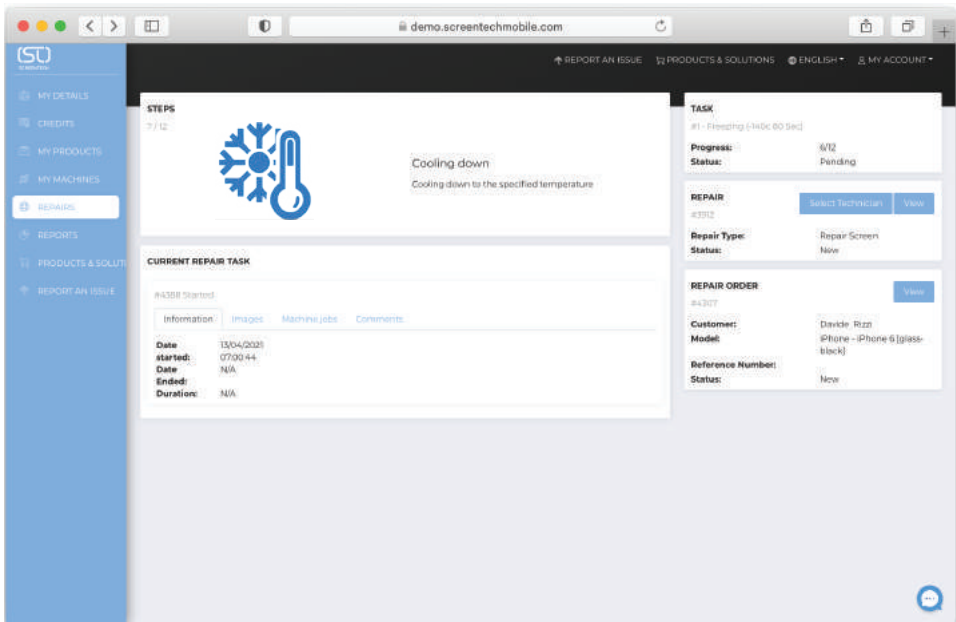

22

TEMPERATURE
-140.8 °C

FRZTCH-00000

Machine Temp
26 °C

1: Remove lid
2: Clean cold plate from dirt and insert device
3: Press button
4: Close lid

0%

Shut Down

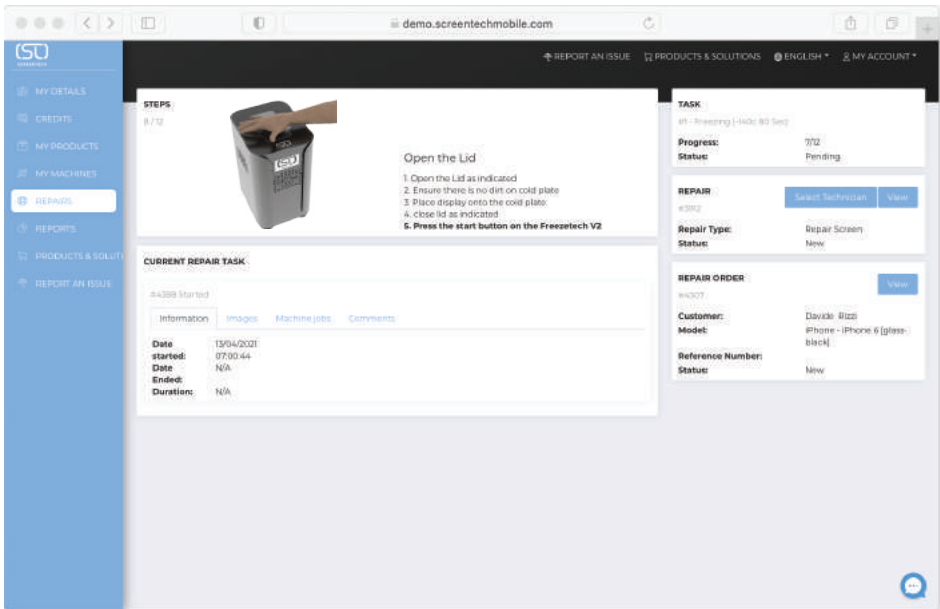

23



Press firmly in the center of the lid with the Palm of your hand to open the lid



Remove the Lid and place the device onto the cold plate



Place the Lid back into the closing position



Press firmly in the center of the lid with the Palm of your hand to close the lid

20



TEMPERATURE

-140.8 °C

FRZTCH-00000

Machine Temp

26 °C

PROCESS RUNNING

50%

Shut Down

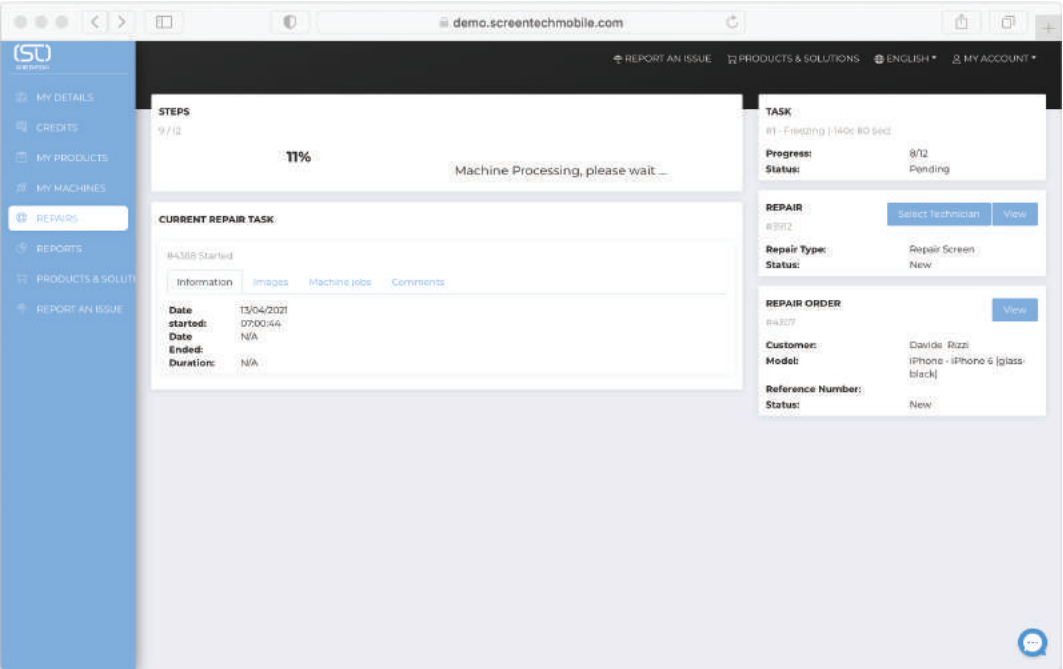

23



TEMPERATURE

-140.8 °C

FRZTCH-00000

Machine Temp

26 °C

PROCESS COMPLETED

100%

Shut Down

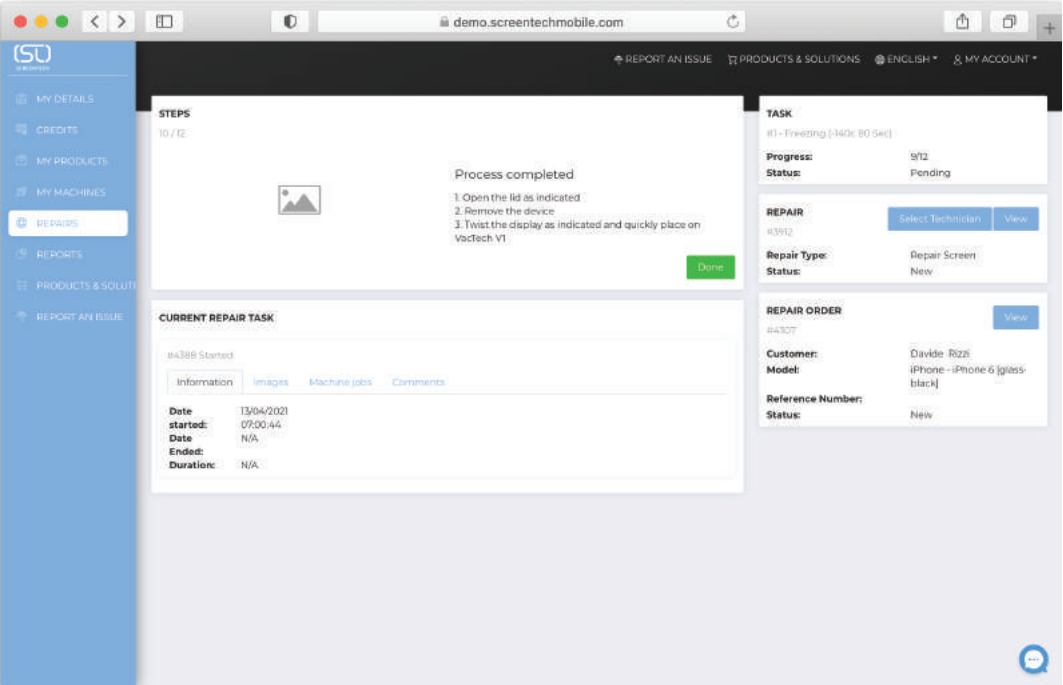

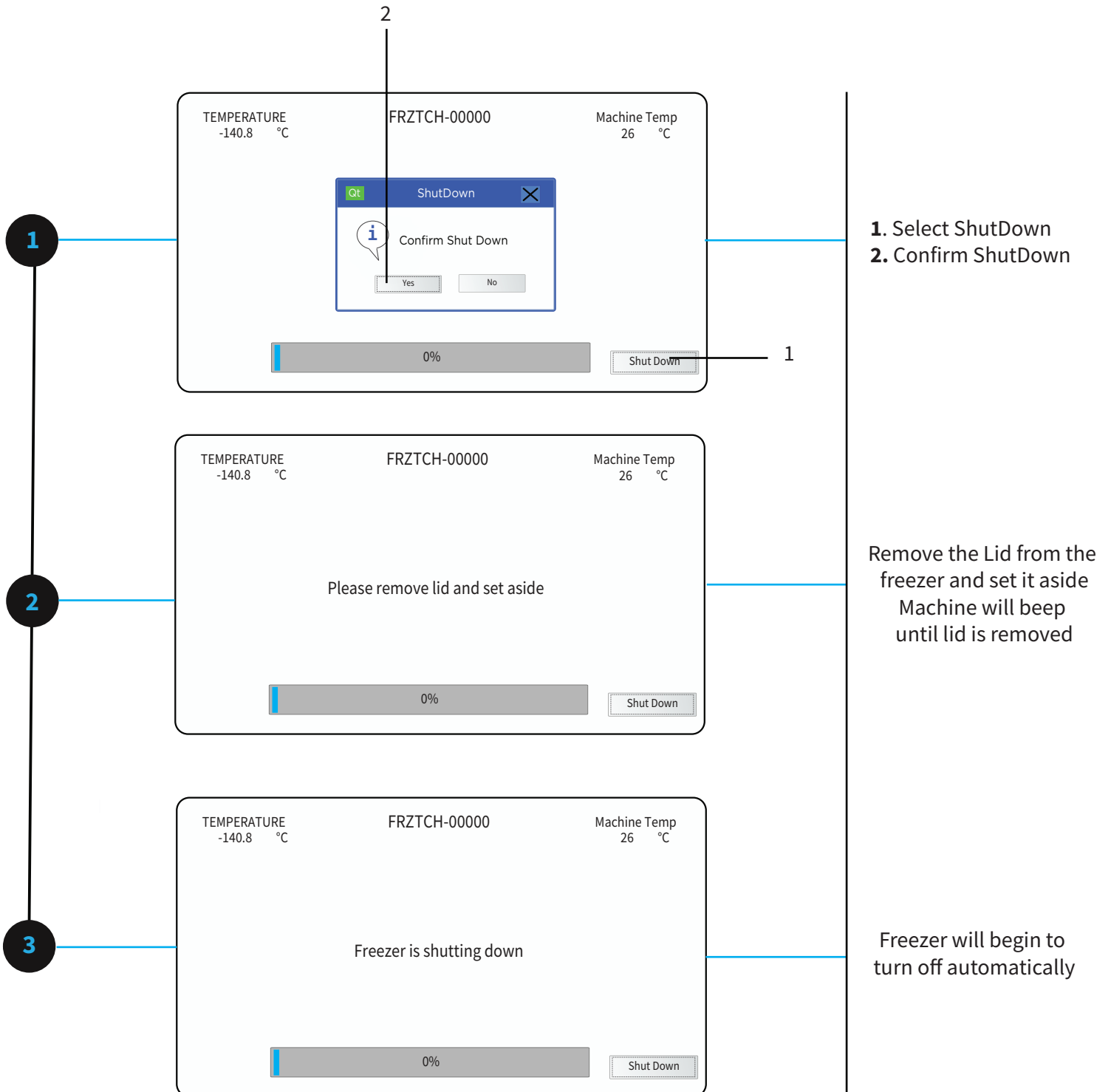

SCREENTECH STRIVES TO IMPROVE ITS PRODUCTS AT ALL TIMES. BOTH TEH DESIGN SPECIFICATIONS AND THESE USER INSTRUCTIONS ARE THUS TO SUBJECT TO CHANGE WITHOUT NOTICE.

POWER

INPUT VOLTAGE	Single Phase 110VAC/220VAC
OUTPUT VOLTAGE	24VDC
FREQUENCY	50-60Hz
WATTAGE	<= 150 WATTS

FEATURES

ENGINE	STIRLING COOLER FPSC
ENGINE VOLTAGE	19V
FREQUENCY	80Hz
TEMPERATURE MINIMUM	-185C
NOISE LEVEL MAXIMUM	<59DB
CONNECTION IOT	ETHERNET LAN

GENERAL

WEIGHT	42.4kg
DIMENSIONS	450MM x 355MM x 255MM

REGION	COUNTRY	CUSTOMER CARE CENTRE
EUROPE	GERMANY	+46 0000 0000
	GREECE	+46 0000 0000
	FRANCE	+46 0000 0000
	ITALY	+46 0000 0000
ASIA PACIFIC	HONG KONG	+46 0000 0000
AFRICA	SOUTH AFRICA	+46 0000 0000
LATIN AMERICA		

FCC Warning

This device complies with part 15 of the FCC rules. Operation is subject to the following two conditions: (1) this device may not cause harmful interference, and (2) this device must accept any interference received, including interference that may cause undesired operation.

Changes or modifications not expressly approved by the party responsible for compliance could void the user's authority to operate the equipment.

NOTE: This equipment has been tested and found to comply with the limits for a Class B digital device, pursuant to part 15 of the FCC Rules. These limits are designed to provide reasonable protection against harmful interference in a residential installation. This equipment generates uses and can radiate radio frequency energy and, if not installed and used in accordance with the instructions, may cause harmful interference to radio communications. However, there is no guarantee that interference will not occur in a particular installation. If this equipment does cause harmful interference to radio or television reception, which can be determined by turning the equipment off and on, the user is encouraged to try to correct the interference by one or more of the following measures:

- Reorient or relocate the receiving antenna.
- Increase the separation between the equipment and receiver.
- Connect the equipment into an outlet on a circuit different from that to which the receiver is connected.
- Consult the dealer or an experienced radio/TV technician for help.

Radiation Exposure Statement

This equipment complies with FCC radiation exposure limits set forth for an uncontrolled environment. This equipment should be installed and operated with minimum distance 20cm between the radiator and your body.