

## I. Download surplifeAPP

Download “Surplife” APP from Apple Store and Google Play Store, or scan the QR code.



surplife APP



## II. How to connect the controller to wi-Fi network?

1) Register/Login your surp life account.

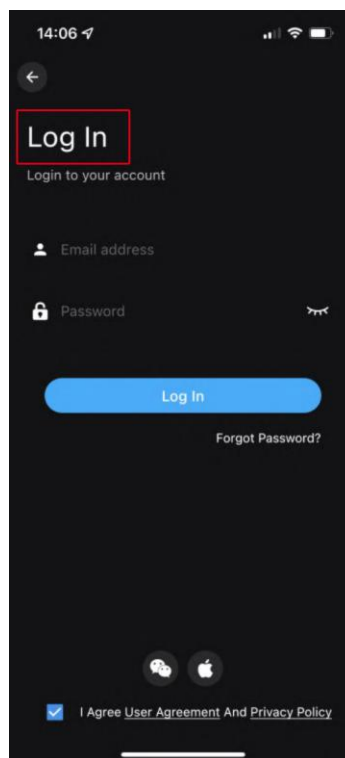
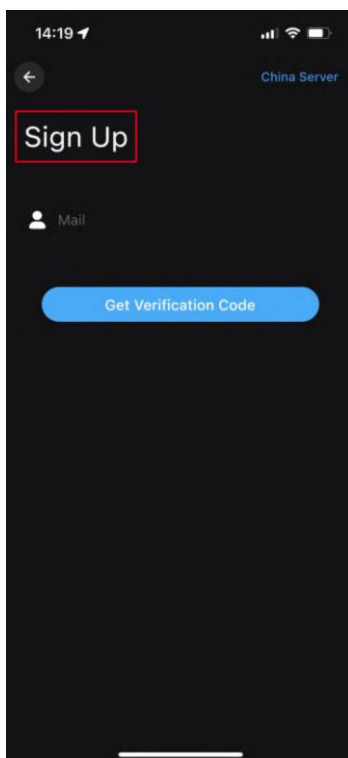
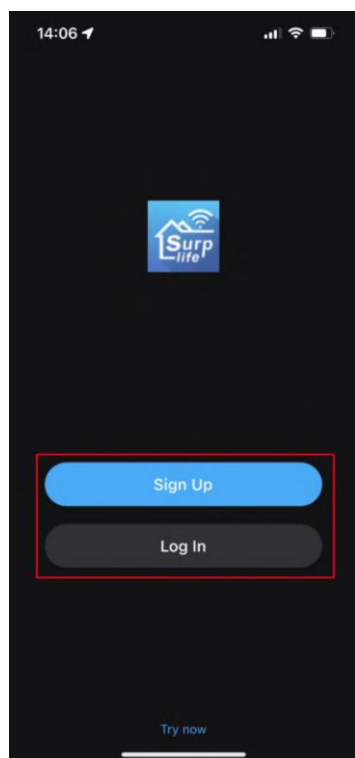

2)open your phone Bluetooth, turn on the device.

3) Enter "surplife" app, tap "Add Device" or click "+" to add the device.  
click Add to complete

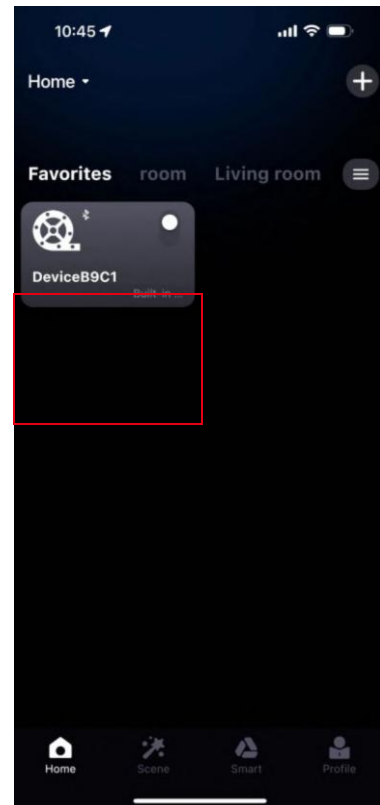
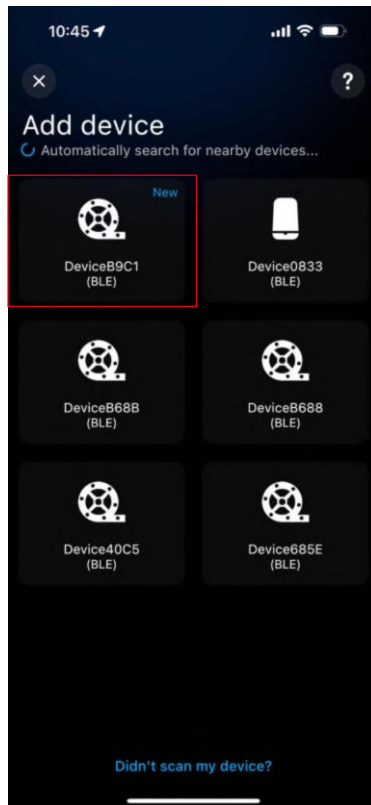
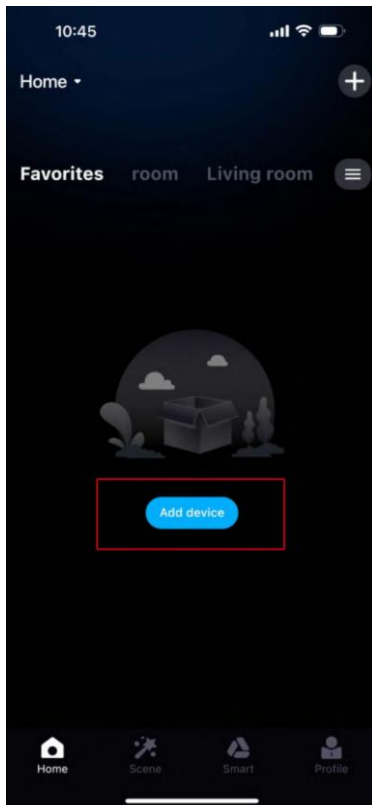

4) Rename the device and select a room for it.

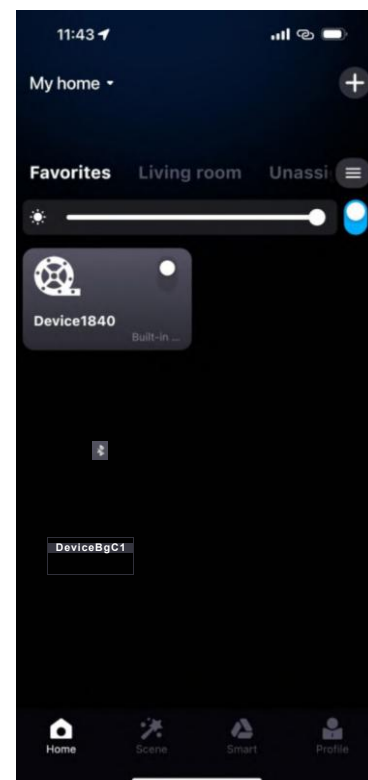
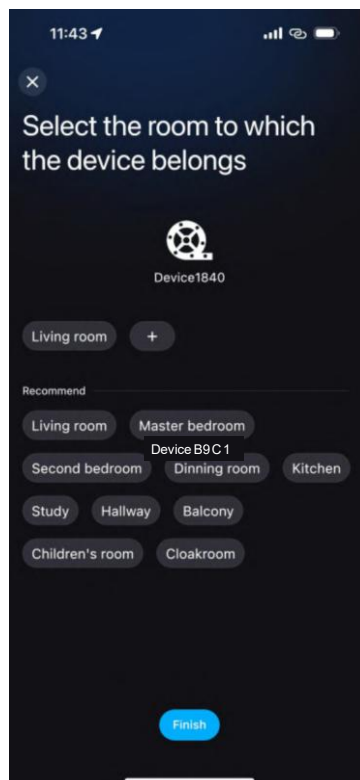
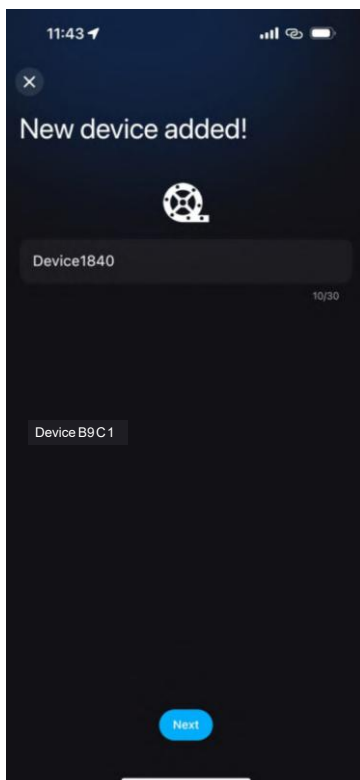

### III. Appfeatures in detail:

#### 1). Colorful function

In the color interface, you can adjust the color and brightness of the light strip. Click "+" to enter the static effect interface, in the static effect interface, you can add or delete the color of the light strip, and long press a static effect to delete or edit the static effect

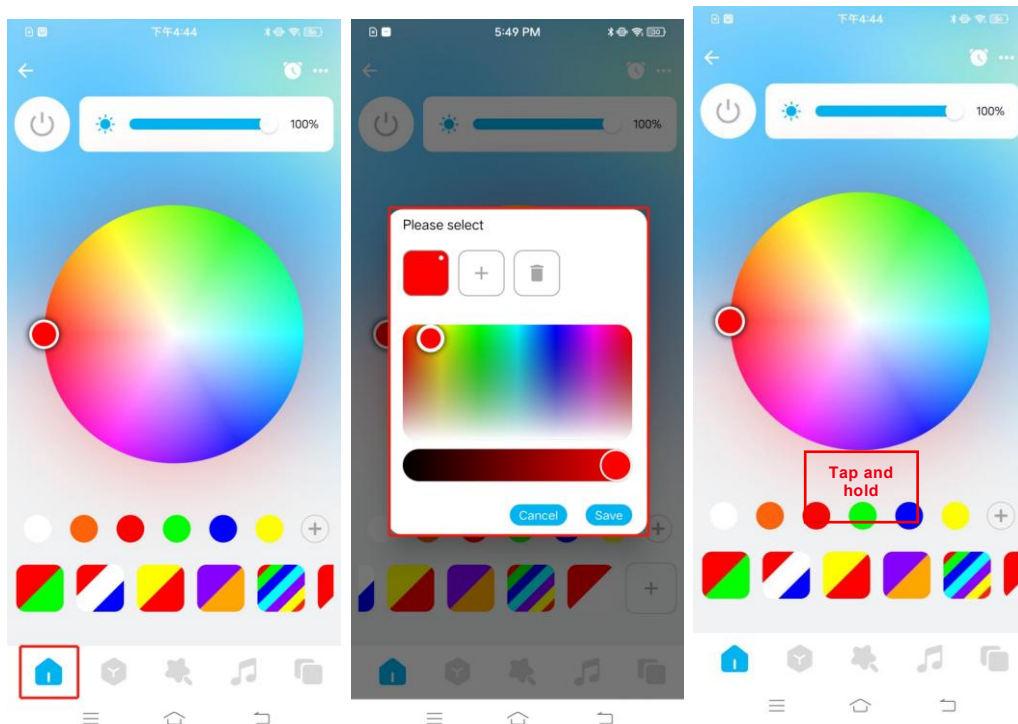

#### 2). Lighting effect

1) Built-in lighting effect selection of various categories of scene modes, and can be long pressed to save or edit to add custom effects. In the Custom effect screen, click Create Custom Effect to add a custom effect

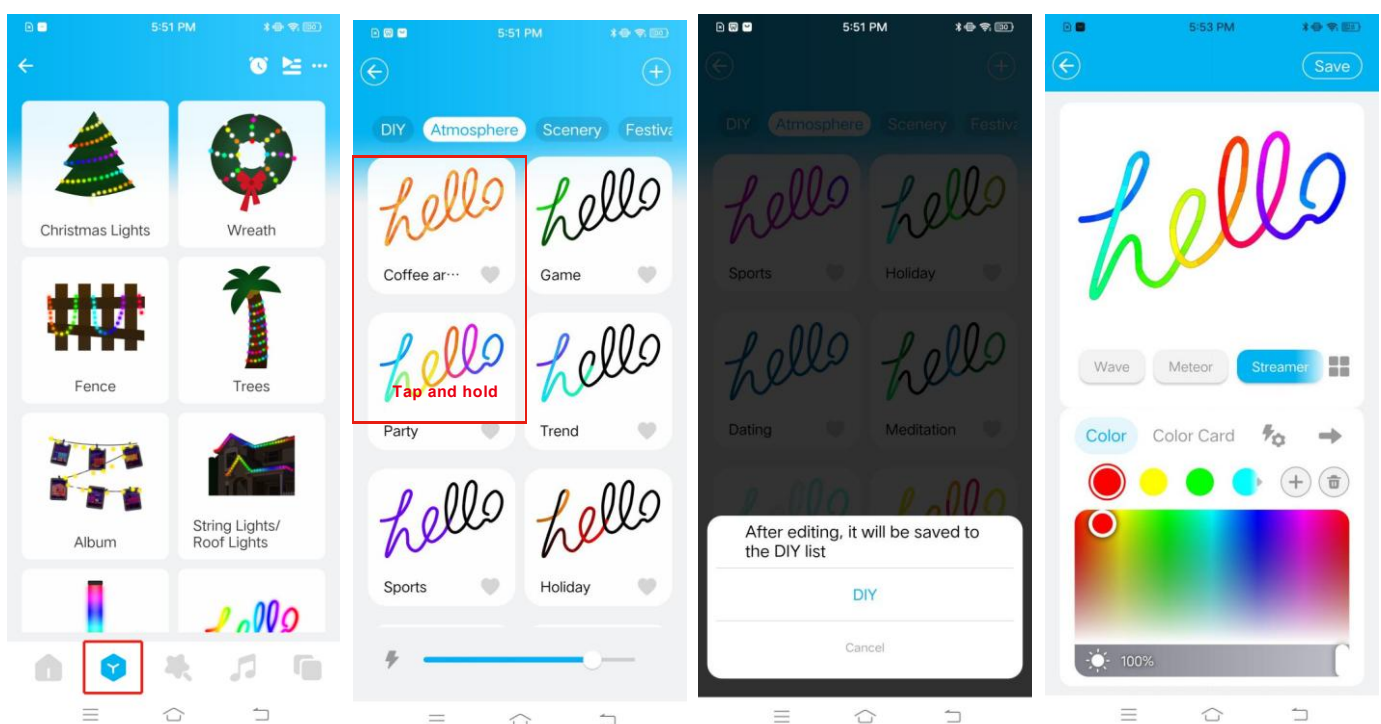

2) In the Custom Effects screen, click Create Custom Effect to add a custom effect.

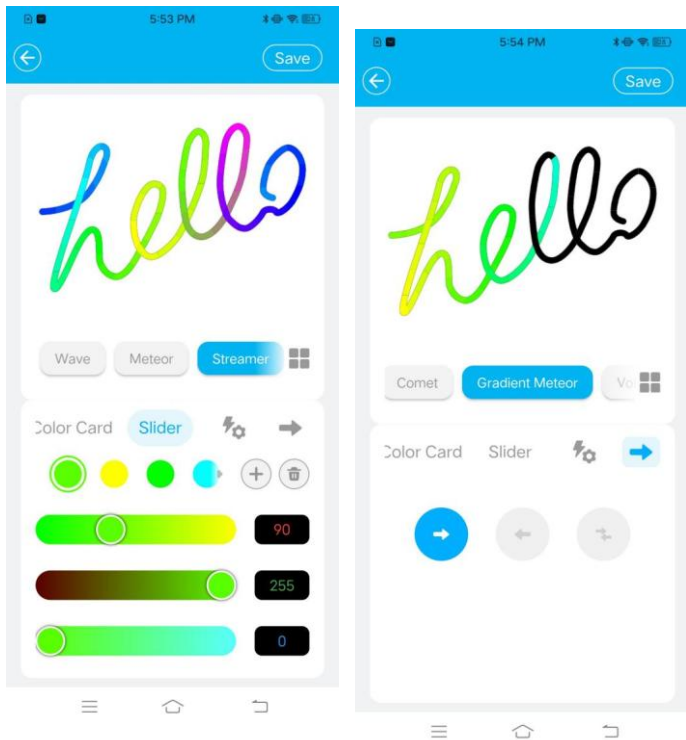

### 3) . Rotation function

You can select lighting effects for different categories of modes on the rotating screen and set the duration of the lighting effects. Different lighting effects can be combined and played back in sequence.

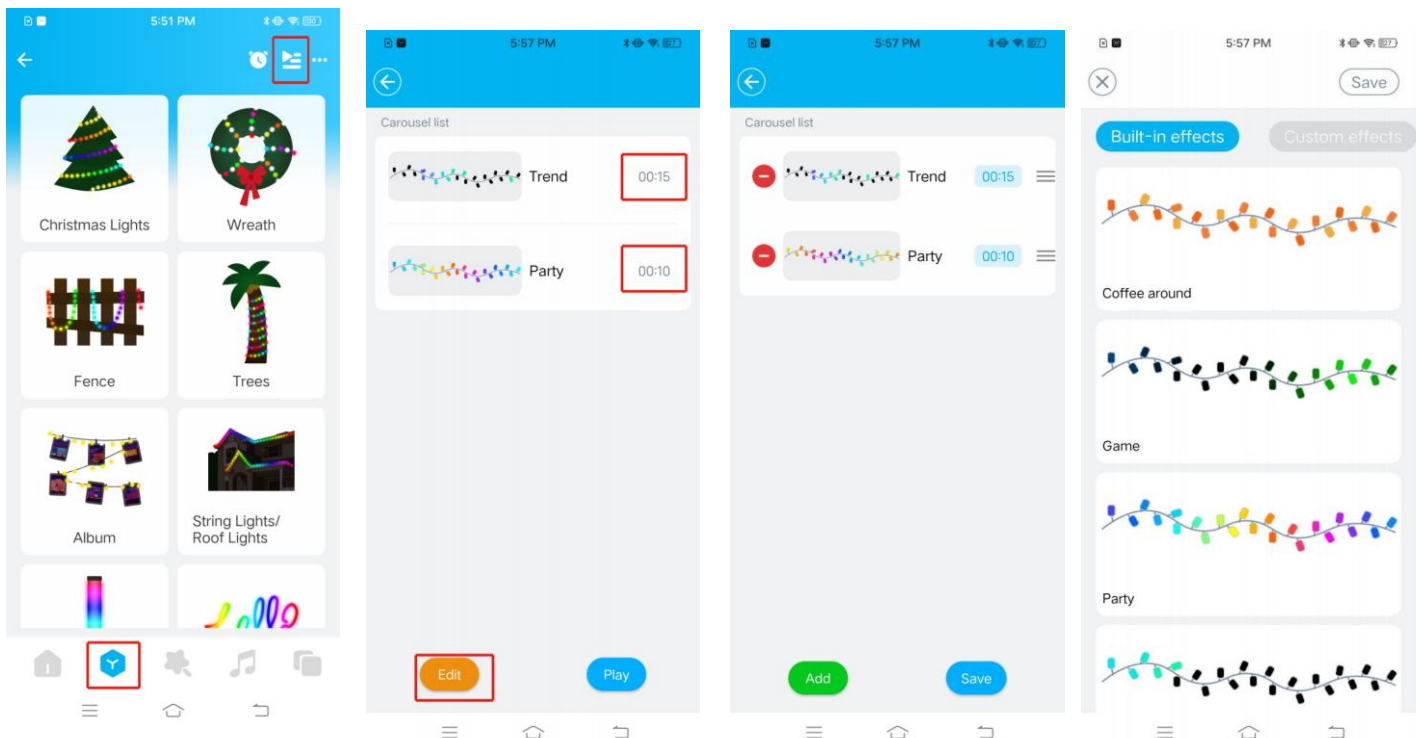



#### 4). Spreading function

1) Single-frame smear interface: click Create Smear, select dynamic effect, color and color ratio, and click Save after setting.

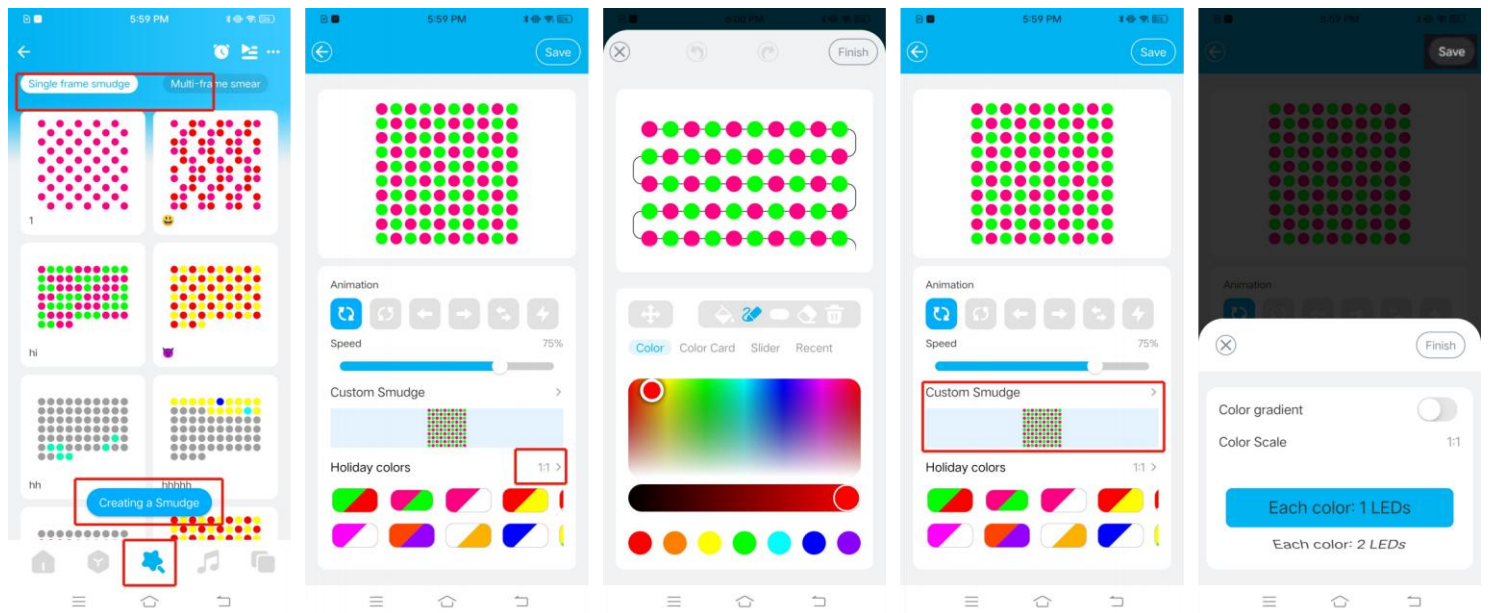

2) Multi-frame paint interface: click to create a paint, slide the slider can be set to adjust the speed, click “+” to add a frame of the canvas to select the color of each frame, click save after the settings are complete.

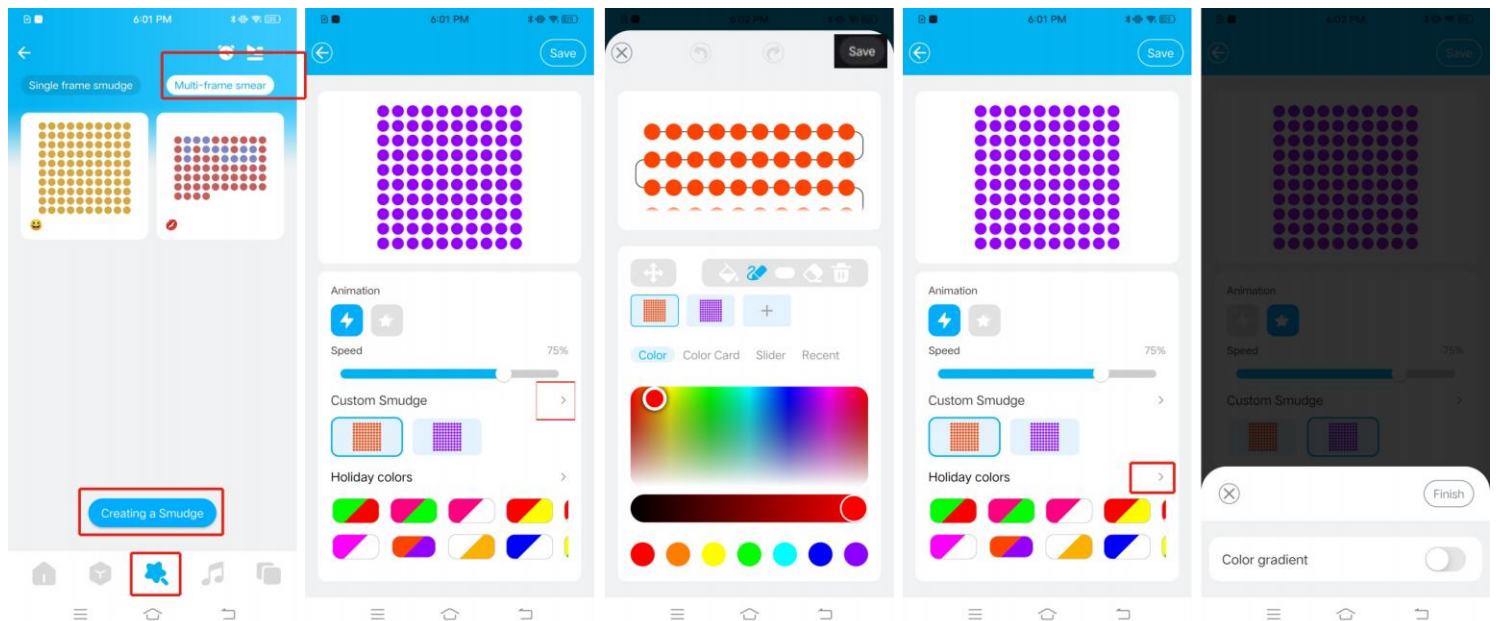

## 5). Rhythmic function

### 1) Music Mode: Lighting jumps and changes with the rhythm of music

Click “Add Sound”to import a sound file or import from the built-in sound library.

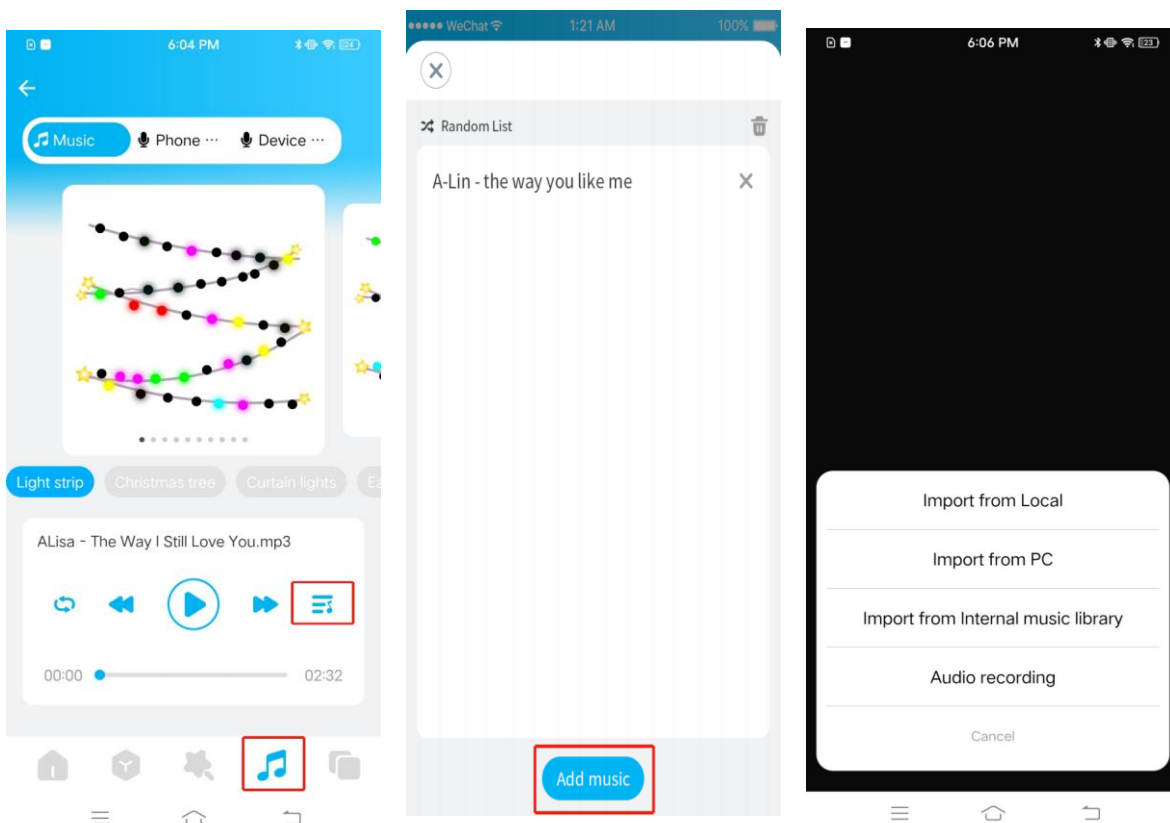

### 2) Microphones

Cell phone cycloid or device cycloid function that converts light effects to different rhythms according to the signal received by the cycloid

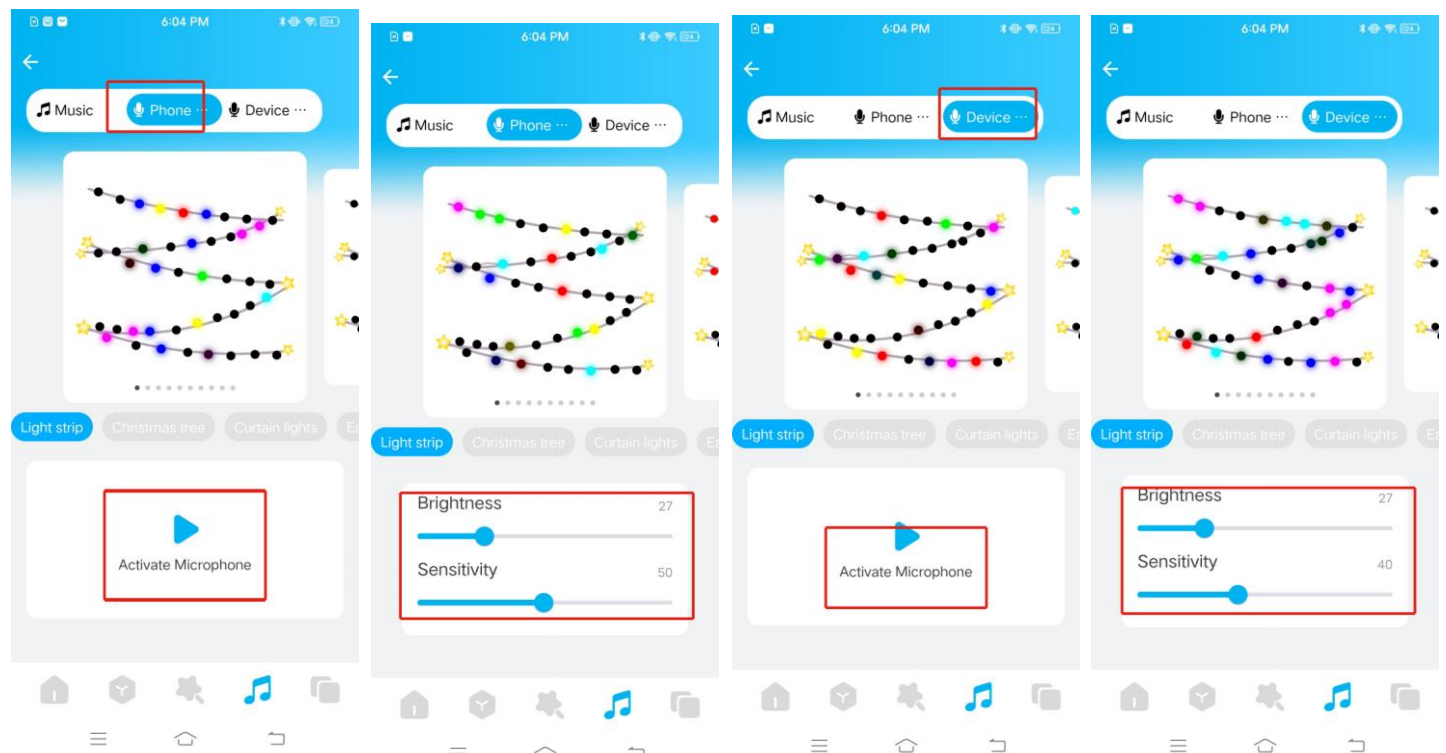

## 6). Timing function

The lights controlled by this unit can be switched on and off according to the set time. When the lights are turned on, you can select colorful or moody lighting effects by yourself.

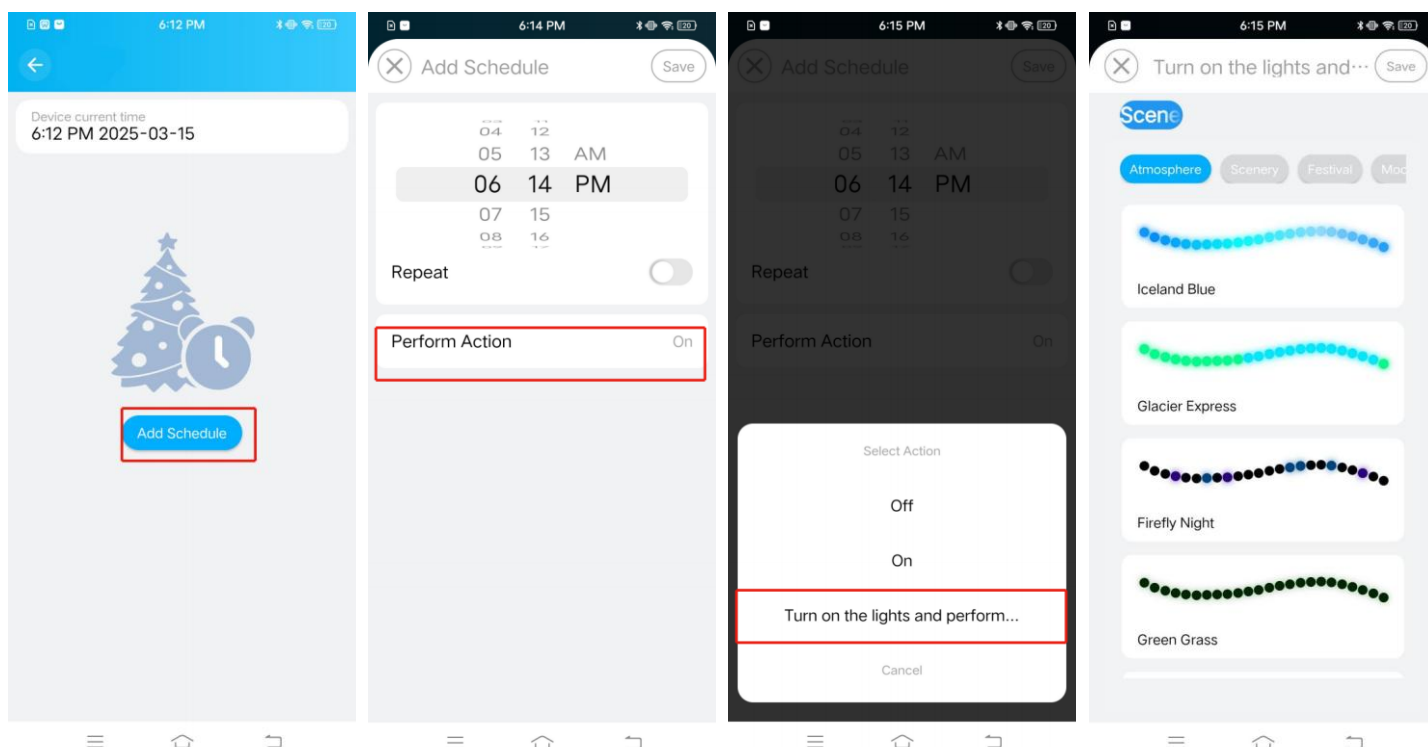

## 7). Group control function

Classify multiple controllers into the same group, you can simultaneously control the equipment in the group with one key dimming and color dimming, switching and other functions.

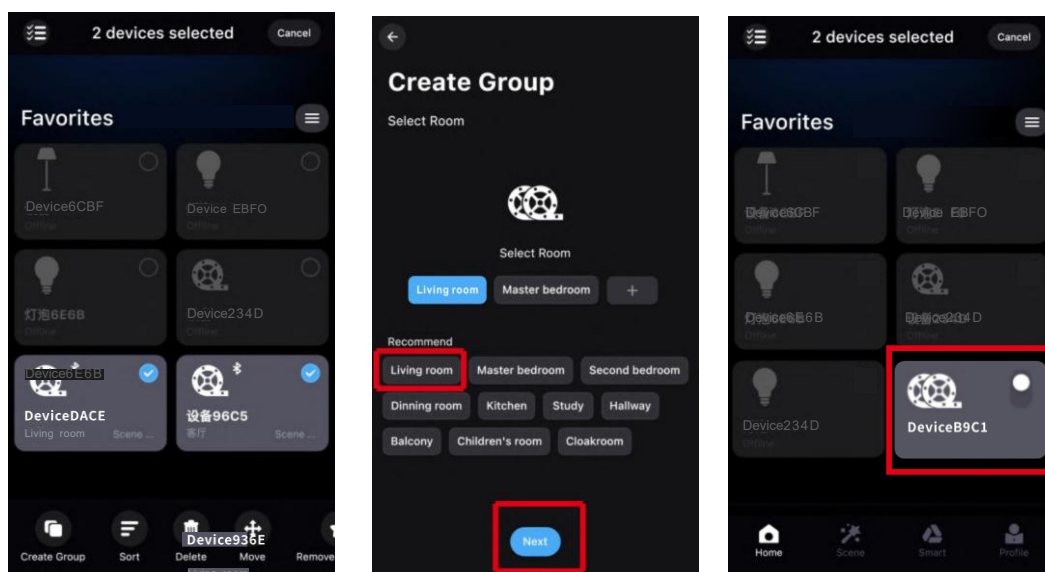

## 8). Scene Functions

In the scene interface, find the corresponding controller to create different scene lighting colors or dynamic effects according to your personal needs.

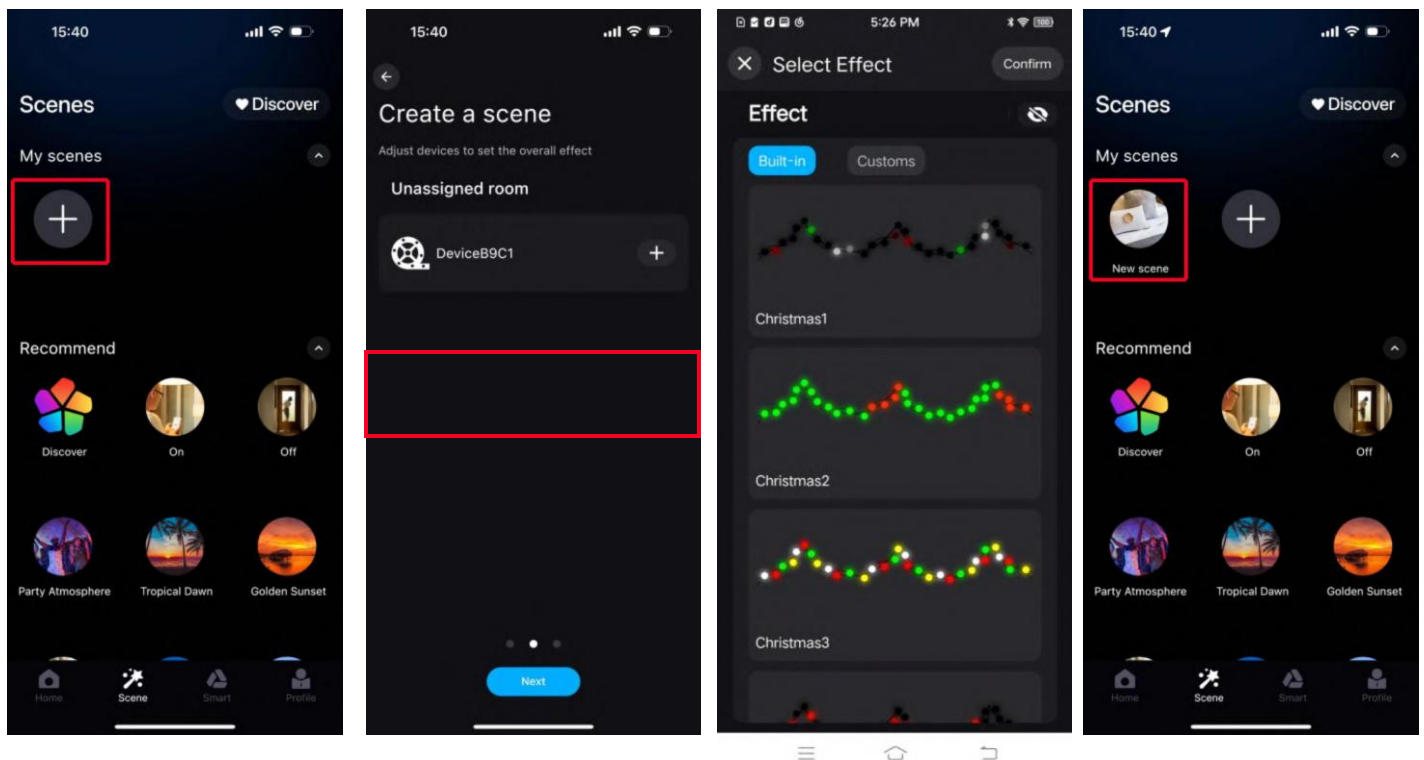

### FCC Statement

This equipment has been tested and found to comply with the limits for a Class B digital device, pursuant to Part 15 of the FCC Rules. These limits are designed to provide reasonable protection against harmful interference in a residential installation. This equipment generates uses and can radiate radio frequency energy and, if not installed and used in accordance with the instructions, may cause harmful interference to radio communications. However, there is no guarantee that interference will not occur in a particular installation. If this equipment does cause harmful interference to radio or television reception, which can be determined by turning the equipment off and on, the user is encouraged to try to correct the interference by one or more of the following measures:

- Reorient or relocate the receiving antenna.
- Increase the separation between the equipment and receiver.
- Connect the equipment into an outlet on a circuit different from that to which the receiver is connected.
- Consult the dealer or an experienced radio/TV technician for help.



This device complies with part 15 of the FCC Rules. Operation is subject to the following two conditions: (1) This device may not cause harmful interference, and (2) this device must accept any interference received, including interference that may cause undesired operation.

Changes or modifications not expressly approved by the party responsible for compliance could void the user's authority to operate the equipment.

This equipment should be installed and operated with minimum distance 20cm between the radiator & your body.

## Attentions

- 1) Please use the product in a dry environment.
- 2) For input voltage, please use the AC voltage within the specified range as instructed in the manual, must not connect into 380VAC directly.
- 3) The product is requested common anode connection. The wrong connection will cause a malfunction.