

OSMA

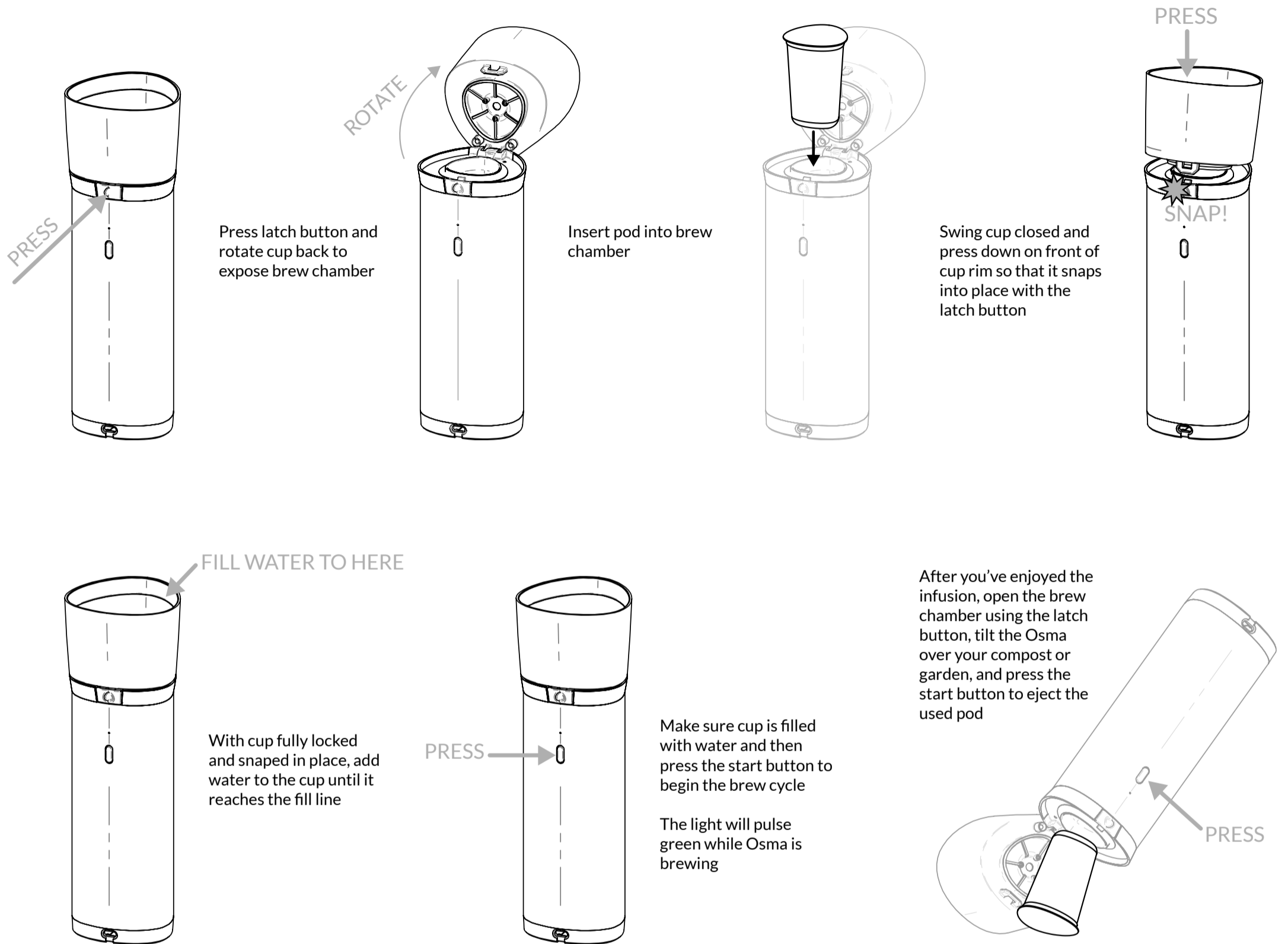

FCC

Any changes or modifications to this equipment not expressly approved by Osma for compliance will void the user's authorization to operate this equipment.

This equipment has been tested and found to comply with the limits for a Class B digital device, pursuant to part 15 of the FCC Rules. These limits are designed to provide reasonable protection against harmful interference in a residential installation. This equipment generates, uses and can radiate radio frequency energy and, if not installed and used in accordance with the instructions, may cause harmful interference to radio communications. However, there is no guarantee that interference will not occur in a particular installation. If this equipment does cause harmful interference to radio or television reception, which can be determined by turning the equipment off and on, the user is encouraged to try to correct the interference by one or more of the following measures:

Reorient or relocate the receiving antenna.
Increase the separation between the equipment and receiver.
Connect the equipment into an outlet on a circuit different from that to which the receiver is connected.
Consult the dealer or experienced radio/TV technician for help.

This device complies with part 15 of the FCC Rules. Operation is subject to the following two conditions: (1) This device may not cause harmful interference, and (2) this device must accept any interference received, including interference that may cause undesired operation.

For body worn application, this device has been tested and meets FCC RF exposure guidelines when used with the Osma. Use of other accessories may not ensure compliance with FCC RF exposure guidelines.

IC

This device contains licence-exempt transmitter(s)/receiver(s) that comply with Innovation, Science and Economic Development Canada's licence-exempt RSS(s). Operation is subject to the following two conditions:

This device may not cause interference.
This device must accept any interference, including interference that may cause undesired operation of the device.

For body worn application, this device has been tested and meets ISSED RF exposure guidelines when used with the Skydio 2. Use of other accessories may not ensure compliance with ISSED RF exposure guidelines.

L'émetteur/récepteur exempt de licence contenu dans le présent appareil est conforme aux CNR d'Innovation, Sciences et Développement économique Canada applicables aux appareils radio exempts de licence. L'exploitation est autorisée aux deux conditions suivantes :

L'appareil ne doit pas produire de brouillage;
L'appareil doit accepter tout brouillage radioélectrique subi, même si le brouillage est susceptible d'en compromettre le fonctionnement.

Pour les applications portées sur le corps, cet appareil a été testé et répond aux directives d'exposition ISDE RF lorsqu'il est utilisé avec le Osma. L'utilisation d'autres accessoires peut ne pas garantir la conformité aux directives d'exposition ISSED RF.