

Totally Touchless **CARDI/O®** Quick Start Guide

Model No. ATX-2410-GW

Technical Specifications

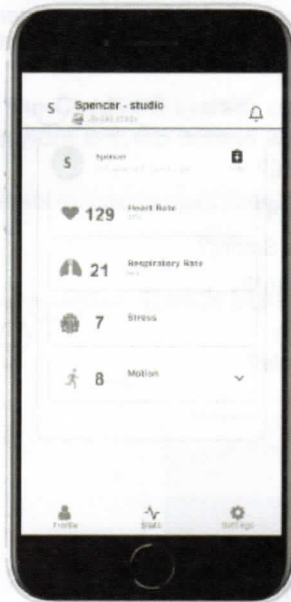

www.cardio.io

CARDI/O®

CARDI/O® FEATURES:

- Touchless Heart Rate, Respiratory Rate, Stress (Heart Rate Variability / HRV), Motion
- Typical room coverage up to 3 meters, varies by individual
- Dual Wall Mount for flat surfaces or corners
- Moisture resistant and dust resistant
- "ON" light indicator
- WiFi connectivity
- Android & iOS Phone Apps
- My Cardi/o® Skill for Amazon Alexa, featuring Commands:
 - Alexa, Open my Cardi/o®. *[The user must start this this command]*
 - What are the features?
 - What are the stats of [Henry Smith]?
 - What are [Henry Smith's] stats?
 - What is the heart rate of [Henry Smith]?
 - What is the pulse rate of [Henry Smith]?
 - What is the respiratory rate of [Henry Smith]?
 - What is the breath rate of [Henry Smith]?
 - What is [Henry Smith's] heart rate?
 - What is [Henry Smith's] respiratory rate?
 - What is [Henry Smith's] breath rate?
 - What are the vitals of [Henry Smith]?
 - What are [Henry Smith's] vitals?

WHAT'S IN THE BOX

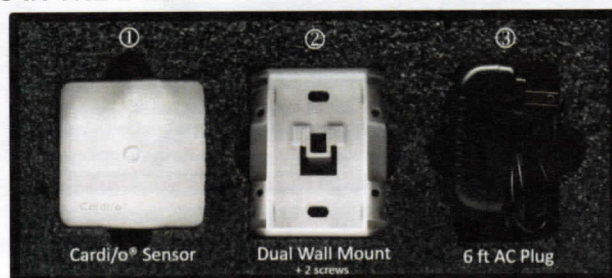

QUICK START – 3 Steps

1. Download the Cardi/o® Phone App for Android or iOS

- Create a User Account – a passcode will be sent to the email used to set up the account.

2. Scan the QR code located on the product package to connect the Cardi/o® sensor to your phone (sensor must be plugged in)

- Follow the instructions to connect to sensor's access point SSID.

3. Connect the Cardi/o® sensor to Wi-Fi by entering the local WiFi SSID/password into the screen when prompted.

The sensor connects and is operational when the indicator LED is blue.

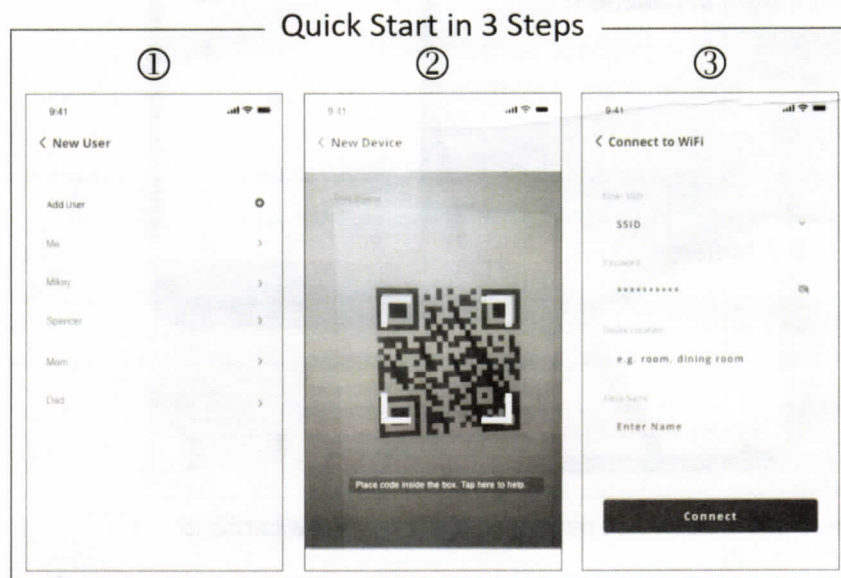

ASSEMBLY & INSTALLATION - CARDI/O® SENSOR

Note: Check first that the Power Cord will extend to power

1
Thread Power Cord
through Wall Mount

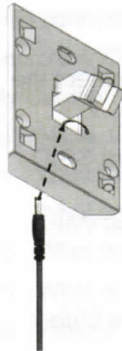

2
Screw Wall Mount to
flat wall or corner wall

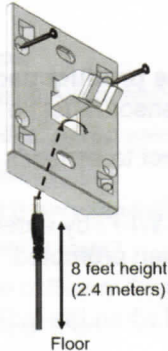

8 feet height
(2.4 meters)
Floor

3
Slide Cardi/o® Sensor
onto Wall Mount

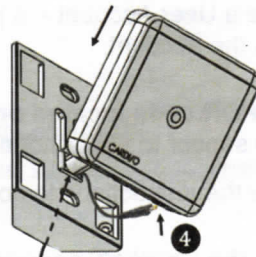

4
Plug in power cord
to Cardi/o® Sensor
and wall outlet



Correct height installation:

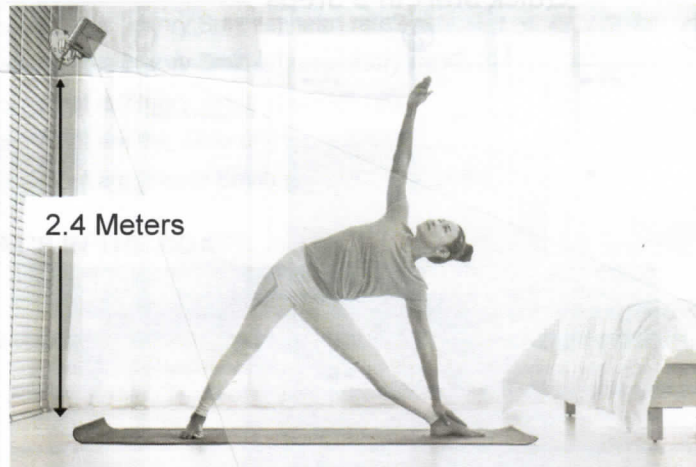

For more information visit our **support** page at www.cardio.io.

TECHNICAL SPECIFICATIONS

HARDWARE DIMENSIONS

Weight: 142g (sensor + mount + cable)

Sensor Dimensions: 7.62 cm x 7.62 cm x 1.91 cm

MEASUREMENTS

Heart Rate: 30 – 180 BPM

Respiratory Rate: 9 – 60 bpm

Stress (HRV) Score: 0 – 10

Motion Intensity: 0 – 10

Sensing Field of View: 30 degrees

Dynamic Sensing Range: Max sensing range varies between 2-3 meters;
varies with different individuals. Maintain 5 cm
minimum separation from Cardi/o[®] sensor

COMMUNICATION

24.0 – 24.497 GHz ISM band

IEEE 802.11b/g/n, Wi-Fi compliant

WEP-128, WPA-PSK (TKIP), WPA2-PSK security

POWER CONSUMPTION & OUTPUT

110V – 240V – 50/60 Hz 0.4A max

Output 5.9V 2.0A max

OPERATING ENVIRONMENT

Temperature: 0 – 70°C

Humidity: 10 – 95% RH (noncondensing)

Altitude: <3000 m

FCC ID: 2AXL8-ATX2410V4P1

The Cardi/o[®] Sensor complies with part 15 of the FCC Rules. Operation is subject to the following two conditions: (1) This device may not cause harmful interference, and (2) This device must accept any interference received, including interference that may cause undesired operation (FCC Title 47, Subpart C, Part 15.249)

This device includes FCC ID: O7P-362.



ONE-YEAR LIMITED MANUFACTURER'S WARRANTY

Advanced TeleSensors, Inc. hereby warrants solely to End User that its hardware product will not contain any defects in material or workmanship that cause such product to fail to function in any material respect when properly operated (the "Product Warranty") for a period of twelve (12) months from the date of purchase (the "Warranty Period") by End User.

See www.cardio.io for specific warranty information about your product and procedures to act on a warranty claim. Advanced TeleSensors' entire liability and your exclusive remedy for any breach of warranty shall be, at Advanced TeleSensors' option, to repair or replace a functional equivalent of the product. You may be required to furnish proof of purchase details when making a claim under this warranty. Warranty protections are in addition to rights provided under local consumer laws and may vary among countries, states, and cities. See the full warranty information to know your consumer rights and the additional protections provided by this warranty.

Register your product at <https://cardio.io/pages/register>.

CUSTOMER SUPPORT

If you find your Cardio® product is experiencing or demonstrating any abnormal behavior, immediately stop all product use and contact us at support@cardio.io.

COPYRIGHTS AND DISCLAIMER

Information furnished is believed to be accurate and reliable. However, Advanced TeleSensors assumes no responsibility for the consequences of use of such information nor for any infringement of patents or other rights of third parties which may result from its use. No license is granted by implication or otherwise under any patent or patent rights of Advanced TeleSensors. Specifications mentioned in this publication are subject to change without notice. This publication supersedes and replaces all information previously supplied. Advanced TeleSensors products are not authorized for use as critical components in life support devices or systems without express written approval of Advanced TeleSensors, Inc.

MADE IN THE USA

CARDIO®

Revision Information

- ATX-2410-GW Quick Start Guide; V1-02
 - pn 44133-003*
- © 2022 All rights reserved. CARDIO® is a registered trademark of Advanced TeleSensors, Inc.

Advanced TeleSensors, Inc.

5114 Balcones Woods Dr, STE 307-472

Austin, TX 78759 USA

Tel: (888) 292-2208

support@cardio.io

Addendum