

Quick Guide of Smart wifi bulb A19-S01

1.What you need to get started

Before using Echo to control your smart devices, make sure you meet the following conditions,

- Stable WIFI network which could access to Amazon server, (For mainland China users)
- An Echo device, including Echo, Echo Tap, or Echo Dot,
- An Amazon account,
- Smart Life app and a related account,
- Make sure there's at least one device under your Smart Life account, and the device's name could be easily recognized by Echo (e.g., bedroom light),

2. Add smart devices in Smart Life app

You can skip this part if you've already add some devices to your Smart Life account, and in the mean time the devices' name are easily recognized,

2.1 Download Smart Life app

You can scan the QR code below to download the Smart Life app,



You can also search "Smart Life" in either App Store or Google Play to install the app.
IOS version download: [App Store](#)
Android version download: [Google Play](#)

2.2 Register a Smart life account

Open the Smart Life app, tap "Register", then register a Smart Life account.

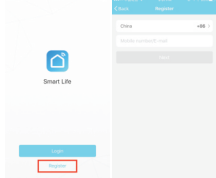

2.3 Add device

Sign in with the Smart Life account, tap on the top right corner, then follow the instructions to add device,



2.4 Change device's name

After you managed to add the device, get into the device panel, tap on the top right corner, then change device's name to a easily recognized word or phrase, like **bedroom light**.

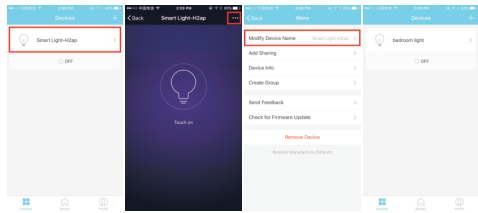

3. Set up Amazon Echo and enable Smart Life Skill

We suggest using web for configuration in mainland China since Alexa app is not available here.

User can configure Echo through web or Alexa app.

Web configuration link: <http://alexa.amazon.com/spa/index.html>

Download Alexa app: [iOS version](#), [Android version](#)

In this manual, we take Alexa app as an example.

3.1 Set up Echo with Alexa app

You can skip this part if your Echo is already set up.

1. Make sure your Echo device is energized.
2. Make sure there's a stable WIFI network which could access to Amazon server, (For mainland China users)
3. Open the Alexa app by tapping the app icon on your mobile device.
4. Type in your Amazon account and password, then tap



5. Tap the hamburger menu on the top left corner, select , then tap .

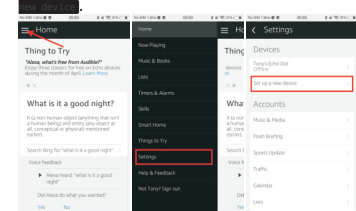

6. Select your Echo model, choose a proper language, then tap .

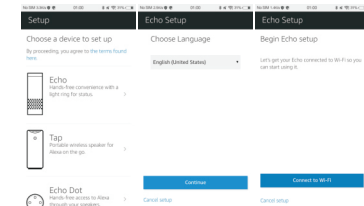

7. Long press the dot button on the top of your Echo device until the orange light shows up, then tap . To let the phone automatically link Echo's hotspot, tap .

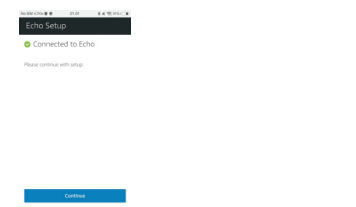
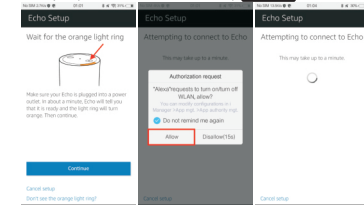

8. Select a Wi-Fi to let Echo have the access to the Internet. Type in the Wi-Fi password, then tap . Echo may take several minutes to connect the network.

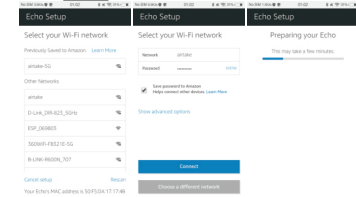

9. Tap when Echo is connected to the network. After an introduction video, tap to finish the setup.

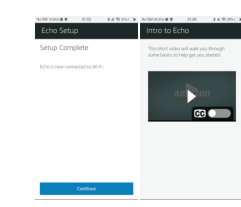

3.2 Link Smart Life account to Echo

1. Tap in the hamburger menu, then search "Smart Life". Select "Smart Life" and tap to enable the Smart Life Skill.

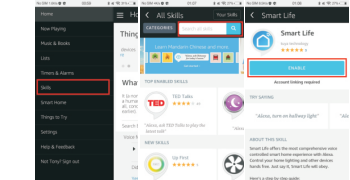

2. You will be redirected to the account link page. Type in your Smart Life account and password, don't forget to select the country/region where your account belongs to. Then tap to link your Smart Life account. When "Alexa has been successfully linked with Smart Life" shows up, tap on the top right corner.

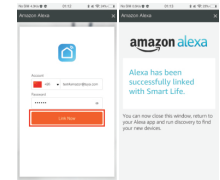

4. Control your smart devices through Echo

4.1 Discover devices

Echo needs to discover your smart devices before it controls them. You can say "Alexa, discover devices" to Echo. Echo will discover devices which have already been added in the Smart Life app.

You can also tap to discover the smart devices. Discovered devices will be shown in the list.

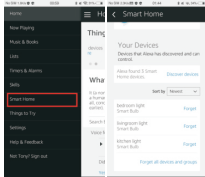

Note: every time you change the device's name on Smart Life app, Echo must re-discover before you control them.

4.2 Control devices by voice commands

Now you can control your smart devices through Echo. You can use the following commands to control your devices(e.g., bedroom light):

- Alexa, turn on/off bedroom light.
- Alexa, set bedroom light to 50 percent.
- Alexa, brighter/increase bedroom light.
- Alexa, dim/decrease bedroom light.

You can also set up groups in Alexa app. Tap give your group a name like "my smart lights", select devices to add them in this group, then tap .

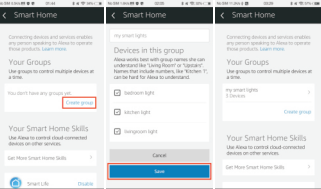

Now you can control your devices by group. Try saying "Alexa, turn on my smart lights", all the lights are turned on!

We also support light strips, smart plugs, smart switches, heaters, e.t.c.

FCC Statement

This device complies with Part 15 of the FCC rules. Operation is subject to the following two conditions: 1) this device may not cause harmful interference, and 2) this device must accept any interference received, including interference that may cause undesired operation.

Note: This equipment has been tested and found to comply with the limits for a Class B digital device, pursuant to part 15 of the FCC Rules. These limits are designed to provide reasonable protection against harmful interference in a residential installation.

This equipment generates uses and can radiate radio frequency energy and, if not installed and used in accordance with the instructions, may cause harmful interference to radio communications. However, there is no guarantee that interference will not occur in particular installation. If this equipment does cause harmful interference to radio or television reception, which can be determined by turning the equipment off and on, the user is encouraged to try to correct the interference by one or more of the following measures:

- Reorient or relocate the receiving antenna.
- Increase the separation between the equipment and receiver.
- Connect the equipment into an outlet on a circuit different from that to which the receiver is connected.
- Consult the dealer or an experienced radio/TV technician for help.

Changes or modifications not expressly approved by the party responsible for compliance could void the user's authority to operate the equipment.

Radiation Exposure Statement

This device complies with RF radiation exposure limits set forth for an uncontrolled environment. This transmitter must not be co-located or operating in conjunction with any other antenna or transmitter.

This device must operate with a minimum distance of 20 cm between the radiator and user body.