

Varicolored Meteor Galaxy Projector

7th
Generation

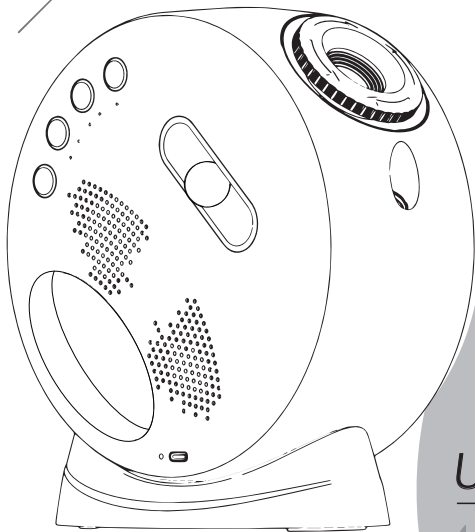

User Manual

Unboxing Check

- Thank you for purchasing our products, please read the user manual carefully before use. The user manual contains necessary safety advice and user instructions, follow them to operate to avoid damaging the product for misuse.
- Check the product to ensure it is in good condition when received. Do not disassemble the host and component by yourself.

Package List

- Varicolored Meteor Galaxy Projector x 1
- Base x 1
- Wireless Remote Control x 1
- USB Type-C Cable x 1
- User Manual x 1
- Film Discs x 2 Boxes (6pcs/box)

Warning:

- This product requires a USB Type-C DC 5V/2A power supply. The product has undergone comprehensive and rigorous testing before leaving the factory. Users should strictly adhere to the warnings and instructions. Improper use resulting in product damage is not covered under our warranty.

Warm Tips

- Film discs are consumable accessories. To extend their lifespan, it is recommended to frequently alternate and replace them.
- For optimal projection results, it is suggested that users operate the projector in a dark environment, particularly when projecting onto a white background wall at a distance of 2 meters (6.56 feet) for best clarity and reality.

- The protruding device on the lens part of the main unit is the focus adjustment knob. By rotating it back and forth, the projection clarity can be adjusted.
- The slow-speed mode of this product simulates the slow orbit of planets. If users prefer a faster rotation effect, it is recommended to switch to the fast-speed mode.
- Time Calibration: For first-time use, time calibration is required. Connect to the Bluetooth "BL-YHX06" via your phone, this product requires permission to access your phone to read and sync with the current phone time.

Instructions for Use

- This product has a built-in bluetooth speaker. When powered on, bluetooth is enabled by default and in pairing mode. You can use Bluetooth to connect to "BL-YHX06" to play music.
- This product has 15 built-in white noise tracks, which can be played or switched via the remote control. The built-in white noise tracks are as follows: ① Lullaby 01, ② Lullaby 02, ③ Lullaby 03, ④ White Noise, ⑤ Babbling Brook, ⑥ Drizzling Rain, ⑦ Rolling Waves, ⑧ Summer Night Insects, ⑨ Bird Chirping and Cicada Singing, ⑩ Frog Croaking and Flowing Water, ⑪ Thunderstorm, ⑫ Wind Blowing Through Leaves, ⑬ Wind Chimes and Waves, ⑭ Joyful Burning, ⑮ Jungle Waterfall.
- This product supports wireless remote control to operate the main unit. When using the remote control, please ensure that it remains within range of the main unit.
- The product supports clock, date, day of the week, and temperature display. It is equipped with a built-in temperature sensor that displays the current temperature in real time. You can use the remote control to switch between 12-hour and 24-hour time formats and switch the temperature display between Celsius and Fahrenheit.

- The product has a built-in button battery, allowing it to retain time settings even when powered off. After reconnecting the power, there is no need to reconnect to the network to recalibrate the time.
- **Alarm Clock Setting:** This product allows setting up to 2 alarms, which repeat daily. The alarms can be set using the remote control. Long press the “🕒” button on the remote to choose the alarm you want to set. The alarm interface will flash, and you can select Alarm 1 or Alarm 2 using the |◀/▶| buttons. Use the -/+|▶|| buttons to select and edit the current alarm. When editing the alarm, the |◀/▶| buttons can switch between setting the hour and minute, and the -/+ buttons adjust the values. After completing the setup, press the ▶|| button. The alarm and time will flash three times, indicating the alarm is successfully saved and activated. If there is no operation within 10 seconds, it will automatically exit without saving the alarm settings.
- **Snooze Mode:** When the alarm sounds, Short-press any button on the unit or any button on the remote control to interrupt the alarm and enter snooze mode. The default interval for snooze mode is 9 minutes, and the alarm will sound three times. After three times, it will automatically exit snooze mode. Long-press any button on the unit or the remote control to stop the alarm and end the snooze mode.

Operation Instructions:

When using, insert the film disc with the "UP↑" side facing up into the film disc tray, and twist it into card slot to securely lock film disc in place. Powering on the product automatically activates the projection status when plugged in, and enables meteor and rainbow light effects, the default rotation speed is slow, bluetooth is enabled and in pairing mode, and the product is set to automatically shut down after 4 hours.

When the device is powered off, the varicolored light can be enabled independently by remote control or button on the main unit, independent varicolored light will automatically turn off after 12 hours by default.

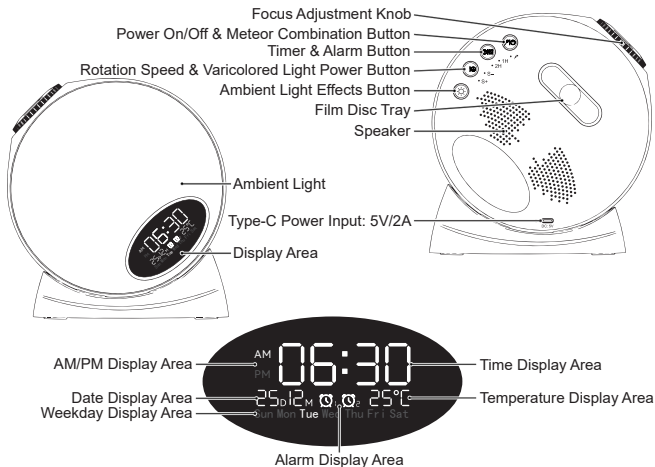

Main Unit Button Function Instructions:

- **Power On/Off & Meteor Combination Button:** Short press to switch projection light status. The cycle sequence is: Only enable the star projection → Only enable the meteor light effect. → Turn off both the star projection and meteor effect → Turn on both the star projection and meteor effect. When the meteor effect is on, the meteor indicator light will be illuminated. When the meteor effect is off, the meteor indicator light will be off. Long press to power on or off.
- **Timer & Alarm Button:** Short press to switch timer settings in sequence. The cycle sequence is: one-hour timer shutdown, two-hour timer shutdown, and cancel timer shutdown (automatically enters the default 4-hour auto-shutdown state). The indicator above the timer button shows the current timer setting: "1H" indicates one-hour timer shutdown, and "2H" indicates two-hour auto-shutdown. Long press to turn on or off all alarms.

- **Rotation Speed & Varicolored Light Power Button:** Short press to switch speed settings in sequence. The default setting is slow rotation, with the sequence as follows: slow rotation - fast rotation - stop rotation. The current speed setting can be checked via the indicator lights. When set to slow speed, the "S-" indicator light is on; when set to fast speed, the "S+" indicator light is on. When set to "stop," both "S-" and "S+" indicator lights are off. Long press to turn the varicolored light on or off. When the device is powered off, a long press will independently turn on the varicolored light, which will automatically turn off after 12 hours by default.
- **Varicolored Button:** When powered on, the rainbow lighting effect is enabled by default. Short press to switch varicolored light effects in sequence. The cycle sequence is: rainbow - gradient - marquee - neon - vibrant - multicolor - flowing - dynamic - breathing - stacking - fireworks - sunrise - turn off varicolored light. Long press to adjust the brightness of the varicolored light: the first long press gradually increases brightness, and after releasing the button, another long press will gradually decrease the brightness. When the device is powered off, a short press will independently turn on the varicolored light, which will automatically turn off after 12 hours by default.

Remote Control Function Description

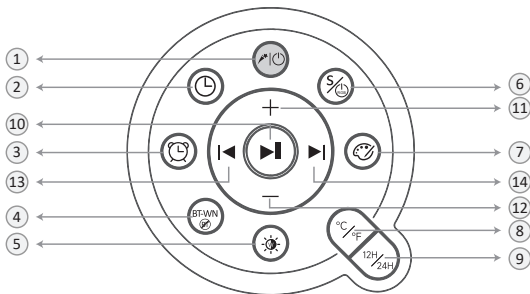

- ① Power Button: Short press to switch projection light states. The cycle sequence is: Only enable the star projection → Only enable the meteor light effect. → Turn off both the star projection and meteor effect → Turn on both the star projection and meteor effect. When the meteor effect is on, the meteor indicator light will be illuminated. When the meteor effect is off, the meteor indicator light will be off. Long press to power on or off.
- ② Timer Button: Sets the product's timer shutdown. Short press to switch timer settings in sequence. The cycle sequence is: one-hour timer shutdown, two-hour timer shutdown, and cancel timer shutdown (automatically enters the default 4-hour auto-shutdown state). The indicator above the timer button shows the current timer setting: "1H" indicates one-hour timer shutdown, and "2H" indicates two-hour auto-shutdown.
- ③ Alarm Button: Short press to switch the alarm settings in sequence. The cycle sequence is: Enable Alarm 1 only - Enable Alarm 2 only - Enable both Alarm 1 and Alarm 2 – Turn off both Alarm 1 and Alarm 2. Long press to enter alarm editing mode.
- ④ BT-WN Button: Short press to switch between white noise playback mode and Bluetooth playback mode. Long press to disconnect the currently connected Bluetooth device, waiting for the varicolored light to flash white three times, indicating that the current Bluetooth device has been disconnected.
- ⑤ Night Light Button: Short press to turn the white night light on or off. Long press to enter stepless dimming mode: on the first long press, the brightness gradually decreases; after releasing the button, long pressing again will gradually increase the brightness. (When the device is powered off, a short press can independently turn on the white night light, which will automatically turn off after 12 hours by default.)
- ⑥ Rotation Speed Button: Short press to switch rotation speed settings in sequence, defaulting to slow rotation. The cycle sequence is 3 level speed: slow rotation, fast rotation, and stop rotation. The indicator lights show the current speed setting: "S-" for slow, "S+" for fast, and both off for "stop." Long press to turn the varicolored light on or off. When the device is powered off, a long press will independently turn on the varicolored light, which will automatically turn off after 12 hours by default.
- ⑦ Varicolored Light Effects Button: Short press to switch varicolored light effects in sequence. The cycle sequence is: rainbow - gradient - marquee - neon - vibrant - multicolor - flowing - dynamic - breathing - stacking - fireworks - sunrise - turn off varicolored light. (In the off state, short press activates the varicolored light independently, which will automatically turn off after 12 hours by default.)
- ⑧ Short press to switch between displaying the temperature in Celsius or Fahrenheit.
- ⑨ Short press to switch between 12-hour and 24-hour time formats. Long press to turn the clock display on or off.
- ⑩ Play/Pause
- ⑪ Volume Up
- ⑫ Volume Down
- ⑬ Previous Song
- ⑭ Next Song

Film Discs Replacement Instructions:

(1) Standard Configuration: This product comes with 12 pieces of $\phi 18\text{mm}$ large pattern film discs.

(2) Place in film disc: When installing the film disc, ensure that the side marked with "UP↑" is facing upwards. Align it with the groove and place it into the film disc slot. Firmly press down on the film gear with your hand, then rotate the film disc clockwise until it is fully locked into the film disc slot.

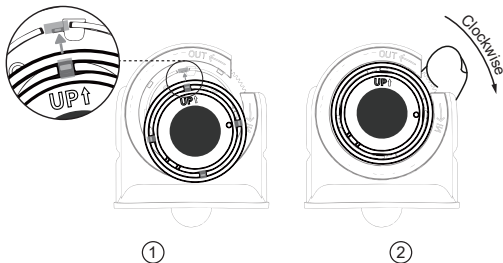

(3) Take out film disc: When replacing the film, firmly press down on the film gear with your hand while rotating the film disc counterclockwise to remove it or insert a new film disc.

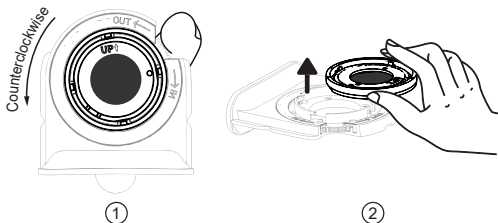

(4) Note: It is recommended to replace the film disc in the powered-off state.

How to Adjust the Projection Angle:

- This product supports projection focus adjustment from 0.5 meters to 3 meters (1.64-9.84 ft).
- When adjusting the projection focus, rotate the focus adjustment knob in the positive or negative direction based on the current projection clarity to achieve a sharper image on the projection surface.

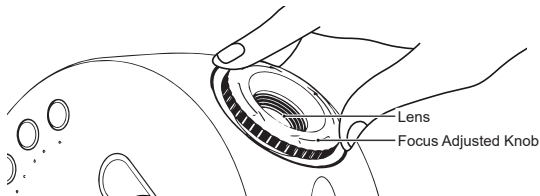

How to Adjust the Projection Angle:

- The main unit and the base of this product are designed to be detachable. You can adjust the projection angle by changing the placement angle of the main unit.

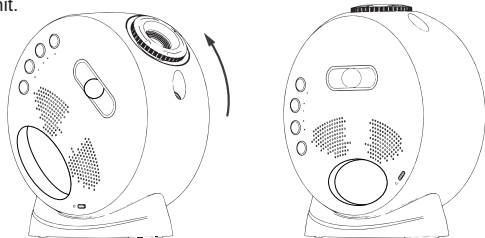

Common Troubleshooting:

- No Power On: Check if the power adapter meets the product's specified input voltage standard (DC 5V/2A). Excessive input voltage can damage the product, while insufficient voltage may result in failure to power on.

- **Unclear Projection:** Verify if the focus is adjusted to the optimal state. Ensure the projection distance and projection surface are appropriate.
- **Rotation Halt:** Check if the rotation speed is set to either S+ or S-. Confirm if the corresponding speed indicator blue light is continuously on, indicating a successful speed setting.

Specifications

Product Model	BL-YHX06
Material	PC+ABS
Power Input	DC 5V 2A
Maximum Power	10W
Projection Way	Film Disc Projection
Projection Source	LED Bulbs
Projection Distance	0.5m-3m/1.64-9.84ft
Projection Area	The projection area is 12.5m ² ~23.75m ² /134.55 sq.ft~255.64sq.ft at a 2m~3m/6.56ft~9.84ft projecting distance, and so on
Recommended Projection Environment	For optimal projection results, it is recommended to use the product in a dark environment, especially achieving the best clarity and reality when projecting onto a white background wall at a distance of 2 meters (6.56 feet).
Night Light Output Power	5W
Ambient Lighting	12 Varicolored Light Effects / White Night Light
Operating Temperature	-10°C~40°C/14°F~104°F
Storage Temperature	-20°C~60°C/-4°F~140°F
Operating Environment	Use in a dark indoor environment

§ 15.19 Labelling requirements.

This device complies with part 15 of the FCC Rules. Operation is subject to the following two conditions: (1) This device may not cause harmful interference, and (2) this device must accept any interference received, including interference that may cause undesired operation.

§ 15.21 Information to user.

Any Changes or modifications not expressly approved by the party responsible for compliance could void the user's authority to operate the equipment.

§ 15.105 Information to the user.

Note: This equipment has been tested and found to comply with the limits for a Class B digital device, pursuant to part 15 of the FCC Rules. These limits are designed to provide reasonable protection against harmful interference in a residential installation. This equipment generates uses and can radiate radio frequency energy and, if not installed and used in accordance with the instructions, may cause harmful interference to radio communications. However, there is no guarantee that interference will not occur in a particular installation. If this equipment does cause harmful interference to radio or television reception, which can be determined by turning the equipment off and on, the user is encouraged to try to correct the interference by one or more of the following measures:

- Reorient or relocate the receiving antenna.
- Increase the separation between the equipment and receiver.
- Connect the equipment into an outlet on a circuit different from that to which the receiver is connected.
- Consult the dealer or an experienced radio/TV technician for help.

This equipment complies with FCC radiation exposure limits set forth for an uncontrolled environment. This equipment should be installed and operated with minimum distance 20cm between the radiator & your body.



Explore the Mysterious, Light up Your Dreams