

Bird Feeder Camera Installation

Catalog

1. What's in the Box.....	1
2. Camera Structure.....	2
3. Install bird feeders.....	4
3.1. Insert Micro SD Card.....	4
3.2. Assemble Bird Feeder Cam	5
3.3. Install the roof.....	6
※ Battery Charging	7
※ How to Turn On & Off the Camera	7
3.4. Configure the camera	8
3.4.1. Set Up With VicoHome App.....	8
3.4.2. Power on/off and network configuration	9
3.4.3. Set up the camera	10
3.5. Secure the product to the surface	12
3.5.1. Wall Installation	13
3.5.2. Tree Installation.....	16
3.5.3. Mailbox Pole Installation.....	18
3.6. Installation Of Solar Panels.....	20
4. How to Add Bird Seed	23
5. Status Light	24
6. AI Bird Recognition	24
7. FCC Warning	24

1. What's in the Box



1 Bird Feeder cam



2 Roof

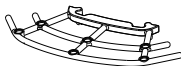

3 Perch

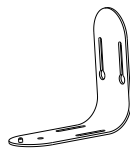

4 Mounting Bracket



5 Black Strap*2

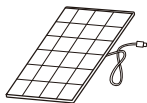

6 Solar Panel*



7 Solar Panel bracket*



8 Quick Guide



9 M3 Holder Screw*

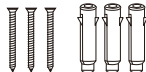

10 M5 Mounting Screw

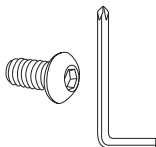

11 1/4-20 Screw and Driver



A

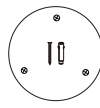

B*



13 Type C Power Cable

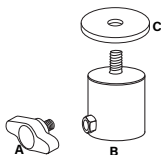

14 Sleeve



15 Ejector Pin

The parts marked with * may not be included. This manual provides a universal version applicable whether these parts are present or not.

2. Camera Structure

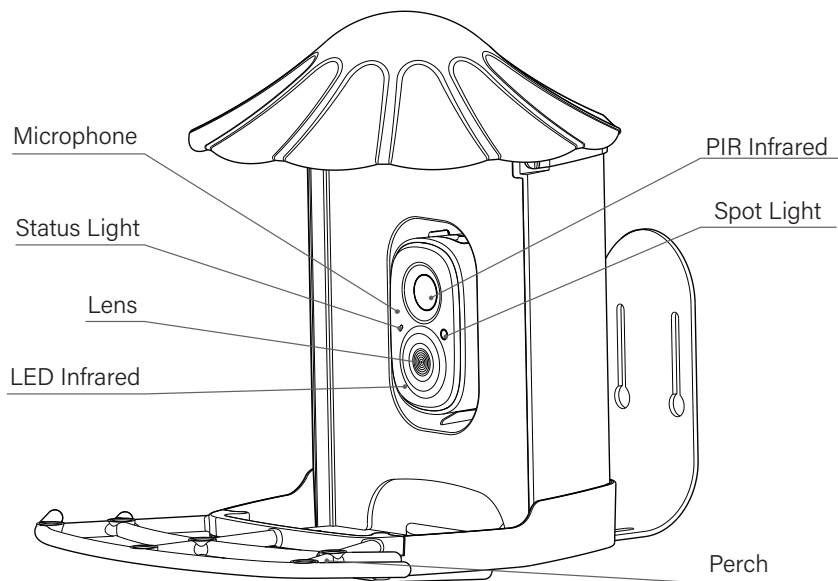

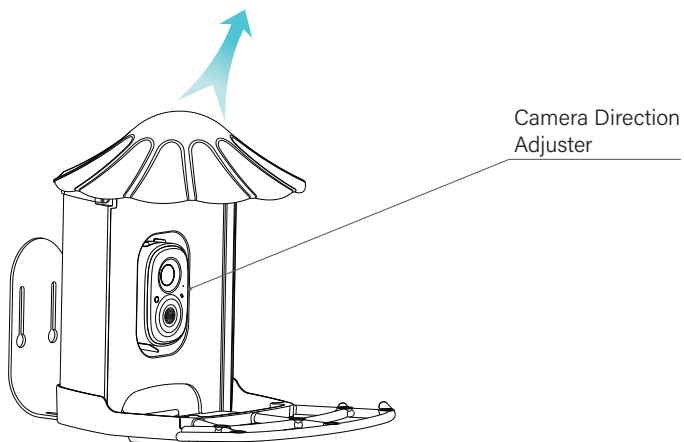
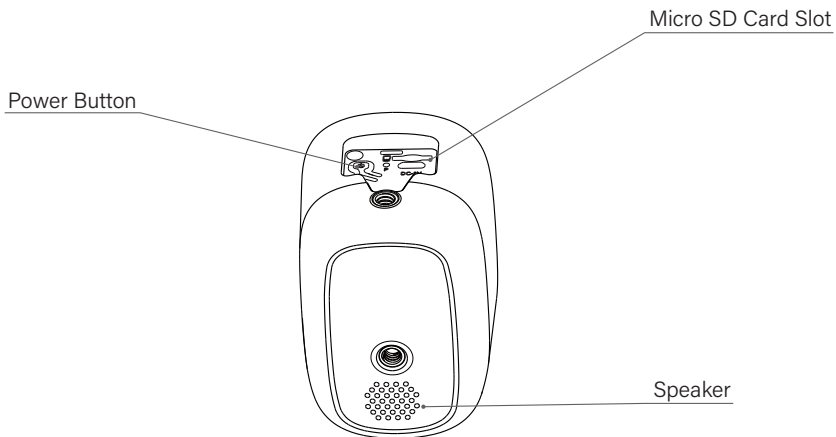

3. Install bird feeders

Before installing the device, ensure that the installation location is within network coverage and that all accompanying parts are present.

- Keep Bird Feeder Cam and all accessories out of reach of children and pets.
- Make sure the camera has been fully charged (DC5V/1.5A).
- Working temperature: -10°C to 50°C (14°F to 122°F) Working relative humidity: 0-95%.
- Please do not expose the camera lens to direct sunlight.
- The camera has an IP65 waterproof rating, which supports working properly under rains or snows. But it can not be soaked in water.

3.1. Insert Micro SD Card

Bird Cam comes with a built-in card slot which supports up to 128GB Micro SD card.

Step 1: Rotate the camera down to the bottom.

Step 2: Open the top silicone plug. Insert the Micro SD card. Make sure to plug it in the right direction.

Step 3: Finally, Cover silicone plug.



3.2. Assemble Bird Feeder Cam

At the bottom of the feeder for ❶ Bird Feeder cam, where food is stored, there are two holes at the front. Ensure that the two protruding parts on the ❸ perches are aligned at the positions indicated by the red markings. Press down on the ❸ perches and the installation is complete.

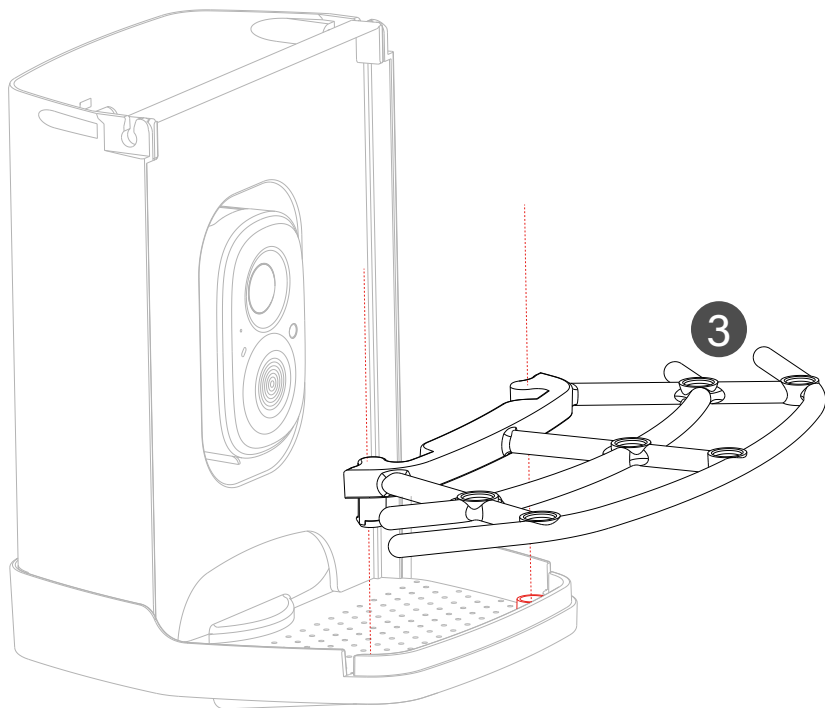

3.3. Install the roof.

Install ② roofs on ① bird feeder cam. Insert the bayonet of one end of ② roofs into one side of ① bird feeder cam. Press the other side to make the bayonet of ② roofs clamp on the top of ① bird feeder cam. Rotate ② roofs to make its buckle clamp on the back of ① bird feeder cam.

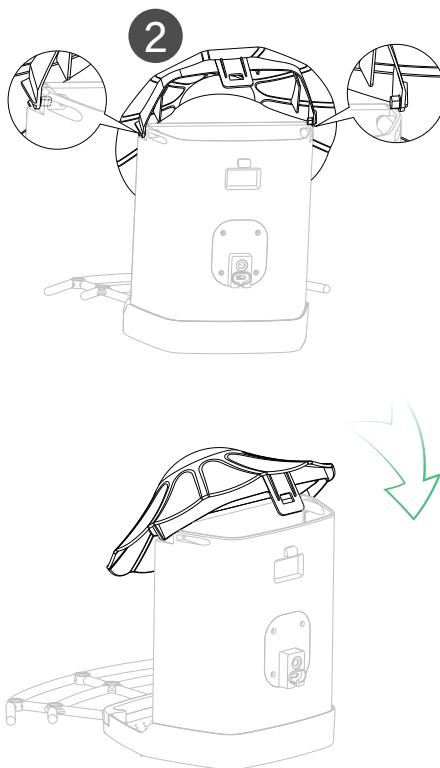

※ Battery Charging

The batteries inside the camera are not fully charged according to the transportation safety regulations. Please fully charge the camera before using it. Please charge the batteries with provided Type C Port Cable (DC5V/1.5A adapter not included).

※ How to Turn On & Off the Camera

To turn on the camera:

Press and hold the power button for 3-5 seconds until the device sends a voice, and broadcast "The device has been turned on, please use the APP to bind the device".

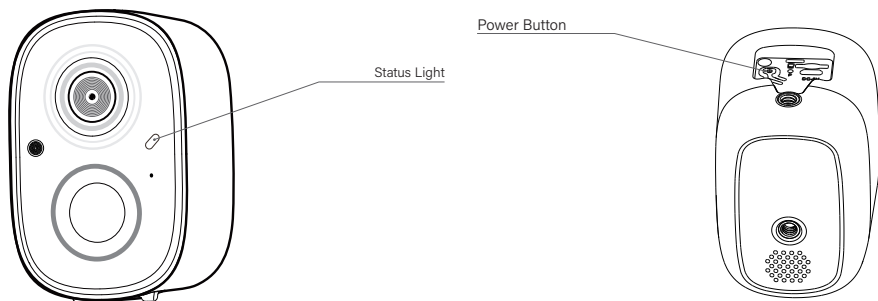

To turn off the camera:

Long press the power button for 3s to turn off the camera. Then the Status Light in the front of the camera will be off.

3.4. Configure the camera

To facilitate installation, we will first complete the camera configuration.

Note:

1. Bird Feeder Cam only works with 2.4GHz Wi-Fi.
2. Strong lights may interfere with the device's ability to scan QR code.
3. Avoid placing the device behind furniture or near microwaves products. Try to keep it within range of your Wi-Fi signal.

3.4.1. Set Up With App



App Download

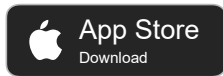
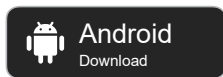

Download App from App Store or Google Play. Follow the in-app instruction to complete the entire set up process.



3.4.2. Power on/off and network configuration

- Long press the power button for 3 seconds to power on/off the device.
- Short press 2 times in a row to reset the machine.

When connecting the camera for the first time, use the App and follow the instruction to configure the camera network.

3.5. Secure the product to the surface

Check the following things before you drill holes on your wall:

Bird Feeder Cam has been successfully added to your App and is able to stream video.

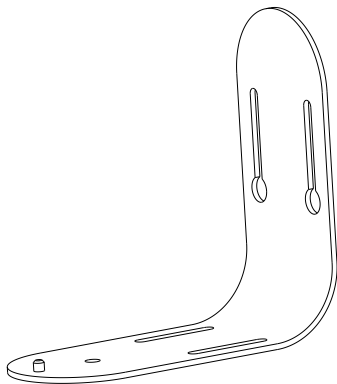

As shown in the figure, the indicated direction is the correct upright position for the bracket, matching the product. Below, three installation methods will be listed.

3.5.1. Wall Installation

STEP 1

Use a level and the Positioning stickers (A) 12 positioning stickers to ensure the installation position is level. Attach the Positioning stickers (A) 12 at the appropriate height.

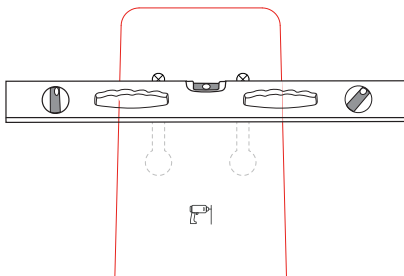

STEP 2

Using a drill, create three holes at the cross marks on the Positioning stickers (A) 12, each with a diameter of 10mm and a depth of 60mm.

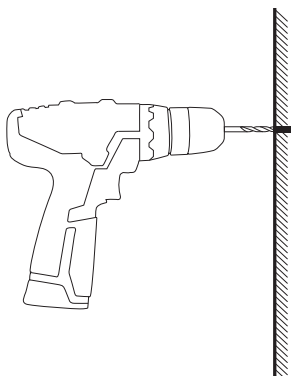

STEP 2

Insert the plastic wall anchors from the M5 mounting screws ⑩ into the drilled holes. Align the three holes on the mounting bracket ④ with the drilled holes and use a screwdriver to secure the mounting bracket ④ to the wall.

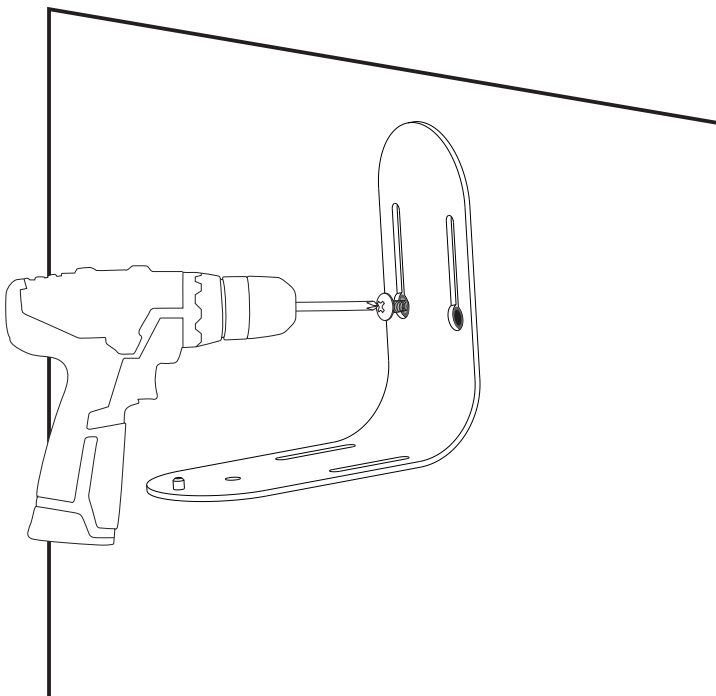

STEP 3

Align the protrusion at the base of the L-shaped bracket with the appropriate hole in the circular hole on the bottom of the Bird Feeder cam **1** as indicated by the cyan mark. Ensure the screw holes are aligned with the center point of the base as indicated by the green mark. Using the **11** L-shaped screwdriver, secure the 1/4-20 screw **11** into the screw hole to connect the mounting bracket **4** and the Bird Feeder cam **1**.

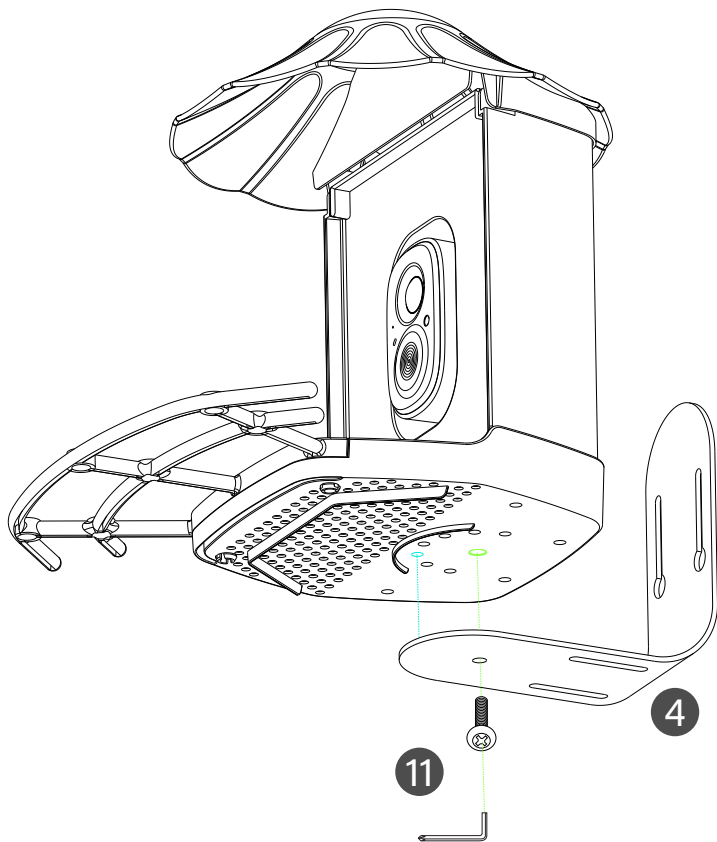

3.5.2. Tree Installation

STEP 1

Wrap the Mounting Bracket around the tree with the Black Strap 16 .

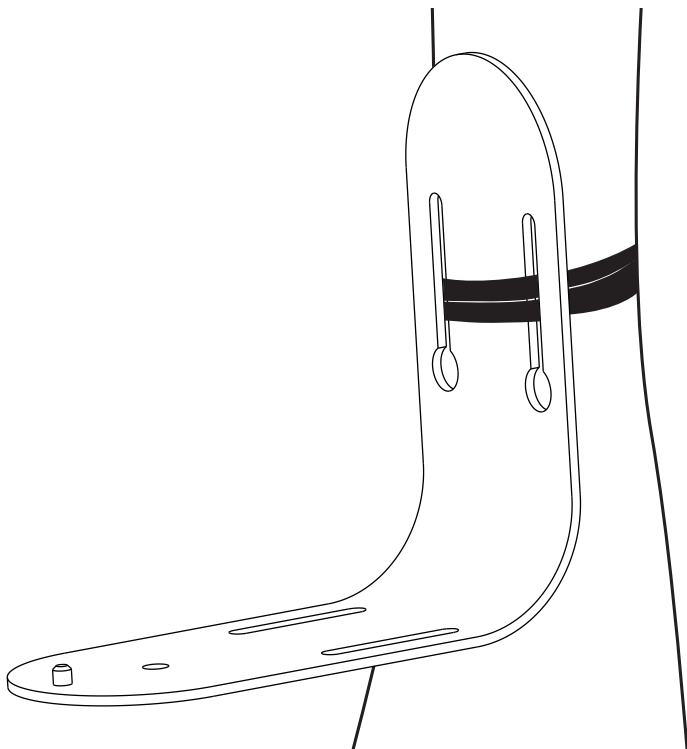

STEP 2

Align the protrusion at the base of the L-shaped bracket with the appropriate hole in the circular hole on the bottom of the Bird Feeder cam **1** as indicated **by the cyan mark**. Ensure the screw holes are aligned with the center point of the base **as indicated by the green mark**. Using the **11** L-shaped screwdriver, secure the 1/4-20 screw **7** into the screw hole to connect the mounting bracket **4** and the Bird Feeder cam **1**.

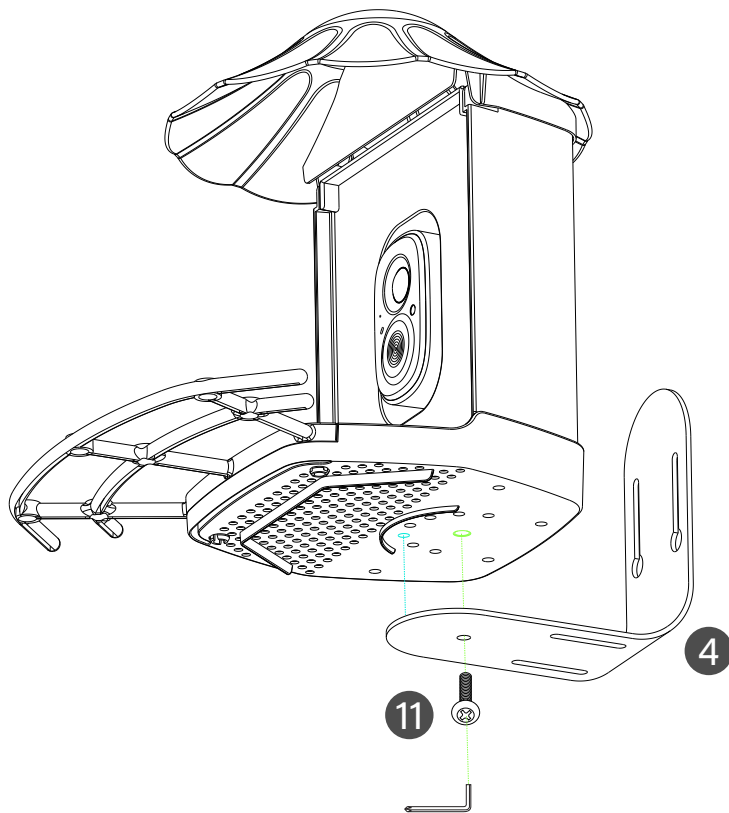

3.5.3. Mailbox Pole Installation

STEP 1

As shown in the figure, install the roof screw 14-A onto the sleeve 14-B as indicated by the red mark, ensuring the bolts do not extend beyond the inner wall of the sleeve 14-B. Align the hole of the rubber gasket 14-C with the bolt on the sleeve 14-B and place it on top as indicated by the blue mark.

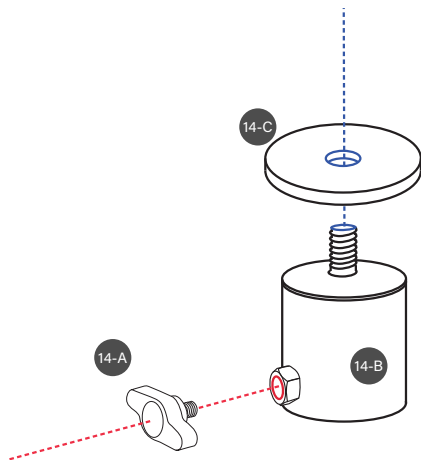

STEP 2

Align the screw hole of the assembled sleeve with the central screw hole at the bottom of the Bird Feeder cam 1 and tighten as indicated by the pink mark.

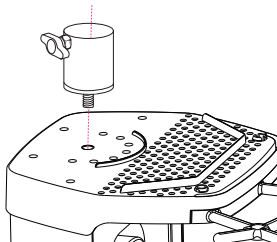

STEP 3

Slide the assembled bird feeder cam ① 's sleeve onto the pole. Rotate the ⑭ sleeve screw to secure the sleeve firmly onto the poleas indicated by the red mark.

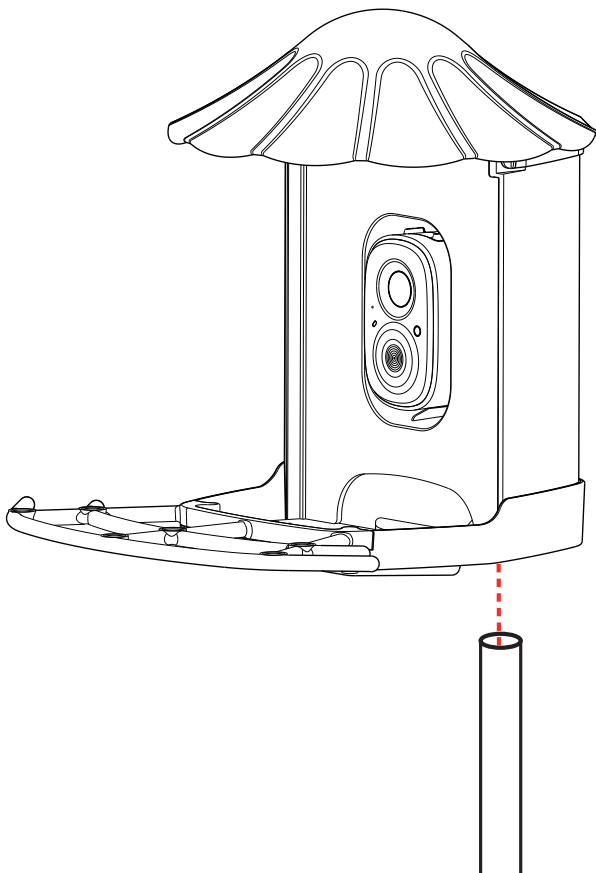

3.6. Installation Of Solar Panels

Choose an appropriate position to install the solar panel, ensuring it is within the length of the provided cable. Make sure the solar panel can connect properly to the bird feeder.

STEP 1

After determining the installation position for the solar panel, attach the positioning stickers (B) 12 to the appropriate position.

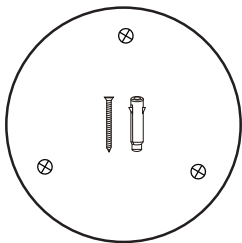

STEP 2

Using a drill, create three holes at the cross marks on the positioning stickers (B) 12, each with a diameter of 5mm and a depth of 30mm.

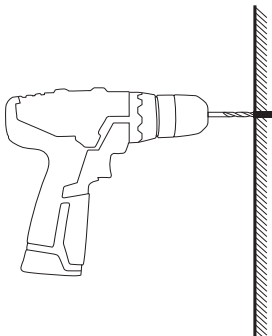

STEP 3

Install Solar Panel bracket ⑦ at the drilled location using the M3 holder screws ⑨ .

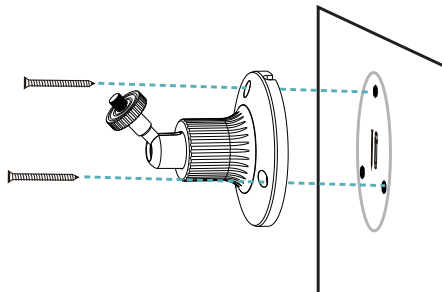

STEP 4

Install the solar panel ⑥ onto the solar holder ⑦ .

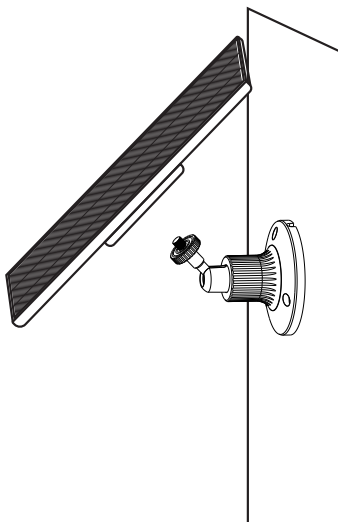

STEP 5

Install the cable of the 3W solar panel ⑥ in the same location.



4. How to Add Bird Seed

STEP 1

Open the buckle at the back. Rotate the roof ② to open the cover of the bird feeder, allowing you to add the specified bird food.

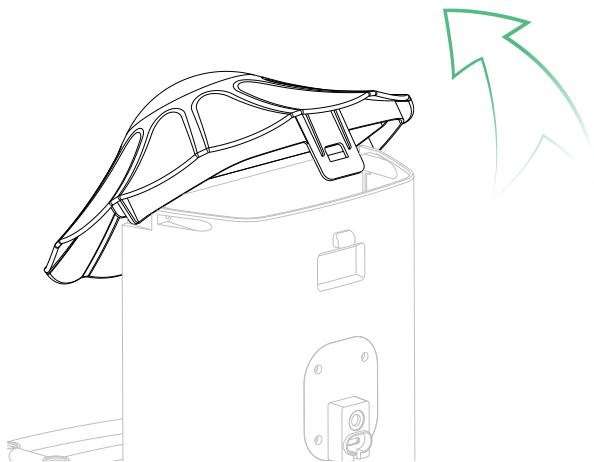

STEP 2

After adding the bird food, close the cover.

5. Status Light

This camera uses status light to communicate.

LED Indicator	Description
Solid Blue	Working
None	Sleep/Power Off
Solid Red	Charging

6. AI Bird Recognition

AI Bird Recognition has undergone massive machine learning and uses AI intelligent recognition algorithms to inform you in real time "what species of bird are coming", automatically save the bird images/videos data for you, and also provide bird knowledge learning and so on.

7. FCC Statement

This equipment has been tested and found to comply with the limits for a Class B digital device, pursuant to part 15 of the FCC rules. These limits are designed to provide reasonable protection against harmful interference in a residential installation.

This equipment generates, uses and can radiate radio frequency energy and, if not installed and used in accordance with the instructions, may cause harmful interference to radio communications. However, there is no guarantee that interference will not occur in a particular installation. If this equipment does cause harmful interference to radio or television reception, which can be determined by turning the equipment off and on, the user is encouraged to try to correct the interference by one or more of the following measures:

- Reorient or relocate the receiving antenna.
- Increase the separation between the equipment and receiver.
- Connect the equipment into an outlet on a circuit different from that to which the receiver is connected.
- Consult the dealer or an experienced radio/TV technician for help.

To assure continued compliance, any changes or modifications not expressly approved by the party.

Responsible for compliance could void the user's authority to operate this equipment. (Example- use only shielded interface cables when connecting to computer or peripheral devices).

This equipment complies with Part 15 of the FCC Rules. Operation is subject to the following two conditions:

- (1) This device may not cause harmful interference, and
- (2) This device must accept any interference received, including interference that may cause undesired operation.

FCC Radiation Exposure Statement:

The equipment complies with FCC Radiation exposure limits set forth for uncontrolled environment. This equipment should be installed and operated with minimum distance 20cm between the radiator and your body.