

Wireless Earphone User Guide

Dear Customer:

Thanks for choosing our wireless earphone! This wireless earphone produced by our company is a very precise electronic device for hearing impaired. Our company has been committed to the developing and producing of high-quality wireless earphone products.

This user guide is suitable for ALD-N10, ALD-N30 and ALD-N50.

Please read the manual carefully before using this product, and be sure to use and maintain it in accordance with the instructions in order to extend the life of your wireless earphone.

Contents

1. Overview.....	3
1.1. Product Name.....	3
1.2. Product features.....	3
1.3. Software brand.....	3
1.4. Model Number.....	3
1.5. Operation Condition.....	3
1.6. Impact on the Environment.....	3
1.7. Warning.....	3
2. Structural Characteristics.....	4
3. Steps for Wearing and Using Wireless Earphones.....	4
3.1. Power ON/OFF.....	4
3.2. Replace earplug.....	5
3.3. Replace Ear hook.....	6
3.4. Bluetooth pairing.....	6
3.5. Headphone controls.....	7
3.6. Wireless Earphone application.....	8
3.7. Headphones status indicators.....	8
3.8. Charge the battery.....	8
3.9. Precautions for wired charging.....	9
3.10. Automatic detection.....	9
4. Mobile APP Use.....	9
4.1. Download and open the app.....	9
4.2. Registered Account.....	9
4.3. Pairing Operation.....	10
4.4. Volume Control.....	10
4.5. Program Mode Adjustment.....	10
5. Simple Failure Analysis and Troubleshooting.....	10
6. Maintenance of Wireless Earphone.....	11
6.1. Cleaning of earwax.....	11
6.2. Wireless Earphone Vibration.....	11
7. Method for cleaning and disinfecting earplugs.....	11
8. Accessories List.....	11
9. Unpacking and Check.....	12
10. Warranty of Wireless Earphone.....	12
10.1. Range for free warranty.....	12
10.2. The warranty period.....	12
10.3. Any of the following conditions are not covered by the free warranty.....	12
11. Production date and Use period.....	12
12. Transport and storage restrictions.....	12

1. Overview

1.1.Product Name

Wireless Earphone

1.2.Product features

- This wireless earphone is equipped with the function of sound amplification, intelligent noise reduction and volume memory.
- This wireless earphone is comfortable to wear and easy to operate.

1.3.Software brand

Embedded sound processing software based on ultra-low power DSP.

1.4.Model Number

ALD-N10, ALD-N30, ALD-N50

1.5.Operation Condition

Temperature: 0℃～+40℃

Humidity: 0 %～80 %

Voltage: DC3.7V

1.6.Impact on the Environment

This wireless earphone contains a rechargeable lithium battery. Please do not abandon the wireless earphone randomly. Please dispose of the used batteries according to local regulations to protect the environment.

1.7.Warning

- Keep wireless earphone away from fire to avoid explosion.
- To prevent possible hearing damage, do not listen at high volume levels for long time.
- If you have undergone ear canal surgery, please kindly seek professional advice from doctor or audiologist.

2. Structural Characteristics



- | | |
|---------------------------------|----------------------------------|
| 1.Headphone Back Shell | 2.Headphone Front Shell |
| 3.Metal Sound Tube | 4.Ear Hook |
| 5.Ear Plug | 6.Headphone controls front shell |
| 7.Headphone Controls Back Shell | 8.Right neckband front shell |
| 9.Right Neckband Back Shell | 10.Neckband Stand |
| 11.Left Neckband Back Shell | 12.Left Neckband Front Shell |
| 13.Microphone Decoration | 14.Microphone Hole |
| 15.Power button | 16.LED indicator |

3. Steps for Wearing and Using Wireless Earphones

3.1.Power ON/OFF

Power ON: shortly press the power button in the off state, the device vibrates, and the headset indicator lights up green.

Power OFF: Press and hold the power button for 2 seconds in the power on state, the device vibrates, and the earphone indicator light turns yellow.

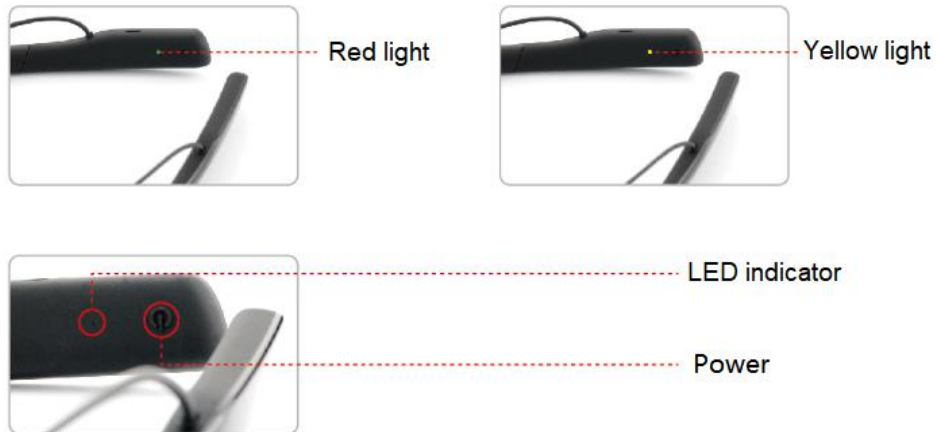

3.2. Replace earplug

Remove earplugs: Pinch the earplugs with your thumb, forefinger, and middle finger to separate the earplugs from the earphone sound tube.

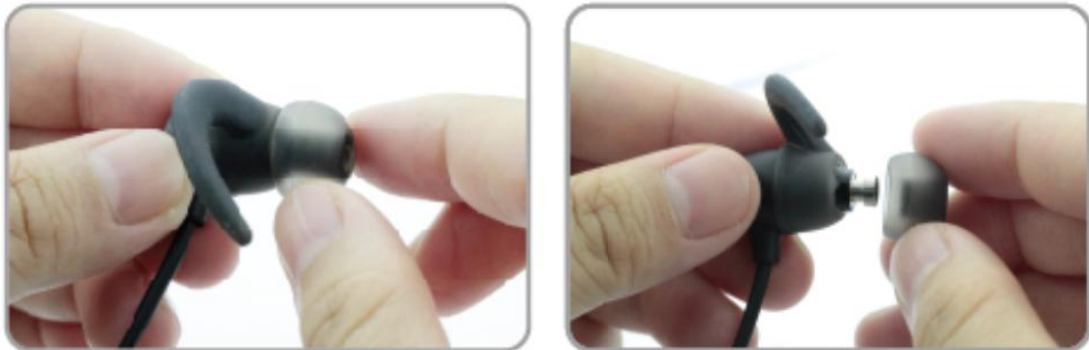

Assemble earplugs: Choose the right size earplugs, pinch the earplugs and insert them into the headphone sound tube.



Tips: It is recommended to choose the earphone with the smallest size first for more comfortable wearing. If howling occurs due to too small earplugs and excessive sound leakage, please replace the larger earplugs until no howling occurs.



Three sizes of ear hook and earplugs

3.3. Replace Ear hook

- Detach the ear hook: after removing the earplug, separate the ear hook from the earphone.



- Install the ear hook: pinch the ear hook and install it on the front cover of the earphone, and then install the earplugs.



Tips: It is recommended to choose the smallest ear hook first for more comfortable wearing. If the ear hook is too small and the wearing is unstable, please replace the larger earplugs until it can be worn stably.



3.4. Bluetooth pairing

Wireless earphone can be paired with a mobile phone via Bluetooth to answer calls and listen to music.

In the power-on state, press and hold the "+" and "-" buttons at the same time for 4 seconds, the headset indicator light flashes blue quickly, and enters the pairing state.

Open the Bluetooth of mobile phone and search for "**ALD-N10, ALD-N30 or ALD-N50**" for pairing. After successful pairing, the indicator turns into a slow flashing blue light.



After the Bluetooth successfully paired, you can make calls and listen to music, the Bluetooth mode will automatically switch to the wireless earphone mode. When there is a call or playing music, the wireless earphone mode will automatically switch to the Bluetooth mode.

3.5. Headphone controls

3.5.1 The headset controls are on the right side of the headset and there are three buttons on it.

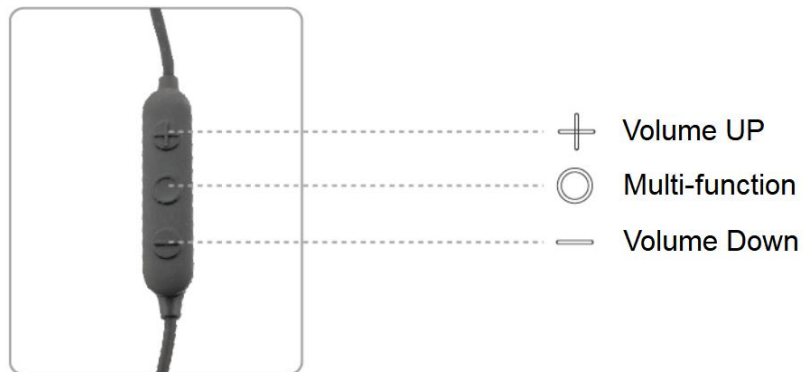

3.5.2 There are three different modes, and the functions of each mode are as follows:

Music Mode	
Volume +:	• Press to increase the volume.
	• Press and hold to skip forward.
Multi-function button:	• Press once to play/pause music.
Volume -:	• Press to decrease the volume.
	• Press and hold to skip backward.

PSAP Mode	
Volume +:	• Press to increase the volume.
Multi-function button:	• Press once to play/pause music.
	• Long press to switch mode. (Quiet/Noisy)
Volume -:	• Press to decrease the volume.

Phone Mode	
Volume +:	• Press to increase the volume.

Multi-function button:	• Press once to answer/cut off a call.
	• Long press to reject call.
Volume -:	• Press to decrease the volume.

3.6. Wireless Earphone application

Press and hold the multi-function button to switch between 2 modes:

1. Quiet mode: listen to clear voice and ambient sound at the same time.



2. Noisy mode: Specially strengthen the voice and reduce the environmental noise, it is recommended to use in an environment where the voice is not clear.



3.7. Headphones status indicators

The headphones indicators are located on the right side of the neck hanging body.

	LED Indicator	Headphones status
Status Display	Green light on	Power On
	Blue light flashes	Match search
	Yellow light on	Power Off
Battery Indicator	Green Light flashes	High power
	Yellow light flashes	Medium power
	Red light flashes	low power

3.8. Charge the battery

3.8.1 Plug the smaller end of the USB cable into the micro-USB connector on the right side of headphones.

3.8.2 Plug the other end of the USB charging cable into a USB charging socket, and the

battery can be fully charged in 2.5 hours.



3.9. Precautions for wired charging

3.9.1 The first charge should ensure a sufficient charging time (not affected by the charging indicator), and it should guarantee a charging time of 2.5 hours.

3.9.2 If the wireless earphone is not used for a long time, the battery will be over-discharged due to self-discharge. Over-discharge will cause the battery performance to decline or even fail; To prevent over-discharge, the wireless earphone must be fully charged every six months.

3.9.3 Battery charge and discharge parameters:

Items	Parameters
Battery Capacity (mAh)	200
Charging time (H)	2.5
Continuous working hours (H)	20 hours for wireless earphone mode, 5 hours for Bluetooth mode.

3.10. Automatic detection

- The headset automatically goes to sleep when it is removed from the ear.
- The headset automatically wakes from sleep when it is put into the ear canal.

4. Mobile APP Use

4.1. Download and open the app

IOS system: Please search for word "mHear" in App Store.

Android system: Please scan the QR code provided by each app store or distributor to download the APP.

4.2. Registered Account

Please log in according to the page prompt.

4.3. Pairing Operation

To enter the app for the first time, you must turn on Bluetooth pairing on your phone.

In the power-on state, press and hold the "+" and "-" buttons at the same time for 4 seconds, the headset indicator light flashes blue quickly, and enters the pairing state.

Open the mobile APP for pairing. After the successful pairing, the indicator turns to a slow flashing blue light.



4.4. Volume Control

Adjust the volume of the left and right headphones on the App home page .

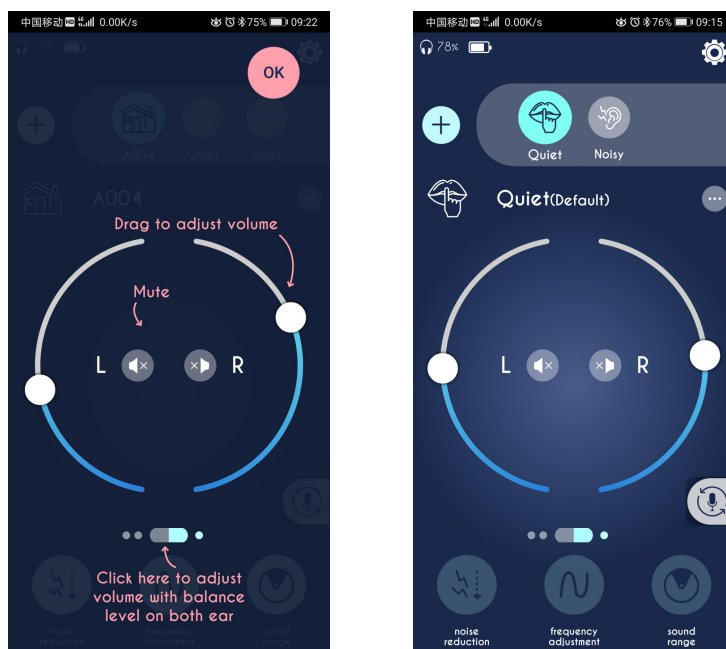

4.5. Program Mode Adjustment

Click "quiet" and "noisy" on the main interface to adapt to the environment mode.

5. Simple Failure Analysis and Troubleshooting

Failure	Cause	Solution
Whistling	The earphone is not worn correctly Too much earwax in the ears	Wear correctly again Clean earwax

No sound	Not powered on Low battery power or no power sound hole of the earphone is blocked by dirt	Power on Charge the battery Clean the earphone sound hole
Small voice	Low volume The sound hole of the earphone is blocked by dirt	Turn up the volume Clean the earphone sound hole
High power consumption	Wireless earphone are not turned off when not using	Please turn off your Wireless earphone when not in use
Intermittent voice	Bluetooth connection is unstable The sound hole of the earphone is blocked by dirt	Please perform Bluetooth pairing again Clean the earphone sound hole

If the failure still can not be solved by above methods, please contact with customer service center. Don't disassemble or repair the device by yourself.

6. Maintenance of Wireless Earphone

6.1.Cleaning of earwax

During the use of wireless earphone, earwax generated by the ears can accumulate in the ear canal and the wireless earphone outlet. A large amount of accumulated earwax will affect the use of the wireless earphone, so please regularly clean your ear canal and maintain the wireless earphone.

6.2.Wireless Earphone Vibration

When you do not need to use a wireless earphone when going out, please save the wireless earphone in a shockproof box or shockproof bag.

7. Method for cleaning and disinfecting earplugs

Wash and disinfect with medical alcohol.

8. Accessories List

Items	Quantity	Unit
Earplug	1	Set
Ear hook	1	Set
User Manual	1	Piece
Certificate of conformity	1	Piece
Warranty Card	1	Piece

Charging Cable	1	Piece
----------------	---	-------

9. Unpacking and Check

- After unpacking, please check whether the actual parts are in accordance with the accessory list.
- Please check the model marked on the warranty card is consistent with the wireless earphone model.
- Please check the serial number marked on the warranty card is consistent with wireless earphone serial number.

10. Warranty of Wireless Earphone

10.1. Range for free warranty

For all devices, the failures caused by non-human factors will enjoy free warranty from the date of purchase.

10.2. The warranty period

From the date of purchase, for non-human damage factor, free repairs are given within the warranty time, please check the warranty period on the warranty card.

10.3. Any of the following conditions are not covered by the free warranty

- The damage caused by incorrect use or improper operation.
- Disassemble, assemble parts and other human caused damage.
- The damage caused by irresistible reason (Floods, fires, earthquakes, etc).
- Change the wireless earphone model, serial number on the warranty card without authorization.
- No warranty card.

11. Production date and Use period

The product needs to be stored and used as required, and its expected function will be affected after the specified usage time. (Such as failure to meet product performance indicators). Wireless earphone products have a lifespan of 5 years. The date of manufacture is shown on the label.

12. Transport and storage restrictions

Temperature: -20°C ~ +50°C

Humidity: 0% ~ 90%

Storage conditions: normal temperature, clean, protected from light, non-corrosive gas and well-ventilated room.

Transportation conditions: The packaged wireless earphone can be transported by

general cargo transportation methods, and should be protected from rain, sun and collision during transportation.

Manufacturer :FuliCare (Xiamen) Co., Ltd.

Address: Building B8,Biomedical Industrial Park,Haicang,Xiamen, China

Postcode:361028

Tel:+86-0592-5610678

Email:fulicare@fulicare-xm.com

FCC Statement:

Any Changes or modifications not expressly approved by the party responsible for compliance could void the user's authority to operate the equipment.

This device complies with part 15 of the FCC Rules. Operation is subject to the following two conditions:

- (1) This device may not cause harmful interference, and
- (2) This device must accept any interference received, including interference that may cause undesired operation.

RF warning for Portable device:

The device has been evaluated to meet general RF exposure requirement. The device can be used in portable exposure condition without restriction.

Note: This equipment has been tested and found to comply with the limits for a Class B digital device, pursuant to part 15 of the FCC Rules. These limits are designed to provide reasonable protection against harmful interference in a residential installation. This equipment generates, uses and can radiate radio frequency energy and, if not installed and used in accordance with the instructions, may cause harmful interference to radio communications. However, there is no guarantee that interference will not occur in a particular installation. If this equipment does cause harmful interference to radio or television reception, which can be determined by turning the equipment off and on, the user is encouraged to try to correct the interference by one or more of the following measures:

- Reorient or relocate the receiving antenna.
- Increase the separation between the equipment and receiver.
- Connect the equipment into an outlet on a circuit different from that to which the receiver is connected.
- Consult the dealer or an experienced radio/TV technician for help.