

X1 Smart Remote

FCC ID:2AXDU-X1-REMOTE

CONTENS

- I Connect X1-Hub to your home Wi-Fi
- II Adding devices in the app
- III Create a New Activity
- IV Configuring the Source in an Activity
- V Using third-party voice smart speakers
- VI Using Your Remote
- VII Specifications and Performance
- VIII FAQs

Important

I Connect X1-Hub to your home Wi-Fi

1. Plug in the Hub' s power cord
2. Download the app:



Search "Sofabaton " on App store or Google Play

3. Use the app to connect to your X-Hub with the following steps:

Step1: Open the app and select X1 from the device list.



Step2: Make sure your phone's Bluetooth is on and the phone is connected to your home Wi-Fi.

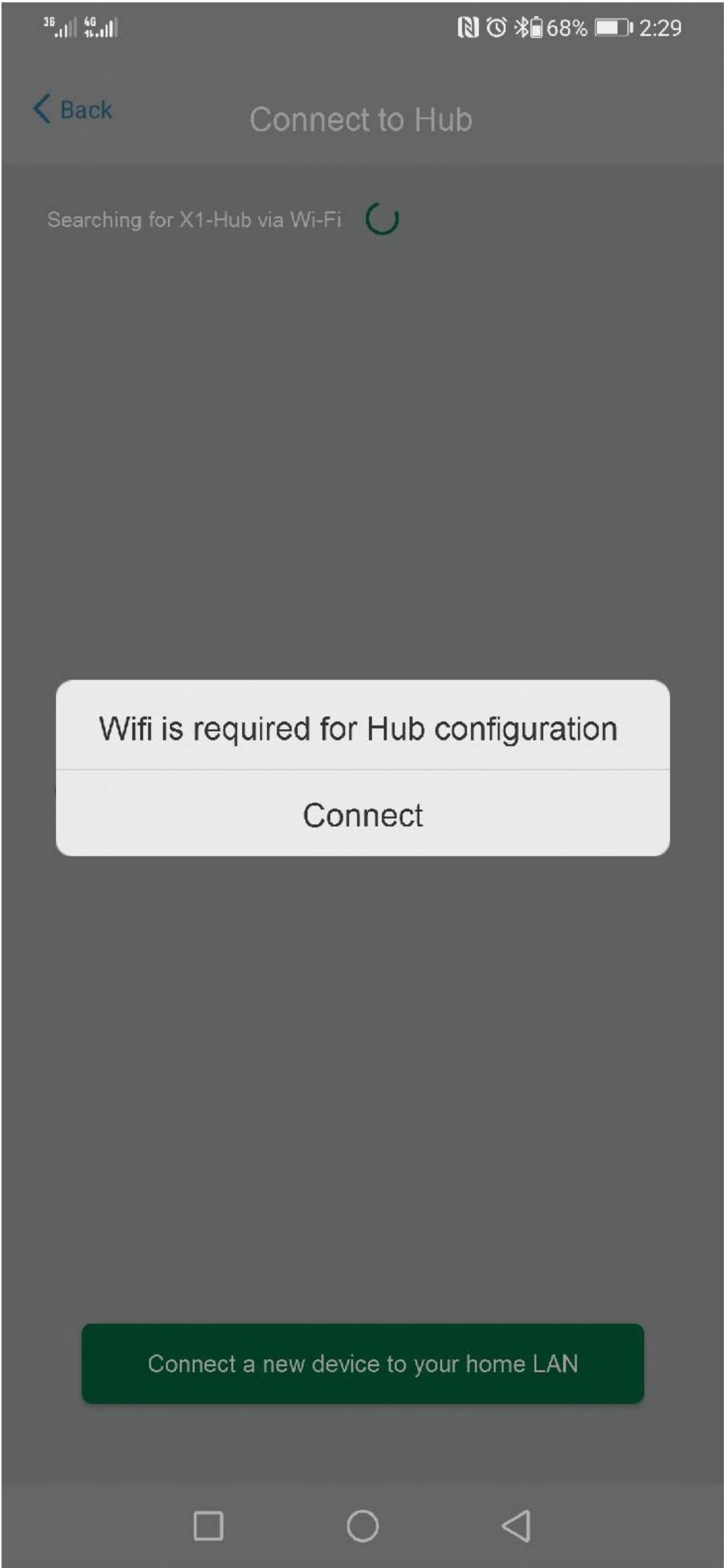

Step3: Press and hold the button on the X-Hub for 3s to allow the Bluetooth connection.

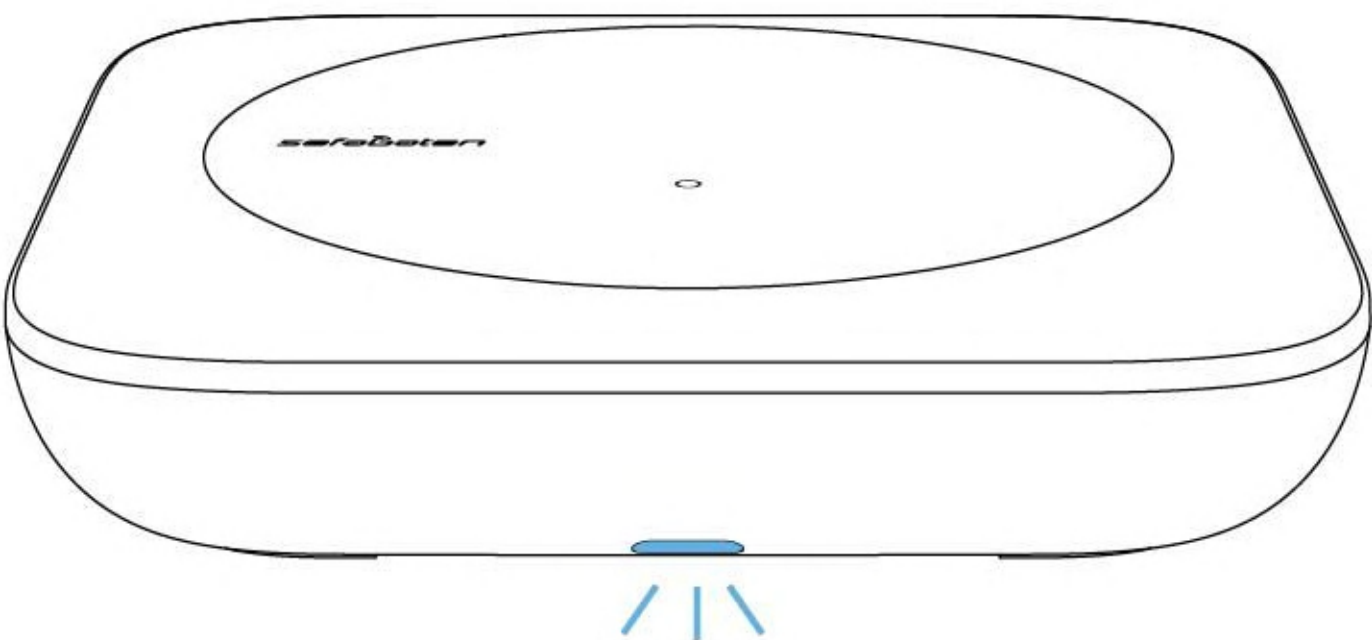
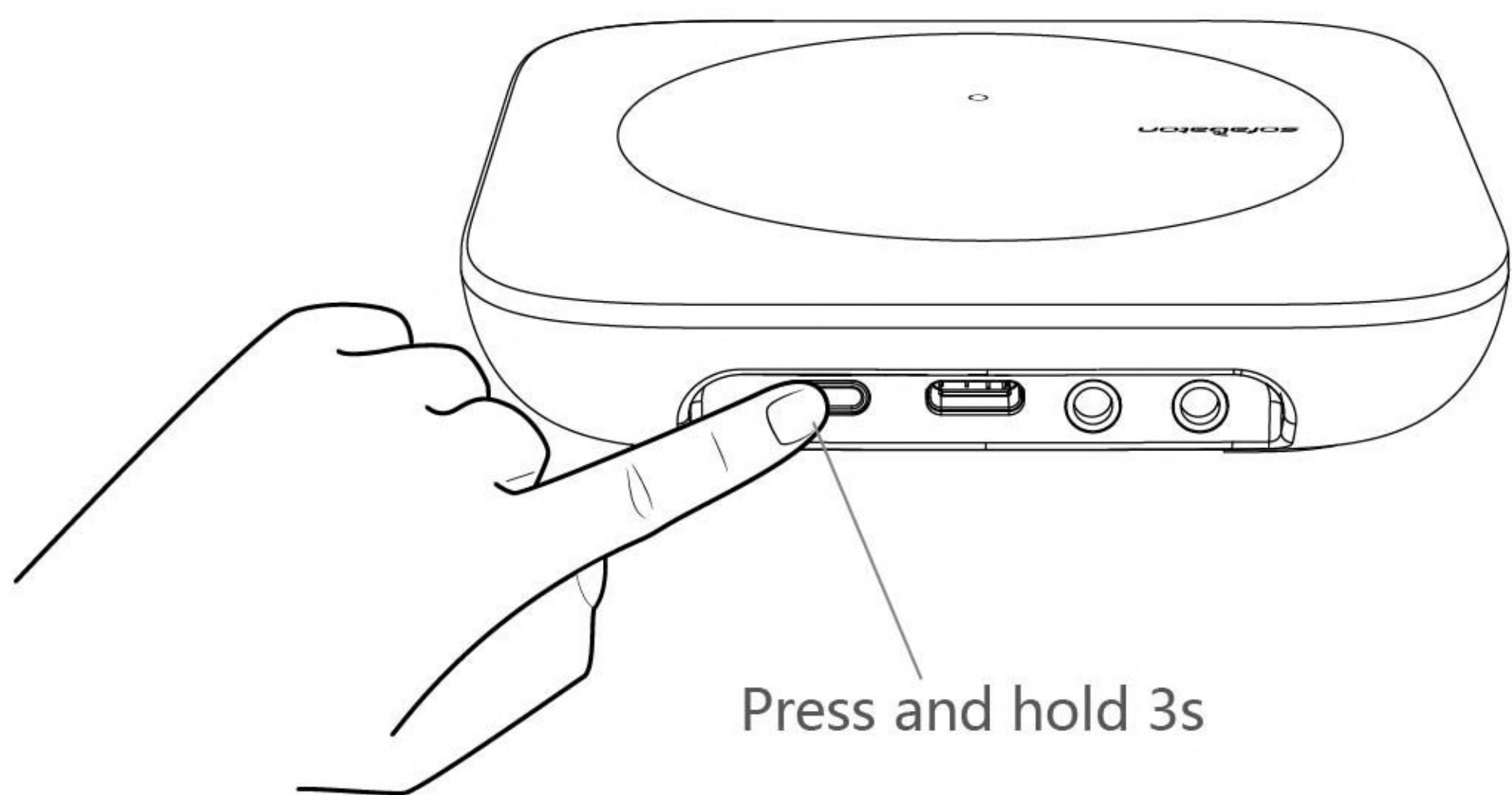

Step4: Select the device you want to connect to your home Wi-Fi.

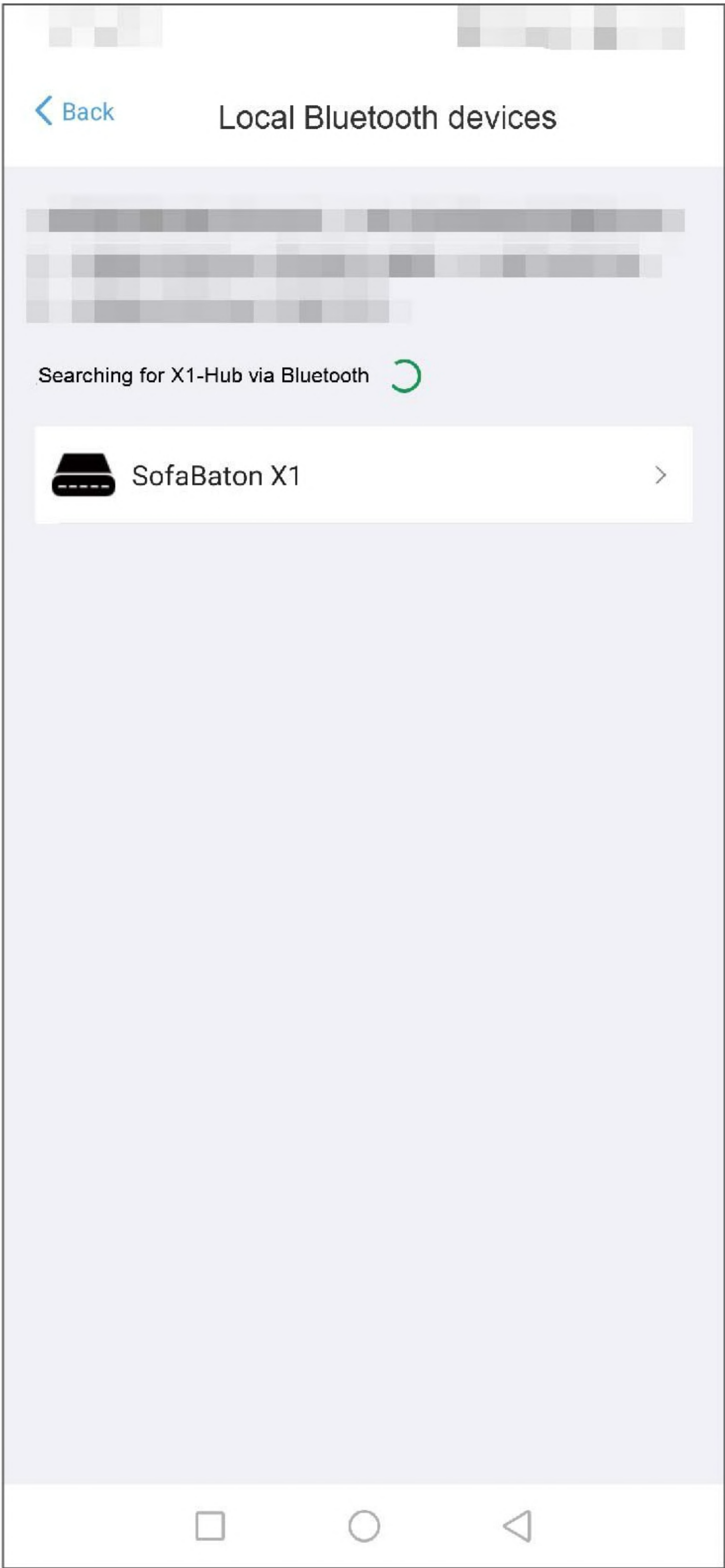

Step5: Send the WiFi password so that the Hub can access your home LAN.

< Back

Wi-Fi information

Wi-Fi ID

Wi-Fi Password

Next

Step6: The device will show a successful connection.

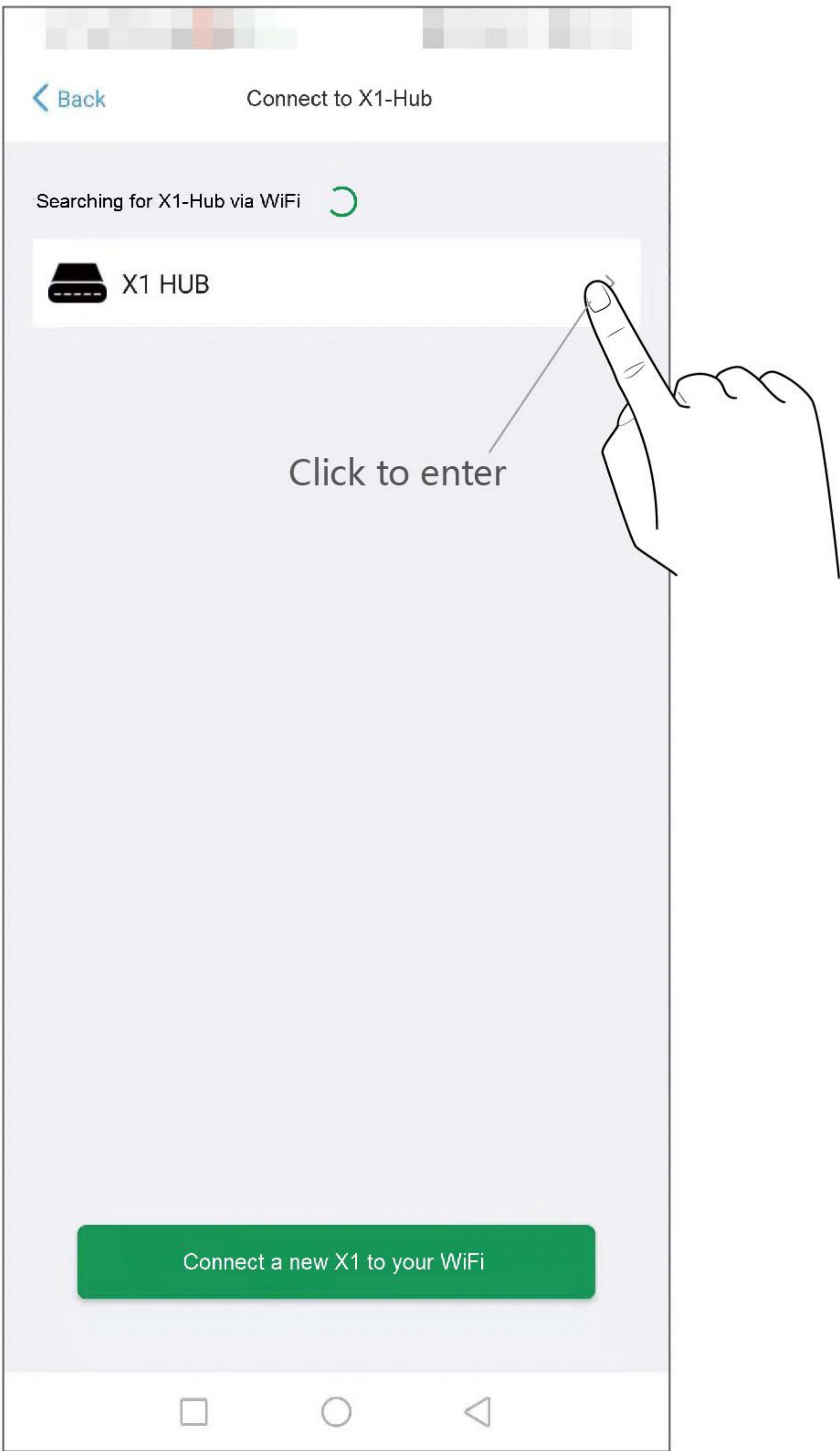

II Adding devices in the app

Quick Search (Via IR Mode)

Here are the steps to perform a quick search to add devices.

Step1: Search for the device brand and model in the app.

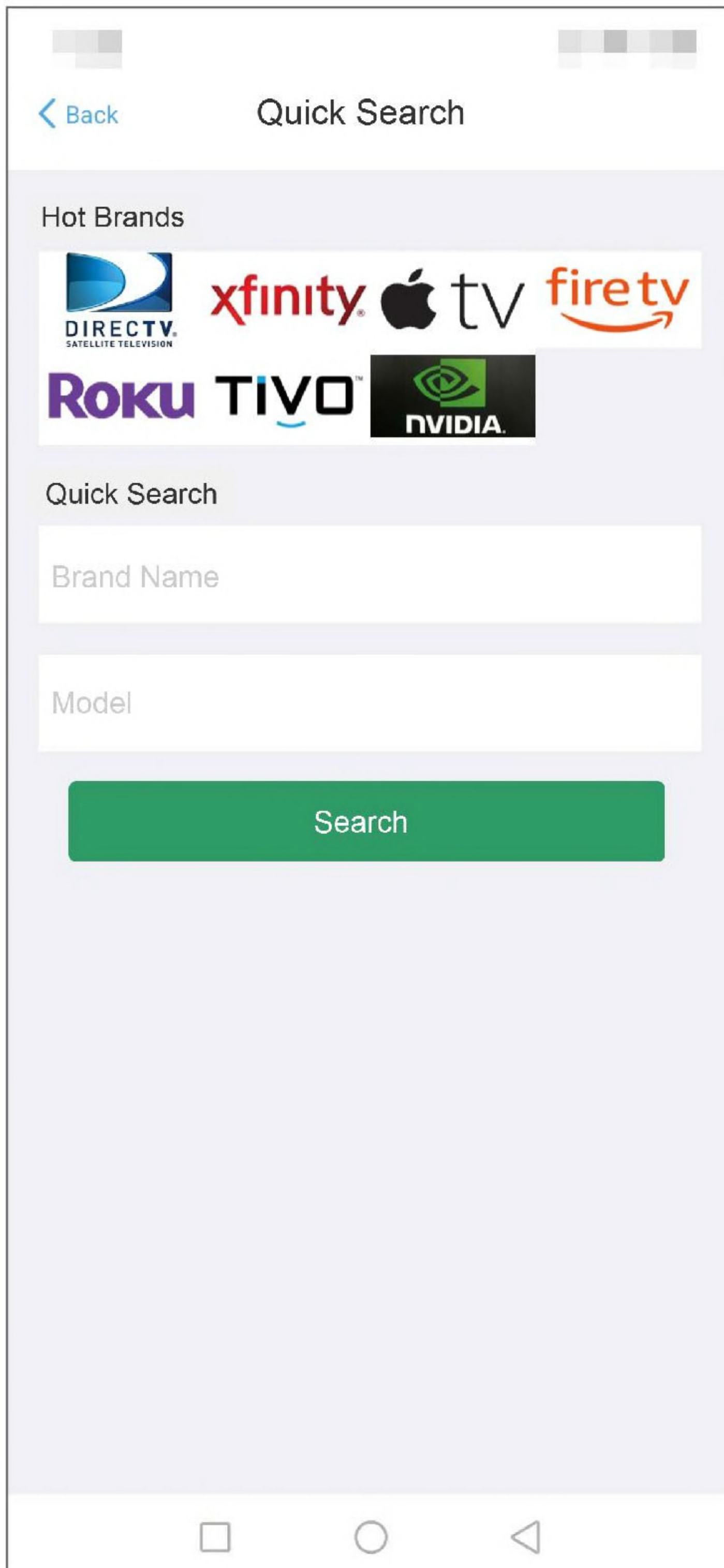

The screenshot shows the 'Quick Search' screen of an application. At the top, there is a header bar with a blue '< Back' button on the left and the title 'Quick Search' in the center. Below the header, there is a section titled 'Hot Brands' which displays a grid of logos for DIRECTV, xfinity, Apple TV, fire tv, Roku, TIVO, and NVIDIA. Underneath the 'Hot Brands' section, there is another 'Quick Search' label followed by two input fields: 'Brand Name' and 'Model'. Below these input fields is a large green button labeled 'Search'. At the very bottom of the screen, there is a white bar containing three standard Android navigation icons: a square, a circle, and a triangle.

Step2: For some models without a corresponding code base, you may need to select the most suitable code base through key testing. This will show up as follows:

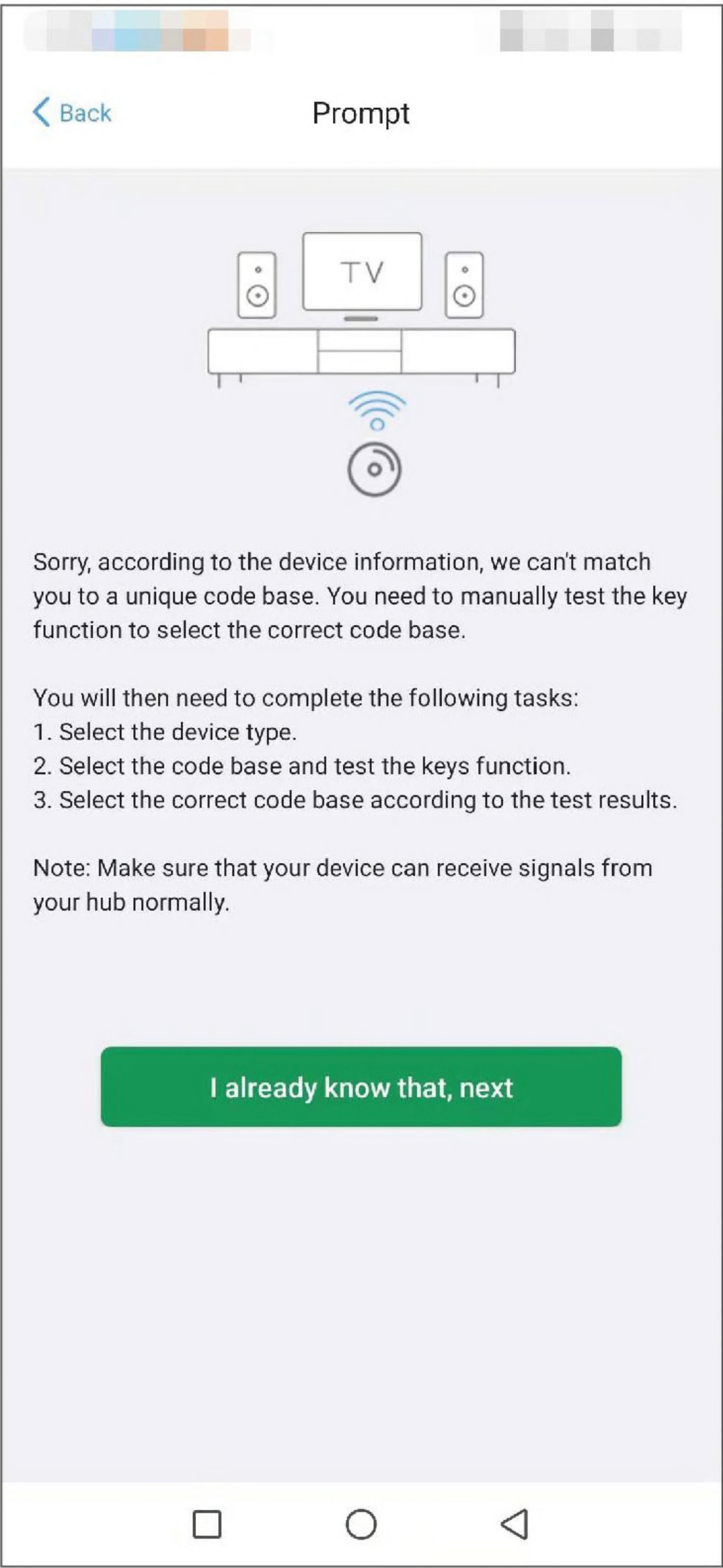

A. Select the device type.

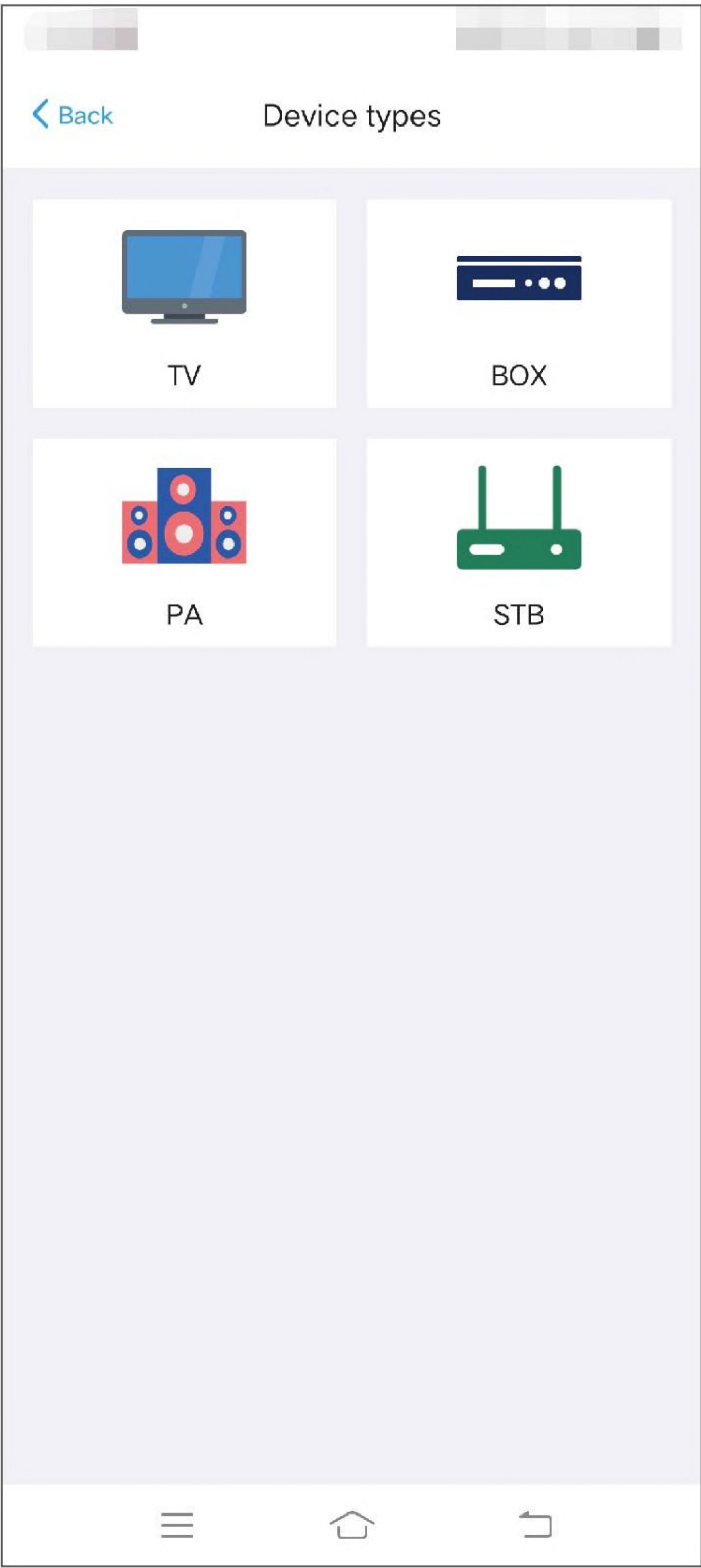

B. select the correct code base according to keys testing.

Back

filter

Find 4 sets of code libraries for your device, please select the code library and manually test the key function.

Option 1

HOT

Option 2

Option 3

Option 4

Common keys

MENU

NAVIGATE_DOWN

NAVIGATE_LEFT

NAVIGATE_RIGHT

NAVIGATE_UP

OK

PAUSE

PLAY

Step3: Confirm the device information and submit it so that you can download the code to the hub.

< Back

Device information

Name:

Icon:

>

Submit

Step4: Confirm the power configuration.

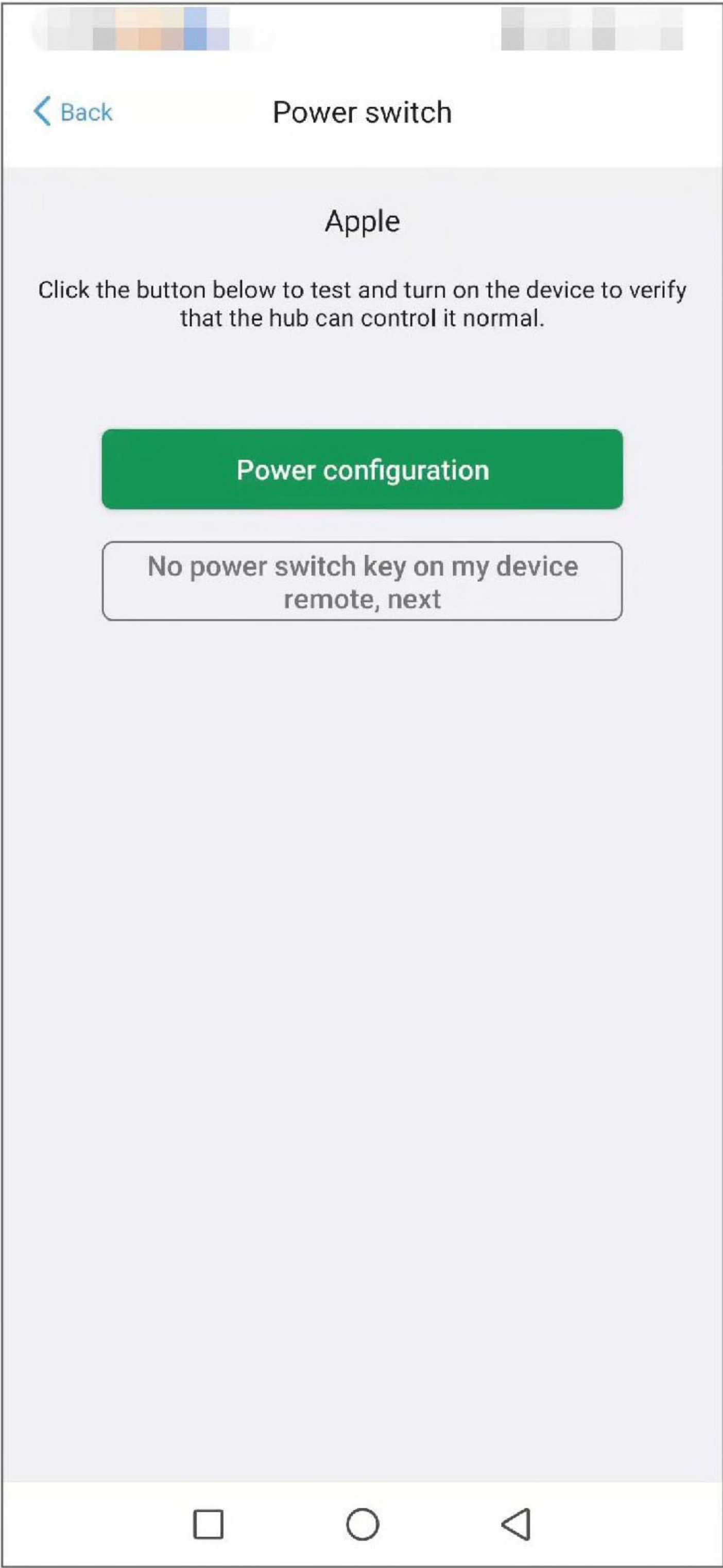

Other Methods for Adding Devices

- Via Bluetooth

Step1: Search or select your device in the list.

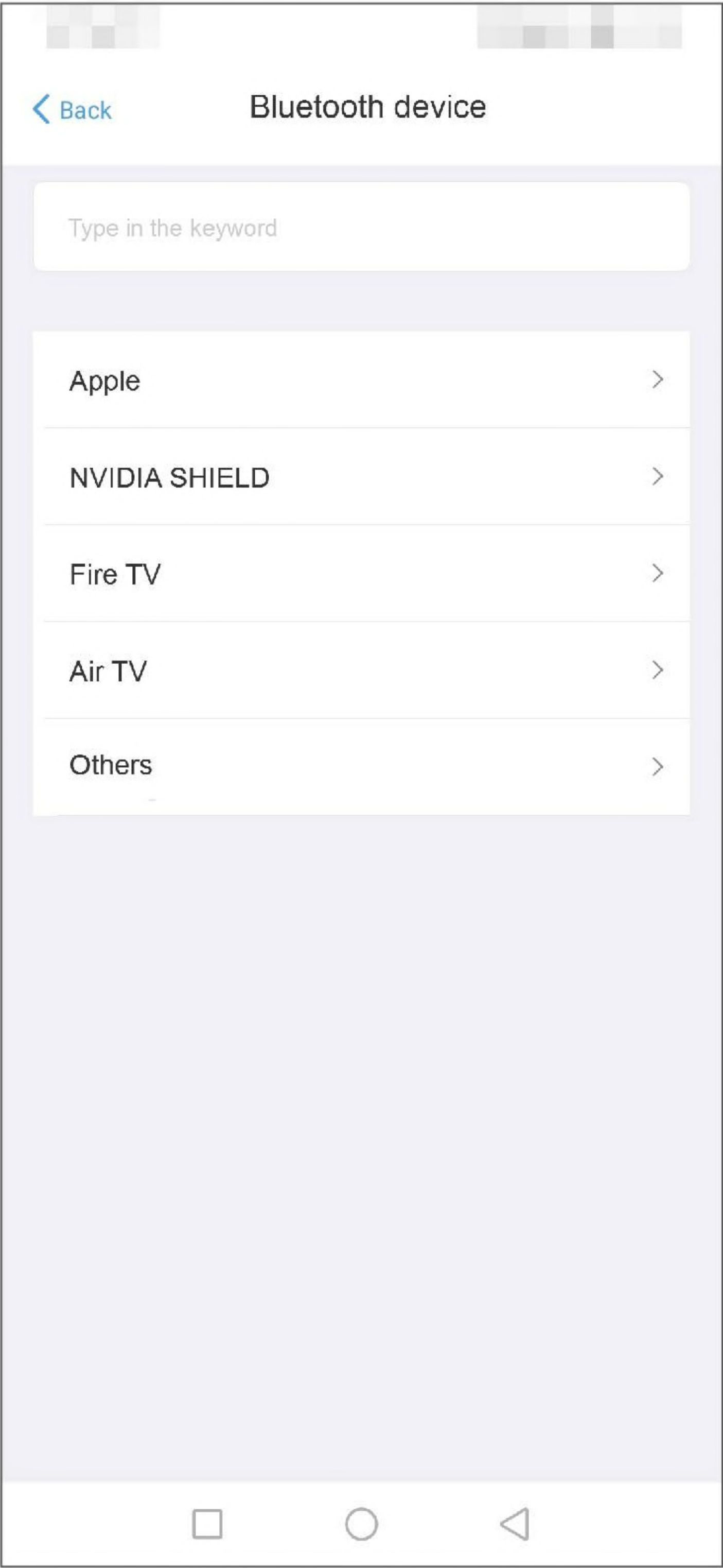

Step2: Confirm the device information and submit it so that you can download the code to the hub.

Back

Device information

Brand:

Model:

Icon:

Category:

TV

Submit

Step3: Use the original remote control to pair the device with Sofabaton X1 via Bluetooth.

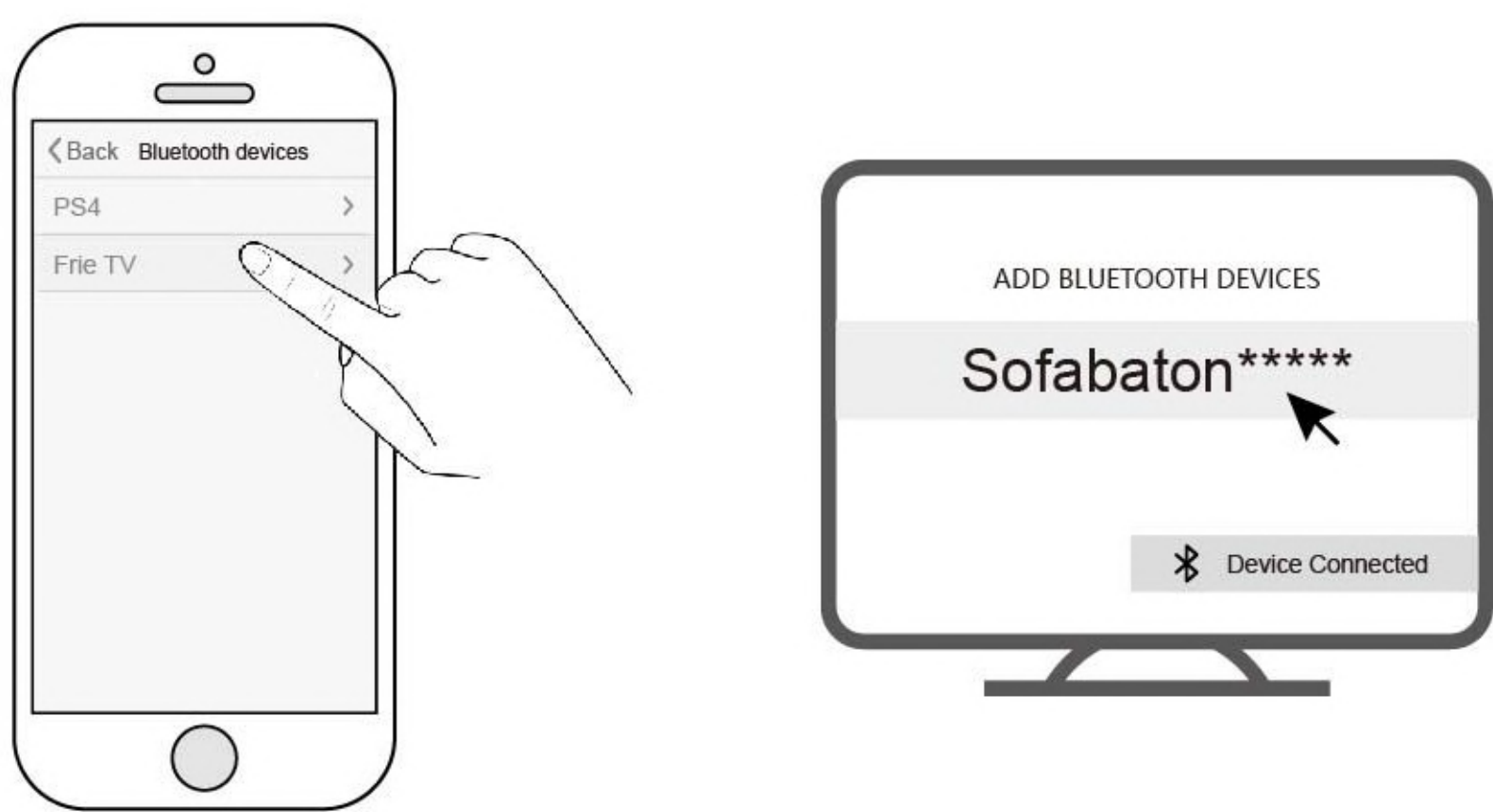

- Via Wi-Fi (for smart devices)

Make sure your device is turned on and connected to Wi-Fi. The devices found after scanning can be added by clicking the list.

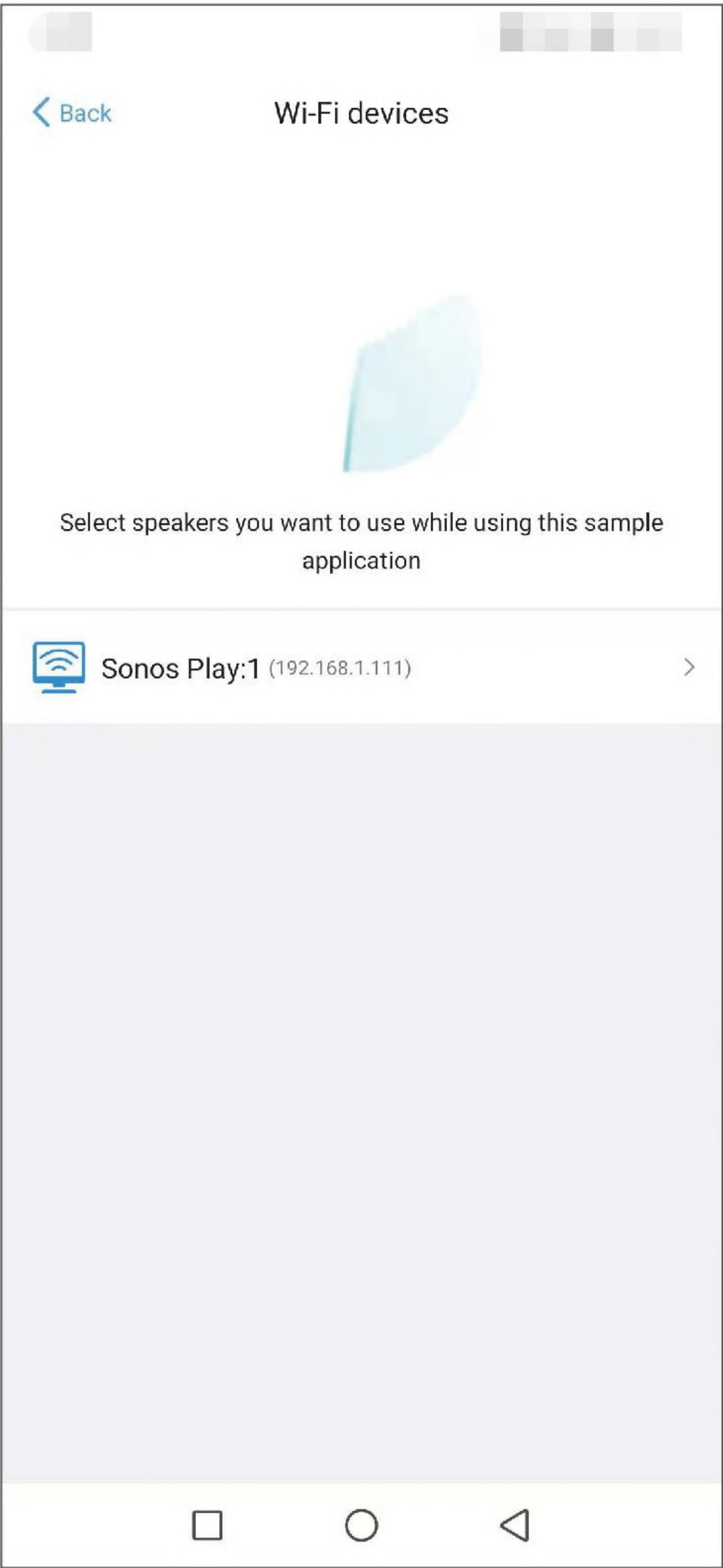

- Via Manual learning mode

Step1: Enter the information for your device.

Back

SofaBaton

Please fill in the information of the device you want to learn
(only infrared devices can be learned)

brand:ABC

model:A001

Icon>

Types of:TV >

Next

Step2: Enter the name of the key you want to learn.

< Back

SofaBaton

Please set the button name

Power

Next

Step3: Follow the instructions in the app to learn from the original remote.

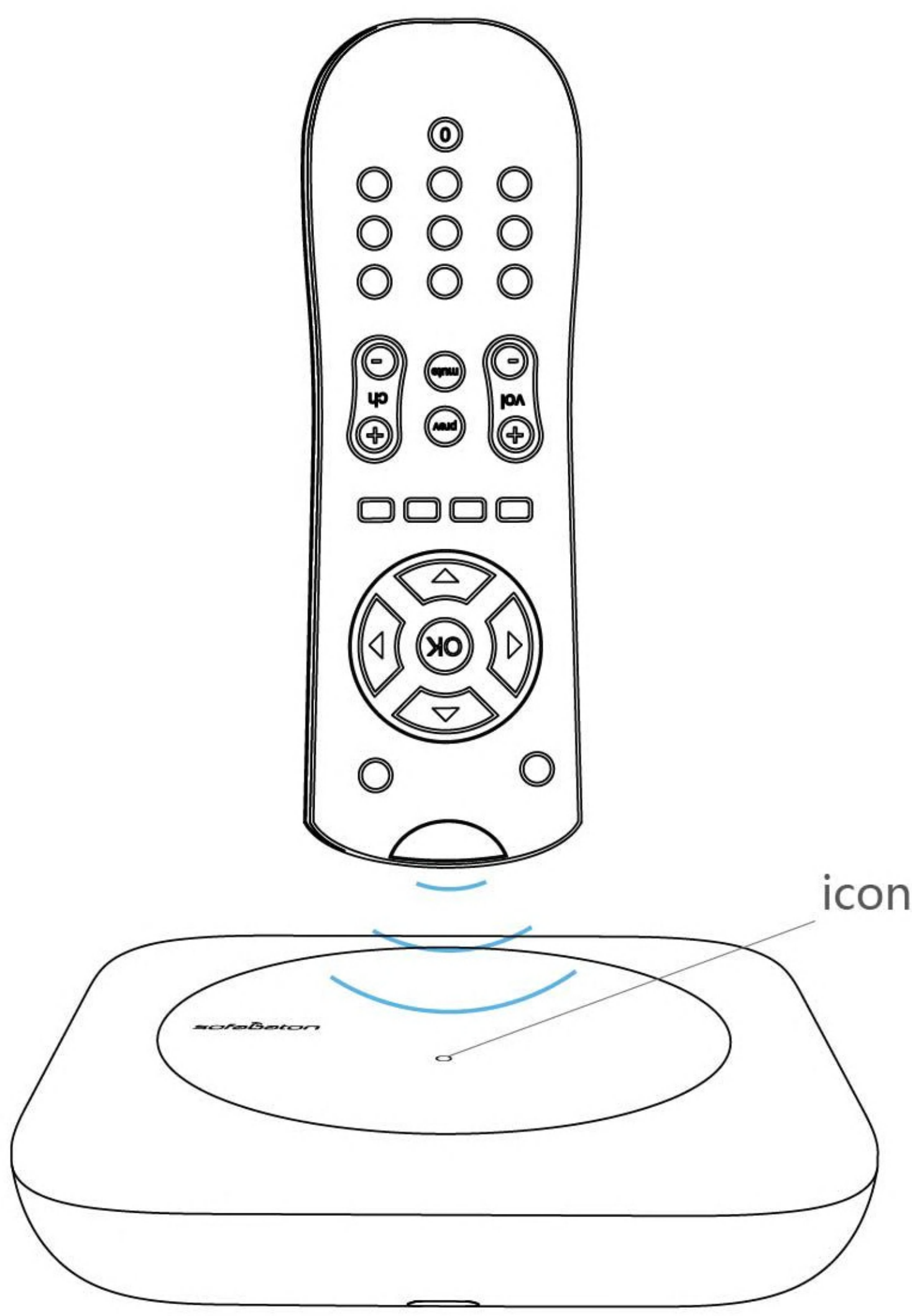

When learning, the original remote should be pointed toward the circular icon, at a distance of 3-5 inches and perpendicular to the hub surface.

III Create a New Activity

Step1: Select the devices you want to use for this Activity.

< Back

Select devices

Select the devices for this Activity.

☒

Philips (TV)

☐

Roku Streaming S (WIFI)

☐

Sonos Play:1 (WIFI)

☐

ABC (TV)

☒

Apple (BOX)

☐

DIRECTV (STB)

Next

Step2: Confirm the input source.

If you are not familiar with source configuration, please follow the instructions on “IV Configuring the source in an Activity” .

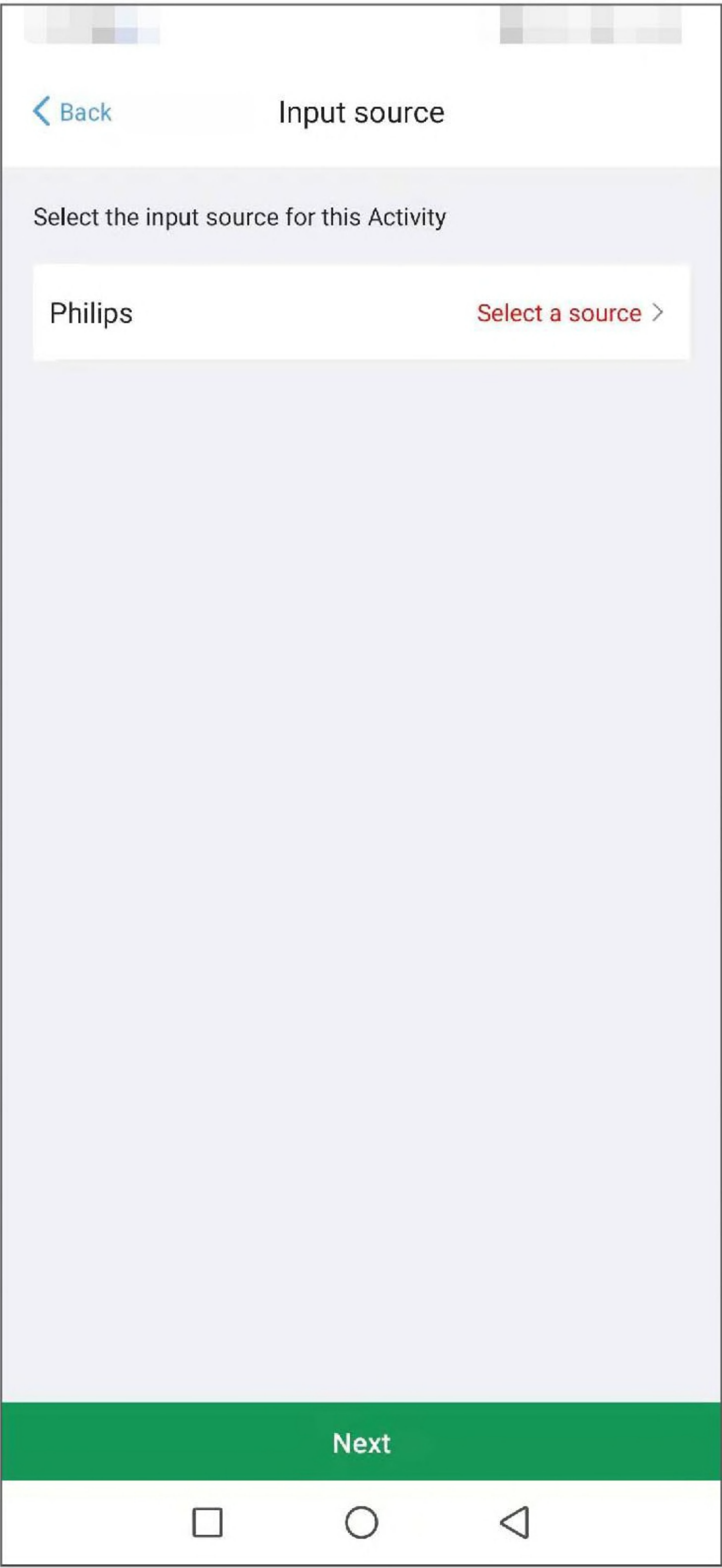

Step3: Verify that all devices are powered on.

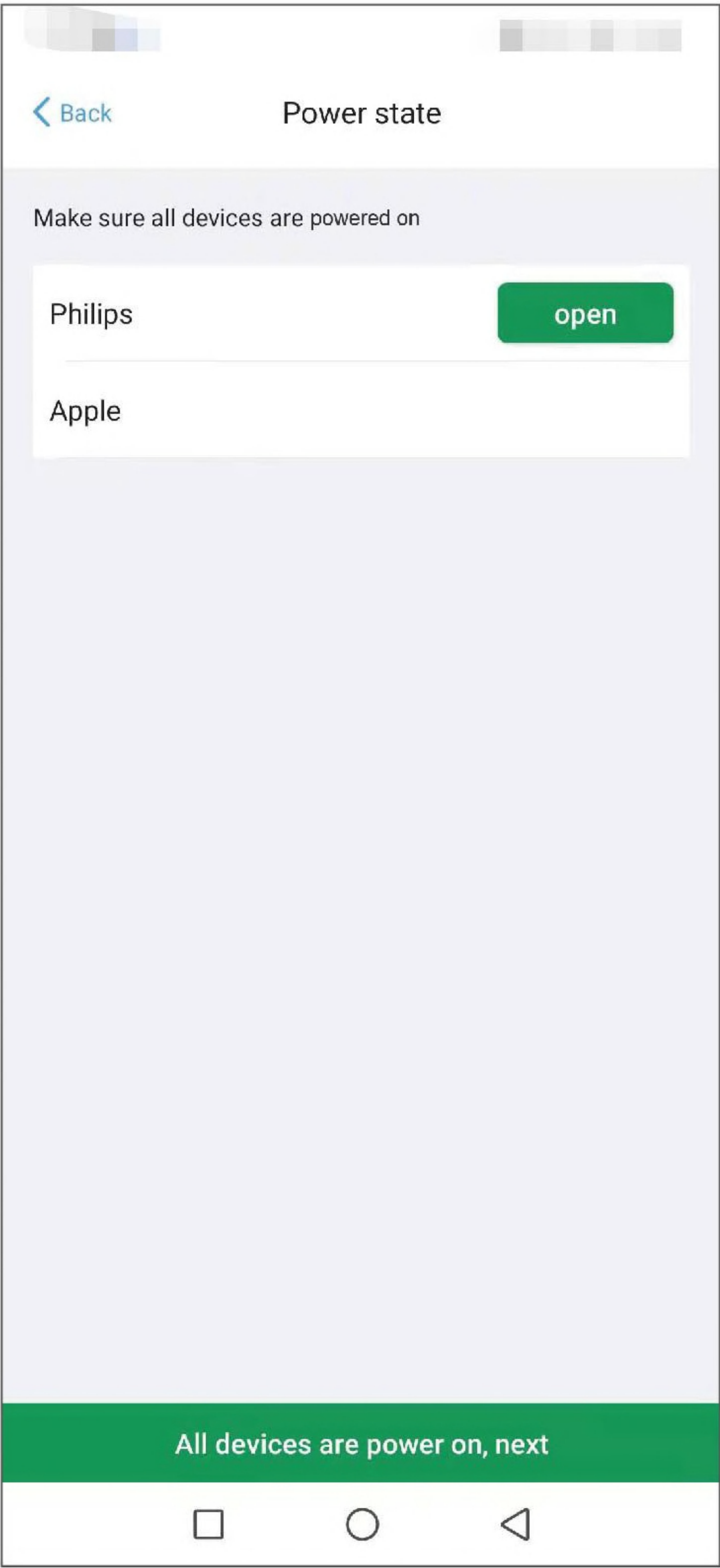

Step4: Configure the X1-Remote key for the current Activity.

Back

Voice

Which device do you want the volume keys on the X1-Remote to control?



☒ Philips

☐ Apple

Next

Step5: Fill in the Activity name. This will complete the activity creation process.

< Back

Activity information

Name

Please enter the device name

Icon



>

Complete

IV Configuring the Source in an Activity

For proper functioning, the system needs to obtain the following source information for the output device (TV, power amplifier, projector, etc.).

- source switching mode
- source control keys
- source list
- source location information

After obtaining the source configuration of the output device and the source location of the input device(Streaming box, Player) , the system can automatically switch to the correct source to enable all associated devices when you start an activity.

To do this, follow the steps listed below.

Step1: If the device has not configured the source in advance, you need to click to configure when creating an Activity .

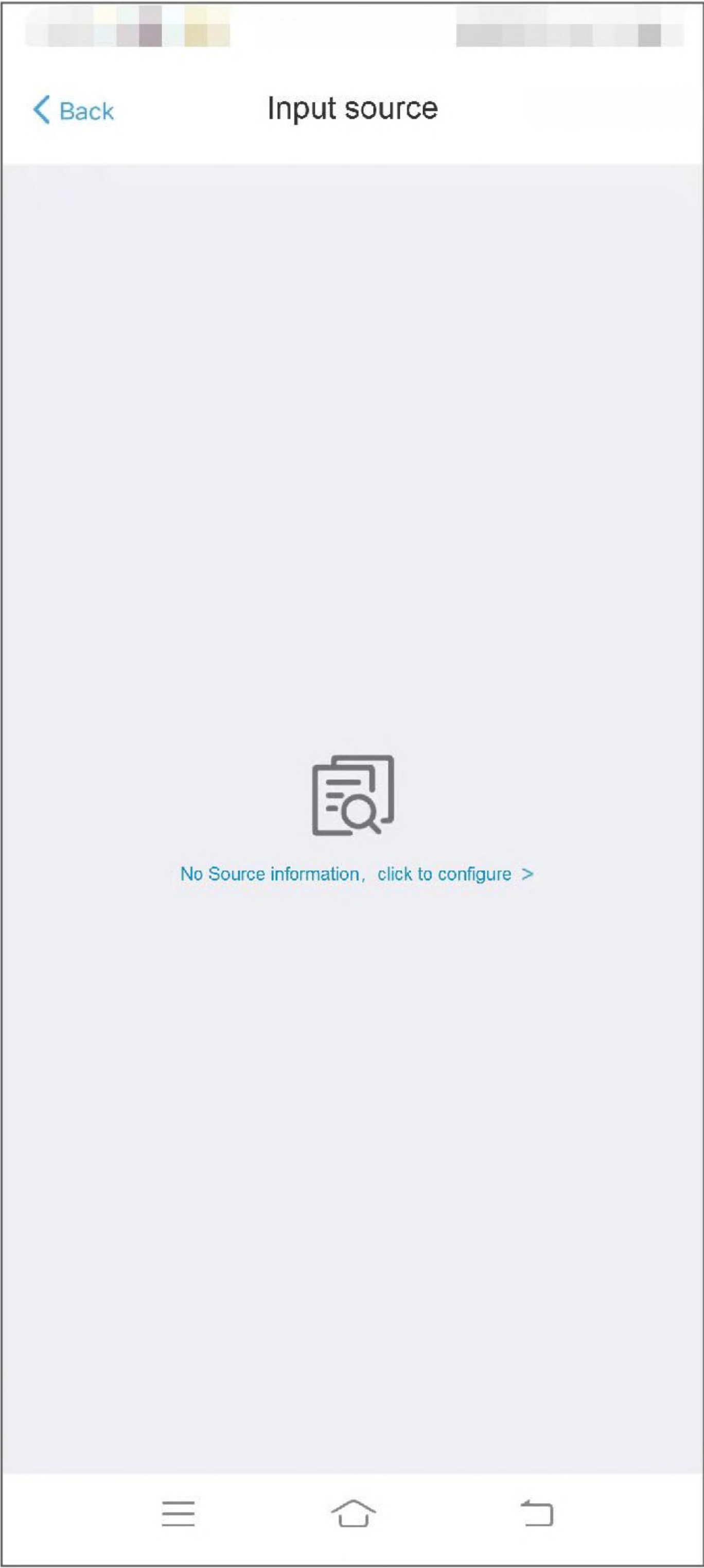

Step2: Source information: source switching mode of the output device. Select the appropriate option for your device.

Back

Source switching mode

HDMI 1

HDMI 2

AV 1

Switch sources with one-click

Source

Cyclic switch by pressing source key

2

Switch sources by Up or Down keys

Source

Switch sources by Source or Input key

2

Switch sources by Source or Input key

No input

No source switching function

Next