

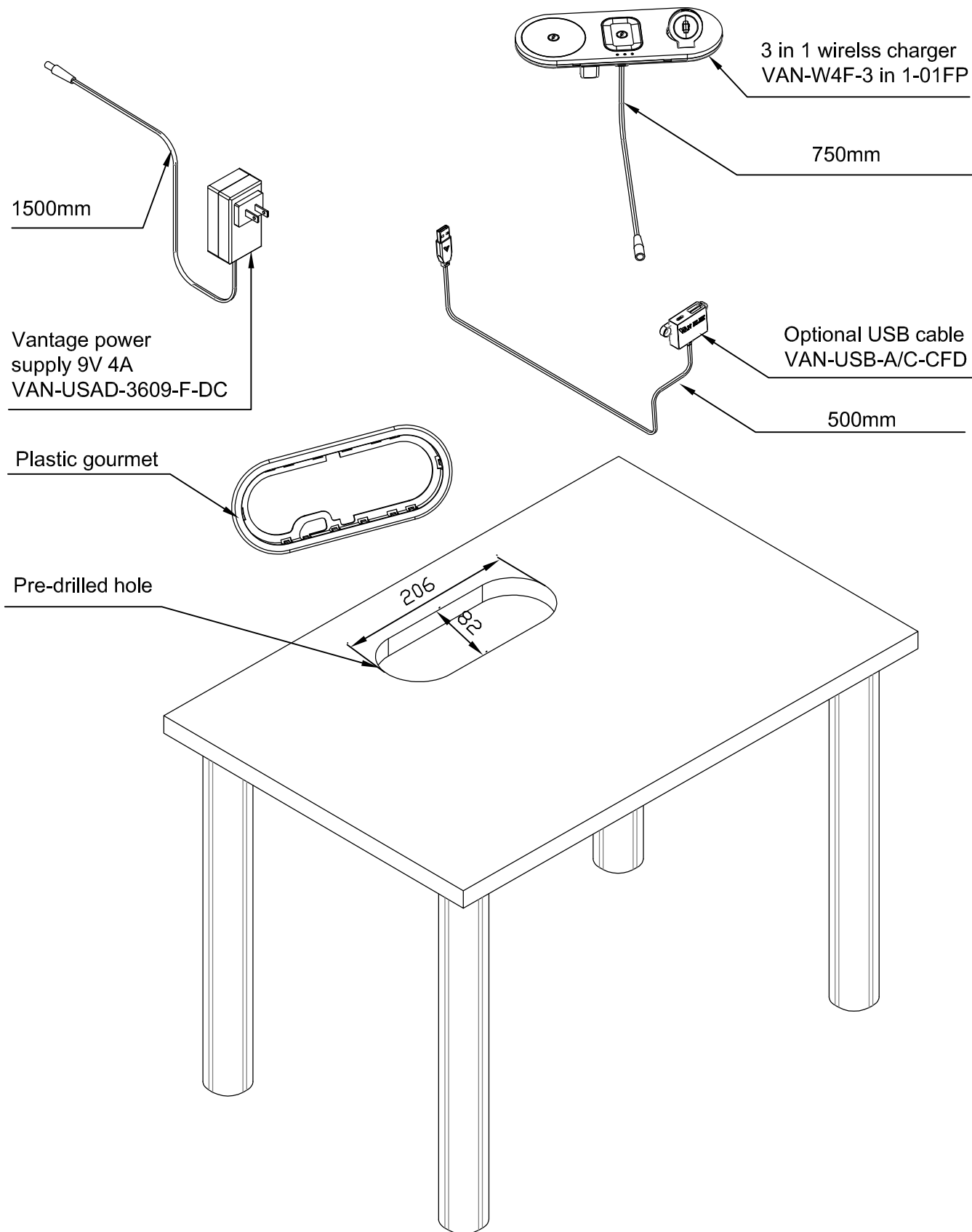

VANTAGE MULTI FUNCTION WIRELESS CHARGER VAN-W4F-3 in 1-01FP

TOP MOUNTING ASSEMBLY INSTRUCTION

VAN-W4F-3 in 1-01FP +VAN-USAD-3609-F-DC+VAN-USB-A/C-CFD





VANTAGE MULTI FUNCTION WIRELESS CHARGER VAN-W4F-3 in 1-01FP

STEP#1:

Insert plastic gourmet

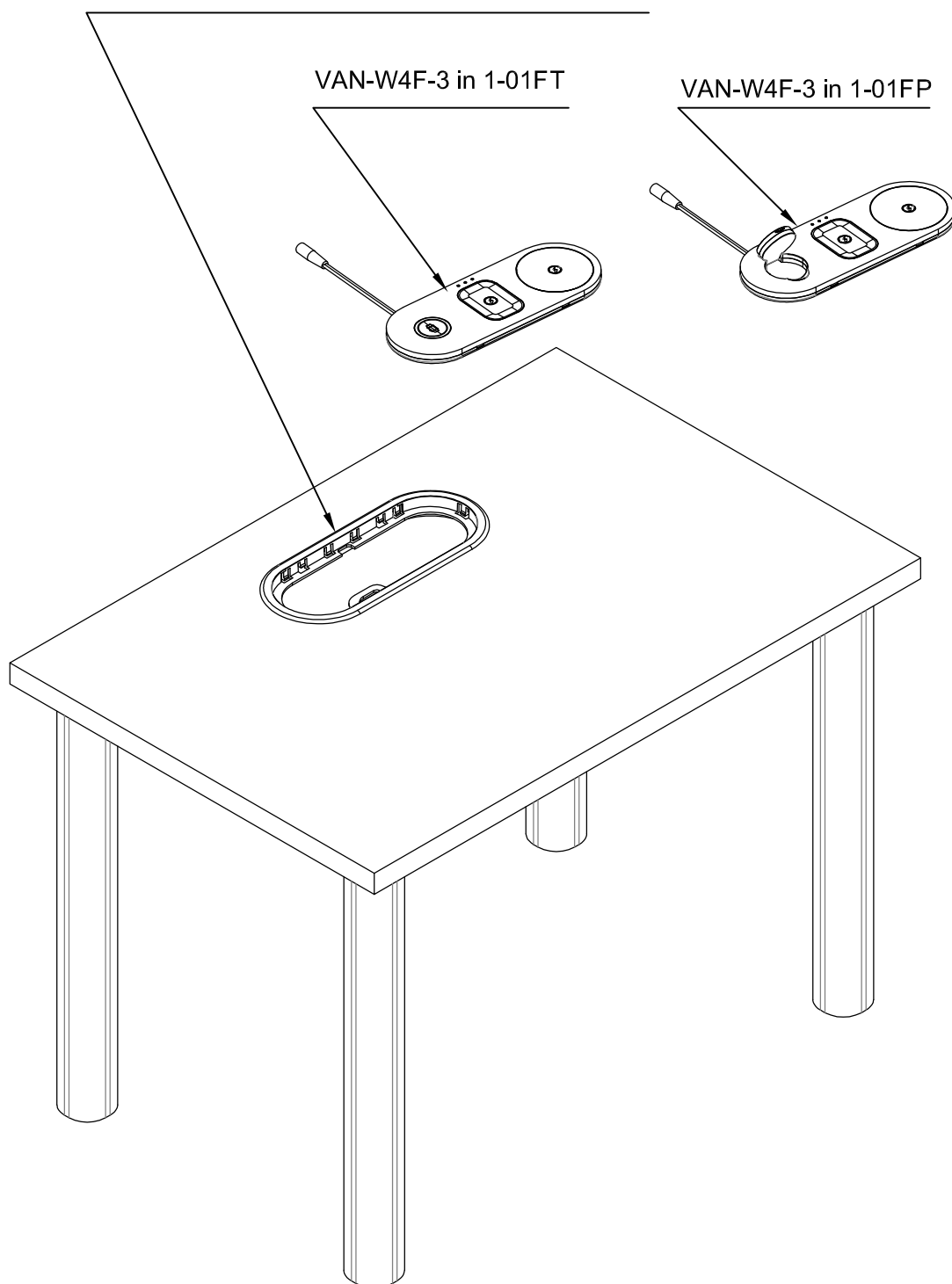



VANTAGE MULTI FUNCTION WIRELESS CHARGER VAN-W4F-3 in 1-01FP

STEP#2:

Insert 3 in 1 unit VAN-W4F-3 in 1-01FP into prepared hole and snap into plastic gourmet

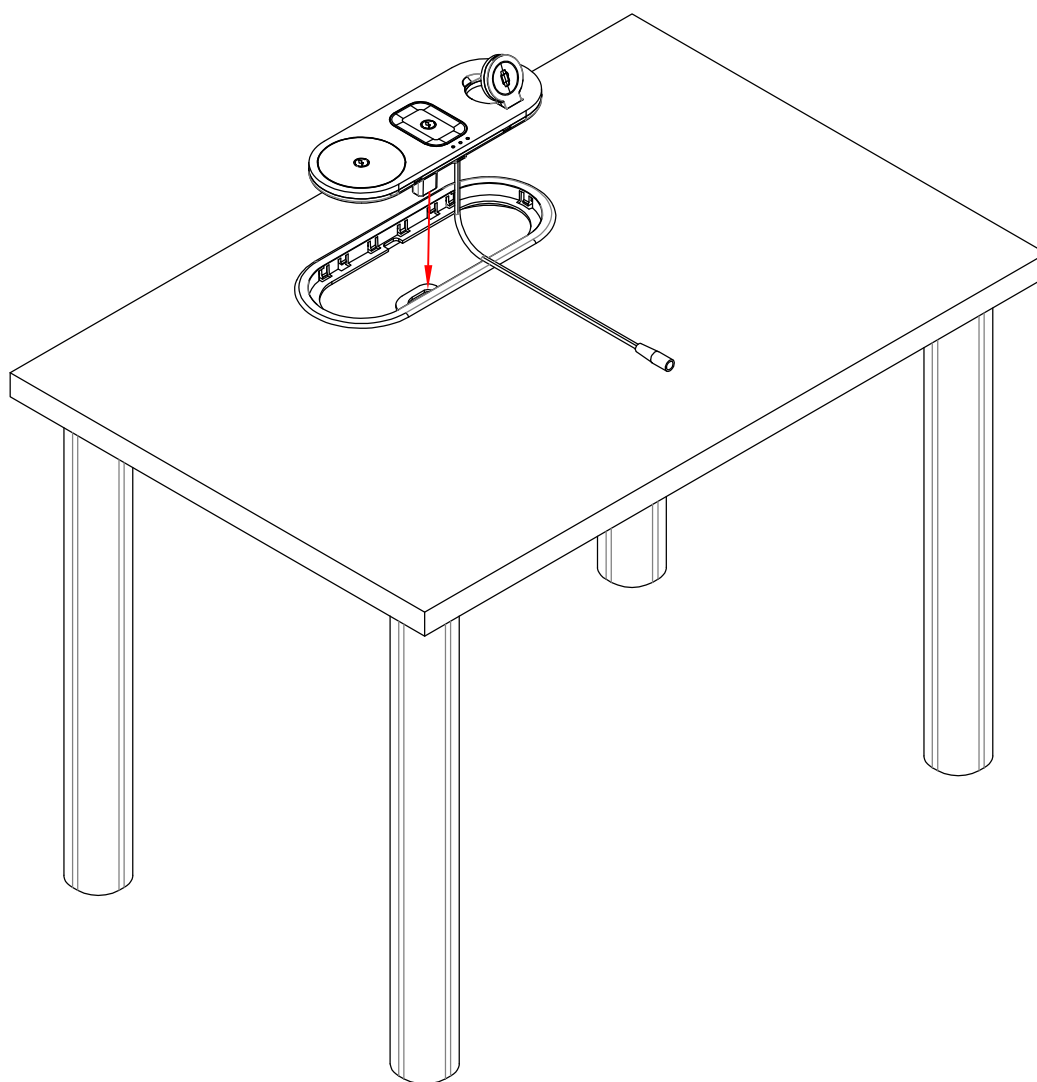



VANTAGE MULTI FUNCTION WIRELESS CHARGER VAN-W4F-3 in 1-01FP

STEP#3:

Run DC power supply
through back of the
furniture.

USB output for extra
device charging

There are 3 indicators red/
blue/ green present phone/
airpods/ iwatch.

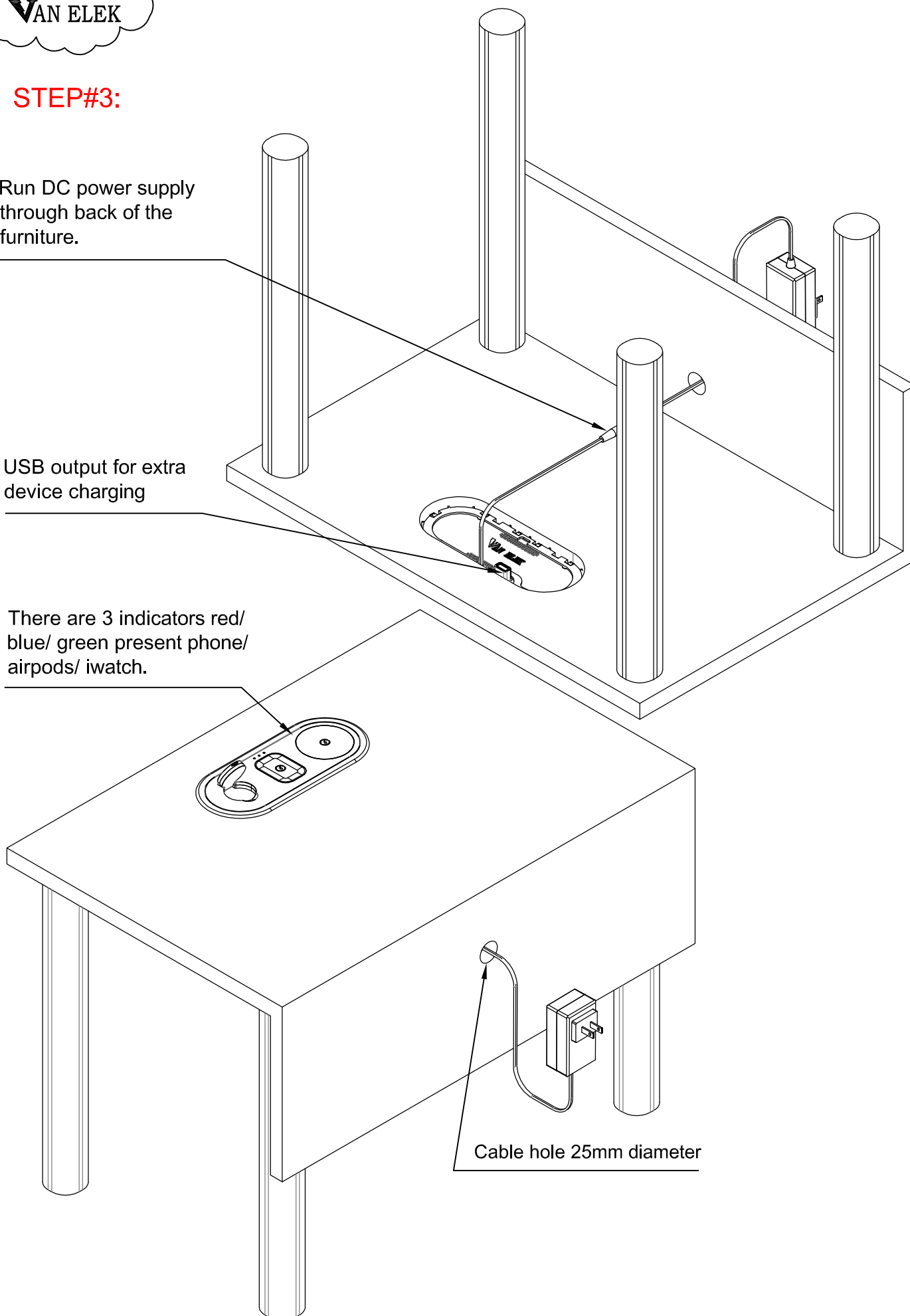



VANTAGE MULTI FUNCTION WIRELESS CHARGER VAN-W4F-3 in 1-01FP

Extra USB is optional to use
for non wireless function
device if any

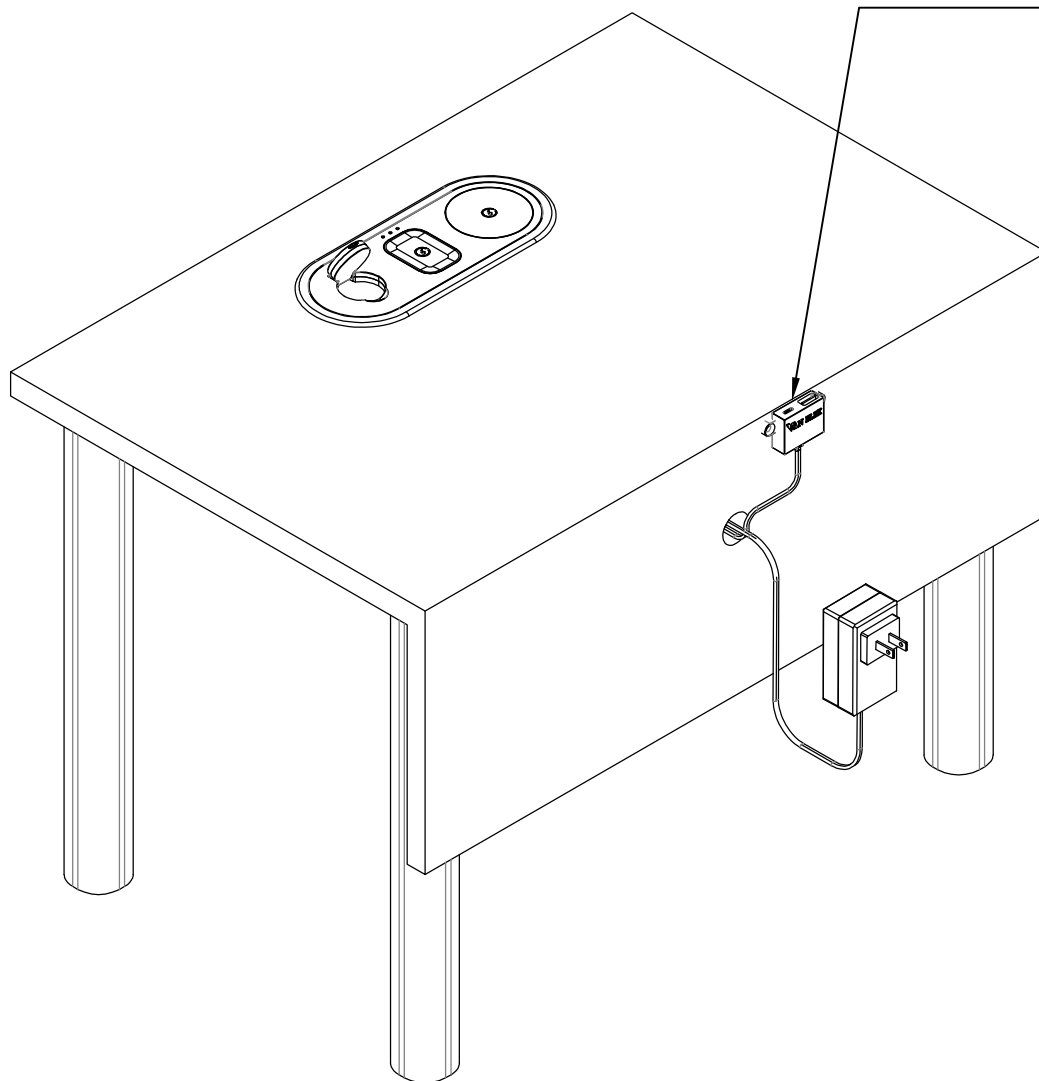

VAN-W4F-3 in 1-01FP

+VAN-USAD-3609-F-DC+VAN-USB-A/C-CFD



VANTAGE MULTI FUNCTION WIRELESS CHARGER VAN-W4F-3 in 1-01FP

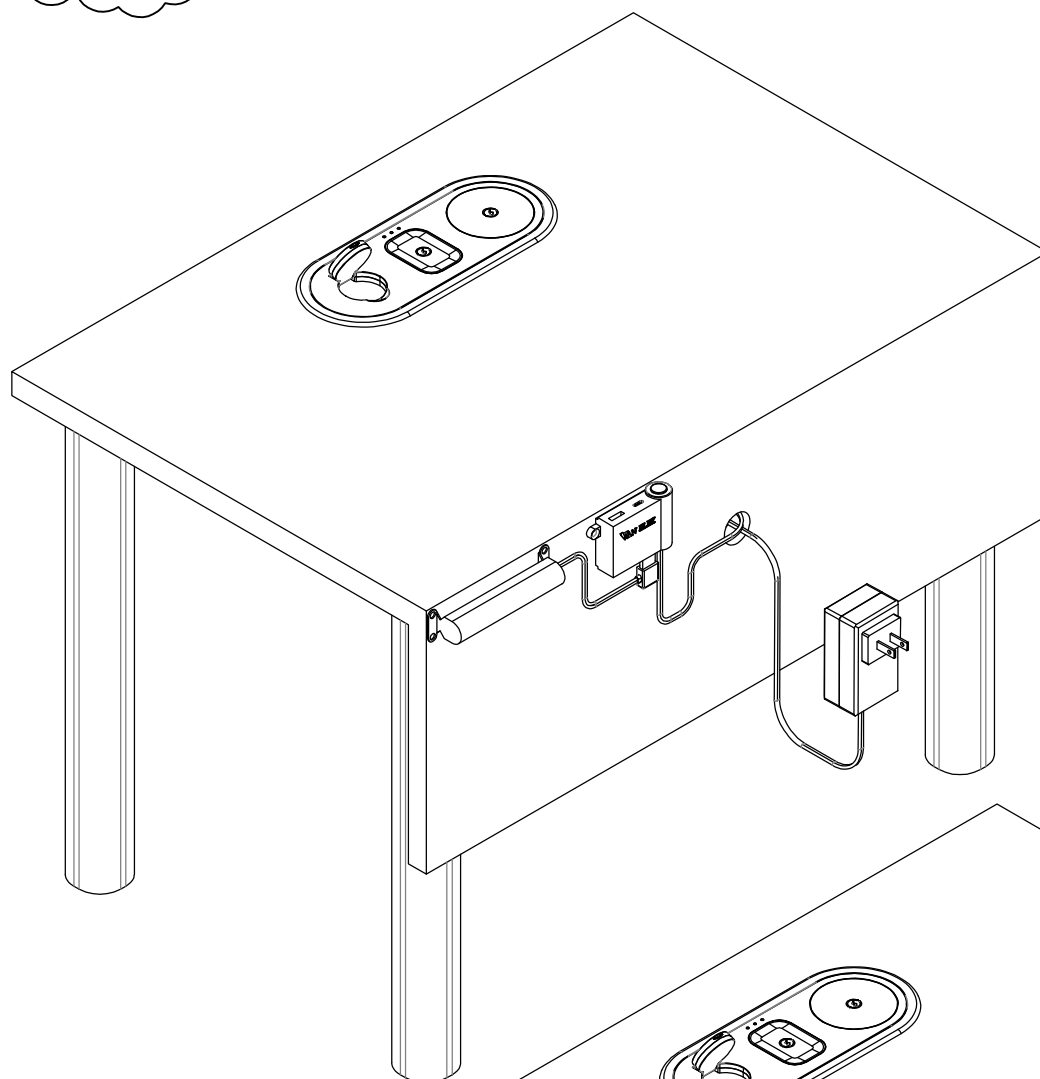

VAN-W4F-3 in 1-01FP
+VAN-USAD-3609-F-DC+
VAN-USB-A/C-BFD+
VAN-AL01-2835W-100

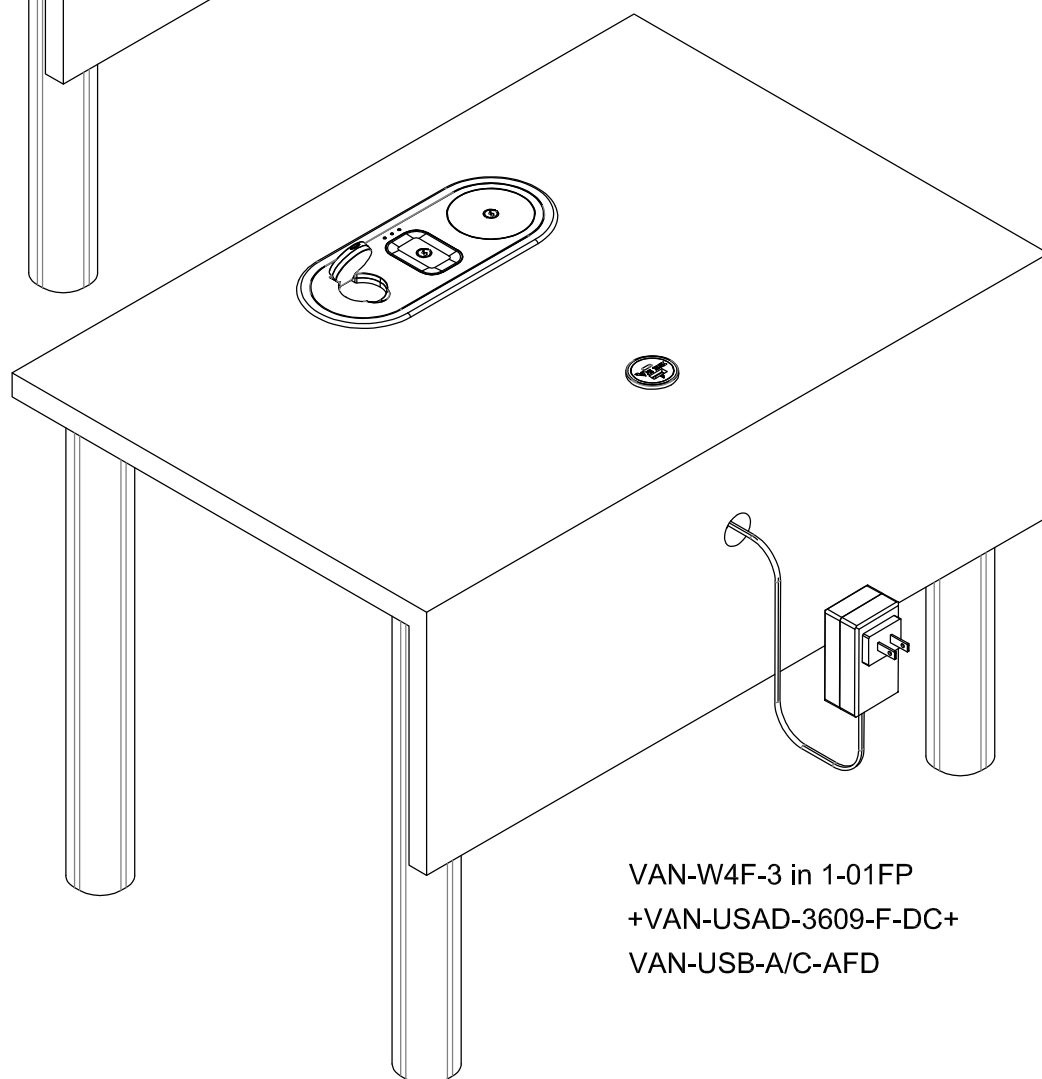

VAN-W4F-3 in 1-01FP
+VAN-USAD-3609-F-DC+
VAN-USB-A/C-AFD



VANTAGE MULTI FUNCTION WIRELESS CHARGER VAN-W4F-3 in 1-01FP

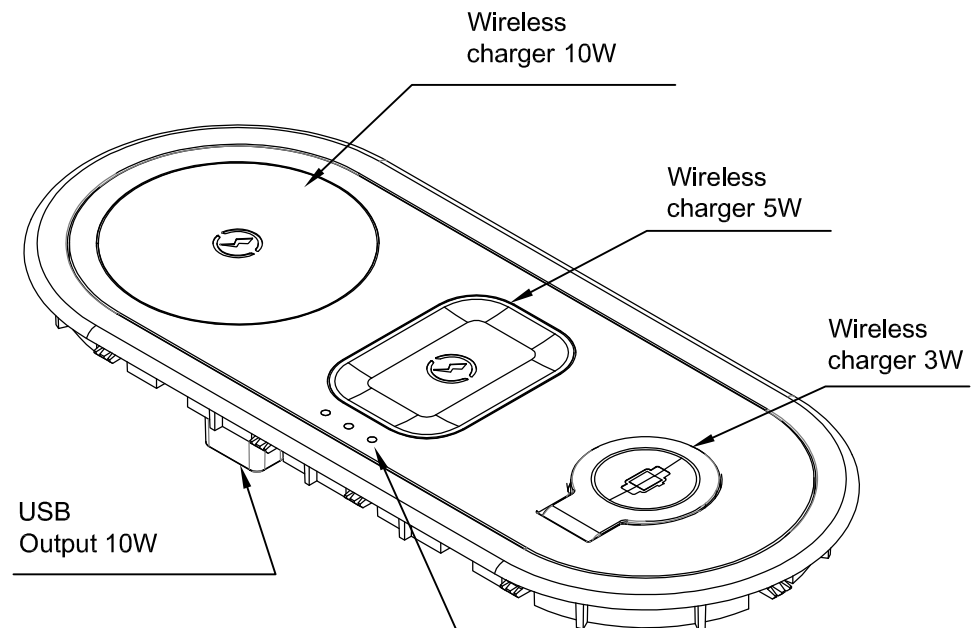

Light description

- One blink at power on
- Constant light on when wireless charges device: phone/ airpods/iwatch
- The red and blue light disappear when phone and aidpods are charged fully
- The green light is always on as long as iwatch is on the lot
- Constant blinking-error

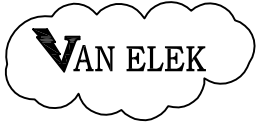

FCC Warning

This device complies with Part 15 of the FCC Rules. Operation is subject to the following two conditions:

(1) This device may not cause harmful interference, and (2) this device must accept any interference received, including interference that may cause undesired operation.

Note: This equipment has been tested and found to comply with the limits for a Class B digital device, pursuant to part 15 of the FCC Rules. These limits are designed to provide reasonable protection against harmful interference in a residential installation. This equipment generates, uses and can radiate radio frequency energy and, if not installed and used in accordance with the instructions, may cause harmful interference to radio communications. However, there is no guarantee that interference will not occur in a particular installation. If this equipment does cause harmful interference to radio or television reception, which can be determined by turning the equipment off and on, the user is encouraged to try to correct the interference by one or more of the following measures:

- Reorient or relocate the receiving antenna.
- Increase the separation between the equipment and receiver.
- Connect the equipment into an outlet on a circuit different from that to which the receiver is connected.
- Consult the dealer or an experienced radio/TV technician for help.

NOTE 2: Any changes or modifications to this unit not expressly approved by the party responsible for compliance could void the user's authority to operate the equipment.

Refer to FCC Part 18.213(c) and KDB 784748 Anner A section A.5:

- Max. Electric Field Emissions: 6.26V/m
Max. Magnetic Field Emissions: 0.60A/m

(b) The maintenance of the system is the responsibility of the manufacturer.

(c) To prevent interference, the product should be as far away from devices operating at the same frequency as possible.

RF exposure considerations

This equipment complies with the FCC RF radiation exposure limits set forth for an uncontrolled environment. This equipment should be installed and operated with a minimum distance of 20cm between the radiator and any part of your body.