

# USER GUIDE

## Car Wireless Charger Phone Holder WX-01

### Please read this operation

Instruction carefully and keep it properly before using this product.

### FCC Statement

This device complies with Part 15 of the FCC rules. Operation is subject to the following two conditions: 1) this device may not cause harmful interference, and 2) this device must accept any interference received, including interference that may cause undesired operation.

Note: This equipment has been tested and found to comply with the limits for a Class B digital device, pursuant to part 15 of the FCC Rules. These limits are designed to provide reasonable protection against harmful interference in a residential installation. This equipment generates uses and can radiate radio frequency energy and, if not installed and used in accordance with the instructions, may cause harmful interference to radio communications. However, there is no guarantee that interference will not occur in particular installation. If this equipment does cause harmful interference to radio or television reception, which can be determined by turning the equipment off and on, the user is encouraged to try to correct the interference by one or more of the following measures:

- Reorient or relocate the receiving antenna.
- Increase the separation between the equipment and receiver.
- Connect the equipment into an outlet on a circuit different from that to which the receiver is connected.
- Consult the dealer or an experienced radio/TV technician for help.

Changes or modifications not expressly approved by the party responsible for compliance could void the user's authority to operate the equipment.

### Radiation Exposure Statement

This device complies with RF radiation exposure limits set forth for an uncontrolled environment. This transmitter must not be co-located or operating in conjunction with any other antenna or transmitter. This device must operate with a minimum distance of 20 cm between the radiator and user body.

### Product Introduction

Thank you for purchasing and using this products! In order to ensure that you can provide a better operating experience for your mobile phone or electronic products.

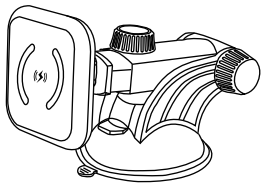

Suction cup  
telescopic support

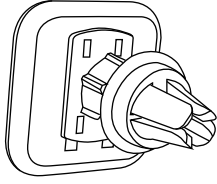

Air vent phone  
holder

Applicable model	Compliance with Qi standard cell phone.		
Normal input	DC 5V/2A(max)	Ordinary output	5V/1A(max)
Quick input	DC 9V/1.67A(max)	Fast output	9V/1.2A(max)
Working frequency	100~205KHZ	Output Power	10W/7.5W/5W

PS:these above information is based on real sample testing,it will be a little bit different for different products in different conditions.

### Operation

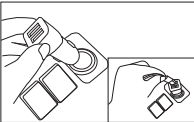

1.Insert the car charger into the car charging port, and insert one end of the data cable into the car charger.

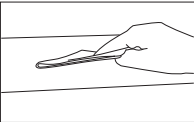

2.Please wipe the car dashboard carefully with the damp cloth .



3.Press the air switch so that the suction cup is firmly attached to the instrument panel.

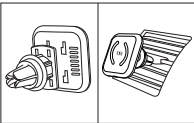

4.Replace with the air outlet bracket, install the bracket to the car air outlet.

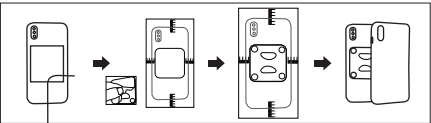

5.Install the magnetic sheet, stick the mobile phone protective film paper to the back of the mobile phone, use the positioning card to stick the magnetic sheet to the appropriate position, and install the mobile phone case.

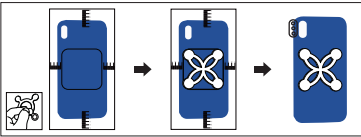

6.Install the external magnetic sheet, use the positioning card to stick the magnetic sheet to the appropriate position of the phone case, and install the phone case.

### ⚠ Note

- 1.Don't squeeze or crash.
- 2.Don't use the wireless charger in high temperature, humidity or corrosive environment,avoid damaging the circuit and avoid leakage.
- 3.Take care of the children,to ensure that they will not play the wireless charger as a toy , to avoid unnecessary accidents.
4. Don't disassemble or throw into fire or water,to avoid causing a short circuit leakage.
- 5.Don't close with magnetic stripe or chip care(ID card, bank card, ect) to avoid leakage.
- 6,please keep the distance at least 20cm between implantable medical devices (pacemakers, implantable cochlear, ect) and the wireless charger,to avoid potential interference with the medical device.
- 7.No metal plate on the back of the phone ,because it will stop the phone charging.
- 8.To ensure the fast and safe charging ,we select the QC2.0/QC3.0/standard car charger and the best four-core universal data cable ,others nonstandard car charger or cables will make the charging slow .
- 9.If the car temperature inside is too high ,the charging will become slow ; with the cold wind from the air outlet,charing on the air outlet will be much better ,with the hot wind from the air outlet ,pls charging the mount on the dashboard.