

# User Manual of MH107

## 1. Product Features

*Name: Wireless Door & Window Alarm*

*Working voltage: 3V*

*Standby current: 100uA*

*Working current: 50mA*

*Power: 0.15w*

1. Type: magnetic induction
2. Sounds an alarm when somebody opens the door or window illegally.
3. Can be free controlled by the wireless remote control.
4. A password of 3 digits can be set, and it won't be lost even if power off.
5. Zone control function. Multiple devices can be controlled by the remote control at different zones
6. Siren on/off setting
7. Setting of reminder sound when door not closed
8. Setting of reminder sound when door not locked
9. "DING DONG" sound when linked with MH101 Door Phone for use.
10. Triggers MH102 Video Camera to take videos when linked with it for use.
11. RF on/off setting
12. Lock the keypad automatically when entering wrong password 5 times.
13. Sounds an alarm after 4 seconds when triggered.
14. LED indicator when battery low
15. Still sounds an alarm even in the environment of strong magnetism.

## ◆ Appearance

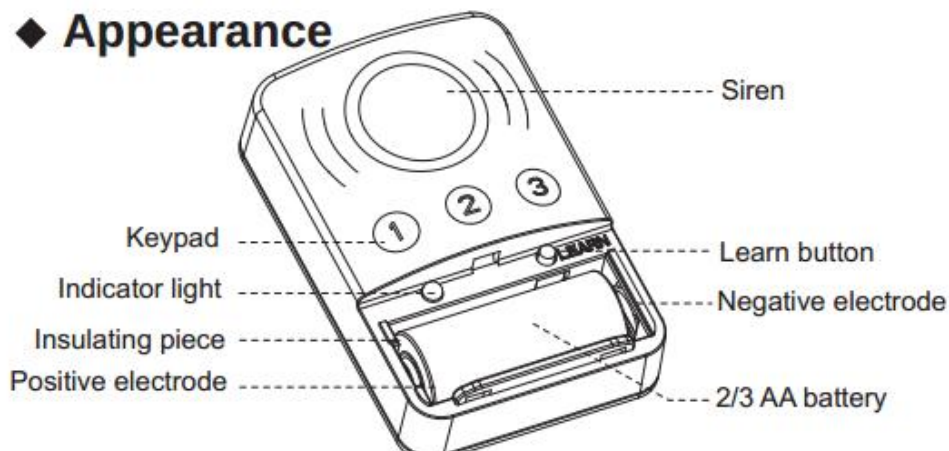

## 2. Installation and Use

1. Take out the insulating piece, and you will hear one "bi", which means correct insert of the battery.
2. Tear off the protection paper of 3M adhesive tape on the back of MH107, and stick the magnet part parallel to the alarm, ensuring the gap to be less than 1cm.

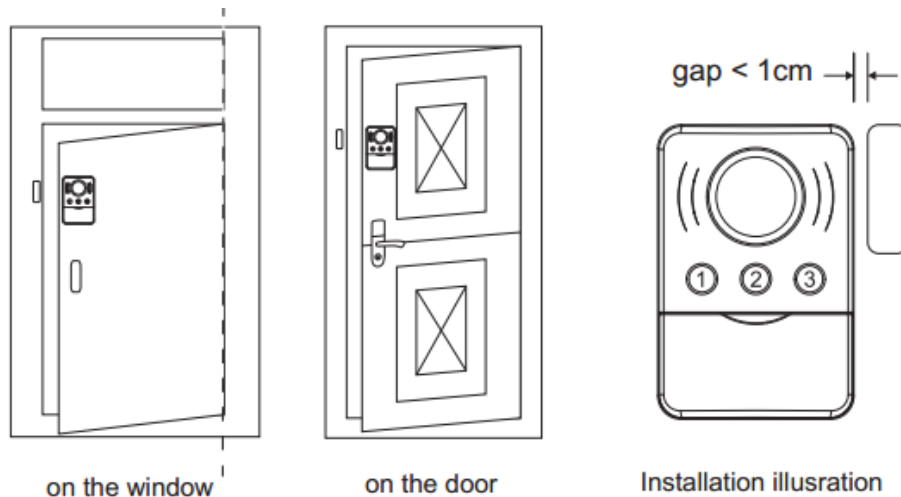

## 3. Function setting

### Password setting

\* Default password is "1 2 3"

#### 1) . ARM

Press "3" on the keypad and we will hear one beep. 20 seconds later it is ARMED

#### 2) .DISARM

Enter the correct password and press "3". After one beep it is DISARMED. (default password is "1 2 3" if it's not revised)

#### 3) .Revise password

In the status of "DISARMED", enter the current password "1 2 3" and press "3", red light stays on for 3 seconds. Enter the new password "xxx" and enter "1 2 3" again and press "3", the red light flashes 3 times. New password is successfully set. ("xxx" stands for new password; default password is "1 2 3" if it's not revised)

### RF on/off

#### 1) .ON

Enter the password "xxx" and enter "2111" to turn the RF function on. Red light

flashes 3 times. In this case, MH107 can work with other wireless units.

2) .OFF

Enter the password "xxx" and enter "2112" to turn the RF function off. Red light flashes 3 times. In this case, MH107 can't work with other wireless units and it will work individually

#### **Siren on/off**

1) .ON

Enter the password "xxx" and enter "2121" to turn the siren on. Red light flashes 3 times. When MH107 is triggered, the siren will sound.

2) .OFF

Enter the password "xxx" and enter "2122" to turn the siren off. Red light flashes 3 times. When MH107 is triggered, the siren will not sound

#### **Reminder sound when door not closed**

1) .ON

Enter the password "xxx" and enter "2211" to turn the sound on. Red light flashes 3 times.

2) .OFF

Enter the password "xxx" and enter "2212" to turn the sound off. Red light flashes 3 times.

#### **Reminder sound when door not locked**

1) .ON

Enter the password "xxx" and enter "2221" to turn the sound on. Red light flashes 3 times.

2) .OFF

Enter the password "xxx" and enter "2222" to turn the sound off. Red light flashes 3 times

## Function setting

Description	On	Off
RF	Enter the password "xxx" and enter "2111"	Enter the password "xxx" and enter "2112"
Siren	Enter the password "xxx" and enter "2121"	Enter the password "xxx" and enter "2122"
Reminder sound when door not closed	Enter the password "xxx" and enter "2211"	Enter the password "xxx" and enter "2212"
Reminder sound when door not locked	Enter the password "xxx" and enter "2221"	Enter the password "xxx" and enter "2222"
"DING DONG" sound when linked with MH101 Door Phone for use.	Enter the password "xxx" and enter "2131"	Enter the password "xxx" and enter "2132"
Triggers MH102 Video Camera to take videos when linked with it for use.	Enter the password "xxx" and enter "2231"	Enter the password "xxx" and enter "2232"
Supposed the password is "1 2 3"; enter "1232111" to turn on RF function, and enter "1232112" to turn it off.		

### 4. Reset to default factory

Open the battery cover and take out the battery. After 3 seconds, press and hold the learn code key, and insert the battery. When you hear three beeps, it has been reset to default factory. Default password is "1 2 3"

### 5. Pairing two MH107, Divide into different zones

With the help of the remote control, you can pair two units to be divided into different zones and managed separately by the same remote.

- a. Zone "1": Open the battery cover of unit "1", press the code button continuously, at same time press the "1 " button (represent zone 1) of the remote control for 3 seconds, the red light of the remote control will flash and beeps twice. Zone "1" is set successfully. The button "1" can arm/disarm alarm unit "1" installed at Zone 1.
- b. Zone "2" : Open the battery cover of unit "2", press the code button continuously, at same time press the "2 " button (represent zone 2) of the

remote control for 3 seconds, the red light of the remote control will flash and beeps twice. Zone "2" is set successfully. The button "2" can arm/disarm alarm unit "2" installed at Zone 2.

## **6. Remark**

- 1). Every step of button operation must be completed within 5 seconds.
- 2 ). When you enter the password wrongly for 5 times, MH107 sounds a 2-second beep and 10 beeps, and the keypad will be locked for 5 minutes. After that time, you can use the remote control to unlock the keypad and re-enter the password.

## **FCC Statement:**

This device complies with part 15 of the FCC Rules. Operation is subject to the following two conditions:

- (1) this device may not cause harmful interference, and
- (2) this device must accept any interference received, including interference that may cause undesired operation.

### **CAUTION:**

*Changes or Modifications not expressly approved by the party responsible could void the user's authority to operate this device.*

NOTE: This equipment has been tested and found to comply with the limits for a Class B digital device, pursuant to Part 15 of the FCC Rules. These limits are designed to provide reasonable protection against harmful interference in a residential installation. This equipment generates, uses and can radiate radio frequency energy and, if not installed and used in accordance with the instructions, may cause harmful interference to radio communications. However, there is no guarantee that interference will not occur in a particular installation.

If this equipment does cause harmful interference to radio or television reception, which can be determined by turning the equipment off and on, the user is encouraged to try to correct the interference by one or more of the following measures:

- Reorient or relocate the receiving antenna.
- Increase the separation between the equipment and receiver.
- Connect the equipment into an outlet on a circuit different from that to which the receiver is connected.
- Consult the dealer or an experienced radio/TV technician for help.

Examples of RF Exposure statement:

This equipment complies with the FCC RF radiation exposure limits set forth for an uncontrolled environment. This equipment should be installed and operated with a minimum distance of 20 centimeters between the radiator and your body.

**FCC ID: ZAX5E-MH107**

This device complies with part 15 of the FCC rules. Operation is subject to the following two conditions: (1) This device may not cause harmful interference, and (2) This device must accept any interference received, including interference that may cause undesired operation.

## After-sale service

Please don't hesitate to call the service hotline, contact the online customer service or visit Mosaic website.

Hotline: 0769-8544 9889

Email: [sales01@mosaichk.net](mailto:sales01@mosaichk.net)

Website: [www.mosaichk.net](http://www.mosaichk.net)