

# House Garden Light

## Pattern Replacement

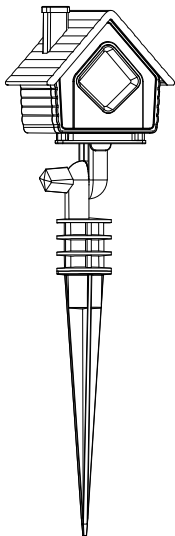

Thanks for your purchasing, please read this manual carefully before operating the system, It gives you general information for your safety and better operation.

## ◆Packing Accessories

Check for the contents in the package refers to the following list;

1.IP65 water-proof :1	
2.Adaptor:1	3.Power cord:1
4.Junction:1	5.Ground stake:1
6.Remote control:1	7.Screws:1
8.Base:1	9. User Manual:1

## ◆Product Features

Laser classification/power class 2/less than 1 mw(single beam)	
Laser wavelength(s)	515nm Green/660nm Red/450nm Blue
Laser Diode Life About	> 10000 hours
Power Input	120-240V AC
Operating Environment	Indoor/ Outdoor; -30℃-30℃
Waterproof Level	IP65 for the light and IP44 for Adaptor
Projection Coverage	40 ft. X 40 ft.

## ◆ Installation Steps

\*Position the projector by loosening and tightening the angle adjustment screws.

\*Attach the cable to the adaptor and the projector light by fully inserting the two-pronged plug and tighten the wire cap.

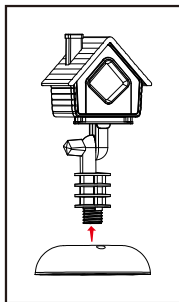
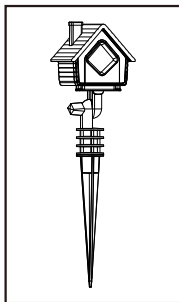
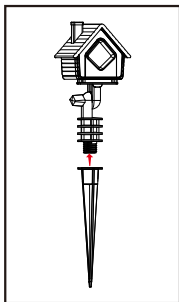
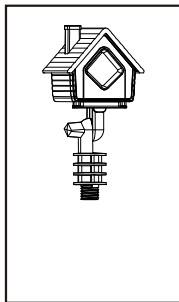
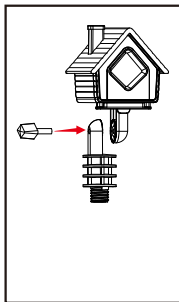
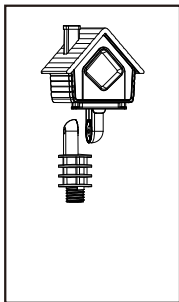

## ◆Light' pattern plate replacement instructions

\*Manually take out the pattern from the lamp.

\*Handle the side of pattern and take it out , put the new pattern into the pattern plate ( gear surface up ) .

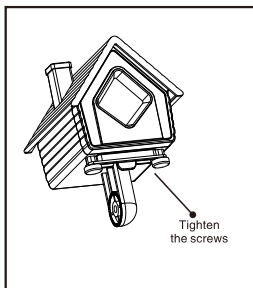
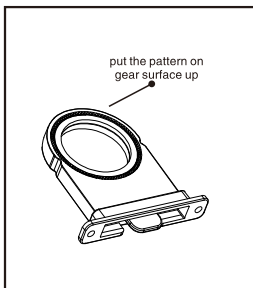
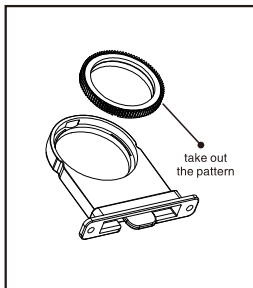
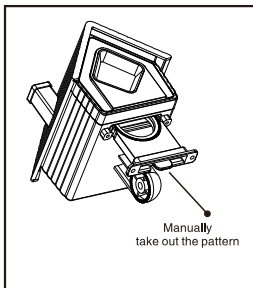

\*Insert the pattern plate with the new pattern into the lamp (pay attention to the sealing ring). Tighten the screws , pattern plate replacement completed.

\*Repeat the above actions to complete the replacement of the pattern plate.

## ◆Remote Guide

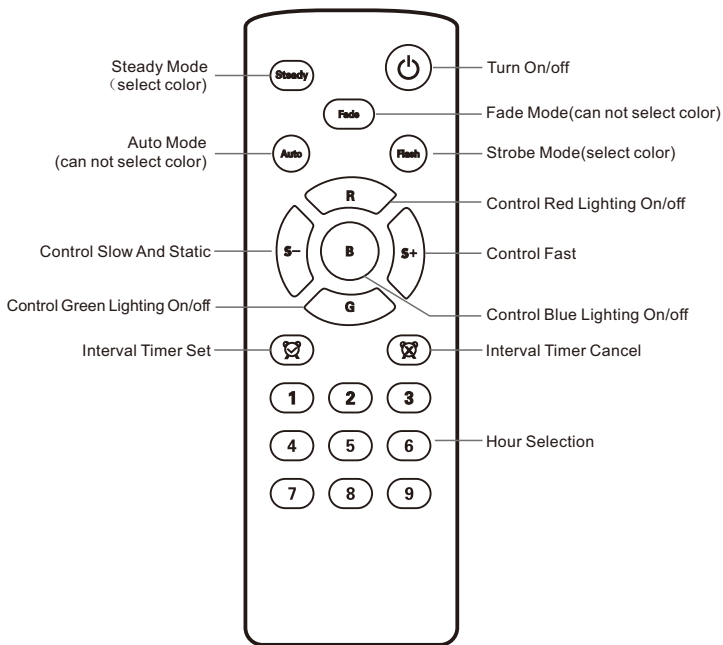

1. When you need to use the remote control, please tear off the protective film of the battery in the remote control, So that you can use it better.

2. : On / Off;

3. Fade: Breath mode (Non-selectable color);

4. Auto: Automatic mode (Non-selectable color);

5.Flash: Stroboscopic mode (Selectable color)

6.R G B: Control color on and off;

R: Control the red light On/Off;

G: Control the green light On/Off;

B: Control the blue light on and off;

7. S-S + : Adjust the motor speed, with 3 speeds:slow, medium,fast.

S- Slow down; S+ Acceleration;



8.   : Set timing On/Off;

9.1 h-9h: Setting timing time;

10.Steady: Steady mode (Selectable color)

Note: When the time is required, please press  the light will flash twice to indicate that it has received the directive, then select the desired time (press once) to set the timing successfully.

When you need to cancel the timer, please press  , the light will flash twice to indicate that it received the directive, the timer was been off.

If you want to change the timing time, please press  to cancel the timing firstly, then press  and press the desired time ( 1, 2,3, 4…… only select one).

For example: if you select 2h, the light will automatically turn off after 2 hours, and 22h will automatically turn on(24 hour cycle, under the condition of uninterrupted electricity power).

## ◆Installation

※Better to work 6 hours then cool it down with 30 minutes, it will save the lifetime of lighting source.

※Laser is Class 2,the power of each laser point is not more than 1mW,no harmful to human body and eyes.

※This product is mainly used for outdoor with waterproof IP65.It has excellent radiating ease put it far way from the flammable objects or liquids.

※Please use our own power adaptor to support the light.If you need to change a new adaptor please check the parameter of our adaptor and buy a new One. If you need more longer power cable,please use legal cable with enough diameter and control the length or it will give more higher load to the adapter.

※When connecting the cable to the plug adapter,please make sure the 2 pin plug is the right way round,the "Flat" and "Keyway" need to match or there will be no contact.

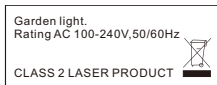

MADE IN CHINA

This device complies with part 15 of the FCC Rules. Operation is subject to the following two conditions: (1) this device may not cause harmful interference, and (2) this device must accept any interference received, including interference that may cause undesired operation.

Any changes or modifications not expressly approved by the party responsible for compliance could void the user's authority to operate the equipment.

NOTE: This equipment has been tested and found to comply with the limits for a Class B digital device, pursuant to Part 15 of the FCC Rules. These limits are designed to provide reasonable protection against harmful interference in a residential installation. This equipment generates, uses and can radiate radio frequency energy and, if not installed and used in accordance with the instructions, may cause harmful interference to radio communications. However, there is no guarantee that interference will not occur in a particular installation.

If this equipment does cause harmful interference to radio or television reception,

which can be determined by turning the equipment off and on, the user is encouraged to try to correct the interference by one or more of the following measures:

- Reorient or relocate the receiving antenna.
- Increase the separation between the equipment and receiver.
- Connect the equipment into an outlet on a circuit different from that to which the receiver is connected.
- Consult the dealer or an experienced radio/TV technician for help.

The device has been evaluated to meet general RF exposure requirement. The device can be used in portable exposure condition without restriction