

BC800 3G

Body Weight Scale

Instruction Manual



M+edisanté



BC800 3G Summary

EN Instruction Manual

- Package contents
- Display Indicators
- Operating Instructions
- Important Safety Information
- Specification

EN



Read the instruction manual before using the device

Intended use: The Body Weight Scale BC800 3G is a digital monitor for home/domestic use which measures weight of persons 18 years of age or more.

Package contents

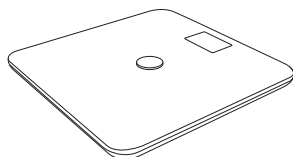

Body Weight Scale
BC800 3G

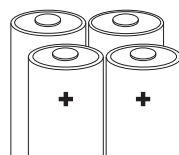

4x1.5V AAA
Alkaline batteries

1. Insert batteries

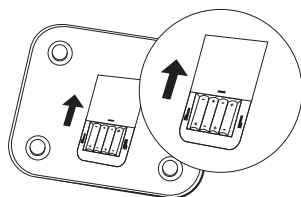

- 01** Place the scale upside down on a flat surface being careful not to scratch it.
- 02** Remove the battery cover and insert 4×1.5V AAA alkaline batteries with correct polarity.

Display Indicators

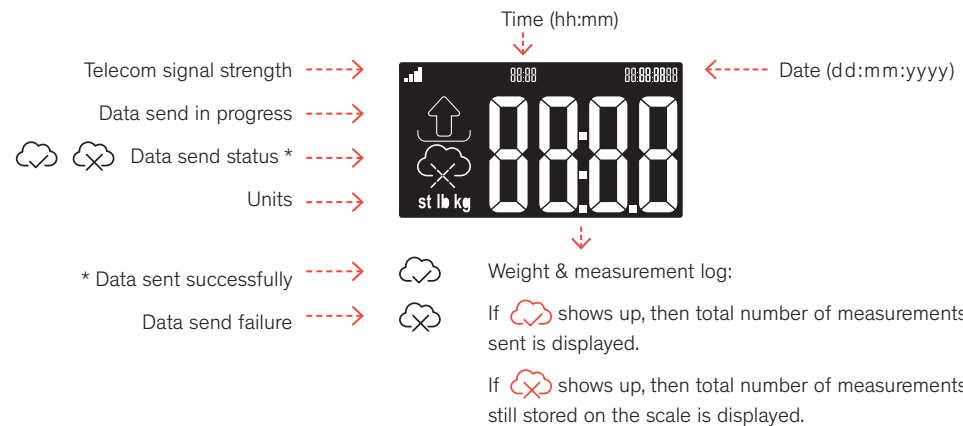

Overload Indicator

ERR

Scale is overloaded (max. 180 kg, 396 lbs, 28.3 st)

Low Battery Indicator

LO

Batteries are low and need to be replaced.

- 01** Remove battery cover.
- 02** Insert batteries.
- 03** Replace battery cover.

2. Operating Instructions

- 01** Place the scale on a hard, flat surface.
- 02** Step on the scale and remain still during measurement.
- 03** When the "data send in progress" indicator is displayed, the data is being sent and you may step off the scale.
- 04** After a period of time, the data send status will be displayed. If it shows a "data send failure", move the scale to a new location and try again.



Notes

- Weight measurements are possible with shoes and socks on.
- Calibration: if you place the body weight scale BC800 3G at new place, quickly step with one on it, until the display turns on. Step off and wait until the calibration gets performed(10-15 seconds)and the display switches off.
- If there is no signal strength indicator and you continue to receive a data send failure, contact your distribution partner.
- user should clean the glass surface before use.
- Please contact tonia@ebmtech.com for troubleshooting and maintenance.

Automatic Shutdown

If no measurement is being taken, the scale will automatically turn off in 10 seconds.



Important Safety Information

- Please read the entire instruction manual and safety precautions before using the Body Weight Scale BC800 3G.
- Unusual measurement values should be discussed with your doctor or health care professional.
- Never change the dosage of any prescribed medications without first consulting your doctor or health care professional.
- Always perform the measurements on a hard and flat surface. Uneven floors may affect the readings.
- If necessary, clean the Body Weight Scale BC800 3G with a damp cloth and a small amount of dishwashing liquid. When the surface is dirty.
- Never immerse the scale in water or rinse it under running water.
- Protect the Body Weight Scale BC800 3G against knocks, moisture, dust, chemicals, drastic changes in temperature and electromagnetic fields.
- Keep the Body Weight Scale BC800 3G away from any sources of heat.
- Never step on the outer edge of the glass. This could cause the scale to tip or damage the glass.
- Keep packaging materials away from children. Store the Body Weight Scale BC800 3G horizontally, not vertically.
- If the measurement appears inaccurate or if the LCD display does not show any figures, please check that the batteries are correctly inserted and the battery contacts are clean.
- If the Body Weight Scale BC800 3G will not be used for an extended period of time, remove the batteries from the Weight Scale BC800 3G and store it properly. Do not store other objects on top of it.
- Please use the device in a dry and clean environment, and place the device on a flat ground before use.
- Do not use hot water, volatile oil or rosin oil to clean the scale.
- Please store at room temperature, keep in a dry and cool place and avoid sun exposure.
- Do not run or jump near the Body Weight Scale BC800 3G.
- This product is applied parts(type BF).No maintenance required during the product life cycle.

- EBM Technologies Inc. will provide circuit diagrams, component part lists, descriptions, calibration instructions to assist to service personnel in parts repair.
- 300 Measurements (Info: the Battery life depends on the used batteries.
- The time required for scale to warm from -25°C between uses until scale is ready for its intended use when the ambient temperature is 20°C is 2 hours.
- The time required for the scale to cool from 40°C between uses until the scale is ready for its intended use when the ambient temperature is 20°C is 2 hours.
- If the degraded sensors and electrodes, or loosened electrodes, that can cause weight measurement failure ,please contact EBM Technologies Inc.
- The waste products and batteries should follow the domestic waste disposal regulation.
Product life expectancy: 5 years
- operation environment:
 - (1) Temperature (°C),/Relative Humidity (%)/Atmospheric Pressure (kPa):
10~40 °C /15~90%RH / 70 kPa ~106 kPa
 - (2) Home healthcare.
- Transportation and storage environment:
 - (1) Temperature (°C),/Relative Humidity (%)/Atmospheric Pressure (kPa):
-25~40°C / 10~95%RH / 70 kPa ~106 kPa

To Avoid Injury

- Only use this device for its intended use and in accordance with the instruction manual.
- Do not use the device if it is damaged in any way.



Warning

- known contraindication: People are equipped with Pace Maker or other implant device shall not use this scale.
- Scale shall not be broke down or maintained in operation.
- Scale release a weak current and it pass through the body. The current may affect electrical product and cause erroneous operation. The failure may become the cause of major accidents.
- Do not use a mobile phone or low frequency therapy device near the Scale.
- Prohibit any modification of the scale, it may cause hazards.

FCC compliance statement

changes or modifications not expressly approved by the party responsible for compliance could void the user's authority to operate the equipment.

This equipment has been tested and found to comply with the limits for a Class B digital device, pursuant to Part 15 of the FCC Rules. These limits are designed to provide reasonable protection against harmful interference in a residential installation. This equipment generates, uses and can radiate radio frequency energy and, if not installed and used in accordance with the instructions, may cause harmful interference to radio communications. However, there is no guarantee that interference will not occur in a particular installation.

If this equipment does cause harmful interference to radio or television reception, which can be determined by turning the equipment off and on, the user is encouraged to try to correct the interference by one or more of the following measures:

- Reorient or relocate the receiving antenna.
- Increase the separation between the equipment and receiver.
- Connect the equipment into an outlet on a circuit different from that to which the receiver is connected.
- Consult the dealer or an experienced radio/TV technician for help.

FCC SAR statement

This equipment complies with FCC radiation exposure limits set forth for an uncontrolled environment. End user must follow the specific operating instructions for satisfying RF exposure compliance. This transmitter must not be co-located or operating in conjunction with any other antenna or transmitter.

The portable device is designed to meet the requirements for exposure to radio waves established by the Federal Communications Commission (USA). These requirements set a SAR limit of 1.6 W/kg averaged over one gram of tissue. The highest SAR value reported under this standard during product certification for use when properly worn on the body.

Specification

Sensors	High precision strain gauge sensors
Maximum Capacity	180 kg / 396 lbs / 28.3 st
Increments	0.1 kg / 0.2 lbs / 0.01 st
Measurements	Weight
Display	White backlight LCD display
Fault indications	Overload and low battery
Data transmission	Over a 3G/2G mobile connection (with Vodafone SIM card inside)
Operating environment	Temperature 10~40°C (50~104°F) Humidity 15 %~90 % RH
Frequency bands	GSM/GPRS/EDGE: Dual band GSM 900/1800MHz UMTS/HSPA+: Dual band UMTS 900/2100MHz
Output power	Class 4 (+33dBm ±2dB) for EGSM900 Class 1 (+30dBm ±2dB) for GSM1800 Class E2 (+27dBm ± 3dB) for GSM 900 8-PSK Class E2 (+26dBm +3 /-4dB) for GSM 1800 8-PSK Class 3 (+24dBm +1/-3dB) for UMTS 2100, WCDMA FDD BdI Class 3 (+24dBm +1/-3dB) for UMTS 900, WCDMA FDD BdVIII
Automatic shutdown	Yes, after 10 seconds

Symbol Description



Indicates the manufacturer's serial number so that a specific medical device can be identified.



Indicates a medical device that needs to be protected from moisture.



Indicates the need for the user to consult the instructions for use.



Indicates the need for the user to consult the instructions for use for important cautionary information such as warnings and precautions that cannot, for a variety of reasons, be presented on the medical device itself.

Hereby, EBM Technologies Inc. declares that the radio equipment type BC800 3Gis in compliance with directive FCC ID (FCC PART 22/24, IEEE 1528, KDB447498), IEC60601-1: 2005+A1: 2012, IEC60601-1-11: 2015, IEC606601-1-2: 2014, 2014/53/EU, 2014/30/EU, 2011/65/EU.

EBM Technologies Inc. declares that the medical device weight scale BC800 3G is listing in FDA(Registered Establishment Number: 3004722076)

**Manufacturer**

EBM Technologies Inc.

5F. No. 516 Sec. 1 Neihu Road Taipei, Taiwan

Distribution by

Medisante' USA, Inc.

Suite 14A, 2077 Center Avenue

+1 973-851-6874

<https://www.medisante-group.com/>

Dennis.lottero@medisante-group.com

Instruction Manual - Version 4, 2020/06

© 2017 Medisanté. All rights reserved.



2AWYXBC800

M+edisanté