

petmomwater

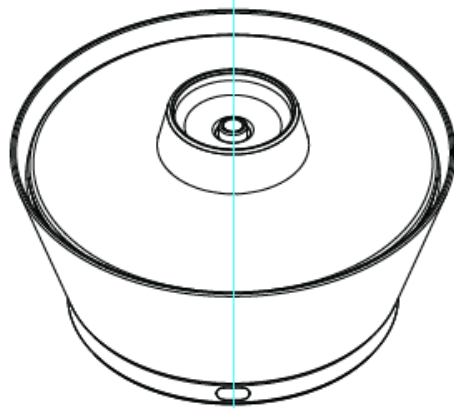

PWF- 500
User's Guide

IoTEC
INTERNET OF THINGS

Refer to **petmom-water** YouTube video

(IoT

EC YouTube) IoTEC YouTube home

You can watch the video below by capturing the QR code or searching for "IoT

EC" on YouTube.

1. **petmom-water** : Unboxing
2. **petmom-water** : Motor Cleaning
3. **petmom-water** : Pre-filter Cleaning
4. **petmom-water** : Cleansing Pottery
5. **petmom-water** : Mode Change

New videos may be added.



Note:

petmom-water may intermittently stop the motor due to the nature of wireless products. It automatically detects this action and resumes operation within 2-3 seconds. This is normal behavior.

Contents

1. How to get started

- 1.1 petmom-water product composition p2
- 1.2 Names of parts of petmom-water p3

2. petmom-water installation and management

- 2.1 Assembling / using petmom-water p4
- 2.2 User's guide p5
- 2.3 How to replace the petmom-water filter p6
- 2.4 petmom-water precautions and user tips p7
- 2.5 How to wash petmom-water p8
- 2.6 Replacement cycle p8

3. Usage notes

- 3.1 Frequently Asked Questions p9, P10
- 3.2 Customer notice p11
- 3.3 Safety precautions p12
- 3.4 Consumer damages compensation and related precautions p12
- 3.5 Copyrights p13
- 3.6 Product specification p13
- 3.7 Warranty p14

1. How to get started

P2

1.1 petmom-water product composition

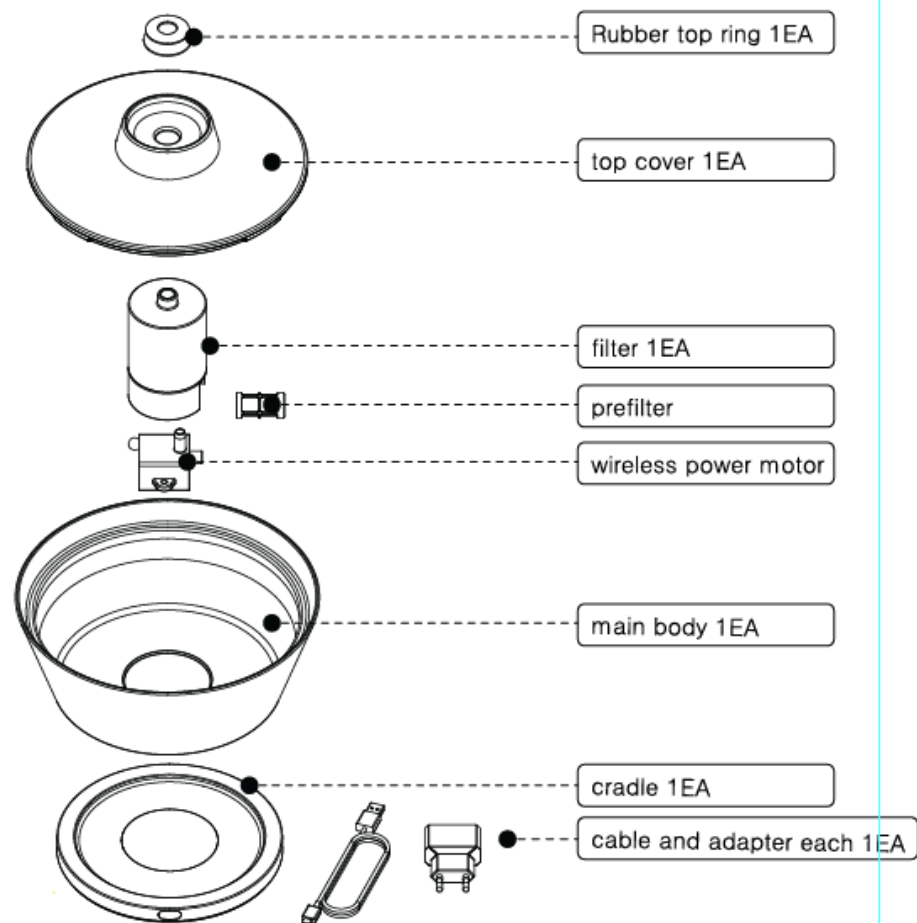

1. How to get started

P3

1.2 Names of parts of petmom-water

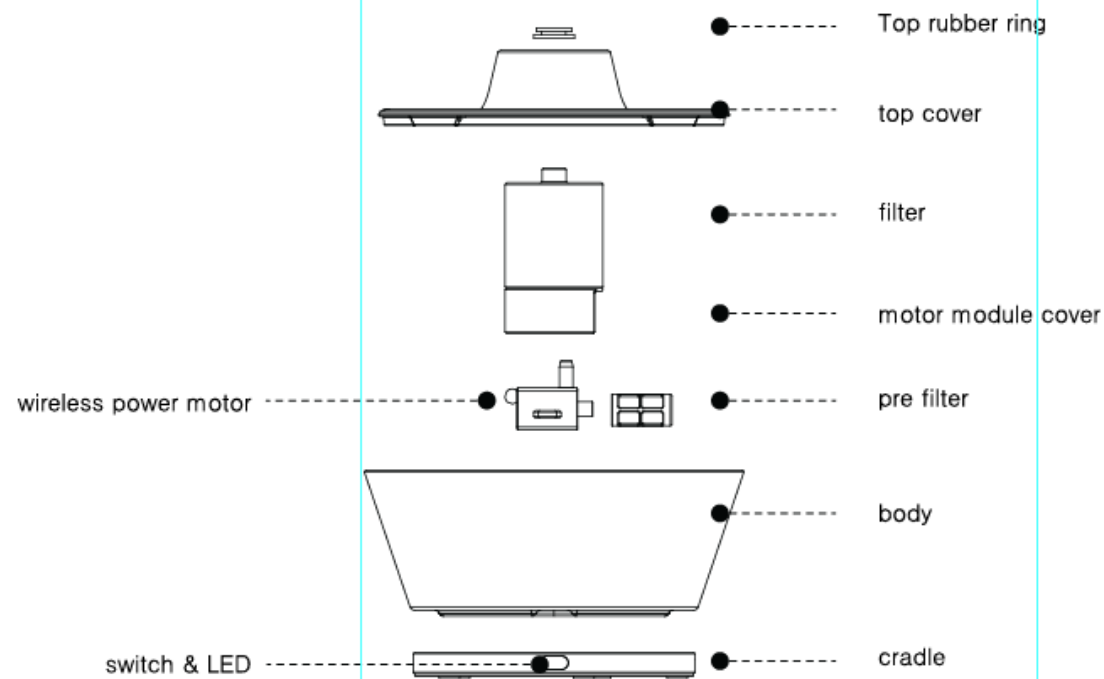

2. petmom-water installation and management

P4

2.1 Assembling / using Pet Mom Water

1) Plug the power adapter cord into the power connection on the bottom of the cradle and place the cradle in the desired position.

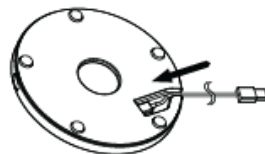

2) Pour water to the bottom of the body of petmom-water and place it on the cradle.



3) Assemble the prefilter and filter to the motor and place them in the designated position in the main body.

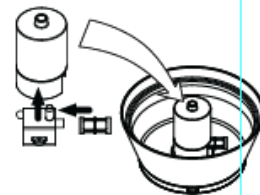

4) Insert the top rubber ring into the hole of the top cover from the bottom of the top plate so that the small circle is upward and place the top plate on the main body.

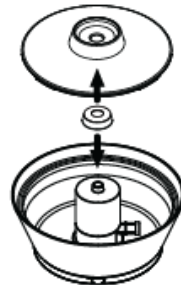

5) Please read the following mode setting method before using petmom-water.

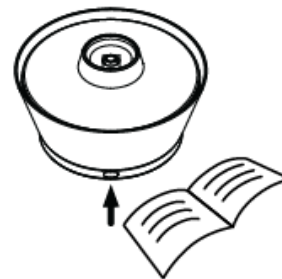

6) Plug the power adapter into the outlet and press the switch to start petmom-water.

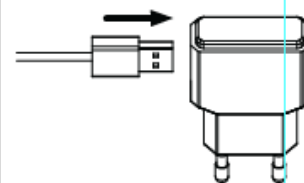

2.petmom-water installation and management

P5

2.2 User's guide

1)Continuous mode:

When the power is turned on, the blue lamp is turned and the motor operates continuously.

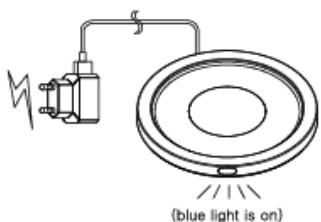

2)Cycle mode:

Press the button once more from the continuous mode to switch to cycle mode. The lamp will turn green and the motor will repeat 2 minutes of operation and 2 minutes of pause.

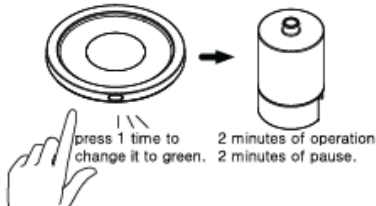

3)Power off status:

Press the button once from cycle mode to turn off the lamp and stop the operation



(press the power button once more to switch it to off mode)

4)Continuous red lamp:

Occurs when motor is out of place or a fault occurs

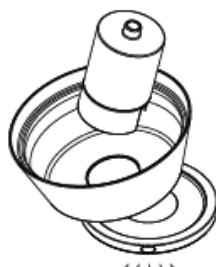

(red light is on)

2.petmom-water installation and management

P6

2.3 petmom-water filter replacement

1)Prefilter can be removed by holding onto the motor module and the prefilter and pulling it to both sides.

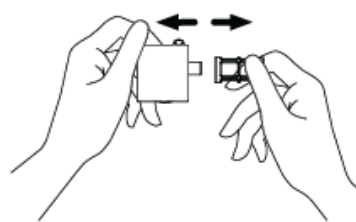

2)Filter can be removed by holding onto the motor module and the filter and pulling it to both sides.

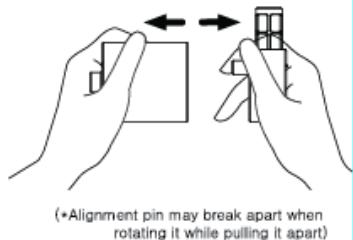

3)Assemble the filter by aligning the guide hole at the top of the motor module with the bottom of the filter and putting the two surfaces in close contact.

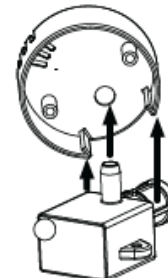

4)After assembling with a new filter, operate it for about 10 minutes, then discard the water and fill it with a new one.



2.petmom-water installation and management

P7

2.4 petmom-water precautions and user tips

1)Please make sure that there is no water on the cradle. If you accidentally spill water, continue using it after wiping it off. Be especially careful to not allow water to touch the power supply.



2) Do not move the cradle that is filled with water. Always move the cradle separately when moving.

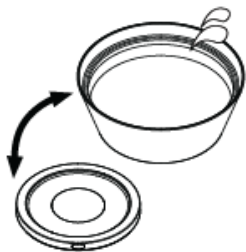

3)The pre-filter filters out foreign substances into the motor, so that the motor is not overwhelmed. Please install it before use.

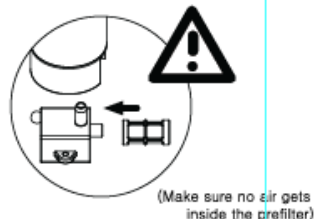

4)Please make sure to place the equipment flat out on the ground. If the bottom is not leveled, water may flow to one side.

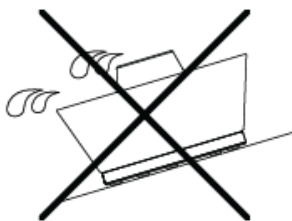

5)Filters that have been opened and used may be contaminated. Please discard them when expired even if they are not used.

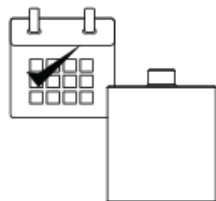

6)Only use it indoors where proper temperature is maintained.

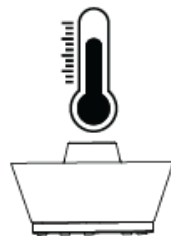

2.petmom-water installation and management

P8

2.5 How to clean petmom-water

Caution! -Do not use harsh scrubbers even for washable parts.

1)petmom-water main body and top cover (detergent can be used): can be cleaned using similar method for cleaning ceramics

2)Top rubber ring (silicon material, detergent can be used): cleaning with detergent is available

3)Pre-filter (detergent can be used): clean with a thin brush

4)Motor module (detergent can be used): wash after disassemble

5)Filter (Don't use detergent!!!): Clean the outside with wet wipes or damp cloth. If detergent enters the filter, the pet can drink the detergent dissolved in water.

2.6 Consumable replacement cycle

1)Filter	-4 weeks
2)Top rubber ring	-Semi-permanent
3)Pre-filter	-Semi-permanent
4)Motor	-In case of failure
5)Body and top cover	-In case of damage

3.Usage notes

P9

3.1Frequently Asked Questions

1) I don't know why dust keeps coming out even after replacing the petmom-water filter.

The filter contains a filter screen and a filter material. When using it for the first time, fine dusts may mix with water. Therefore, when using it for the first time, operate it for 10 minutes according to the filter replacement method, then discard the water and fill it up again.

2) The equipment doesn't work even after turning on the power.

First, check whether the power adapter is properly connected to the cradle. Place the main unit and the motor and filter in the designated positions. If this still doesn't work, please contact IOTEC customer center.

3) What is the water replacement cycle?

Although it is better to change it every day, you can also change water while washing the petmom-water 2-3 times a week. If you have several pets, you should change them frequently.

4) How do I clean the motor?

Since foreign substance is filtered through the pre-filter before water enters the motor, you can either clean the exterior only or disassemble and clean it completely.

5) The water level seems to be low.

petmom-water is designed with a quiet concept. If the water fills the top plate and flows in concentric circles, it is operating normally.

3.Usage notes

P10

3.1Frequently Asked Questions

6) Isn't the bottom of the pottery smooth?

During the pottery manufacturing process, the bottom surface on which the glazed surface is mounted may not be smooth when baking at a high temperature in the kiln. It is normal that the glaze is not even on the top and bottom of the body.

7) Why are bubbles are coming up, and the noise getting louder?

This is a phenomenon in which water and air flow together as the water level drops near the water shortage sensor position. Please add water.

8) The water wouldn't come up even though the green and blue lights are on.

The motor is in its normal position, but it has stopped due to lack of water. Please add water.

3.Usage notes

P11

3.2 Customer Notice

- 1) Do not install near direct sunlight or places with heat.
Water may be contaminated.
- 2) Do not install the product in places with high humidity or moisture or a lot of dust.
There is a danger of electric shock or fire.
- 3) If the product is subjected to excessive force or impact, it may be damaged or broken.
- 4) Pay attention to the handling of the power cord when installing the product.
- 5) Clean at least once a week. When washing, the main body and top cover can be washed like washing dishes. For other parts, refer to 2.4 petmom-water cleaning method.
- 6) Contact with the cradle or power cord may cause malfunction.
- 7) If it is not used for a long time, clean, dry it and store it in a safe place.
It is recommended to discard the used filter.
- 8) It is better to install on the floor. Installation on carpets or furniture may cause water to splash and cause accidents.
- 9) Do not place metal objects on the cradle. It may cause malfunction.
- 10) Do not charge your smartphone with the cradle. Smartphone may malfunction.

3.Usage notes

P12

3.3 Safety precautions

- 1) Do not touch the power cord or plugs with wet hands, and do not handle it with excessive force.
- 2) Protect the pet from chewing the power cord. There is a risk of electric shock.
- 3) Make sure to put it in a place where the pet could not unplug the cord.
- 4) Please use the equipment after ensuring that the pet has been trained to not play with this product.
- 5) Do not expose to dust, heat, direct sunlight or harsh chemicals.
- 6) The use of power adapters not provided by us can have significant impact on product performance and lifespan; therefore safety cannot be guaranteed.
- 7) Do not allow others to disassemble or repair other than IOTEC's repair technicians.
Disassemble, repair or modification by the customer is prohibited as it may cause fire, electric shock and injury. Please contact your dealer or our service center for repair.

3.4 Consumer damages compensation and related precautions

- 1) petmom-water is manufactured under strict quality control and inspection standards.
- 2) The warranty period for this product is one year from the date of purchase.
- 3) Free service (AS, exchange and refund within 7 days) or paid repair is possible if service is needed due to product defects.
- 4) The free warranty period of petmom-water is calculated based on the purchase date.
- 5) Confirmation of purchase date is based on product warranty or product production date (including purchase receipt). (When purchase date is not confirmed, it is calculated 15 months from the date of manufacture)

3.Usage notes

P13

3.5 Copyrights

- 1) This manual and the product are protected by copyright law.
- 2) Unauthorized copying, reproduction or translation of all or any part of this user's manual and products is prohibited without our prior written consent.
- 3) This manual and the product may have typographical or technical errors that may change without notice.
- 4) In case of using this product, we shall not be liable for any damages caused by use other than the purpose and method described in this manual.
- 5) Free repair is not supported if the product is broken by unauthorized disassembly.

3.6 Product specifications

Product name	petmom-water purifier
model name	PWF-500
rated voltage	DC-5V
power consumption	5W
water bowl capacity	2L
weight (excluding packaging)	1.8Kg
product size	250*250*150(mm)
manufacturer	Republic of Korea
manufacturer	IOTEC

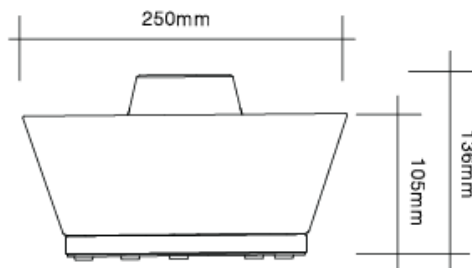

3.Usage notes

P14

3.7 Warranty

Product Name	petmom-water
Model name	PWF-500
Purchasing place	
Purchase date	
Customer name	
Customer phone	
Customer address	

Warranty is one year from the date of purchase

- 1) This warranty is guaranteed in accordance with the petmom-water Consumer Compensation Guideline in Korea.
- 2) In case of malfunction within the warranty period, please contact the customer center.
- 3) If there is no product warranty, repairs will be made for a fee even if the warranty period remains.
- 4) If it is not a malfunction, please be sure to read this manual carefully since service and delivery costs will be charged when service is requested.
- 5) Free purchase service is not available if the place of purchase and purchase date are not listed. In this case, it can be replaced with a receipt at the time of purchase.
- 6) We will notify you of compensation and contents notification according to consumer damage compensation notice within 7 working days.
- 7) You can record your personal information and consultation contents described in this warranty and use them for history management and after sales service. Apart from justifiable reasons (such as courier delivery), it will not be provided to third parties.

Customer Service : Please contact Customer Service for AS inquiry.
 Counseling number : 02-6673-0114
 Opening hours : Weekdays AM 09:00 - PM 05:30
 (Closed on Saturdays, Sundays and Public Holidays)
 Center address : 802 Mario Tower, 28, Digital-ro 30-gil, Guro-gu, Seoul
 Email : info@iotec.kr
 Homepage : www.iotec.kr

FCC Information to User

This equipment has been tested and found to comply with the limits for a Class B digital device, pursuant to Part 15 of the FCC Rules. These limits are designed to provide reasonable protection against harmful interference in a residential installation. This equipment generates, uses and can radiate radio frequency energy and, if not installed and used in accordance with the instructions, may cause harmful interference to radio communications. However, there is no guarantee that interference will not occur in a particular installation. If this equipment does cause harmful interference to radio or television reception, which can be determined by turning the equipment off and on, the user is encouraged to try to correct the interference by one of the following measures:

- Reorient or relocate the receiving antenna.
- Increase the separation between the equipment and receiver.
- Connect the equipment into an outlet on a circuit different from that to which the receiver is connected.
- Consult the dealer or an experienced radio/TV technician for help.

Caution

Modifications not expressly approved by the party responsible for compliance could void the user's authority to operate the equipment.

FCC Compliance Information : This device complies with Part 15 of the FCC Rules. Operation is subject to the following two conditions: (1) This device may not cause harmful interference, and (2) this device must accept any interference received, including interference that may cause undesired operation.

IMPORTANT NOTE:

FCC RF Radiation Exposure Statement:

This equipment should be installed and operated with a minimum distance of 20 centimeters between the radiator and your body. This transmitter must not be co-located or operating in conjunction with any other antenna or transmitter.

