

1. Product Appearance

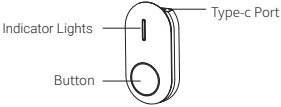

Indicator Light Status	
Indicator Light	Mini Remote
No light	Powered off, sleeping, or fully charged
Blinking green	Powering on/off, pairing with the camera, or taking a photo
Solid green	Successfully paired with the camera
Solid red	Charging
Blinking red	shooting a video
Blinking yellow	Low battery

2. Charging

Connect the Type-C port of the Mini Remote with a 5V/1A power adapter for charging, and it will be fully charged in about 1.5 hours.



3. Installation

- Attach the Mini Remote to the Flip Stick (sold separately) .
After removing the decorative cover on the Flip Stick, place the Mini Remote in the direction shown below.

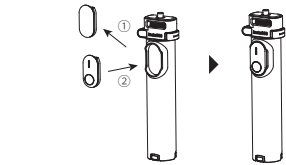

- Attach the Mini Remote to the remote mount

Open the plug on the remote mount, push the Mini Remote into the remote mount, and then cover the Type-C port on the Mini Remote with the plug.

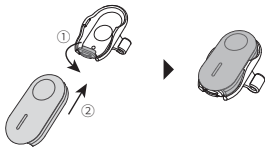

Choose a suitable strap, hang it on the hook on one side of the mount, bypass objects such as the selfie stick or handlebars, and then hang it on the hook on the other side to fix the Mini Remote.

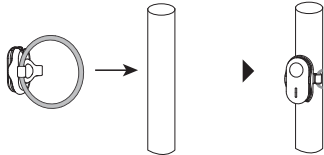

4. How to Use

Power on / off

When powered off, long press the button for 3 seconds to turn

on the remote.

When powered on and with the camera disconnected, long press the button for 3 seconds to turn off the remote.

When powered on and with the camera connected, long press the button for 3 seconds to turn off the camera, at this time press the Mini Remote's button once to wake up the camera and the camera enter the shooting status (the camera turns on quick capture); long press the button for 6 seconds to turn off both.

Connecting the camera

Turn on the Remote. Turn on the camera, click "Insta360 Mini Remote" on the camera's Bluetooth Remote interface. When the camera's screen displays Connected, it has been paired successfully. The Mini Remote's indicator light will keep solid green.

Wake up the Camera

After the camera is successfully connected for the first time, the "Quick Shooting" function is enabled in the camera, and the remote control can wake up the camera when the camera is shut down.

- When the remote control is turned on, press the remote control once to wake up the camera and automatically enter the recording state.
- When the remote control is off, long press 3s to turn on the remote control, and then press the remote control once to wake up the camera and automatically enter the recording state.

Note: After waking up the camera to start recording, wait a moment, the remote control can automatically connect with the camera via Bluetooth.

Take photos or videos

After the Mini Remote is connected to the camera, press the button to take a photo or start recording, then press the button again to stop recording.

Video marking

When the remote controls camera recording videos, long press its button for more than or equal to 1s and then release it to make the video highlight mark.

Important:

- Be sure that your camera's firmware has been updated to the latest official version.
- The remote can be used up to 26.2ft (8m) for effective preview and 65.6ft (20m) for effective control in optimal conditions.
- For support of cameras, please stay tuned for Insta360's official website and its future firmware updates of the remote.
- After the first successful pairing, the Mini Remote can wake up the camera directly without repeating the connection steps the next time you use it.

5. Specifications

Model: CINSCAVV	
Diameter of the straps	4cm, 5cm
Battery	Capacity:60mAh
	Energy: 0.222Wh
	Type: Li-ion
Charging environment	0°C ~ 45°C
Work environment	-10°C ~ 45°C
Store environment	-5°C ~ 35°C
Input	DC 5V/1A
Bluetooth	Protocol: 5.0
	O p e r a t i o n F r e q u e n c y :
	2402~2480MHz
Output Power (E.I.R.P.) <10dBm	

Safety Information

- The Mini Remote contains magnets. Keep it away from pacemakers and other devices to avoid interference.
- The Mini Remote is suitable for multiple Insta360 cameras, such as Insta360 X3, X4, Ace, Ace Pro, etc.
- The product should be used in temperatures from 14°F to 104°F (-10°C to 40°C), humidity 0-75%.
- The product is spillproof. If it is splashed, dry it as soon as possible.
- Ensure that the Type-C port is free of water. If it sticks to water, clean it with a soft dry cloth.
- If the product is not used for a long time (e.g. 2 months or longer), the battery may be depleted. Please charge the product fully, then turn it on.
- Do not drop or strike the product. Do not place heavy objects on the product, as this will cause damage.
- Do not use any liquid cleansers on the product. Do not wipe the charging points on the remote with liquid detergent, as these may corrode and rust, affecting the remote. Only use soft dry cloth to clean the product.

Disclaimer

Please read this Disclaimer carefully. Using this product means that you acknowledge and accept the terms of this disclaimer. By using this product, you hereby acknowledge and agree that you are solely responsible for your own conduct when using this product and any consequences thereof. You agree to use this product only for proper and lawful purposes. You understand and agree that Arashi Vision Inc. (hereinafter referred to as "Insta360") accepts no liability for any and all misuse, consequences, damages, injuries, penalties, or any other legal responsibility directly or indirectly incurred by your using this product and associated accessories. Before every use, make sure that your accessories are functioning properly. If there's any damage or irregularity, stop using them immediately. Within the scope of state laws and regulations,

Insta360 reserves the right of final explanation and revision for the commitment.

FCC Statement

This equipment has been tested and found to comply with the limits for a Class B digital device, pursuant to Part 15 of the FCC Rules. These limits are designed to provide reasonable protection against harmful interference in a residential installation. This equipment generates uses and can radiate radio frequency energy and, if not installed and used in accordance with the instructions, may cause harmful interference to radio communications. However, there is no guarantee that interference will not occur in a particular installation. If this equipment does cause harmful interference to radio or television reception, which can be determined by turning the equipment off and on, the user is encouraged to try to correct the interference by one or more of the following measures:
-- Reorient or relocate the receiving antenna.
-- Increase the separation between the equipment and receiver.
-- Connect the equipment into an outlet on a circuit different from that to which the receiver is connected.
-- Consult the dealer or an experienced radio/TV technician for help.

This device complies with part 15 of the FCC Rules. Operation is subject to the following two conditions:
(1) This device may not cause harmful interference, and (2) this device must accept any interference received, including interference that may cause undesired operation.

Changes or modifications not expressly approved by the party responsible for compliance could void the user's authority to operate the equipment.

The device has been evaluated to meet general RF exposure requirement. The device can be used inportable exposure condition without restriction.

IC Statement

This device complies with Industry Canada's licence-exempt RSSs. Operation is subject to the following two conditions:

- (1) This device may not cause interference; and
- (2) This device must accept any interference, including interference that may cause undesired operation of the device.

The device has been evaluated to meet general RF exposure requirement. The device can be used in portable exposure condition without restriction.

Le présent appareil est conforme aux CNRd'Industrie Canada applicables aux appareils radio exempts de licence. L'exploitation est autorisée aux de ux conditions suivantes:

- (1) l'appareil ne doit pas produire de brouillage, et
- (2) l'utilisateur de l'appareil doit accepter tout brouillage radioélectrique subi, même si le brouillage est susceptible d'en compromettre le fonctionnement.

L'appareil a été évalué pour répondre aux exigences générales en matière d'exposition aux RF. Le dispositif Peut être utilisé en condition d'exposition portable sans restriction.

After-Sales Service

The warranty period of the attached product is 3 months from the original retail purchase. Warranty service may vary according to the applicable laws of your state or jurisdiction. For detailed warranty policies, please visit <https://insta360.com/support>