

J8 Ear Phones

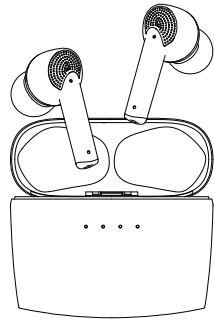

User manual

1、Product Function introduction

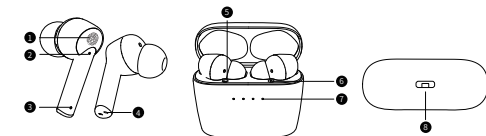

- 1 Multi-touch point
- 2 Display light/microphone
- 3 Microphone
- 4 Earphone charging contact
- 5 Left ear logo
- 6 Right ear logo
- 7 Battery indicator
- 8 Type-C charging interface

2、Packaging accessories

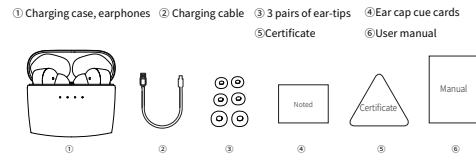

3、Instructions for headset touch operation

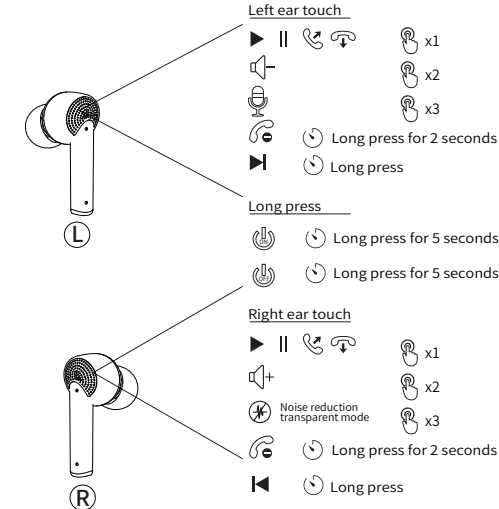

4、Earphone connection instructions

A. Singles-ear mode: take out a earphone.
B. Binaural mode: first turn off the BT device and take out the earphone. Touch (L) left ear 2 times and wait for 3-5 seconds, when both earphones flash blue lights, the match is successful(Please refer to the index below for specific operations)

01 Headset pairing

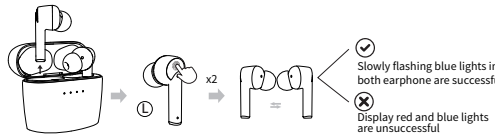

02 Connection

- a. Device connection: Open your phone or other device, search for "J8", and click Connect.
- b. The left and right earphones can be connected separately.

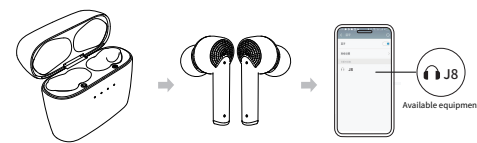

03 Turn it off

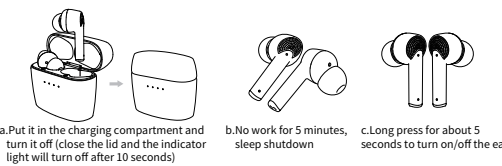

5、Charging instructions

01 Unilateral headset charging

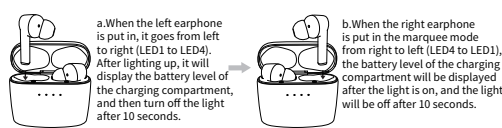

02 Charge both left and right ears simultaneously

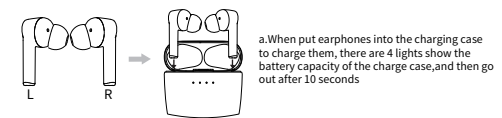

03 Charging in the charging compartment

a. After opening the lid, the four lights will gradually light up at the same time, and then display the charge compartment battery level. After 10 seconds, the lights will go out.
b. When the charging compartment uses the data cable to charge, from the left to the right (LED1 to LED4), each light is 25% of the power, and it is fully on. When the charging cable is unplugged, it turns on for 10 seconds and then turns off.

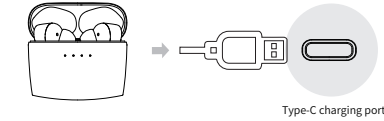

7、The basic parameters

Product name	J8	Playing time	4-5hours
BT	5.2+EDR	Frequency	2.4GHZ
Connection distance	15m	Impedance	32Ω
Charging time	about 1 hour	Standby time	7-10days
Input	5V-1A	Battery capacity	50/500mah
Talking time	3-4hours	Noise reduction depth	33-38dB

8、Matters needing attention

- Please make sure the product is fully charged before the first use;Or charge it first.
- Please use a brand charger or computer USB to charge the headset (note: 5V-1A charger).
- Stay away from WiFi and routers and other high frequency transmitting devices, which may affect the signal reception of the unit and cause the phenomenon of sound blocking and disconnection.
- Please use the product in an effective environment (15m) and there should be no physical barriers (such as walls, etc.) between the BT device and the headset.
- Please refer to Item 4 when there is no sound on one side of the earphone and the pairing of two ears is not successful(headset connection instructions) pair and connect the headset again, and the product will work normally after reconnection!

⚠ Safety warning

- Please ensure that the product is not used or stored in high temperature or humid environment to avoid affecting the product performance.
- Do not drop or drop the product from high altitude to avoid damage.
- Please contact manufacturer if there is any product problem, and don't disassemble the product for repair.

Thanks for buying our J8 TWS earphone which comes with wireless stereo, left and right channel separation and HiFi sound functions. And It can be used alone or in pairs. We welcome your suggestions and comments on our products and services!

Note:

This equipment has been tested and found to comply with the limits for a Class B digital device, pursuant to Part 15 of the FCC Rules. These limits are designed to provide reasonable protection against harmful interference in a residential installation. This equipment generates, uses and can radiate radio frequency energy and, if not installed and used in accordance with the instructions, may cause harmful interference to radio communications.

However, there is no guarantee that interference will not occur in a particular installation. If this equipment does cause harmful interference to radio or television reception, which can be determined by turning the equipment off and on, the user is encouraged to try to correct the interference by one or more of the following measures:

- Reorient or relocate the receiving antenna.
- Increase the separation between the equipment and receiver.
- Connect the equipment into an outlet on a circuit different from that to which the receiver is connected.
- Consult the dealer or an experienced radio/TV technician for help.

Warning: Changes or modifications to this unit not expressly approved by the part responsible for compliance could void the user's authority to operate the equipment.

FCC Radiation Exposure Statement

This equipment complied with FCC radiation exposure limits set forth for an uncontrolled environment. This equipment should be installed and operated with minimum distance 0cm between the radiator & your body.