



SECTOR SELECTOR

PRODUCT & INSTALLATION **GUIDE**



TABLE OF CONTENTS

SECTOR SELECTOR 3

ACCESSORIES 5

ASSEMBLY INSTRUCTIONS..... 6

PROGRAMMING INSTRUCTIONS..... 15

FCC CAUTION
This device complies with Part 15 of the FCC. Operation is subject to the following two conditions: (1) this device may not cause harmful interference, and (2) this device must accept any interference received, including interference that may cause undesired operation. Any changes or modifications not expressly approved by the party responsible for compliance could void the user's authority to operate the equipment.

NOTE:
This equipment has been tested and found to comply with the limits for a Class B digital device, pursuant to Part 15 of the FCC Rules. These limits are designed to provide reasonable protection against harmful interference in a residential installation. This equipment generates uses and can radiate radio frequency energy and, if not installed and used in accordance with the instructions, may cause harmful interference to radio communications. However, there is no guarantee that interference will not occur in a particular installation. If this equipment does cause harmful interference to radio or television reception, which can be determined by turning the equipment off and on, the user is encouraged to try to correct the interference by one or more of the following measures:
—Reorient or relocate the receiving antenna.
—Increase the separation between the equipment and receiver.
—Connect the equipment into an outlet on a circuit different from that to which the receiver is connected.
—Consult the dealer or an experienced radio/TV technician for help.

MPE REMINDER
To satisfy FCC RF exposure requirements, a separation distance of 20 cm or more should be maintained between the antenna of this device and persons during device operation. To ensure compliance, operations at closer than this distance is not recommended.

SECTOR SELECTOR

2022 
NEW PRODUCT
CONTEST Winner
Irrigation Association

GOLD | Landscape Lighting Category



Part Number:
BRI-SECTOR-SELECTOR

DESCRIPTION

Use the Brilliance Sector Selector to create specific zones that can be controlled independently from a single transformer. The Sector Selector can split a single transformer into four separate zones with up to 200 watts to each zone.

You can use zones to separate lighting schedules and scenarios to create special scenes or layers of light in your landscaping. For example, you can separate the front yard from the back yard, or use zones to independently control lighting for water/architectural features, outdoor kitchens, pool and spa areas, outdoor decks or seating areas, or path and garden lighting.

NEC* Article 411.5 (B): Lighting systems shall be installed not less than 3m (10ft) horizontally from the nearest edge of the water, unless permitted by Article 680. This product shall be used in conjunction with low voltage landscape lighting system evaluated by UL1838, with maximum output current 25A.



**FAILURE TO FOLLOW
INSTRUCTIONS WILL
VOID WARRANTY**

SECTOR SELECTOR

FEATURES

- Compatible with any transformer and works on AC/DC
- Create up to four zones on a single transformer, with up to 200 Watts per sector, and manage with the Brilliance Smart App
- Fitted with two 3/4" PVC conduit adapters to accommodate four 12-2 AWG cables
- Installs on the low-voltage side of magnetic transformer
- Includes: Sector Selector Enclosure; (4) Enclosure Mounting Tabs with Screws; (4) Exterior Mounting Anchors with Screws; High Range Antenna; (20) U Connectors; (2) Terminal Covers; Sector Chart; Product and Installation Guide

SECTOR SELECTOR SPECS

| | |
|------------------|----------------|
| Wattage | 200 per Sector |
| Input Voltage | 12-24VAC/DC |
| Capacity | 800W |
| Minimum Load | None |
| IP | 65 |
| Warranty (years) | 3 |

12 to 24 vac, 50/60hz, max. 20a each way; 12 to 24 vdc, 50/60hz, max. 20a each way. resistive, type 1.b, class iii, micro-disconnection, 10000 cycles (m), pti: 175v, pollution degree 2, rated impulse voltage: 0.33kv, overvoltage category: i, raintight.

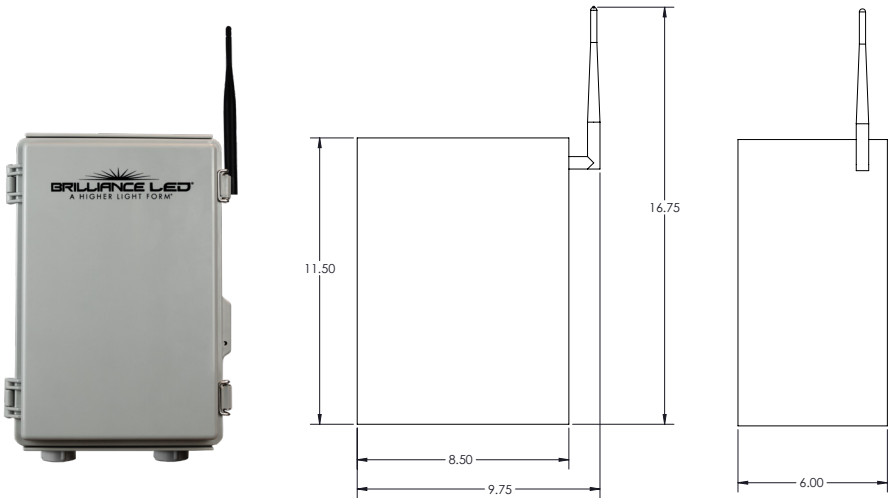

WIRING DIAGRAM

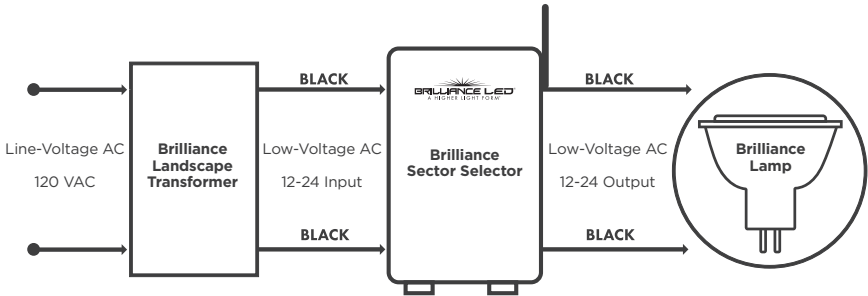

INCLUDED ACCESSORIES

(4) Mounting Anchors with Screws



(1) Antenna



(2) Terminal Covers



(4) Mounting Tabs with Screws



(20) U Connectors



INSTALLATION AND OPERATIONAL REQUIREMENTS: Be sure that the transformer is powered off. The Sector Selector door must be closed and latched during operation. Before installing lamps, ensure the transformer is turned off. Hotplugging lamps may cause electrical overstress. This product shall be used in conjunction with low voltage landscape lighting system evaluated by UL1838, with maximum output current 25A.

TECHNICAL REQUIREMENTS: Must have consistent 2.4 GHz Wi-Fi signal at the installation location with dBm strength of -70 or better. See the Brilliance Smart Products Guide for more information and troubleshooting regarding the Brilliance Smart App.

ASSEMBLY INSTRUCTIONS

1. Using a Philips screwdriver and the mounting tab screws provided, attach the mounting tabs to each cabinet corner in a horizontal position.

Position the flat side of Hole A against the Sector Selector and secure the screw into the recessed side of Hole A so it is flush with the edge of the cabinet. See Figure A.

A

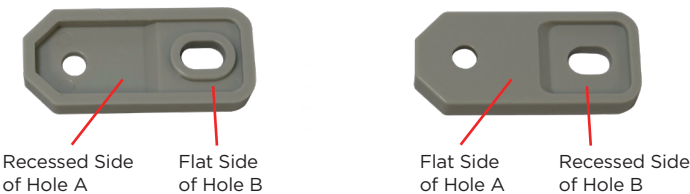

The mounting tabs have two holes and two sides.

Hole A is used to secure the mounting tab to the Sector Selector.

Hole B is used to secure the mounting tab and connected Sector Selector to the installation location.

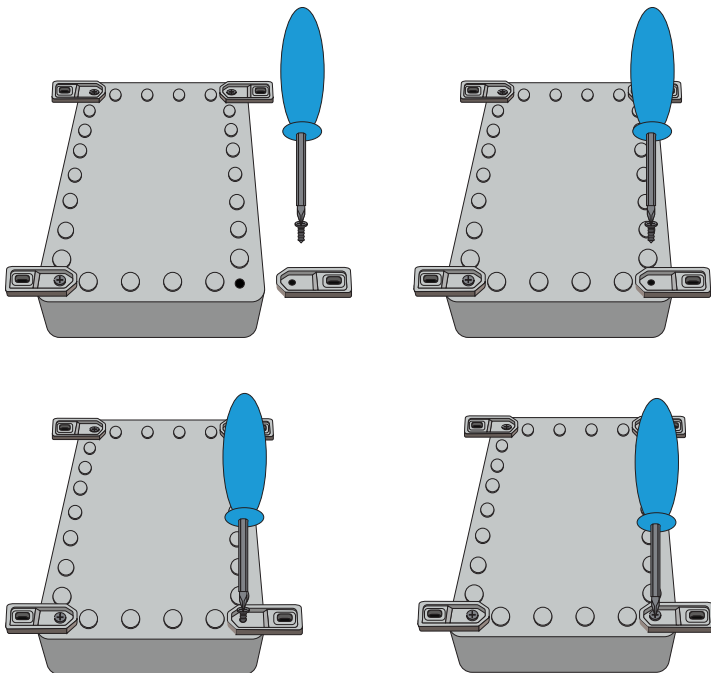

CONTINUED

2. Locate the Antenna Port on the right side of the unit, and thread the antenna onto the port.

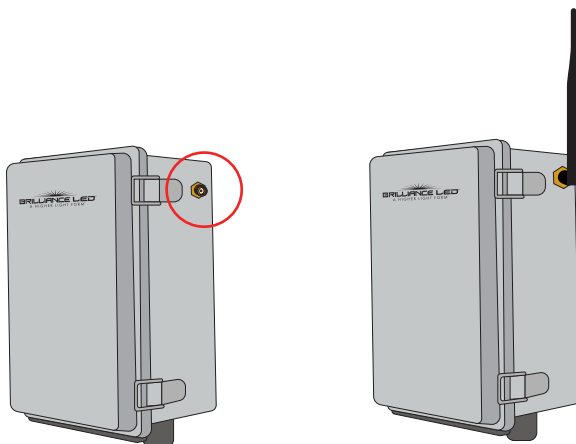

3. Use a torpedo level and mark the tab holes on the wall.

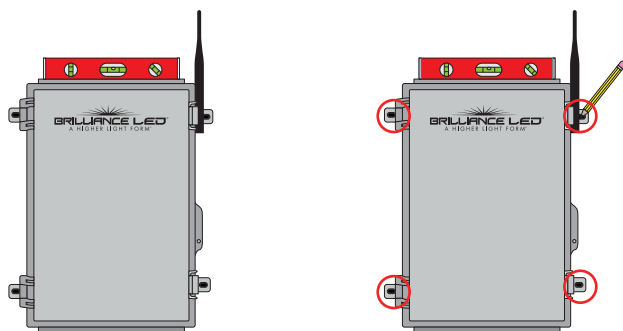

4. Use a 1/4" drill bit for the pilot holes. Use the Mounting Anchors and Screws provided to mount the Sector Selector to the surface.

CONTINUED

NOTE: The Brilliance Sector Selector is fitted with 2-3/4" PVC conduit adapters and will accommodate four 12-2 AWG cables.

5. Pull the input cables from the transformer into the left input side of the Brilliance Sector Selector.

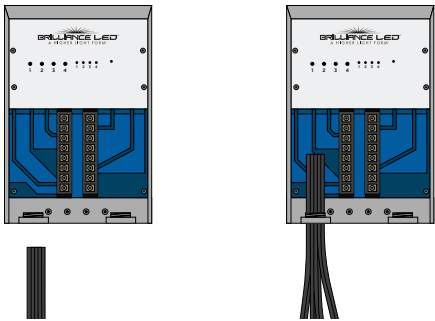

6. Pull the output cables into the right output side of the Brilliance Sector Selector.

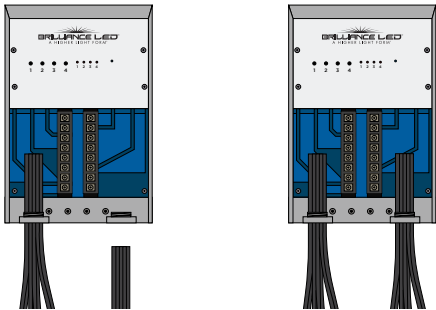

7. Strip each 12-2 cable 1/4 inch.

