

Quick Start Guide for C190SHP, C190POS, C190DSK – Page 1

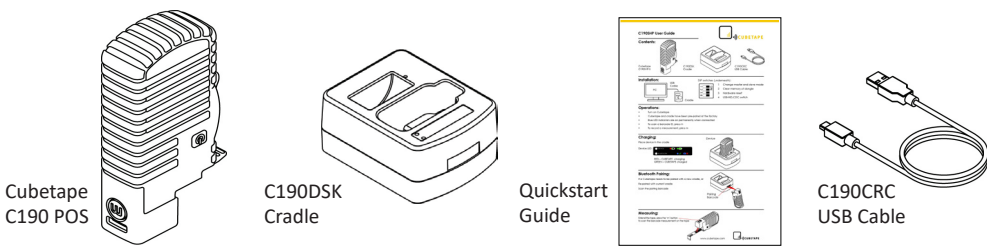

Contents of C190SHP:



Installation:

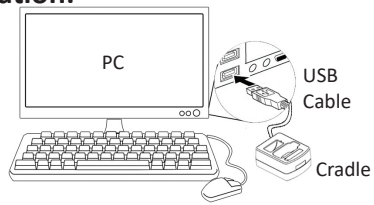

DIP switches beneath cradle:

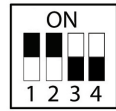

	OFF	ON	DEFAULT
RESERVED	--	--	OFF
COMMS MODE	USB-VPC	USB-HID	ON
RESERVED	--	--	OFF
RESERVED	--	--	OFF

Powering On/Off and Bluetooth Pairing:

- Power on Cubetape by pressing and holding m button for 3 seconds
- Power off Cubetape by pressing and holding m button for 6 seconds
- To pair with cradle, scan the pairing barcode on the front of the cradle
- Connection is successful when the Blue LED indicators on Cubetape and the cradle are permanently ON. If the Blue LED indicators continue to flash, re-scan the Bluetooth pairing barcode on the cradle.
- Cubetape will remain ON while it has an active Bluetooth connection, otherwise it will power OFF after around 3 minutes

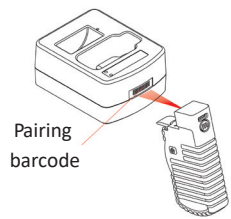

Operations and Measuring:

Extend the tape, press the 'm' button to scan the barcode measurement on the tape

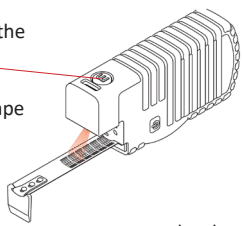

- Blue LED indicators are on permanently when connected
- To scan a barcode ID, press 'm'

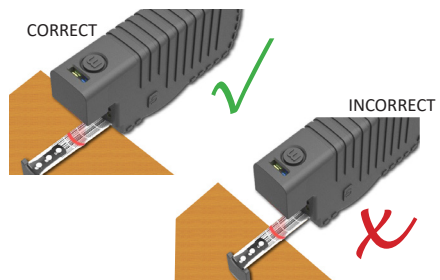

Quick Start Guide for C190SHP, C190POS, C190DSK – Page 2

Charging:

Place device in the cradle
Low battery warning will signal with Q-) and LED on cubetape will be solid when charging

Device LED



RED \ V - CUBETAPE charging
k-) \ 77' #y" - u" h-'

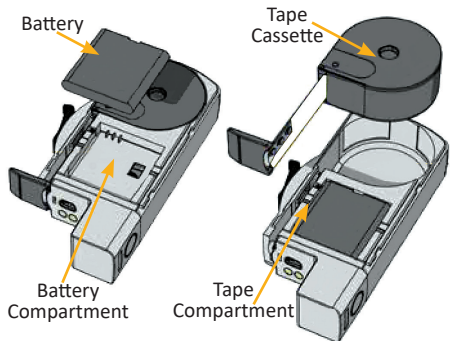
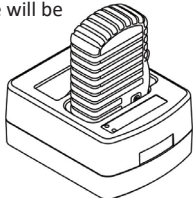

C190POS General Settings



Bluetooth Cradle Mode (Default)



Bluetooth SPP Mode



Bluetooth HID Mode



Bluetooth Reset



Suffix TAB (Default)



Suffix CR



Off floor or Inside Measure ON



FCC STATEMENT :

This device complies with Part 15 of the FCC Rules. Operation is subject to the following two conditions:

- (1) This device may not cause harmful interference, and
- (2) This device must accept any interference received, including interference that may cause undesired operation.

Warning: Changes or modifications not expressly approved by the party responsible for compliance could void the user's authority to operate the equipment.

NOTE: This equipment has been tested and found to comply with the limits for a Class B digital device, pursuant to Part 15 of the FCC Rules. These limits are designed to provide reasonable protection against harmful interference in a residential installation. This equipment generates uses and can radiate radio frequency energy and, if not installed and used in accordance with the instructions, may cause harmful interference to radio communications. However, there is no guarantee that interference will not occur in a particular installation. If this equipment does cause harmful interference to radio or television reception, which can be determined by turning the equipment off and on, the user is encouraged to try to correct the interference by one or more of the following measures:

- Reorient or relocate the receiving antenna.

- Increase the separation between the equipment and receiver.

- Connect the equipment into an outlet on a circuit different from that to which the receiver is connected.

- Consult the dealer or an experienced radio/TV technician for help.

FCC Radiation Exposure Statement:

This equipment complies with FCC radiation exposure limits set forth for an uncontrolled environment. This equipment should be installed and operated with minimum distance 20cm between the radiator & your body.

- English: "

This device complies with Industry Canada licence-exempt RSS standard(s). Operation is subject to the following two conditions:

- (1) this device may not cause interference, and
- (2) this device must accept any interference, including interference that may cause undesired operation of the device."

- French:"

Le présent appareil est conforme aux CNR d'Industrie Canada applicables aux appareils radio exempts de licence. L'exploitation est autorisée aux deux conditions suivantes :

- (1) l'appareil nedit pas produire de brouillage, et
- (2) l'utilisateur de l'appareil doit accepter tout brouillage radioélectrique subi, même si le brouillage est susceptible d'en compromettre le fonctionnement."