

*Win Smart Illumination
via Innovation*

MustWin

Smart RGBCW LED Spotlight

Smart RGBCW LED Spotlight

THANK YOU for choosing MustWin. To optimize user experience, please install and use the light according to the following instruction.

Set-up is easy and takes only a few minutes by following the instructions.

The smart spotlight can work with both Amazon Alexa and Google Assistant. But the light after being installed will need to be paired with an app called 'Smart Life' first, and then the Smart Life app will need to be bound with either Amazon Alexa or Google Assistant to activate the voice control function.

Therefore, this manual consists of four parts. Part one and two are fundamental set-up, while part three and four are alternatives. If you use Amazon Alexa for voice control, please follow instructions on part one, two and three. If you use Google Assistant for voice control, please skip part three, follow the instructions on part one, two and four.

Part One

How to install the spotlight? 2 - 8

Part Two

How to pair the spotlight to Smart Life app? 9 - 19

Part Three

How to control the spotlight with Amazon Alexa?20 - 22

Part Four

How to control the spotlight with Google Assistant?23 - 24

Part One - How to install the spotlight?

Warning

- (1) Please check if the light and the parts are intact before installation.
- (2) Make sure to cut off power before installation.
- (3) Please do not place this light in corrosive conditions.
- (4) If there is any damage to the cord, please cut off the power and stop using it immediately.
- (5) Please do not retrofit the light within the warranty period.
- (6) To ensure the light works properly, please use the voltage indicated on the packing.
- (7) To avoid any damage to the light, please do not use chemical solvent during routine maintenance.
- (8) Please do not shoot the light directly to the eyes.
- (9) Please do not immerse the whole light into water.
- (10) In case of explosion, please keep the light away from fire and high temperature.
- (11) If any component of this light needs to be replaced, please choose those of the same specification.

1. Specification

SKU	MWS01RGBCW-US-A MWS01RGBCW-UK-A MWS01RGBCW-EU-A	MWS01RGBCW-US-B MWS01RGBCW-UK-B MWS01RGBCW-EU-B
Bluetooth Hub	Included	Not included
Input	AC100-240V 50/60Hz Max 1.0A	
Wattage	60W	
Model Number	MWS01	
Color	RGBCW	
Waterproof	IP65	
Beam Angel	60°	
LED	3030LEDs	
Dimming	Yes	
Control	Bluetooth control	
Power Apater & Cable	Included	
ta	-25°C - 40°C	

2. Components

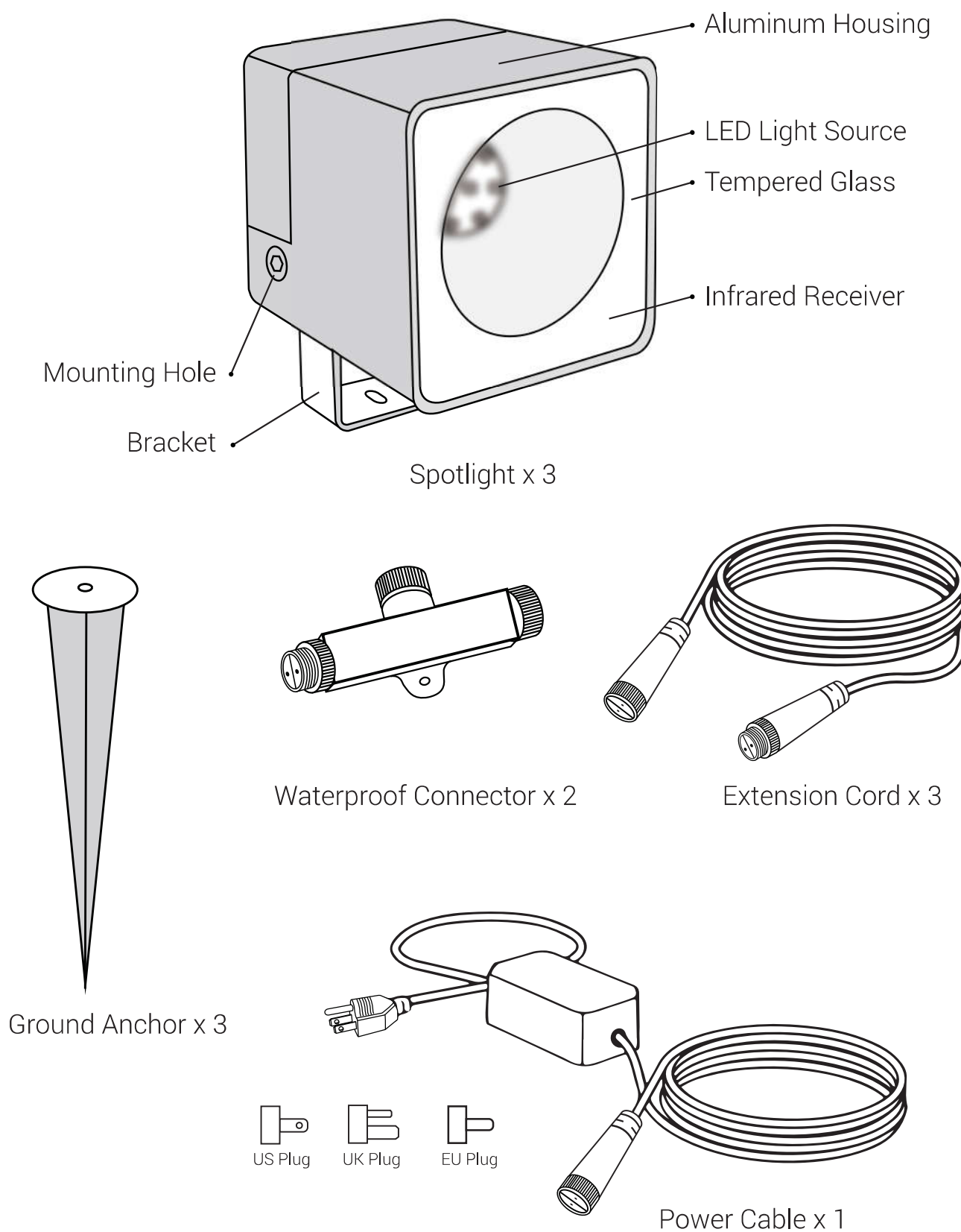

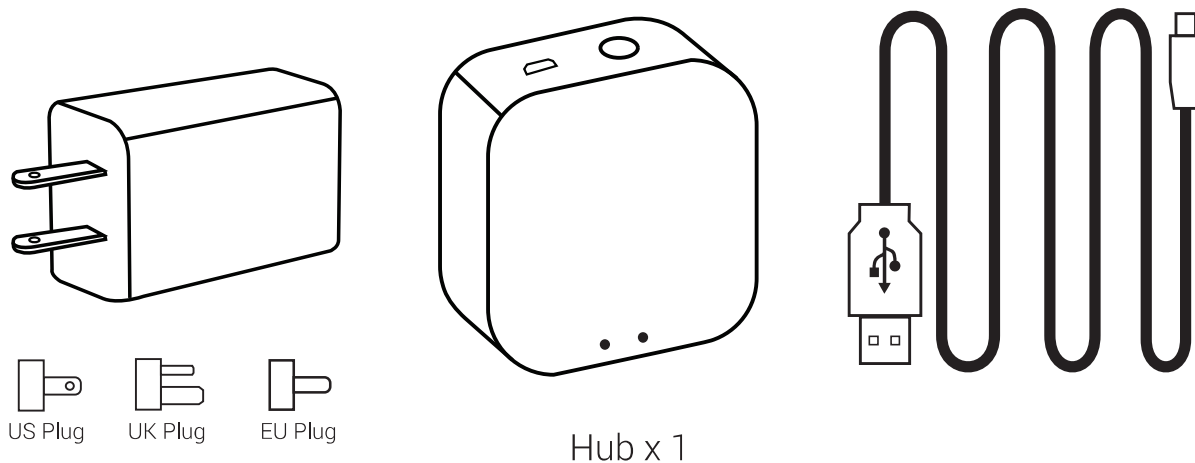

**** Only MWS01RGBCW-US-A, MWS01RGBCW-UK-A, MWS01RGBCW-EU-A includes a hub.
MWS01RGBCW-US-B, MWS01RGBCW-UK-B, MWS01RGBCW-EU-B doesn't include a hub.**

Not included

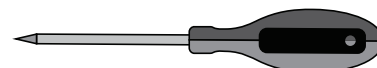
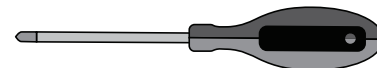
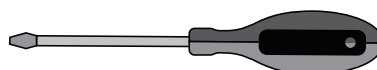
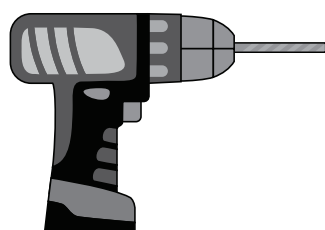

Note: Cord - type Y attachment.

For type Y attachment: If the external flexible cable or cord of this luminaire is damaged, it shall be exclusively replaced by the manufacturer or his service agent or a similar qualified person in order to avoid a hazard.

3. Dimension

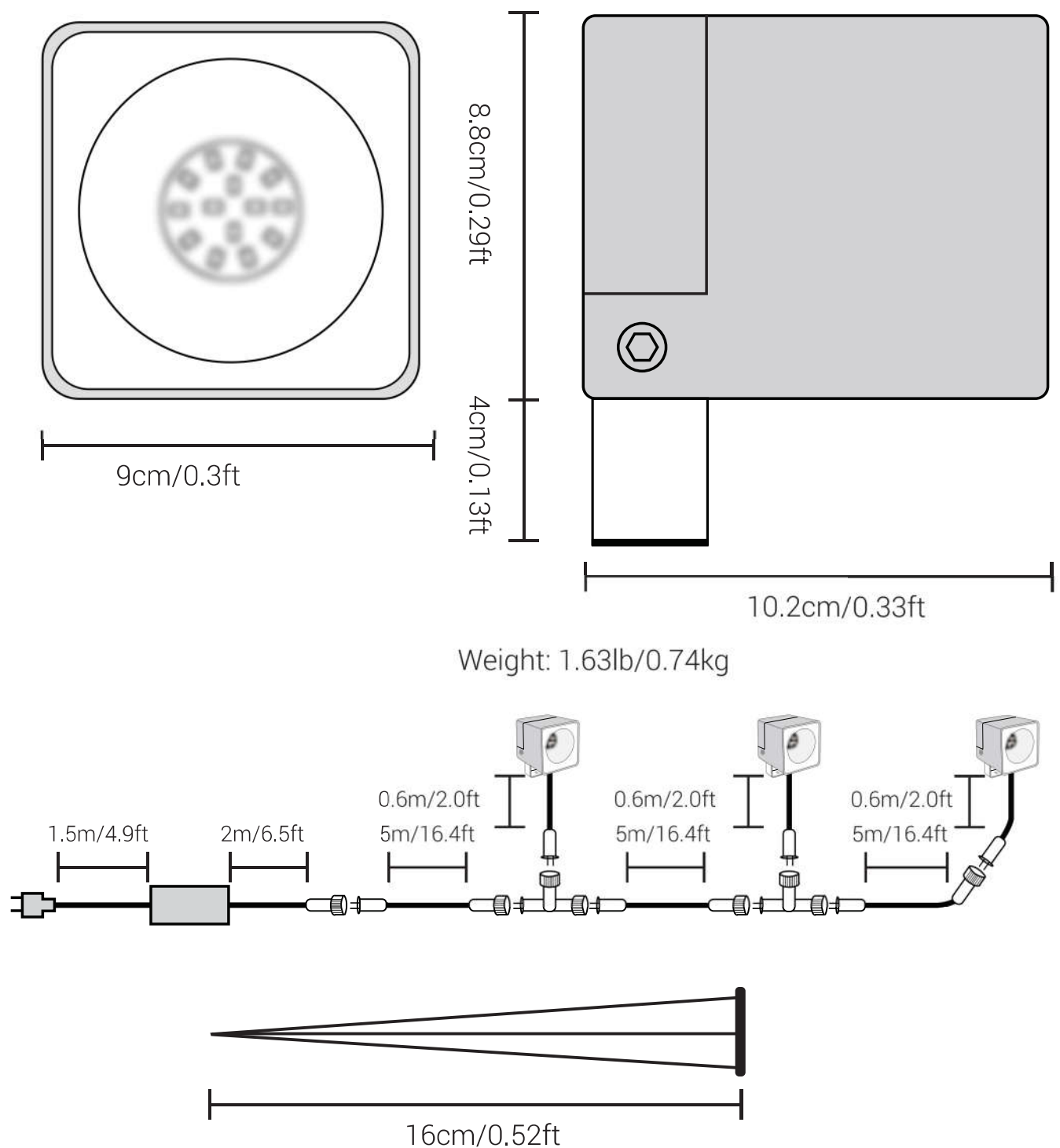

4. Installation

This luminaire and power supply unit is intended for installation in accordance with the National Electrical Code and local code specifications. Failure to adhere to these codes and instructions may result in serious injury and/or damage to the PSU and void the warranty. These instructions do not purport to cover all details or variations in equipment, not to provide for every possible contingency related to installation, operation, maintenance, or mounting situation. Should specific problems occur that are not addressed by these instructions, contact your Sales Representative or distributor for assistance. **SAVE THESE INSTRUCTIONS** for future reference.

- The plug on the power supply unit must be connected to a GFCI protected hooded flush type cover plate receptacle marked “Wet Location” while in use.
- Protect the wire by routing it in close proximity to the light fitting, or next to a building structure such as a house or a deck.
- The landscape wire and connector can also be hidden under stone or buried under grass at a maximum depth of 6 inches (15.2cm).
- Mustwin recommends a minimum depth of 4 inches when burying in the lawn to prevent damage from aerators or other lawn plugging equipment.
- Mustwin recommends not to bury the T-shaped connectors.
- Do not submerge luminaire or PSU in water.
- **WARNING-Risk of Electric Shock.** Do not install power supply unit or luminaires within 10 feet(3.05m) of a pool, spa, or fountain.
- Use only with Mustwin 24V luminaires!

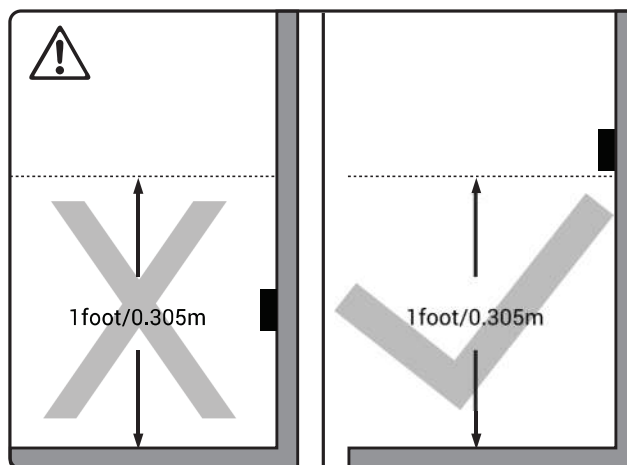
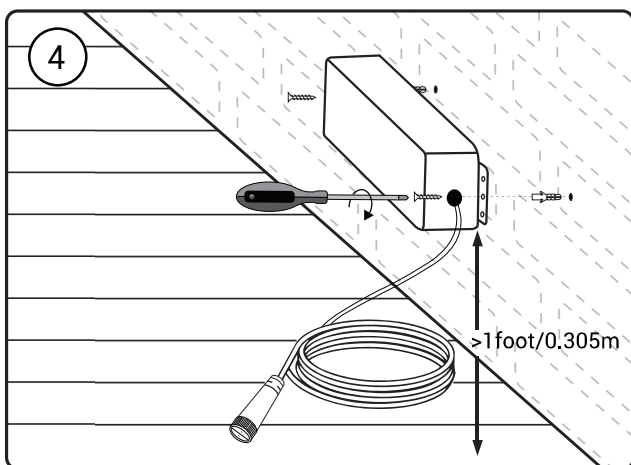
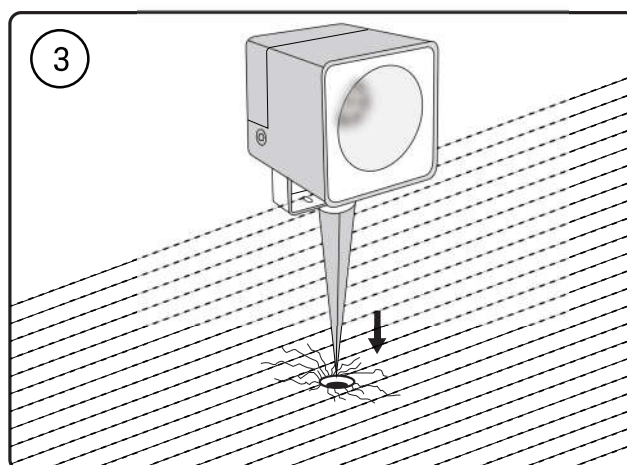
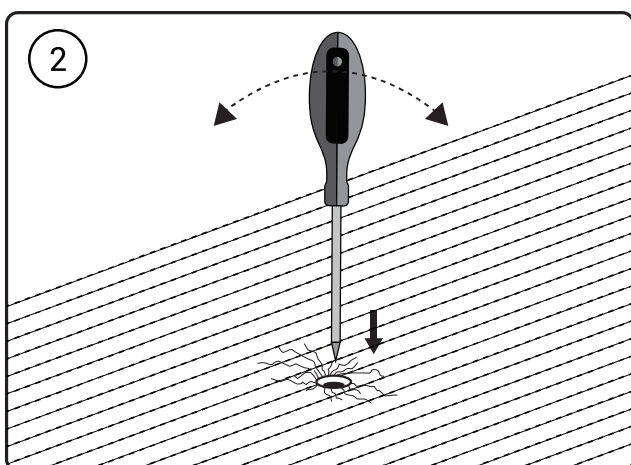
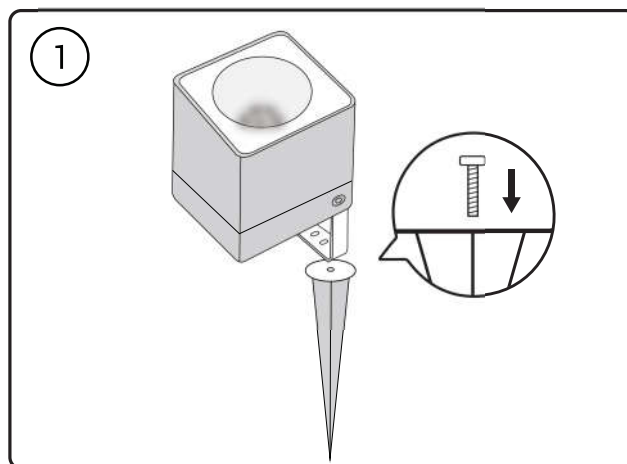
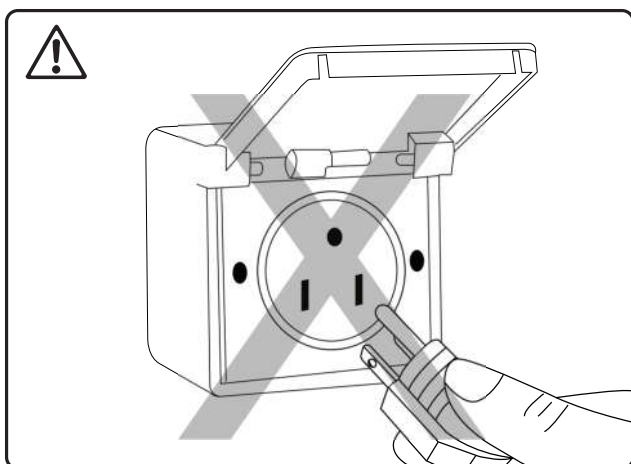

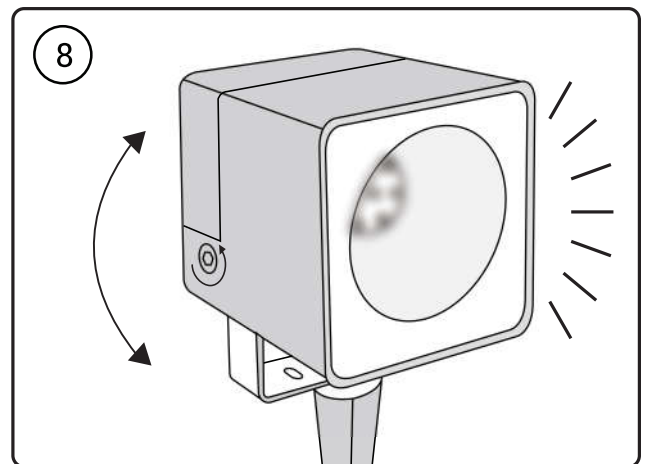
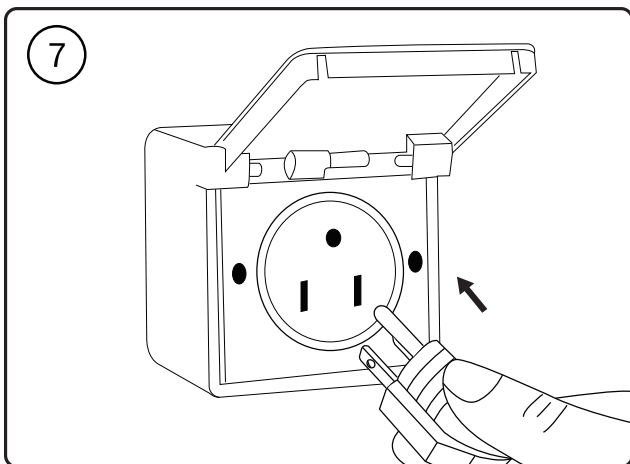
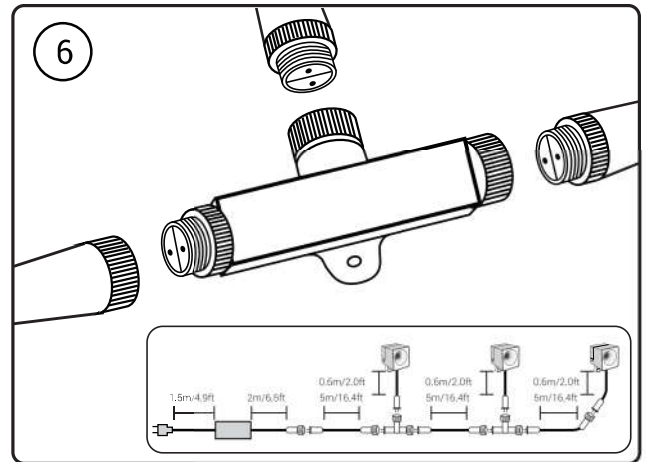
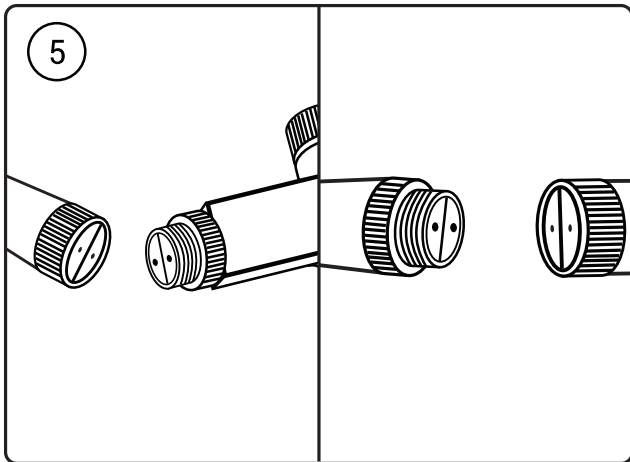

Limitation of Indoor and Outdoor Use

- (1) This light is waterproof and dampproof. It is protected against the rain, but it cannot be immersed in water.
- (2) This light should be used in condition that is good for heat dissipation. Its working temperature should be less than 40°C. Too high the working temperature will cause serious lumen depression and affect lifespan of the light.

Part Two - How to pair the spotlight to Smart Life app?



Before starting the pairing, please make sure to turn on the Bluetooth on your phone.

Step A : Smart Life app installation.

Please choose either way below to download and install the app.

1. As per your phone system, choose the QR code to scan.



iOS



Android

2. Search keyword 'Smart Life' in Apple Store or Google Play.

Step B : Create an account on Smart Life and login.

Note: Please keep your account and password in mind for Alexa or Google Assistant App pairing later.

Step C : WiFi Connection.

This product only supports 2.4GHz WiFi network, not 5.0GHz. Please make sure your working network is 2.4GHz and your router has disabled the MAC filter.

1. Pair Smart Life App to Bluetooth Mesh hub.

1) Option One

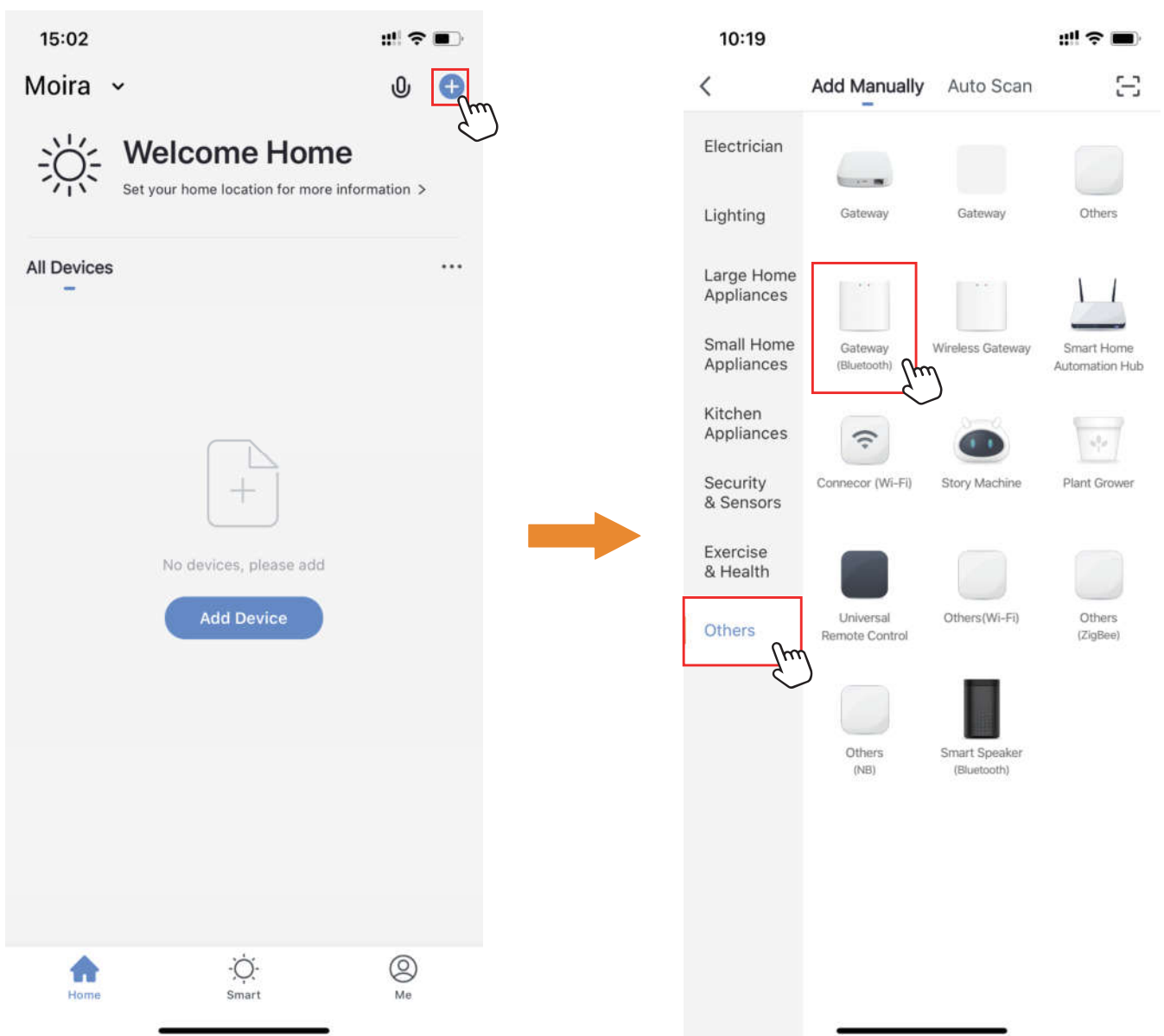

(1) Tap '+' button on top right corner to enter next page.

(2) Tap 'Others', then choose 'Gateway (Bluetooth)' to add the hub.

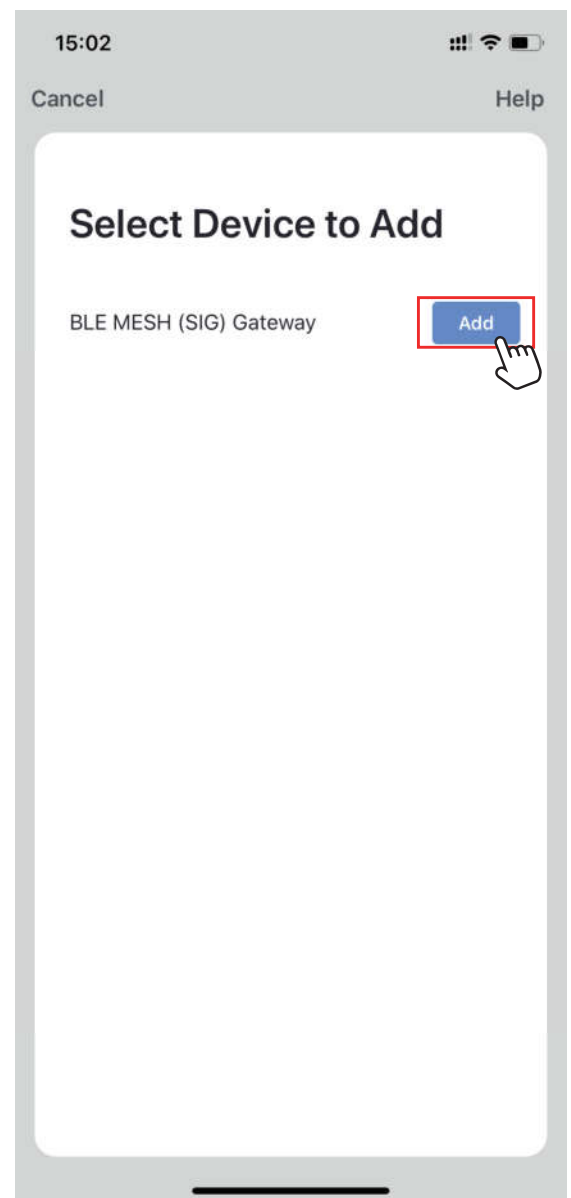
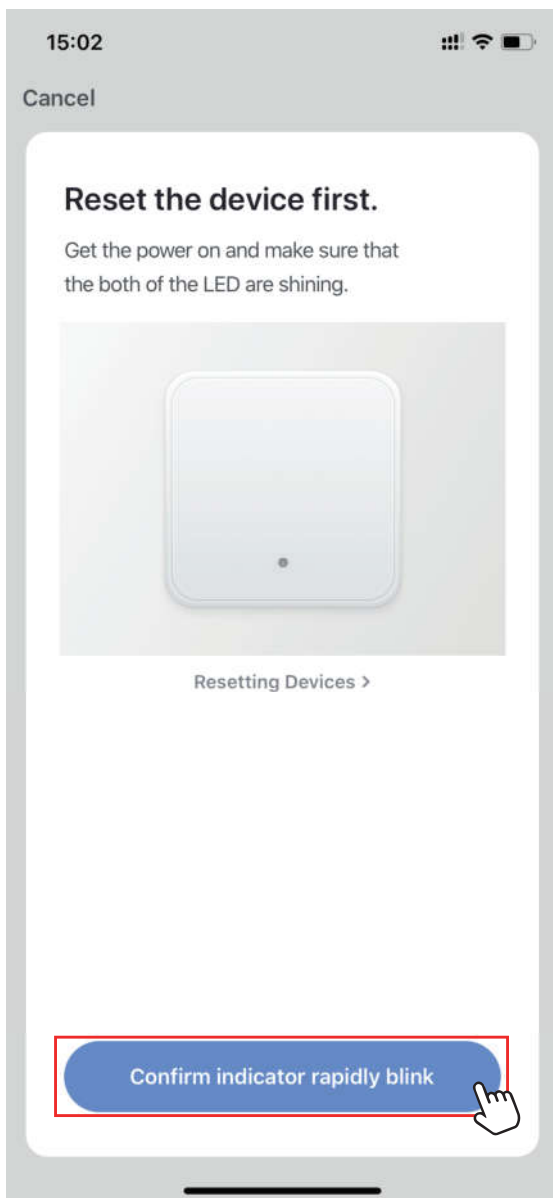

(3). Plug the hub into a socket. Long press the power button on the hub till the indicator lights rapidly blink, then tap the confirm button on this page.

(4) Click 'Add' button to add the hub.

** It is recommended to place the hub to somewhere that is between the lighting device and the router, and also responds well to the WiFi signal.

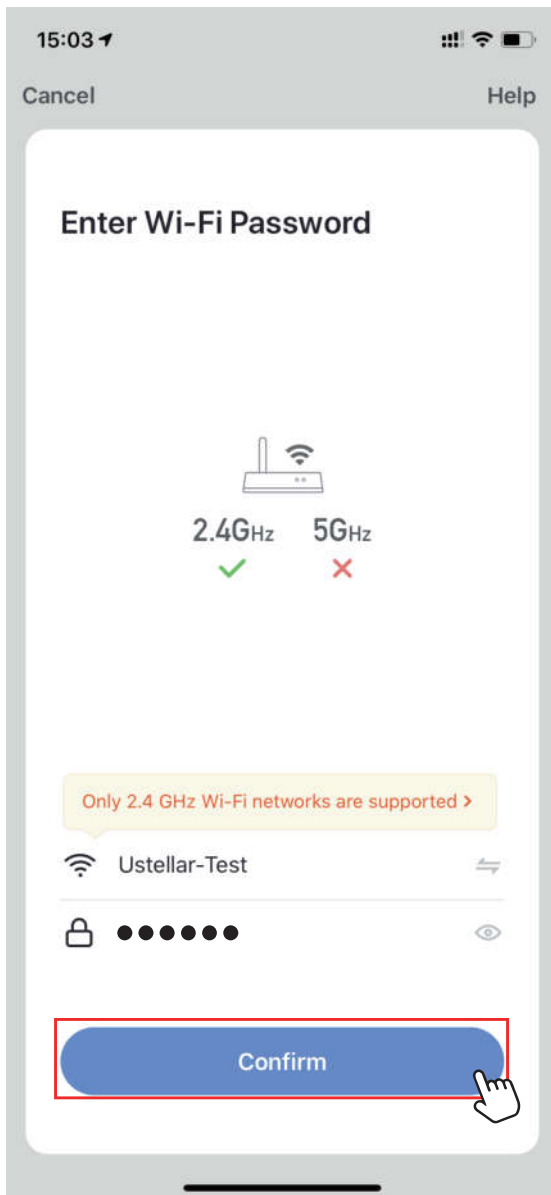

(5) Select you WiFi network and enter the password.

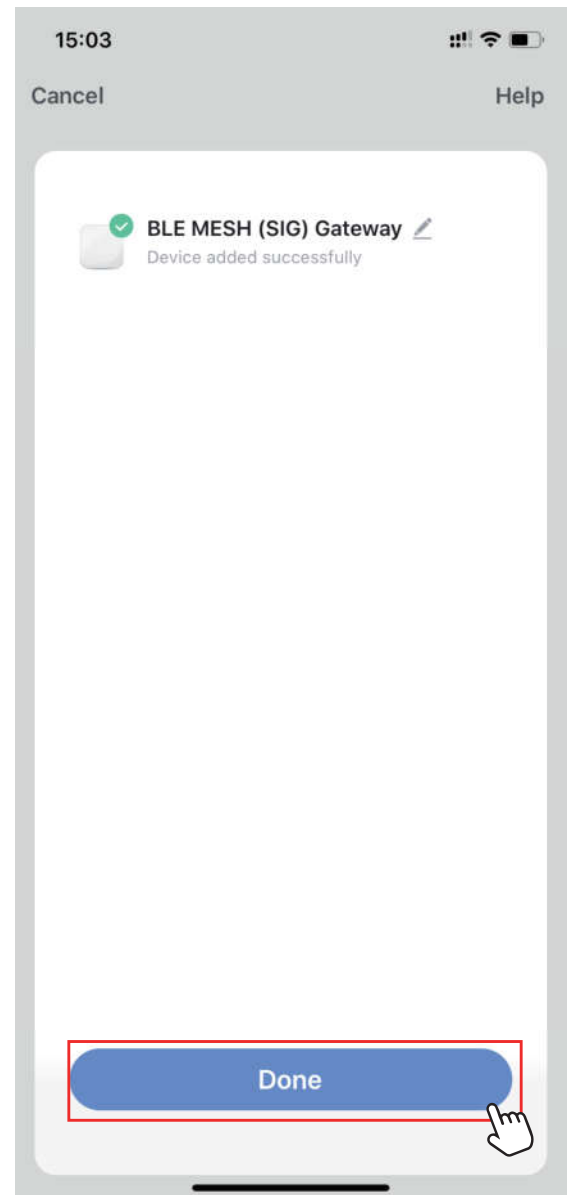

(6) Give a name to the hub and tap 'Done'.

2) Option Two

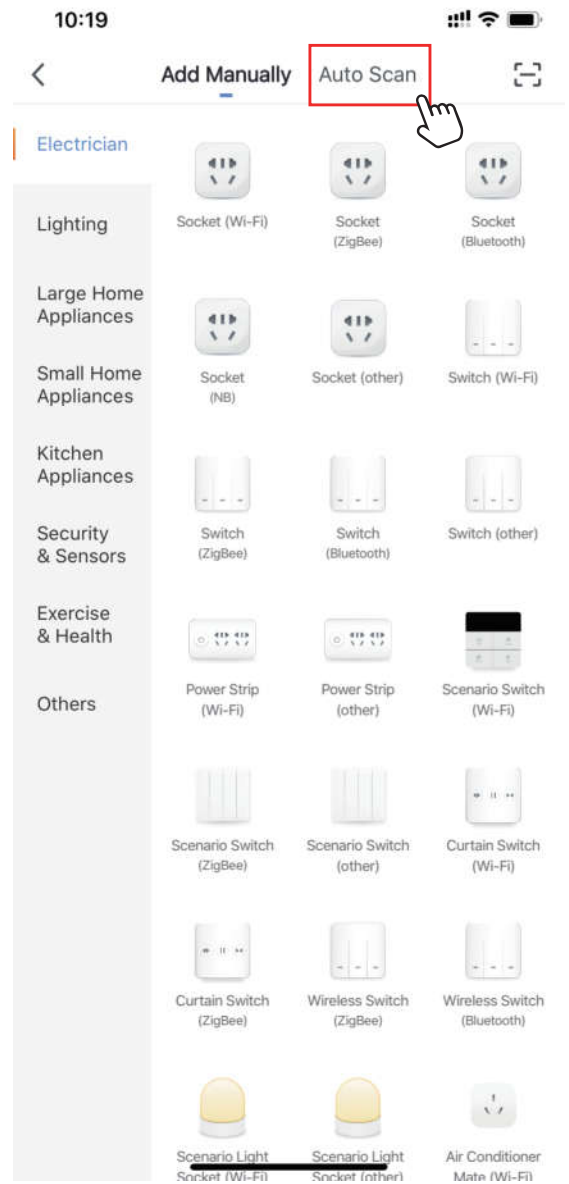
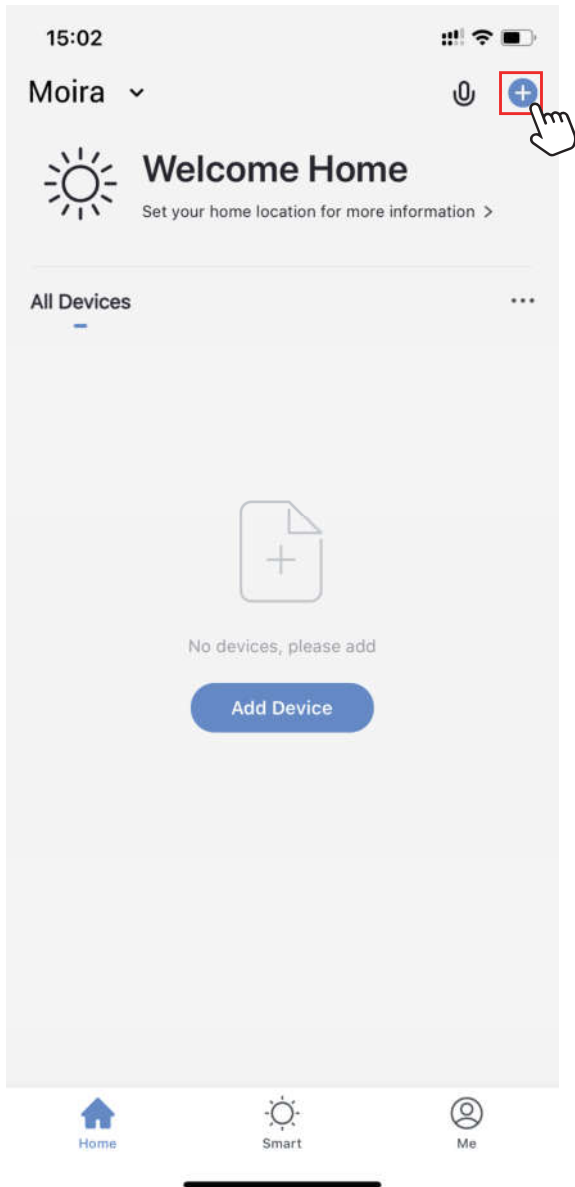

(1) Tap '+' button on top right corner to enter next page.

(2) Tap 'Auto Scan' to enter next page.

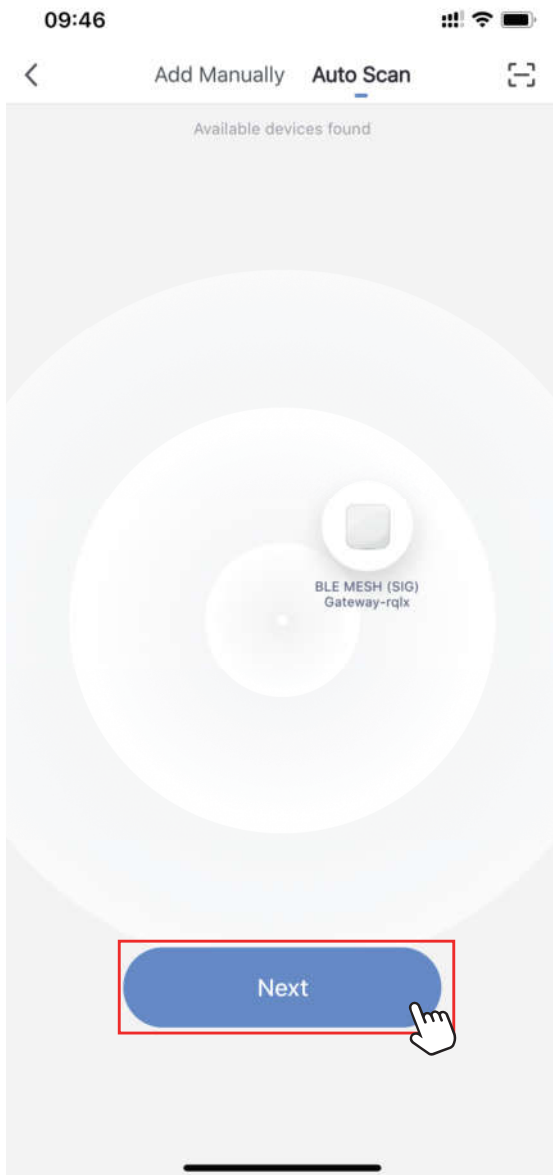

(3) When the page shows 'BLE MESH (SIG) Gateway-rqlx', tap 'Next'.

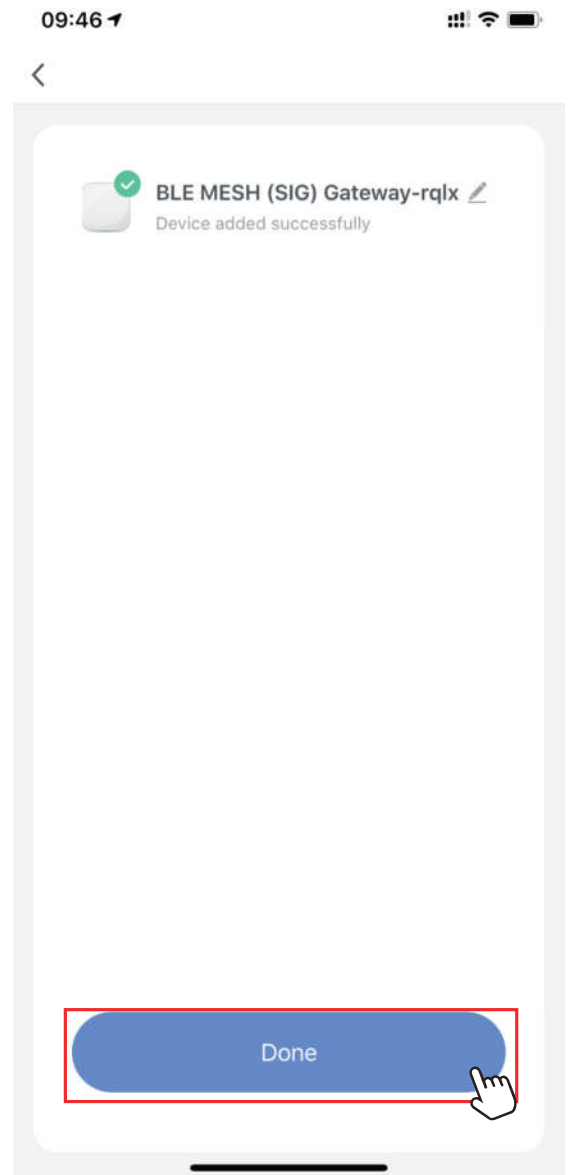

(4) Rename it and tap 'Done'.

2. Pair Smart Life App to the spotlight.

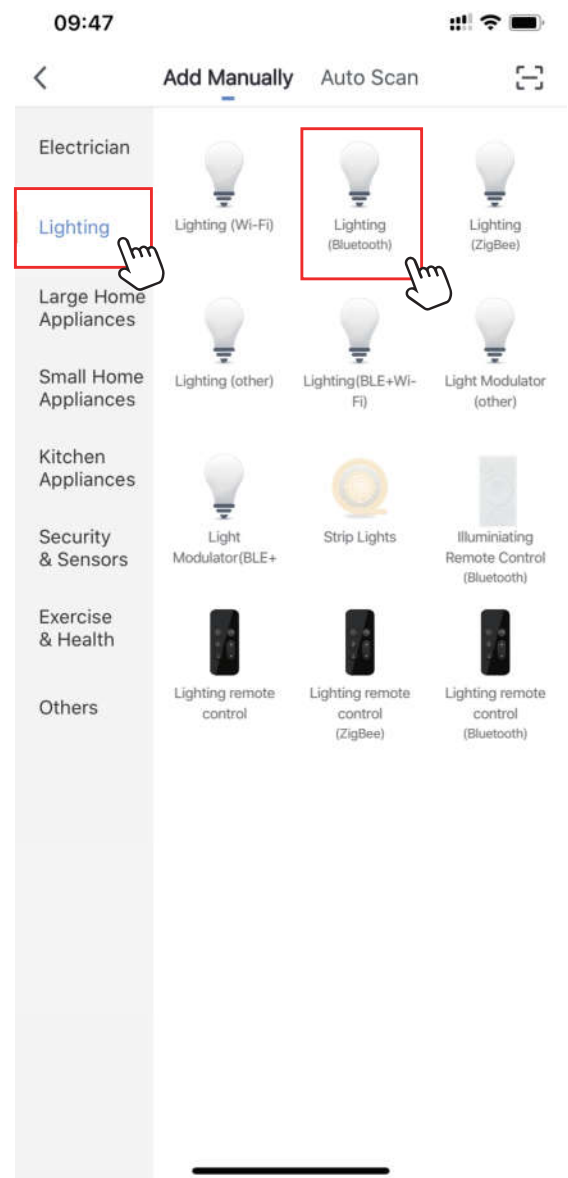
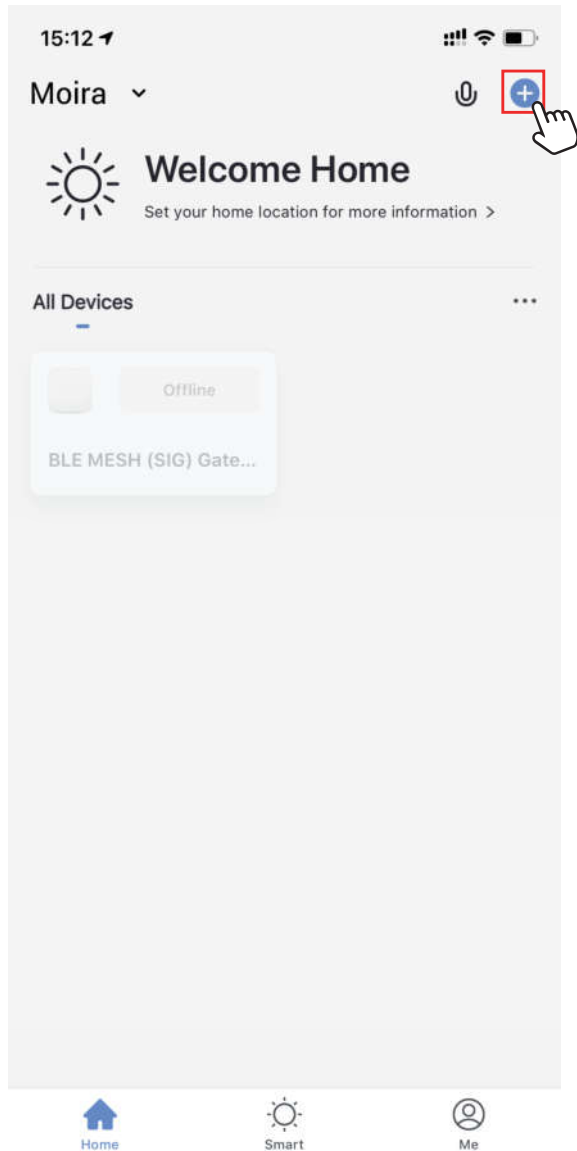

(1) Tap '+' button on top right corner to enter next page.

(2) Tap 'Smart Lighting', then choose 'Lighting Device(Bluetooth)' to add the spotlight.

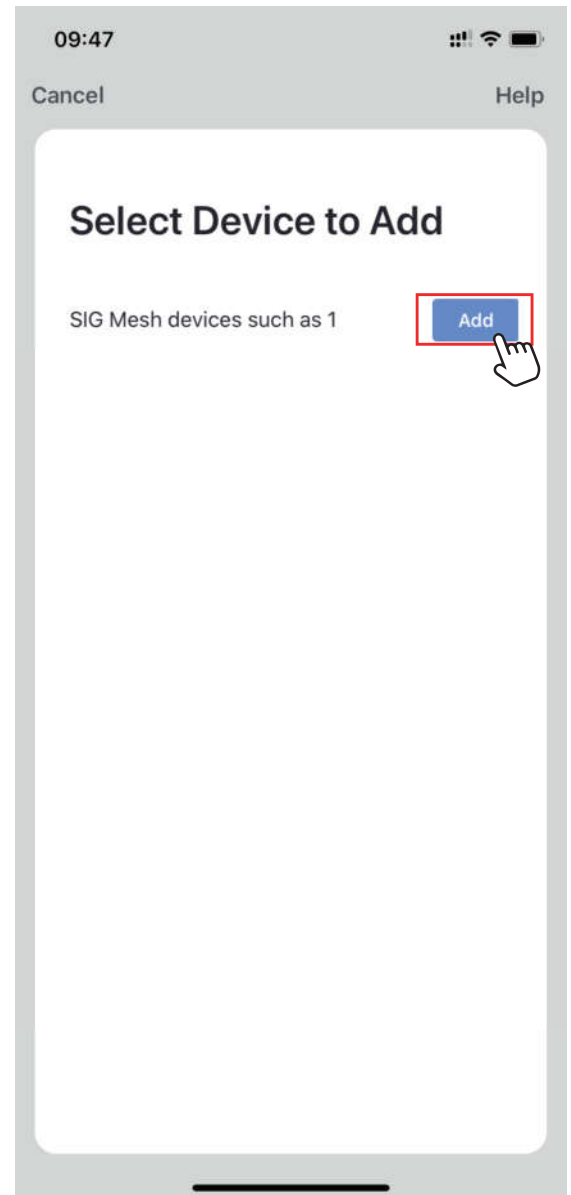
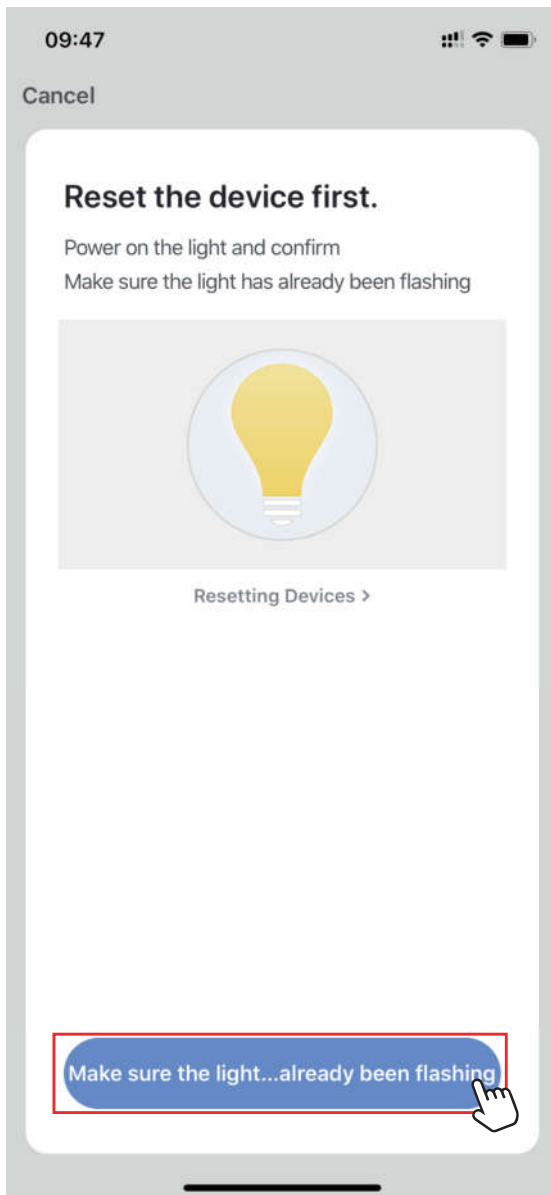

(3) Power on the spotlight. Repeatedly plug on-off-on-off-on-off-on the spotlight to activate it into rapid blinking status (about 0.5s per blink). Wait till the spotlight no longer blinks, click the confirm button on this page.

(4) Discover the lighting device and click 'Add'.

How to group the spotlight?

Make sure all the lights have been paired to “smart life” app, then group the lights by following these steps.

1. Choose any light on the app, click the edit button on the top right corner, then click “Create Group” .
2. Choose the lights you want to group from the device list and rename the group.

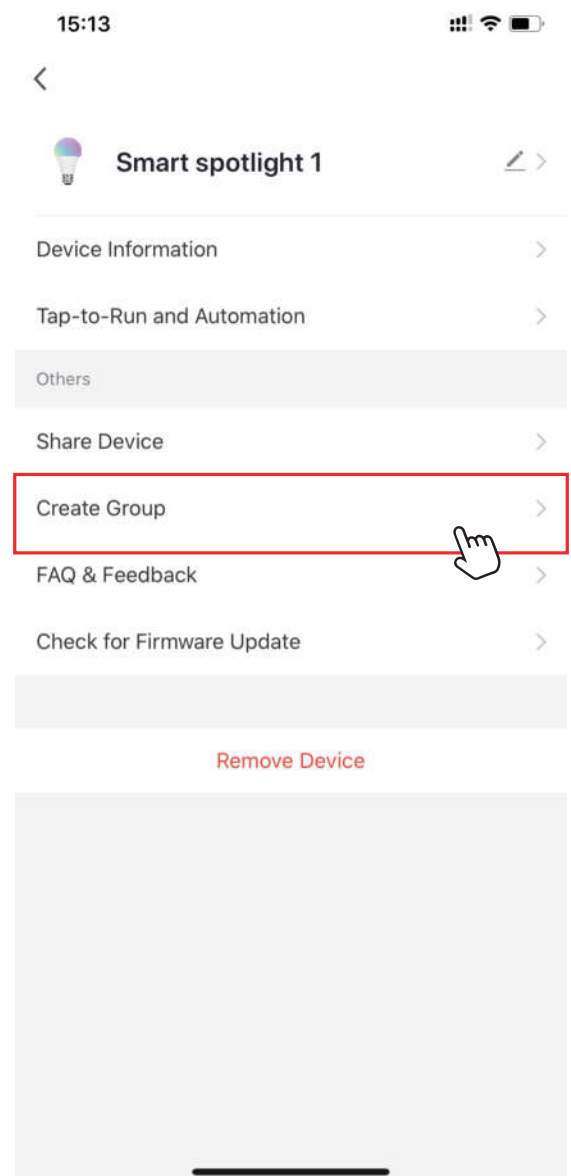
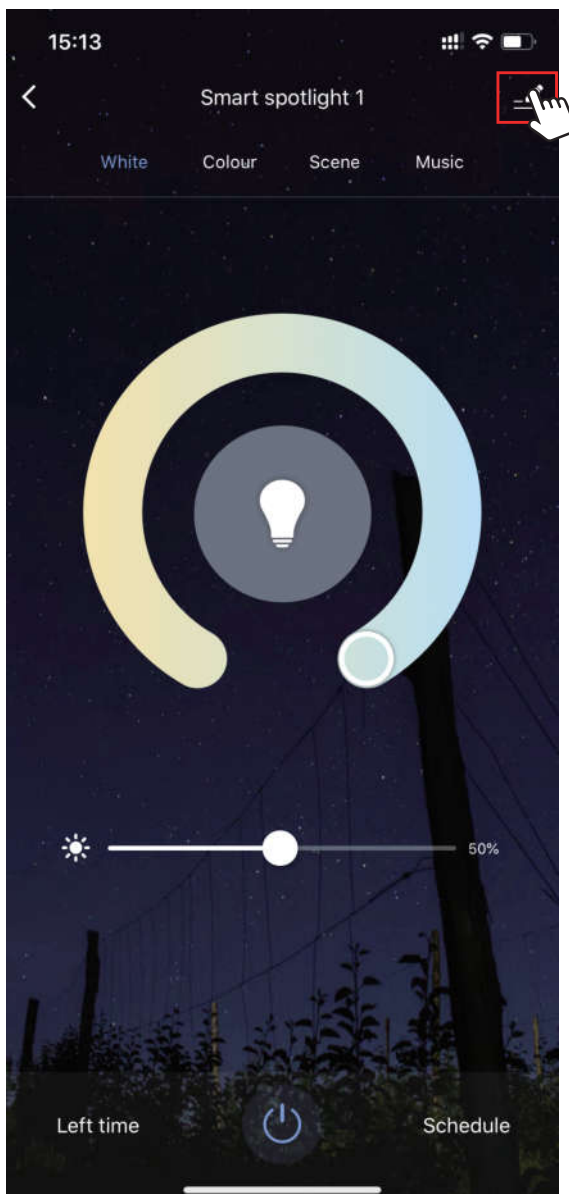

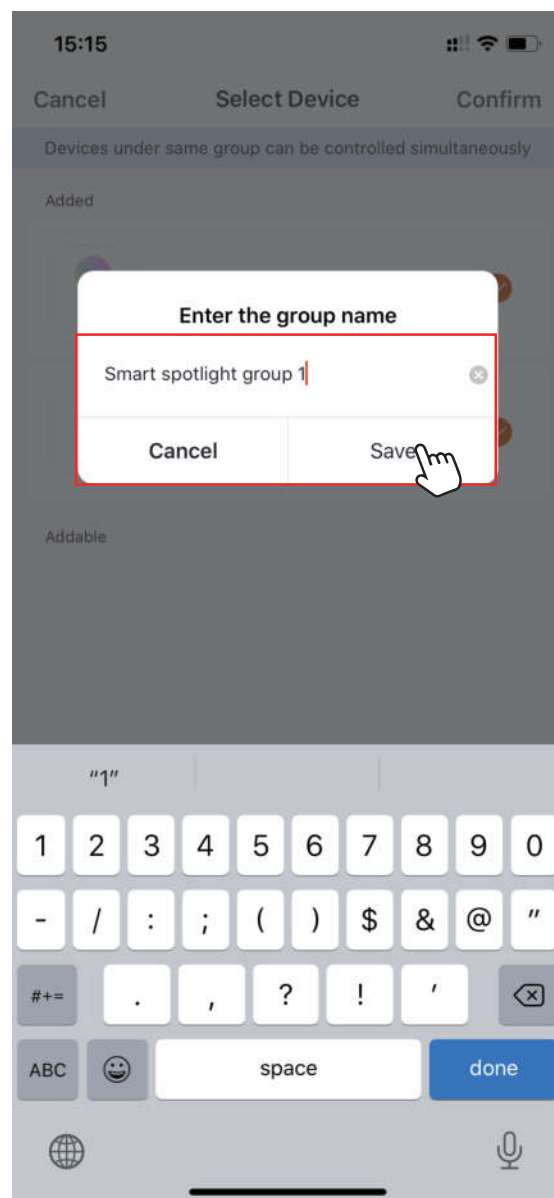
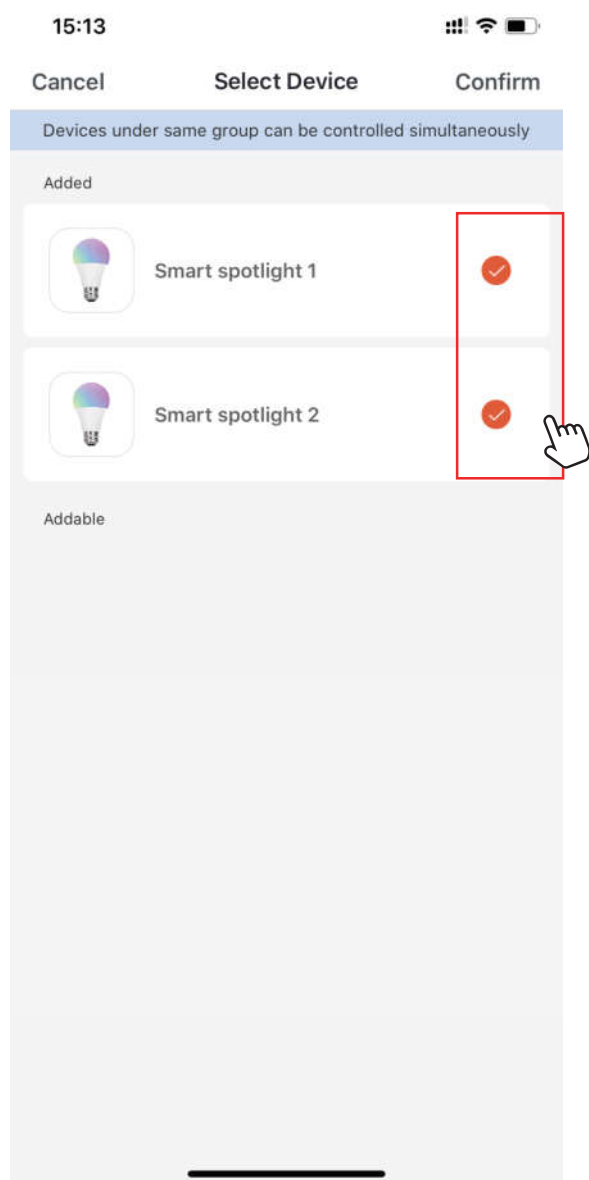

Step D : Give a name to the spotlight.

- A simple name is recommended for easier voice recognition with Alexa or Google Assistant.
- The name given to the spotlight will be the same for voice control on Alexa or Google Assistant. For example, the spotlight is named 'smart spotlight' on this manual.

Step E : The named spotlight will be shown on the app homepage.

Now you can control the spotlight (turn on/off, change colors, adjust brightness ect) with Smart Life on the setting page. Turn on or off the spotlight by tapping the bulb icon.

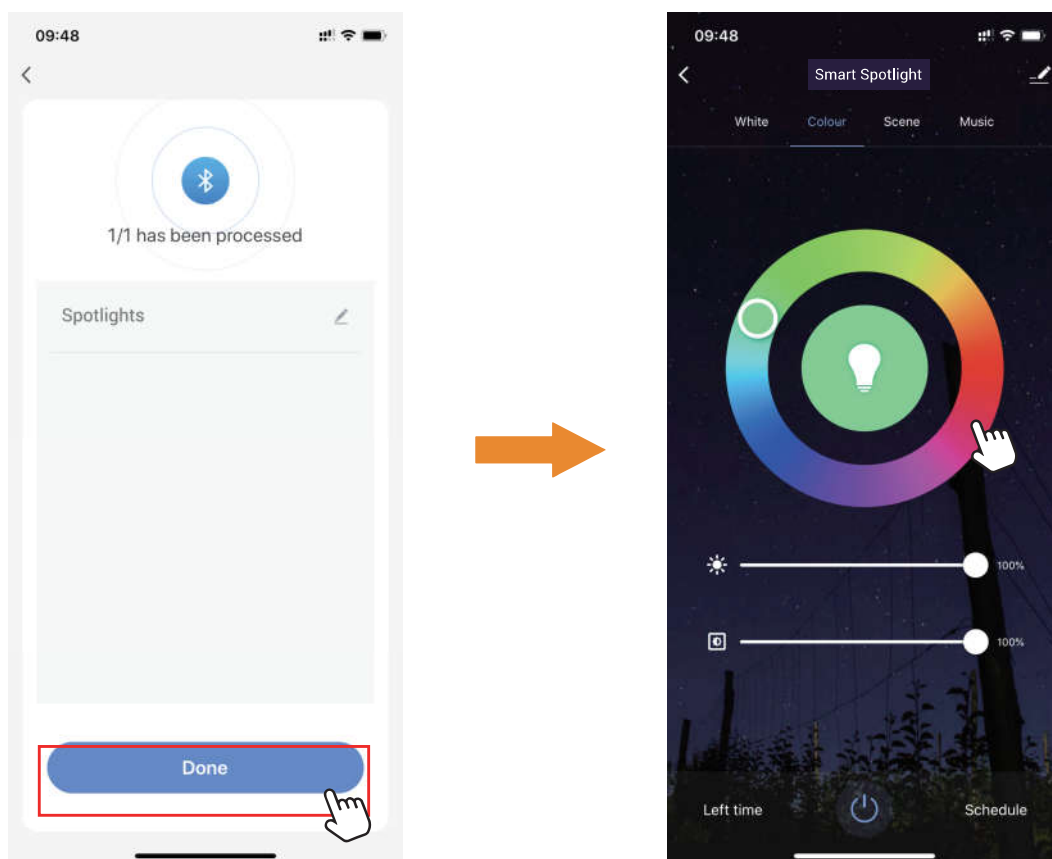

Note: To control the spotlight with Amazon Alexa, please read Part Three. To control the spotlight with Google Assistant, please read Part Four directly.

Part Three - How to control the spotlight with Amazon Alexa?



Please make sure that your Alexa app is connected to Echo, and both work well under your WiFi network.

Step A : Log in your Alexa App, tap top left corner, and tap 'Skills'.

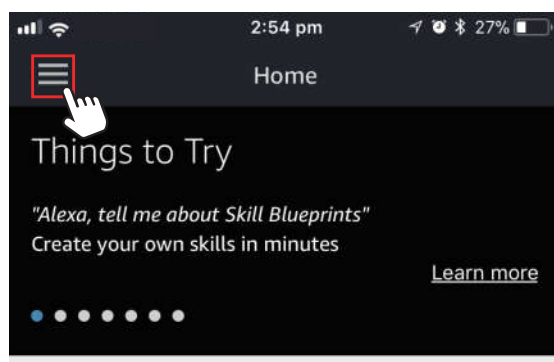

Your Alexa settings have been updated

Household Drop In was enabled from one of your Echo devices or from the Alexa app. The opt-in Drop In feature lets you automatically connect to an Echo device for a voice or a video chat. Your Echo devices with a screen and the Alexa app will indicate which of your other devices are recently active.

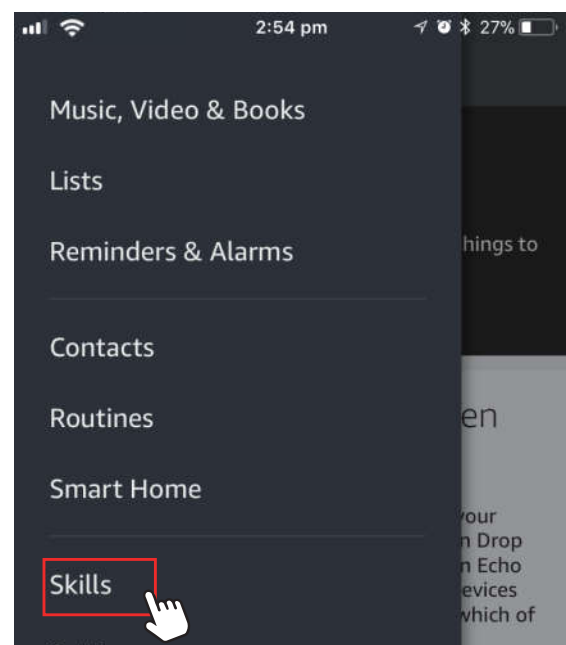

Step B : Type 'Smart Life', find 'Smart Life' from the search result and tap it to enable the skill.

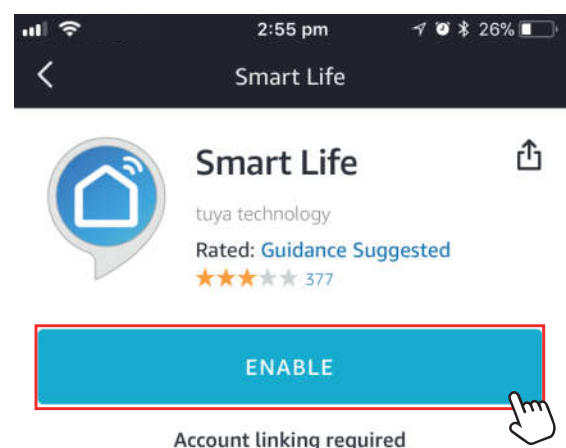
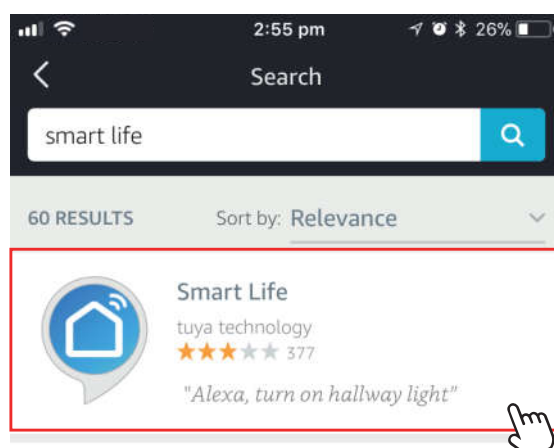

Account linking required

Step C : Enter your Smart Life App account and password. Tap 'Link Now', then tap 'Authorize' on the next page to bind Smart Life account to Alexa.

Step D : When your Smart Life account is bound to Alexa, tap 'DISCOVER DEVICES' to detect the spotlight.

Step C

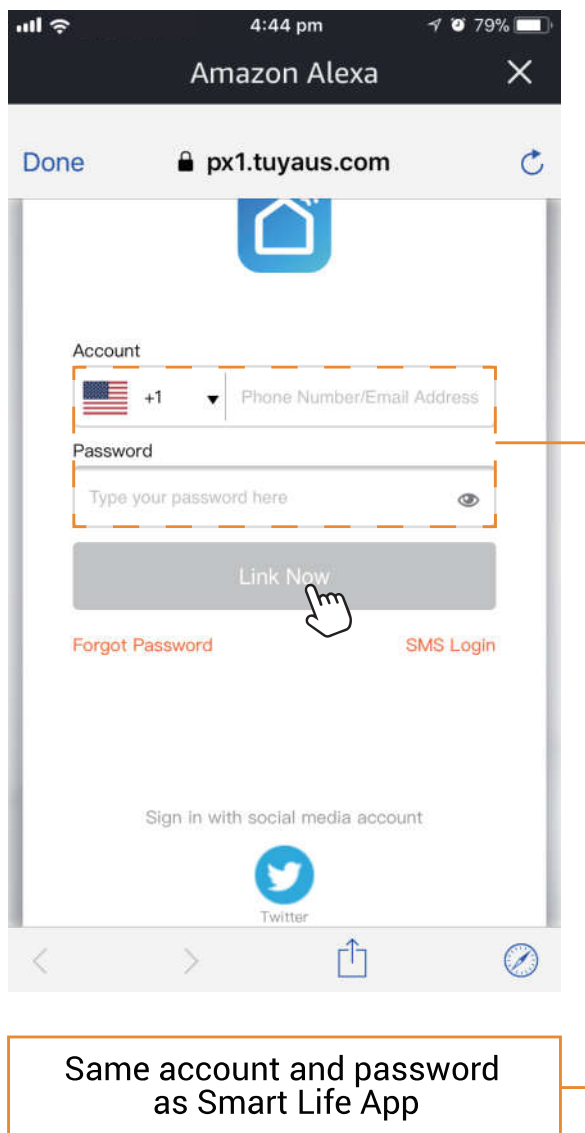

Step D

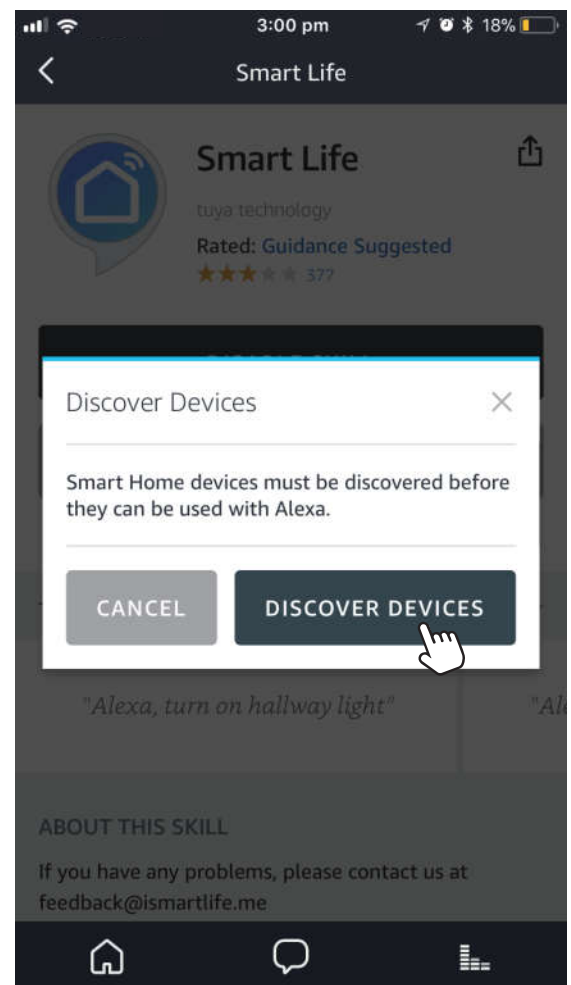

Step E : When the named spotlight is paired to Alexa from Smart Life, it will show on the device page (see the 'smart spotlight' example).

Step F : Now you can control the spotlight with Alexa App on the setting page. To turn on or off the spotlight, simply tap the bulb icon.

Step G : You can also voice control the spotlight with Alexa by giving these commands: “Alexa, turn on ‘device name’ ”, “Alexa, set ‘device name’ to ‘color’ ”, “Alexa, set ‘device name’ to ‘number’ ”.

Device name is the one you give to the spotlight. The spotlight is named ‘smart spotlight’ in this manual. For example, “Alexa, turn on ‘smart spotlight’ ”, “Alexa, set ‘smart spotlight’ to ‘blue’ ” etc.

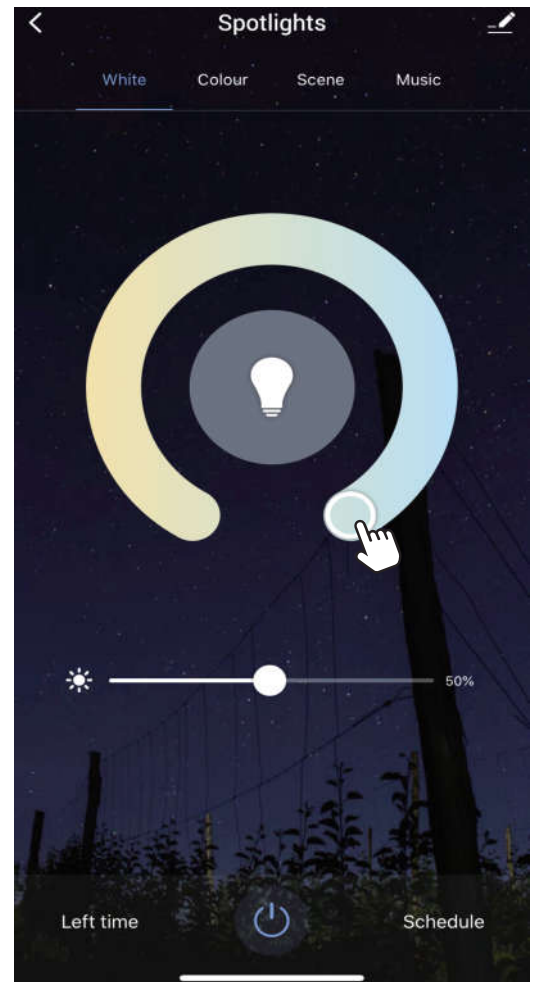
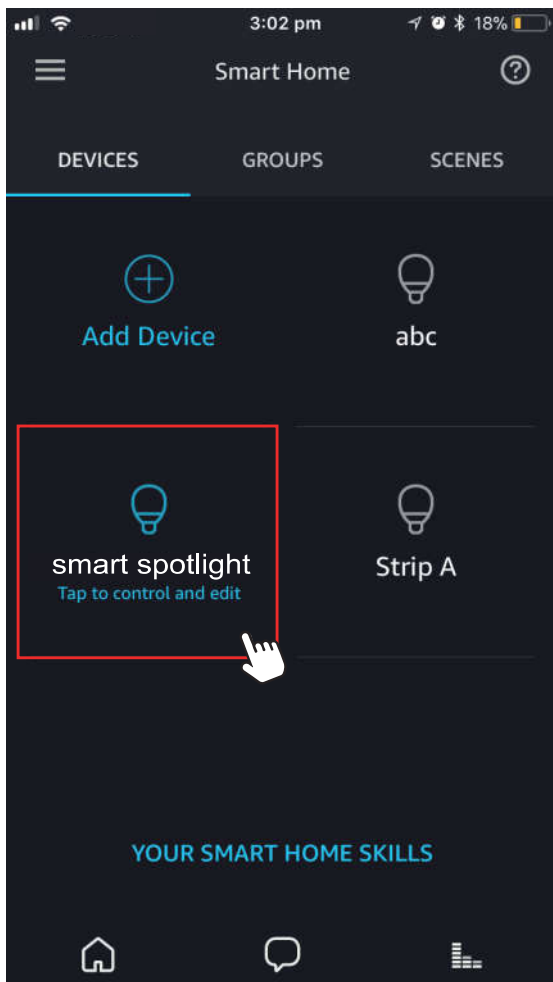

Note: To control the spotlight with Google Assistant, please continue to read Part Four.

Part Four - How to control the spotlight with Google Assistant?



Step A : Login Google Assistant App, tap 'Home Control' on the left side bar page.

Step B : Tap '+' button on the bottom right to enter next page.

Step C : Find 'Smart Life' from side bar list.

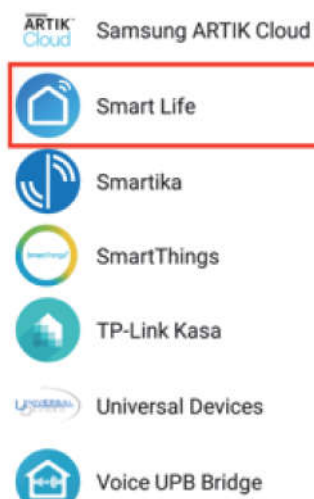
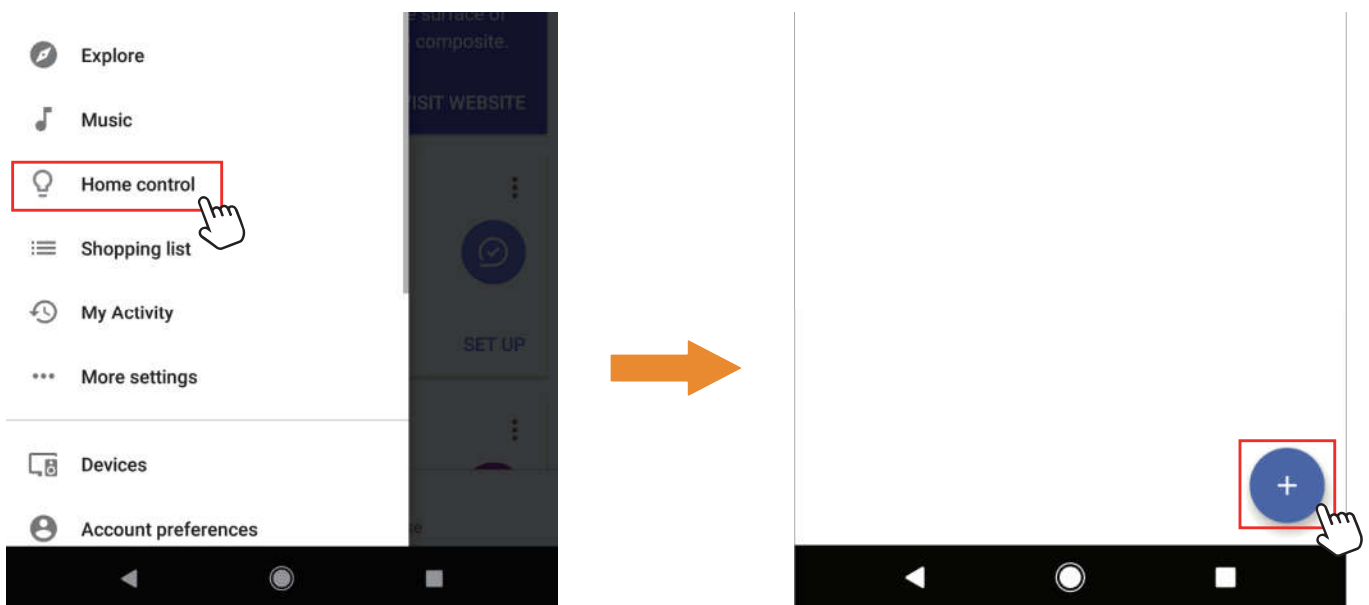

Step D : Enter your Smart Life App account and password to bind Smart Life account to Google Assistant.

Step E : You will find the named spotlight shows on the Home Control page. Now you can control the spotlight on Google Assistant App, or voice control it by giving these commands: “ok Google, turn on ‘device name’ ”, “ok Google, set ‘device name’ to ‘color’ ”, “ok Google, set ‘device name’ to ‘number’ ”.

Device name is the one you give to the spotlight. The spotlight is named ‘smart spotlight’ in this manual. For example, “ok Google, turn on ‘smart spotlight’ ”, “ok Google, set ‘smart spotlight’ to ‘blue’ ” etc.

Step D

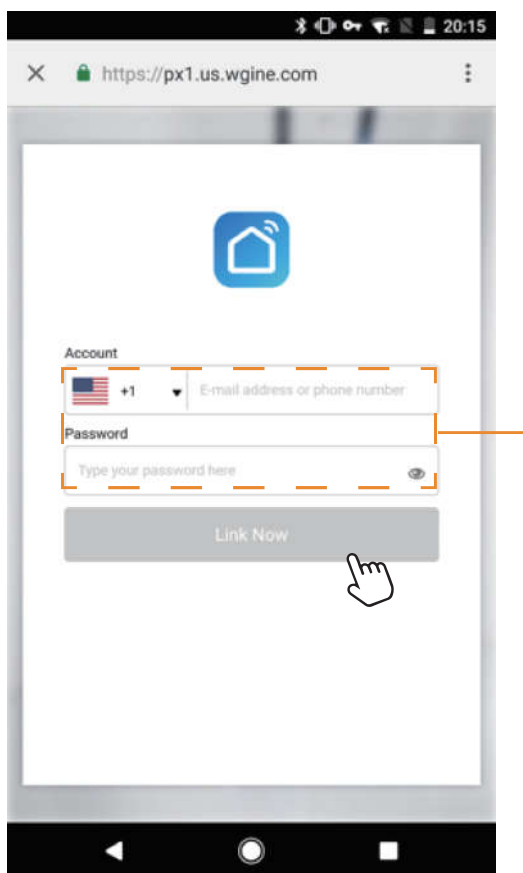

Same account and password
as Smart Life App

Step E

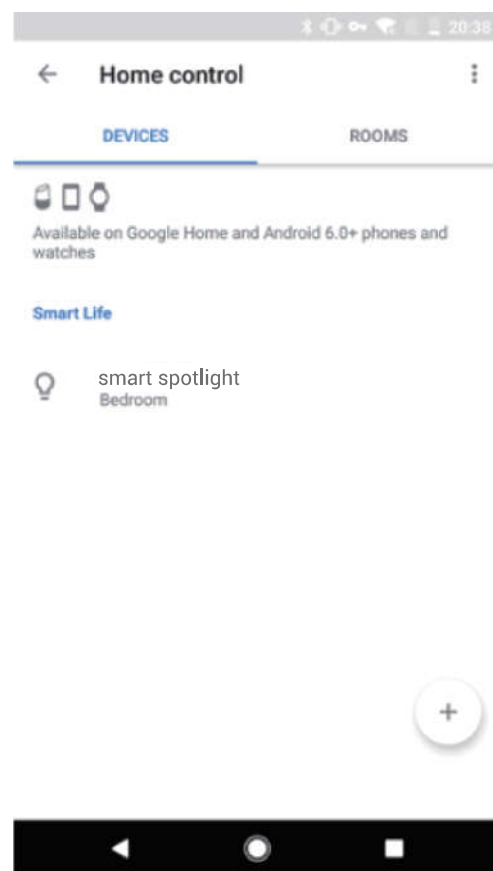

FCC Warning:

Any Changes or modifications not expressly approved by the party responsible for compliance could void the user's authority to operate the equipment.

This device complies with part 15 of the FCC Rules. Operation is subject to the following two conditions:

- (1) This device may not cause harmful interference, and
- (2) This device must accept any interference received, including interference that may cause undesired operation.

Note: This equipment has been tested and found to comply with the limits for a Class B digital device, pursuant to part 15 of the FCC Rules. These limits are designed to provide reasonable protection against harmful interference in a residential installation. This equipment generates uses and can radiate radio frequency energy and, if not installed and used in accordance with the instructions, may cause harmful interference to radio communications. However, there is no guarantee that interference will not occur in a particular installation. If this equipment does cause harmful interference to radio or television reception, which can be determined by turning the equipment off and on, the user is encouraged to try to correct the interference by one or more of the following measures:

- Reorient or relocate the receiving antenna.
- Increase the separation between the equipment and receiver.
- Connect the equipment into an outlet on a circuit different from that to which the receiver is connected.
- Consult the dealer or an experienced radio/TV technician for help.

This equipment complies with FCC radiation exposure limits set forth for an uncontrolled environment. This equipment should be installed and operated with minimum distance 20cm between the radiator & your body.



Contact Us

Any questions?

Our lovely customer service team is always there for you.

Please reach us via



support@mustwin.ltd

Manufactured by Shenzhen Michuang Technology Ltd.

Address: Rm.1012, A Bldg., No.142, Meilong St., Longhua District,
Shenzhen, CHINA 518000

The logo consists of a large, rounded orange hexagon with the text "MustWin" in white. The background of the entire page is white with several smaller orange hexagons of varying sizes and colors (some solid, some outlined) scattered around.

MustWin

✉ support@mustwin.ltd

FC RoHS IP65 CE 