

H2B-02Pro

Dual Hub motor Long board

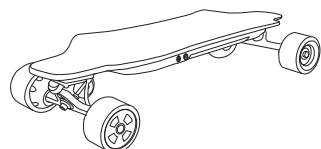

USER MANUAL

Thank you for buy our electric skateboard

Do note that an electric skateboard is not a toy. Please take time to learn it and read this manual carefully. Particularly the safety instruction pages.

We hope you will enjoy this product and have lots of fun with it in the future

PREPARATION

1. Be sure that wear a helmet and safty gear when you ride it
2. Confirm the front direction of the skateboard
3. Confirm the position on the skateboard, The feet stand on the widest front and back skateboard.
4. Please start with the low speed mode to be familiar with the accelerate and brake of the skateboard.
5. Please stop riding by remote control brake operation,then get down your front foot at first and then get down your back foot.

PARTS DIAGRAM

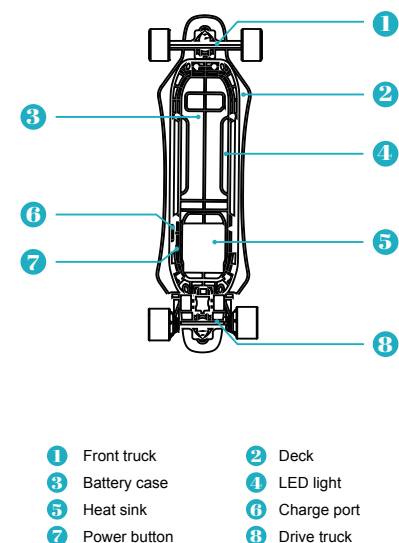

REMOTE CONTROL

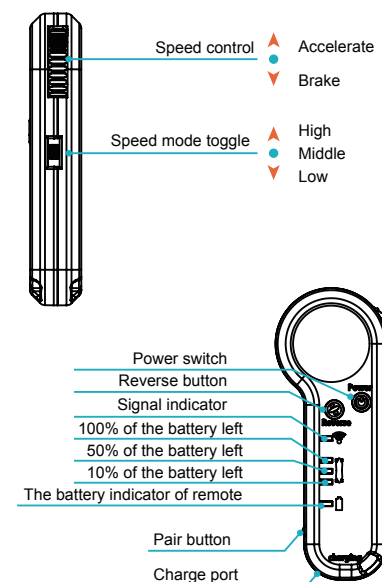

PAIR INSTRUCTION

At the first step, the Board and Remote must be paired. Before starting, to ensure the Board and Remote are turn off.

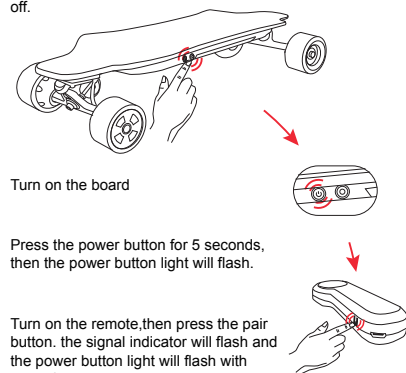

Push the joystick, forward to test the accelarate and backward to test the brake. After tested all function work normal you can start your riding.

SPECIFICATION

Specification		Dual Hub Motor
Speed		38KM/H
Mileage		35KM
Max load		150KG
Climbing ability		15°
Motor	Watts	450W*2
	Type	Hub motor *2
Weight	N.W.	8.3KG
	G.W.	9.6KG
Wheel Size		90mm
Deck		8 layers Canadian maple
Battery	Voltage	36V
	Capacity	6000mAh / 7500mAh
	Type	Lithium Battery
	Charge	4 hours
Remote	Frequency	2.4GHz
	Valid range	14M
Product Size		970*265*125mm
Inner Box Size		1025*310*170mm
Outer Box Size		1050*325*195mm

SAFETY INSTRUCTIONS

- ⚠ The electric skateboard is not a toy, should be treated with appropriate caution. Always practice safety first-as it is possible to lose balance and cause a collision or fall. Ensure that you use the board in a safe appropriate environment, and always wear appropriate safety gear.
- 🧑 Safety Gear: we recommend that you wear full safety gear while riding. Please wear a suitable skateboard helmet, elbow pads, knee pads, and gloves.
- 🚫 Wear shoes: Flipflops or similar loose footwear are not suitable for riding wear.
- 👤 The skateboard is designed for rider over 10 years old and above.
- 👤 Only one person riding for each skateboard at a time. The maximum load of the board is 150kg. Exceeding this weight will compromise the structural integrity of the skateboard, as well as remote and functionality,and may cause board damage, losing control or other breakage.

- 🚫 Please observe your local traffic laws and regulations.
- ⚠ The board is designed to drive on flat and paved surfaces. Avoid driving on sand, gravel,mud, rugged or open ground. Do not drive on slippery ground, such as snow, ice or wet ground.
- 🚫 Keep fingers, hairs, and clothing away from motors, wheels and moving parts.
- 🚫 Do not open or tamper with electronics housing. Electricshock is possible and this also voids the warranty.

USER MANUAL

FCC Caution:

This device complies with part 15 of the FCC Rules. Operation is subject to the following two conditions: (1) This device may not cause harmful interference, and (2) this device must accept any interference received, including interference that may cause undesired operation.

Any Changes or modifications not expressly approved by the party responsible for compliance could void the user's authority to operate the equipment.

Note: This equipment has been tested and found to comply with the limits for a Class B digital device, pursuant to part 15 of the FCC Rules. These limits are designed to provide reasonable protection against harmful interference in a residential installation. This equipment generates uses and can radiate radio frequency energy and, if not installed and used in accordance with the instructions, may cause harmful interference to radio communications. However, there is no guarantee that interference will not occur in a particular installation. If this equipment does cause harmful interference to radio or television reception, which can be determined by turning the equipment off and on, the user is encouraged to try to correct the interference by one or more of the following measures:

- Reorient or relocate the receiving antenna.
- Increase the separation between the equipment and receiver.
- Connect the equipment into an outlet on a circuit different from that to which the receiver is connected.
- Consult the dealer or an experienced radio/TV technician for help.

The device has been evaluated to meet general RF exposure requirement. The device can be used in portable exposure condition without restriction.