

# P07

Smart electronic cat toy



## Remote control instructions

Indicator light

Steering wheel

Rotation

Mode switch

remote control mode  
automatic floor mode  
automatic carpet mode

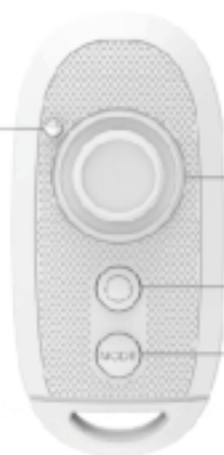

# P07

## Smart electronic cat toy

### How to work?

- **Operation**

**Press the button once** : remote control mode

**Press the button secondly** : the light flash twice into automatic floor mode

**Press the button thirdly** : the light flash twice into automatic carpet mode

**Press the button fourth** : power off and light off

- **Standby** : the toy will be in standby mode after working for 10 minutes, 1.5 hour later, it will work 10 minutes again, the rest can be done in the same manner. In standby mode, LED lights will be on once every 1 minute

- **Low voltage** : LED light flash quickly

- **Charging** : LED light flash regularly

- **Full charged** : LED light is always on

- **Charging time** : 2 hours

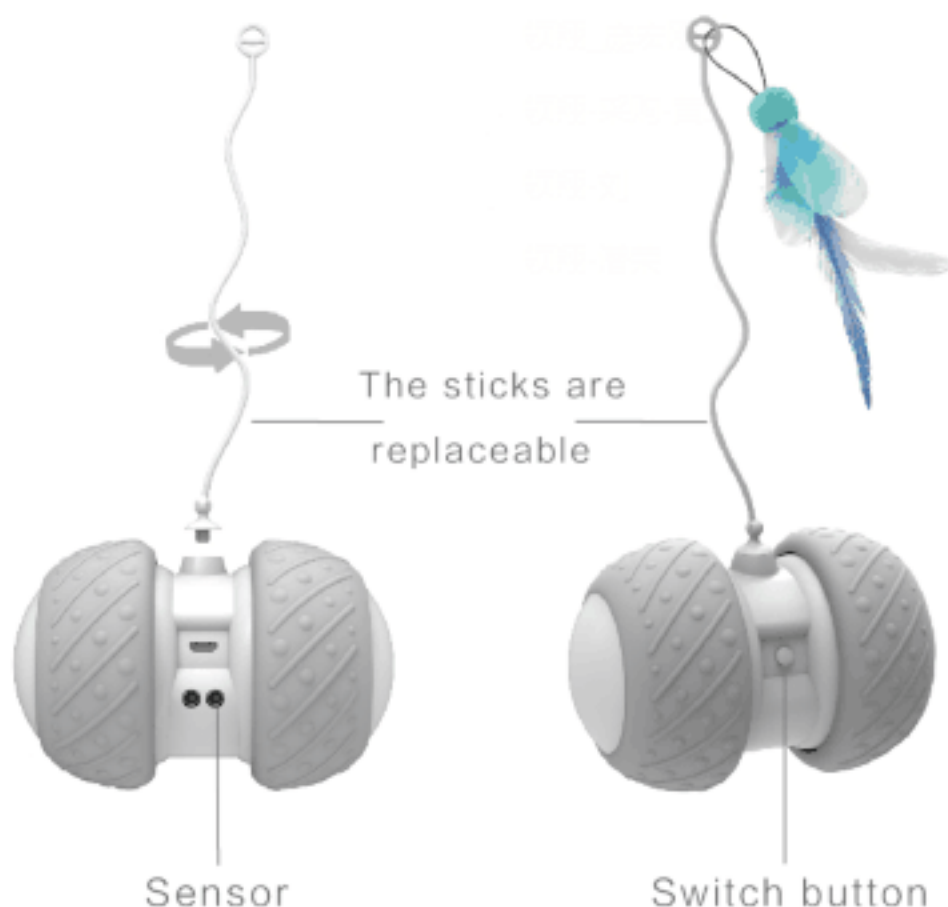

**Tips:** the sticks are consumable, can be purchased separately after damage

## FCC Statement

This device complies with Part 15 of the FCC rules. Operation is subject to the following two conditions: 1) this device may not cause harmful interference, and 2) this device must accept any interference received, including interference that may cause undesired operation.

Note: This equipment has been tested and found to comply with the limits for a Class B digital device, pursuant to part 15 of the FCC Rules. These limits are designed to provide reasonable protection against harmful interference in a residential installation. This equipment generates uses and can radiate radio frequency energy and, if not installed and used in accordance with the instructions, may cause harmful interference to radio communications. However, there is no guarantee that interference will not occur in particular installation. If this equipment does cause harmful interference to radio or television reception, which can be determined by turning the equipment off and on, the user is encouraged to try to correct the interference by one or more of the following measures:

- Reorient or relocate the receiving antenna.
- Increase the separation between the equipment and receiver.
- Connect the equipment into an outlet on a circuit different from that to which the receiver is connected.
- Consult the dealer or an experienced radio/TV technician for help.

Changes or modifications not expressly approved by the party responsible for compliance could void the user's authority to operate the equipment.

## Radiation Exposure Statement

This device complies with RF radiation exposure limits set forth for an uncontrolled environment. This transmitter must not be co-located or operating in conjunction with any other antenna or transmitter.