

DrBrown's™



Model Number BF100



Model Number BF101

INSTRUCTIONS FOR USE
Double Electric Breast Pump

PLEASE DO NOT RETURN THIS PUMP TO THE RETAILER.

If you experience any issues with your Dr. Brown's Pump, please contact our dedicated Customer Service team by:

<https://www.drbrownsbaby.com/contact/>

or

1-800-778-9001

**READ ALL INSTRUCTIONS BEFORE USING THIS PRODUCT.
PLEASE SAVE THESE INSTRUCTIONS.**

Table of Contents

- 1. Important Safeguards**
- 2. Product Description**
- 3. Getting Started**
- 4. Product Assembly**
- 5. Power Adaptor**
- 6. Operating the Pump**
- 7. Storing Breastmilk**
- 8. Preparing and Feeding Breastmilk**
- 9. Technical Data**
- 10. Troubleshooting**
- 11. Important Symbols**
- 12. Warranty**

1.Important Safeguards

**READ ALL INSTRUCTIONS BEFORE USING THIS PRODUCT.
PLEASE SAVE THESE INSTRUCTIONS.**

WARNING: Read this ENTIRE “Instructions For Use” manual to become familiar with the features of the product before operating. Failure to operate the product correctly can result in damage to the product, personal property and cause serious injury. Failure to operate this Product in a safe and responsible manner could result in injury or damage to the product or other property. This product is not intended for use by children. Do not attempt disassembly or use with incompatible components. This manual contains instructions for safety, operation and maintenance. It is essential to read and follow all the instructions and warnings in the manual, prior setup or use, in order to operate correctly and avoid damage or serious injury.

DANGER: To reduce the risk of electrocution:

- Always unplug electrical product immediately after use.
- Do not use while bathing.
- Do not place or store product where it can fall or be pulled into a tub or sink.
- Do not place or drop into water or other liquid.
- Do not reach for a product if it has fallen into water. Immediately unplug from electrical outlet.

WARNING: To avoid fire, electrocution, or injury:

- Danger of electrocution! Keep the device dry! Never immerse in water or other liquids! Do not run water over the pump.
- The breast pump and accessories are not heat-resistant: keep away from radiators, open flame and sunlight.
- Keep the power adaptor away from heated surfaces.
- Do not reach for any electrical device if it has fallen into water. Unplug immediately.
- Do not use outdoors, or operate where aerosol (spray) products are being used or where oxygen is being administered.

- The breast pump should never be left unattended when plugged into a power source.
- Never operate an electrical device if it has a damaged cord, plug or battery pack, if it is not working properly, if it has been dropped or damaged, or dropped into water. If damage is found, immediately discontinue use of power adaptor or battery pack and call Dr. Brown's Customer Service at 1-800-778-9001.
- Do not use the breast pump while bathing or showering.
- Close supervision is necessary when the breast pump is used in the vicinity of children.
- Follow the exact order of the steps in powering breast pump as listed on page 15 of this instructions for use.
- Only use the power adaptor supplied with the breast pump.
- The power adapter supplied with this unit is polarized (one prong is larger than the other). Always connect to a polarized outlet.
- Do not modify the polarized plug to fit into a non-polarized outlet.
- Make sure the voltage of the power adaptor is compatible with the power source.
- Do not use force to push the battery into the battery compartment.

CAUTION: To avoid risk of minor injury:

- Wash hands thoroughly with soap and water before touching breast pump, kit and breasts and avoid touching the inside of containers or lids.
- Separate and wash all parts that come in contact with breastmilk immediately after use to avoid dry up of breastmilk residue and prevent growth of bacteria. Always inspect breast flanges, connectors, valves, membranes and tubing prior to use for cleanliness.
- Only use drinking-quality tap or bottled water for cleaning your breast pump and parts.

WARNING: To avoid health risk and reduce the risk of injury:

- Do not store wet or damp parts as mold may develop.
- Do not run pump with wet tubing. Doing so will harm the pump motor.
- While some discomfort may be felt when first using a breast pump, using a breast pump should not cause pain.
- If you are experiencing discomfort at the base of the nipple due to rubbing of your breast tissue with the breast flange tunnel, discontinue use and contact your healthcare professional or breastfeeding specialist.
- For assistance with correct breast flange sizing and comfort please contact customer support at www.drbrownsbaby.com/contact/or contact a lactation consultant/breastfeeding specialist.
- Contact your healthcare professional or breastfeeding specialist if you can express only minimal or no milk or if expression is painful. See Section 8 for more information.
- Do not try and express with vacuum that is too high and uncomfortable (painful). The pain, along with potential breast and nipple trauma, may decrease milk output.
- Make sure tubing is not kinked or pinched while pumping. • Do not hold the pump kit by the bottle. This can lead to blockage of the milk ducts and engorgement.
- Do not thaw frozen breastmilk in a microwave or in a pan of boiling water. • Do not microwave breastmilk. Microwaving can cause severe burns to baby's mouth from hot spots that develop in the milk during microwaving. (Microwaving can also change the composition of breastmilk.)

2. Product Description

Dr. Brown's™ breast pump includes (2) collection kits:

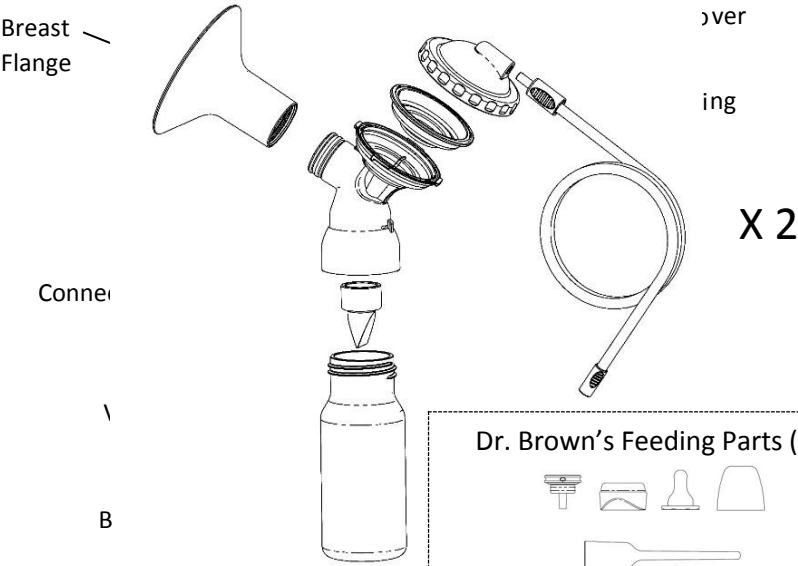

Includes (2) complete 4oz (120 ml) Dr. Brown's® Options +™ bottles:



Included Accessories:

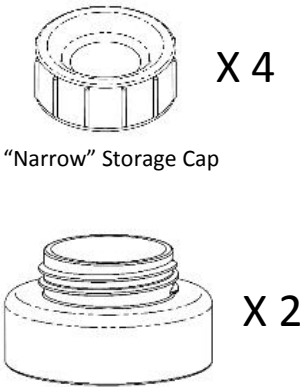

Your Dr. Brown's™ Double breast pump motor:

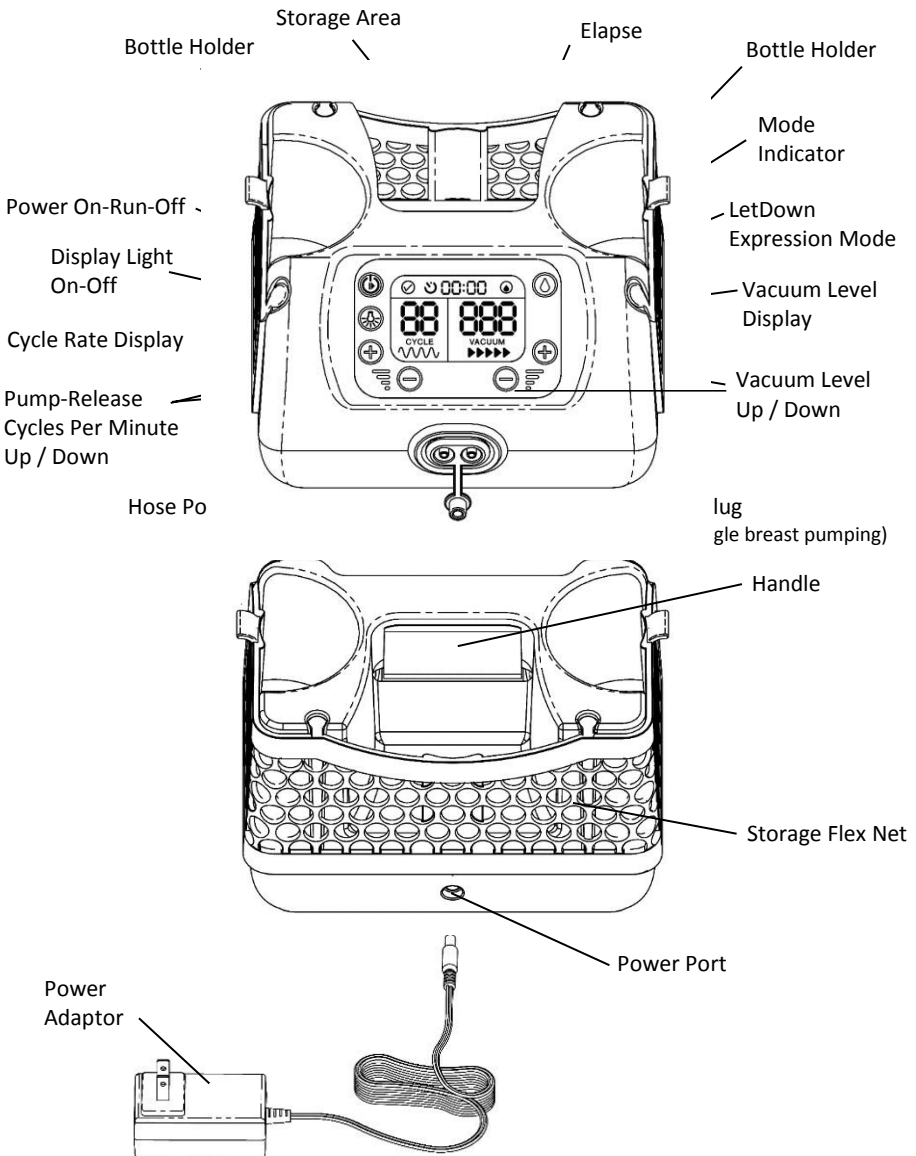

3. Getting Started

3-1. Disassemble

The Breast flange/Milk Collection Kit comes pre-assembled. All milk contact components must be disassembled, washed and sanitized.

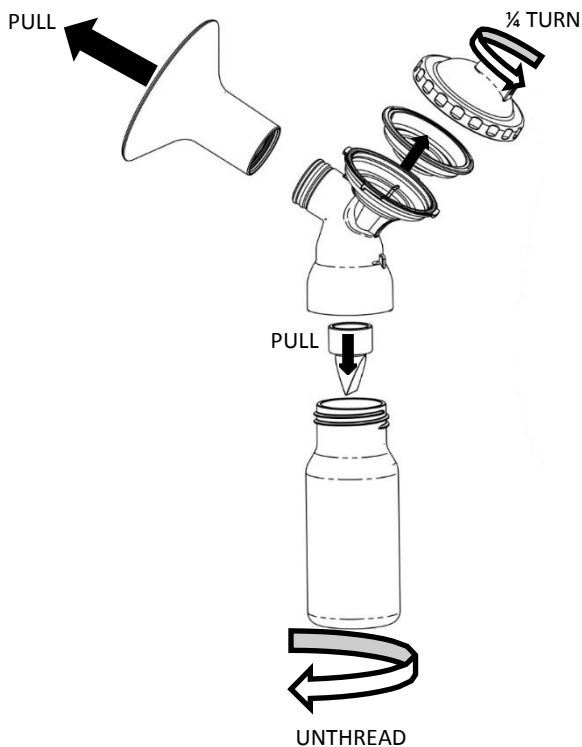

3-2. Wash

Separate and wash all milk contact components by hand in warm water with mild detergent and rinse with clear water or place in the top rack of dishwasher. *Only use drinking quality water for cleaning!*

Milk Contact Components

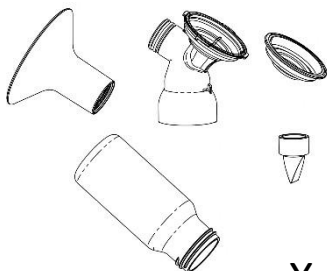

X 2

Non-Milk Contact (Wash If Required)



X 2

*See section 3-6 for special
tubing care instructions.*

Dr. Brown's Feeding Parts: Wash, Sanitize and save for bottle feeding. (See separate instructions for bottle assembly)

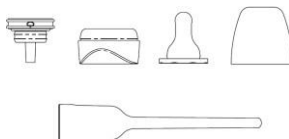

X 2

Hand Wash or place in Top Rack of Dishwasher

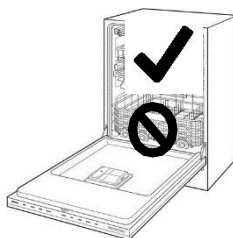

3. Getting Started continued

Do not submerge the pump motor in water! Wipe clean with a damp cloth only.



3-3. Dry

If not for immediate use or sanitizing: Allow all parts to air dry on a clean surface or towel.

NEVER store wet or damp parts. Store clean, dry pump kit in a clean bag or container until next use. Sanitize parts before each use.

3-4. Sanitize Before Use.

Separate all parts to be sanitized.

Method #1: Boil parts in a clean pot of water for 10 minutes.

Method #2: Use one of these Dr. Brown's™ Sterilizer Products.



Microwave Steam
Sterilizer Bags



Microwave
Steam Sterilizer



Deluxe Electric
Steam Sterilizer

Questions? Please visit www.drbrownsbaby.com/contact/ or call 1-800-778-9001

3-5. Dry after Sanitizing.

Allow all parts to air dry on a clean surface or towel.

NEVER store wet or damp parts. Store clean, dry pump kit in a clean bag or container until next use. Sanitize parts before each use.

3-6. Tubing Care.

The Tubing does not contact breastmilk.

Tubing should only be washed if dirty or condensation is present.

If the condensation is from a previous washing process, there is no need to wash again.

Use warm soapy water and rinse with clean clear water.

Allow water to drain from tubing completely after washing. Shake out any remaining water droplets and hang to dry. A small amount of condensation is ok; however, a tube filled with water droplets may damage the pump motor.

4. Product Assembly

4-1. Collection Kit Assembly

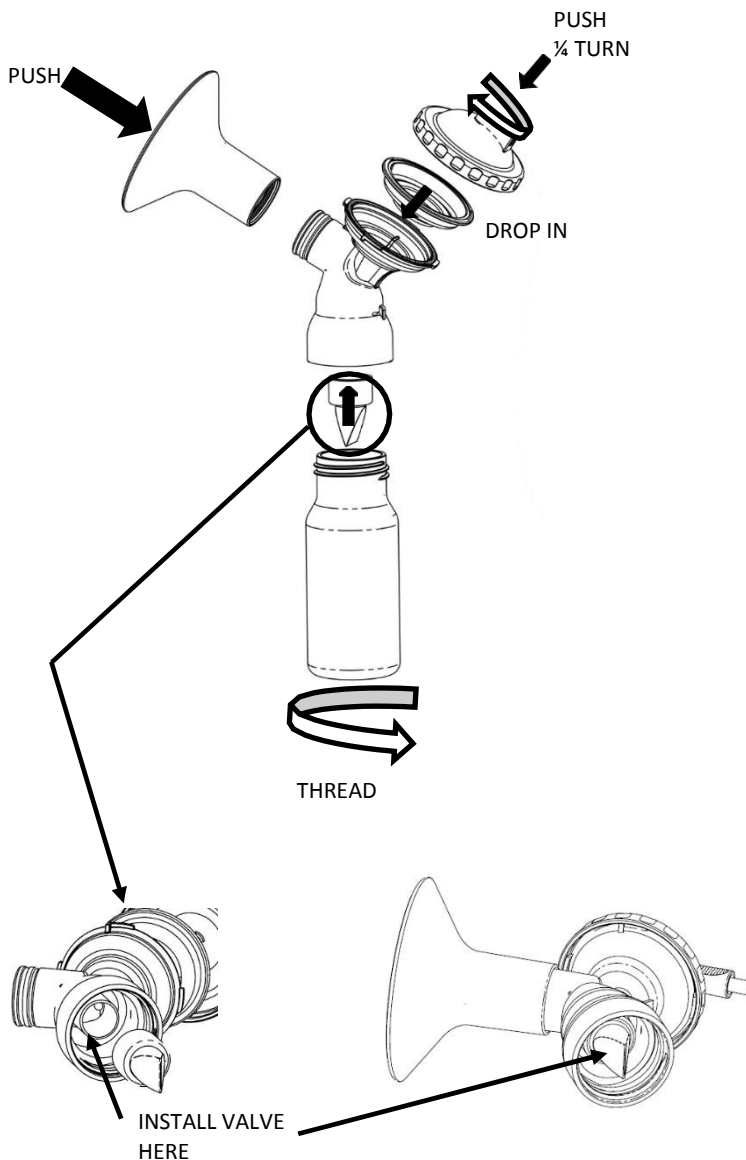

4-2. Tubing Connection

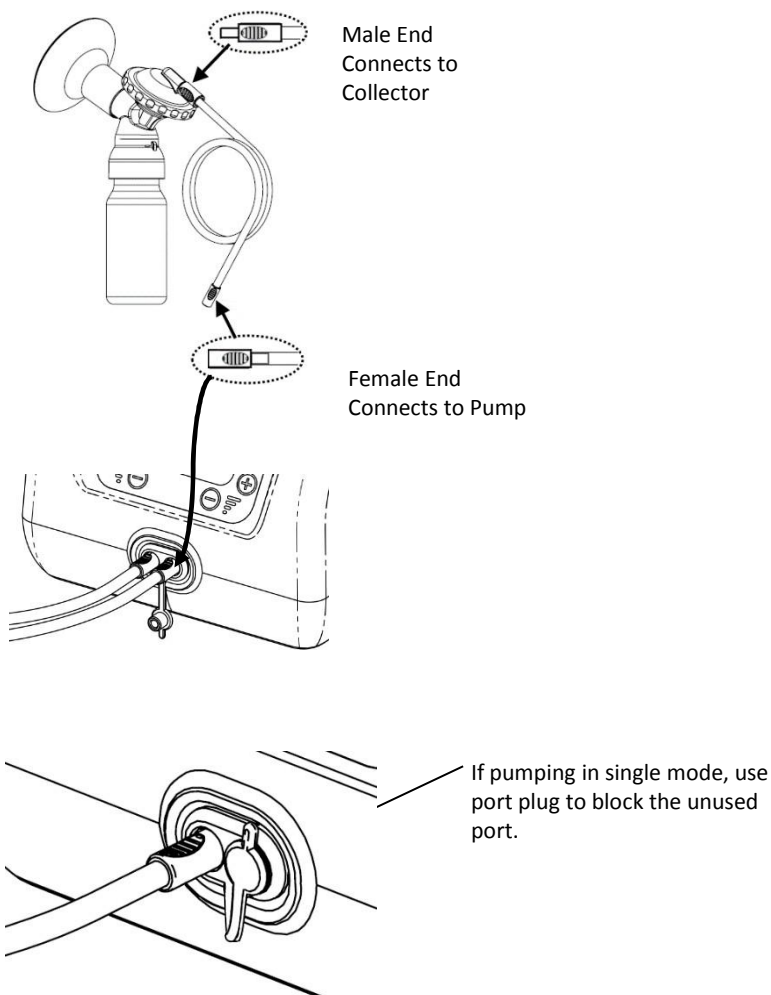

5. Power Adaptor

5-1. Power Connection

The power adaptor supplied with this unit is polarized (one prong is larger than the other). Always connect to a polarized outlet.

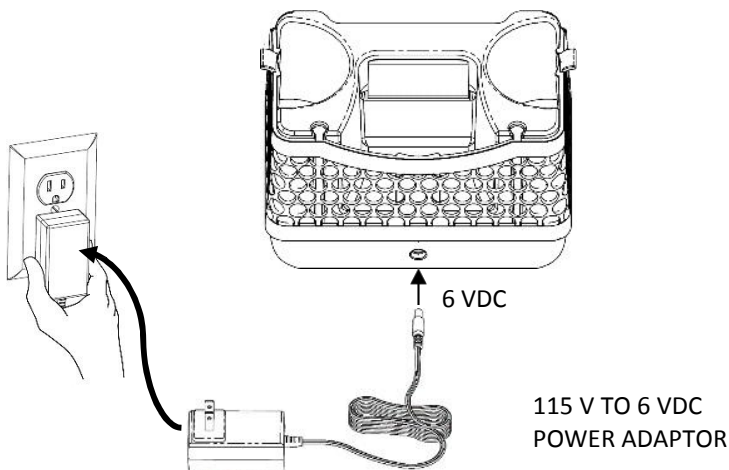

5-2. Power Adapter Care

To prevent damage to your power adapter cord, always grasp the body of the adapter as shown below. Never pull by the cord to unplug.

6. Operating the Pump

6-1. Pumping Modes

Two Modes are available:

- 1) **Letdown Mode**- Used to stimulates the release of milk from the breast. This mode helps prompt the reflex that happens when nerves in your breasts are stimulated (usually by your baby's sucking).
- 2) **Expression Mode**- Used after the breast is stimulated to release milk.

6-2. Using Letdown Mode

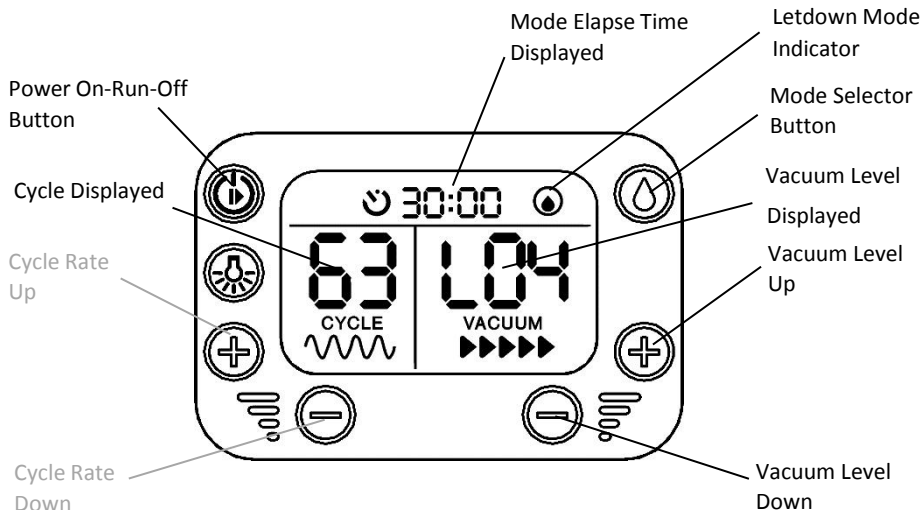

Letdown Mode uses a single (unchangeable) rapid 63 “pumps per minute” cycle setting, with (5) user selectable vacuum levels.

6. Operating the Pump

6-2. Using Letdown Mode (continued)

- 1) Select the **[Power Button]** to turn the unit on.
The pump will automatically display Letdown Mode at the last used vacuum level used (this pump has a memory feature that recalls the last used settings for both modes).
- 2) Adjust the vacuum level to your preferred comfort level using the Vacuum Level **[Up]** or **[Down]**. There are five settings from which to choose, L1 thru L5.
- 3) Press the **[Power Button]** again to start pumping.
- 4) Letdown Mode will automatically change to Expression Mode after 2 minutes. See Mode Elapse Time on display.

6-3. Using Expression Mode

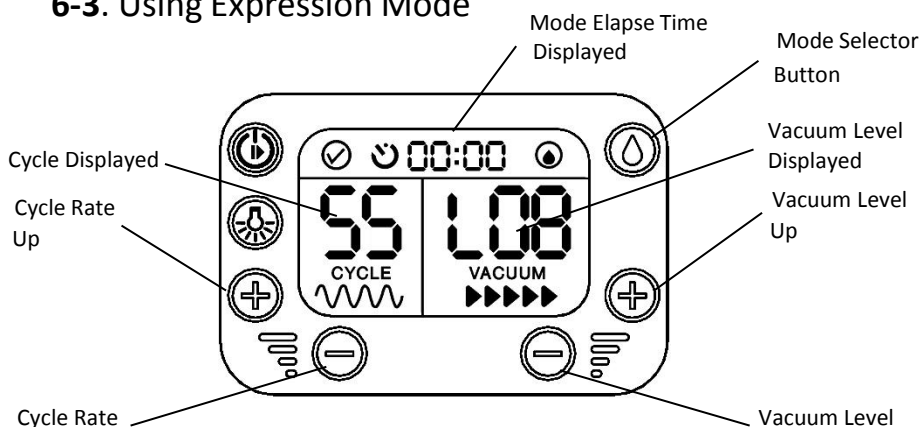

Expression Mode has (6) “pump-release cycles” per minute rates, each with (12) user selectable vacuum levels.

6-3. Using Expression Mode (continued)

4. Select the **[Mode Selector Button]**. When in Expression mode, the Letdown mode symbol  will disappear.
The pump will automatically start in the last used cycle and vacuum levels (this pump has a memory feature that recalls the last used settings for both modes).
5. Adjust the vacuum level to your preferred comfort level using the **Vacuum Level [Up]** or **[Down]**. There are twelve settings from which to choose, L1 thru L12.
6. Adjust the cycle rate to your preferred comfort level using the **Cycle Rate [Up]** or **[Down]**. There are five settings from which to choose: 36, 40, 43, 46 and 49.
7. Letdown Mode will automatically change to Expression Mode after 2 minutes. See Mode Elapse Time on display.

6-4. Pumping with a Single Collector

Plug a hose into either port on the front of the pump. Place the port plug in the empty port. Select the vacuum level for performance and comfort. You will need to use a lower vacuum level setting than for pumping with two collectors.

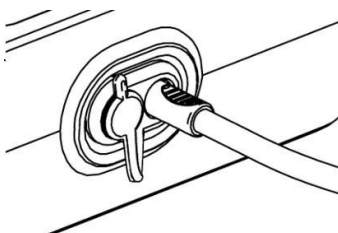

6. Operating the Pump

6-5. Placement of the Collection Assembly

Center the breast Flange on your breast so that the nipple is aligned with the tunnel portion. Make sure your breast completely fills the Flange to ensure a seal and that a vacuum can form.

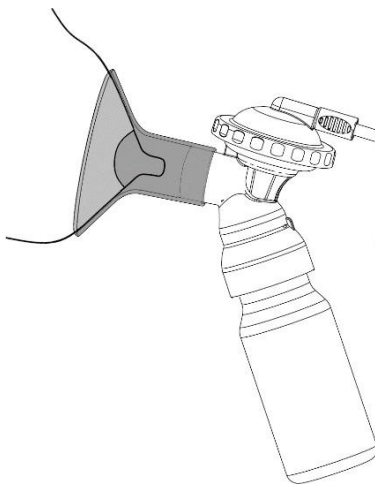

While you may feel some discomfort when first breast pumping, it should not cause pain. Adjust the Cycle and Vacuum levels to lower settings to achieve your comfort level and milk flow.

If you continue to have problems, please contact us at:
www.drbrownsbaby.com/contact/
or call 1-800-778-9001

For hands free pumping, consider using a pumping bra.

6-6. Storing a Collection Assembly

Often when double pumping, one side is finished before the other. The completed side may be removed from the breast and placed in the convenient half-moon bottle holders or large storage space in the back of the pump housing. The expandable netting will secure the bottle and assembly without risk of spillage.

You will need to adjust the vacuum level after removing one collection unit from a breast to maintain performance and comfort level of the remaining unit.

Helpful tip for one handed operation:

*When using **Narrow Bottles** for collection, easily place the finished assembly in the **half-moon holders**.*

*When using the optional **Wide Bottles** for collection, easily place the finished assembly in the **rear storage area**.*

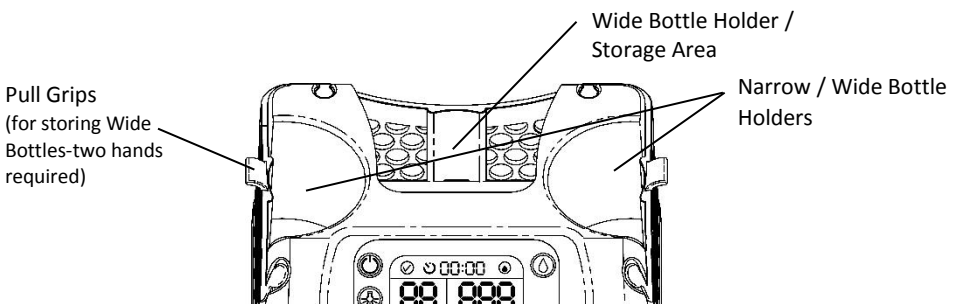

7. Storing Breast Milk

7-1. Milk Storage Containers

You may store expressed milk directly in the bottle after pumping. Simply unthread from the Collector assembly and attach a clean sterilized storage cap (included).

We recommend you store milk in our disposable Dr. Brown's™ Breastmilk Storage Bags (sold separately) for easy identification and space savings.



7-2. Milk Storage Guidelines

Guidelines Are for Home Use and Not for Hospital Use.

Use the following guidelines for the storage of breastmilk. By following recommended storage and preparation techniques, nursing mothers and caretakers of breastfed infants and children can maintain the safety and quality of expressed breast milk for the health of the baby. These are general guidelines for storing breast milk at different temperatures. Various factors (milk volume, room temperature when milk is expressed, temperature fluctuations in the refrigerator and freezer, and cleanliness of the environment) can affect how long breast milk can be stored safely.

Human Milk Storage Guidelines			
	Storage Locations and Temperatures		
Type of Breast Milk	Countertop 77°F or colder (25°C) (room temperature)	Refrigerator 40°F (4°C)	Freezer 0°F or colder (-18°C)
Freshly Expressed or Pumped	Up to 4 hours	Up to 4 days	Within 6 months is best Up to 12 months is acceptable
Thawed, Previously Frozen	1-2 hours	Up to 1 day (24 hours)	Never refreeze human milk after it has been thawed
Leftover from a Feeding (<i>baby did not finish the bottle</i>)	Use within 2 hours after the baby is finished feeding		
Adapted from "ABM Clinical Protocol #8: Human Milk Storage Information for Home Use for Full-Term Infants," Revised 2017  .			

****Breast Milk Storage Guidelines Center for Disease Control and Prevention (“CDC”);**
https://www.cdc.gov/breastfeeding/recommendations/handling_breastmilk.htm

8. Preparing & Feeding

8-1. Fresh Breast Milk

If the milk is freshly expressed or thawed to feeding temperature, simply feed in a clean sanitized bottle. Discard any remaining milk after 2 hours.

8-2. Refrigerated Breast Milk

Warm the milk to desired feeding temperature in a clean sanitized bottle. Place the sealed bottle in a bowl of warm water for 20 min to body temperature.

CAUTION: Do Not Warm Breast Milk In The Microwave Or Boiling

8-3. Frozen Breast Milk

Thaw breast milk overnight in the refrigerator. You can quickly thaw breast milk by holding the frozen vessel under warm running water. Thawed breast milk is safe in the refrigerator for 24 hours.

CAUTION: Do Not Thaw Breast Milk In The Microwave Or Boiling Water.

Warm the thawed milk (see 8-2) to desired feeding temperature and feed in a clean sanitized bottle. The warmed milk is safe for up to 2 hours.

Need a faster way to safely thaw and warm breast milk?

The Dr. Brown's® MilkSpa™ Breast Milk and Bottle Warmer quickly and gently thaws and warms milk in storage bags or bottles. The patented pulsating water action warms without overheating, which can reduce nutrients.

Visit www.drbrownsbaby.com for details.

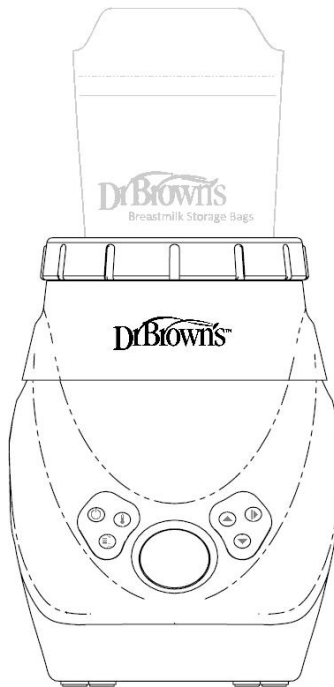

9. Technical Data

9-1. Power Supply

AC Wall Plug Adaptor: 100-240V 50/60 Hz 0.3A Max
Output: 6 VDC 2.0A

Regulatory Compliance: XXXXXX

9-2. EMF Compatibility

Wireless Statement:

Wireless communications equipment such as wireless home network devices, mobile phones, cordless telephones and their base stations, walkie-talkies can affect the electric breast pump and should be kept at least a distance 1.0 m away from the equipment. Electromagnetic Compatibility (EMC, IEC 60601-1-2:2007, Table 1)

FCC Statement:

This device complies with part 15 of the FCC Rules. Operation is subject to the following two conditions: (1) This device may not cause harmful interference, and (2) this device must accept any interference received, including interference that may cause undesired operation.

Stacking:

The electric breast pump should not be used adjacent to or stacked with other equipment. If adjacent or stacked use is necessary, the electric breast pump should be observed to verify normal operation in the configuration in which it will be used.

Note:











This equipment has been tested and found to comply with the limits for a Class B digital device, pursuant to part 15 of the FCC Rules. These limits are designed to provide reasonable protection against harmful interference in a residential installation. This equipment generates, uses and can radiate radio frequency energy and, if not installed and used in accordance with the instructions, may cause harmful interference to radio communications. However, there is no guarantee that interference will not occur in a particular installation. If this equipment does cause harmful interference to radio or television reception, which can be determined by turning the equipment off and on, the user is encouraged to try to correct the interference by one or more of the following measures:

- Reorient or relocate the receiving antenna.
- Increase the separation between the equipment and receiver.
- Connect the equipment into an outlet on a circuit different from that to which the receiver is connected.
- Consult the dealer or an experienced technician for help.

9. Troubleshooting

Issue	Possible Causes	Checks	Solution
No Power	Adaptor	Check if the power cord is not connected or it is damaged.	Confirm if plugged into working wall outlet and in power port in back of the pump.
No Suction	Tubing	Check connection to Collector and to Pump port(s) on the front of the unit.	Confirm connections.
Low Suction	Tubing	Inspect tubing for holes or cracks.	Replace tubing if crack is in the middle of the length. If cracked near tube ends, remove end and trim away damage tube and reinstall tube end.
	Assembly Error	Check for Loose assembly of Collection Components.	Disassemble and Reassemble. Take care to tighten the Membrane Cover.
	DuckBill Valve	Check for Damage.	Replace Valve if damaged.
	Breast Flange	Check for Damage. Flange is completely on the breast.	Replace if damaged. Press more firmly against the breast.
	Silicone Membrane	Check for Damage.	Replace Membrane if damaged.
Pain	Too high suction	Check the suction level.	Set to the lowest suction level or consult your lactation consultant or physician.

10. Important Symbols

	This symbol indicates do not dispose the device together with unsorted municipal waste (in accordance with local regulations).
	This symbol indicates compliance with international requirements for protection from electric shock. (Type BF applied parts.)
	This symbol indicates that the power adaptor is a class II device.
	This symbol indicates that the power adaptor is for indoor use only.
	This symbol indicates the compliance with USA and Canada safety requirements.
	This symbol indicates the compliance with the essential requirements of the Council Directive 93/42/EEC of 14 June 1993 concerning medical devices.
	This symbol indicates polarity of D.C. power connector.
	This symbol indicates alternating current. (The type from your wall outlet)
	This symbol indicates direct current. (The type required to power the pump device)
	This symbol indicates that this device is for a single user.
	This symbol indicates that this device should be kept dry.

11. Warranty

Warranty

This breast pump device is warranted against defective material or workmanship for a period of one year from the date of purchase. Any defective part will be repaired or replaced at no charge if it has not been tampered with and appliance has been used according to these printed instructions. This warranty gives you specific legal rights as well as other rights which vary from state to state.

Customer Service

If you experience unsatisfactory operation or have any questions/comments, call Handi-Craft's Customer Service at 1-800-778-9001, or write to:

Handi-Craft Company, Customer Service, 4433 Fyler Avenue, St. Louis, Missouri 63116 USA.

Our Customer Service Representative will advise you how to correct the problem yourself, or will ask you to return the product for repair or replacement.

Warning: Changes or modifications to this unit not expressly approved by the party responsible for compliance could void the user's authority to operate the equipment.

NOTE: This device complies with part 15 of the FCC Rules. Operation is subject to the following two conditions: (1) This device may not cause harmful interference, and (2) this device must accept any interference received, including interference that may cause undesired operation.

FCC Statement:

This equipment has been tested and found to comply with the limits for a Class B digital device, pursuant to part 15 of the FCC Rules. These limits are designed to provide reasonable protection against harmful interference in a residential installation. This equipment generates, uses and can radiate radio frequency energy and, if not installed and used in accordance with the instructions, may cause harmful interference to radio communications. However, there is no guarantee that interference will not occur in a particular installation. If this equipment does cause harmful interference to radio or television reception, which can be determined by turning the equipment off and on, the user is encouraged to try to correct the interference by one or more of the following measures:

- Reorient or relocate the receiving antenna.
- Increase the separation between the equipment and receiver.
- Connect the equipment into an outlet on a circuit different from that to which the receiver is connected.
- Consult the dealer or an experienced radio/TV technician for help.

Distributed By:

Handi-Craft Company St. Louis, Missouri 63116 USA/Etats-Unis/EE.UU.
drbrownsbaby.com (800) 778-9001
Made in China. Fabriqué en Chine. Fabricado en China.
May be patented, see drbrownsbaby.com/patents . Ces produits peuvent faire l'objet de brevets. Consultez drbrownsbaby.com/patents . Puede estar patentado, vea drbrownsbaby.com/patents .
©2019 Handi-Craft Company. All Rights Reserved. ©2019 Handi-Craft Company. Tous droits réservés. ©2019 Handi-Craft Company. Todos los derechos reservados. F1

DR. BROWN'S and all other trademarks are owned or used under license by Handi-Craft Company.
DR. BROWN'S et toutes les autres marques de commerce sont la propriété ou utilisées sous licence par Handi-Craft Company.
DR. BROWN'S y todas las demás marcas registradas son propiedad o se usan bajo licencia de Handi-Craft Company.

Manufactured By:



Guangzhou Yongyi Industrial Co., Ltd.
B3 Factory, No. 29 Dongsan Street, Qixin Road,
Dongchong, Nansha Distric, GuangZhou, 511453
GuangDong, P.R.C.

