



SWIMMING POOL ALARM INSTRUCTION MANUAL

This product has been designed to aid in the detection of unwanted intrusions into unsupervised pools. POOLSAVIOR IS A SAFETY ALARM SYSTEM AND NOT A LIFE SAVING DEVICE. This device is not intended to replace any other safety consideration- i.e., adult supervision, lifeguards, fences, gates, pool covers, locks, etc., and some devices may not detect gradual entry.

"NSF CERTIFIED TO THE ASTM SAFETY SPECIFICATION F 2208"

DO'S AND DONT'S

SWIMMING POOL SAFETY WARNINGS

1. Supervise children at all times.
2. Never permit swimming alone. Never leave a child alone, even briefly.
3. Always remove the entire solar cover from a pool before swimming.
4. Avoid mixing alcohol with water activities.
5. Ensure your pool area is fenced and gated, with locks to prevent unauthorized access, and consider installing a gate alarm.
6. Secure all doors leading to the pool area and consider installing door alarms.
7. Have a responsible adult teach swimming and water safety to your children.
8. Maintain clean and clear water in the pool.
9. Avoid swimming during storms, especially electrical storms. - they will be glad to assist you.
10. Do not permit bottles, glass, or sharp objects to be used around the pool.
11. Consult your pool dealer for advice on improving pool safety - they will be glad to assist you.
12. Above all: remember that common sense, awareness, and caution are essential for enjoying your pool safely.

PACKAGE CONTENTS

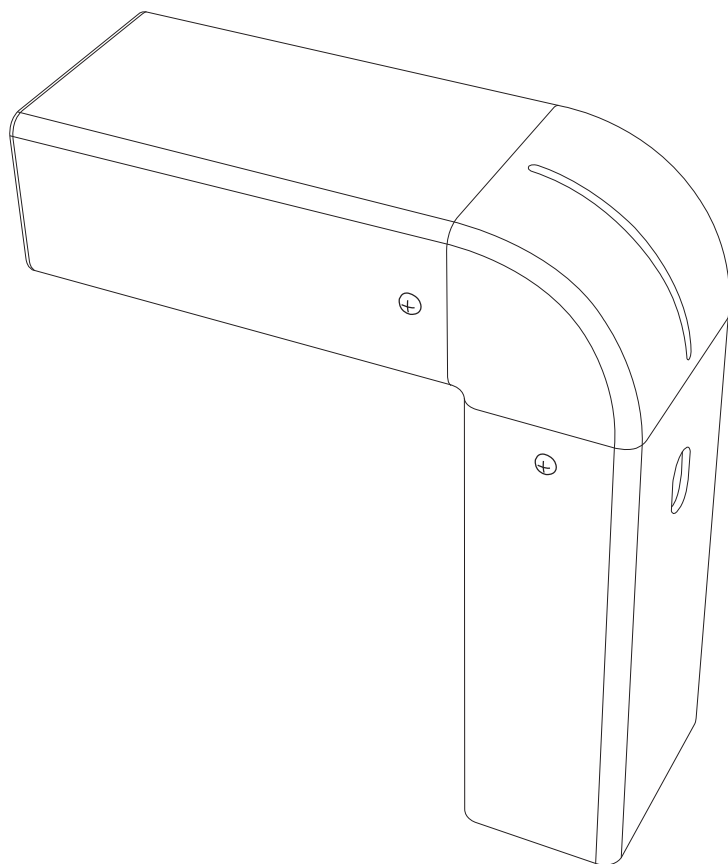

Pool Unit

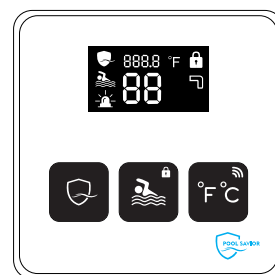

Home Unit

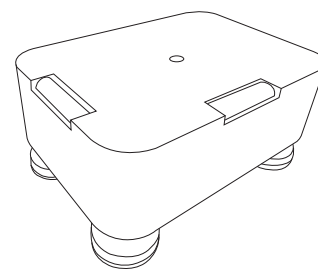

Pool Unit Stand



Pool Unit handle

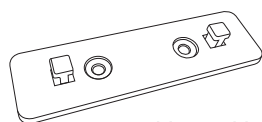

Home Unit
Mounting Bracket



Swimming
pool drilling template

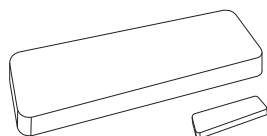

Bracket sponge pad

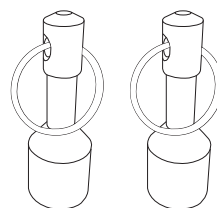

Reset Key x2

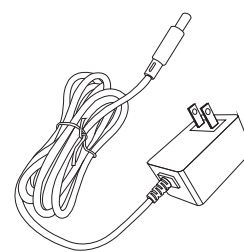

Power Supply cable x2



3M EVA foot pads x4



Plastic expansion wall plug
6*25MM x2

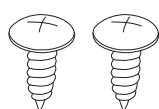

Screw M4*12mm x2

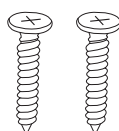

Screw M3.5*20mm x2

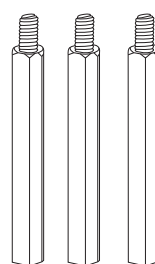

Ground connection
metal pin x3



Screw installation tool

PRODUCT DIAGRAM

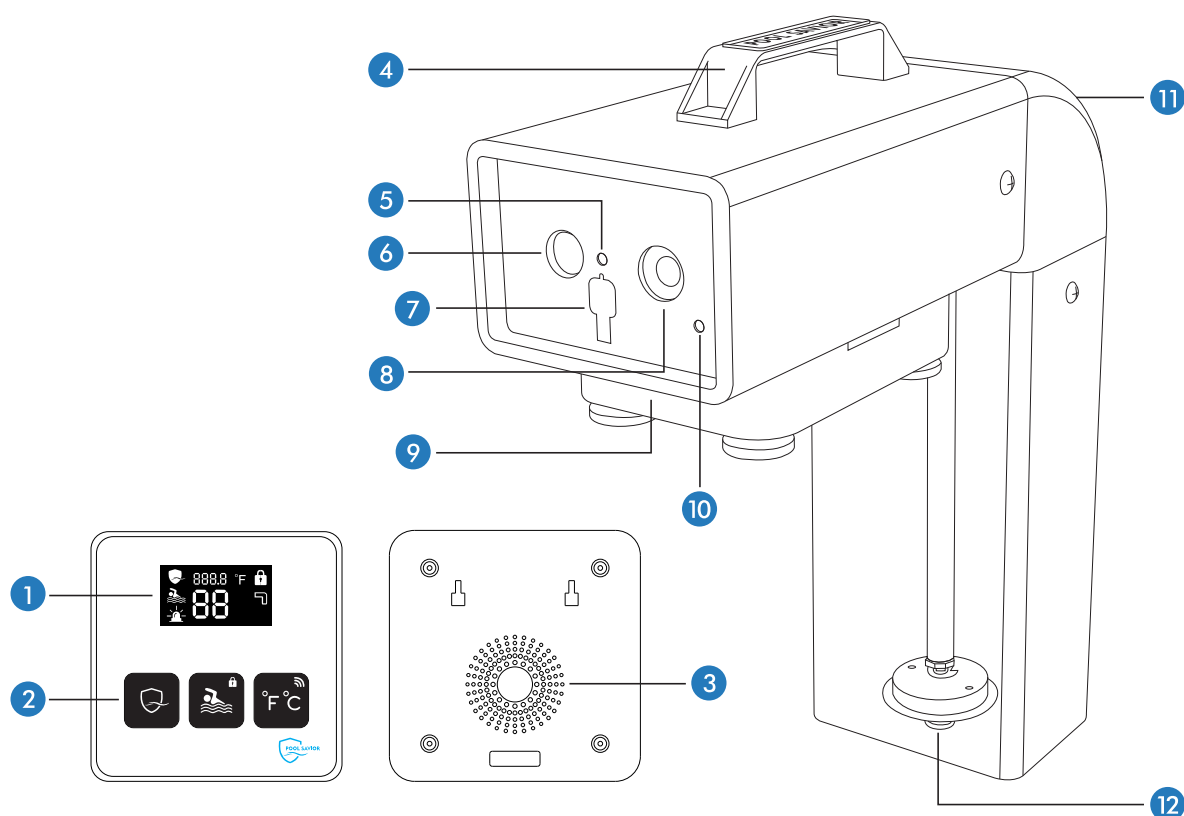

1. Home Unit display
2. Home Unit buttons
3. Buzzer speaker
4. Pool Unit handle

5. Interface/ Alarm Light
6. Reset Key Port
7. Charging Port
8. Siren

9. Pool Unit Stand
10. Charging Light
11. Alarm Light
12. Detection Sensor

Specifications

Model	Pool Alarm
Charging voltage / current	9.0V/1100mA (Max)
Wireless frequency band	433Mhz (product maximum operating frequency 433.92 MHz)
Wireless distance	A distance of 50 meters, if 3 walls are inbetween. Avoid to place large metal objects between Pool and Home Unit. (If it is in an open space without obstacles, the straight-line distance can reach up to 200 meters)
Dust and water resistance level	IPX4
Buzzer sound decibel	Alarm sound when tested at 3,5 meters from the product: 85 - 98 db Tested close to the product: 120db (Max)
Built-in battery capacity	7.4V/4000mAh
Operating voltage	Pool unit: 6.5V-8.4V Indoor unit: DC: 9.0V
Working current	Pool unit: 50uA-30MA (alarm sound state ≤ 600 MA) Indoor unit: ≤ 40 MA (alarm sound state ≤ 600 MA)
Charging time	5-8 hours
Power adapter	INPUT: 100-240V 50/60Hz, 0.5A Max OUTPUT: 9.0V, 2000mA

POOL UNIT INSTALLATION

Before use, some simple installation needs to be completed.

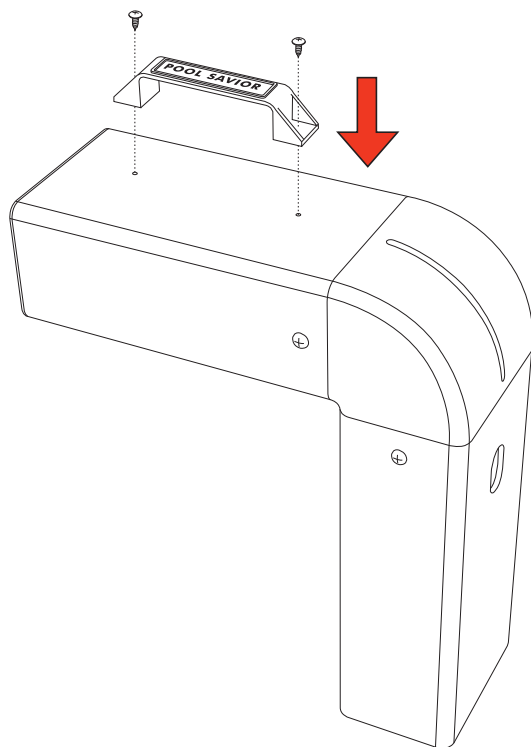

- 1** Use the installation tool to install the handle above the alarm device.

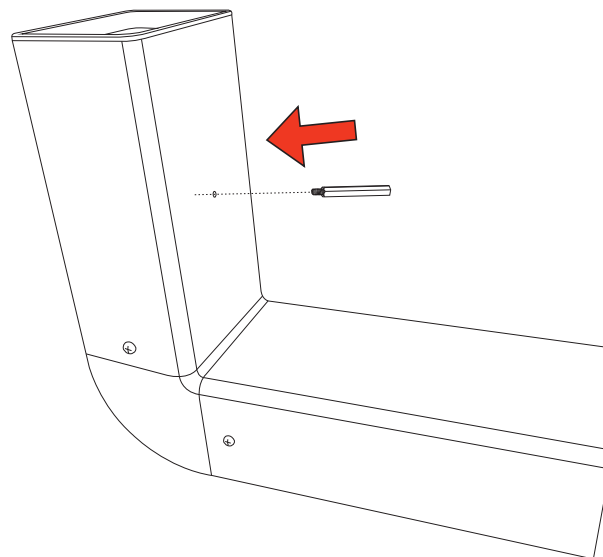

- 2** Manually screw the metal pin into the bottom of the alarm device.

- 3** First, place the drilling template on the side of the swimming pool, aligning one side with the edge of the swimming pool, then use an electric drill to align the hole on the template, and drill a 7mm diameter hole in the floor tile beside the swimming pool, with a depth of not less than 7cm.

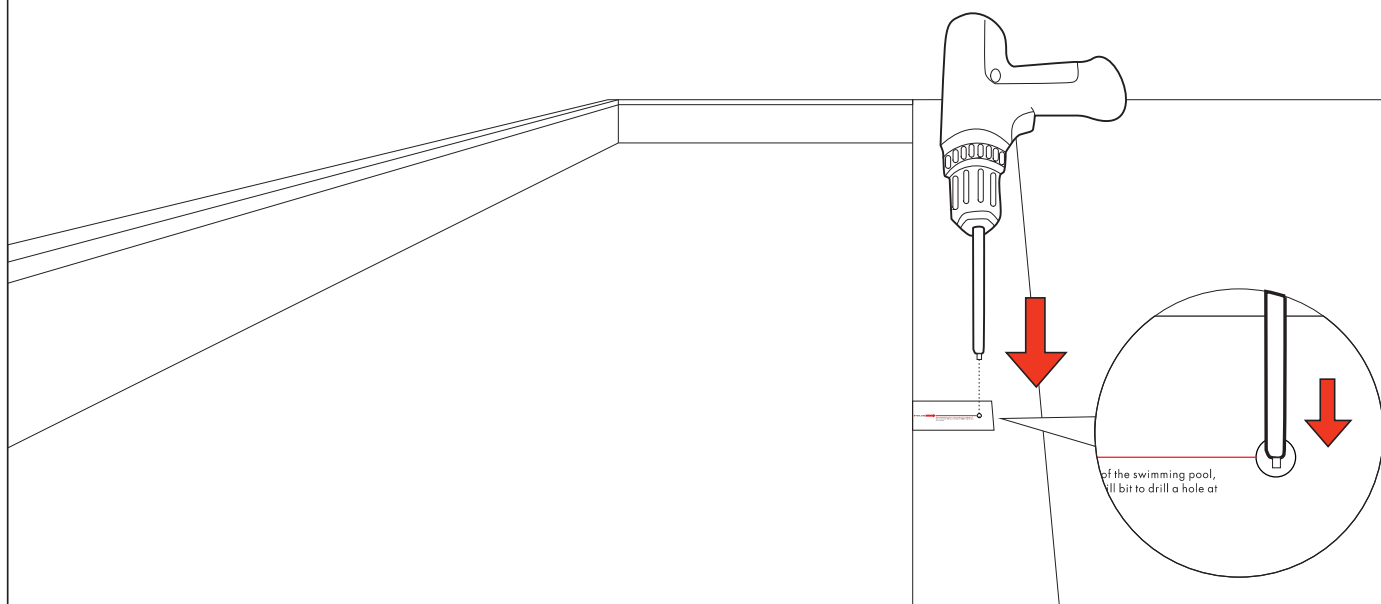

POOL UNIT INSTALLATION

- 4 Insert the grounded metal rod at the bottom of the pool alarm into the hole and make sure it does not shake or loosen, and does not easily tilt and fall into the water.

Note: The pool alarm device can only achieve normal waterproofness and cannot be soaked in water for a long time. Once it falls into the water, it may affect its use, so please pay attention when installing it to ensure stability.

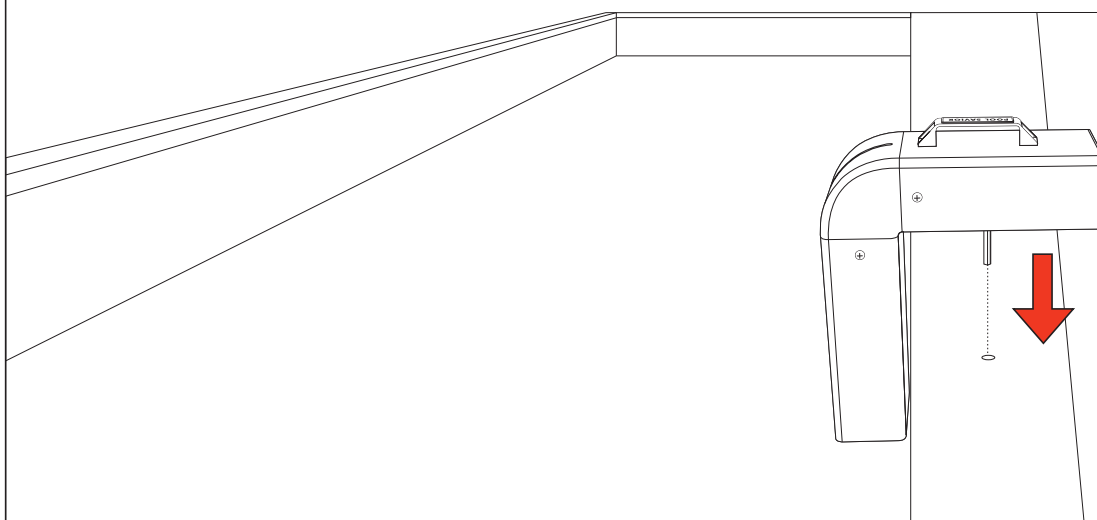

- 5 When the pool alarm is placed on one side in the water and the water level is just below 5.91 inches (15cm) and above 2.36 inches (6cm), the pool alarm can work effectively. There is no need to use the pool equipment bracket. Simply insert the grounding metal pin at the bottom of the pool alarm into the hole.

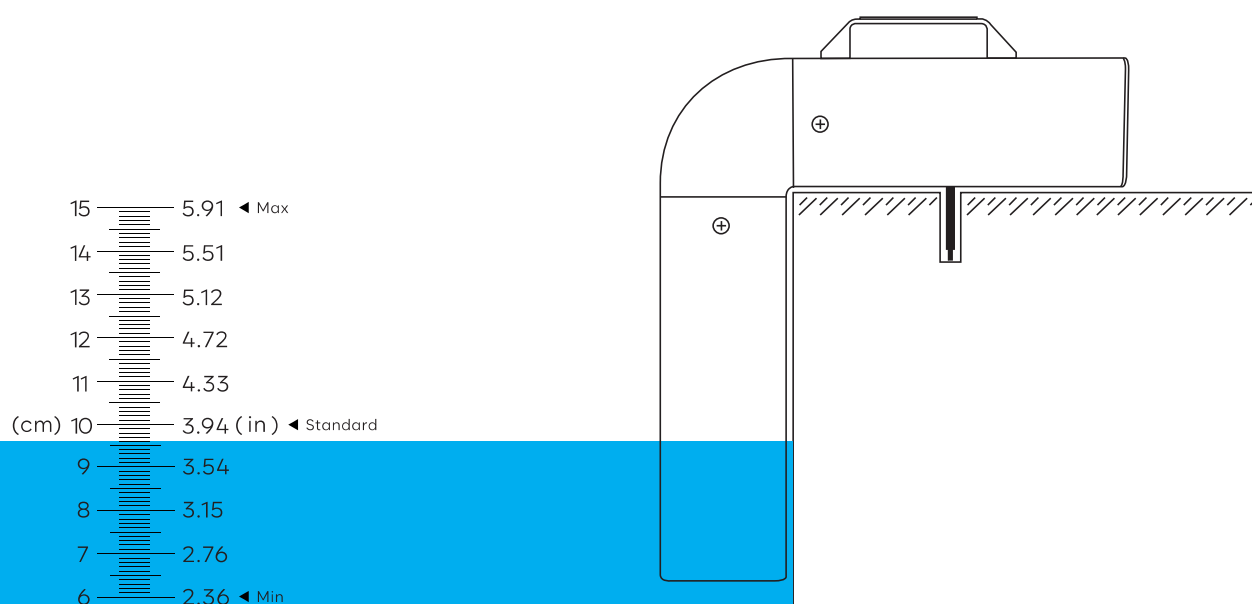

POOL UNIT INSTALLATION

- 6** When the water level of the pool is 5.91 inches (15cm) higher than the pool alarm, you need to use the pool equipment bracket to increase the height of the pool alarm. Before that, you need to manually rotate and tighten the other two metal rods in the accessories to the connected metal rods to extend their length, and then pass through the hole in the center of the pool equipment bracket, and then insert it into the hole drilled on the side of the pool.
- If the water level is still 5.91 inches (15cm) higher than the pool alarm, you can adjust the height through the 4 legs at the bottom of the pool equipment bracket and use the level to check whether the pool equipment bracket is in a parallel state (when the bubble in the level is centered, the pool equipment bracket is in a parallel state).

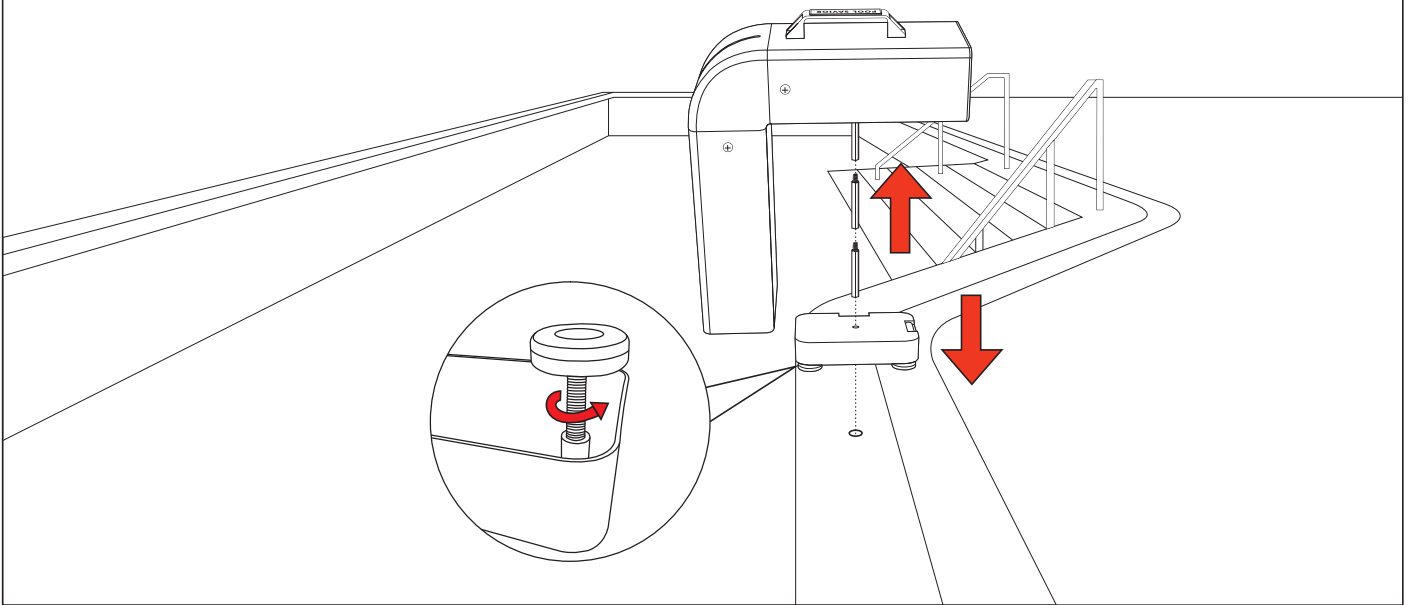

- 7** **Note:** The Pool Unit Stand is compatible with water levels ranging from 6 inches (15.4 cm) to 1.5 inches (3.8 cm). If the water level is below 1.5 inches (3.8 cm), the stand cannot be used, and alternative solutions, such as a custom stand, may be necessary. However, this may affect the effectiveness of the alarm sensor.

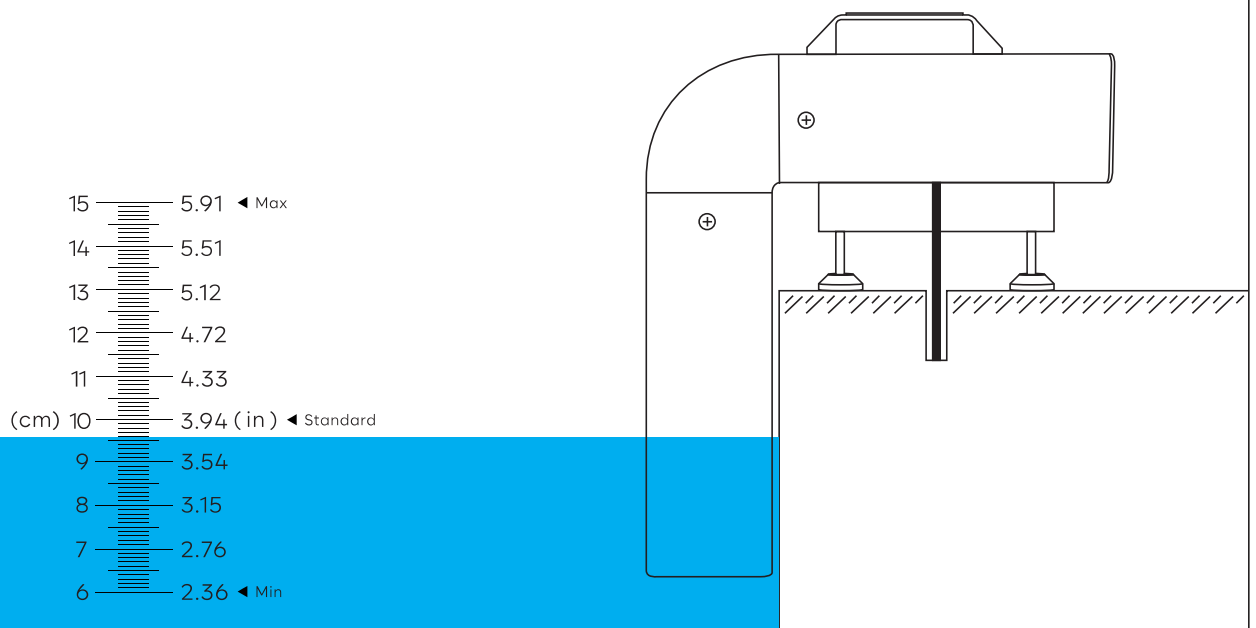

HOME UNIT INSTALLATION

There are three ways to install the home unit. You can choose one of them according to the installation location.

1. If the wall is not suitable for sticking 3M sponge pads and it is easy to fall off, you can choose to use a bracket to install it.

Before installation, you need to hold the bracket to mark the position of the screw holes on the wall, and then use an electric drill to drill two holes with a diameter of 6.5mm and a depth of 27mm according to the position of the screw holes, and then put the plastic plugs into the holes, and then use two M3.5x20mm screws to fix the bracket to the wall, and finally stick the large rectangular 3M sponge pad on the bracket, and then stick the small rectangular 3M sponge pad on the small raised square below the back of the home unit, and finally stick the home unit on the bracket.

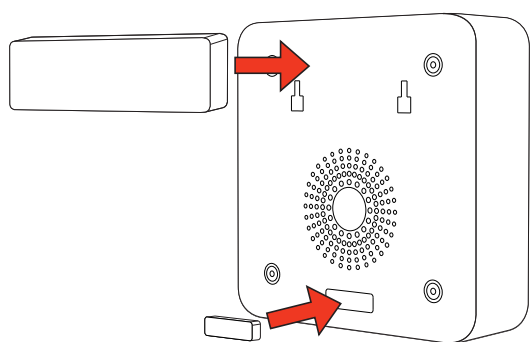
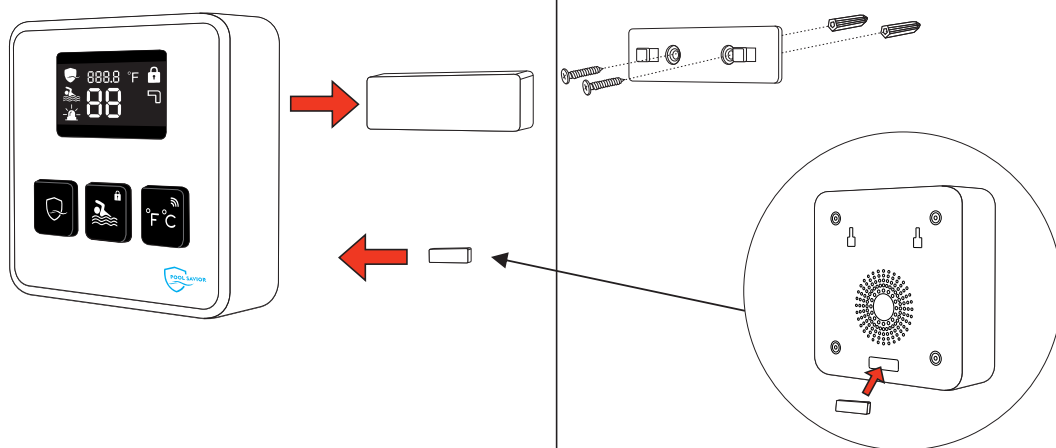

2. If your wall is strong, just stick two rectangular 3D sponge pads on the back of the home unit and then stick them on the wall.

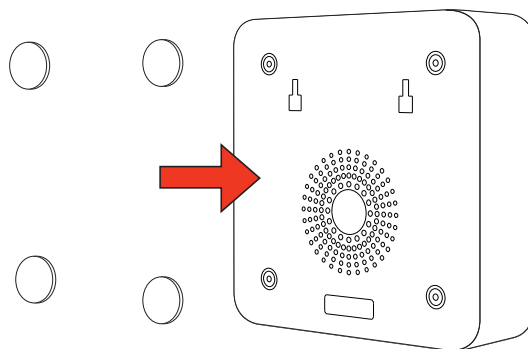

3. If you don't like using the rectangular 3M sponge pad for installation, you can also choose four round sponge pads to stick on the four corners of the home unit, and then stick them on the wall.

INTRODUCTION

Important components of swimming pool alarm system

The Pool Alarm monitors the pool and is intended to alarm when an intrusion into the pool is detected. The alarm system consists of two main units:

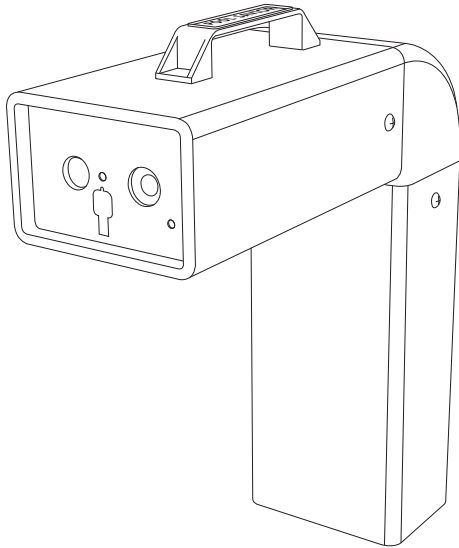

The Pool Unit (Fig. 1)

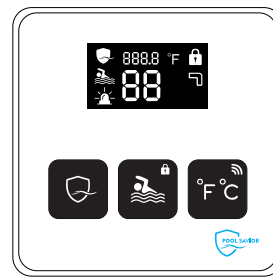

The Home Unit (Fig. 2)

The Pool Unit will be installed on the pool deck (in accordance with the Pool Savior guidelines), while the Home Unit installation is located inside the house not more than 164 feet/ 50 m away, with no more than 3 walls in between (depending of the type of wall even 1 can cause signal irritation).

We recommend to install the Home Unit at a point where the pool is in sight. The Pool and Home Units communicate wirelessly and offer the user different features, such as a swim timer and pool temperature display.

In this manual, we will explain the different units in detail.

IMPORTANT SAFETY WARNINGS

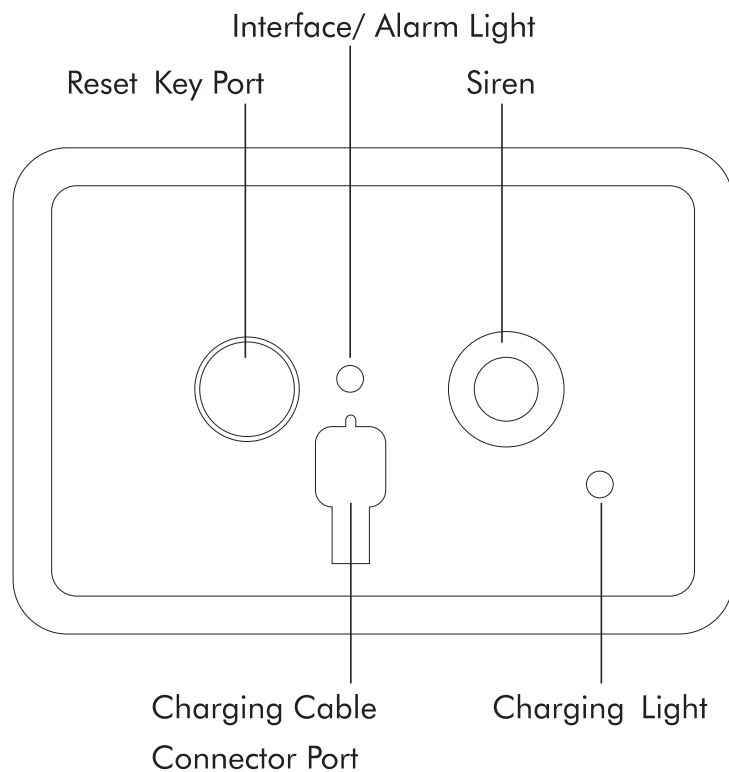

Even the Pool Alarm is crafted from durable ABS material. Pool users should be informed not to pull, kick, or drop the Pool Alarm.

In the event that the Pool or Home Unit falls into the pool accidentally, promptly remove it and drain any water from it. The Pool Unit is splash waterproof and should not be submerged in the pool water. Before use, thoroughly test the alarm according to the manual to ensure correct operation.

Caution: keep the reset keys out of reach of children, as they can deactivate the alarm and pose a swallowing hazard. Follow all the safety and operating instructions in this manual.

Please turn the return line eyeball fittings of your pool system towards the bottom of the pool.

Do not use the alarm in combination with any type of pool cover. If your pool has special water features such as a waterfall or automatic cleaning systems, reach out to our customer support at **support@poolsavior.com** for individual installation consultation.

Do not use the Pool Alarm in temperatures under 32 degree Fahrenheit, as the sensor might not detect pool entry when the water surface is frozen.

LIGHT INTERFACE

Light Interface

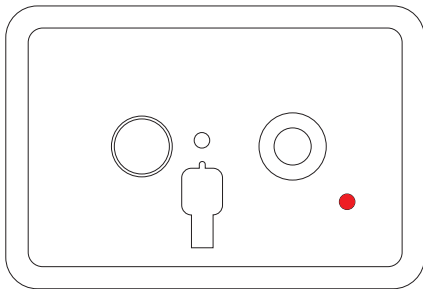

Charging

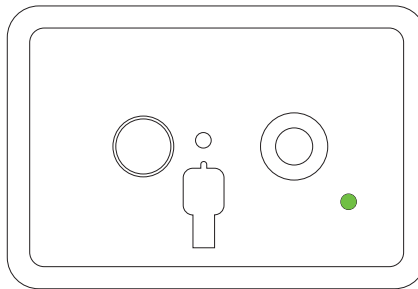

Fully Charged

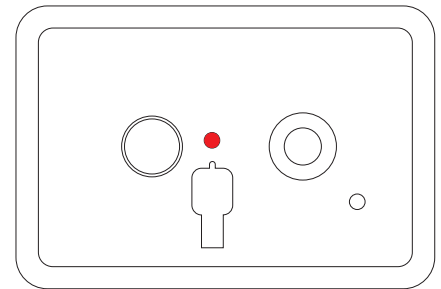

Alarm Light

Power ON

Hold one of the magnetic keys onto the key port for 6 seconds. The Pool Unit light and sound signal 4 times rapidly, with each signal lasting 0.5 seconds to indicate that the unit is switched ON.

Power OFF

Hold one of the magnetic keys onto the key port for 6 seconds. The Pool Unit light and sound signal for 2 seconds continuously to indicate that the unit will switch OFF.

Automatic Connection Mode

After turning the Pool Unit ON, the light signals for 20 seconds rapidly, with each signal lasting 0.5 seconds to indicate the automatic connection mode..

Pairing Mode

If the automatic connection is not successful, the Pool Unit light signals every two seconds, for 3 minutes.

Monitoring

When the system is in monitoring mode, the Pool Unit light signals once every 30 seconds.

Alarm

If an intrusion into the pool is detected, the Pool Unit light and sound signal every 1 second continuously for 5 minutes. (after 5 minutes the alarm will automatically stop and the system will reset to monitoring mode).

Calm Mode

After an alarm is deactivated, the calm mode automatically activates. Over a period of 5 minutes, the light and sound signal every 20 seconds for 4 seconds continuously. The system will reset to monitoring mode after 5 minutes.

Connection Lost

If the Pool and Home Unit lose connection the light and sound signal once every 2 seconds, for 5 minutes. The system will reset to monitoring mode after 5 minutes.

LIGHT INTERFACE

Low Power

If the Pool Unit battery is low the light and sound signal for 10 seconds rapidly, with each signal lasting for 0.5 seconds. This repeats once every 1 minute for 5 minutes long. After 60 minutes it will repeat.

Swimming Mode

When the swim timer is activated, the Pool Unit light signals 3 times for 3 seconds with 1 second off inbetween. After 1 minute off, it will repeat and will do so until the swim timer is over or is deactivated.

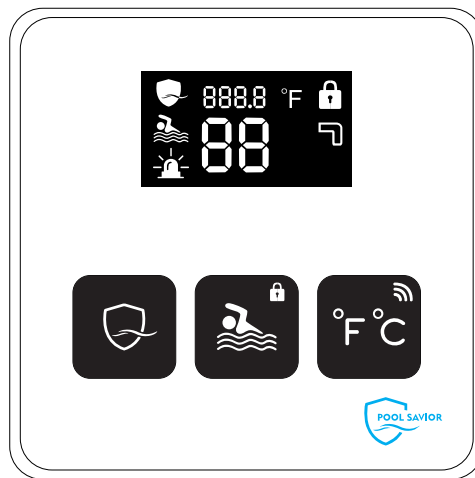

Power ON

The light signal circles 360 degree to indicate that the Home Unit is ON and ready to be used.

Alarm

The light and sound signal every 1 second continuously for 5 minutes. (after 5 minutes the alarm will automatically stop and the system goes back to monitoring mode).

Calm Mode

After an alarm is deactivated, the calm mode automatically activates. Over a period of 5 minutes, the light and sound signal every 20 seconds for 4 seconds continuously. **You can set the swim timer mode for 5 minutes to overwrite the calm mode.**

THE POOL UNIT

Charging the Pool Unit

The Pool Unit can be charged using either of the two included power cables fitting for outlets with 100-240V with 50/60Hz.

To charge the Pool Unit, open the water protection rubber cap to access the charging connector. Insert the cable into the charger, and the right side light indicator will illuminate in red, indicating charging. This light will remain until the unit is fully charged, at which point it will turn green. The battery in the Pool Unit is 4000 mAh large and lasts for 50 days.

Please Note: When the battery capacity drops below 20%, the Pool Unit will emit a rapid 10-second light flashing and sounding alarm every minute for 5 minutes. This cycle will then repeat after 60 minutes. Please ensure that the Pool Alarm is fully charged before proceeding with the installation. The charging process typically takes 5 to 8 hours.

Installing the Pool Unit

Before installing the Pool Unit, please measure the distance from the pool deck surface to the water level. If this distance falls between 5.2 - 8.7 inch (13.2 cm - 22.1 cm), you can install the Pool Alarm without using the included Pool Unit stand. Please note that, an uneven placement of the Pool Alarm can result in less accurate sensor performance.

The Pool Unit includes markers that indicate the optimal area where the water level should be within. Position the Pool Unit at the edge of the pool, extending into the water. This is where the swimming sensor detects movement below the surface. Installation of the Pool Unit Stand is contingent upon the deck material and surface and may involve drilling a hole for a stabilising metal pin. Included in the packaging are three metal pins that can be connected to the Pool Unit and as an extension to each other, providing flexibility in installation and ensuring a secure connection with the stand and ground. For simplified installation, a drill hole template is provided.

IMPORTANT: Before installing the Pool Unit, it's crucial to remove the foam piece that serves as protection for the sensor during transport. This foam piece prevents the sensor from getting damaged while the alarm is being transported or stored. Once the foam piece is removed, you can proceed with the installation.

Please ensure that the position you choose for installation adheres to our guidelines. For reference, please review the following graphics depicting various pool shapes and the optimal installation orientations.

THE POOL UNIT

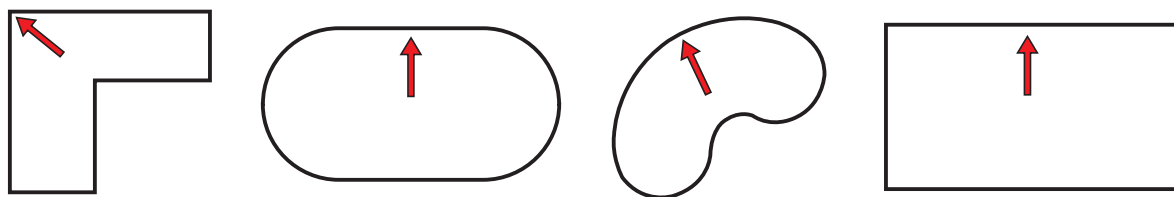

Do not place the alarm on the same side of the pool where a pool ladder is located, and avoid using it with any form of pool cover.

For pools exceeding 800 square feet (74.32 square meter) in size, possessing more than 2 return lines, exhibiting concerns regarding size, or featuring irregular shapes or water elements like waterfalls or automatic cleaners please reach out to our customer service at **support@poolsavior.com** to determine the recommended number and placement of alarms.

De/ activating the Pool Unit

To activate the Pool Unit, simply hold one of the reset keys to the key port (see Fig. 3) for 6 seconds until an indicator light accompanied by a beep, is prompting 4 times rapidly, with each signal lasting 0.5 seconds to confirm the device status ON.

The Pool Unit is now ON and will try to connect with the Home Unit. The indicator light flashes once every 0.5 seconds for the first 20 seconds to indicate the automatic connection state, followed by single light flash every 2 seconds for 3 minutes to indicate the pairing state. Afterward, the alarm light will blink once every 30 seconds to indicate that it is ON. (If the Pool and Home Units successfully connect during the automatic connection or pairing process, they will automatically exit that state and transition to monitoring mode.)

Hold the reset key to the key port for 6 seconds until a 2 second long red light and beep sound confirm the device status is OFF.

The Pool Unit Stand

The Pool Unit is designed to be placed at the pool deck, positioned at the edge of the pool. Depending on the water level, it may be necessary to utilize the Pool Unit Stand. The Pool Unit stand features two water-levels, providing overview to achieve the best balanced position. Additionally, the four legs can be adjusted by turning to extend or shorten them as needed. The Stand not only facilitates levelling the Pool Unit to a horizontal position for optimal monitoring results but also provides stability.

The Pool Alarm can effectively function when the water level is between 1.5 - 8.7 inch (3.8 cm - 22.1 cm) below your deck level. In the range of 5.2 - 8.7 inch (13.2 cm - 22.1 cm), it can operate without the Pool Unit Stand. In the range of 1.5 - 5.2 inch (3.8 cm - 13.1 cm), the stand is required. If the water level is more than 8.7 inch (22.1 cm) from the pool deck, the Pool Alarm cannot be used. The Pool Unit Stand is compatible with water levels ranging from 6 inches (15.4 cm) to 1.5 inches (3.8 cm). If the water level is below 1.5 inches (3.8 cm), the stand cannot be used, and alternative solutions, such as a custom stand, may be necessary. However, this may affect the effectiveness of the alarm sensor..

THE HOME UNIT

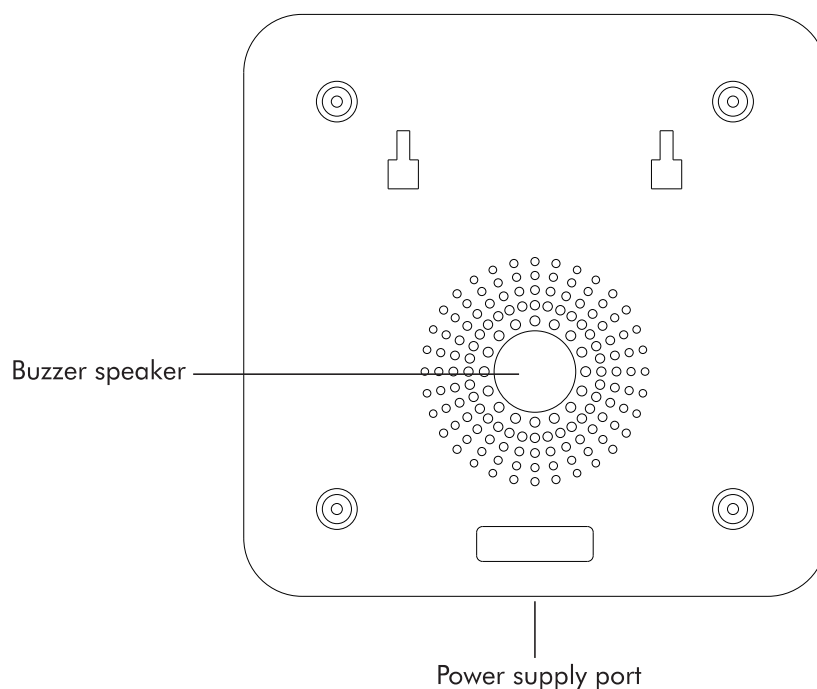
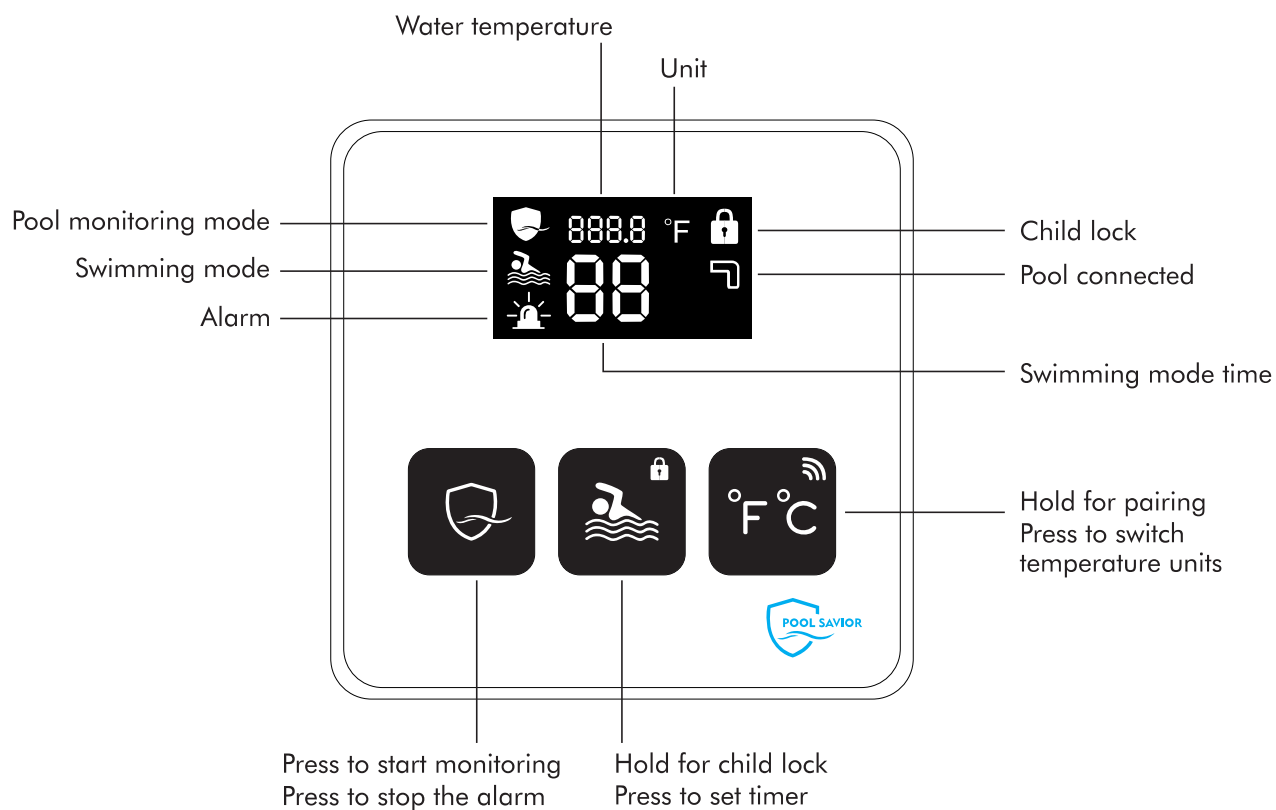

THE HOME UNIT

Installing the Home Unit

The Home Unit functions as the central control hub of the system and should be positioned within 164 feet (50m) with no more than 3 walls between the hub and the Pool Unit (avoid steel walls or any other large metal objects or obstructions that might interfere with the signal reception and do not place the Home Unit in a basement or anywhere below the pool water level).

Notes:

1. Do not install the Home Unit outdoors. The Home Unit is designed to extend the alarm sound inside the house and is not weather or splash water resistant.
2. It is advisable to install the Home Unit at a location offering clear visibility of the pool area.
3. Ensure the chosen position is near an electric outlet, as the Home Unit requires continuous power. Upon connecting the power cable to the port on the lower side of the unit, the Home Unit will indicate readiness with a light signal travelling 360 degrees around its side.

Installation on the wall is straightforward and can be achieved using either the provided 3M tape or a screwing setup.

Alternatively, utilize the screwing setup by drilling two holes, inserting the included rawlplugs, and securing the unit holder to the wall. Once mounted, slide the Home Unit into place.

Operating the Home Unit

Equipped with three buttons and a high-contrast black and white screen, the Home Unit facilitates various functions, including arming the alarm, setting swim timers, activating child lock, and switching between Fahrenheit and Celsius. Additionally, it supports the reconnection process if needed.

The Home Unit comes with a cover foil that emphasizes its functions and provides explanations for the screen information. Even after removing the foil, there is a legend on the top of the Pool Unit that outlines the button functions.

IMPORTANT: The manufacturer is not responsible for any radio or TV interference caused by unauthorized modifications to this equipment. Such modifications could void the users authority to operate the equipment.

Connection setup

Upon powering ON, the Home Unit will attempt to establish automatic connection with the Pool Unit. Ensure that the Pool Unit is charged and switched ON before activating the Home Unit. If both units are installed as per the manual instructions, the connection process will occur seamlessly.

Upon successful connection, the Pool Alarm icon will appear on the right side of the screen as confirmation. If the icon does not appear, verify that the Home and Pool Units are positioned within 164 feet (50m) and no more than 3 walls apart.

The Pool Unit indicator light flashes once every 0.5 seconds for the first 20 seconds, which is the automatic connection state, followed by light flashes once every 2 seconds for 3 minutes for the pairing state. And will then flash every 30 seconds once after that.

In case of connection issues, press and hold the  button for 5 seconds to initiate a new connection attempt. The reconnection will take up to 30 seconds. The Pool Unit icon will flash during the process and remain steady upon successful connection.

THE HOME UNIT

Note: If the Home Unit loses connection to the Pool Unit (for example because a child pulled the power cable of the Home Unit), the Pool Unit will keep monitoring, and will also give a special light and sound signal after 30 seconds to indicate lost connection. (see Light Interface - Connection Lost)

Temperature measurement

The Home Unit can display temperature readings in both Celsius and Fahrenheit. To switch between these measuring units, press the  button.

Setting up the swim timer

To set the swim timer, press the  button to cycle through the available time options: 5 minutes, 10 minutes, 20 minutes, 30 minutes, 60 minutes, 2 hours, 5 hours, 12 hours, 24 hours, 2 days, 3 days, 4 days, 5 days, 6 days, 7 days, 10 days, and 21 days. Once you reach the desired time, wait for 5 seconds, and the alarm will automatically activate the timer. The swimming icon will appear on the screen next to the timer.

In swim timer mode, the LED at the Pool Unit will flash in a distinctive light pattern (see Light Interface - Swimming Mode) to signal the special condition.

IMPORTANT: Please note that it can take up to 30 seconds for the Home Unit to communicate the start of the swim timer to the Pool Unit. For safety reasons, refrain from entering the pool within 30 seconds after setting up the swim timer.

Arm the alarm

You can activate the alarm at any time. If a swim timer is currently running, activating the alarm will automatically end the swim timer. To arm the alarm, press the X1 button. The monitoring icon will appear on the screen  replacing the swim timer icon, indicating that the alarm is armed and active.

Note: Please do not arm the alarm immediately after swimming. It is recommended to wait for the water to calm down before arming it again, to avoid false alarms.

Alarm testing

To confirm proper functionality, press the  button and wait for 30 seconds to ensure the alarm is in monitoring mode. Then, simulate waves 6 - 9 feet (1.8 - 2.7 meter) from the device or simply jump into the pool to test the sensor's response. The alarm should activate, indicating its functionality.

Stop the alarm

During an alarm situation, you can press and hold the  button for 2 seconds to stop the alarm, returning the system to monitoring mode. You can also use one of the 2 included reset keys and hold it for 1 second at the key port of the Pool Unit to turn the alarm off.

IMPORTANT: After an alarm is triggered and subsequently turned off, the alarm system will automatically enter a 5-minute non-monitoring mode to allow the water to calm down. After this period, it will automatically rearm itself. This 5-minute non-monitoring mode is indicated by a special light signal at the Pool Unit (see Light Interface - Calm Mode).

THE HOME UNIT

Child lock

To activate the child lock feature, press and hold the  button for 3 sec. Once activated, the lock icon will appear on the screen, and all buttons will become non-functional.

Pressing any button will only illuminate the screen and cause the lock icon to blink. To deactivate it, press and hold the  button again for 3 sec.

Note: In the event of an alarm, the child lock remains active. To stop the alarm, you must press and hold the  button for 3 seconds.

TROUBLESHOOTING & FALSE ALARM

Adjust the return line fittings

Avoid placement near return lines: Do not place the pool alarm too close to a return line, and ensure that no return line is pointing in the direction of the alarm. Turbulence caused by the return lines can trigger false alarms or interfere with the alarm's ability to detect intrusion.

If your pool has more than two return lines, it's advised to contact customer support via email at support@poolsavior.com for further guidance.

Adjust Eyeball Fittings: adjust all the eyeball fittings on your return lines to prevent water flow from interfering with the pool alarm. Pointing the eyeball fittings downward helps maintain proper water circulation while preventing algae growth and ensuring the proper functioning of the pool alarm.

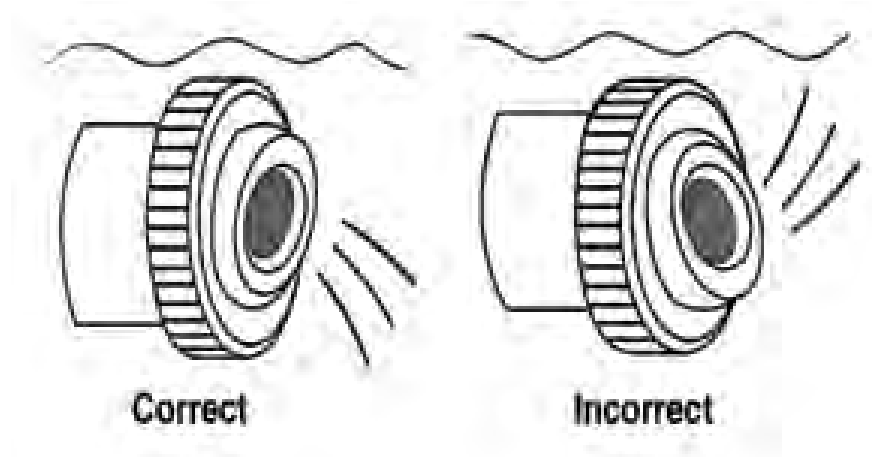

Troubleshooting & false alarms

Weather and Wind: while the pool alarm is stationary on the pool deck, strong or steady winds causing significant water movement can trigger false alarms. On extremely windy days, it's advised to either activate the swim timer for several hours or remove the alarm from the pool. Light wind and rain typically do not affect the alarm.

Monitoring Mode After Swimming: false alarms can occur if the alarm enters monitoring mode too quickly after swimming. It's recommended to allow the timer to run down naturally after swimming, as it may take 5 to 30 minutes for the pool water to calm down depending on the pool size.

Automatic Cleaners: certain automatic cleaners may trigger the pool alarm. Setting the swim timer for the duration of cleaning sessions can help mitigate this issue.

Water Features: water features like waterfalls or waterslides can also cause false alarms. To avoid this, install the pool alarm away from these features. If determining the best position is challenging, customers can reach out to customer service for assistance.

Alarm Placement: incorrect placement of the alarm can lead to false alarms. The unit should be placed on a flat, solid surface for optimal results. The water level on the throat of the unit should also be checked regularly.

Water Level: confirm that the pool alarm is positioned so that the water level falls within the instructed measurements. A water level outside of the instructed reach, can lead to false alarms. (see Fig. 7) By following these recommendations, users can minimize false alarms and ensure the effective functioning of the Poolsavior Pool Alarm. Remember that we are always at your disposal for any questions, issues or suggestions. Please don't hesitate to reach out to us at support@poolsavior.com.

Connection issues

If you encounter connectivity issues between the Home and the Pool Unit, you can troubleshoot using the following steps:

1. Check Pool Unit:

Ensure that the Pool Unit is charged and powered on. Initiate a reconnection by pressing and holding the  button on the Home Unit for 5 seconds to attempt a new connection. The reconnection may take up to 30 seconds.

2. Check Distance and Location:

Confirm that the Pool and Home units are within 164 feet (50m) distance from each other. Verify that there are no more than 3 walls, metal walls, or heavy metal objects obstructing the signal path between the units, as they can cause interference.

3. Check Signals:

Identify if there are any other wireless communication products in the vicinity. Visit the websites related to these products to gather signal information. Test if other signals are causing interference by temporarily turning them off and checking if the Home and Pool Unit can reconnect.

Pool Unit does not turn on

If you encounter difficulties with turning on the Pool Unit, you can troubleshoot using the following steps:

Use a Different Wall Plug: try using a different wall plug in your environment to charge the Pool Unit again. Ensure that the red light indicates that the unit is charging. Wait until the green light signals that it's fully charged. Attempt to turn the Pool Unit on again after it's fully charged.

Check Magnetic Receiver and Charging Cable/Port: if the first attempt doesn't yield positive results, it's possible that the magnetic receiver is dysfunctional or there's an issue with the charging cable or port. If you suspect any of these issues, please contact us at support@poolsavior.com for further assistance.

WARRANTY AND REPAIRS

Home Unit does not turn on

If you encounter difficulties with turning on the Home Unit, try the following troubleshooting steps:
Ensure connection: Ensure that you have inserted the power cable correctly into the power port of the Home Unit.

Test other wall plug: use a different wall plug in your house to verify that it is not a faulty plug. Test with a different device to ensure that the wall plug functions correctly.

Try the other charging cable: try using the other of the two included cables. The cables are identical, and this will help you determine if the cable itself is defective.

No alarm

If the Pool Unit fails to detect entrance into the water when making waves near the device or jumping into the pool, several factors could be responsible:

Stopper Foam Not Removed: before installing the Pool Unit, it's essential to remove the foam piece that serves as protection for the sensor during transport. This foam piece prevents the sensor from being damaged while the alarm is being transported or stored.

Sensor Blocked by Debris: check for any leaves or dirt that may be blocking the sensor. If the sensor is obstructed, it may not recognize water movement effectively.

Alarm Not Turned On: ensure that the alarm is turned on. You can verify if the pool unit is on by observing the blinking green light, which blinks every 30 seconds.

Water Level: confirm that the pool alarm is positioned so that the water level falls within the instructed measurements.(see fig. 8)

Product care

Cleaning: The Pool Alarm can be wiped clean with a warm wet cloth. Do not use detergents, as they may damage the device.

Temperature: Do not keep the Pool Alarm outside if the temperatures drop below 32 degrees Fahrenheit (0 degrees Celsius). Exposure to extreme cold temperatures can affect the device's functionality.

Battery Maintenance: Keep the battery charged and avoid letting it run empty to ensure a healthy battery life. Regularly checking and maintaining the battery charge level will help ensure the proper functioning of the Pool Alarm over time.

Warranty and repairs

PoolSavior - Pool Alarm comes with a limited warranty covering defects in parts and workmanship for a period of three years from the date of purchase (warranty only covers if you retain proof of purchase). We do our best to ensure the product is of the highest quality.

We will not honor claims if the unit is dropped or damaged by the user. In the event that your PoolSavior - Pool Alarm demonstrates a defect, please contact our customer support at **support@poolsavior.com**.

Please note that proper repair can only be guaranteed when the unit is returned to the manufacturer. Thank you for choosing PoolSavior - Pool Alarm.

WARRANTY AND REPAIRS & FCC

"THIS DEVICE IS NOT INTENDED TO REPLACE ANY OTHER SAFETY CONSIDERATION; THAT IS, ADULT SUPERVISION, LIFEGUARDS, FENCES, GATES, POOL COVERS, LOCKS, AND SO FORTH, AND SOME DEVICES MAY NOT DETECT GRADUAL ENTRY."

IMPORTANT: This product has been designed to aid in the detection of unwanted intrusions into unsupervised pools.

Send Correspondence to: Marcus Excelsior Limited

Suite 2512, Langham Place Office Tower, 8 Argyle Street, Mongkok, Kowloon, HongKong

FCC Compliance Statement / FCC Warning

NOTE: This equipment has been tested and found to comply with the limits for a Class B digital device, pursuant to part 15 of the FCC Rules. These limits are designed to provide reasonable protection against harmful interference in a residential installation. This equipment generates, uses and can radiate radio frequency energy and, if not installed and used in accordance with the instructions, may cause harmful interference to radio communications. However, there is no guarantee that interference will not occur in a particular installation. If this equipment does cause harmful interference to radio or television reception, which can be determined by turning the equipment off and on, the user is encouraged to try to correct the interference by one or more of the following measures:

- Reorient or relocate the receiving antenna.
- Increase the separation between the equipment and receiver.
- Connect the equipment into an outlet on a circuit different from that to which the receiver is connected.
- Consult the dealer or an experienced radio/TV technician for help

Changes or modifications not expressly approved by the party responsible for compliance could void the user's authority to operate the equipment.

This device complies with Part 15 of the FCC Rules. Operation is subject to the following two conditions:

(1) this device may not cause harmful interference, and (2) this device must accept any interference received, including interference that may cause undesired operation.

To maintain compliance with FCC's RF Exposure guidelines, This equipment should be installed and operated with minimum 20cm distance between the radiator and your body: Use only the supplied antenna.



Marcus Excelsior Limited
Rm 907 Silvercord Tower 2,
30 Canton Rd., Tsim Sha Tsui
Hong Kong

Authorized EU representative
Marcus Excelsior Limited
Bracken Road No 51, Carlisle Offices
D18CV48 Dublin, Sandyford
Ireland

Authorised UK representative
Marcus Excelsior LLP
71-75, Shelton Street, Covent Garden,
London, WC2H 9JQ, ENGLAND



Raccolta differenziata.
Verifica le disposizioni del tuo Comune