

# Installation & Operation Guide

## Keypad Electronic Lock

Model No. M19F

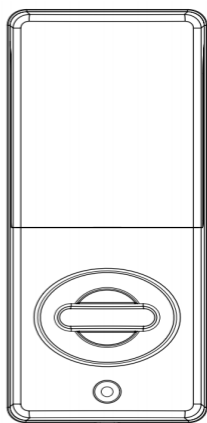
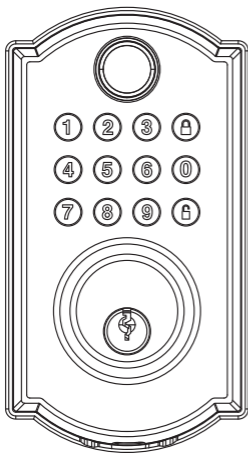

## Specifications

Product Name:	M19F
Communication Type:	Bluetooth
Unlock Type:	Fingerprint,RF Card,APP
Material:	Metal+ABS
Batteries:	4AA Batteries (not included)
Battery life:	12Months
Fingerprint capacity:	10 Groups
Code capacity:	10 Groups

## Components list

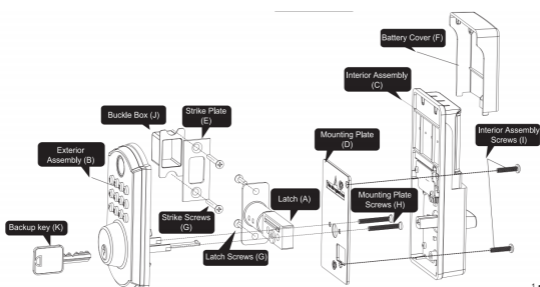

## Parts List

<b>A</b> Latch x1 	<b>B</b> Exterior Assembly x1 	<b>C</b> Interior Assembly x1 	<b>D</b> Mounting Plate x1 
<b>E</b> Strike Plate x1 	<b>F</b> Battery Cover x1 	<b>G</b> 3/4"(19mm) Strike/Latch Screws x4 	<b>H</b> 1-5/32" (33mm) Mounting Plate Screws x2 
<b>I</b> 3/4"(19mm) Interior Assembly Screws x2 	<b>J</b> Buckle box x1 	<b>K</b> Backup key x2 	

If any parts are missing or damaged, please contact Customer Support.

# Installation Guide

## STEP

### 1 Prepare the door and check dimensions

If you need to drill a new door, use the supplied template and the complete door drilling instructions.

A

Measure to confirm that the hole in the door is 2-1/8" (54mm).

Measure to confirm that the hole in the door edge is 1" (25mm).

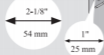

B

Measure to confirm that the backset is either 2-3/8" or 2-3/4" (60 or 70mm).

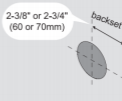

C

Measure to confirm that the door is 1-3/8" to 2" (35 mm or 50mm) thick.

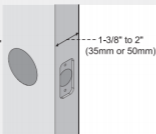

D

Make sure the hole in door frame is drilled a minimum of 1" (25mm) deep.

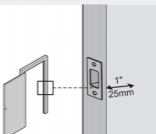

## STEP

### 2 Install the latch and strike

A Determine backset and adjust the latch



Hold the latch in front of the door hole, with the latch face flush against the door edge. Is the slotted hole centered in the door hole?



**YES**

No adjustment is required. Proceed to next step.



**NO**

Slotted hole is NOT centered.



Twist the latch and adjust the bolt length. (Make sure the latch bolt is retracted.)

B

Install the latch

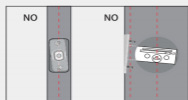
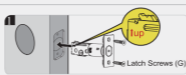

C

Use a screwdriver to test if deadbolt works smoothly.

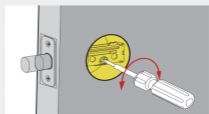

D

Install strike on the door frame.

**IMPORTANT:**

Make sure the hole in door frame is drilled a minimum of 1" (25mm) deep.



# Installation Guide

STEP

## 3 Install exterior assembly

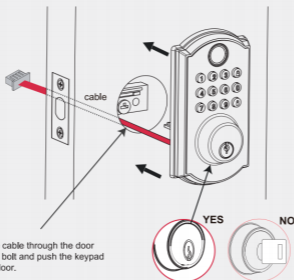

### IMPORTANT:

The key must be pulled out when installing.

STEP

## 4 Install interior assembly

- 1 Take off the mounting plate (D).



### IMPORTANT:

Do not load batteries until lock is completely installed.

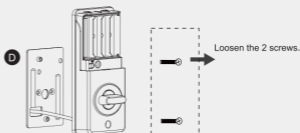

- 2 Route cable through the bottom of mounting plate.

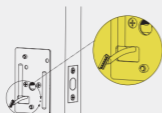

- 3 Tighten screws.

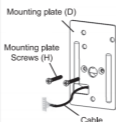

Note: Please support exterior assembly during mounting plate installation.

- 4 Ensure tight cable connection.

The smooth side of the plug should be at the bottom.

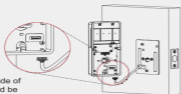

- 5 Tighten screws.



- 6 Insert key and test latch.

If latch does not extend or retract smoothly, adjust mounting plate screws.



If the keypad and mounting plate are deflected, loose mounting plate screws and adjust.

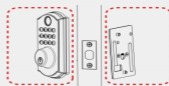

# Installation Guide

STEP

## 5 Install the batteries and perform the door handing process

- 1 While the door is OPEN and UNLOCKED, load 4 AA batteries into the battery compartment.

### IMPORTANT:

Do not use rechargeable batteries or non-alkaline batteries.

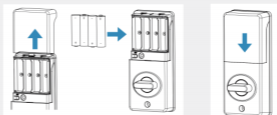

The batteries are not included.

- 2 Perform the door handing process.

- a. Press , the latch bolt extends by itself.
- b. Enter preset programming code: 123456, then press , the latch bolt retracts by itself.



If the latch bolt cannot extend or retract smoothly, check the latch and re-install the lock.

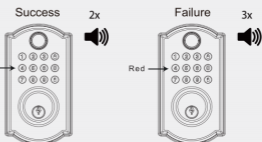

Make sure the door is unlocked and that you are using a fresh set of batteries.

## Exterior Assembly

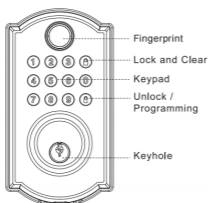

## Interior Assembly

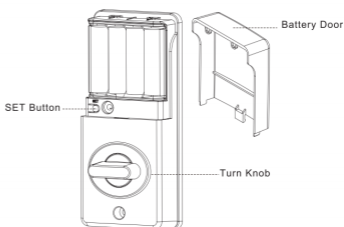

## UNLOCK the door from outside

Master code + 

User code + 

Fingerprint

## LOCK the door from outside

### Auto Lock Mode

In Auto Lock mode, the bolt will extend out automatically in 10 seconds after unlocking.

### Manual Mode

Press .

## UNLOCK the door from inside

Rotate the thumb turn to horizontal position.



## LOCK the door from inside

### Auto Lock Mode

In Auto Lock mode, the device will be locked automatically.

### Manual Mode

Rotate the thumb turn to vertical position.



## Factory Default settings

### How to Reset?



**IMPORTANT:** The resetting will delete all User Codes stored in the lock.

**Step 1.** Keep the door open and unlocked.

**Step 2.** Open the battery cover.

**Step 3.** Keep pressing the SET button for more than 5 seconds until the lock gives 5 short beeps and light flashes blue 5 times, then the beep sounds for 1 second and green light flashes once.

1

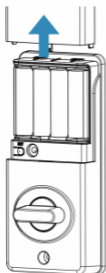

2

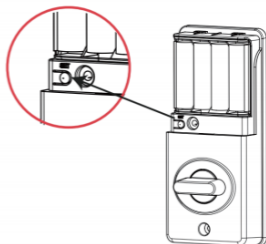

5x



## Install Free App

Download App "Smart Life"  
from Google play or App Store.  
Or scan the QR code



### 1. Register and login

Open the App to register  
and login according to the prompts

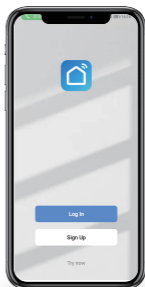

### 2. Turn On Your smart phone's Bluetooth



Turn on your smartphone's Bluetooth.

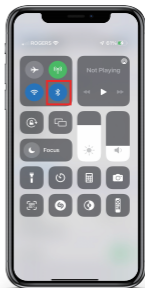

⚠ Please keep the mobile phone and smart lock within 15 meters.

⚠ Please add new password after you finish binding the lock.  
the initial password "123456" will be invalid.

## Connect the Smart Lock to "Smart Life" App

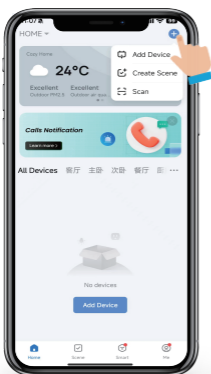

1 Launch the APP and tap the Plus(+) in the top right corner to add a device

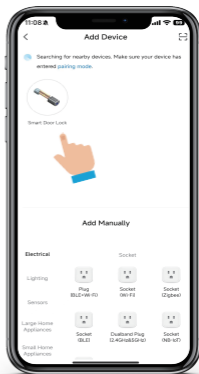

2 Tap to add

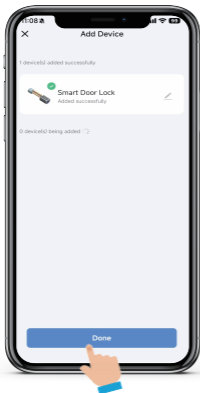

3 Tap "Done"

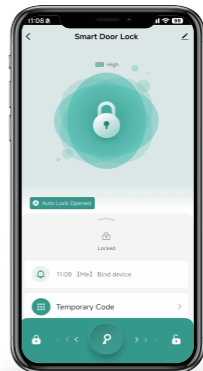

4 Now you lock is successfully added to app.

⚠ Attention: The smart lock supports to be connected with one phone in one time. it means that if your phones is connecting with the smart lock, the other phone can't connect the lock



## How to add new member

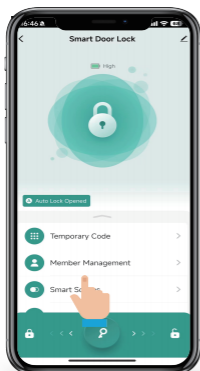

1 Select "Member management"

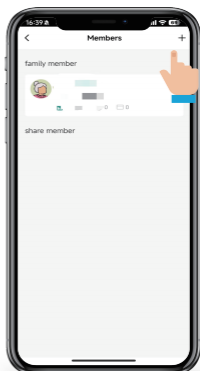

2 Tap "+"

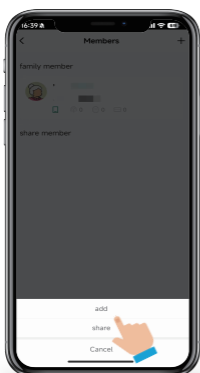

3 Tap "add"

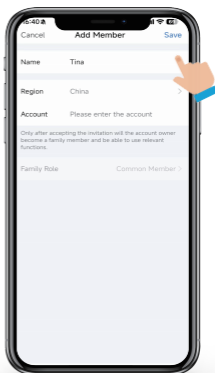

4 Tap "Save"

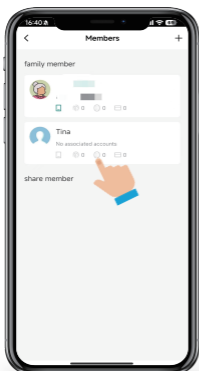

5 New member is successfully added

## How to remove member

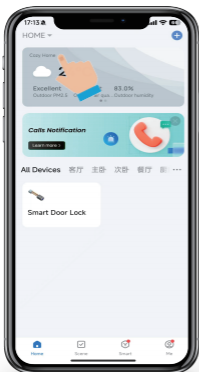

- 1 Select home in the upper left corner

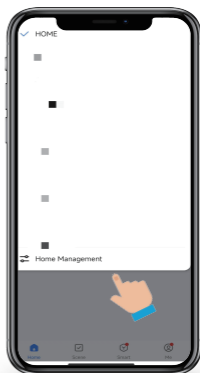

- 2 Select "Home Management"



- 3 Select a member's family

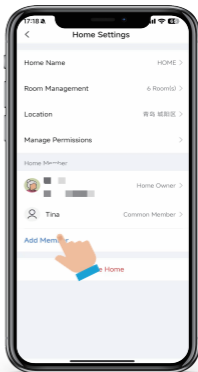

- 4 Select the member you want to delete

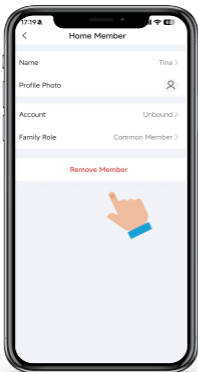

- 5 Select "Remove Member"

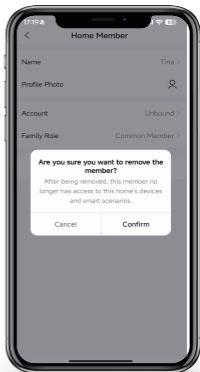

- 6 Select "Confirm" to remove the member

## How to set up user password

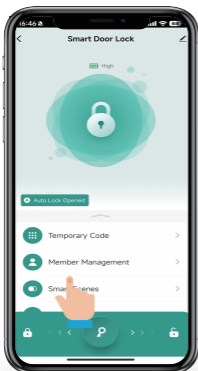

1 Select "Member management"

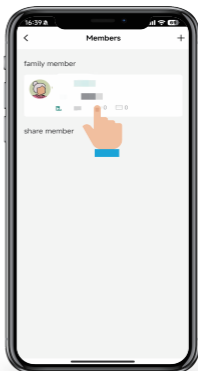

2 Select "user"

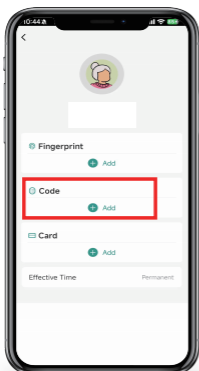

3 Tap "Add"

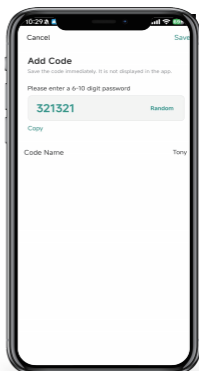

4 Tap "Save" after code added

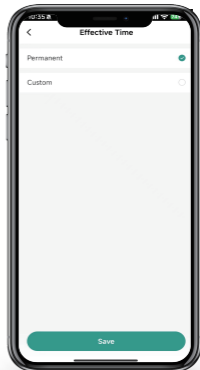
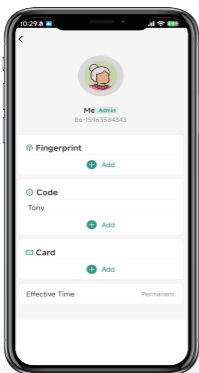

5 Select "Effective time"

6 Permanent is default setting

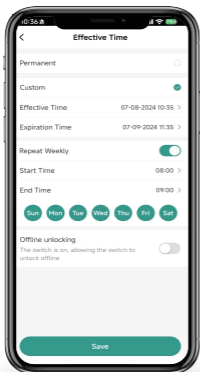

7 Tap "Save"

Follow the instruction to fill in "Effective Time" and Expiration Time. If timed repeat is needed, click the slide button on the right of "Repeat", then fill in "Start Time", "End Time", and select the day of the week. then save the settings.

# How to set up the Fingerprint

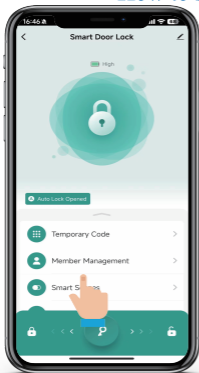

1 Select "Member management"

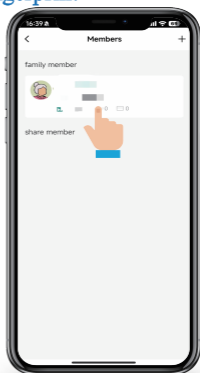

2 Select "user"

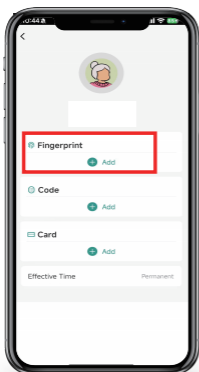

3 Click "Add"

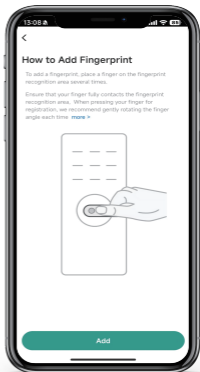

4 Tap "Add"

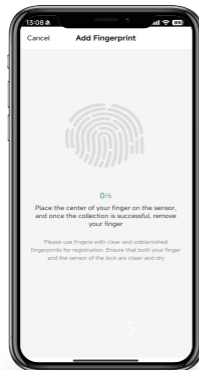

5 Press the finger 6 times

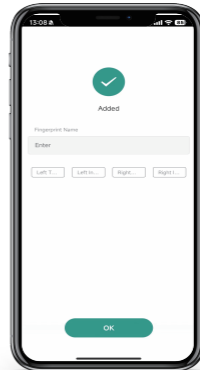

6 Tap "OK" and Now you can unlock with the new fingerprint

# How to set up the IC Card

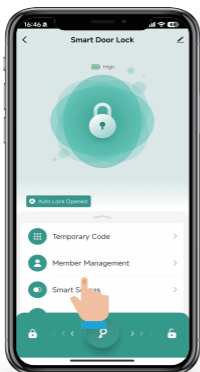

1 Select "Member management"

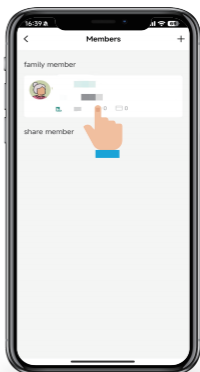

2 Select "user"

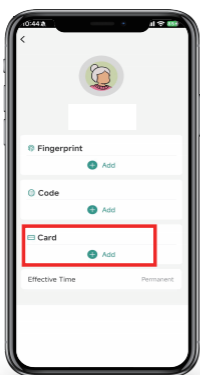

3 Click "Add"



4 Tap "Add"

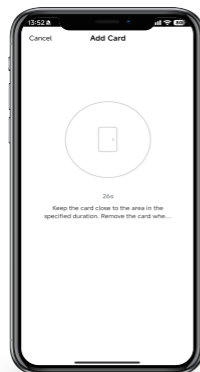

5 Enter a new IC Card

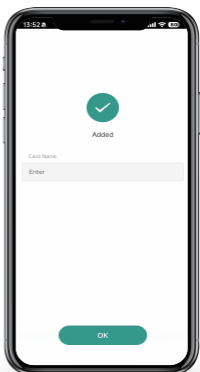

6 Tap "OK" and Now you can unlock with the new card

## App unlock

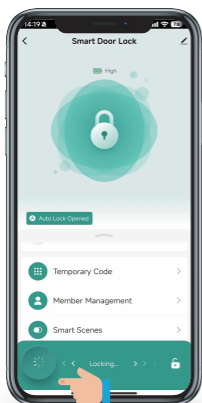

Slide left to lock

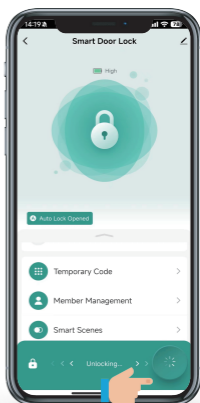

Slide right to unlock

## How to set up Temporary password

### (Time-Limited password)

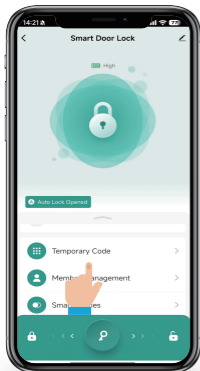

1 Click "Temporary Code"

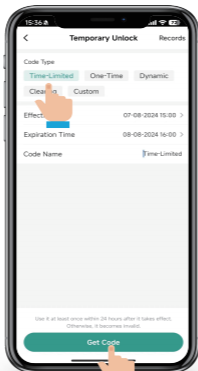

2 Click "Time-Limited" and Get Code

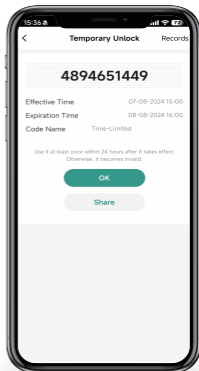

3 Click "Ok"

## How to set up Temporary password

### (One-Time password)

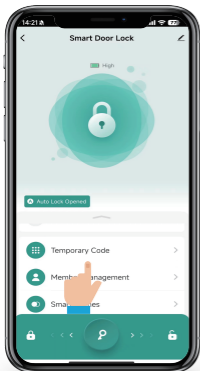

1 Click "Temporary Code"

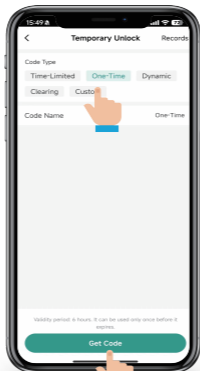

2 Click "One-Time" and Get Code

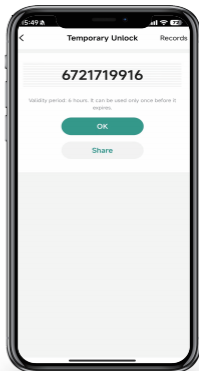

3 Click "Ok"



## How to set up Temporary password

### (Dynamic password)

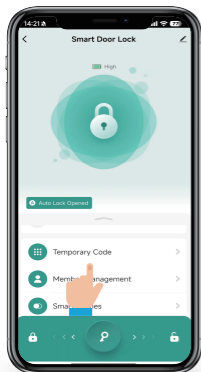

1 Click "Temporary Code"

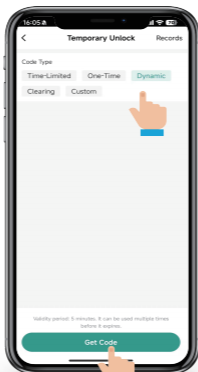

2 Click "Dynamic" and Get Code

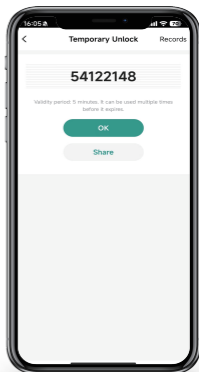

3 Click "Ok"

## How to set up Temporary password

### (Clearing password)

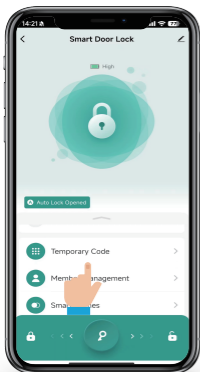

1 Click "Temporary Code"

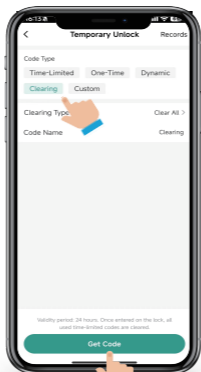

2 Click "Clearing" and Get Code

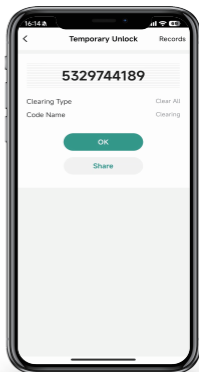

3 Click "Ok"

The items clear all password or clear single password can be chosen

## How to set up Temporary password

(Custom password)

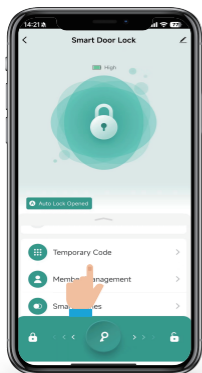

1 Click "Temporary Code"



2 Click "Custom" and Save

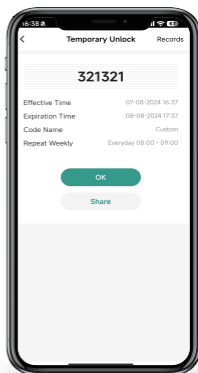

3 Click "Ok"

Follow the instruction to fill in "6~10-Digit Password", "Password Name", "Effective Time" and Expiration Time. If timed repeat is needed, click the slide button on the right of "Repeat", then fill in "Start Time", "End Time", and select the day of the week. then save the settings.

## How to View Records

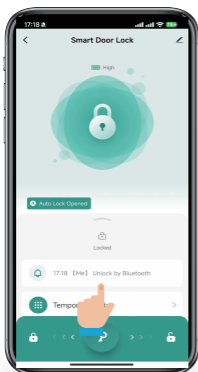

1 Select records



2 View records

## How to set up Auto Lock

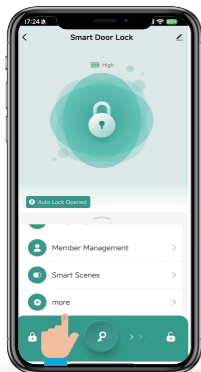

1 Click "more"

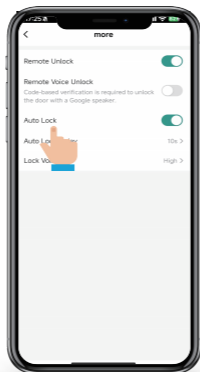

2 Set "Auto Lock " on/off

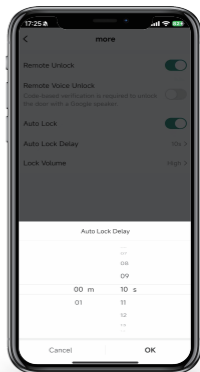

3 Set "Auto Lock "time

## How to set up Lock Volume

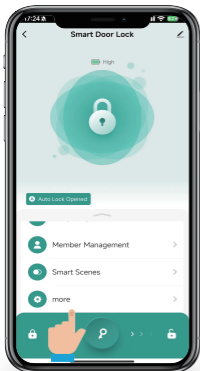

1 Click "more"

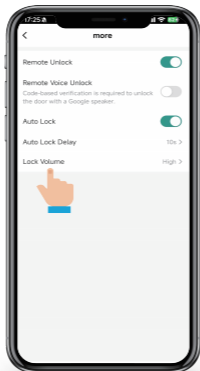

2 The default value is High

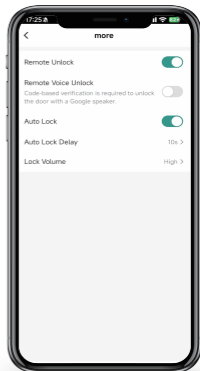

3 Select Volume

## Information to User

1. Note: This equipment has been tested and found to comply with the limits for a Class B digital device, pursuant to part 15 of the FCC Rules. These limits are designed to provide reasonable protection against harmful interference in a residential installation. This equipment generates, uses and can radiate radio frequency energy and, if not installed and used in accordance with the instructions, may cause harmful interference to radio communications. However, there is no guarantee that interference will not occur in a particular installation. If this equipment does cause harmful interference to radio or television reception, which can be determined by turning the equipment off and on, the user is encouraged to try to correct the interference by one or more of the following measures:

- Reorient or relocate the receiving antenna.
- Increase the separation between the equipment and receiver.
- Connect the equipment into an outlet on a circuit different from that to which the receiver is connected.
- Consult the dealer or an experienced radio/TV technician for help.

2. Important: Change or modifications not expressly approved by the manufacturer responsible for compliance could void the user's authority to operate the equipment.

Product Name: SMART lock	FCC ID: 2AWGO-M19F
Model Number: M19F	Color: ORB
Input: DC 6V, 0.3W	Voltage: DC6V (AA*4)

Manufacturer: QINGDAO KINGFORCE INTELLIGENT TECHNOLOGY CO.,LTD  
 Manufacturer Address: NO.69 Guangsheng Road, High-tech ZONE, Qingdao, Shangdong

<div> <div>EC</div> <div>REP</div> </div>	Company: SUCCESS COURIER SL Address: CALLE RIO TORMES NUM.1, PLANTA 1, DERECHA OFICINA 3,Fuenlabrada, Madrid,28947 Spain Email:succeservice2@hotmail.com Tel: +34 910602659
<div> <div>UK</div> <div>REP</div> </div>	Company: EVATOST CONSULTING LTD Address: Office 101 32 Threadneedle Street, London, United Kingdom, EC2R 8AY Email: contact@evatost.com Tel: +442921680945

This device complies with part 15 of the FCC Rules. Operation is subject to the following two conditions: (1) This device may not cause harmful interference, and (2) this device must accept any interference received, including interference that may cause undesired operation



**FR**  
 Cet appareil,  
 ses cordons,  
 et batterie  
 se recyclent

À DÉPOSER  
 EN MAGASIN

À DÉPOSER  
 EN DÉCHÈTERIE

OU



Points de collecte sur [www.quefairemesdechets.fr](http://www.quefairemesdechets.fr)  
 Privilégiez la réparation ou le don de votre appareil !



**FR**  
 ÉLÉMENTS D'EMBALLAGE  
 À SÉPARER ET À DÉPOSER  
 DANS LE BAC DE TRI







**WARNING**  
 TO AVOID DANGER OF  
 SUFFOCATION, KEEP THIS  
 PLASTIC BAG AWAY FROM  
 BABIES AND CHILDREN.  
 DO NOT USE THIS BAG IN  
 CRIBS, BEDS, CARRIAGES  
 OR PLAY PENS.  
 THIS BAG IS NOT A TOY.

**MADE IN CHINA**