

CUBO

INSTRUCTION MANUAL

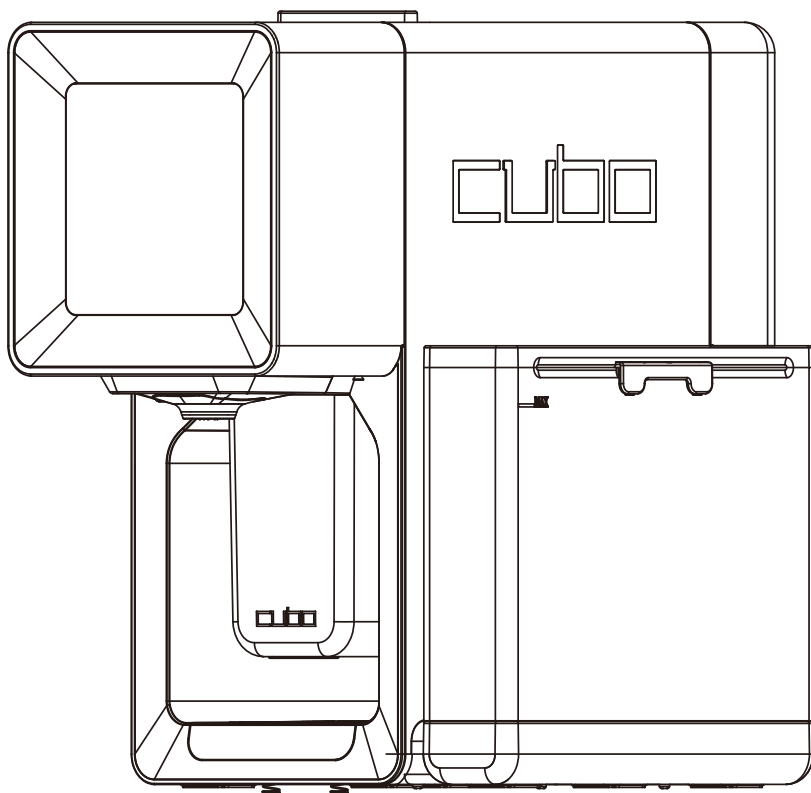

Model : CB1-0-01



Read this instruction manual carefully before operating this machine!

IMPORTANT SAFEGUARDS

When using electrical appliances, basic safety precautions should always be followed including the following:

- a) Read all instructions.
- b) To protect against risk of electrical shock do not put in water or other liquid.
- c) This appliance is not intended for use by persons (including children) with reduced physical, sensory, or mental capabilities, or lack of experience and knowledge, unless they are closely supervised and instructed concerning use of the appliance by a person responsible for their safety. Close supervision is necessary when any appliance is used by or near children. Children should be supervised to ensure that they do not play with the appliance.
- d) Unplug from outlet and remove all parts such as podbin and water tank before cleaning. Flashing light indicates either the machine is with top lid open and ready to operate or some parts of the machine are not attached.
- e) Avoid contacting moving parts.
- f) Do not operate any appliance with a damaged cord or plug or after the appliance malfunctions, or is dropped or damaged in any manner. Contact us through our customer service telephone number +1 (844) ONECUBO for information on examination, repair, or adjustment.
- g) The use of attachments not recommended or sold by the manufacturer may cause fire, electric shock or injury.
- h) Do not use outdoors.
- i) Do not let cord hang over edge of table or counter.
- j) Keep hands and utensils out of container while working to reduce the risk of severe injury to persons or damage to the machine. A scraper may be used but must be used only when the machine is not working.
- k) Blades are sharp. Handle carefully.
- l) Always operate machine with cover in place.
- m) Do not touch hot surfaces. Use handles or knobs.
- n) Do not place on or near a hot gas or electric burner, or in a heated oven.
- o) Always attach plug to appliance first, then plug cord into the wall outlet. To disconnect, turn any control to off, then remove plug from wall outlet.
- p) Do not use appliance for other than intended use.

FCC ID Warning

Warning: Changes or modifications to this unit not expressly approved by the party responsible for compliance could void the user's authority to operate the equipment.

Note: This equipment has been tested and found to comply with the limits for a Class B digital device, pursuant to part 15 of the FCC Rules. These limits are designed to provide reasonable protection against harmful interference in a residential installation. This equipment generates, uses and can radiate radio frequency energy and, if not installed and used in accordance with the instructions, may cause harmful interference to radio communications. However, there is no guarantee that interference will not occur in a particular installation. If this equipment does cause harmful interference to radio or television reception, which can be determined by turning the equipment off and on, the user is encouraged to try to correct the interference by one or more of the following measures:

- Reorient or relocate the receiving antenna.
- Increase the separation between the equipment and receiver.
- Connect the equipment into an outlet on a circuit different from that to which the receiver is connected.
- Consult the dealer or an experienced radio/TV technician for help.

This device contains licence-exempt transmitter(s)/receiver(s) that comply with Innovation, Science and Economic Development Canada's licence-exempt RSS(s).
Operation is subject to the following two conditions:

- (1) This device may not cause interference.
- (2) This device must accept any interference, including interference that may cause undesired operation of the device.

IC Radiation Exposure Statement:

This equipment complies with Canada radiation exposure limits set forth for uncontrolled environments. This transmitter must not be co-located or operating in conjunction with any other antenna or transmitter.

L'émetteur/récepteur exempt de licence contenu dans le présent appareil est conforme aux CNR d'Innovation, Sciences et Développement économique Canada applicables aux appareils radio exempts de licence. L'exploitation est autorisée aux deux conditions suivantes:

- 1) L'appareil ne doit pas produire de brouillage;
- 2) L'appareil doit accepter tout brouillage radioélectrique subi, même si le brouillage est susceptible d'en compromettre le fonctionnement.

Déclaration d'IC sur l'exposition aux radiations:

Cet équipement est conforme aux limites d'exposition aux radiations définies par le Canada pour des environnements non contrôlés.

Cet émetteur ne doit pas être installé au même endroit ni utilisé avec une autre antenne ou un autre émetteur.

Content

PRODUCT OVERVIEW	1
OPERATING INSTRUCTIONS	1
1. Before use	1
2. First time cleaning	2
3. Variations and adjustments	3
4. Auto cleaning	4
CUBOPODS	4
1. Storing CUBOPODS	4
2. Using CUBOPODS	4
SETTINGS MENU	4
1. Order CUBOPODS	5
2. Cleaning options menu	5
CLEANING	5
1. Quick flush	5
2. Detergent cleaning	5
3. Deep cleaning	6
4. Descaling	6
FUNCTIONAL INFORMATION	8
1. CUBOPOD reading	8
2. Sleep and Low power	8
3. Removable parts	8
4. LEDs	9
WARNING SCREENS	9
1. Water Tank warnings	9
2. Podbin warnings	10
3. Spout warning	11

ERROR SCREENS	11
1. CUBOPOD errors	11
2. Crushing errors	11
3. Preparation error	12
4. Power-on exception	12
5. System errors	13
TRUBLESHOOTING	15
TECHNICAL PARAMETERS AND COMPLIANCE	15
LIMITED WARRANTY.....	16

>> PRODUCT OVERVIEW

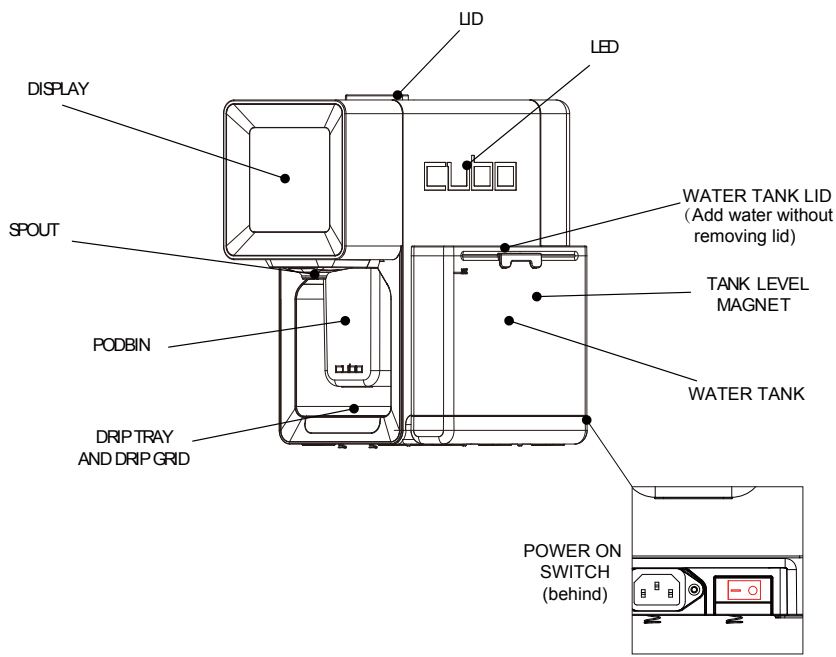

>> OPERATING INSTRUCTIONS

1. Before use



Connect power cable.

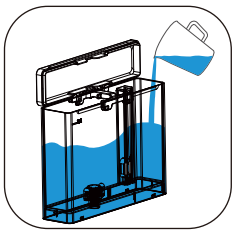

Fill the water tank up to the MAX indication.

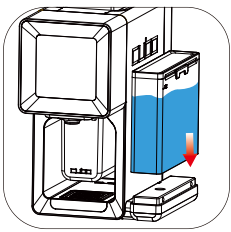

Make sure the water tank is properly seated.

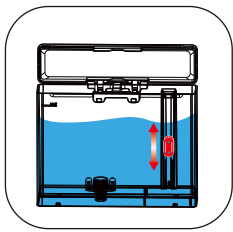

Check if the tank level magnet can freely move inside the rail.

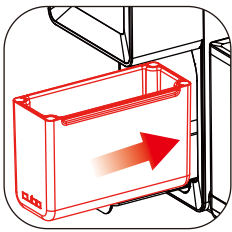

Place magnetic podbin beneath the machine body.

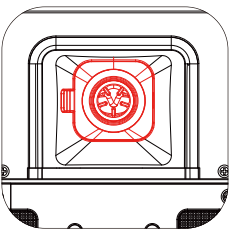

Make sure the spout is properly placed and latched.

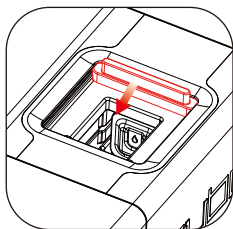

Close the lid making sure no CUBOPOD is inserted.

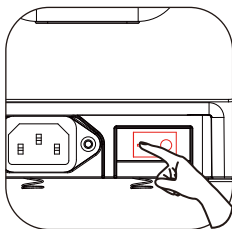

Switch On.

2. First time cleaning



When you turn on the machine for the first time, after the welcome screen appears, you will be asked to watch a brief presentation. Touch WATCH NOW or MAYBE LATER to skip.



On any animation screen, if you touch LINK, a QR Code will appear linking you to online help resources. All SHOW ME buttons direct to a brief demonstration.

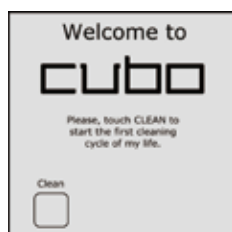

At the first time, it is mandatory to do a self-cleaning cycle. Touch CLEAN to get started.

Beverage preparation



After first-time cleaning cycle, and every time the machine is turned on, the homescreen indicates it is ready to prepare a beverage.

The SHOW ME button will display a brief demonstration.

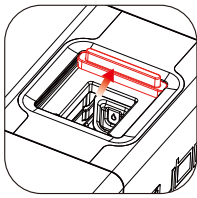

Open lid.

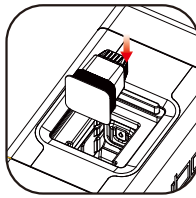

Insert frozen CUBOPOD.

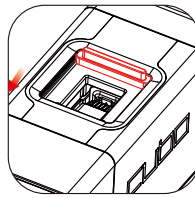

Close lid.

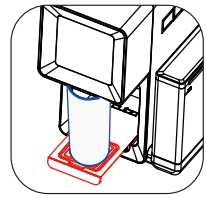

Extend tray and place a cup.





After reading the CUBOPOD, machine will display the START screen:
Touch START to begin preparation.

3. Variations and adjustments

It is possible, for most drinks, to add a personal touch by changing the temperature and dilution.

- Dilution selection.



Touch DILUTION and the icon will change indicating the current selection:

	Less water – concentrated
	Recommended water amount – standard
	More water – diluted

The amount of water added on each selection is predetermined in order to ensure the optimal taste. Some CUBOPODS have fewer options, and others do not allow changes. In this case, the icon and button will not be displayed.



- Cold beverage selection.

If you touch COLD button in a cold beverage preparation, the icon will change indicating the current temperature selection:

	Icy – colder than standard temperature
	Cold – standard temperature for cold serving
	Cool – mildly cold

- Hot beverage selection.

If you touch HOT button in a hot beverage preparation, the icon will change indicating the current temperature selection:

	Hotter – hotter than standard temperature
	Hot – standard temperature for hot serving
	Warm – mildly hot serving

The temperature of each selection is predetermined. Some CUBOPODS have fewer options and others do not allow changes. In this case, the icon and button will not be displayed.

- Cold or Hot serving selection.

Some CUBOPODS can be enjoyed cold or hot. Choose before preparation.



After selecting your preference, the START screen is displayed.

4. Auto cleaning:

After every preparation, the machine will perform a self-cleaning cycle, ensuring it is always neat and ready for a new CUBO. You may enjoy your beverage while the machine takes care of itself.

>> CUBOPODS

1. Storing CUBOPODS

CUBOPODS must be kept in the freezer. The best storage condition is 0°F (-18°C).

2.Using CUBOPODS

To guarantee quality, insert the frozen CUBOPOD within 5 minutes from removing from freezer. If a CUBOPOD stays more than 5 minutes out but is still solid, it should be put back in the freezer to become usable again.

IMPORTANT: Once thawed, the CUBOPODS cannot be used, and should be discarded.

>> SETTINGS MENU

At the homescreen, if you press the Config button (center) you will access the SETTINGS MENU:



SETTINGS MENU

- EXIT button takes you back to home screen.
- NEXT button moves selection bar to next option.
- ENTER button confirms selected option.

NOTE: in all menus, the selected option is displayed with a dark background.

- Order CUBOPODS

Displays a QR code linking to our website where you can order more CUBOPODS to enjoy.



ORDER CUBOPODS

- BACK button takes you back to SETTINGS menu..
- EXIT button takes you back to home screen.

- Cleaning options menu

You may need (or want) to perform different cleaning procedures over time. Select them here.

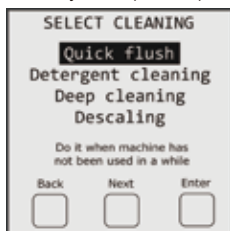

CLEANING MENU

- BACK button takes you back to SETTINGS menu.
- NEXT button moves selection bar to next option.
- ENTER button starts selected cleaning procedure.

>> CLEANING

After each preparation, the machine performs a self-cleaning cycle.

There are four other types of cleaning that can be selected by the user:

1. Quick flush

A quick flush should be performed when the machine has not been used in a while.

It is fast and uses only a small amount of water.

2. Detergent cleaning

A cleaning procedure using detergent, may be requested occasionally, especially after the preparation of specific drinks.

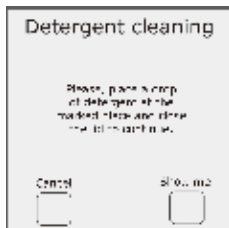

After you placed a drop of detergent, close the lid.

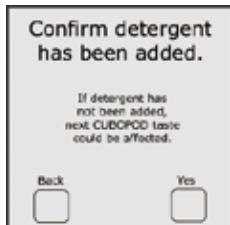
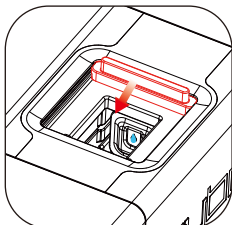

- BACK button takes you back to previous screen.
- YES button performs the cleaning procedure.

If you chose BACK and the detergent cleaning has been automatically called after a preparation, you will see a warning screen:



- ▶ EXIT button takes you back to homescreen.
- ▶ CLEAN button takes to detergent cleaning screen.

Skipping this step allows the user to save time and water to prepare the same drink more than once in a row.

IN ANY OTHER SITUATION WE STRONGLY RECOMMEND THAT YOU DO NOT SKIP DETERGENT CLEANING WHEN REQUESTED, AS THE TASTE OF THE NEXT CUBOPOD COULD BE AFFECTED.

3. Deep cleaning

It is a cleaning procedure aimed to clean the valve and vent tubes. A deep cleaning is not available as an automatic cleaning procedure. It can be manually started from menu and should be done periodically. The machine will remind you to perform a deep cleaning according to its use. During deep cleaning process the valve will spin continuously, releasing water into the podbin and through the spout. Place a container to collect this water.

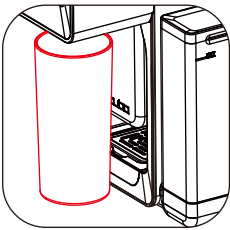

Once you touch CONTINUE the process will start right away. If you select BACK you will return to the cleaning menu.

4. Descaling

Descaling is used to remove mineral deposits accumulated over time in water pipes. You will need to perform this cleaning by adding white vinegar to the water tank as instructed below. The machine will let you know when its time to perform this cleaning.



Descaling preparation steps:

- Close lid making sure there is no CUBOPOD inserted.

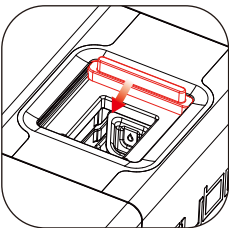

- Empty podbin and put it in position.

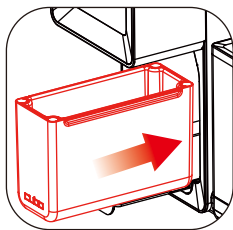

- Fill with white vinegar.

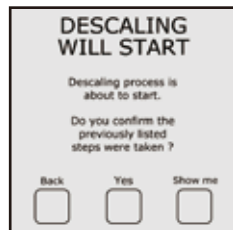
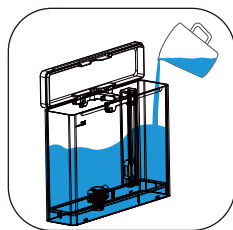

Touch YES to start descaling.

Rinse the machine after the first part of the process.

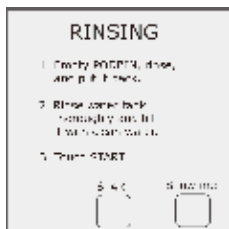

- Empty podbin, rinse it and put back in place.

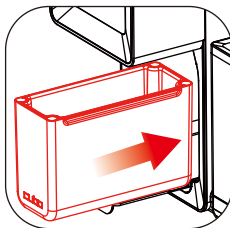
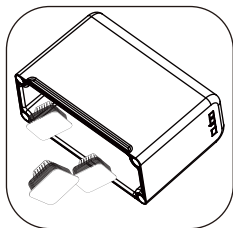

- Rinse water tank and fill it with 530ml (18oz) of clean water.

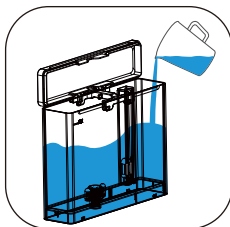
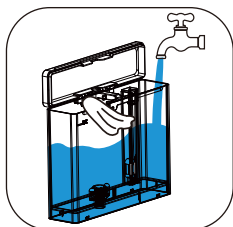

Touch START to rinse the descaling agent from the internal pipes.

When the process is complete, wash all removable parts before the next preparation.

>> FUNCTIONAL INFORMATION

1. CUBOPOD reading

All information for a beverage preparation is contained in the CUBOPOD. After starting the process, the CUBOPOD is registered and cannot be reused. If the CUBOPOD is unreadable for any reason, the machine won't start the preparation process.

The machine only prepares CUBO™ compatible pods, called CUBOPODS.

2. Sleep and Low power

The machine enters sleep mode after 90 seconds without use. The screen turns off and the side LEDs exhibit a breathing pattern. Any interaction with the lid or any removable part activates the machine.

After 15 minutes of non-use, the machine goes into power saving mode and will wake up only when the lid opens.

3. Removable parts

The machine contains removable parts that must be cleaned frequently:

- Spout

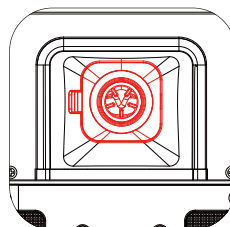
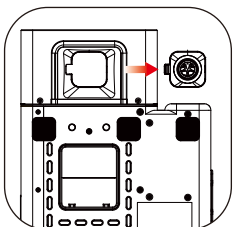

▪ Water tank

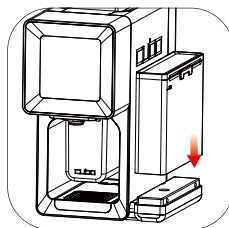
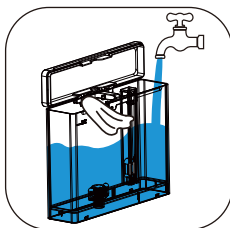
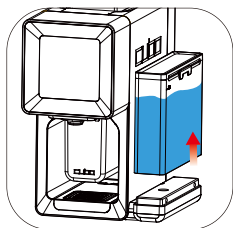

▪ Podbin

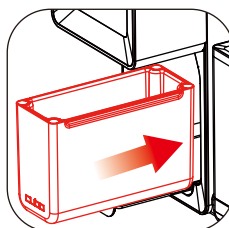
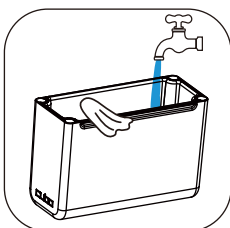
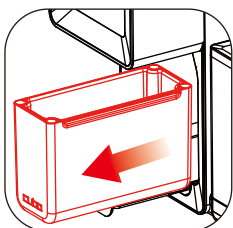

4. LEDs

The LEDs on the machine's side change color according to status. Whenever the lid is open, the led flashes red, indicating the need for attention. When a removable part is missing or not properly fitted or locked, the LEDs also flash red.

If the machine is ready for use, the LEDs will remain deep blue.

When in cleaning mode, the LEDs remain cyan. When reading the capsule label, they turn pink.

During preparation, the LEDs display the drink color.

>> WARNING SCREENS

1. Water Tank warnings

- Whenever the water tank is removed, a warning is displayed on the screen. Put it back in place to normalize.

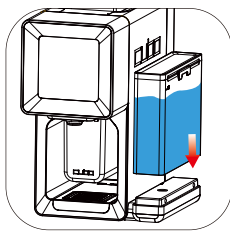

- When the low-level sensor is activated, the machine will display the "Tank too low" warning. To dismiss it, just fill the tank with clean water. We suggest you use this break as an opportunity to wash it.

Note: This warning doesn't necessarily occur when the tank is completely empty, since there must be enough water to complete a full preparation and cleaning cycle.

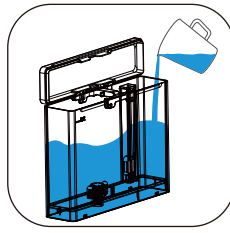
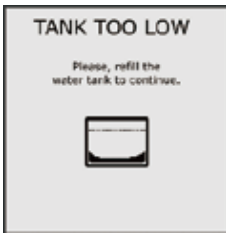

- If the water tank temperature sensor reads more than 40°C (104°F), a warning will be displayed. You can ignore it if you are not going to prepare cold drinks (center button) or replace the water otherwise. Touch OK to dismiss the message.

Note: After replacing the water it may take some time for the temperature sensor to normalize.

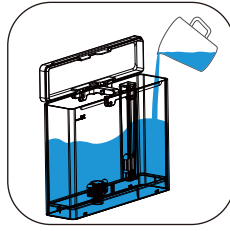

2. Podbin warnings

- When the Podbin is removed, a warning screen is displayed. Just put it back in place to normalize.

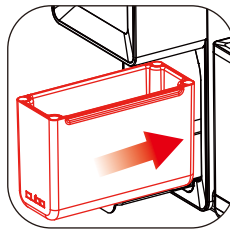

- When the Podbin is full, a warning screen is displayed. Empty it, wash it, and put it back in place to normalize.

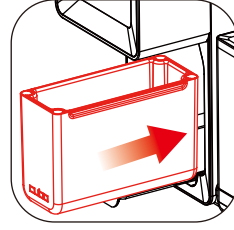

- When the machine discharges more than 1 liter (33 oz) of water in the podbin, you will be prompted to empty it.

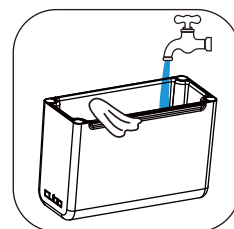
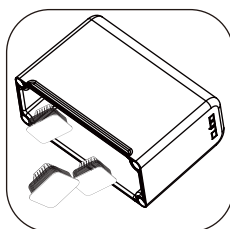
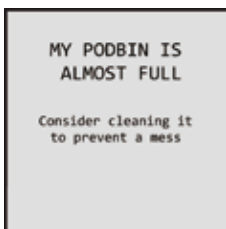

3. Spout warning

- When the Spout is removed, a warning screen is displayed. Just put it back in place and latch it to normalize.

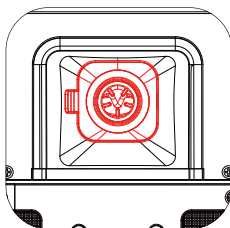

>> ERROR SCREENS

1. CUBOPOD errors

All information about the preparation of the drink is available on the CUBOPOD. In case of errors, they will be displayed on the screen.



The machine could not validate the CUBOPOD.



The CUBOPOD has been tagged as used.

In any of the cases you should use a new original CUBOPOD.

2. Crushing errors

- Unusually hard cubes

When you touch START, the CUBOPOD is crushed and preparation begins. If, for any reason, the crusher is unable to do that, an error screen will be displayed:

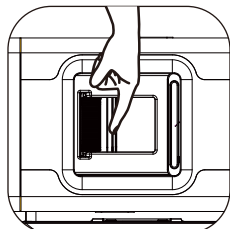

Such behavior is absolutely unusual and may indicate that the capsule is not good for consuming. You are requested to open the lid and remove any remains of the capsule from inside the shaft before preparing another beverage.

- Obstructed way

If during crushing, the sensor detects an obstruction, the same error screen will be displayed, and the same procedure will apply.

- Jammed CUBOPOD

When the CUBOPOD is crushed, it falls into the podbin. If it does not occur as expected, a jammed CUBOPOD error message will be displayed:

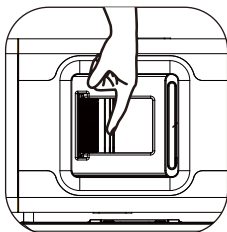

If this happens, open the lid and manually push the empty CUBOPOD.

If any part of the frozen CUBOPOD is still stuck, remove it manually, make sure the frozen CUBOPOD is pushed into the blender chamber, and the empty CUBOPOD falls into the podbin.

Close the lid and preparation will continue as normal.

If the empty CUBOPOD has not fallen into the podbin, the machine will ask you for confirmation of removal before continuing the process. Note: Never continue process if the CUBOPOD is still jammed as it could irreversibly damage the machine.

3. Preparation error

- No water flowing

If the water flow falls unexpectedly, the process will be halted, and the following error screen will be displayed:

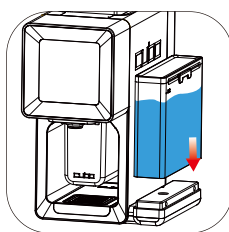
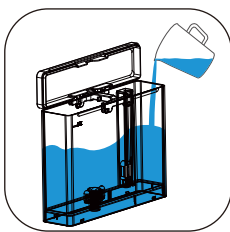

In this case, it is mandatory to remove and place back the water tank to restart the cycle.

Check to see if the floating water level sensor isn't jammed as this could be the cause of the problem.

Be sure there is sufficient water in the water tank.

4. Power-on exception

- No water flowing

Interrupted operation



If the machine is powered off while preparing a drink, a warning screen will be displayed when powered on.

Wait for the machine to clean itself before inserting a new CUBOPOD.

5. System errors

- AC frequency failure



Error indicating that machine did not detect the AC frequency, thus cannot operate.

- Temperature sensor failure



Error indicating that one of the temperature sensors has failed, thus machine cannot operate.

- Crusher sensors failure



Error indicating that one of the sensors has failed.

- Crusher motor failure



Error indicating that crusher motor has failed.

- Mixer failure



Error indicating that mixer motor has failed.

- Heater failure



Error indicating that heater has failed.

- Memory Access Failure



Error indicating that machine has identified a memory access failure.

>> TROUBLESHOOTING

- | | | |
|----------|---|--|
| a | PODBIN REMOVED
appears on the
screen | ▶ · Check if the podbin is properly in place. |
| <hr/> | | |
| b | TANK NOT
DETECTED appears
on the screen | ▶ · Check if the water tank is correctly installed
in place. |
| <hr/> | | |
| c | JAMMED CUBOPOD
appears on the
screen | ▶ · CUBOPOD jammed, open the lid and manually
push down the empty CUBOPOD, and then
close the lid. |
| <hr/> | | |
| d | PODBIN FULL
appears on the
screen | ▶ · The podbin is full. Empty it, wash it, and put it back
in place. |
| <hr/> | | |
| e | NO WATER
FLOWING appears
on the screen | ▶ · Water tank is short of water. Remove to fill water
and place back. |
| <hr/> | | |
| f | Other problems | ▶ · Call service center at +1 (844) ONECUBO. |

>> TECHNICAL PARAMETERS AND COMPLIANCE

Operating Voltage and Power:	AC 120V 60Hz 1785W
Operating Pump Pressure:	15 bar
Weight:	19 lbs / 8.61 Kg
Water Tank Capacity:	57 fl oz / 1.7 L
Operating Temperature:	41-104°F / 5-40°C
Dimensions (WxLxH):	9 ¾ x 15 ½ x 15 ¼ in / 24.6 x 39.2 x 38.5 cm

Please search the user manual information at www.onecubo.com

This product complies with FCC and UL.

>> LIMITED WARRANTY

This Limited Warranty covers any defects in material or workmanship under home use only for one year from the date of purchase.

During the Warranty Period, CUBO will repair or replace, at no charge, products or parts of a product that proves defective because of improper material or workmanship, under normal use and maintenance.

This guarantee excludes liability for consequential loss or any other loss or damage caused to property or person arising from any cause whatsoever. It also excludes commercial use, owner change, defects caused by the product not being used in accordance with instructions, accidental damage, misuse, cosmetics damages, being tampered with by unauthorized persons, improper maintenance, consumable items or normal wear and tear and does not cover the cost of claiming under the warranty. Cost of shipment from buyer to CUBO covered by buyer and from CUBO to buyer covered by CUBO.

Except to the extent applicable by law, the terms of this warranty do not exclude, restrict or modify, and are in addition to, the mandatory statutory rights applicable to the sale of the product to you. Only the use of CUBOPODS will guarantee the proper functioning and lifetime of your CUBO machine. Any defect resulting from the usage of non-genuine CUBOPODS will not be covered by this warranty.

To obtain warranty service, you must first contact us to determine the problem and the most appropriate solution for you.

IMPORTER:

CUBO BEVERAGES LLC

5805 Sepulveda Blvd, 5th Floor, Sherman Oaks, CA 91411

MADE in CHINA