

85mm

75mm



USER MANUAL
OKX T12

Exterior

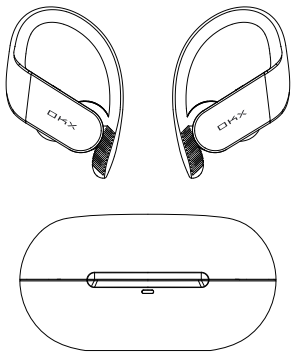

Packing List

Totally wireless earbuds	X1	Charging case	X1
Ear cup cap (The M size caps are on the earbuds)	X3	User Manual	X1
USB C charging cable	X1		

Product Description

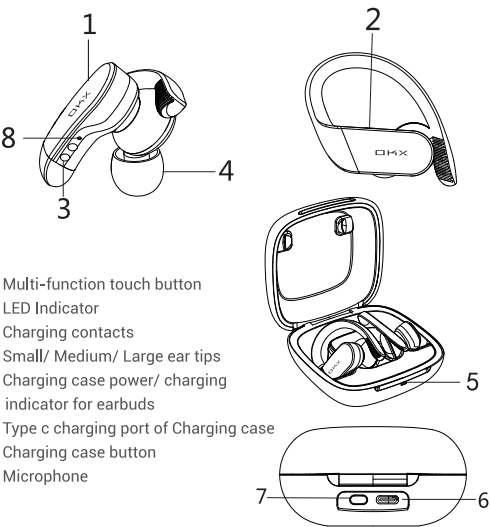

1. Multi-function touch button
2. LED Indicator
3. Charging contacts
4. Small/ Medium/ Large ear tips
5. Charging case power/ charging indicator for earbuds
6. Type c charging port of Charging case
7. Charging case button
8. Microphone

Product Technical Parameters

1. Product pairing name: OKX T12 Wireless
2. Bluetooth Version: Bluetooth 5.0
3. Bluetooth range: 10M
4. Earbuds charging time: 2 hours or less
5. Charging case charging time: 1.5 hours
6. Standby time: about 100 hours
7. Play time: about 4 hours, up to 32 hours with charging case
8. Earbud battery: 40mAh/ earbud (rechargeable lithium-ion)
9. Charging case battery: 650mAh (rechargeable lithium-ion)

How to Connect earbuds to mobile or bluetooth - supported device

1. Open the charging case, the earbuds will turn on automatically

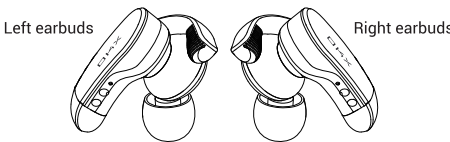

2. Earbuds will automatically enter pairing mode, open your Bluetooth settings on phones or other devices, click "OKX T12 Wireless".

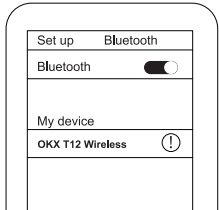

3. if the audio experience is lacking, simply rotate the earbuds and readjust earbuds to line up with your ear canal.

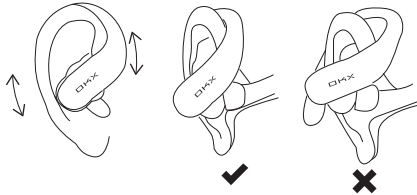

4. Close the charging case, the earbuds will turn off automatically.

Earbuds LED indicator

Status	LED indicator
Turn on	White light on for 1s
Turn off	Red light on for 1s
Pairing	white light flashes slowly
connected	(not bright)
not connected	white light flashes slowly
reset	Red and white lights flash 3 times at the same time
charging	Red light is always on
full charge	(not bright)
play music	(not bright)
Low power state	(not bright)
Incoming call	(not bright)

Multi-function touch button guidance

▶	Double press
	Double press
☎	Double press
📞	Long press 2 seconds (beep)
🔄	Double press
▶▶	Long press right earbud 2 seconds
◀◀	Long press left earbud 2 seconds
🔊+	One press right earbud
🔊-	One press left earbud
🎤	Quick press 3 times(left/right earbuds)

Charge the earbuds

The charging case with LED indicator flashes once every 10s while the earbuds are charging, the indicator goes out when the earbuds are fully charged

Charging the case

The red LED is always on while the charging case is charging. The charging case is fully charged while the white LED is always on.

Open the charging case lid or close the lid:

1. The white LED light turns off after 3 flashes, the power is 100%
2. The white LED light turns off after 2 flashes, the power is 70%
3. The white LED light stays on for 3s and then goes out, the power is less than 25%

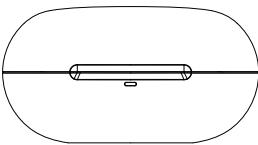

Tripartite way calling

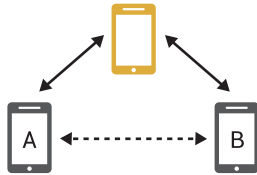

function	operate
Answer the B call, put the A call on hold	Double press
Two calls switch between each other	Double press
Hang up the A call	short press
Hang up the A call and answer the B call	short press
Reject call from B	Long press 2 seconds

Reset factory setting

Without closing the lid, place both earbuds into the charging case. Press and hold the button on the charging case until the earbuds show a breathing lighting effect. Open your bluetooth settings on your desired device to connect to "OKX T12 Wireless".

Safety Precautions

1. This product contains a built-in rechargeable lithium battery. Safety warning: do not disassemble, bump, squeeze, puncture or throw into fire. if severe swelling occurs, do not place in high temperature environment. do not use the battery after it has been exposed to water.
2. Do not remove or modify the earbuds for any reason, or it may cause the headset to malfunction or burn out. These are not covered by our warranty.
3. Hearing damage caused by long-term listening to music, please adjust to appropriate volume when using the device. Exposure to high volumes might put you at risk for hearing loss. Please use these earbuds with due diligence.
4. Avoid using the device indicator light near to children or animals.
5. Please use with caution during harsh weather conditions, such as thunderstorms. it may cause the device to malfunction and increase the risk of contacts.



Be careful to your hearing

Listening at high volume for a long time may cause permanent hearing loss

Warranty

If there are any problem with your wireless earbuds, please feel free to contact us at: support@loopee.com

NOTE: This equipment has been tested and found to comply with the limits for a Class B digital device, pursuant to part 15 of the FCC Rules. These limits are designed to provide reasonable protection against harmful interference in a residential installation. This equipment generates uses and can radiate radio frequency energy and, if not installed and used in accordance with the instructions, may cause harmful interference to radio communications. However, there is no guarantee that interference will not occur in a particular installation. If this equipment does cause harmful interference to radio or television reception, which can be determined by turning the equipment off and on, the user is encouraged to try to correct the interference by one or more of the following measures:

- Reorient or relocate the receiving antenna.
 - Increase the separation between the equipment and receiver.
 - Connect the equipment into an outlet on a circuit different from that to which the receiver is connected.
 - Consult the dealer or an experienced radio/TV technician for help
- Changes or modifications not expressly approved by the party responsible for compliance could void the user's authority to operate the equipment.

This device complies with Part 15 of the FCC Rules. Operation is subject to the following two conditions:
(1) this device may not cause harmful interference, and (2) this device must accept any interference received, including interference that may cause undesired operation.