



Product Features:



- ENZD wireless switch may have one or two rockers. Single rocker switch provides up to 2 unique controls; double rocker switch provides up to 4 unique controls.
- It can be used as either On/Off or dimmer control.
- The switch can be mounted anywhere and reconfigure or relocated as needed, no costly and time-consuming wiring installation needed.
- The switch uses strong coding system and is interference proof. Because its' radio power is very low (< 10mw), it has no impact to other wireless devices around.

Product	ZHILANG switch
Model	EN-K9012W
Specification	
Power Supply	CR2032 button cell
RF	2.480GHZ
RF Bandwidth	540KHZ
Modulation Mode	MSK
RF transmission Power	<10mW
RF Transmission Range	Outdoor: >120m, Indoor: >20m
Button Lifetime	≥50,000 times
Button and Battery Lifetime	≥200000 times without maintenance
Working T&H	0℃~60℃, 20%~95%RH
Storage T&H	-10℃~60℃, 10%~95%RH, non-condensing
Atmosphere	86kPa-106 kPa
Dimensions	8 5mm x 85mm x 12mm
weight	71g
Structure	
 	



No.	Name	Description
1	button	The four areas are four buttons, which can be pressed or held continuously.
2	Tape	Open the film of the tape and past on a smooth surface.
3	QR code	Switch ID
4	LED	The blue LED will flash once when a button being pressed to trigger signals. If it is at low voltage, red LED will flash when a button being pressed.

Install

Before installation, please test whether the wireless switch can control your electrical equipment normally. If cannot, please do not install it.

It can be fixed with double-sided tape on wall, furniture, glass and other places.

Warning: If there is strong interference behind some walls, and the propagation distance of concrete and alloy walls is short. It is better not to install on such walls.

Usage

It will transmit, if you touch the four buttons. Touch once, send data only once. You can also press repeatedly to send continuously.

The switch can be configured by using En and Ed APP, which can be downloaded from many app stores. For usage, please refer to the manual of relevant software products. Identify the QR code, you can download the APP.



After you download the EN APP, you should click "Settings" → "Switch" → "+" → "SCAN QR CODE" → enter name → click "Save". Following the figure below.

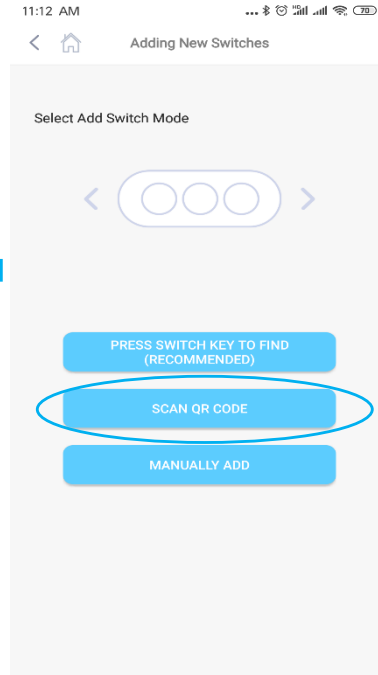
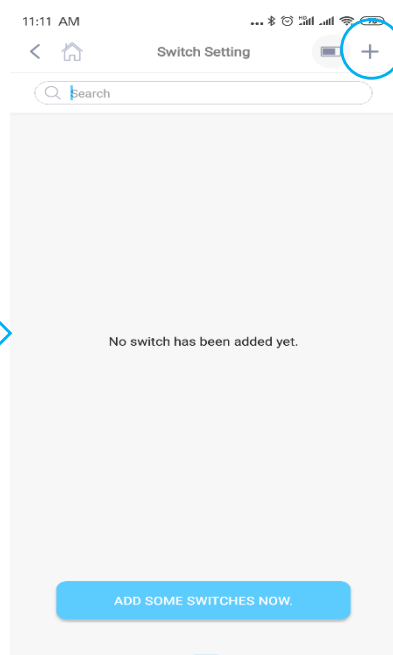
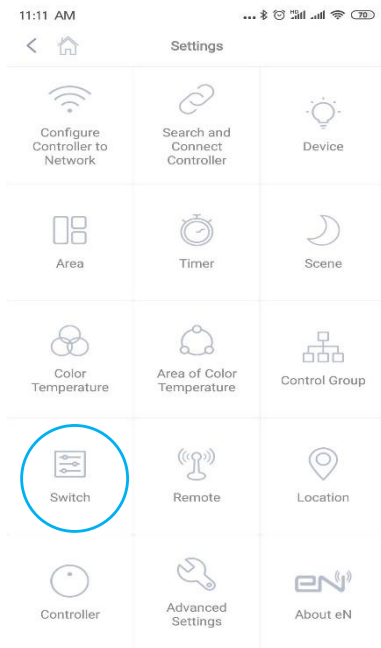

12:00 PM 📶 📶 📶 📶 📶

< 🏠 Switch Setting Save

Switch Name

Device Address

Liked to Controller

Device Type

Control Mode

Note: Push a button once, light will be turned on; push one more time on the same button, light will be turned off, and so on.

Set Key of Switch

☐ A ☐ C

☐ B ☐ D

A Key Modify >

B Key Modify >

C Key Modify >

D Key Modify >

The switch provides a variety of control modes, such as press continuously, press shortly, and etc. Each control mode can achieve different control effects according to system configuration. For example: if it configured as a dimming control, when you press the button once, the light will turn on; when you press and hold on, the light will turn from dark to bright or from bright to dark.

Warning:

This device complies with Part 15 of the FCC Rules. Operation is subject to the following two conditions: (1) this device may not cause harmful interference, and (2) this device must accept any interference received, including interference that may cause undesired operation.

changes or modifications not expressly approved by the party responsible for compliance could void the user's authority to operate the equipment.

NOTE: This equipment has been tested and found to comply with the limits for a Class B digital device, pursuant to Part 15 of the FCC Rules. These limits are designed to provide reasonable protection against harmful interference in a residential installation. This equipment generates, uses and can radiate radio frequency energy and, if not installed and used in accordance with the instructions, may cause harmful interference to radio communications. However, there is no guarantee that interference will not occur in a particular installation. If this equipment does cause harmful interference to radio or television reception, which can be determined by turning the equipment off and on, the user is encouraged to try to correct the interference by one or more of the following measures:

- Reorient or relocate the receiving antenna.
- Increase the separation between the equipment and receiver.
- Connect the equipment into an outlet on a circuit different from that to which the receiver is connected.
- Consult the dealer or an experienced radio/TV technician for help.

NOTE: This device and its antenna(s) must not be co-located or operation in conjunction with any other antenna or transmitter

RF Exposure Statement

To maintain compliance with FCC's RF Exposure guidelines, This equipment should be installed and operated with minimum distance of 5mm the radiator your body. This device and its antenna(s) must not be co-located or operation in conjunction with any other antenna or transmitter