

Product Information

Product Name	Ultrasonic humidifier
Model Number	YK-MH-701A
Voltage	110V/120V
Frequency	50/60Hz
Power	28W
Maximum Mist Output	300mL/h
Tank Capacity	7L
Product Size	730x265x265mm
Noise	≤35dB(A)

YOKEKON

Ultrasonic Humidifier

YK-MH-701A

Instruction Manual

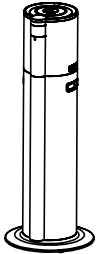

V1.0

Thank you for your purchase.
Please read the instruction manual before use.
If you have any questions about the product, please
send email to service@keecocon.com.

Website: <https://keecocon.com/>
Tel: +18886668909

Thank you for choosing our ultrasonic humidifier. The ultrasonic humidifier uses ultrasonic waves to generate 1.7 million high-frequency oscillations per second. The water is atomized into ultra-fine particles of 1 to 5 microns, and the water mist is diffused to the air through the air moving device. Thereby achieving the purpose of evenly humidifying the air. The humidifier keeps the room at the desired humidity and prevents static electricity.

From here, feel the healthy breathing brought by the ultrasonic humidifier.

Products and accessories:

1 humidifier, 2 user manual, 3 remote control, 4 cleaning sponge (gift)

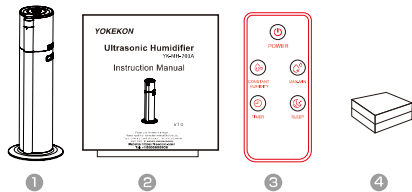

Please check carefully whether the contents of the package are complete. If there is any missing or damaged, please promptly give feedback to the salesperson for more after-sales questions.



Components

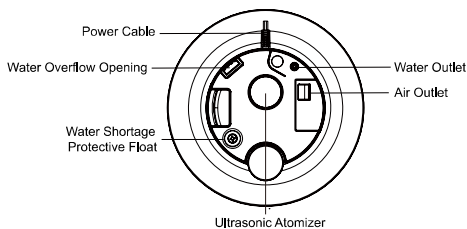
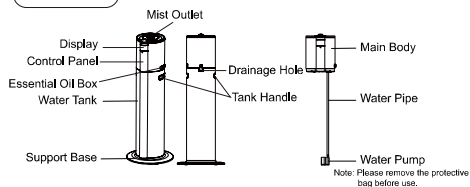

Control Panel

- POWER**
 After turning on the power, touch to turn on the screen, and touch again to turn it off.
- MAX-MIN**
 The product is divided into low/medium/high mist volume and the mist volume can be adjusted. Touch the mist button each time for cycle adjustment.
- CONSTANT HUMIDITY**
 Touch the button for the first time to enter into the constant humidity function. The default humidity is 40%; touch this button again to adjust the preset humidity, the maximum is 90%. When adjusting, the screen shows the setting humidity, touch again to turn off the constant humidity function, (humidity value is 5% increment)
- TIMER**
 This product has the appointment timer shutdown function. Touch this button to set the shutdown time. Each time to touch the button, the screen will display the setting time. The product can continue to work for 12 hours and then automatically shut down. The automatic shutdown time is set in units of one hour, and the user can select settings from thirteen levels.
- SLEEP**
 Under the working condition, press the SLEEP button to turn on the sleep function. The display will turn off automatically and the product will continue to work in its original state. Press any button to light up the display and turn off the sleep function.

Instructions

1. Place the machine on a flat surface, take off the main body and remove the protective bag of the pump, fill the tank with clean tap water or distilled water (please make sure the power plug must be unplugged when filling water) and do NOT exceed the "MAX" water level.
2. Put the main body on the water tank steadily (the pump should be placed in the water tank and be tightly attached to the bottom of the water tank), then plug in the power plug. Please be sure that the working voltage of the machine must match the use voltage before connecting the power supply.
3. Turn on the POWER switch / MAX-MIN switch, the power indicator lights (the display lights up), the machine starts to work and the mist volume can be adjusted at will.
4. When the water level is too low, the machine will automatically cut off the power and stop working. At the same time, the water shortage indicator lights (red), Please turn off the power switch before re-filling water.

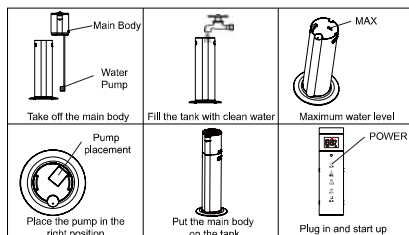

4

Safety guide

Please read this user manual carefully before using the product and keep it for future reference.

Danger

- Do not allow liquids such as water or (flammable) detergent to enter the bottom part area of the product to avoid electric shock or fire.
- Do not immerse the product in water or any other liquid or (flammable) detergent to avoid electric shock or fire.

Caution

- Before connecting the product to the power supply, first confirm whether the voltage labeled on the product matches with the local voltage.
- Please keep away from heat sources, avoid direct sunlight, and leave other electrical products more than 2 meters to avoid moisture.
- This product is not designed for use by persons (including children) who are physically impaired, have sensory or mental disabilities, or lack relevant experience and knowledge, unless they are supervised or instructed by the person responsible for their safety.
- Children should be taken care of to ensure that they do not play with this product.
- Do not block the air inlet and outlet.

Note

- The product should be placed at room temperature for 30 minutes before use.
- Please use clean water with a temperature below 40 degrees.
- If the power socket connecting the product is not in good contact, the plug of the product may get hot. Make sure the socket you are connecting is in good contact.
- Always place and use this product on a dry, firm, flat surface.
- Do not place the product directly under the air conditioner to prevent condensation from dripping onto the product.
- Do not place books or other wet-proof objects in the outlet of the product or under the product.
- Please use the product at normal room temperature (temperature 5 °C ~ 40 °C, relative temperature <80% RH).
- Before turning on the product, make sure the water tank is properly installed and add water as required.
- Do not hit the product with a hard object.
- Do not insert your fingers or other objects into the air inlet and outlet.
- Do not use this product near gas appliances, heating devices or stoves.
- Always unplug the power cord after use and before cleaning the product.
- Do not use this product in a humid or hot environment such as a bathroom, toilet or kitchen.

5

Important

- Unplug when filling and cleaning;
- If the power cord is damaged, it must be replaced by the manufacturer or professional service personnel in order to avoid danger. It must not be replaced by yourself.

Routine maintenance

In some places, the tap water is "hard" (the content of calcium and magnesium ions is high) and some areas use water purifying agents such as bleaching powder. Therefore, when using humidifier, a part of calcium and magnesium ions are sprayed together with the water mist, spreading on the surface of the object and on the ground. After drying, it forms a water-alkali like white powder. Due to the impure water, a part of the precipitate forms scale on the transducer and the surface of base, which affects the humidification effect of the humidifier.

1. Keep the humidifier clean.
 - Humidify with pure water;
 - Clean the atomizer and water tank every week;
 - Replace the old water in the water tank frequently to keep the humidifier clean;
 - When the humidifier is not used for a long time, do not store water in the water tank and main body;
 - When collecting, please wash and dry the parts and store them.
2. Method of cleaning the transducer and the base.
 - Before cleaning, please turn off the power and unplug the power socket;
 - Pour the detergent into the main body, then add warm water of about 60° to dissolve completely, soaking for 5-10 minutes;
 - Then brush the surface of the atomizer with a cleaning brush until the scale is removed;
 - Clean the main body at the same time, wipe the surface of the atomizer with a piece of soft cloth.

Common problems

Abnormal phenomenon	Cause analysis	Solution
Water shortage alarm	Water cannot be pumped upward to the main body	Take off the main body to check whether the protective bag of water pump is removed, or press the power switch to observe whether the pump is working
	No water or only a small amount of water in the tank of the main body	Turn on the machine and observe whether there is water flowing out of the water outlet in the tank of the main body
	No water flows out of the water outlet of the pump	Check if the water pipe is well connected
	Abnormal water shortage protection	Check whether the water shortage protective float in the tank of main body can float up and down normally
Mist is weak	There are impurities in the air outlet of the main body	Check whether the air outlet (essential oil box) of the main body is blocked by impurities

Common problems

Abnormal phenomenon	Cause analysis	Solution
The display is off, no wind and mist	Power is not connected or there is a problem	Reconnect the power. If it still does not work, please contact our after-sales service in time
The display is on, but there is no wind or mist	Water level is too high	Pour off some water from the tank and tighten the main body with water tank
Low mist volume	Ultrasonic atomizer has more scale or excessive impurities in water	Clean the atomizer, or replace with clean water
Abnormal noise	Too little water in the tank or uneven surface	Refill the water tank and place the machine on a solid and stable surface

Warranty Policy

Warranty period

- The humidifier shall have a non-human damage performance failure within 30 days from the date of receipt by the user, and may choose to return, exchange or repair;
- Man-made damage, damaged packaging, missing spare parts, and used products are not included in the 30-day free return. Therefore, the round-trip freight shall be borne by the user;
- Within 1 year from the date of signing in, if there is any non-human damage performance failure, users can enjoy the free replacement service. The round-trip freight shall be borne by the seller.

Non-warranty policy

- The following conditions are not covered by the warranty and require the user to pay for repairs.
- The warranty period has expired;
 - Damage caused by human causes;
 - Damage caused by force majeure factors;
 - Any damage caused by use, maintenance, and adjustment not in accordance with the requirements of the User Manual;
 - Failure or damage caused by forced use of this product beyond normal use conditions;
 - The user disassembles or repairs the product without authorization.

FCC Caution.

§ 15.21 Information to user.

Any Changes or modifications not expressly approved by the party responsible for compliance could void the user's authority to operate the equipment.

§ 15.105 Information to the user.

Note: This equipment has been tested and found to comply with the limits for a Class B digital device, pursuant to part 15 of the FCC Rules. These limits are designed to provide reasonable protection against harmful interference in a residential installation. This equipment generates uses and can radiate radio frequency energy and, if not installed and used in accordance with the instructions, may cause harmful interference to radio communications. However, there is no guarantee that interference will not occur in a particular installation. If this equipment does cause harmful interference to radio or television reception, which can be determined by turning the equipment off and on, the user is encouraged to try to correct the interference by one or more of the following measures:

- Reorient or relocate the receiving antenna.
- Increase the separation between the equipment and receiver.
- Connect the equipment into an outlet on a circuit different from that to which the receiver is connected.
- Consult the dealer or an experienced radio/TV technician for help.

This device complies with part 15 of the FCC Rules. Operation is subject to the following two conditions:

(1) This device may not cause harmful interference, and (2) this device must accept any interference received, including interference that may cause undesired operation.

*RF warning for Mobile device:

This equipment complies with FCC radiation exposure limits set forth for an uncontrolled environment. This equipment should be installed and operated with minimum distance 20cm between the radiator & your body.