



MAGIC EAGLE

ALWAYS CONNECTED TO NATURE



* Please scan the QR code to download the instruction manuals
in English, German, Italian, French, Spanish and Japanese.

QUICK START GUIDE

Contents

1. What's in the Box.....	01
2. Camera Introduction.....	02
3. Set up the Camera.....	04
4. Install the Camera.....	05
5. Troubleshooting.....	09
6. Specifications.....	11
7. Important Safety Instructions.....	12
8. Notification of Compliance.....	13

1 What's in the Box



Camera *1



Antenna *1

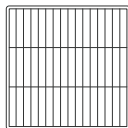

Solar panel *1



Solar panel bracket*1



Strap*2

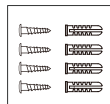

Screw pack*1



Ejection pin*1



User manual*1

2 Camera Introduction

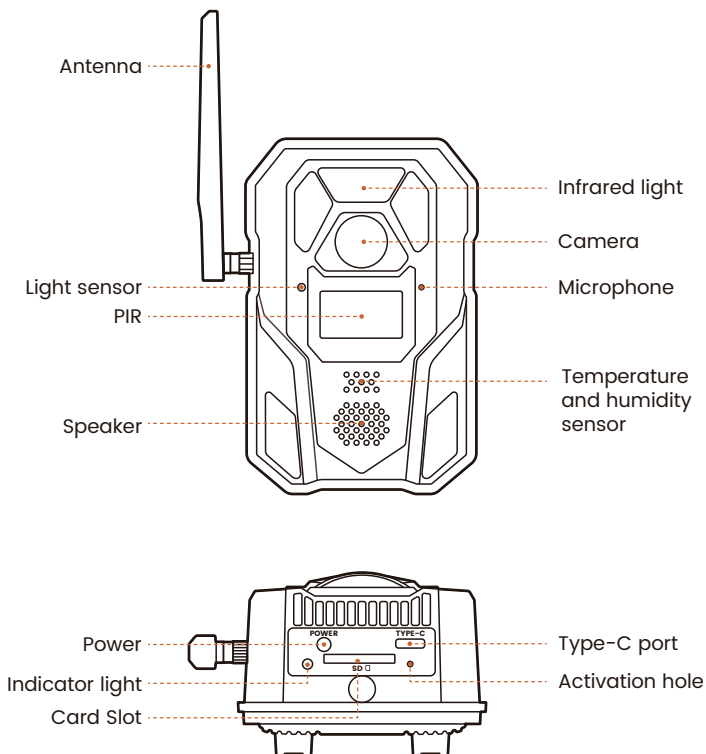

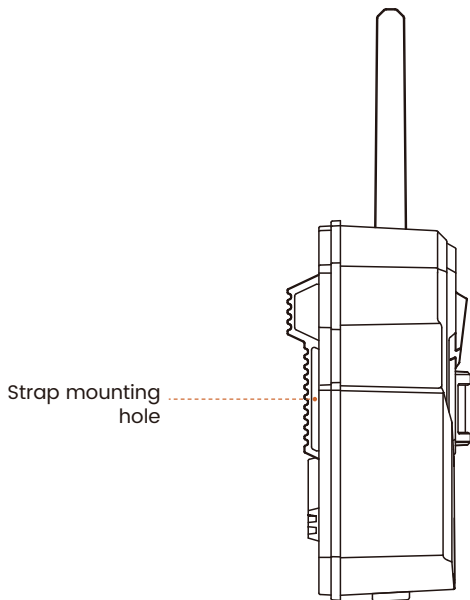

3 Set up the Camera

STEP 1: DOWNLOADING AND LOGGING IN TO THE MAGIC EAGLE® APP

Download the Magic Eagle® app, and log in to or register for a Magic Eagle® account.

Note: The app is available on the App Store and Google Play.



STEP 2: ADDING AND BINDING THE CAMERA ON THE DEVICE PAGE

Open the app and click the "⊕" button or the "+ Add Device" button at the top right corner of the homepage.

Note: Before the first use, insert the ejection pin into the activation hole to press the activation switch. The camera will then start and wait for binding.

There is no need to insert an additional SIM card, since the The device comes with a 4G network cloud SIM card offering free trial usage. Please recharge as soon as possible before the trial period ends or the data runs out. If you are unable to bind the device, please contact our customer support.

4 Install the Camera

STEP 1: INSTALLING THE SD CARD

We recommend using an SD card. Please insert the SD card as shown in the diagram.

Note: We recommend using an SD card with a capacity of 32 GB or higher (up to 256 GB supported). Please insert the SD card as shown in the diagram.

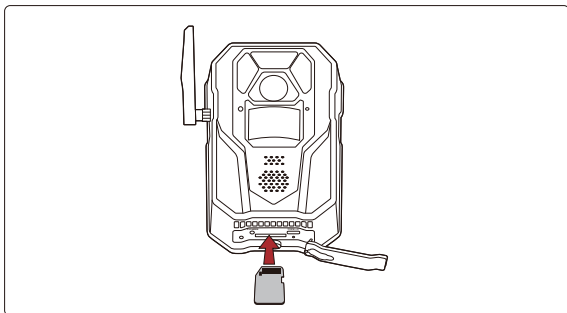

STEP 2: INSTALLING THE ANTENNA

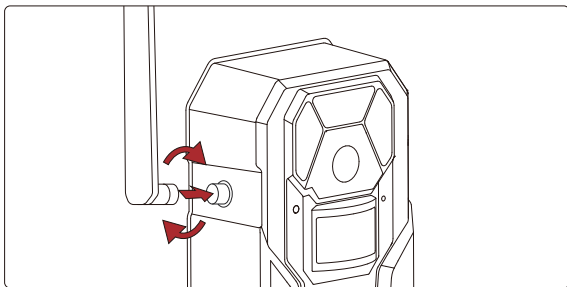

STEP 3: INSTALLING THE CAMERA

Thread the strap through the installation slot and tie the camera to a tree. A recommended height is 1-1.5 meters, which is roughly the same as the height of the monitored animals.

Note: You can adjust the camera according to the altitude of the monitored target.

* It is recommended not to have leaves, branches, or tall grass obstructing the camera's line of sight, and not to let the light source directly shine onto the lens.

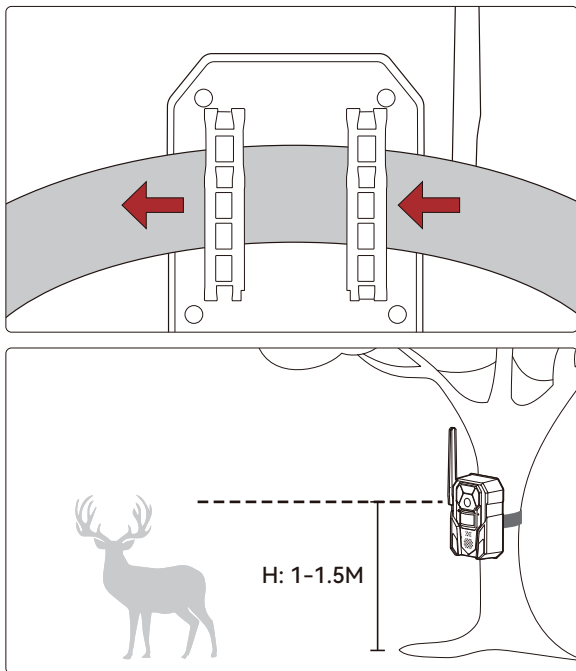

STEP 4: CONFIRMING THE DEVICE'S OPERATING STATUS

1. Turn on the power switch and observe the indicator light to ensure that the device is connected to the network and operating successfully.

INDICATOR STATUS

- Solid Blue Light: Operating properly
- Fast Flashing Blue Light: Connected to network
- Slow Flashing Blue Light: Device already bound
- Solid Red Light: Charging completed
- Fast Flashing Red Light: Charging error
- Slow Flashing Red Light: Charging in progress
- No Light: In sleep mode/power off

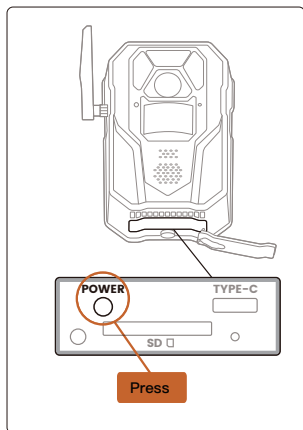

2. Open the camera preview page on the mobile app: Click the Homepage's "+" icon -> Add device -> Successful addition -> View camera, and adjust the angle to capture the desired target.

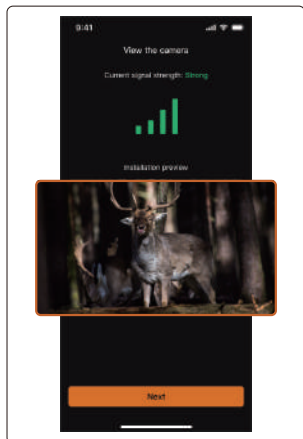

STEP 5: INSTALLING THE SOLAR PANEL

1. First, turn the bracket's nut to the left to make it active, then turn the bracket to the right against the solar panel screw hole until it is fully tightened. To remove the bracket, press the spring tab to easily disassemble it.

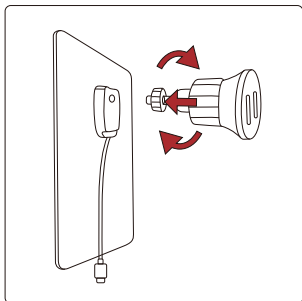

2. Then, pass one end of the strap through the loop at the bottom of the bracket.

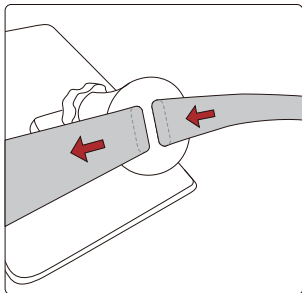

3. Finally, tie the strap around the tree trunk or pole and tighten the buckle to firmly lock the strap. Adjust the tilt angle of the solar panel and tighten the nut to receive as much sunlight as possible every day.

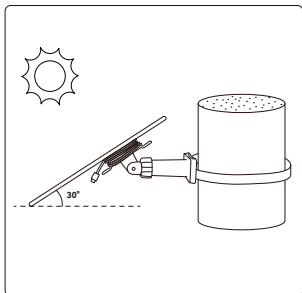

5 Troubleshooting

THE CAMERA CANNOT BE POWERED ON OR GETS OFFLINE

Getting offline means that the device has lost its network connection, and it will not function properly in this state. The possible causes for the device being offline are listed below. Please investigate them one by one:

- Check if the device's battery is low or if it is powered off.
- If the device has no network, compare the signal strength between your phone and the device for consistency. If your phone also has no signal, install the device in a location with stable signals instead.
- Poor or unstable network connection.
- When the signal is low/medium, the device may get offline. Thick walls, bricks, ceramics, electromagnetic devices, large amounts of liquid, and large metal objects can interfere with the signal. Avoid these obstacles as much as possible. You can check the signal strength on the app homepage or the device settings page.
- Your phone cannot access the Internet or has an unstable network.
- Ensure that your phone is properly connected to the Internet.
- Make sure that your phone has enabled network permissions for the app.
- Try reconnection by pulling down the device list on the app homepage and refreshing the list.

If these steps don't work, please contact the support team.

THE PIR SENSOR FAILS TO TRIGGER ALARMS

If the PIR sensor fails to trigger any type of alarm in the coverage area, try the following solutions:

Ensure that the camera is positioned perpendicular to the expected movement direction of wildlife.

Ensure that the PIR sensor is enabled or the schedule is correctly set and running.

Check the sensitivity settings and make sure that they are correctly configured.

Ensure that the battery is functioning properly.

Reset the camera and try again.

If these methods don't work, please contact the support team.

UNABLE TO RECEIVE PUSH NOTIFICATIONS

If you don't receive any push notifications when motion is detected, try the following solutions: Ensure that push notifications are enabled. Ensure that the PIR schedule is set up correctly.

- Check your phone's network connection and try again.
- If the signal indicator shows red, the camera is disconnected from the Internet.
- Ensure that you have allowed notifications on your phone. Go to system settings on your phone and allow the Magic Eagle® App to send push notifications.

If these methods don't work, please contact the support team.

WHAT TO DO IF THE DEVICE RUNS OUT OF POWER?

If the environment has been overcast for an extended period or there is insufficient sunlight, adjust the solar panel to a location with more sunlight exposure. If the device runs out of power and cannot be turned on, press the POWER button on the device to power it on, and use a 5V1A power adapter to recharge it.

6 Specifications

Image resolution	5MP
Video bit rate	Adaptive
Storage media	32GB SD card included, supported up to 256GB
Battery capacity	13000mAh Lithium-ion battery
Adapter requirement	5V/1A
GPS	AGPS
IR quantity	6
Size(without bracket)	5.65x3.66x2.85 inch

7 Important Safety Instructions

- Before using the camera, please read the user manual carefully: Only use the same or equivalent type of devices and accessories recommended by the manufacturer for replacement.
- Temperature and Humidity Range

Operating Temperature and Humidity Range	Charging	0~45°C 60±25%R.H.	A temperature below -10°C results in charging efficiency decrease, which can affect the battery's lifespan.
	Discharging	-20~60°C 60±25%R.H.	
Long-Term Storage Temperature	-20~45°C 60±25%R.H.		Do not store the device for more than six months. If it has been stored for six months, charge the battery once. For batteries with a protection board, charge them once every three months.

- Do not use or store the camera near heat sources such as space heaters, cooking surfaces, cooking equipment, irons, radiators, or fireplaces. Extreme high temperatures may lead to explosions.
- Do not impact or excessively compress the camera, as this may cause a fire or explosion.
- Keep the camera and batteries away from children.
- Never attempt to disassemble, repair, or modify the camera or battery by yourself.
- Keep the charging port dry, clean, and free of debris.
- Always comply with local safety laws and regulations when using the camera.
- Always follow local laws regarding waste disposal and recycling.

8 Notification of Compliance

The laws and regulations related to this product vary by jurisdiction. Before using the product, please review all relevant laws and regulations in your jurisdiction to ensure compliance with applicable laws and regulations. During use of the product, you must adhere to the relevant local laws and regulations. Magic Eagle® is not liable for any illegal or improper use or its consequences. Magic Eagle® is not liable in any of the following circumstances:

TERMS AND PRIVACY

By using this product, you agree to the service terms and privacy policy on Magic Eagle®.

TECHNICAL SUPPORT

If you need any technical assistance, please contact our official customer service before returning the product.

FCC WARNING

This device complies with part 15 of the FCC rules. Operation is subject to the following two conditions: (1) this device may not cause harmful interference, and (2) this device must accept any interference received, including interference that may cause undesired operation.

Changes or modifications not expressly approved by the party responsible for compliance could void the user's authority to operate the equipment.

NOTE: This equipment has been tested and found to comply with the limits for a Class B digital device, pursuant to part 15 of the FCC Rules. These limits are designed to provide reasonable protection against harmful interference in a residential installation. This equipment generates uses and can radiate radio frequency energy and, if not installed and used in accordance with the instructions, may cause harmful interference to radio communications. However, there is no guarantee that interference will not occur in a particular installation. If this equipment does cause harmful interference to radio or television reception, which can be determined by turning the equipment off and on, the user is encouraged to try to correct the interference by one or more of the following measures:

- Reorient or relocate the receiving antenna.
- Increase the separation between the equipment and receiver.
- Connect the equipment into an outlet on a circuit different from that to which the receiver is connected.
- Consult the dealer or an experienced radio/TV technician for help.

Radiation Exposure Statement

This equipment complies with FCC radiation exposure limits set forth for an uncontrolled environment. This equipment should be installed and operated with minimum distance 20cm between the radiator and your body.

Contact Us

For any inquiries, feel free to contact us. We will respond as soon as possible.

E-mail: support@magiceagle.com Tel: +1 888-991-1009

Website: magiceagle.com

Manufacturer: Shenzhen Efercro Electronic Technology Co.,Ltd.

Address: Room 901, Block E, Building 1, Section 1, Chuangzhi
Yuncheng, Liuxian Avenue, Xili Community, Xili Street, Nanshan
District, Shenzhen