

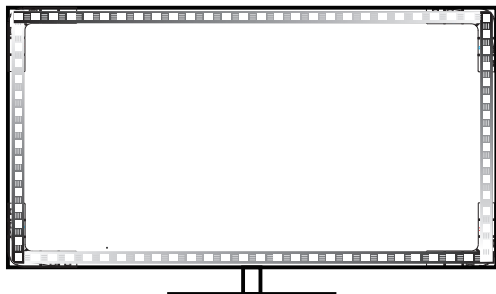

Smart **TV Light Strip**  
with **HDMI Sync Box** ET6  
**User Manual**





We appreciate the trust and confidence you have placed in LINKIND through the purchase of lighting kits. We strive to continually create quality products designed to enhance your smart home experience. Visit us online to see our full line of products available for your home improvement needs. **Thank you for choosing LINKIND.**

Product Name	Smart TV Light Strip with HDMI Sync Box ET6
Adapter Input	100-240V~50/60Hz
Adapter Output	DC12V=3A
Power	36W
Light Strips	10ft*2
Voice Assistants	Amazon Alexa, Google Assistant
Control Way	APP, voice, sync box
HDMI Cable 2.0	Max Support 4K@60Hz

## ■ Packing List

Item List	Quantity
Sync Box	1 PC
RGB LED Strip	2 Rolls
Power Adapter	1 PC
HDMI Cable 2.0	1 PC
Mounting Accessories List	Quantity
Fixing Bracket	4 PCS
Bracket Clip	16 PCS
Strip Tie Holder	2 PCS
Strip Tie	2 PCS
Light Strip Holder	4 PCS



Sync Box

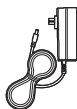

Power Adapter

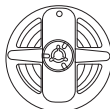

RGB LED Strip\*2



HDMI Cable 2.0



Fixing Bracket \*4



Brackets Clip \*16



Light Strip Holder \*4



Strip Tie &  
Strip Tie Holder\*2

## ■ Introduction Of Sync Box

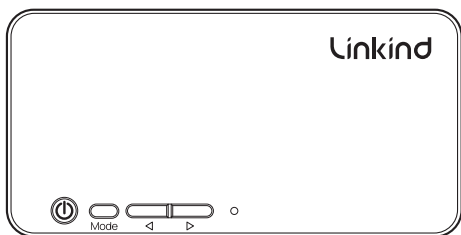

Network Connection Indicator

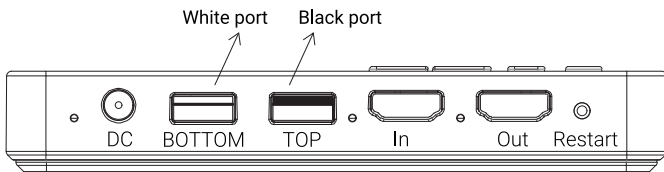

Power button (long press at least 5s: reset the sync box)	On/Off
Mode button (short press: change the mode)	Screen mode
	Preset mode
	Music mode
◀ ▶ Button	Switch to Screen mode: Low/Medium/High sensitivity
	Switch to Preset mode: Party/Christmas/Romance/Spotlight /Meteor/Firework
	Switch to Music mode: Rhythm/Roll/Energy/Lively



Power indicator

HDMI input indicator

HDMI output indicator

Symbol	Function description
Restart	Restart device
HDMI Output	Connect with TV/Projector/Monitor screen etc.
HDMI Input	Connect with PS5/Switch/Computer/Laptops/TV Box and other HDMI Signal devices
USB TOP	Light Strip  → Note: from TV backside view
USB BOTTOM	Light Strip  → Note: from TV backside view
Power Adapter	12V=3A

## ■ Connect to the APP and set light positioning

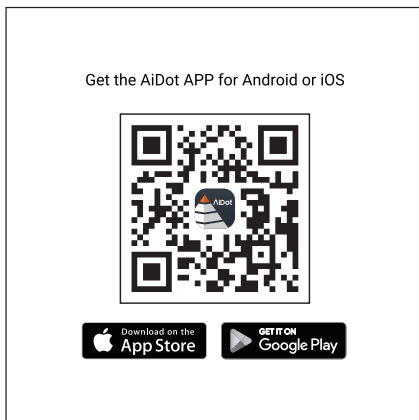

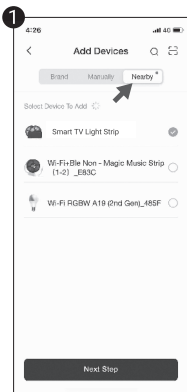

Choose the device that you want in "nearby". Make sure your Bluetooth and location services are turned on. If you still can not find the device in "nearby" try to press "power" for 5s to reset the device.

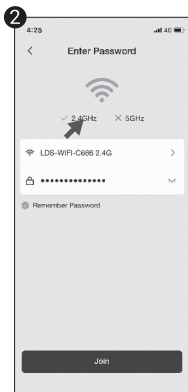

Connect Wi-Fi (please use 2.4GHz Wi-Fi)

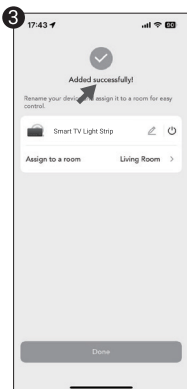

Device added successfully

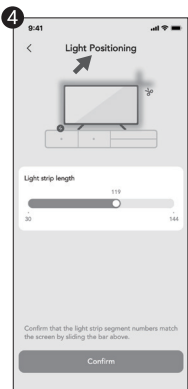

Use light positioning to match TV size and then go back to "Screen" in APP

Where is "Light Positioning"?

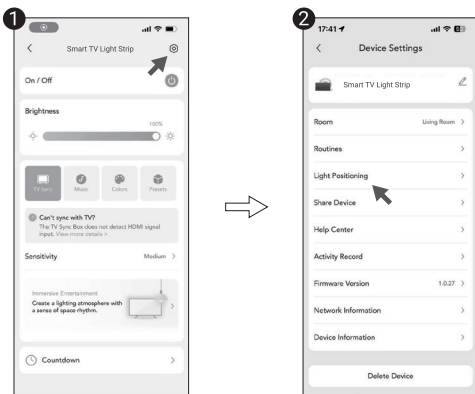

Click Settings

Light Positioning

## ■ Trouble Shooting

**Q1: Why are the lights not synchronized with the TV screen?**

1. Make sure that the mode selected is TV screen.
2. Slide the light strip on the APP to ensure that the length of the light strip is the same as the length of the TV. If you have cut the light strip, please adjust the actual length to set up the light strip.
3. Check to ensure the light strip installation began at the lower right corner of the TV for the "TOP" light strip. Make sure the USB of each roll is connected into the correct top and bottom USB port.
4. Make sure that the cable is connected correctly; the sync box should read the signal of the TV Box/PS5/Switch and other devices, not the screen signal. Please check whether the TV Box, PS5 or Switch has a signal input to the sync box.

**Q2: Why can't I connect the sync box to the APP?**

1. Check to ensure the Wi-Fi is 2.4G, the sync box does not support 5G Wi-Fi.

2. Make sure that the Wi-Fi is working.
3. Reset the device and reconnect by pressing and holding the power button of the sync box for 5 seconds.

### **Q3: How can I connect the sync box to Alexa and Google Assistant?**

#### **Alexa**

1. After you have connected your device to AiDot APP, go to the Aidot>Integration>choose Amazon Alexa.
2. Put in your Alexa username and password to connect the two accounts.
3. This enables the AiDot skill within Alexa (Please note: the skill is AiDot).
4. Once connected, use your nearest Alexa device and address it using the name you assigned in the AiDot APP. You can tell it to turn the light strips on or off, change colors, dim the light strips etc.

#### **Google Assistant**

1. After you have connected your device to AiDot APP, go to the AiDot APP>Integration>choose Google Assistant.
2. Search the AiDot action within Google Assistant (Please note: the action is AiDot).
3. Once connected, you can tell it to turn the light strips on or off change colors, dim the light strips etc.

### **Q4: Why does the APP state "no internet access" when I select the Wi-Fi of the sync box?**

A: The notification is from your phone, this occurs especially with an Android phone. This message is not actually from the APP. This message appears because the Wi-Fi of the device does not have access to the Internet. You can tap 'connect' to proceed. Please do not select cancel or the light strips will not connect.

### **Q5: How can I share the light strips to be controlled by family members?**

- A: Step 1: Tap "My Home" in the top left corner of the APP home page.  
Select "Manage Home"
- Step 2: Select home and then select "invite" under "Home Member"
- Step 3: Put the name and email of the people in your home that you want to invite.
- Step 4: Select "Share Invitation"



## ■ FCC WARNING

This device complies with part 15 of the FCC Rules. Operation is subject to the following two conditions: (1) this device may not cause harmful interference, and (2) this device must accept any interference received, including interference that may cause undesired operation. Any changes or modifications not expressly approved by the party responsible for compliance could void the user's authority to operate the equipment.

NOTE: This equipment has been tested and found to comply with the limits for a Class B digital device, pursuant to Part 15 of the FCC Rules. These limits are designed to provide reasonable protection against harmful interference in a residential installation. This equipment generates, uses and can radiate radio frequency energy and, if not installed and used in accordance with the instructions, may cause harmful interference to radio communications.

However, there is no guarantee that interference will not occur in a particular installation. If this equipment does cause harmful interference to radio or television reception, which can be determined by turning the equipment off and on, the user is encouraged to try to correct the interference by one or more of the following measures:

- Reorient or relocate the receiving antenna.
- Increase the separation between the equipment and receiver.
- Connect the equipment into an outlet on a circuit different from that to which the receiver is connected.

To maintain compliance with FCC's RF Exposure guidelines, This equipment should be installed and operated with minimum 20cm distance between the radiator and your body: Use only the supplied antenna.

# Linkind

Our goal is to bring you the best shopping experience. If you have any questions about our product, please feel free to contact us. Our customer service team will be happy to provide assistance.

☎ 1877-770-5727 (Mon.-Fri.9 to 5 PST)

✉ [service@linkind.com](mailto:service@linkind.com)

🌐 <http://www.linkind.com>

@ Why not share your stories to help other buyers?

📘 @linkind.lights

📺 @linkindofficial

📺 @linkindofficial

Made in China **FC**