



Only suitable for children over 14 years old

## Manual for Remote Control Racing Yacht (Product model: HJ819)



★ Please read the product manual carefully before use. The pictures in the manual may differ from the actual product, and the actual product shall prevail.

Product parameter	Length	Width	Height	Frequency	Control distance	High speed driver time	Low speed driver time	Max speed	Battery required in the yacht	Battery required in the transmitter
	250mm	80mm	70mm	2.4G	≈60m	≈50min	≈2hours	≈15km/h	3.7V Lithium battery	4×1.5V AA

### Product features

1. This product uses 2.4G automatic frequency matching technology and has strong anti-interference ability, enabling multiple people to play simultaneously.
2. The speedboat is equipped with circular dazzling lights, making it quickly become the focus of observation. At night, you can also see the direction clearly and play freely.
3. Off water induction: After the speedboat leaves the water surface, it will automatically cut off the power supply to avoid injury from touching the high-speed rotating propeller.
4. Anti overturning function: In case of accidental capsizing during navigation, the speedboat can be quickly overturned through the remote control to ensure normal navigation.
5. Low voltage protection function: When the battery of the speedboat is low during play, the lights of the speedboat quickly flash, the green light of the remote control quickly flashes, and the speedboat is forced to drive at low speed, effectively ensuring that the speedboat returns to shore.
6. The speedboat adopts full proportional control, with delicate and sensitive operation, making navigation more enjoyable.
7. The speedboat uses two 130 strong magnetic motor, which is more powerful and can travel at a maximum speed of up to 15km/h.
8. The speedboat adopts a 3.7V lithium-ion rechargeable battery to increase upgrade capacity and provide longer range.
9. The remote control is equipped with steering fine adjustment to ensure fast and convenient adjustment of the speedboat's straight travel.
10. The remote control is equipped with a high and low speed switching function, allowing beginners to play happily.
11. The remote control is equipped with a power reminder function. When the red light on the remote control slowly flashes, it indicates that the remote control has insufficient power. Please replace the battery in a timely manner.
12. Ultra long distance reminder function, when the speedboat exceeds the controllable signal range or environmental signal interference, the green light on the remote control will slowly flash to prompt, ensuring that the speedboat is sailing within the effective control range.

### Packing list

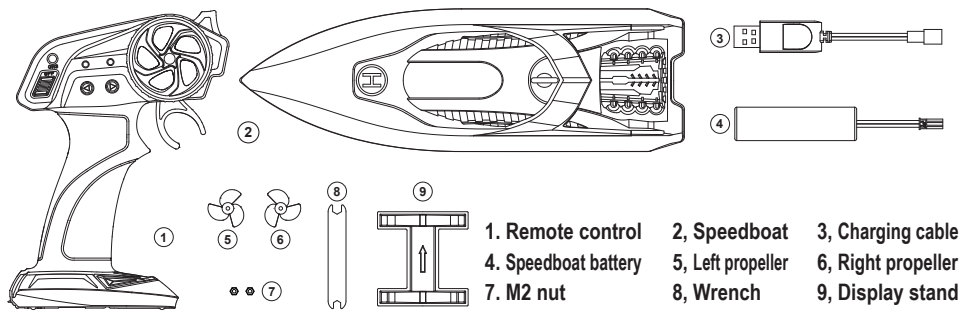

### Product Plan Illustration

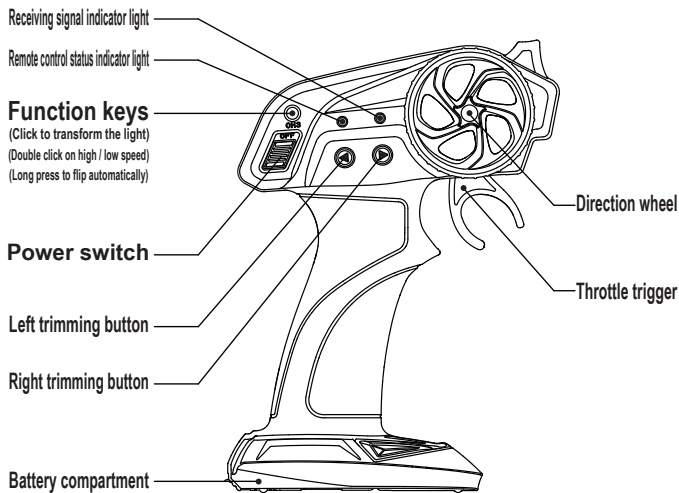
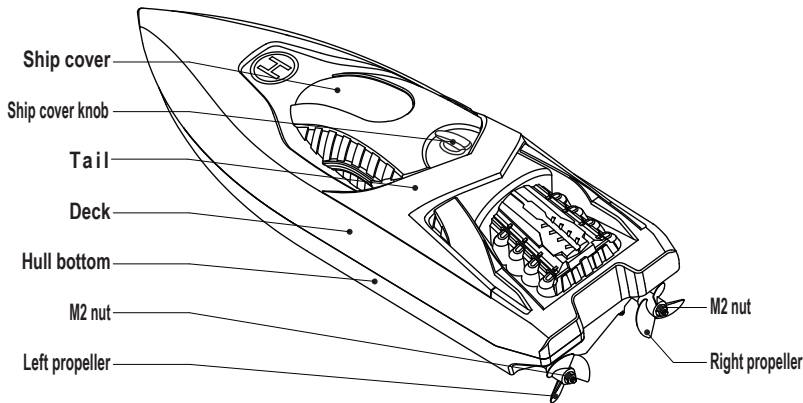

### Preparation before playing the racing yacht

1. As shown in Figure 1, press the battery cover latch backward with your thumb as shown by arrow 1, and at the same time, use upward force as shown by arrow 2 to open the battery cover.
2. Insert the positive and negative electrodes of the battery into the battery compartment in the direction shown in Figure 2, and then cover the battery cover.
3. When turning on the power switch of the remote control, do not simultaneously pull the remote accelerator trigger and steering wheel to ensure that the startup detection function is normal.

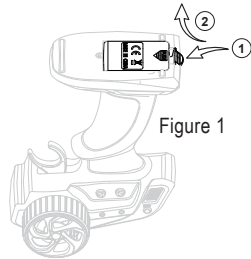

Figure 1

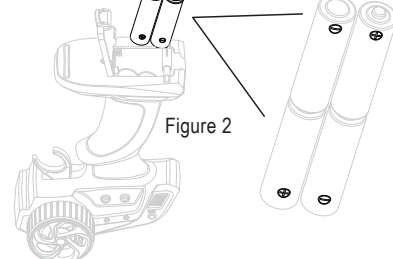
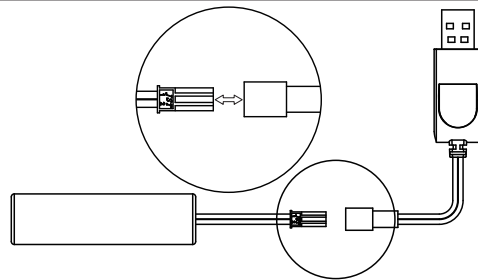

Figure 2

### Charging of Power battery

Insert the lithium rechargeable battery configured for the product into a USB charger (compatible with the buckle and slot), and then plug the USB charger into the built-in 5V charger adapter or a powered on computer USB port. At this time, a red light in the USB will light up to indicate that the battery is charging (charging time is about 2 hours), and a red light off to indicate that the charging is complete. Please disconnect all connections



### ⚠ Attention

Can only use the built-in charger for the product charging.

Do not leave the charger alone when charging.

Stop the charging process immediately when the battery is found hot.

Disconnect the charger and battery plug and disconnect the power supply when you stop charging.

Please immediately stop using the current battery once appears odor or a sudden change in the process of heat, deformation, discoloration or other abnormal phenomena during using or charging the battery.

After drive, if the battery temperature is high, it is suggested that you should wait 30 minutes before recharge the battery, which can effectively extend the service lifespan of the battery.

Fully charging the battery before storing it, in order to avoid the battery over-discharge and damage too much.

Please contact our product distributor for help if you are not sure about charging procedure.

### ⚠ Warning

Remove or restructure battery is prohibited.

Short circuit the battery is prohibited.

It is forbidden to battery into the water.

Direct contact with the discharge battery is prohibited.

It is prohibited to pierce the battery using a cutting-edge insert or other ways to damage the battery.

Use the designated charger to charge batteries according to the charging request.

### Preparations before playing the racing yacht

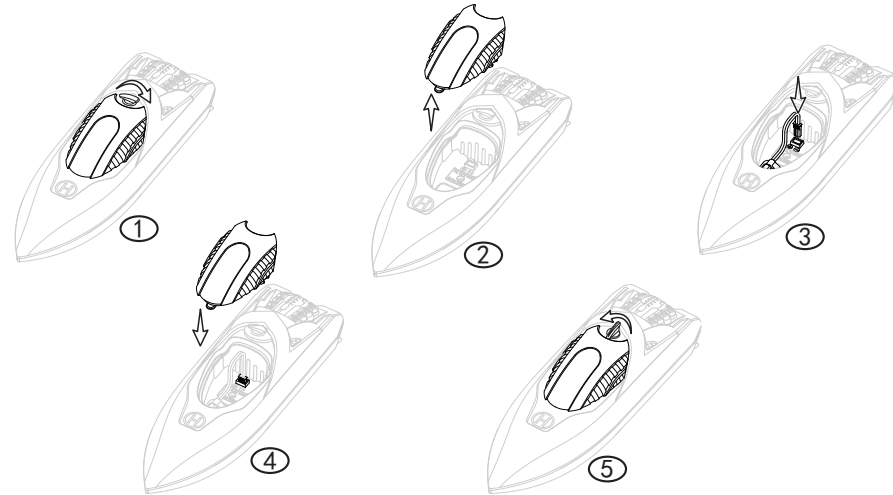

1. As shown in Figure 1, rotate the ship cover knob clockwise by 90 degrees. As shown in Figure 2, pinch both sides of the ship cover and lift it up.
2. As shown in Figure 3, install a fully charged battery into the ship, with red positive and black negative inserted into the socket hole in the cabin. (Battery plug foolproof design. If it cannot be inserted smoothly, please change the direction of insertion)
3. As shown in Figure 4, insert the front end of the ship cover into the cabin, as shown in Figure 5. Rotate the ship cover knob counterclockwise by 90 degrees to tighten the ship cover.

### Transmission and reception matching method

1. Put the battered speedboat into the water, and the speedboat will automatically power on. The speedboat lights will flash, and then turn on the remote control power switch. The remote control power indicator light and signal indicator light will always be on. If the speedboat lights are always on, the automatic frequency synchronization will be successful. At this time, the remote control throttle and steering wheel can be operated to control the speedboat to play.
2. When multiple speedboats are playing at the same time, follow step 1 to put each speedboat into the water one by one, and turn on the corresponding remote control. Do not put multiple speedboats into the water at the same time and then turn on multiple remote controls to avoid frequency mixing.
3. If you are unable to control your speedboat due to cross frequency phenomenon, simply take the cross frequency speedboat out of the water, turn off the power switch of the remote control, and follow step 1 again to place the speedboat in the water in order to automatically re align.

### ⚠ Attention

1. The product is only suitable for kids over 14 years age.
2. Don't play in the grass and sundry water, the water impurities may bind the boat propellers, leading to the boat moored.
3. Don't play in the swimming pool or water where there are someone, so as not to hurt.
4. Don't exceed the scope of remote control when playing the boat, in order to avoid the boat out of control.
5. Don't play the boat in brackish waters, to avoid damage to the boat of parts.
6. It is a normal phenomenon that the boat releases a little smoke for the first time to play, the smoke will gradually disappear after several cycles.

**Tips:** After driving, first lift the speedboat out of the water, and then turn off the power switch of the remote control to prevent the speedboat from losing control due to other signal interference.

Operation:

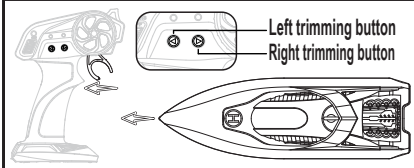
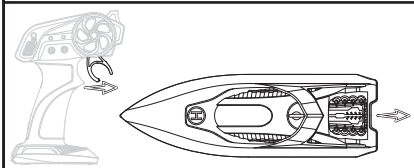
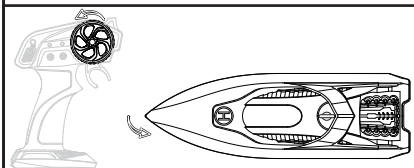
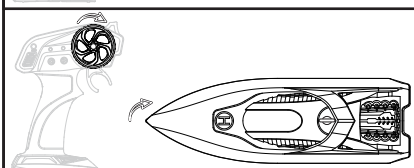
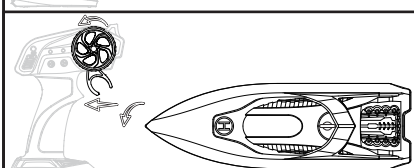
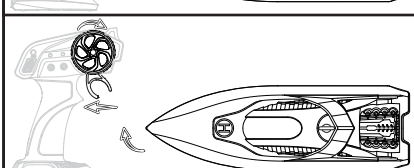
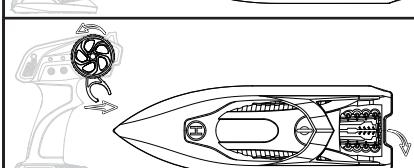
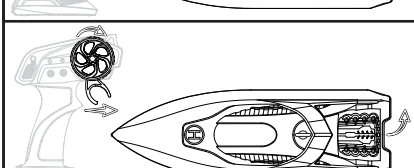
	Forward: Pull the trigger backwards, and the speedboat will travel in a straight line forward. The speed of travel is proportional to the proportion of the trigger pulled.  Fine adjustment: When only pulling the trigger, if the speedboat cannot travel in a straight line, there will be left yaw. Please click the right fine adjustment button to correct the straight direction to the right. If yaw is right, click the left fine adjustment button and continue to click the fine adjustment button until the speedboat travels in a straight line.
	Backward: Push the trigger forward and the speedboat will move backwards.
	Left turn in place: Turn the steering wheel to the left, and the speedboat will turn left in place.
	Turn right in place: Turn the steering wheel to the right, and the speedboat will turn right in place.
	Left turn: Pull the accelerator trigger and the speedboat will move forward. At this point, turn the wheel in the left direction again and the speedboat will turn left and move forward. (The turning angle is proportional to the rotation angle of the wheel)
	Right turn: Pull the accelerator trigger and the speedboat will move forward. At this point, turn the wheel in the right direction again and the speedboat will turn to the right and move forward. (The turning angle is proportional to the rotation angle of the wheel)
	Left Backward: Push the throttle trigger to reverse the speedboat. At this point, turn the wheel in the left direction again, and the speedboat will turn back to the left. (The turning angle is proportional to the rotation angle of the wheel)
	Right Backward: Push the throttle trigger to reverse the speedboat. At this point, turn the wheel in the right direction again, and the speedboat will turn back to the right. (The turning angle is proportional to the rotation angle of the wheel)

Function keys

1. Click on the function button: Switch the speedboat light to slow flashing,click the button again to turn off the speedboat light, click the button again to keep the light on, and click on the cycle switch.
2. Double click function button: Switch the speedboat to low speed driving, double click the button again to switch to high speed driving, and double click to cycle switching.
3. Long press function button: When the speedboat overturns and cannot travel, long press this button to automatically flip the speedboat back to center. If the speedboat does not flip back to center after long press, you can try to long press this button multiple times.

Function keys  
(Click to transform the light)  
(Double click on high / low speed)  
(Long press to flip automatically)

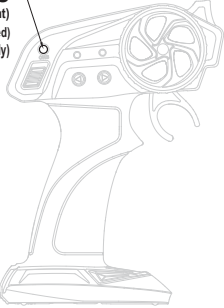

Safety precautions



Please do not touch the propeller when it is rotating, it will cause injury.

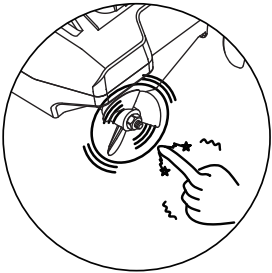

Replace propeller

If the propeller is damaged and needs to be replaced, cut off the power in the speedboat, unplug the battery, grasp the blades to prevent them from rotating, use a delivery wrench to counterclockwise rotate and remove the hexagonal nut, pull out the propeller backwards, replace with a new propeller, and then reinstall the nut clockwise and lock the nut.

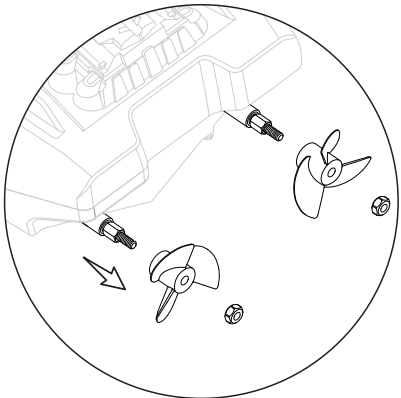
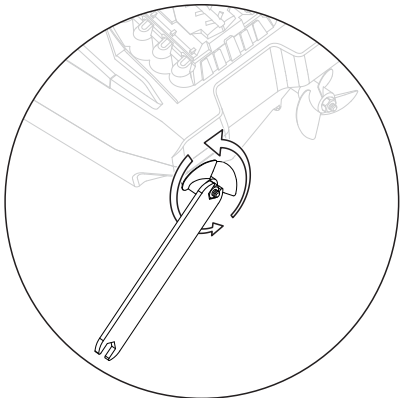

Maintenance

- 1.Avoid prolonged exposure to sunlight on the surface of the product and clean the contaminated oil with neutral detergent and clean water.
- 2.Before storage, please clean the racing yacht after play to ensure that the product is free from moisture and stains.
- 3.The lithium battery must be removed from the hull and stored with full charge before storage.
- 4.Please remove the battery from the remote control before storage to avoid battery leakage and damage to the remote control.

Low voltage protection

Low voltage protection prompt for speedboats:

When the battery level of the speedboat is close to low, the speedboat will instantly stop driving. The speedboat light will flash quickly to indicate entering a low voltage protection state, and the green light on the remote control will also flash synchronously and quickly. At this point, release the accelerator trigger of the remote control to the original position, and then pull the trigger to control the speedboat to move towards the shore (after the speedboat enters low voltage protection, the battery power is limited. To ensure the safe return of the speedboat, please immediately move towards the shore to avoid the speedboat from running out of power on the water)

Remote control low voltage prompt:

When the battery level of the remote control is close to low, the status indicator light (red light) of the remote control slowly flashes, reminding you to replace the remote control battery in a timely manner to avoid losing control of the speedboat and unable to return during play due to the low battery of the remote control.



Warning

- ★ Please follow the instructions or package instructions for proper installation and use. Some parts are assembled by adults. The product should be used under adult supervision.
- ★ The product contains small parts that may pose a risk of accidental ingestion or asphyxiation.
- ★ Please timely put away the packaging materials, so as not to cause accidental injury to children.
- ★ The protective film on the color box is only used for transportation and protection of the color box. Please remove it by yourself before sale and use and dispose of it properly. Do not let children touch it.
- ★ Please keep a safe distance from the propeller which is rotating at high speed to avoid the danger of winch.
- ★ Battery/motor is heat compliance, do not touch to avoid scald danger.
- ★ Warning instructions of radio remote control model:1. In order to ensure the requirements of the electromagnetic environment of the aviation radio station (station), it is forbidden to use all kinds of model remote controls in the area with the center of the airport runway and a radius of 5000 meters. 2. During the period when the relevant national department issues the radio control order, the region shall stop using the model remote control.
- ★ Laser radiation, do not look directly at the speed of light.
- ★ Do not play in deep water to avoid accidents.
- ★ The model can only be connected to class II electrical safety equipment.
- ★ The product must be fully installed according to the instructions before it can be used in water.
- ★ This model is not lifesaving products.
- ★ Charger, battery case and battery shall be plugged into the specified power supply with the same mark as the product.
- ★ Only charger with original factory configuration can be used.
- ★ Charger is not a toy.
- ★ A non-chargeable battery is not chargeable.
- ★ Adult supervision is required while the battery is being recharged.
- ★ Do not mix old and new batteries or different types of batteries.
- ★ The exhausted battery should be taken out in time.
- ★ Please take out the battery if you do not use it for a long time.
- ★ Disconnect the charger before cleaning the model.
- ★ Regularly check chargers, wires, plugs, enclosures and other parts, and stop using them when they are damaged until they are fully repaired.
- ★ Install or replace the battery with the correct polarity.
- ★ Terminals should not be short-circuited.
- ★ The remote controller uses 1.5v \*4 "AA" batteries, and the racing yacht uses 3.7V lithium battery pack.
- ★ Do not short-circuit, decompose or put the battery into fire.
- ★ This package and instruction manual contain important information of the product, please keep it.

Diagram of Sales parts

HJ819-B001 Lithium rechargeable battery 	HJ819-B002 Remote control 	HJ819-B003 USB charger 
HJ819-B004 Receiving board assembly 	HJ819-B005 Motor assembly 	HJ819-B006 Copper nut 
HJ819-B007 Left/Right propeller assembly 	HJ819-B008 Drive shaft assembly 	HJ819-B009 Drive shaft sleeve assembly 
HJ819-B010 Blue battery cover assembly 	HJ819-B011 Orange battery cover assembly 	HJ819-B012 Green battery cover assembly 



**FCC Caution.**

This device complies with part 15 of the FCC Rules. Operation is subject to the following two conditions: (1) This device may not cause harmful interference, and (2) this device must accept any interference received, including interference that may cause undesired operation.

Any Changes or modifications not expressly approved by the party responsible for compliance could void the user's authority to operate the equipment.

**Note:** This equipment has been tested and found to comply with the limits for a Class B digital device, pursuant to part 15 of the FCC Rules. These limits are designed to provide reasonable protection against harmful interference in a residential installation. This equipment generates uses and can radiate radio frequency energy and, if not installed and used in accordance with the instructions, may cause harmful interference to radio communications. However, there is no guarantee that interference will not occur in a particular installation. If this equipment does cause harmful interference to radio or television reception, which can be determined by turning the equipment off and on, the user is encouraged to try to correct the interference by one or more of the following measures:

- Reorient or relocate the receiving antenna.
- Increase the separation between the equipment and receiver.
- Connect the equipment into an outlet on a circuit different from that to which the receiver is connected.
- Consult the dealer or an experienced radio/TV technician for help.

The device has been evaluated to meet general RF exposure requirement. The device can be used in portable exposure condition without restriction.