

WATCH REMOTE CONTROL

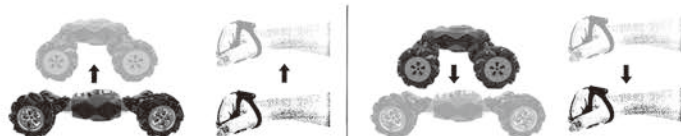

A fist swinging horizontally upward deforms upward

A downward swing of the fist is a downward deformation



The fist can move forward by swinging downward

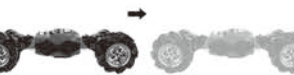

The fist moves upward to operate backward



To tilt left is to move horizontally to the left

To tilt the fist to the right is to move horizontally to the right

温馨提示 Tips 当车移动时,请不要用手触摸遥控车的车轮,以免受伤。

When the car moves, please do not touch the wheels of the Remote control car, so as to avoid injury.

Watch remote control

Short press boot

Short-press switch music after boot-up

Long press 3 seconds to shut down



Watch remote control operation

1. The level of the fist is raised upwards
2. The level of the fist is raised downwards
3. Pushing down your fist is advancing
4. The fist tilts backward
5. The left tilt of the fist is the left run
6. Right tilt of fist is right run
7. The finger key press is the switch key, and the left tilt of the fist is the left 360 degree turn
8. Long press of finger key is braking function

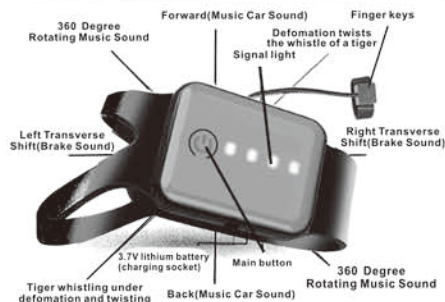

REMOTE CONTROL

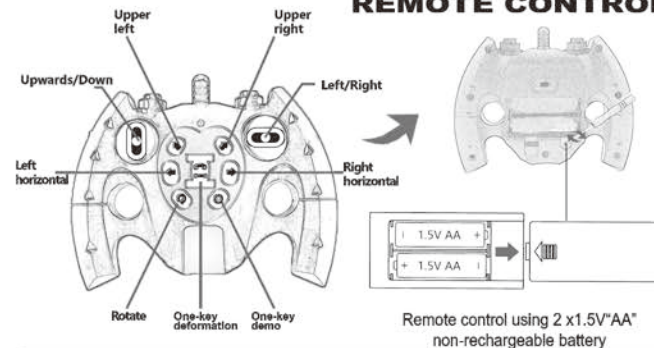

Remote control using 2 x 1.5V "AA" non-rechargeable battery

	One-key deformation	Press the button to deform
	One-key demo	Auto Demonstrate
	Rotate	Multi-directional dancing
	Upper right	Left horizontal drive
	Upper left	Right horizontal drive

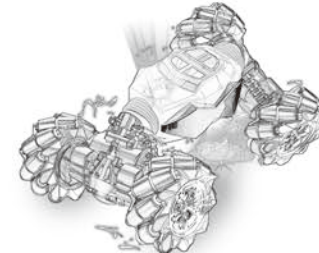
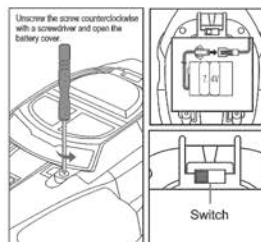

Warning: Changes or modifications to this unit not expressly approved by the party responsible for compliance could void the user's authority to operate the equipment.

NOTE: This equipment has been tested and found to comply with the limits for a Class B digital device, pursuant to Part 15 of the FCC Rules. These limits are designed to provide reasonable protection against harmful interference in a residential installation. This equipment generates, uses and can radiate radio frequency energy and, if not installed and used in accordance with the instructions, may cause harmful interference to radio communications.

However, there is no guarantee that interference will not occur in a particular installation. If this equipment does cause harmful interference to radio or television reception, which can be determined by turning the equipment off and on, the user is encouraged to try to correct the interference by one or more of the following measures:

- Reorient or relocate the receiving antenna.
 - Increase the separation between the equipment and receiver.
 - Connect the equipment into an outlet on a circuit different from that to which the receiver is connected.
 - Consult the dealer or an experienced radio/TV technician for help.
- The device must not be co-located or operating in conjunction with any other antenna or transmitter.

FCC This device complies with Part 15 of the FCC Rules. Operation is subject to the following two conditions: (1) this device may not cause harmful interference, and (2) this device must accept any interference received, including interference that may cause undesired operation.

Remote control stunt toy car
HC8809B

Shantou City Hangcheng Technology Industry Co., Ltd
Qixi Industrial Zone, Ximen, Chenghua street, Chenghai District, Shantou City, Guangdong, China