

正面

130mm

90mm

REXING®

V1 Lite Quick Start Guide

The information in this manual is subject to change without notice.
www.rexingusa.com

REV022023

Activate Your 18-Month Warranty

& Unlock Exclusive Perks!

Activate within 30 days of purchase to extend your limited 12-month warranty to 18 months and unlock bonus rewards just for registered users.

Scan the QR to register & discover your exclusive perks.

SCAN ME!



<https://www.rexingusa.com/productreg/>

1. Overview

Thank you for choosing REXING!

We hope you love your new products as much as we do. If you need any assistance, or have any suggestions to help us improve, please contact us.

care@rexingusa.com
(877) 740-8004

Our support team will respond to you as soon as possible. Always a surprise in REXING.

Check us out here

- <https://www.facebook.com/rexingusa/>
- <https://www.instagram.com/rexingdashcam/>
- <https://www.rexingusa.com/support/registration/>
- <https://www.rexingusa.com/support/product-support/>



2. What's in the Box

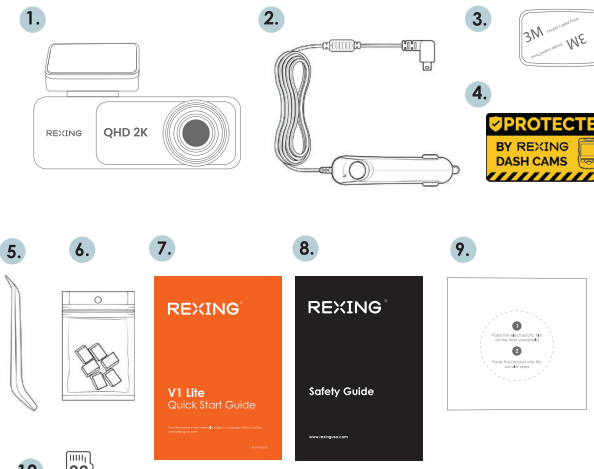

1. REXING V1 Lite Dash Cam
2. Car Charger
3. 3M Adhesive
4. Warning Sticker
5. Cable Management Tool
6. Cable Clips
7. Quick Start Guide
8. Safety Guide
9. Electrostatic Sticker
10. 32GB MicroSD Card

3. Camera Overview

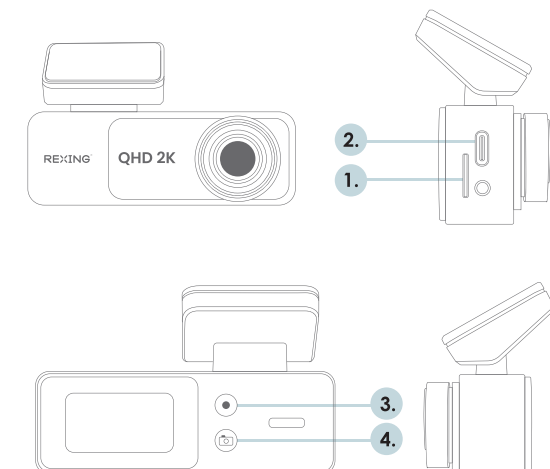

1. Micro SD Card Slot
2. USB Type C Power Port
3. Wi-Fi Power Button
4. Photo Button

Screen Icons

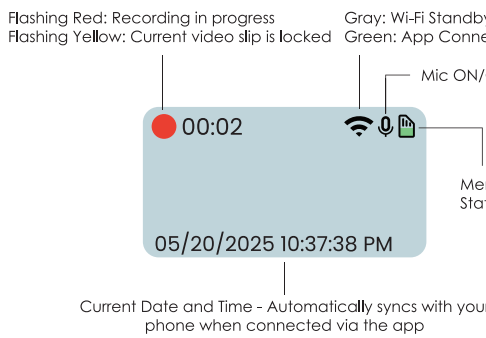

4. Installation

Step 1: Installing the Electrostatic Stickers

1.1 Prepare Your Windshield

Thoroughly cleanse your windshield with either water or alcohol. Follow this by wiping it dry using a clean, dry cloth to ensure a spotless surface.

1.2 Position the Sticker

Next, carefully peel off the protective film from the electrostatic sticker. Attach the sticker to the windshield, ideally behind the rear-view mirror. This position is recommended to avoid obstructing your view while you're on the road.



Step 2: Install the Dash Cam

Place the 3M adhesive on the mount plate and properly orient the mount piece to the roof and hood line of the vehicle.

Important! Ensure the Interlock on the mount is oriented in the correct direction. Firmly press the mount onto the windshield.

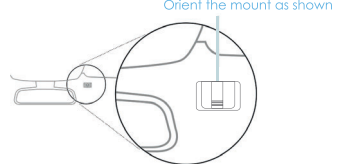

Step 3: Insert the Memory Card

The REXING V1 Lite accepts (Class 10/ UHS-1 or higher) Micro SD memory cards up to 128GB. You will need to insert a memory card **before you can begin recording. Before inserting or removing a memory card, first ensure you've powered down the device.**

Gently push the memory card in until you hear a click, and allow the spring release to push the card out.



Step 4: Power the Camera and Format the Memory Card

Power the camera by connecting the charger to the car cigarette lighter and the camera

To ensure the V1 Lite records to your memory card properly and without error, **Before you start using a new memory card, you must format the card within the camera using the format function.** Always backup important data stored on the memory card before formatting.

To format the memory card, make sure you have inserted your memory card, **then turn on the device by connecting to a power source.** If the memory card needs formatting, a prompt will appear on the screen. The memory card will be formatted automatically. Once formatting is complete, the device will automatically start recording. Formatting may take a few minutes.

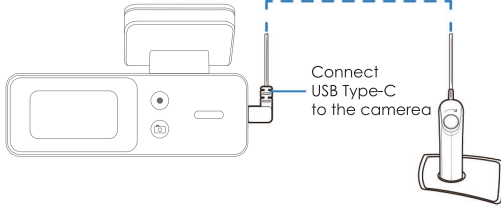

You may now disconnect from power. The camera will shut down after 3 seconds. The camera should begin recording automatically the next time it is powered on.

FCID: 2AWSW-V1LITE

The device complies with part 15 of the FCC Rules. Operation is subject to the following two conditions: (1) This device may not cause harmful interference, and (2) this device must accept any interference received, including interference that may cause undesired operation.

Changes or modifications not expressly approved by the party responsible for compliance could void the user's authority to operate this equipment.

This equipment has been tested and found to comply with the limits for a Class B digital device pursuant to part 15 of the FCC Rules. These limits are designed to provide reasonable protection against harmful interference in a residential installation. This equipment generates, uses and can radiate radio frequency energy and, if not installed and used in accordance with the instructions, may cause harmful interference to radio communications. However, there is no guarantee that interference will not occur in a particular installation. If this equipment does cause harmful interference to radio or television reception, which can be determined by turning the equipment off and on, the user is encouraged to try to correct the interference by one or more of the following measures:

- Reorient or relocate the receiving antenna.
 - Increase the separation between the equipment and receiver.
 - Connect the equipment into an outlet on a circuit different from that to which the receiver is connected.
 - Consult the dealer or an experienced radio/TV technician for help.
- This equipment complies with FCC radiation exposure limits set forth for an uncontrolled environment. The equipment should be installed and operated with minimum distance 20cm between the radiator and your body.

REXING®

FC RoHS CE

MADE IN CHINA

反面

Step 5: Installing the Camera onto the Windshield

Place the camera on the mount and carefully route the power cable around the windscreen and tuck in under the trim.

Plug the Car Charger Cable into a 12V DC power outlet or the car cigarette lighter.

Connect car charger to the camera. The camera will auto-start recording once powered on.

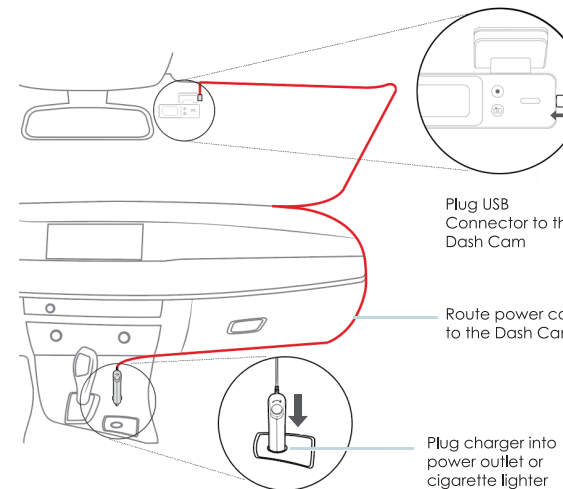

5. Basic Operation

Device Power

The device is automatically powered on when plugged into a 12V accessory socket or cigarette lighter and receives a charge (i.e.: the vehicle is started.)

To turn the device on manually, press and hold the **POWER** button until the welcome screen appears.

The camera will automatically start recording when powered on.

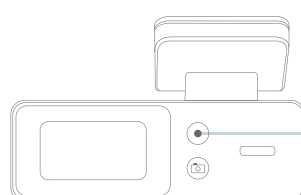

Press and hold the POWER button to turn the device on manually.

REXING Connect App

Easily download the app by scanning the QR code below or search via the App Store or Google Play



Wi-Fi Connect Troubleshooting

If you bring up the REXING Connect app and cannot connect your phone to the dash cam please go to <https://www.rexingusa.com/wifi-connect/> OR scan the QR code below.



Wi-Fi Connect

Step 1

With the dash cam powered on, Wi-Fi enters standby mode automatically. If Wi-Fi is off, press the Wi-Fi button to activate it.

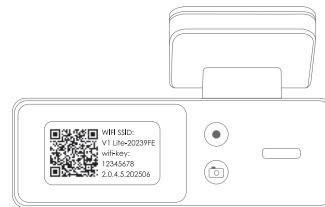

Step 2

On your mobile device, navigate to your Wi-Fi settings. Connect to your dash cam's Wi-Fi by tapping its name (V1 Lite_XXXXXX) when it appears. Enter your dash cam's Wi-Fi password (default: 12345678) if you are prompted to do so.

Note: Turn off your phone's Wi-Fi to disconnect. The dash cam's Wi-Fi will automatically turn off after 5 minutes of inactivity.

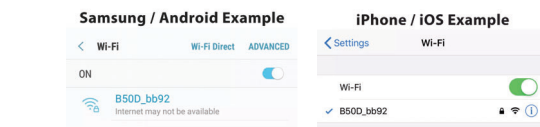

Step 3

Once you're connected to the dash cam, open the REXING Connect app on your mobile device.

Please select "Keep Trying Wi-Fi" if you see the notification on the right.

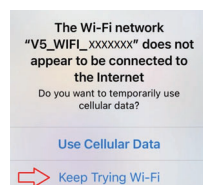

Step 4

In the app, hit the "Connect" button to connect to your dash cam, allowing you to access live view and view/download your recordings.

Note: Turn off your phone's Wi-Fi to disconnect. The dash cam's Wi-Fi will automatically turn off after 5 minutes of inactivity.

Menu Settings

APP Main Screen

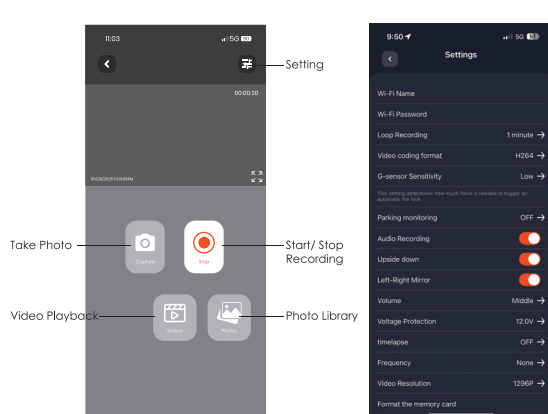

Time and Date

Updates automatically to match your phone when the app is connected.

Video Playback

The video playback can be accessed from the app home screen.



Parking Monitor (Parking Surveillance Mode)

Parking monitor provides surveillance on your parked vehicle. When the engine is off, the hardware kit is used to provide continuous power and protect your car battery from being discharged.

Option 1: Vibration Detection

To enable the Parking Monitor, you'll need to connect it with a OBD Smart Hardwire Kit (Sold Separately).

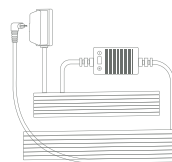

This feature will allow the dash cam to switch to parking mode automatically if the vehicle's engine turns off and switch back to the normal recording after the vehicle's engine turns on.

Gravity Sensing Record:

The Gravity Sensing detects significant or sudden movement (such as an impact or collision), it will trigger an event recording.

Note: If you do not use the parking mode function, please change the Gravity Sensing sensitivity to low. Otherwise, the video will

easily be locked and the video cannot be deleted by the loop recording function. This will cause the memory card to be full of locked videos and cause the recorder to fail to work normally.

Please DO NOT ENABLE the Parking Monitor function in the settings of the dash cam WITHOUT connecting a smart hardwire kit. Otherwise it may cause a malfunction.

Option 2: Motion Detection

To use this feature, you need to connect it with a REXING 360° Intelligent Hardwire Kit (sold separately).

Make sure that the Parking Mode is turned off on your dash cam, otherwise it may cause a malfunction.

Once the sensor has detected MOTIONS, the intelligent hardware kit will power up the dash cam automatically and start recording until the MOTION is cleared.

Please go to <https://www.rexingusa.com/hwk-install/> to watch a video tutorial about the installation or scan the QR code below.



Warranty & Support

Warranty

The REXING V1 Lite Dash Cam comes with a full 12-month warranty. If you register your product on our official site (<https://www.rexingusa.com/support/registration/>), you can extend the warranty to 18 months.

Support

If you have any questions regarding your product, please do not hesitate to contact us at care@rexingusa.com, or call us at (877) 740-8004. Queries are typically answered within 12-24 hours.

Your opinion matters

REXING is firmly committed to always improving our products, services, and user experience. If you have any thoughts on how we can do even better, we welcome your constructive feedback and suggestions.

Connect with us today at care@rexingusa.com

Thank you for choosing REXING!