

WEATHER STATION

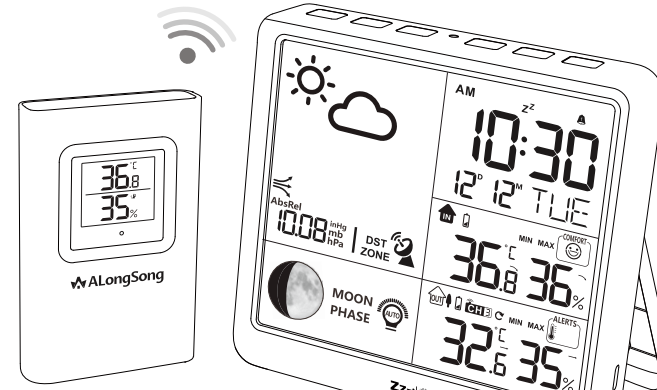

User Manual

Model: ASD012

Package Contents

1 x Packaging Box	1 x User Manual	1 x Type-C Cable
1 x Weather Station	1 x Transmitter	

Installation Steps

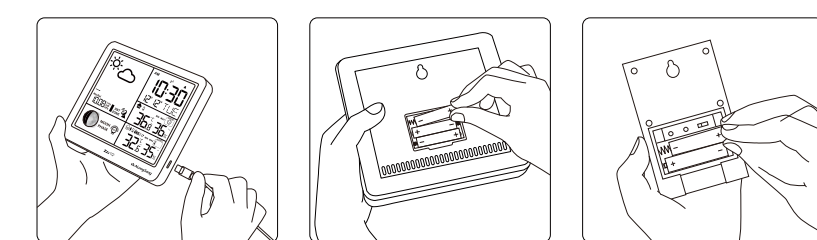

Product Interface Introduction

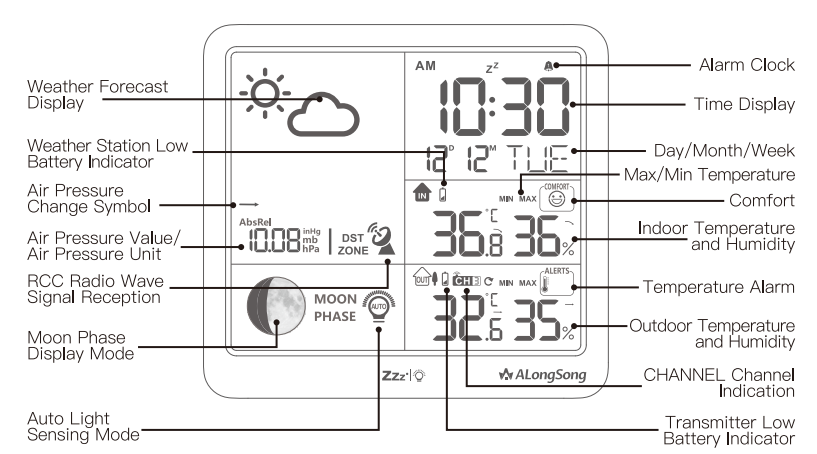

Transmitter

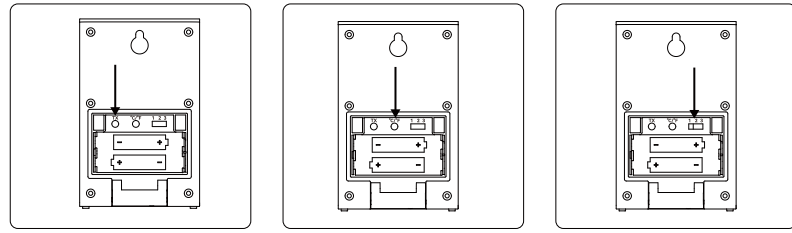
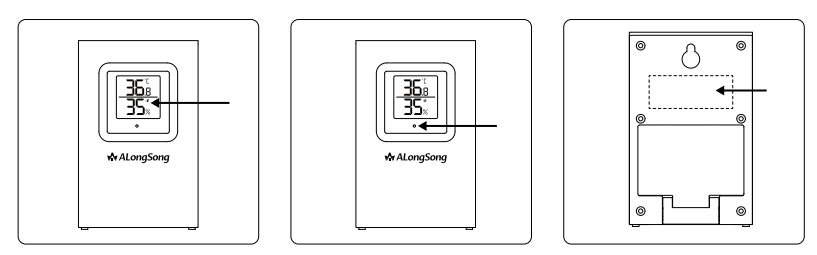

Button Function Introduction

1. SET Button

- Under normal mode, short press to switch 12H/24H time format.
- Under normal mode, long press to enter the time setting mode (RCC automatically receives, no need to manually set the time).
- Under ALARM time mode, short press SET to set ON/OFF of ALARM.

2. UP/MEM/RCC Button

- Under setting mode, short press to increase; long press to quickly increase.
- Short press to switch MAX Value, MIN Value and NORMAL Value of temperature and humidity to display.
- Under MAX/MIN display state, long press to clear the indoor/outdoor maximum/minimum memory.
- Under normal time display state, long press to force RCC receiving, long press again to exit RCC receiving.

3. DOWN/T-ALERT/C/F

- Under setting mode, short press to decrease; long press to quickly decrease.
- Under normal mode, short press to switch to display the temperature value set by the upper limit and lower limit of outdoor temperature.
- Under normal mode, long press to switch the outdoor temperature C/F display.

- Under the upper/lower limit temperature value display state, long press to enter the upper or lower limit temperature value setting, and short press the SET button to confirm.
- When the alarm temperature value is displayed, press the SET button to turn on/off the temperature alarm function.
- Under normal mode, long press the UP/DOWN button at the same time to permanently turn off the RCC function, and press again to turn it on.

4. PRESSURE

- Under normal mode, short press the PRESSURE button to switch RELATIVE/ABSOLUTE mode.
- Long press to enter the air pressure setting (air pressure unit, RELATIVE/ABSOLUTE mode).
- Under setting mode, short press the PRESSURE button to confirm.
- If there isn't any operation, it will auto exit the setting mode after 30s.

5. CHANNEL

- Under normal mode, short press the CHANNEL button to switch among CH1, CH2, CH3 circulation display mode.
- Under normal mode, long press the CHANNEL button for 2s to forcefully enter the RF long reception mode of the current CH channel.

6. ALARM

- Short press the ALARM button to switch to display the normal time mode, the time display of ALARM1/ALARM2 under ALARM display mode, it will auto return to the normal mode if there isn't any operation for 5s.
- Under the ALARM1 or ALARM2 time display mode, long press to enter the time setting and enter the next setting.
- Under the ALARM time display mode, short press the SET button to set the corresponding ALARM ON/OFF.

7. SNOOZE/LIGHT

- Touch to enter the snooze function in the ringing state, the max number of snoozes is 3 times and 7 minutes for each (press any button to turn off the alarm clock, and if there isn't any operation for 3mins, it will auto enter the snooze function).

- When it's powered by batteries, touch the SNOOZE button and the backlight will be on for 10s.

When Powered by DC Power Supply:

- Default backlight auto adjustment.
- Long press the SNOOZE button to turn on/off the auto backlight adjustment (AUTO).

Mode Settings

1. Power-on Initial Value

- When AAA batteries are inserted or reset, the LCD screen is fully displayed and the backlight is always on. Then it enters the normal display, the backlight continues to be on for 3s, the clock directly runs from 0:00:00, and auto detect the temperature.
- Enter the weather initialization setting state, press [▲] or [▼] to select the initial weather state, and press PRESSURE to confirm and exit, if there isn't any operation for 25s, it will auto exit.
- Enter the outdoor temperature and humidity reception for 3mins, 1Hz flashes, and after the 3-minute auto reception, exit the RF reception.
- Enter the RCC 7-minute auto reception mode, and the RCC will auto exit after receiving the signal. When there is no signal or no signal received, it will still auto log out after 7mins.
- Display normal mode.

2. Time Setting

- Time Format Conversion Under normal mode, short press the SET button to switch 12H/24H time format.
- Under normal mode, long press the SET button to enter the time setting, adjust the Hour first, the corresponding Hour number flashes, short press [▲] or [▼] to increase/decrease, and long press to quickly increase/decrease.
- Short press the SET button again to adjust the Minute, the corresponding Minute number flashes, Press [▲] or [▼] to increase/decrease, long press to quickly increase/decrease (if the Minute is changed, the Second will return to zero).
- Adjust the Year/Month/Day in turn using the same method (the Week is auto adjusted according to the date, and the adjustable year is 2000-2099).
- Short press the SET button again to confirm and exit.

- Under setting mode, if there isn't any operation for 30s, it will auto exit.
- Setting Sequence: Hour—Minute—Year—Month—Day—D/M—Language—Time Zone—Exit.
- MSF (UK) Setting Sequence: Hour—Minute—Year—Month—Day—D/M—Language—Exit.
- WWVB (United States) Setting Sequence: Hour—Minute—Year—Month—Day—D/M—Language—Time Zone—DST ON/OFF—Exit.
- Weak Display Language Setting Order: ENG—GER—FRE—ITA—SPA—DAN—SWE.

3. Alarm Time Setting

- Under normal mode, short press the ALARM button to switch between ALARM 1/ALARM 2 time.
- When switch to ALARM 1 time, short press the SET button to turn ON/OFF the ALARM1 alarm function.
- When switch to ALARM 1 time, long press the ALARM button to set ALARM 1 time.
- Set the ALARM 1 alarm time, when the hour number flashes, press [▲] or [▼] to increase/decrease, long press to quickly increase/decrease.
- Short press the ALARM button again to adjust the alarm Minute, when the Minute number flashes, press [▲] or [▼] to increase/decrease, long press to quickly increase/decrease.
- Short press the ALARM button again to adjust L01/L02 loudness, press [▲] or [▼] to select.
- Short press the ALARM button again to confirm and exit.
- Setting Sequence: Hour—Minute—L01/L02 (loudness).
- Under setting mode, it will auto exit if there isn't any operation for 30s.
- The ALARM 2 time can also be set using the above methods.

4. Weather Forecast Display

- 5-level weather forecast graphics and dynamic instructions: Sunny, Less Cloudy, Cloudy, Light Rain, Heavy Rain.
- The weather initialization setting function is available ONLY when power on using AAA batteries for power supply, and cannot be set again during normal operation.

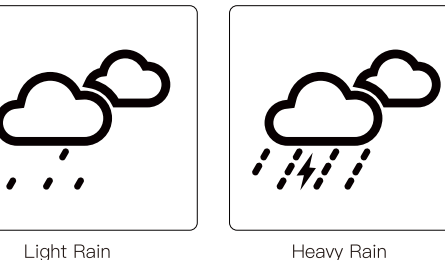
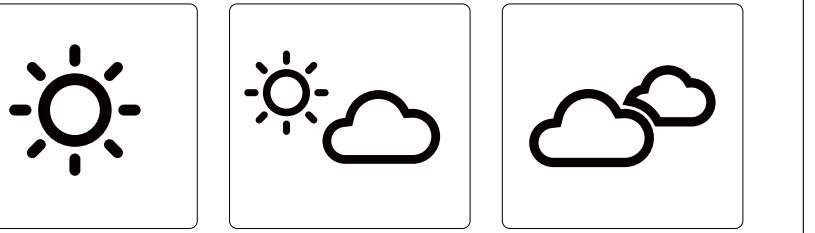

5. Air Pressure Setting

- Short press the PRESSURE button, the air pressure unit flashes, and press [▲] or [▼] to select HPa/mbs, mmHg.
- Long press the PRESSURE button, the RELATIVE air pressure value flashes, and press [▲] or [▼] to set the relative air pressure value (the setting range is 600Pa/mbs to 1100 HPa/mbs).
- Short press the PRESSURE button again to select the current weather state.
- Short press the PRESSURE button again to confirm and exit.
- Under setting mode, it will auto exit if there isn't any operation for 30s.

6. RCC Radio Wave Setting

- After power on, auto RCC reception up to max 7 minutes.
- When receiving RCC radio wave, all buttons have no function except the [▲] button.
- Auto reception 3 times a day at 3:00, 4:00 and 5:00; if the clock receives RCC, it will stop receiving on that day.
- If the clock does not receive the wave signal from 3:00, 4:00, 5:00 in the morning, then it can't receive the signal for the whole day. Need to wait until the next day.
- Under normal mode, long press the [▲] button to manually force receiving, long press again to exit.
- After successfully receiving the radio wave, if you enter the setting mode and change the settings such as: Time, Day, Month, Year, the icon [▲] will disappear from the display interface.
- Under normal mode, long press the [▲] and [▼] button at the same time to permanently turn off the RCC function, and so that again to turn on.
- DST will auto display after receiving successfully.
- Several variations of RCC antenna towers.

	RCC radio wave reception failed, no icon displayed.
	RCC radio wave received successfully, stop receiving, the waveform and triangular tower are always on.
	RCC is receiving, the antenna tower flashes and there is no waveform, indicating that the receiving signal is not good.
	RCC is receiving, the antenna tower does not flash and the waveform flashes from bottom to top, indicating that the receiving signal is good.
	Permanently turn off the RCC reception function, the antenna symbol disappears, and only the waveform is displayed.

7. 6-level Moon Phase Display Mode and Tide Display Mode

Northern Hemisphere, Showing the Phases of the Moon, Blank for the Full Moon.

New Moon	Waxing Crescent	Waxing Crescent	First Quarter
Waxing Gibbous	Waxing Gibbous	Waning Crescent	Waning Crescent
Last Quarter	Waning Gibbous	Waning Gibbous	Full Moon

8. Outdoor Temperature and Humidity Reception

- When powered by AAA batteries, RF receiving interval CH1-114s; when powered by DC, the RF receiving interval CH1-125s.
- After the weather is initialized, the RF is received for 3 minutes, and the CHANNEL is successfully received within 3 minutes.

- RF flashes when initializing the receiving mode [▲] receiving a new ID transmitter signal or lower limit temperature value setting, and short press the reception, it will keep on, the CHANNEL that has not received successfully continues to flash until the reception is successful.
- After the normal receiving and auto synchronization is successful, it will flash once [▲] indicating that the update data is successful. If the receiving is not successful, it will not flash [▲] (only to monitor the lost data).
- Long press the CHANNEL button, the current CHANNEL is forced to receive, RF flashing [▲], and the old ID transmitter signal is received at this time. When receiving, if you long press the CHANNEL button again [▲] and clear the original data and old ID, receive a new ID.

9. Indoor and Outdoor Temperature and Humidity MAX/MIN Memory Function

- Under normal mode, press [▲] button to query the MAX/MIN memory value of indoor temperature and humidity and outdoor temperature.
- Under MAX/MIN display mode, long press the [▲] button for 2s to manually clear the MAX/MIN memory value of indoor temperature and humidity and outdoor temperature.
- Under the display mode of MAX/MIN indoor temperature and humidity and outdoor temperature, it will return to normal clock display mode if there isn't any operation for 5s.

10. Indoor and Outdoor Temperature, Humidity, Air Pressure and Change

- Indoor Temperature Detection Range: -9.9°C to 50°C; below -9.9°C display LLL, and higher than 50°C display HHH.
- Outdoor Temperature Detection Range: -40°C to 60°C; below -40°C display LLL, and higher than 60°C display HHH; within 0 to 40°C is +/-1°C, 0 to -40°C and 40 to 60°C is +/-2°C.
- Indoor and Outdoor Humidity Detection Range: 10% to 95%; lower than 10% display LLL, and higher than 95% display HHH.
- When the temperature continuously rises and the accumulated value exceeds 1°C & 1.8°F, the temperature trend symbol displays [▲].
- When the temperature rises or falls within 1 hour, the cumulative value does not exceed 1°C & 1.8°F, the symbol of the temperature trend displays [▲].
- When the accumulated value of the continuous temperature drop exceeds 1°C & 1.8°F, the symbol of the temperature trend displays [▲].
- When the accumulated value of the continuous increase in humidity exceeds 5% RH, the symbol of the humidity trend displays [▲].

- When the cumulative value of the humidity rising or falling within 1 hour does not exceed 5% RH, the symbol of the humidity trend displays [▲].
- When the accumulated value of the continuous drop of humidity exceeds 5% RH, the symbol of the humidity trend displays [▲].
- The temperature and humidity detection cycle is 30s.
- When the current air pressure is 11hPa higher than the last hour's air pressure, [▲] is displayed below the weather pattern.
- When the current air pressure does not change by more than 1hPa from the past 1 hour's air pressure, [▲] is displayed below the weather pattern.
- When the current air pressure is less than 1hPa lower than the past 1 hour's air pressure, [▲] is displayed below the weather pattern.
- The air pressure detection cycle is 20mins.

11. Indoor Temperature and Humidity Comfort Level Indicator

Comfort Level	Humidity < 20% DRY	20%~ Humidity < 85% COMFORT	> 85% HUMID
Temperature < 10°C			
19°C Temperature < 27°C			
Temperature > 27°C			

12. Temperature ALERT Function

- Under normal mode, short press the [▼] button to switch to display temperature ALERT setting value, the default value: upper limit +50°C, lower limit -20°C.
- Under upper limit or lower limit value display status, short press the SET button to turn on/off the related alarm function (the upper and lower limits can be turned ON/OFF individually).

- Under temperature ALERT (upper limit or lower limit value display status, long press [▼] to enter the current upper/lower temperature ALERT setting.
- Press the SET button to confirm the setting, and the upper and lower temperature limits can be set individually.
- During the setting process, press [▲] or [▼] to increase/decrease, and long press to quickly increase/decrease.
- When the outdoor temperature exceeds the upper limit or is lower than the lower limit, it will auto alarm, you can press the button to stop, or auto stop when the condition reaches the range.
- The set item will flash at 1Hz frequency.

13. Low Battery Indication Function

- When the weather station battery is too low, there is a battery symbol indication at the indoor temperature.
- When the transmitter battery is too low, there is a battery symbol indication at the outdoor temperature [▲], and there is a battery symbol indication on the transmitter LCD screen [▲].

Note: When the power is too low, please replace the battery as soon as possible, so as not to affect the use.

FAQ

Questions	Solutions
After power on, what do I need to do?	1. When the weather station is powered on, the RF will auto receive the transmitter signal. After successful reception, it will auto update the outdoor temperature and humidity. 2. RCC will auto receive the signal wave, after successful reception, it will auto update the weather, time and language. 3. You only need to set the alarm time, screen brightness, and time format according to your needs.
The reception of outdoor temperature and humidity is unsuccessful, and displays "LLL" or "HHH" or "CH1 Channel Flashed"?	1. When the weather station does not match the CH channel of the transmitter, it will display "LLL" or "CH1 Channel Flashed", please adjust to the same CH channel and wait for 1min to receive the signal. (For example, the weather station is on CH1 channel, the transmitter is on CH2 channel, and the weather station needs to be manually adjusted to the transmitter channel).

- Replace the batteries of the transmitter and weather station (use standard alkaline batteries, do not use heavy or rechargeable batteries).
- When power on, there is no need to set the time, as RCC will auto receive radio waves, and after successful reception, it will auto update the outdoor temperature and humidity. If you want to manually set it, long press the SET button to enter time setting.
- Make sure that neither the weather station nor the transmitter is placed in direct sunlight, and away from any heat sources or ventilation openings.

- The signal is interfered, please do not put it in the place that affects the signal, such as metal, TV, radio, computer, etc.
- The external humidity is too high, causing the transmitting element to fail to receive, the transmitter is not waterproof, please do not put it in a place where water/rainwater can reach.
- The distance between the transmitter and the weather station is too far, it is recommended to shorten or adjust the position of the transmitter.

- Under DC power supply mode, long press the SNOOZE button to turn off the automatic light sensing mode and adjust the brightness.
- Is it hard to see the display?
- How to change the screen brightness?
- What are the package contents?

What is the product size?	Weather Station: 5.9 x 6.4 x 1.1in/14.9 x 13.7 x 2.7cm; Transmitter: 3.9 x 2.5 x 0.8in/10 x 6.4 x 2cm.
Does the product have a memory function?	Can record the MAX/MIN temperature and humidity in the past 24 hours.

Cautions

- Do not use chemicals to clean any part of this product, just use a soft cloth if necessary.
- Do not immerse this product in water, it may cause electric shock and damage the product.
- Do not place the product in extreme force, shock or temperature and humidity.
- Do not tamper with the parts inside the device.
- Do not mix old and new batteries or different types of batteries.
- Do not dispose of this product as unsorted municipal waste.

NOTE: This equipment has been tested and found to comply with the limits for a Class B digital device, pursuant to part 15 of the FCC Rules. These limits are designed to provide reasonable protection against harmful interference in a residential installation. This equipment generates uses and can radiate radio frequency energy and, if not installed and used in accordance with the instructions, may cause harmful interference to radio communications. However, there is no guarantee that interference will not occur in a particular installation. If this equipment does cause harmful interference to radio or television reception, which can be determined by turning the equipment off and on, the user is encouraged to try to correct the interference by one or more of the following measures:

- Reorient or relocate the receiving antenna.
- Increase the separation between the equipment and receiver.
- Connect the equipment into an outlet on a circuit different from that to which the receiver is connected.
- Consult the dealer or an experienced radio/TV technician for help.

Changes or modifications not expressly approved by the party responsible for compliance could void the user's authority to operate the equipment.