

InstaVision Smart IP Camera User Manual

Introduction

Welcome to the instaVision Camera App. This manual will guide you through the various features of the app to ensure you get the most out of your security camera.

Installation and Setup

1. Download and Install: Download and install the InstaVision app by scanning the QR code for the Apple Store or Google Play Store.

Android

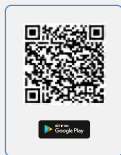

iPhone



2.Account Registration: Open the app.



Welcome to InstaVision

Unlock a more powerful camera.
Sign Up and begin the setup process.

 United States



Sign In

Don't have an account yet? [Sign Up](#)

2. Account Registration: Register a new account or log in to an existing account.

<

Sign Up

Email

Password

Confirm Password

By signing in below, I agree to InstaVision's [terms and conditions](#) & [privacy policy](#)

Sign Up

Already have an account? [Sign In](#)

<

Sign In

Email

Password

☒ Remember me [Forgot Password?](#)

By signing in below, I agree to InstaVision's [terms and conditions](#) & [privacy policy](#)

Sign In

Don't have an account yet? [Sign Up](#)



3.Add Camera: Navigate to the Home Page within the app.



3. Add Camera: Locate and select "Add Camera," then scan the QR code on the device.

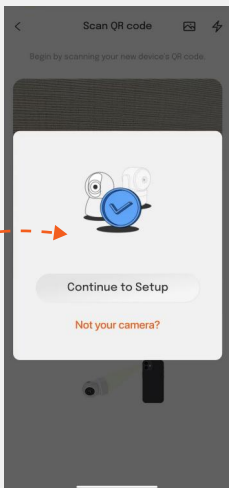
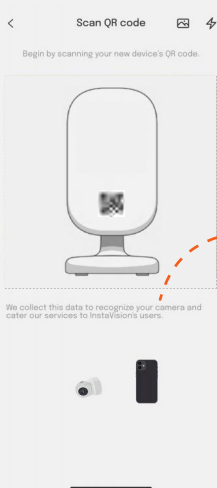

4. Connect to Wi-Fi: Follow the on-screen instructions to enter Wi-Fi network info. Please note that only 2.4GHz networks are supported.

<

Camera Setup

Wi-Fi network

 Wi-Fi network name

Wi-Fi password 

5GHz networks are not supported

Continue

5. Connect your camera to the Wi-Fi network by scanning the QR code in the app with the camera lens.



Camera Setup

Scan this QR code with your new camera to pair the device



Hold up the phone for the security camera to scan the QR code. This will then pair the device.



[If you did not hear anything, tap here](#)

6.Name your camera before everything is set up.



You're almost done!

Let's verify your device now.

Continue

M

Your camera is Paired

Name Your Camera

Location

Next

Powered by Instavision



16



7. See Live view: After completing the initial setup, you will see the live view of the camera on the main interface.

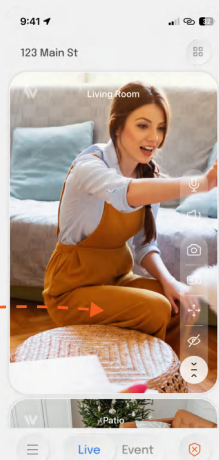
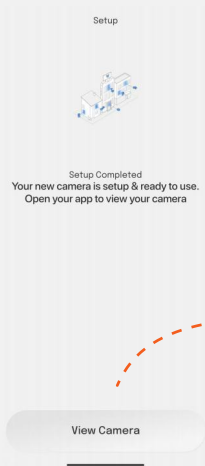

This device complies with part 15 of the FCC Rules. Operation is subject to the following two conditions: (1) This device may not cause harmful interference, and (2) this device must accept any interference received including interference that may cause undesired operation.

FCC warning:

Any Changes or modifications not expressly approved by the party responsible for compliance could void the user's authority to operate the equipment.

Note: This equipment has been tested and found to comply with the limits for a Class B digital device, pursuant to part 15 of the FCC Rules. These limits are designed to provide reasonable protection against harmful interference in a residential installation. This equipment generates uses and can radiate radio frequency energy and, if not installed and used in accordance with the instructions, may cause harmful interference to radio communications. However, there is no guarantee that interference will not occur in a particular installation. If this equipment does cause harmful interference to radio or television reception, which can be determined by turning the equipment off and on, the user is encouraged to try to correct the interference by one or more of the following measures:

- Reorient or relocate the receiving antenna.
- Increase the separation between the equipment and receiver.
- Connect the equipment into an outlet on a circuit different from that to which the receiver is connected.
- Consult the dealer or an experienced radio/TV technician for help.

This equipment complies with FCC radiation exposure limits set forth for an uncontrolled environment. This equipment should be installed and operated with minimum distance 20cm between the radiator & your body.