

Robotic Vacuum Cleaner

Instruction Manual

Please keep this user manual in your sight
read it thoroughly and carefully before using this product.

Table of Contents

1. Important Safety Instructions

1.1 Safety Advice and Warnings.....	01
1.2 Battery and Charging/ Information.....	03

2. About Your Robot

2.1 Package Contents.....	04
2.2 Main Body.....	05
2.3 Dust Bin and Suction Inlet.....	06
2.4 Remote Control.....	07
2.5 LED Indicators.....	07

3. Using Your Robot

3.1 Important Tips Before Use.....	08
3.2 Preparation.....	09
3.3 Charge Your Robot.....	10

4. Connecting Your Robot

4.1 Download Smart Life App.....	11
4.2 APP Connection.....	12
4.3 Use Your Robot with Amazon Alexa.....	20
4.4 Use Your Robot with Google Assistant.....	21

5. Common Functions & Operations

5.1 Start/ Stop Cleaning.....	22
5.2 Cleaning Mode.....	23

6. Regular Robot Care

6.1 Emptying Robot's Dust Bin.....	29
6.2 Cleaning Robot 's Filter.....	29
6.3 Cleaning Robot 's Common Accessories...	30
6.4 Clean the Sensors and Charging Pins.....	31
6.5 Battery Maintenance.....	31
6.6 Battery Replacement.....	32
6.7 Cleaning the 2-in-1 Water Tank.....	32

7. Troubleshooting

7.1 Error Tones.....	34
7.2 Frequently Asked Questions.....	35
7.3 Wi-Fi Connection.....	37

8. Specifications

8. Specifications.....	38
------------------------	----

9. FCC Statement

9. FCC Statement.....	39
-----------------------	----

10. IC Warning

10. IC Warning.....	40
---------------------	----

1. Important Safety Instructions

Robot Vacuum Cleaner

Dear customer:

We are deeply honored that you chose our products and would like to thank you for your purchase. Our products includes the latest technology in the market, allowing our products to offer you Efficiency, Easy Operation and Long Lasting Service when you use it. Also we made sure the design of our products is cool and the maintenance easy to make your life way simpler. Read these instructions carefully before using our robot vacuum cleaner and keep this manual for further reference. Failure to follow these instructions could lead to product failure or harm.

1.1 Safety Advice and Warnings

- This device is not intended for use by people (including children) with reduced physical, sensory or mental capacities, or people without experience or knowledge, unless they have benefited from surveillance or prior instructions regarding the use of the device by a person responsible for their safety.
- Cleaning and maintenance shall not be performed by children without adult supervision.
- This appliance is not a toy. Children should be supervised to ensure that they do not play with the appliance.
- This appliance contains accessories with rotary parts. Loose clothes, jewellery or long hair can be caught in moving parts. Dress properly. Do not wear baggy or loosehanging clothes or accessories. Keep your hair, clothing and gloves away from moving parts.
- This product is designed to be plugged into a standard outlet only. Product may not be used with any type of power converter. Use of power converters will immediately void the warranty.
- **CAUTION:** Only use Max 10.8V/Max 2500mAh Ni-MH or Max 2500mAh Li-ion Battery. Other type of batteries might cause bursting and therefore injuries. Always contact Smart Life Customer Service to receive the best advice and the best service event for the replacement of your battery.
- Always charge and remove the battery from your robot and accessories before long-term storage or transportation.
- The battery must be removed from this device before this device is disposed.

● **WARNING Chemical Exposure:** If the battery pack is leaking, do not let the liquid to come in contact with skin or eyes. If the liquid reached the skin or the eyes, wash the affected area with loads of water and contact your medical adviser. Place the battery (the used battery pack included when the robot will be disposed) in a sealed plastic bag and dispose of safely according to local environmental regulation.

● **WARNING Fire or Explosion Hazard:** Do not crush or dismantle battery packs. Do not heat or place the battery pack near any heat source or direct sunlight. Do not incinerate or short-circuit the battery pack. Do not subject batteries to mechanical shock.

● Contact your local waste management authority for battery recycling and disposal regulations in your area.

● This device is designed for indoor use only, please do not use it outdoor or under strong light environment.

● Do not use non-rechargeable batteries. Use only the rechargeable battery supplied with the product.

● Store and operate the device in room temperature environments only.

● The external flexible cable or cord of the power supply unit cannot be replaced; if the cord is damaged, the power supply unit shall be disposed of.

● Do not use robot to pick up sharp objects, glass, or anything that is burning or smoking.

● Do not immerse the battery pack in any liquid.

● Do not use this device to pick up spills of water bleach, paint, or other chemicals, or anything wet. Do not place anything on top of this device.

● Before using our robot vacuum cleaner, make sure that the floor is cleared of objects like clothes, papers, curtain strings or power lines. If such objects come in contact with the vacuum cleaner, the central may swallow it and block the robot.

● If the room to be cleaned contains a balcony, a physical barrier should be used to prevent access to the balcony and ensure safe operation.

● Be aware that this device moves around on its own. Take care when walking in the area where this device is operating to avoid stepping on it.

● Do not operate this device in areas with exposed electrical outlets on the floor.

● Do not use this device on an unfinished, unsealed, waxed or rough floor. It may result in damage to the floor and this device. Use only on hard floor surfaces or low-pile carpet.

● This device has been designed to be used on floors without scratching them. We still recommend that you test this device on a small area of the room to be cleaned to ensure no scratches are made before cleaning the whole room.

1.2 Battery and Charging/ Information

Lithium-ion Battery

Important: Lithium-ion batteries and products that contain Lithium-ion are subject to stringent transportation regulations. If you need to ship this product with the battery included for service, travel or any other reason, you **MUST** comply with the following shipping instructions:

- Remove the Lithium-ion battery from the product.
- Place a Piece of tape over the battery's metal charging contacts.
- Reinstall the battery (with the tape on it) in the product and secure the battery door.
- Package the product in its original packaging or in your own packaging that prevents any movement during transportation.
- Ship via ground transportation only (no air shipping).

Battery Storage

If storing robot off the Charging Dock, remove the battery first. Then store the robot and the battery in a cool, dry place.



The symbol on this product or its packaging indicates that this device cannot be disposed as unsorted municipal waste. To dispose of such device, you need to use separate collection facilities. Contact your local authority for information regarding the collection systems available. If electrical appliances are disposed of in landfills or dumps hazardous substances can leak into the groundwater and get into the food Chain, damaging your health and well-being. Please contact your local or regional waste authority for more information on collection, reuse and recycling programs.

2. About Your Robot

2.1 Package Contents

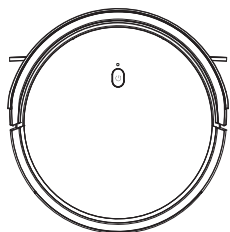

Robot Vacuum

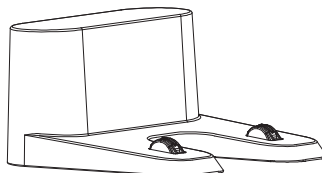

Charging Base

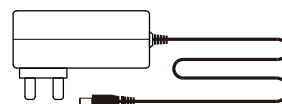

Adapter

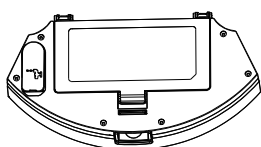

2-in-1 Dust & Water Tank

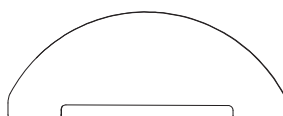

Mop Cloth*2
(1 Piece on the Mop Board)
(1 Piece in Package)

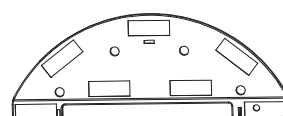

Mop Board

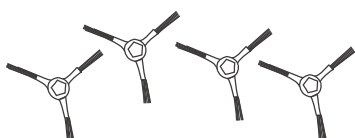

Side Brushes*4

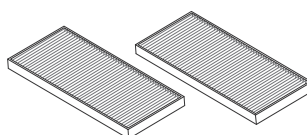

HEPA*2
(1 Piece in Dust Box)
(1 Piece in Package)



Cleaning Tool

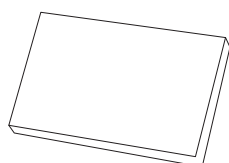

User Manual



Remote Control
(AAA Battery x 2)

2.2 Main Body

 Short press to start cleaning or pause the robot.

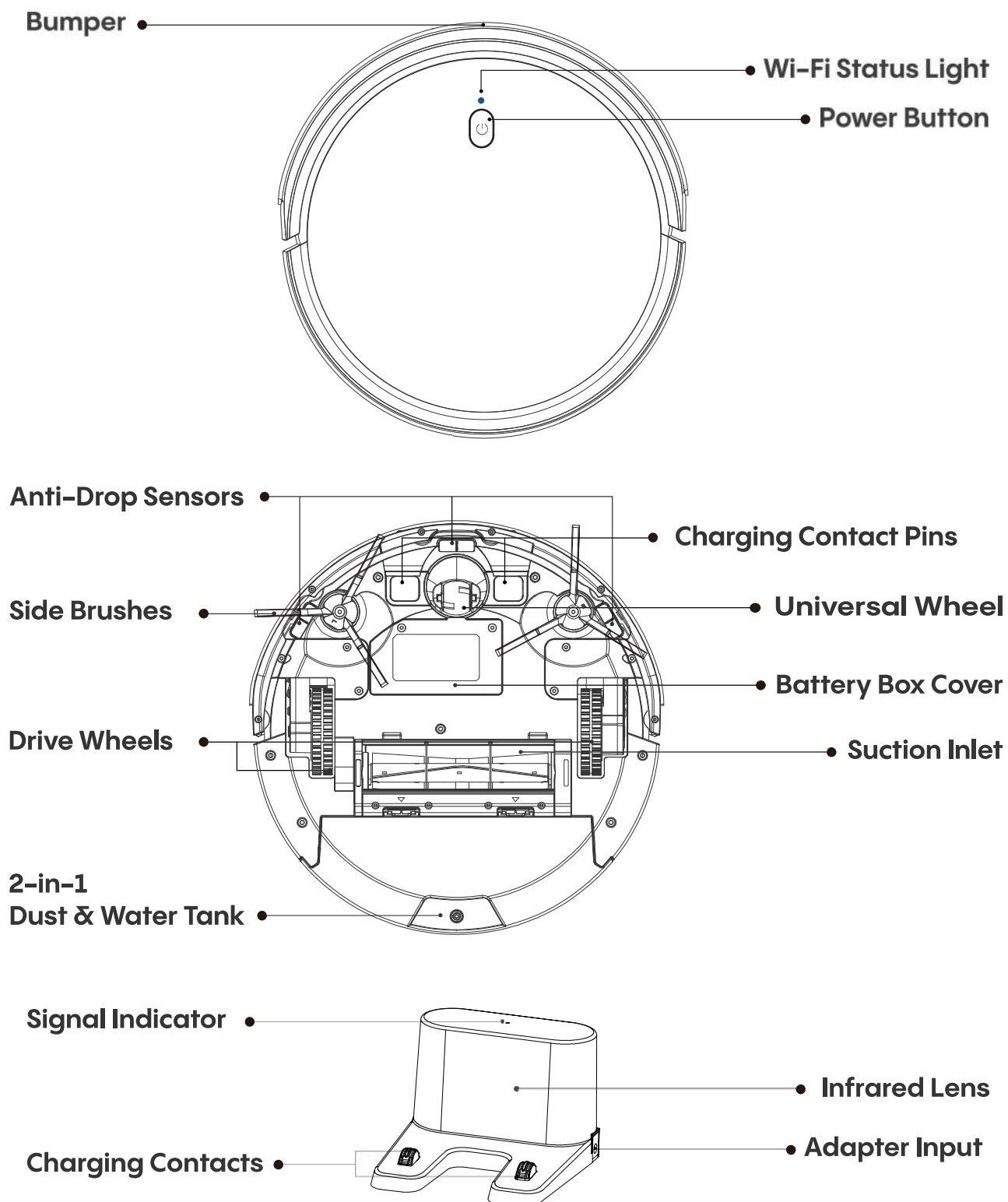

2.3 Dust Bin and Suction Inlet

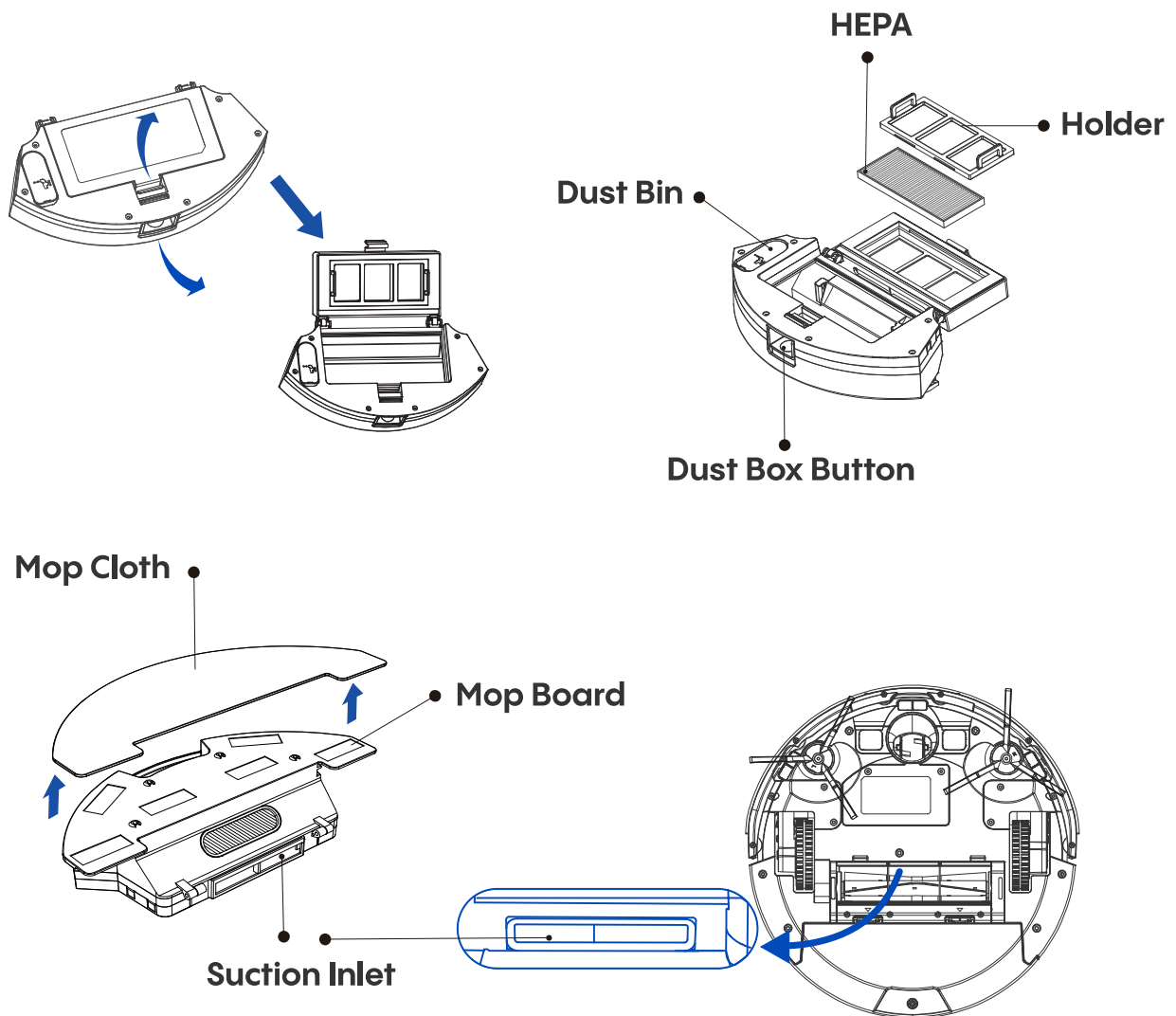

Note:

- Please check the accessories according to your product version.
- If you need buy other accessories and consumable supplies, please purchase in the official store.
- Do not add cleaning products such as detergents, disinfectants, solid detergents, etc.
 - Do not inject hot water to avoid corrosion and damage to the water tank.
 - After mopping is finished, please take out the mop stand in time, pour out the remaining water in the 2-in-1 water tank in time, and wash and dry the mop to avoid odor and mildew.
- ▲ **The black filter can be simply washed and dried for further use.**
- ▲ **When not using the mopping function, remove the mopping cloth and sweep again.**

2.4 Remote Control

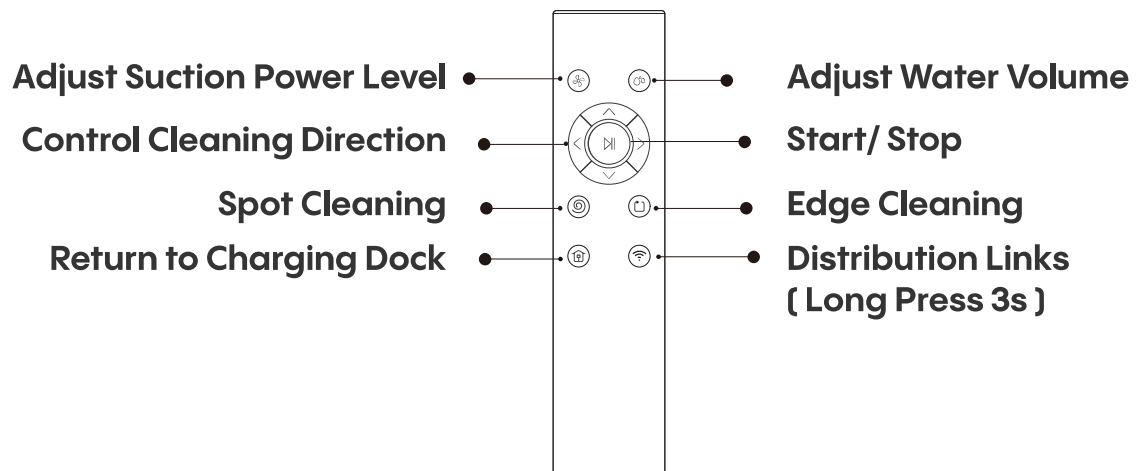

Install 2 AAA batteries before using the remote control for the first time. Make sure the positive and negative ends are facing the correct polarity direction as marked in the battery compartment.

2.5 LED Indicators

You can see the status of Robot from the LED indicator.

Status	Indicator Light
Working	Solid green light
Standby	Solid green light
Recharge	Solid orange light
Charging	Breathing orange light
Fully charged	Solid green light
Error	Solid red light or flashing red light
Sleeping	Light is off

3. Using Your Robot

3.1 Important Tips Before Use

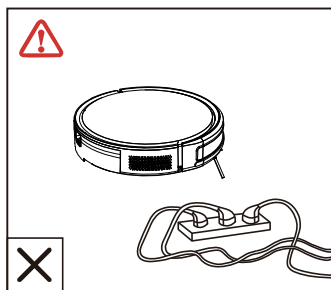

1

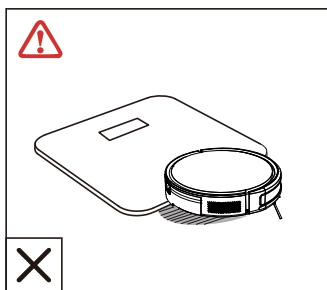

2

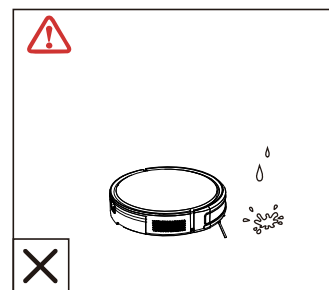

3

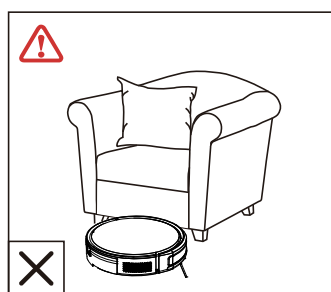

4

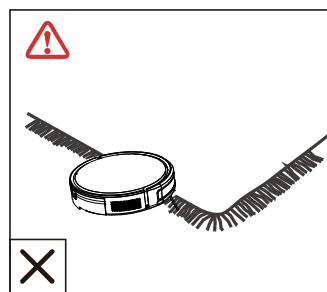

5

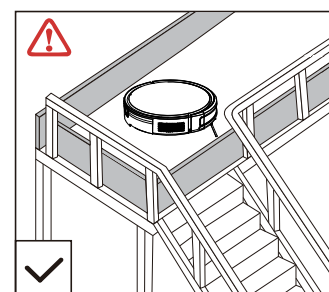

6

- ① Remove every objects that might entangle the Robot such as curtains stings, power cords, nails etc...
- ② Robot may climb on top of objects less than 0.6inch/ 15mm in height. Remove these objects if possible.
- ③ Keep Robot away from wet areas.
- ④ Keep Robot away from spaces lower than 2.89inch/ 73.5mm to prevent Robot from getting stuck. If necessary, place a physical barrier to block off the problem areas.
- ⑤ Fold tasseled edges of area rugs underneath to prevent tangling Robot. Avoid cleaning very dark-colored high-pile rugs or rugs thicker than 1.02inch/ 26mm as they may cause Robot to malfunction.
- ⑥ Anti-drop sensors prevent Robot from tumbling down stairs and steep drops. They may work less effectively if dirty or used on reflective/very dark-colored floors. It is recommended to place physical barriers to block off areas where Robot may fall.



Place physical barriers in from of areas that might damage the Robot such as fireplaces, heaters, pools etc...

3.2 Preparation

- 1 Plug in the Charging Base, and organize the remaining wires so that they can not be touched while the Robot is working.

Note: If you do not tuck away the excess wires, they may snag the robot while charging or cleaning.

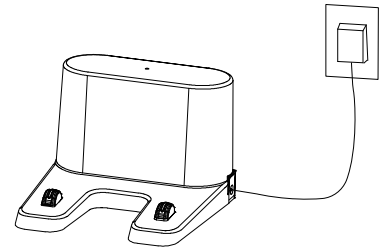

- 2 Charging Base Position Place the Charging Base on a hard, level surface and against a wall.

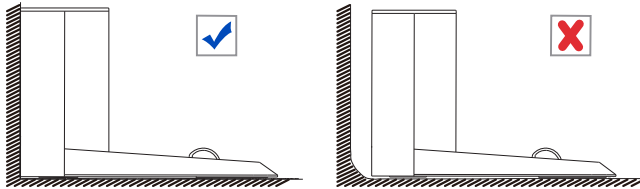

- 3 Remove objects within 3 ft/ 1 m of the left and right side and within 6 ft/ 2 m of the front of the charging base.

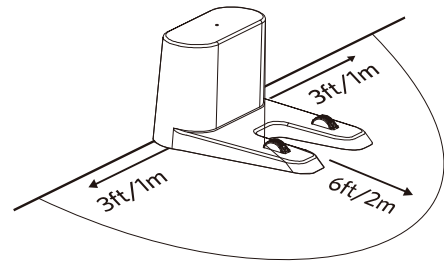

- 4 Connect the round connector of the adapter into the power socket on the Charging Base and the other end into a wall outlet.

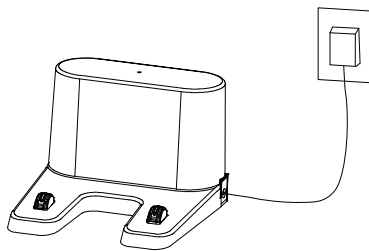

- Install the Charging Base in a location that Robot can easily access. It is recommended to place the Charging Base against a wall, and on a hard-level surface rather than on rugs or carpets.
- Always keep the Charging Base plugged in, otherwise Robot won't be able to automatically find its way back to the charging base.

- 5 Please install the side brush and lock the screw before use. Remove the foam block next to the bumper.

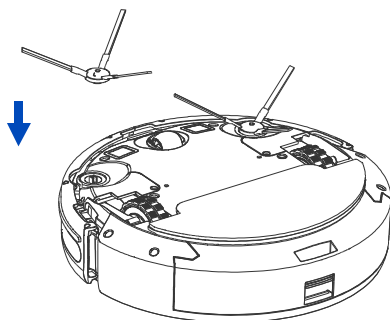

- 6 Press the power  button for 5 seconds to turn on the robot.

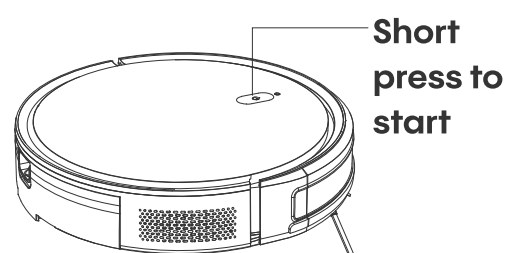

3.3 Charge Your Robot

● Robot has a pre-installed rechargeable battery that has to be fully charged before use.

Robot returns to the Charging Base at the end of a cleaning cycle or when its battery is running low.

Method 1: Connect the robot to the charging base by matching the charging pins on the robot with the charging pins of the base.

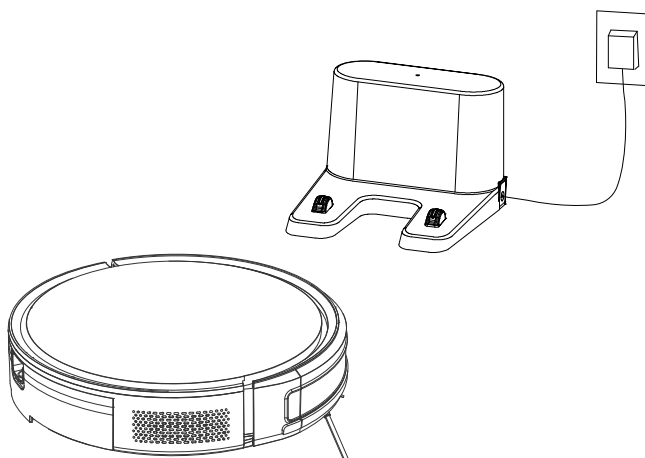

Method 2: Press  on the remote control to return robot to the Charging Base.

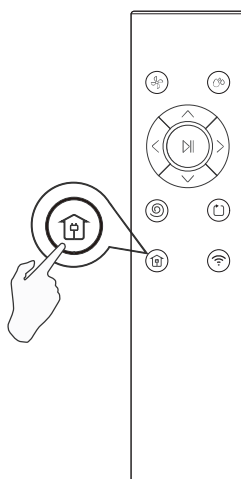

-Turn off the main power switch if the robot is not intended to be used for a long time.
-To ensure a longer battery lifespan, charge it at least once every 6 months.

4. Connecting Your Robot

4.1 Download Smart Life App

To enjoy all available features, it is recommended to control your robot via the Smart Life App.

Before you start, make sure that:

- Your smartphone or tablet is connected to a Wi-Fi network.
- Your smartphone or tablet is running with **iOS 12.0 (or above) or Android 6.0 (or above)**.
- The 2.4 GHz band wireless signal (**NOT 5GHz**) is enabled on your wireless router.
- The Wi-Fi status light on robot is flashing blue.
- The robot is connected to the Charging Base to ensure it has enough power during setup.

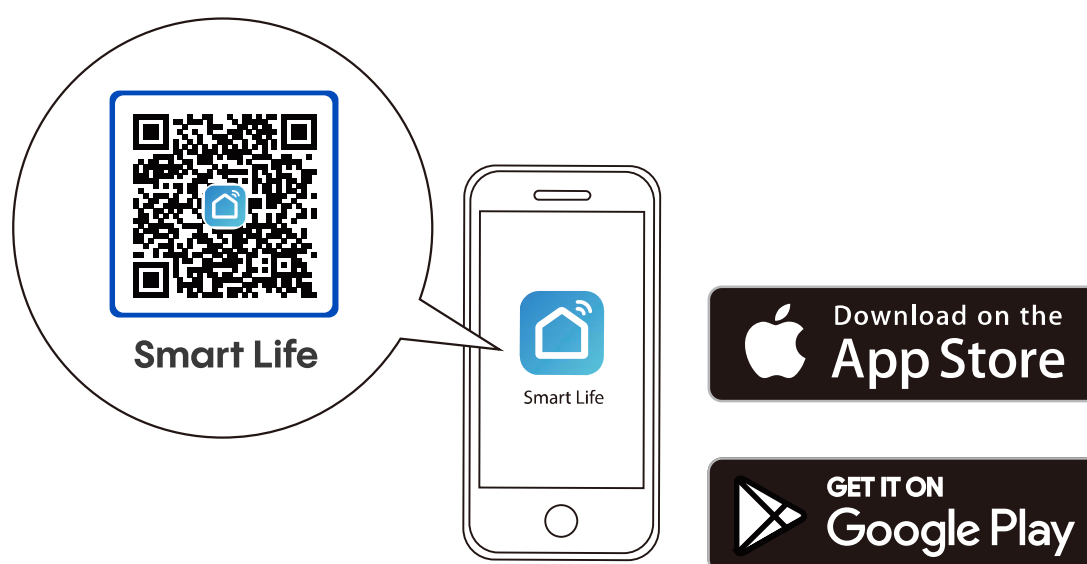

1. Download the Smart Life App from the App Store (iOS devices) or Google Play (Android devices).
2. Open the app and create a user account.
3. Tap the "+" icon to add RoboVac to your Smart Life account.
4. Follow the instructions in the app set up the Wi-Fi connection.
 - After connecting successfully, you can control robot via the App.
 - With the App, you can select a cleaning mode, set the time, schedule a cleaning, view the system status, receive notifications and access additional features.

4.2 APP Connection

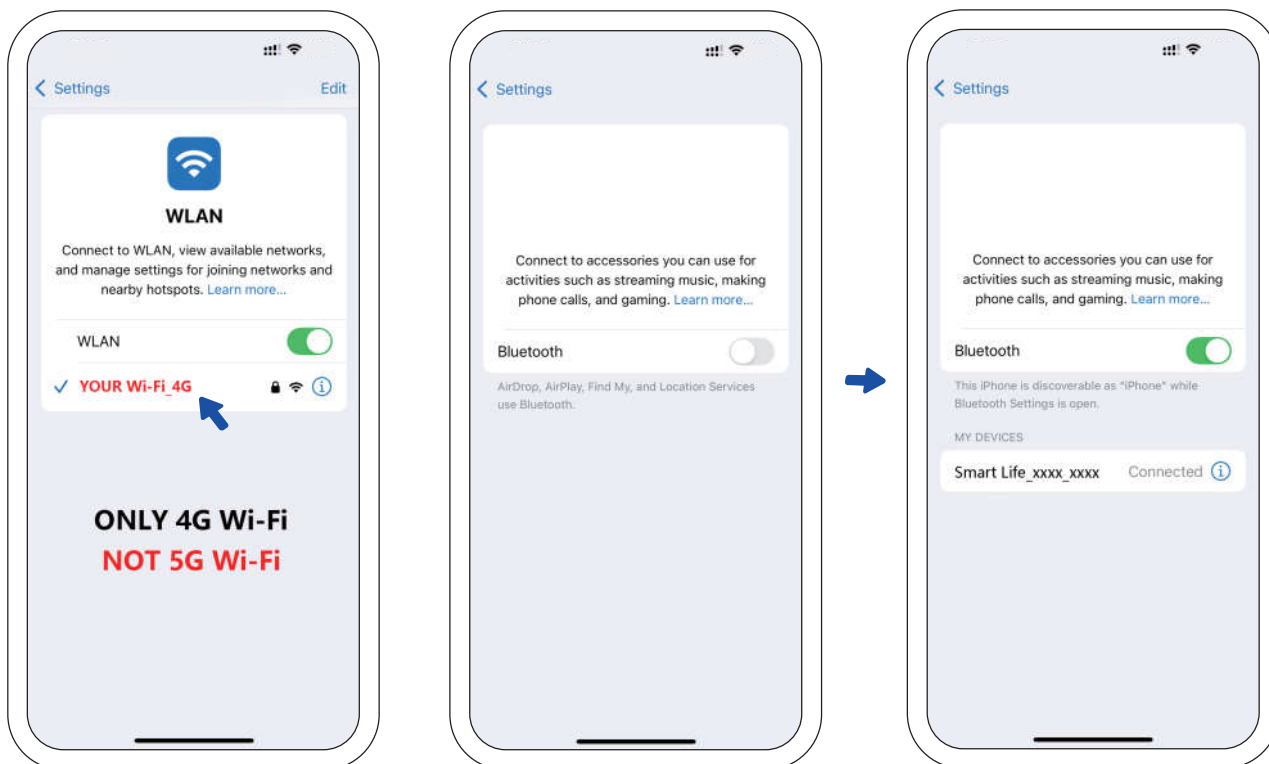

① Turn on WLAN and connect Your WIFI, **ONLY 2.4G Wi-Fi**, NOT 5G Wi-Fi.

② Turn on Bluetooth on your Phone or Pad.

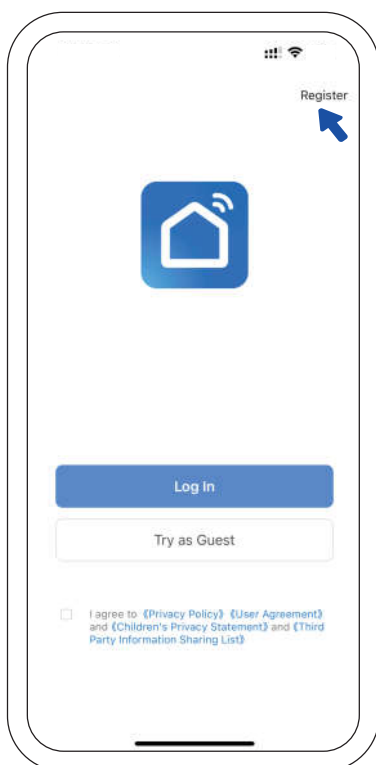

③ Open the Smart Life APP and Register a user account.

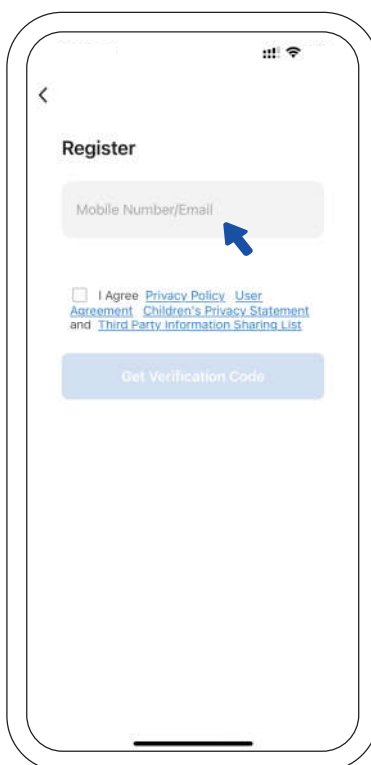

④ Register your account with the mobile phone number or E-mail ID.

● Please connect the **2.4G Wi-Fi** network and turn on the Bluetooth before performing the pairing between the Robot and the Smart Life APP.

● Enter the Smart Life APP and register a new account with your mobile phone number or Email ID.

(1) Reset the Wi-Fi Connection

● **Smart Life APP and Robot have 3 connection modes.**

- ① Quick Connect Mode
- ② EZ Mode
- ③ AP Mode

● **Press the power  button for 5 seconds and hear one Beep to turn on the Robot.**

You can choose "Quick Connect Mode", "EZ Mode" or "AP Mode" for WiFi connection according to your actual needs and follow the instructions on the APP page.

● **Quick Connect Mode or EZ Mode:** Press and hold the power  buttons at the same time for about 5 seconds until you hear two beep. The WiFi Indicator Light flashes quickly and the ROBOT enters into Quick Connect or EZ network configuration mode.

● **AP Mode:** Press and hold the the power  buttons at the same time for about 5 seconds, after you hear two beep in about 5 seconds, continue holding the button for another 5 seconds until you hear another two beep. The WiFi Indicator Light flashes slowly and the ROBOT enters into AP network configuration mode.

(2) Wi-Fi Status Light

Status		Indicator Light
	WIFI is not connected or WIFI connected fails	Light is off
	Quick Connect/ EZ-Mode	Blue light flashing fast
	AP-Mode	Blue light flashing slowly
	WIFI successfully connected	Solid blue light

Tip: In order to increase the success rate of network distribution, please turn on the Bluetooth of your mobile phone.



- If you have any problems during the Wi-Fi setup process, refer to the "[Trouble-shooting > Wi-Ficonnection](#)" section in this Manual.
- If robot gets stuck in any space, tap [Find My Robot](#) in the app to find the machine. This function is available in the app only.

{3} Quick Connect Mode

Please connect 2.4G Wi-Fi network and turn on Bluetooth in advance.

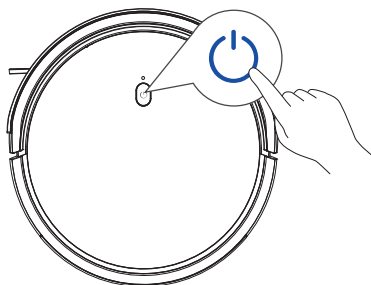
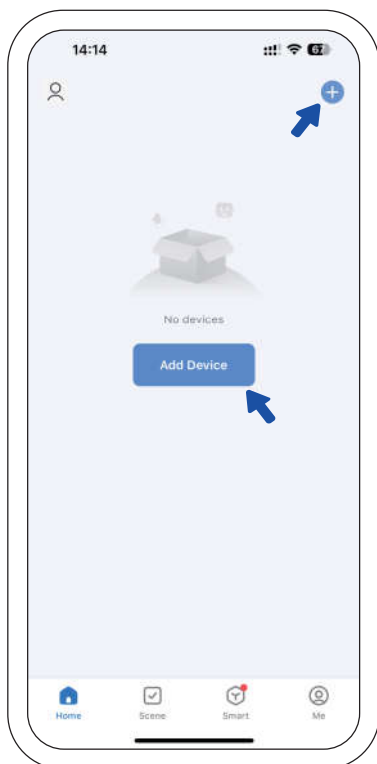

② Press the power  button for 5 seconds and hear one Beep to turn on the Robot.

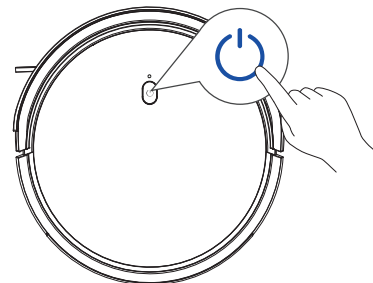

③ Press and hold the power  buttons at the same time for about 5 seconds until you hear two beeps. **The WiFi Indicator Light flashes quickly** and the ROBOT enters into **Quick Connect network** configuration mode.

① After registration and login, click the "+" sign in the upper right corner, or click the **"Add Device"**.

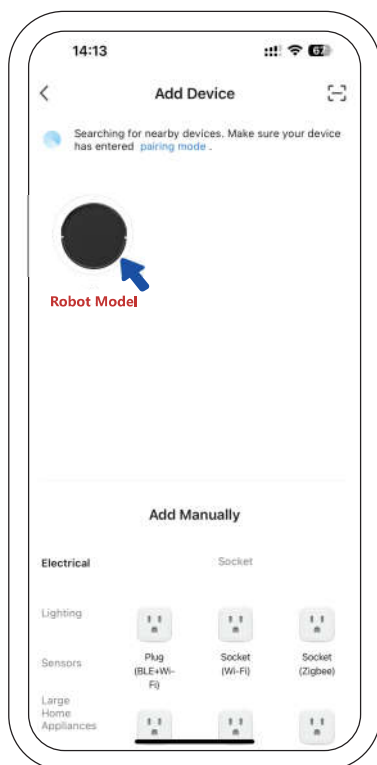

④ Wait a moment and click on **"Robot Model"**.

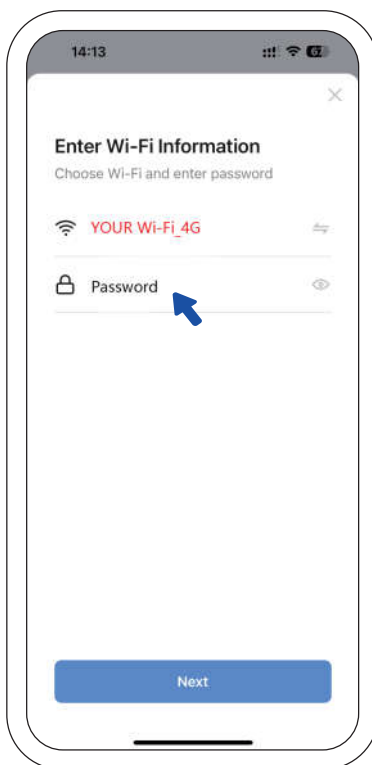

⑤ Select your **2.4G Wi-Fi** and enter the password.

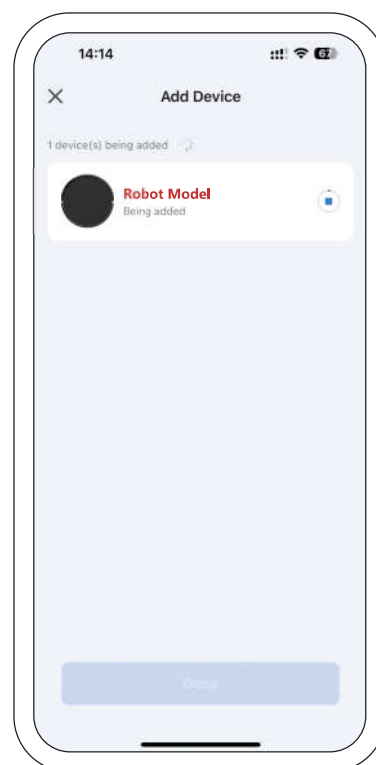

⑥ Being added.

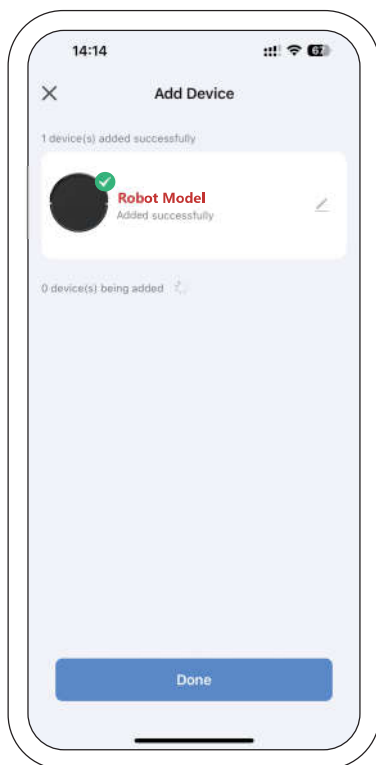

⑦ Added successfully.

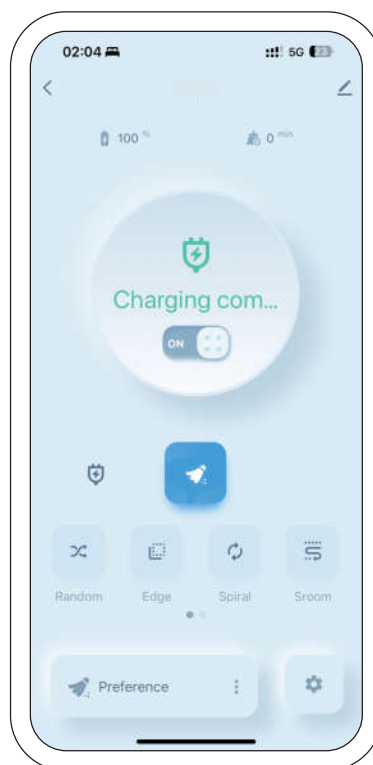

⑧ Click "ON" to default to workin "auto" mode, or select the appropriatemode and operation function accordingto the actual situation.

(4) EZ Mode

Please connect 2.4G Wi-Fi network and turn on Bluetooth in advance.

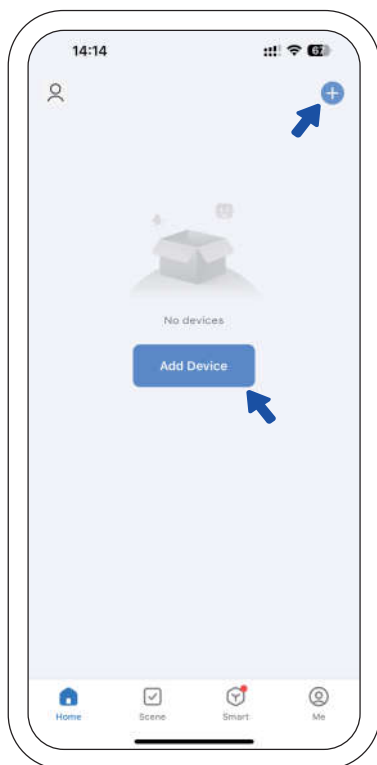

① After registration and login, click the "+" sign in the upper right corner, or click the "Add Device".

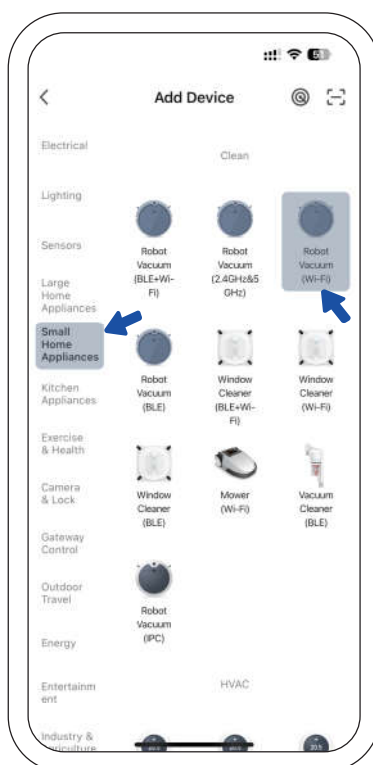

② Among the Small Home Appliances, choose **Robot Vacuum (Wi-Fi)**.

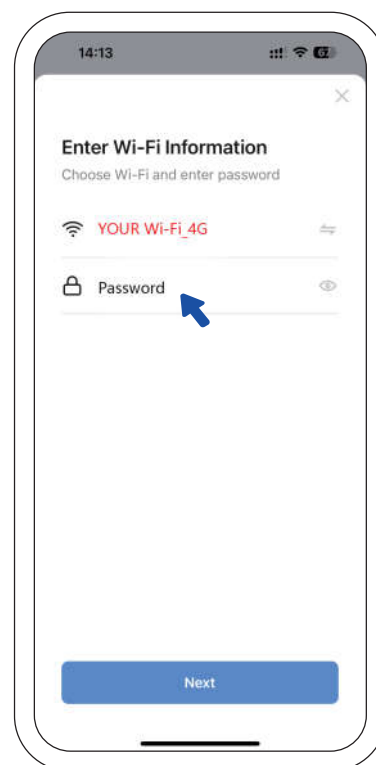

③ Select your **2.4G Wi-Fi** and enter the password.

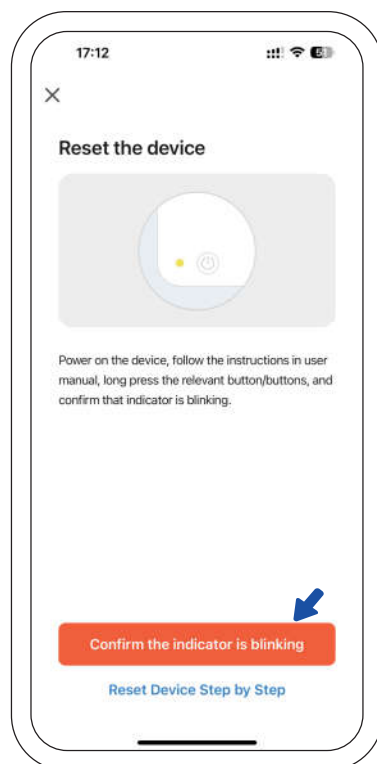

④ Confirm the indicator is blinking.

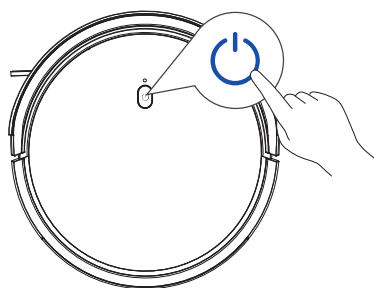

⑤ Press the power button for 5 seconds and hear one Beep to turn on the Robot.

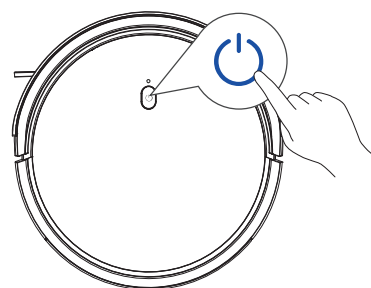

⑥ Press and hold the power buttons at the same time for about 5 seconds until you hear two beeps. **The WiFi Indicator Light flashes quickly** and the ROBOT enters into **EZ network** configuration mode.

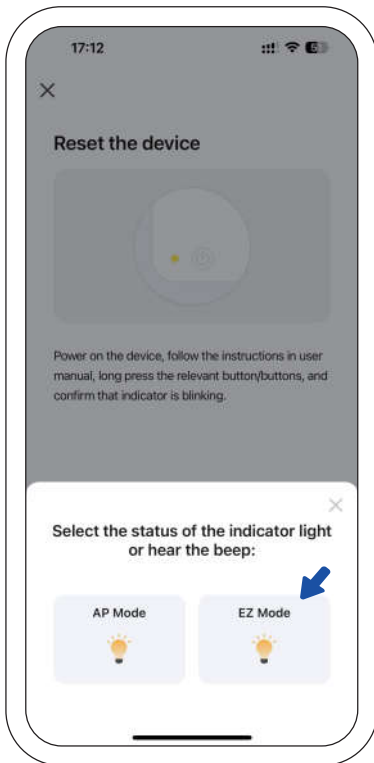

⑦ Select EZ Mode.

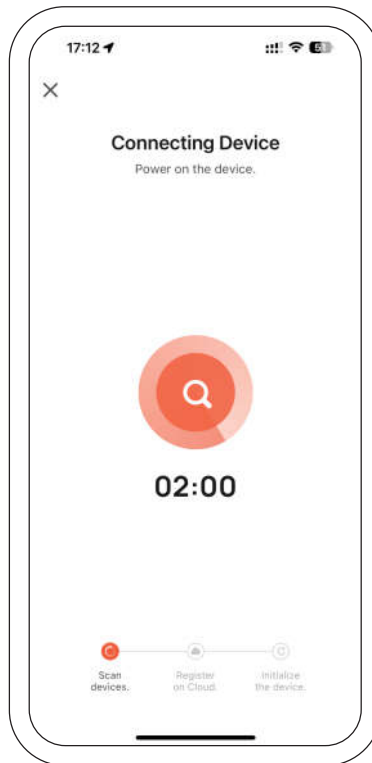

⑧ Connecting Device.

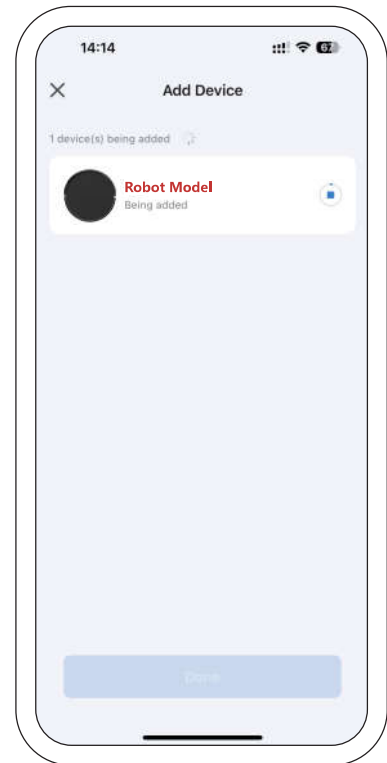

⑨ Being added.

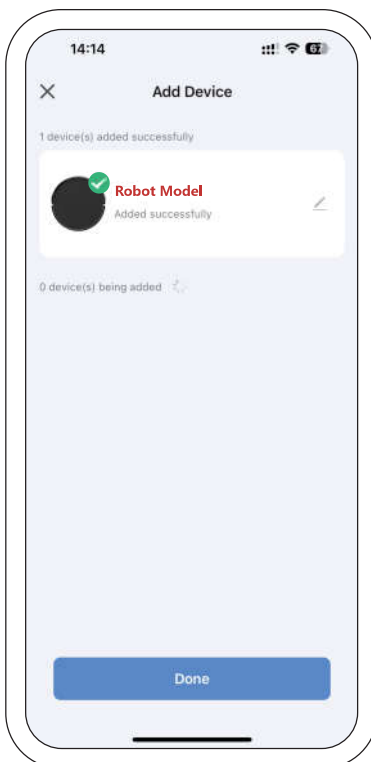

⑩ Added successfully.

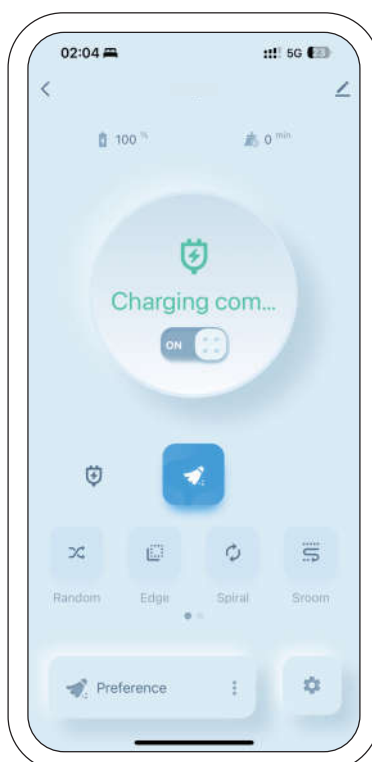

⑪ Click "ON" to default to workin "auto" mode, or select the appropriatemode and operation function accordingto the actual situation.

(5) AP Mode

Please connect 2.4G Wi-Fi network and turn on Bluetooth in advance.

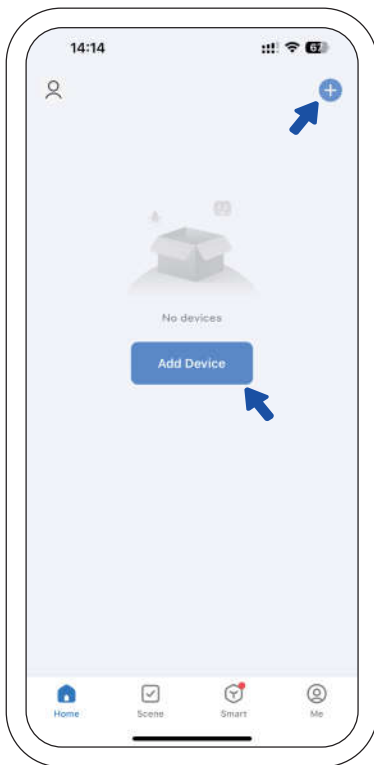

① After registration and login, click the "+" sign in the upper right corner, or click the "Add Device".

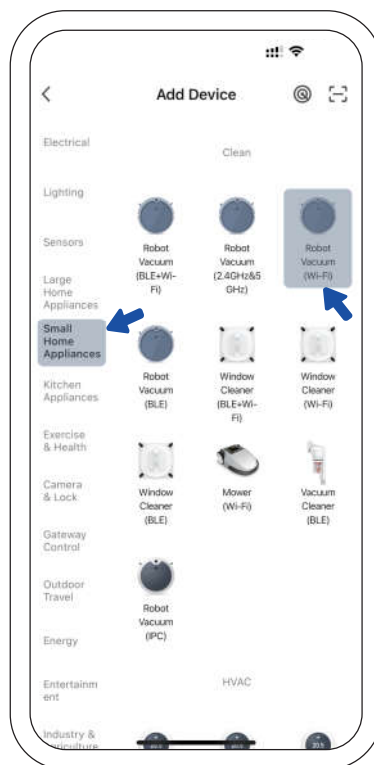

② Among the Small Home Appliances, choose **Robot Vacuum (Wi-Fi)**.

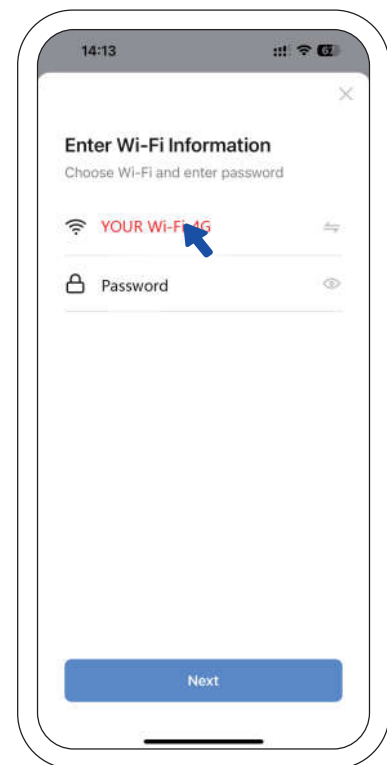

③ Select your **2.4G Wi-Fi** and enter the password.

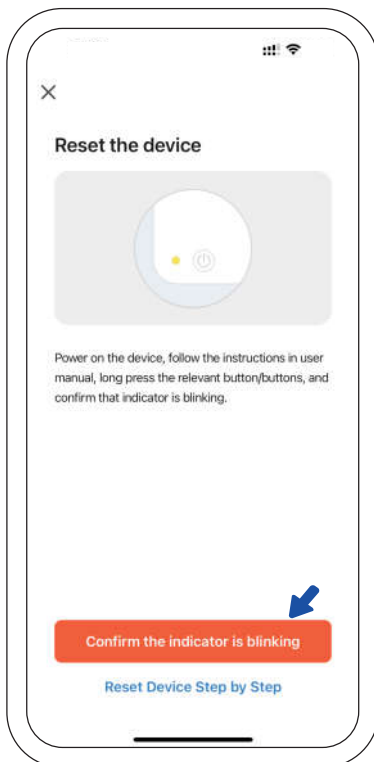

④ Confirm the indicator is blinking.

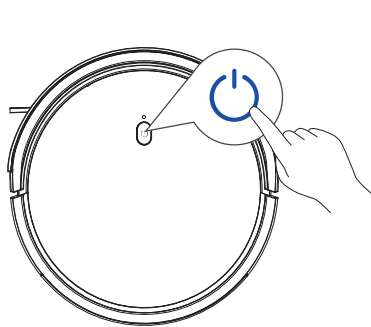

⑤ Press the power button for 5 seconds and hear one Beep to turn on the Robot.

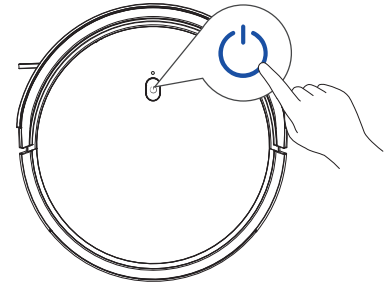

⑥ Press and hold the the power button at the same time for about 5 seconds, after you hear two beep in about 5 seconds, continue holding the button for another 5 seconds until you hear another two beep. The WiFi Indicator Light flashes slowly and the ROBOT enters into AP network configuration mode.

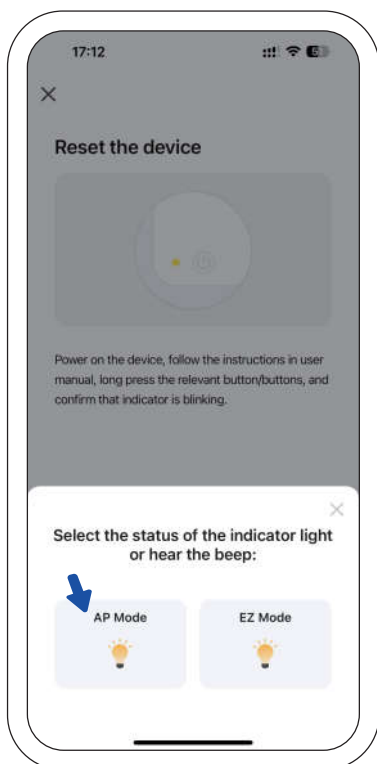

⑦ Select AP Mode.



⑧ Go to connect **SmartLife-XXXX**.



⑨ Select **SmartLife-XXXX**.

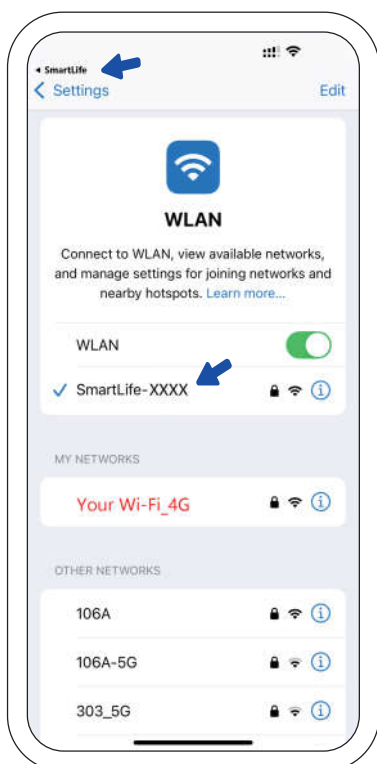

⑩ **iOS:** Once connected to **Smart Life_XXXX**, tap into **"Smart Life"** and go back to the APP for pairing.

⑩ **Android:** After connecting **Smart Life_XXXX**, tap the **"Back Button"** to return to the APP for pairing.

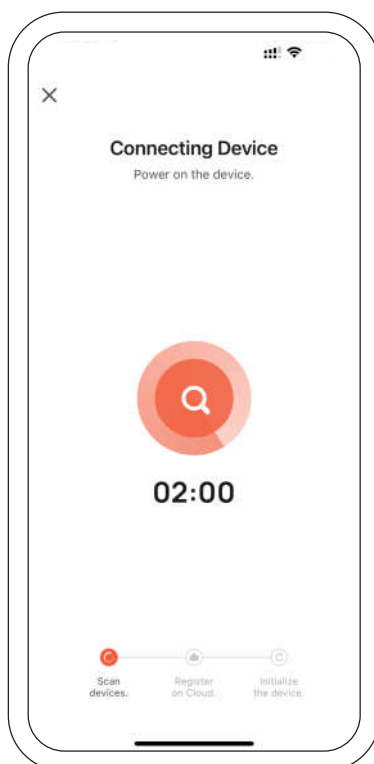

⑪ Device pairing in progress.

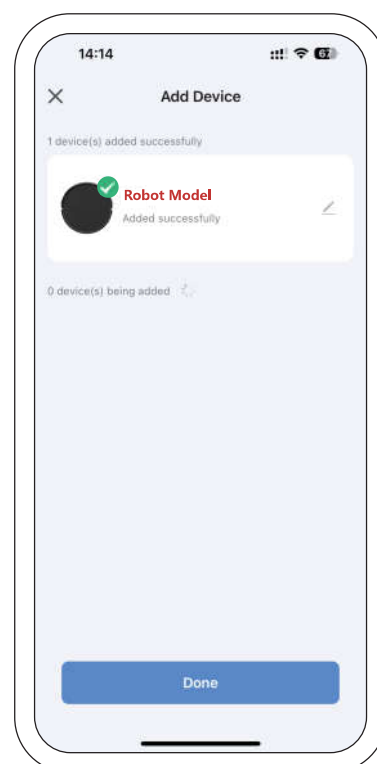

⑫ Pairing was successful.

4.3 Use Your Robot with Amazon Alexa

Amazon Alexa or the Google Assistant is a smart voice control device that enables you to control robot with your voice.

Before you start, make sure that:

- The robot is connected to the Charging Base to ensure there is enough power.
- The robot is connected with the Smart Life App.
- You have an Alexa-enabled device (i.e. Amazon Echo, Echo Dot and Amazon Tap, Echo Show, Echo Spot) . These devices are sold separately.
- The Amazon Alexa App is already installed on your smart device, and you have created an account.

To control Robot with Amazon Alexa

- Open the Amazon Alexa app and select "Skills & Game" from the  menu.
- On the [Skills](#) screen, search for "Smart Life HOME".
- Once you have found the "Smart Life HOME" skill, tap [Enable](#).
- Login with your Smart Life account so that Alexa can control your robot.
- Say simple commands to Alexa.

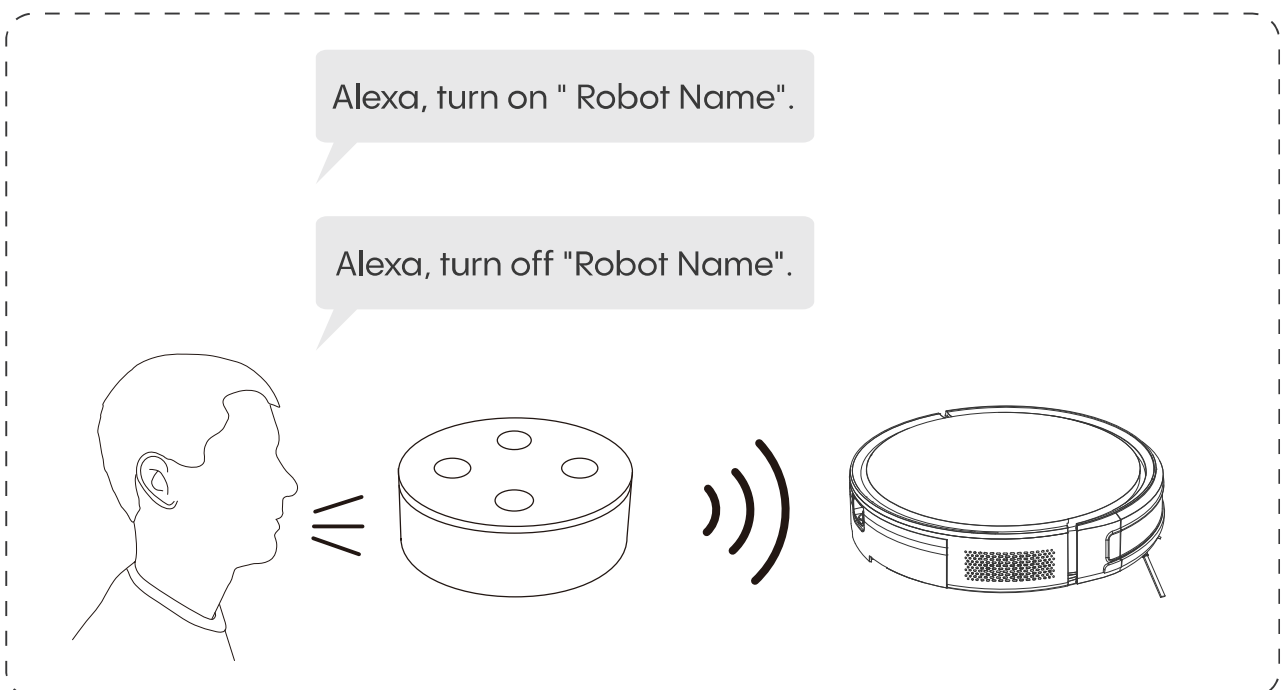

4.4 Use Your Robot with Google Assistant

Amazon Alexa or the Google Assistant is a smart voice control device that enables you to control robot with your voice.

Before you start, make sure that:

- The robot is connected to the Charging Base to ensure there is enough power.
- The robot is connected with the Smart Life App.
- You have a device enabled with the Google Assistant (i.e. Google Home, Google Home Mini). These devices are sold separately.
- The Google Home App is already installed on your smart device, and you have created an account.

To control the robot with the Google Assistant

The robot now works with the Google Assistant on devices like the Google Home.

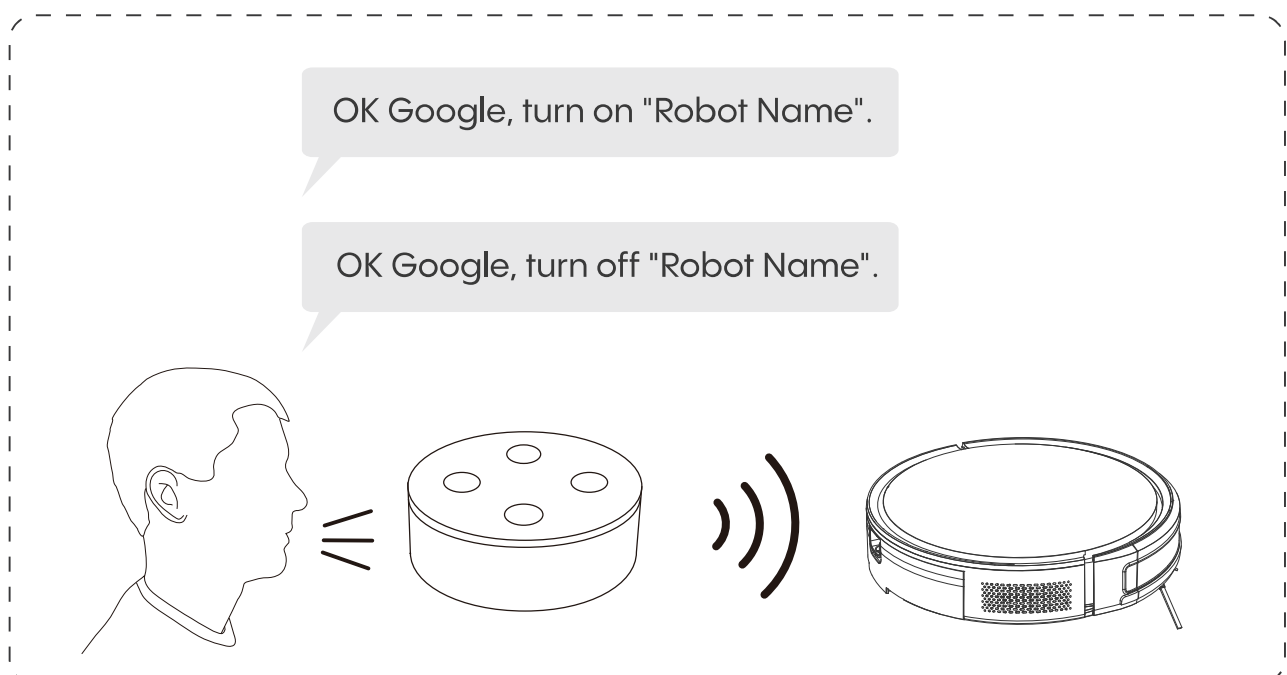

- Open the Google Home App.
- Say "Ok Google, talk to Robot" to the Google Assistant-enabled device to initiate the Google action for Robot.
- Follow the instructions in the Google Home app to authorize the Google Assistant with your Smart Life App account.
- To control Robot with your voice, say simple commands to Google Assistant.



5. Common Functions & Operations

5.1 Start/ Stop Cleaning

● Start a Cleaning Cycle

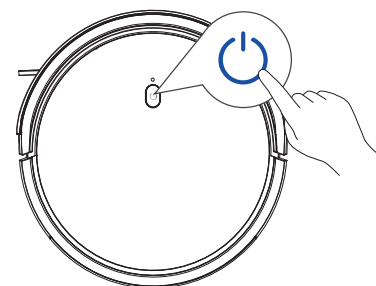

Press the power button  once to wake up the Robot.
Press the power button  again to start a cleaning.

If its battery gets low before finishing a cleaning cycle, the robot will return to the Charging Base to recharge.



If the Charging Base is inaccessible, the robot will not be able to return to the charging base and therefore will not be able to charge. It will return to its starting location and the cleaning cycle will end, please place the robot manually on Charging Base for charging. (Refer Activate the Robot)

● Pause

To pause the robot during a cleaning cycle press the  button.
To resume the cleaning cycle, press the  button again.

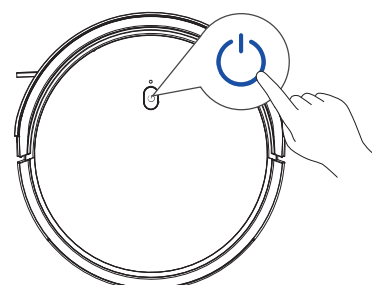

● Power Off

To end the cleaning cycle and put robot in standby mode, press  button and hold the  button until robot indicators turn off.

▲ Notice: Please use the Robot after fully charging the Robot.

▲ When not using the mopping function, remove the mopping cloth and sweep again.

5.2 Cleaning Mode

When you start the ROBOT, it starts working in Auto Cleaning Mode.

● Auto Cleaning

At the start of a cleaning cycle, the robot will map out your home and cleaning it efficiently.

At various times throughout the cleaning cycle, the robot will bump around the edges of the room, as well as chair legs and other furniture.

The Robot continues this process until it has cleaned entire level of your home. If its battery gets low before finishing a cleaning cycle, the robot will automatically return to the Charging Base to recharge.

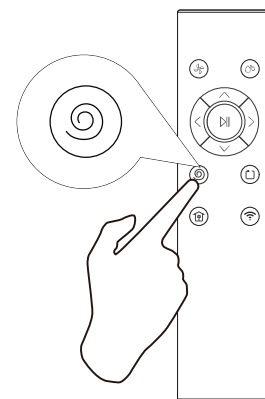
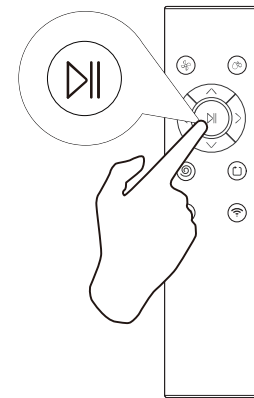
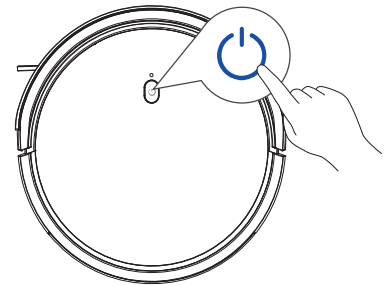

Once the robot finishes its cleaning cycle, it returns to the Charging Base to recharge.



● Spot Cleaning

When you select Spot Cleaning, the robot intensely cleans a localized area by spiraling outward about 3 feet (1 meter) in diameter and then spiraling inward to where it started.

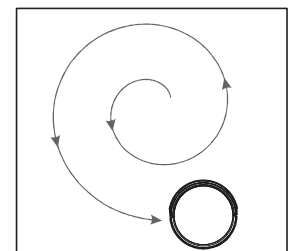

When Spot Cleaning, the robot boosts its vacuum power to provide the best cleaning possible where you need it.

To use Spot Cleaning, place the robot on top of the spot you want to clean the most and press the  button on the App (or press the  button on the Remote Control).



● Edge Cleaning

After robot finishes cleaning the open areas of your floor, it uses Edge Clean to ensure that it has cleaned along walls and around furniture Legs.

If you prefer a quicker edge cleaning, press the  button on the App (or press the  button on the Remote Control).

It is suitable for cleaning at the corners of the room. The Robot is cleaned around the periphery of a fixed object (such as wall) and back to the Charging Base after cleaning.

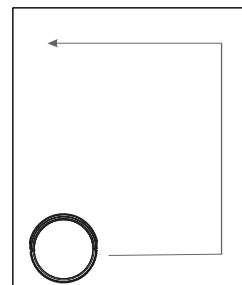

● Adjust Suction Cleaning

When the robot is turned on, the default is the standard gear suction mode.

In Auto, Spot, Edge Cleaning mode, press the  button on the Remote Control repeatedly to adjust the suction power level.

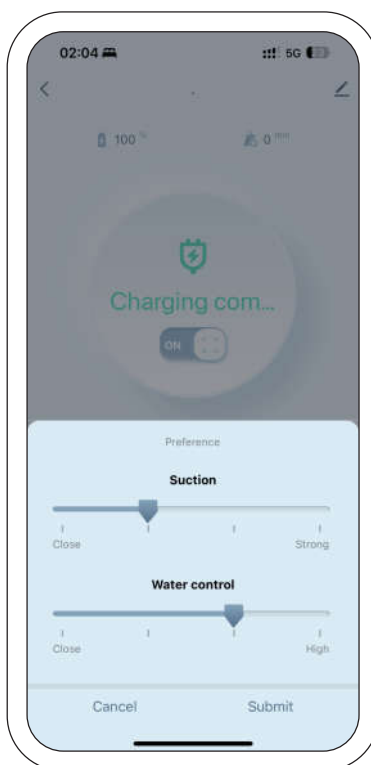

● Adjust Suction Power Level

● Water Adjustment

Before using the water volume adjustment function, add **80%** more water to the tank **(do not fill to the top)** and properly install the **Mop Cloth** and **Mop Board**.

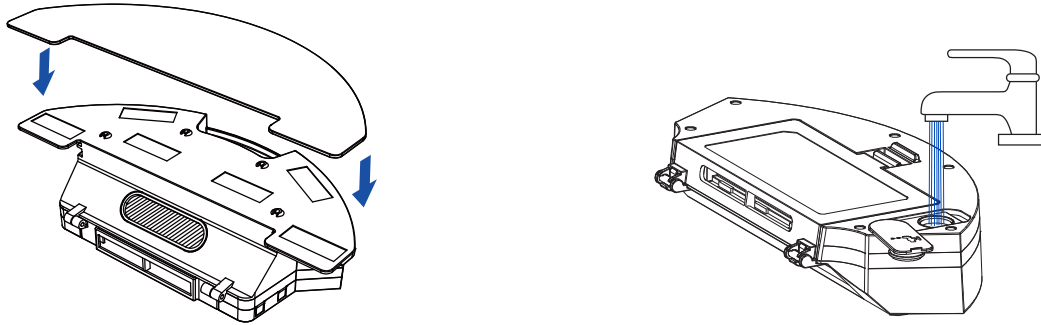

When the Robot is turned on, the default is the mid-grade mode.

You can select the suction power by APP (or press the  button on the Remote Control) to choose high-grade, mid-grade, low-grade mode, the default is mid-grade mode.

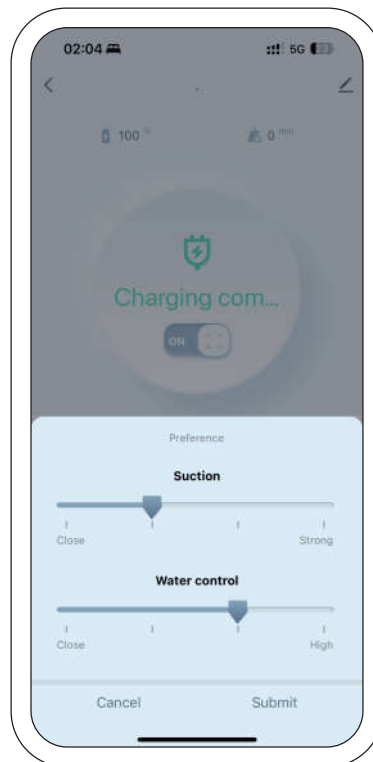

● Water Control

▲ When not using the mopping function, remove the mopping cloth and sweep again.

● Scheduling Cleaning

With the Smart Life App, you can schedule your robot to start cleaning in a specific way at a specific time.

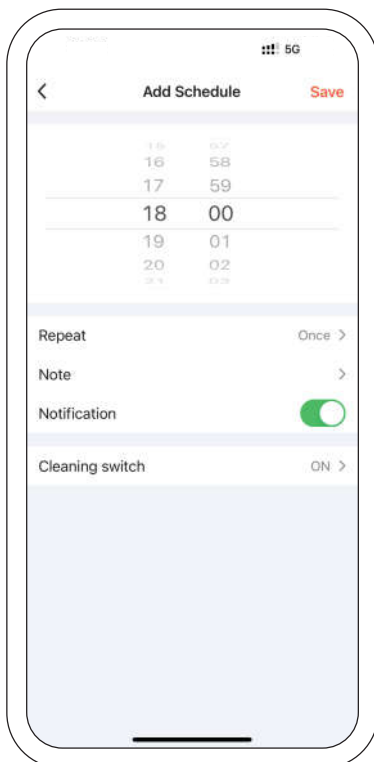

● Add Schedule



● Scheduling Cleaning

● Device Firmware Upgrade

Update to the latest version of the firmware to have a better experience.

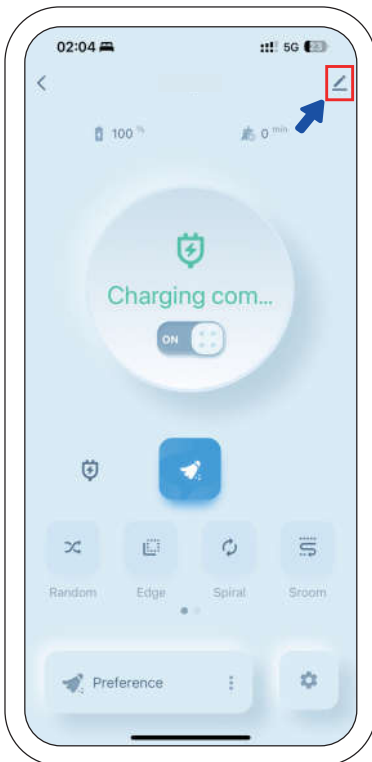

● Click the Edit Button

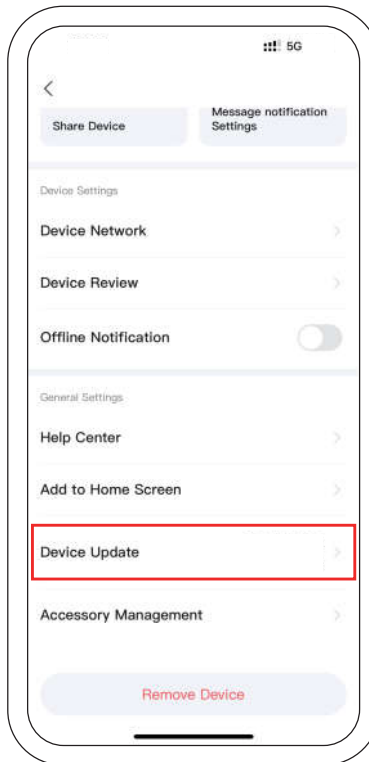

● Click the Device Update

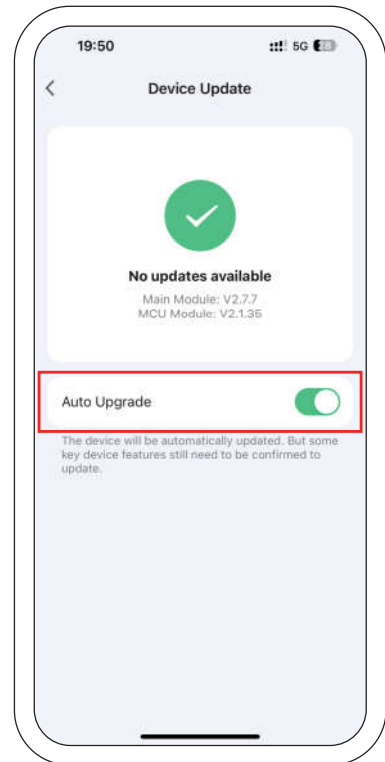

● Update to the Latest Firmware

● Copy Virtual ID

When there is an unsolvable problem with the Robot, please copy the Virtual ID of the device to the official customer service and they will find the problem for you and help you to solve it.

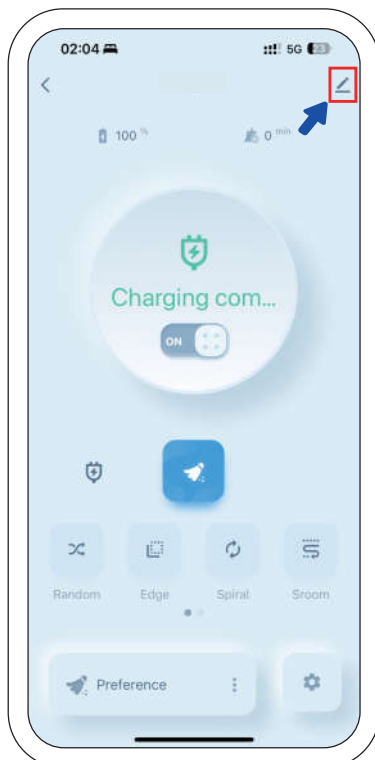

● Click the Edit Button

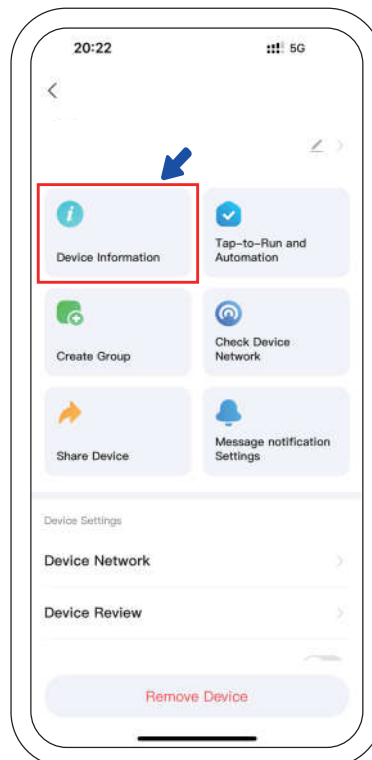

● Click the Device Information



● Copy Virtual ID

● Switch Language

When you give the robot to your family or friends, it may be in the wrong language and you can switch to a language they are familiar with.

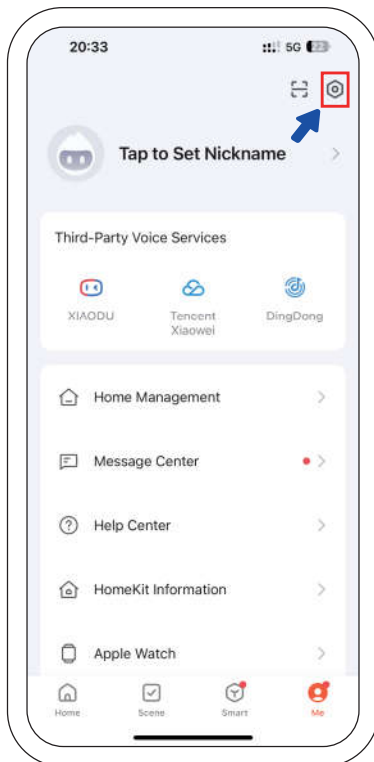

● Click on Setting

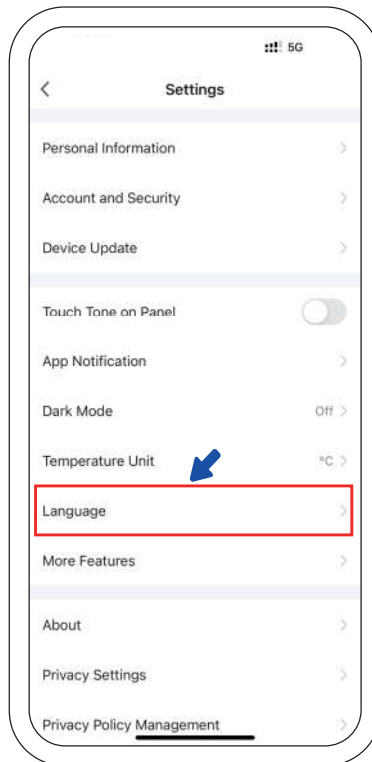

● Click the Language



● Choose the language you need

6. Regular Robot Care

To ensure that the robot will run at full performance, perform the following care procedures.

If you notice robot picking up less debris from your floor, then empty the Dust Bin, clean the Filter and Side Brush.

Recommended cleaning/ replacement frequency:

Position	Cleaning	Replacement Frequency
Dust Bin	After each use	—
Filters/ Hepa	Once every week	Every 2 months
Side Brushes	Once every month	Every 3–6 months(or when visibly worn)
Sensors	Once every month	—
Charging Pins	Once every month	—
Swivel Wheel	Once every month	—

6.1 Emptying Robot's Dust Bin

- ① Press bin release button to remove the Dust Bin.

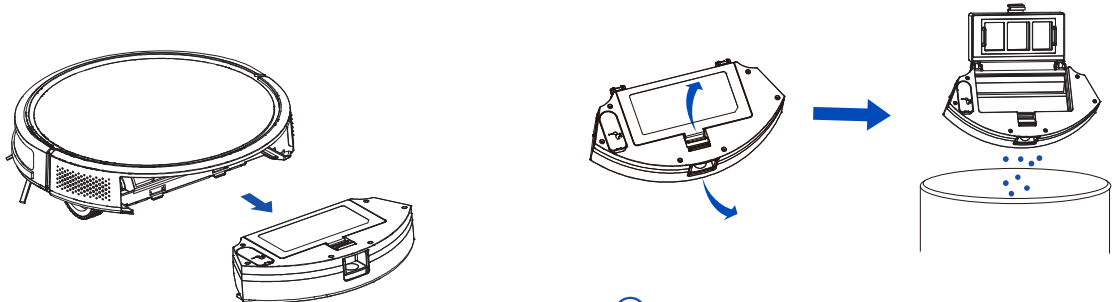

- ② Open bin's door to empty it.

6.2 Cleaning Robot 's Filter

- ① Take off the filter holder and remove dust filter.

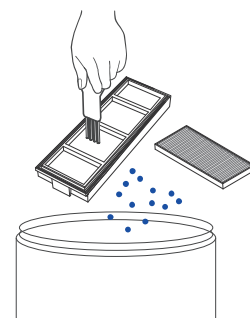
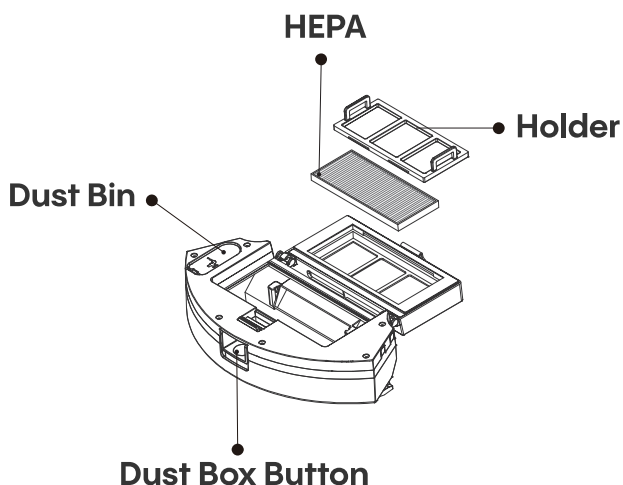

- ② Shake off debris by tapping the filter against your trash container.

- ③ Flush the Dust Bin and Clean the Filter Net.

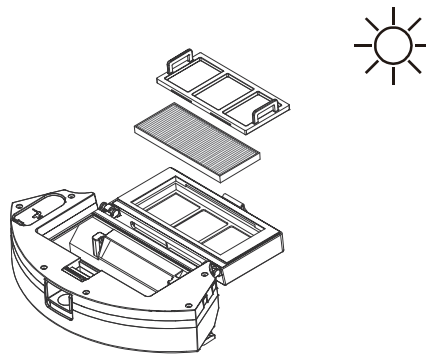
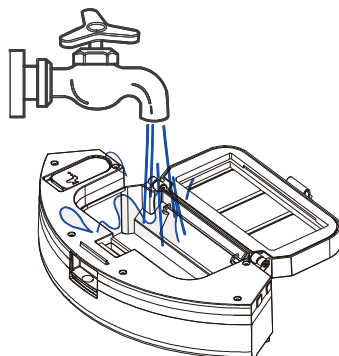

- ④ Dry the Sponge filter, Dust Bin and Filter Net completely before reinstalling.

6.3 Cleaning Robot 's Common Accessories

- ① Clean the suction port with a wet-cloth.

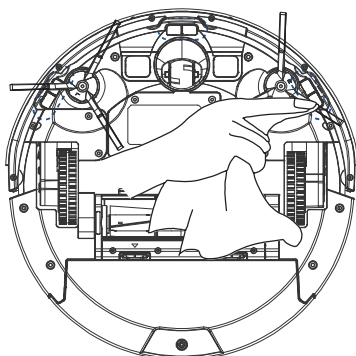

- ② Cleaning the Side Brushes
Remove the Side Brushes. Wipe the Side Brushes and their slots with a dry cloth.

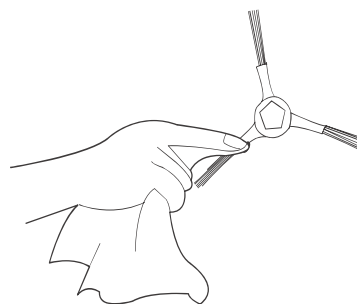

- ③ Use the multi-function cleaning tool to cut off and remove any hair tangled around the universal wheel.

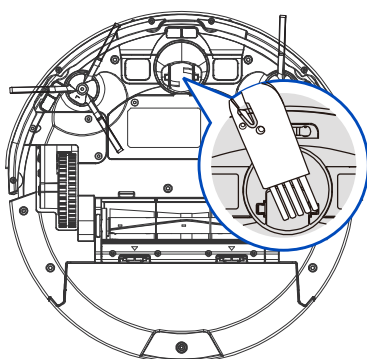

- ④ Clean the driving wheel to maintain it's effectiveness.

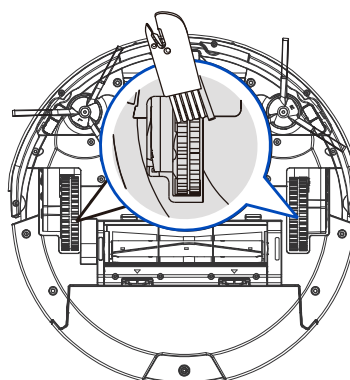

6.4 Clean the Sensors and Charging Pins

- To maintain the best performance, clean the drop sensors and charging pins regularly.
- Dust off the drop sensors and charging contact pins using a cloth or cleaning brush.

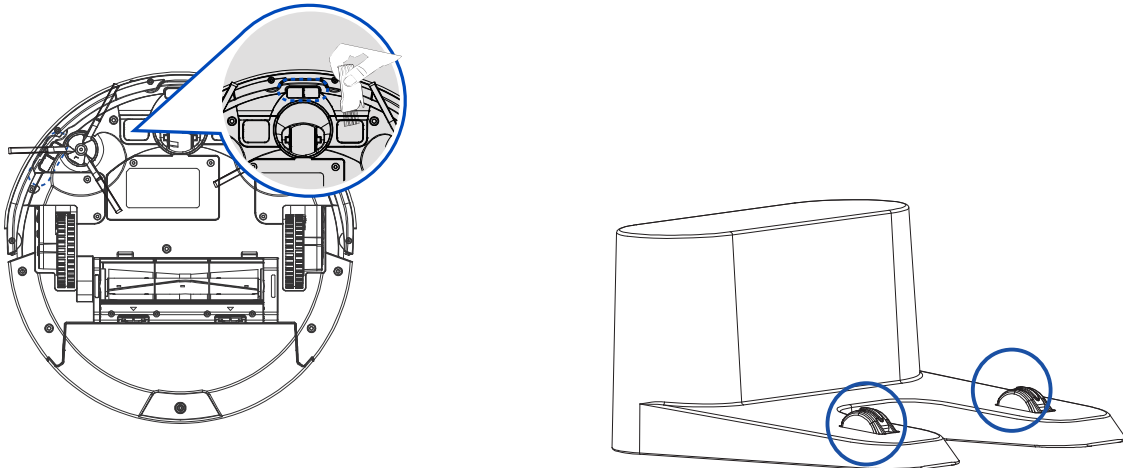

6.5 Battery Maintenance

The robot has inserted high-performance lithium battery packs and to maintain the battery's performance, please keep it charged at a daily basis.

If placing the robot into storage, charge it fully and turn it off before placing it in a cool dry place. Recharge it at least every three months to prevent the battery over discharging.

6.6 Battery Replacement

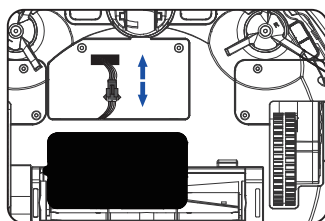
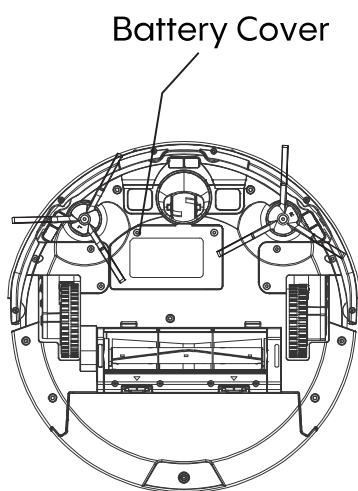

① Use a Phillips screwdriver to remove the screws and open the battery cover.

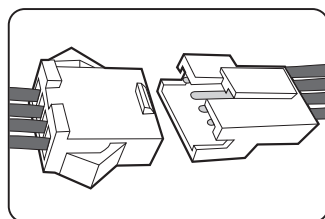

② Unhook the battery connector, replace the battery, and reattach the battery cover in the same way.

6.7 Cleaning the 2-in-1 Water Tank

1. Press and hold 2-in-1 release button, and pull out the 2-in-1 water tank at the same time.

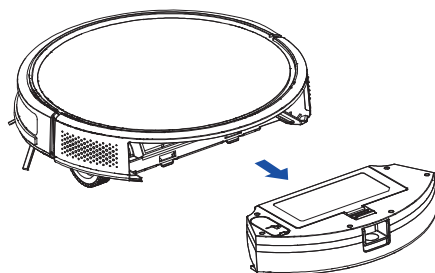

2. Pull the buckle of 2-in-1 water tank and dust box, and pour the waste.

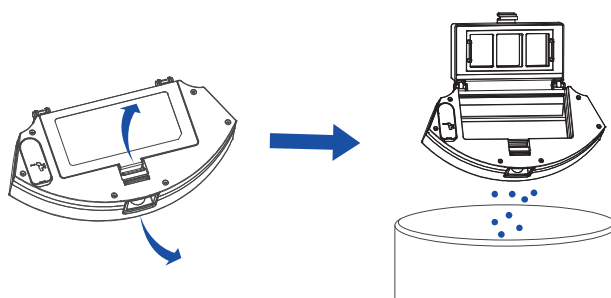

3. Remove the Filter and HEPA and use a cleaning brush to remove any foreign matter from the filter and hepa.

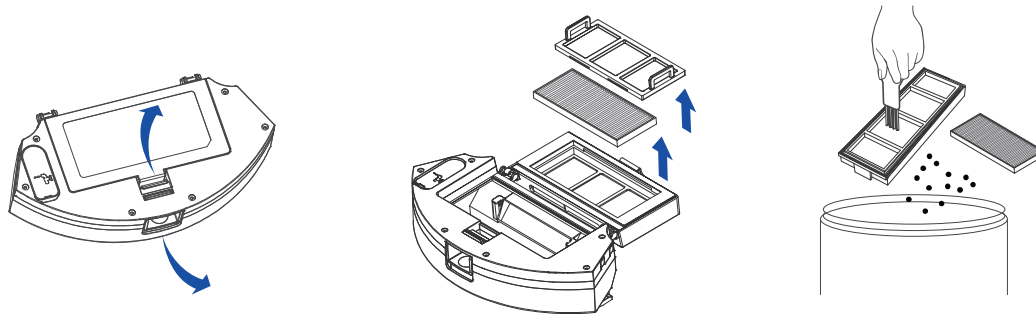

4. Take off the mount by press the latch. Put it in place according to the original direction after cleaning or replace mop cloth.

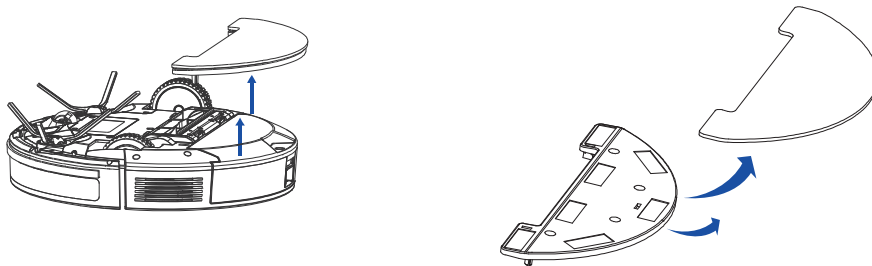

Prompt:

1. Please clean the mop in time, for the mopping effects will be weakened if mop has much dirt.
2. Remove the mop for cleaning and installation. It is forbidden to clean it on the 2-in-1 water tank; otherwise, the water can be damaged easily.
3. It is advised to replace the mop once every 3-6 months, in order to ensure good cleaning effects.

Note:

It is necessary to take off the cloth for cleaning.
It is prohibited to clean the cloth on the mount.

▲ When not using the mopping function, remove the mopping cloth and sweep again.

7. Troubleshooting

7.1 Error Tones

When robot is in trouble, it will emit a series of short or long beeps and the red indicator on robot will be solid or flashing. Refer to the following table to query the cause of the failure.

Robot Prompt	Fault Cause	Trigger Condition	Treatment Method
Solid Red Light	One Beep	Side Wheel Error	Clean the side wheel and restart.
	Two Beeps	Side Brush Error	Clean the side brush and restart.
	Three Beeps	Fan Error	Clean the 2-in-1 water tank and fan and then restart.
	Four Beeps	Rolling Brush Error	Checked if the rolling brush is twined and clean the rolling brush.
Flashing Red Light	One Beep	Machine is Trapped	Clean the surrounding objects or obstacles.
	Two Beeps	Collision Error	Touch the left/ middle/ right side of anti-collision barrier with hands to see if the Product can bounce automatically.
	Three Beeps	Floor Detection Error	Clean the bottom view sensor of machine, put the machine Flat and then restart it.
	Four Beeps	Battery Error	Put the Product back to charging base for recharging.

Note:

- ① Please refer to the Troubleshooting section in the manual for more information.
- ② If the Robot is not used for a long time, please charge it every 3 months to avoid over-discharging and damaging the battery.

If the above does not solve the problem, please try to restart the Robot or contact our customer service.

7.2 Frequently Asked Questions

Problems	Solutions
Robot cannot be activated.	<p>Make sure the main power switch is in the ON position.</p> <p>Make sure the battery is fully charged.</p> <p>If you still have trouble, turn off the main power switch, wait then turn it back on.</p>
The remote control does not work.	<p>Replace the batteries in the Remote Control.</p> <p>Make sure Robot is turned on and fully charged.</p> <p>The infrared signal cannot be transmitted because the Infrared Emitter on the Remote Control or Robot's Infrared Receiver on Robot is dirty.</p> <p>Use a dry cloth or the Multi-Function Cleaning Tool to wipe the Infrared Emitter on Remote Control and the Infrared Receiver on Robot.</p>
Robot stops working suddenly.	<p>Check if robot is trapped or stuck on an obstacle.</p> <p>Robot will try various ways to get itself out of trouble. If it is unsuccessful, manually remove the obstacles and restart.</p> <p>Check if the battery level is too low.</p> <p>If you still have trouble, turn off the main power switch, wait for 2 seconds and then turn it back on.</p>
You cannot schedule cleanings.	<p>Make sure the main power switch on the bottom of Robot is turned on.</p> <p>Make sure the time, time of day (AM/PM), and the scheduled time have been set correctly.</p> <p>Check if Robot's power is too low to start cleaning.</p>
Suction power is weak.	<p>Check if any obstructions are blocking the suction inlet.</p> <p>Empty the dust collector.</p> <p>Clean the filters with a vacuum cleaner or a cleaning brush.</p> <p>Check if the filters are wet due to water or other liquid on the floor.</p> <p>Air-dry the filters completely before use.</p>
Robot cannot be charged.	<p>Check if the indicator on the Charging Base lights up. If not, contact the Smart Life service center to repair or replace the Charging Base.</p> <p>Dust off the charging contact pin with a dry cloth.</p> <p>Check if you can hear a beep when Robot is docked onto the Charging Base.</p> <p>If not, contact the Smart Life service center to repair or replace the Charging Base.</p>

Problems	Solutions
Robot cannot return to the Charging Base.	<p>Remove objects within 3 ft/1 m to the left and right side and within 6 ft/2 m of the front of the Charging Base.</p> <p>When Robot is in the vicinity of the Charging Base, it will return more quickly. However, if the Charging Base is located far away, Robot will need more time to return. Please be patient as it works its way back.</p> <p>Clean the charging contact pins.</p>
Robot's movements or travel path are abnormal.	<p>Clean the sensors carefully with a dry cloth.</p> <p>Restart Robot by turning the power switch off and on.</p>
Robot returns to the Charging Base before it Finishes cleaning.	<p>When battery power gets low, Robot automatically switches to Return to Charger Mode and returns to the Charging Base to recharge itself. This is normal.</p> <p>Working time varies according to floor surface, room complexity and the selected Cleaning Mode. This is normal.</p>
The Robot is too noisy.	<p>Side brush, entangled, dustbin Filter material blocked, etc</p> <p>It is recommended to clean and maintain the brush, dustbin and filters regularly.</p> <p>The Robot is in MAX suction power mode.</p> <p>Change the suction power mode to Medium or Low.</p>
Robot cannot connect to a Wi-Fi network.	<p>Make sure your Wi-Fi router supports the 2.4GHz and 802.11b/g/n bands; the 5GHz band is not supported.</p> <p>For details, refer to the "Troubleshooting > Wi-Fi connection" section in this manual.</p> <p>Ensure the Robot is under WIFI signal coverage.</p>
You cannot control Robot with Amazon Alexa.	<p>Check if there are any Internet connection problems.</p> <p>Check whether you have installed the Amazon Alexa app onto your smart device and enabled "Smart Life" Skill in the Amazon Alexa app. For details, refer to the "Use Your Robot with Amazon Alexa/ the Google Assistant" section in this manual.</p> <p>Make sure you have an Smart Life account.</p> <p>Make sure you are using correct Alexa voice-commands.</p>

You cannot control Robot with the Google

Check if there are any Internet connection problems.
 Check if you have installed the Google Home app onto your smart device and initiated the "Smart Life" action in the Google Home app. For details, refer to the "Use Your Robot with Amazon Alexa/ the Google Assistant" section in this manual.
 Check if you are using the proper commands when talking to the Google Assistant.
 When making your request, first say the wake words "Ok Google".
 Repeat your question. Speak clearly to the Google Assistant.
 Repeat your question. Speak clearly to the Google Assistant.

7.3 Wi-Fi Connection

Before setting up Wi-Fi, make sure the robot and Wi-Fi network meet the following requirements.

Wi-Fi Setup Requirements

Robot:

- Robot is fully charged and robot is turned on.
- Wi-Fi status light slowly flashes blue.

Wi-Fi Network:

- Use the correct password for your network.
- Do not use a VPN (Virtual Private Network) or Proxy Server.
- Your Wi-Fi router supports 802.11b/g/n and IPv4 protocol.
- You are using a 2.4 GHz router or a dual-band router that is configured to support a 2.4GHz frequency band, Robot does not support 5GHz frequency band.
- If robot cannot connect to the Wi-Fi network and you are using a 2.4/5 GHz mixed network switch to a 2.4 GHz network for Wi-Fi setup.

You can switch back once your setup is complete.

- When connecting to a hidden network, make sure you enter the connect network name SSID (case sensitive), and connecting to a 2.4 GHz wireless network.

When using a network extender/ repeater, make sure the network name (SSID) and password are the same as your primary network.

- The firewall and port settings of your Wi-Fi router allow robot to connect with the Smart Life servers.

Network Security Requirement:

- WPA and WPA 2 using TKIP, PSK, AES/ CCMP encryption.
- WEP EAP(Enterprise Authentication Protocol) is not supported.

Wi-Fi Channels:

- The FCC requires that all wireless devices in the United States operate on the 1-11 wireless spectrum channels.
- Some countries can use spectrum channels higher than channel 11. Refer to your local regulatory agency to determine which channels are accessible.
- A future software release will support access to channels above 11 for users outside North America. Until then, use channels 1-11.

8. Specifications

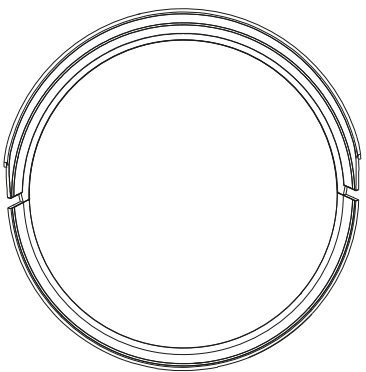
	Product Model	HR1010
	Input	15 V \approx 0.8A
	Output	15 V \approx 0.8A
	Battery Voltage	10.8 V
	Power Consumption	28 W
	Battery Capacity	Li-ion 2500mAh
	Dust Collector Capacity	250mL
	Water Tank Capacity	200mL
	Charging Time	3-5H
	Remote Control	Yes
	Frequency Band	2400-2483.5 MHz
	Maximum Transmission Power	≤ 20 dBm

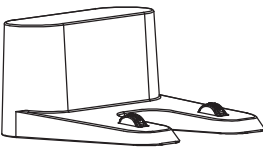
	Input	15V \approx 0.8A
	Output	15V \approx 0.8A

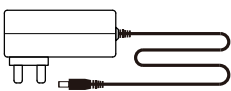
	Input	15V \approx 0.8A
	Output	15V \approx 0.8A

9. FCC Statement

Changes or modifications not expressly approved by the party responsible for compliance could void the user's authority to operate the equipment.

This equipment has been tested and found to comply with the limits for a Class B digital device, pursuant to Part 15 of the FCC Rules. These limits are designed to provide reasonable protection against harmful interference in a residential installation. This equipment generates uses and can radiate radio frequency energy, and if not installed and used in accordance with the instructions, may cause harmful interference to radio communications. However, there is no guarantee that interference will not occur in a particular installation. If this equipment does cause harmful interference to radio or television reception, which can be determined by turning the equipment off and on, the user is encouraged to try to correct the interference by one or more of the following measures:

- Reorient or relocate the receiving antenna.
- Increase the separation between the equipment and receiver.
- Connect the equipment into an outlet on a circuit different from that to which the receive is connected.
- Consult the dealer or an experienced radio/ TV technician for help.

This device complies with part 15 of the FCC rules. Operation is subject to the following two conditions (1) this device may not cause harmful interference, and (2) this device must accept any interference received, including interference that may cause undesired operation.

FCC ID:2AVYJ-HR1010

10. IC Warning

This device contains licence-exempt transmitter(s)/ receiver(s) that comply with Innovation, Science and Economic Development Canada's licence-exempt RSS(s).

Operation is subject to the following two conditions:

- ① This device may not cause interference.
- ② This device must accept any interference, including interference that may cause undesired operation of the device.

RF Warning Statement:

This equipment complies with IC radiation exposure limits set forth for an uncontrolled environment. This equipment should be installed and operated with minimum distance 20cm between the radiator & your body.

L'émetteur/ récepteur exempt de licence contenu dans le présent appareil est conforme aux CNR d'Innovation, Sciences et Développement économique Canada applicables aux appareils radio exempts de licence. L'exploitation est autorisée aux deux conditions suivantes :

- ① L'appareil ne doit pas produire de brouillage;
- ② L'appareil doit accepter tout brouillage radioélectrique subi, même si le brouillage est susceptible d'en compromettre le fonctionnement.

Avertissement RF:

Cet appareil est conforme à IC l'exposition aux rayonnements limites fixées pour un environnement non contrôlé. Cet appareil doit être installé et utilisé avec une distance minimale de 20 cm entre le radiateur et votre corps. Cet transmetteur ne doit pas être co-situé ou opérant en liaison avec toute autre antenne ou transmetteur.

IC:26341-HR1010

INNOVATE

FURTHER



Made in China

**ROBOT
VACUUM
CLEANER**

