

2D Wireless Barcode Scanner

Quick Start Guide

Code: FS-UM2GB2-01_EN

Ver.:V1.0

CONTENTS

Features.....	1
Product Diagram.....	2
Bluetooth HID Mode.....	3
Bluetooth SPP Mode.....	3
2.4G Receiver Mode.....	5
Work Mode.....	6
Sleep Time Setting.....	7
Language.....	8-12
Beeper& Vibration.....	13
Transmit Speed.....	14
End Characters.....	14
Restore Default.....	15
Battery Remaining.....	15
2D Module Setting.....	16-18

[Features]

- 1) **Bluetooth + 2.4G wireless communicator!.**
- 2) **Pairing with various types of PC.**

- 3) Long distance of wireless transmission.
- 4) Built-in large memory space.
- 5) About 130000 pieces of barcodes can be stored at most under off-line mode.
- 6) Both on-line and off-line mode are supported.
- 7) Windows,Android,iOS and Mac devices are supported.
- 8) Bluetooth HID/SPP/ are supported.

[Packing list]

Receiver 1 unite

Charge Base / Receiver 1 unite

Wireless scanner 1 unite

USB data cable Ipc

DC Charge cable 1 pc

Quick guide 1 unite

Power Adapter 1 unite

[Product Diagram]

3. Trigger

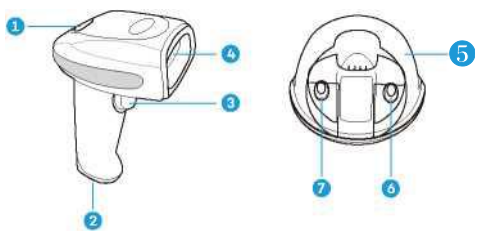

- 1. LED Indicator
- 2. Charging Contacts
- 4. Scan Lens

5. Charge Base / Receiver

6. Pair Button.

Method: Turn on the scanner and put on the Charge Base/Receiver; Press the button "Pair" , sound Di. the scanner pair with 2.4G receiver successful.

7. Reset Button.

Method: Turn on the scanner and put on the Charge Base/Reveiver, press the button "Reset" and hold on 8 seconds long,sound Di Jhe scanner return to 2.4G Mode default successful.

NOTE:

This device complies with part 15 of the FCC Rules. Operation is subject to the following two conditions: (1) This device may not cause harmful interference, and (2) this device must accept any interference received, including interference that may cause undesired operation.

Any Changes or modifications not expressly approved by the party responsible for compliance could void the user's authority to operate the equipment.

Note: This equipment has been tested and found to comply with the limits for a Class B digital device, pursuant to part 15 of the FCC Rules. These limits are designed to provide reasonable protection against harmful interference in a residential installation. This equipment generates uses and can radiate radio frequency energy and, if not installed and used in accordance with the instructions, may cause harmful interference to radio communications. However, there is no guarantee that interference will not occur in a particular installation. If this equipment does cause harmful interference to radio or television reception, which can be determined by turning the equipment off and on, the user is encouraged to try

to correct the interference by one or more of the following measures:

- Reorient or relocate the receiving antenna.
- Increase the separation between the equipment and receiver.
- Connect the equipment into an outlet on a circuit different from that to which the receiver is connected.
- Consult the dealer or an experienced radio/TV technician for help.