



Qi2 Wireless Charger



Model:SL-S2

What's In the Box

1. Acer Qi2 wireless charger
2. USB-C to USB-C fast charging cable
3. 33W USB-C PD adapter

Specification

Brand: Acer

Model: SL-S2

USB-C Input: 9V-3A / 5V-3A

Wireless Output: 2.5W / 5W / 7.5W / 10W /
Qi2 15W max

Charging Efficiency: ≤80%

Size: 76 x 76 x 109 mm

Weight: 350g

Product Parts Description

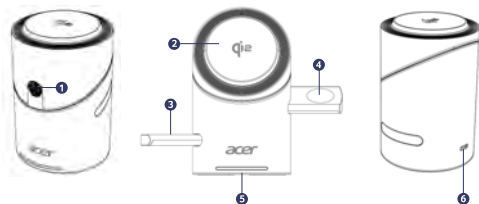

1. Touch Electric Panel
2. Phone Wireless Charging Area
3. Earbuds Wireless Charging Area
4. Watch Wireless Charging Area
5. Charging Indicator Light
6. Power Input Port

How to Use



1. Connect the power supply to turn on the product.



2. Touch the front panel to adjust the angle of the phone charging area. (If the phone charging module is misaligned by manual operation, reboot the product and touch the front panel to realign the charging module.)

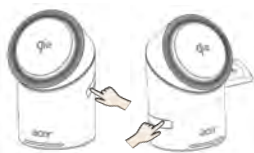

3. Press the side pop-up module to retrieve the watch charging dock & earbuds charging dock. (right: watch / left: earbuds)

Indicator States and Protection Features

1. Standby Mode:

After powering on the product, the green indicator light remains steadily on for 15 seconds, then turns off to enter standby mode.

2. Charging Mode:

The green indicator light enters breathing mode (slow pulsation) and turns off after 15 seconds. Once the receiver is removed, the indicator light stays off.

3. Foreign Object Detection :

If coins, keys, or other metallic or magnetic objects are placed on the product, the red indicator light starts blinking, and power supply stops after 15 seconds.

4. Other Safety Protection:

Our product equips with protection against overheating, short circuit, over-voltage, and over-current.

Applicable Devices



Phone: iPhone 12/13/14/15/16 & Other Qi-compatible Phone.



Watch: Apple Watch Only.



Earbuds: AirPods and other wireless charging earbuds.

Note: Phone: For non-Qi-compatible phones, please use a Magsafe case to use this product.

Applicable Devices

Do not apply excessive pressure or cause impact.

1. Do **not** disassemble the product or expose it to fire or water to avoid short circuits or electric leakage.
2. Do **not** use the product in extremely hot, humid, or corrosive environments to prevent from circuit damage and electric leakage.
3. Do **not** place your cards (e.g., ID cards, bank cards) on the charging area, as it may deactivate the cards.
4. Do **not** place metal objects (such as coins) on the charging area during charging to avoid overheating or other damage.

FCC STATEMENT

This device complies with Part 15 of the FCC Rules. Operation is subject to the following two conditions: (1) this device may not cause harmful interference, and (2) this device must accept any interference received, including interference that may cause undesired operation.

This device has been tested and found to comply with the limits for a Class B digital device pursuant to Part 15 of the FCC rules. These limits are designed to provide reasonable protection against harmful interference in a residential installation. This device generates, uses, and can radiate radio frequency energy and, if not installed and used in accordance with the instructions, may cause harmful interference to radio communications. However, there is no guarantee that interference will not occur in a particular installation. If this device does cause harmful interference to radio or television reception, which can be determined by turning the device off and on, the user is encouraged to try to correct the interference by one or more of the following measures:

- Reorient or relocate the receiving antenna.
- Increase the separation between the device and receiver.
- Connect the device into an outlet on a circuit different from that to which the receiver is connected.
- Consult the dealer or an experienced radio/television technician for help.

Caution: Changes or modifications not expressly approved by the manufacturer could void the user authority, which is granted by the Federal Communications Commission, to operate this product.

FCC Radiation Exposure Statement:

This equipment complies with FCC radiation exposure limits set forth for a equipment should be installed and operated with minimum distance 20cm

WARRANTY & CUSTOMER SERVICE

Thank you for purchasing our product. We provide comprehensive after-sales service to ensure you have an excellent user experience. To safeguard your rights, please read the following warranty instructions carefully:

1. This product offers a one-year warranty service under non-human factors:
 - (1) Returns and Exchanges: Supported within one month of purchase.
 - (2) Free Repairs: Supported within one year of purchase.
2. The warranty does not cover:
 - (1) Damage caused by improper use or unauthorized disassembly of the product.
 - (2) Product malfunctions caused by repairs not authorized by our company.
 - (3) Damage or malfunctions caused by external forces or other human factors.

The warranty period starts from the date of purchase. Please provide proof of purchase when seeking repairs. If proof of purchase is unavailable, the warranty period will be calculated from the manufacturing date.

This product is applied for LOCAL WARRANTY ONLY (valid only in the country/region where you purchase this product), for any warranty services please contact your local dealers directly.

3. For repairs and related inquiries, please contact our service email:

support@szjttech.com



Made in China