

IC-Q3 25W产品说明书

尺寸：350*100mm 双面印刷 材质：128克铜版纸

User Manual

Wireless Car Charger

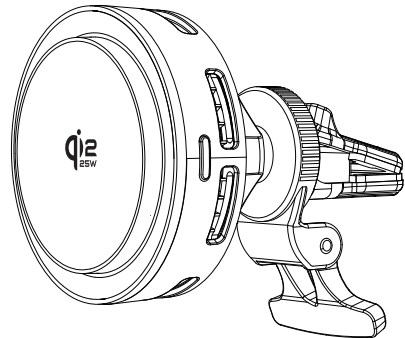

Model:IC-Q3 FCC ID:2AVSB-IC-Q3
Manufacturer:Shenzhen Mgcotech Co.,Ltd.

Product Features

- 1.Built-in strong magnets, easier for one-hand operation.
- 2.Built-in smart semiconductor chilling plate and cooling fan, the fan will start working when the wireless charging starts,the chilling plate cools the wireless charging coil and the phone surface simultaneously to improve the wireless charging efficiency. The semiconductor chilling plate stops working when the phone is removed.
- 3.Standby mode: The light with cycle memory function,the RGB light keeps on after running 3 laps,and the brightness is halved after 10 seconds of standby.
- 4.Charging mode: The ice blue light breathing.
- 5.FOD function: when put metal or magnet objects on the charger, the ice blue light flashes 6 times and the phone does not charge.
- 6.Perfect protective function based on over-voltage, over-current, over-temperature and short-circuit protection.

Product Operating Guide

1. Please make sure the product connect to the power before using.
2. The product stop charging when the current is too large or there is foreign object. Do not wireless charging the phone if similar situation happened.
3. Please purchase the wireless receiver module or case separately (Not included in the product) if your phone do not support wireless charging.
4. The power input is 15V, when placed the phone and wireless charging starts, the chilling plate works and the fan rotates. When the phone is removed, the chilling plate stops working and the fan stops rotating 30 seconds later.
5. It is recommended to use phone case less than 2mm thick. The product cools the phone backside surface,too thickness phone case will affect the cooling effect.

Product Parts Description

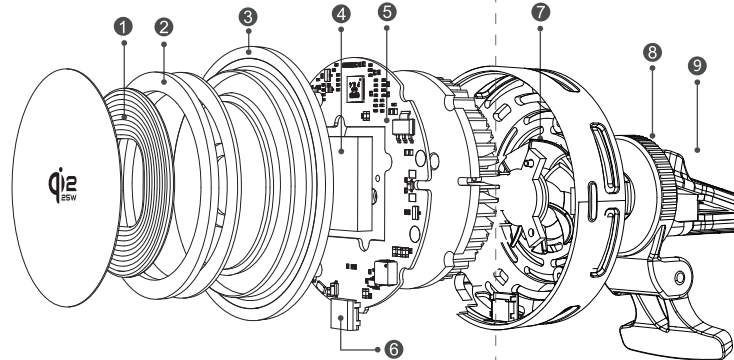

Parts List

1	Charging Transmitter Coil
2	Magnet
3	RGB Light
4	Electronic Refrigeration
5	PCB
6	Type-C Charging Port
7	Cooling Fan
8	Knob
9	Vent Clip

Specifications

Input	15V/3A
Output	25W Max
Product Standard	Qi2.2
Charging Distance	<3mm
Charging Efficiency	≤70%
Product Dimension	72*46*72mm
Product Material	ABS+Tempered Glass

Fast wireless charging requires PD45W or above adapter.

Attention

- 1.Please do not vigorously extrude or collide.
- 2.Please do not dismantle or put it into fire or water when the product is power on,to avoid short circuit or leakage.
- 3.Please do not use it in severely high temperature,high humidity or corrosive environment,to avoid damage to the circuit leakage.
- 4.Please do not put the magnetic strip or chip card (Such as ID card,bankcard etc.)on the charging pad to avoid to cause magneticcard lose efficacy.
- 5.Please do not put the metal (Such as coin etc.) on the charging pad when charging,to avoid damage from heating.

Note:This product is applicable to all Qi standard wireless charging phones,other phones need an external receiver for wireless charging function.

FCC Warning

This device complies with part 15 of the FCC Rules. Operation is subject to the following two conditions:(1) This device may not cause harmful interference, and (2) this device must accept any interference received, including interference that may cause undesired operation.Any Changes or modifications not expressly approved by the party responsible for compliance could void the user's authority to operate the equipment. This equipment has been tested and found to comply with the limits for a Class B digital device, pursuant to part 15 of the FCC Rules. These limits are designed to provide reasonable protection against harmful interference in a residential installation. This equipment generates uses and can radiate radio frequency energy and, if not installed and used in accordance with the instructions, may cause harmful interference to radio communications. However, there is no guarantee that interference will not occur in a particular installation. If this equipment does cause harmful interference to radio or television reception, which can be determined by turning the equipment off and on, the user is encouraged to try to correct the interference by one or more of the following measures:

- Reorient or relocate the receiving antenna.
- Increase the separation between the equipment and receiver.
- Connect the equipment into an outlet on a circuit different from that to which the receiver is connected.
- Consult the dealer or an experienced radio/TV technician for help.

FCC RF exposure statement:
The equipment complies with FCC radiation exposure limits set forth for an uncontrolled environment. This equipment should be installed and operated with minimum distance between 20cm the radiator your body.