

CRTT300

User Manual

Vinyl Record Player with Bluetooth® Speaker

Table of Contents

Safety Precautions	3
In The Box	3
Device Overview	4
Setting Up Your Device	5
Connecting via Bluetooth®	10
Connecting via AUX Cable	11
Connecting External Speakers via RCA Cable	12
Connecting Headphones	12
Need Help?	13
Warranty Information	14

Safety Precautions

THIS INSTRUCTION BOOKLET CONTAINS IMPORTANT SAFETY INFORMATION. PLEASE READ IT CAREFULLY AND KEEP FOR FUTURE REFERENCE.

- Do not place the device near water or in humid environments.
- Store the device in a cool, well-ventilated area and use it according to the manufacturer's instructions.
- Do not place the device near heat sources, such as radiators, stoves, etc.
- Do not pull the power cord carelessly or fold the wire.
- Please use the accessories provided by the manufacturer.
- Unplug from power when not in use.
- Call a professional if maintenance is required.
- Use the power supply as required.
- Do not use chemical cleaners on the surface of the wooden case, as this may cause damage. Use a clean, dry cloth instead.
- Unplug the device from power before moving to a different location.

In The Box

- Turntable x1
- AUX Cable x1
- DC 5V Charging Cable x1
- RCA Cable x1

Device Overview

TOP VIEW

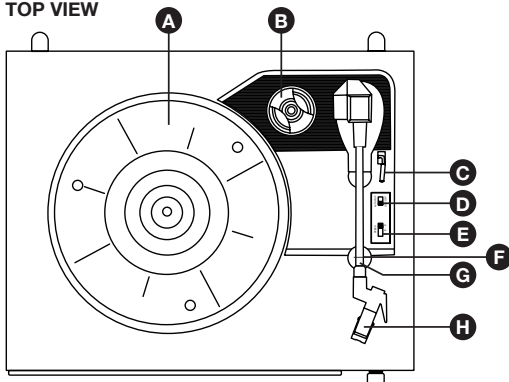

FRONT PANEL

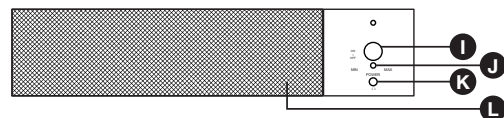

BACK PANEL

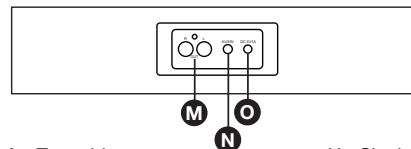

- A. Turntable
- B. Macroporous Disc Regulator
- C. Lifting Rod
- D. Automatic Stop Switch
- E. Record Speed Selection Switch (33/45/78 RPM)
- F. Singing Arm Latch
- G. Singing Arm

- H. Singing Head
- I. Power/Volume Switch
- J. Indicator Light
- K. Headphone Output
- L. Horn
- M. Audio Output
- N. Audio Input (AUX IN)
- O. DC 5V Power Supply

Setting Up Your Device

1. Using the included cable, connect the device to power via the DC 5V input **O** located on the back panel.

Note: This device requires a special 5V 1A power adapter. Using an adapter with different specifications may cause damage and will void the warranty.

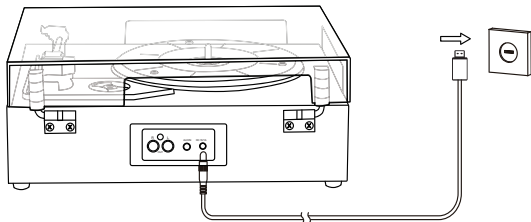

2. Place your record on the turntable **A**, then turn the Power/Volume Switch **I** clockwise. The Power Indicator Light **J** should turn on.

Note: An adapter (sold separately) is necessary when placing small records on the turntable.

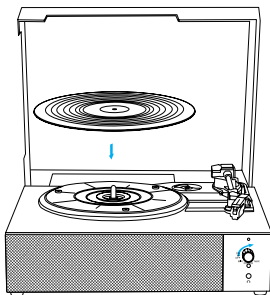

**Placing standard
records**

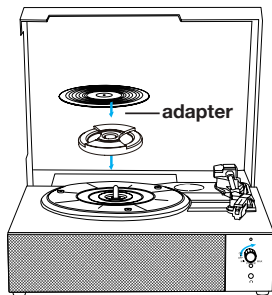

**Placing small records
using an adapter**

Setting Up Your Device

3. Unhook the Singing Arm Latch **F** as shown in the illustration below, then pull the Singing Head's protector forward to remove it.

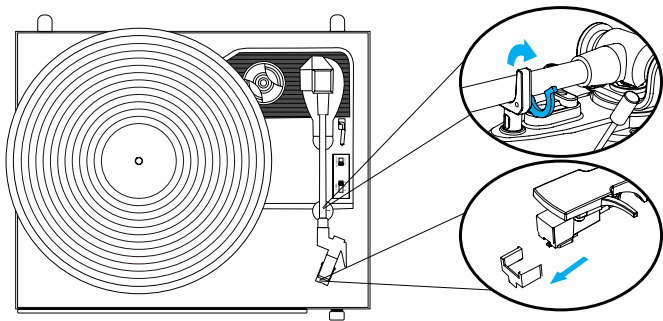

Setting Up Your Device

4. Position the Singing Arm **G** on top of the record, making sure the Lifting Rod Switch **C** is in the UP position before doing so. Then flip the Lifting Rod Switch DOWN to lower the Singing Arm to the record.

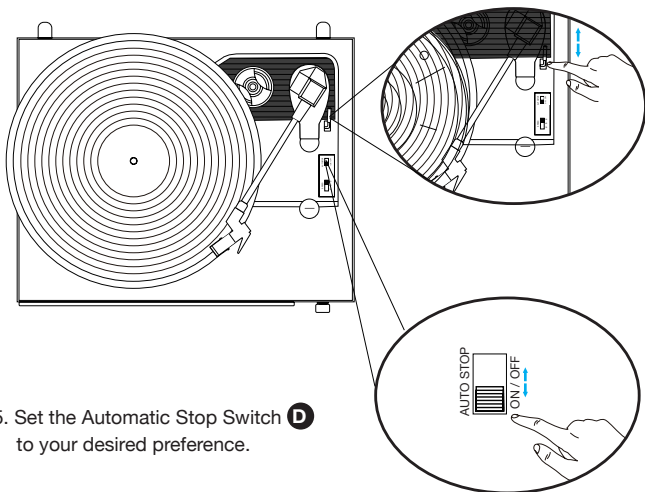

5. Set the Automatic Stop Switch **D** to your desired preference.

What is the Automatic Stop Switch Feature?

When set to ON, the automatic stop function will detect the end of the record and stop playback automatically. When set to OFF, the record will continue spinning after it ends, which can cause wear over time.

6. Set the Record Speed Selection Switch **E** to your desired speed (33/45/78 RPM).

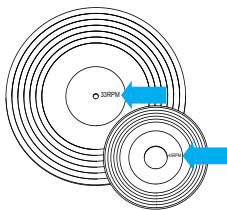
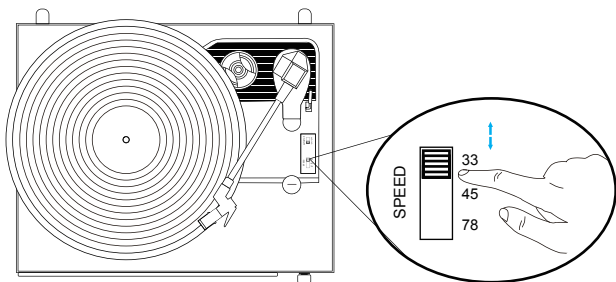

To determine the speed of a vinyl record:

Check the record label for the RPM (revolutions per minute) indication, which is usually printed near the center hole. If the label doesn't specify, 12-inch records are typically 33 $\frac{1}{3}$ RPM, while 7-inch singles are usually 45 RPM. For older records, you might find 78 RPM indicated.

Setting Up Your Device

7. After using the device, use the Lifting Rod **C** to remove the Singing Arm **G** from the record and back to its default position, then lock it into place using the Singing Arm Latch **F**.

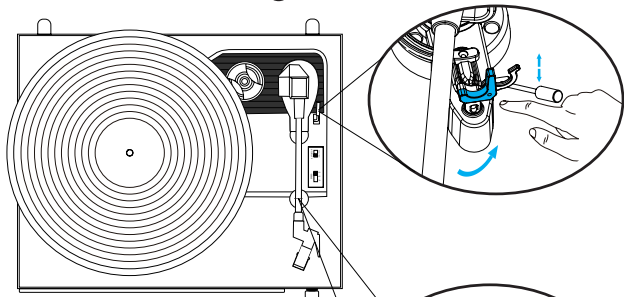

8. Turn the Power/Volume Switch **I** counterclockwise to turn the device off.

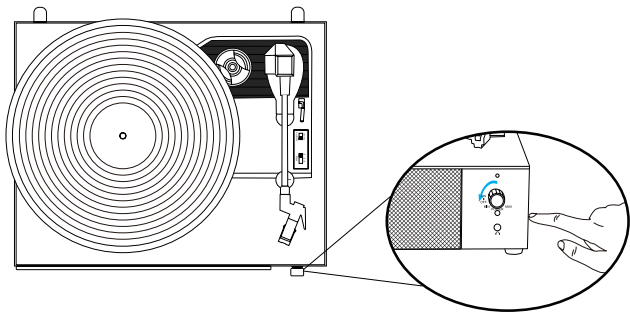

Connecting via Bluetooth®

1. Connect the record player to power.
2. Turn the Power/Volume switch clockwise to turn the turntable on. The indicator light will turn blue and flash rapidly. You will hear a sound from the turntable.
3. On your media device (MP3 player, tablet or smartphone), navigate to the Bluetooth® settings and connect to **"Core Turntable"** to pair the media device with the turntable.
4. Once your media device is successfully paired with the turntable, the turntable will play a brief confirmation sound and the blue indicator light will flash slowly.
5. Play music from your media device to the turntable. The indicator light will turn solid.

Note: When the turntable is in use, Bluetooth® is automatically disconnected, and playback will occur from the turntable.

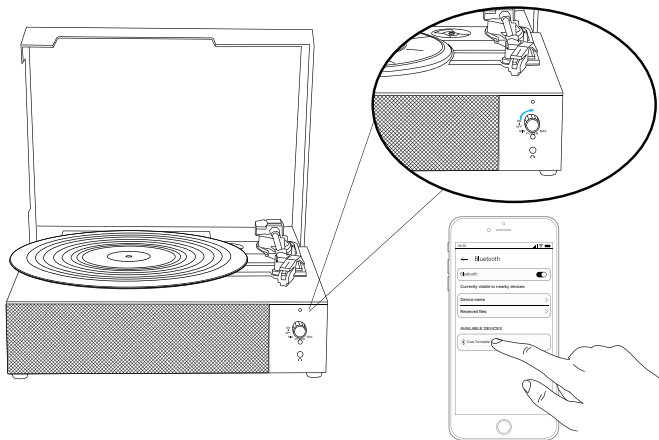

Connecting via AUX Cable

This turntable includes an auxiliary input jack for connecting external audio devices like MP3 players, CD players, smartphones, or tablets, so you can listen to your external source through the turntable's speakers.

1. Use the included AUX cable to connect your media device to the turntable via the AUX IN port located on the back panel.
2. Turn on your turntable by rotating the Power/Volume Switch clockwise. The indicator light of turntable will turn red.
4. The volume level can be controlled through the turntable. Operate all the functions on the auxiliary device as usual.

Note: The AUX function is a first-priority function. Even if the indicator light for Bluetooth® is on, the Bluetooth® function won't work while the AUX function is in use. Please unplug the AUX cable before using the Bluetooth® function.

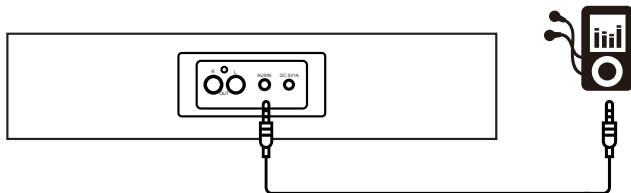

Connecting External Speakers via RCA Cable

Use an RCA cable to connect your turntable to external speakers using the R/L AUDIO OUT ports located on the back panel.

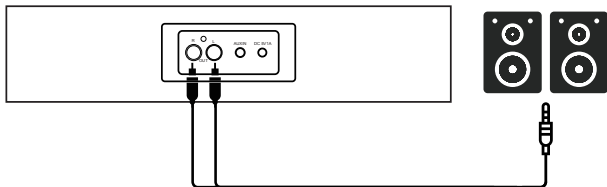

Connecting Headphones

You can connect headphones to the turntable via the Headphones Output port located on the front panel.

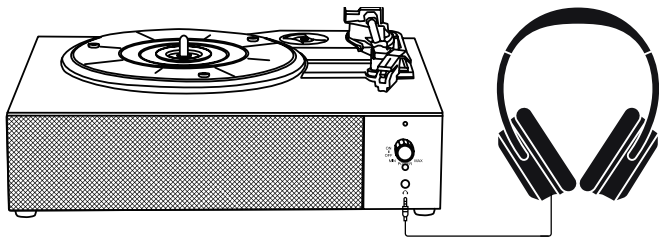

Need Help?

For customer support regarding your device, please submit a request by emailing **support@dpaudiovideo.zendesk.com**. You will be provided a ticket number regarding your inquiry, which you can refer to when contacting us further.

You may also reach a Core Innovations customer service representative by calling **1-833-909-CORE (1-833-909-2673)**. We are available Monday - Friday, 9am - 5pm PST, except major holidays. Core Innovations strongly urges customers to email their inquiry prior to calling, as this will enable us to better assist you.

Please make sure to note the model number and a description of your inquiry.

Thank you for purchasing a Core Innovations product.

Warranty Information

Limited Warranty

Core Innovations (the “Company”) warrants this new product purchased and contained in this package (the “Product”) against defects in material or workmanship for 90 Days (Parts & Labor) and 1 Year (Limited). In order for the Company to honor this limited warranty, you must present a valid proof of purchase (i.e. a receipt) of this Product. **IMPORTANT NOTE:** The customer is encouraged to carefully inspect the Product upon receipt after purchase – especially prior to any assembly, disassembly, mounting, installation or utilizing a third-party product of any kind, such as a decorative or protective cover or case.

This warranty is void if the Company deems, in its discretion, that the Product may have been damaged when the packaging was opened, through modification, improper transport, improper storage, improper use, improper assembly or disassembly, exposure to adverse elements, mounting or other installation, end user negligence, water damage or tampering of the barcode of the Product. This warranty does not apply: (a) to cosmetic damage, including but not limited to screen damage, a cracked display, scratches, dents and broken ports; (b) to damage caused by accident, abuse, misuse, fire, water vapor exposure, excessive exposure

Warranty Information (Continued)

to humidity, water or other liquid contact, earthquake or other external cause; (c) to defects caused by normal wear and tear or otherwise due to the normal aging of the product; (d) if any serial number has been removed or defaced from the product; or (e) to damage caused by installation or mounting, assembly or disassembly, use with a third party device, cable, protective or decorative cover/case, component or product that does not meet the Company's product specifications. This warranty is a limited warranty for repair of the Product or replacement of the Product with a new or refurbished product, subject to the conditions set forth herein.

The Company is not liable for consequential, indirect, incidental, special or punitive damages and the Company's total liability hereunder shall not exceed an amount greater than the retail purchase price of the product.

90 Days Parts & Labor

The Company warrants to you as the original retail purchaser of the Product, that should the Product have any warranted defect out of the packaging, under normal conditions, such defect(s) will be repaired or replaced with a new or refurbished part (at the Company's sole discretion) without charge, if the Product is submitted to the Company within a period of ninety (90) calendar days from the date of purchase of the Product. The customer is responsible for transportation cost and insurance charges (if applicable) to the Company and must be able to document a clear proof of delivery to the Company as well as proof of registered receipt by the Company. It is the customer's responsibility to retain original packaging or provide like packaging in order to facilitate the warranty repair or replacement process. The Company will incur no liability whatsoever to provide packaging for warranty items. Should the product be damaged en route to the Company due to insufficient or improper packaging or improper transport, the warranty may be voided. You must receive a return authorization number (RMA#) before sending the unit in for service. This warranty only applies to manufacturer defects, and the Product must be returned to the Company in its original condition.

1 Year Limited Parts

If determined to be covered under warranty, the one (1) year limited parts warranty gives the customer the option to return the Product to the Company for repair or replacement. The customer will be responsible for labor charges. This warranty does not cover any incidental or indirect costs incurred as a result of a defect in the Product, including any consequential, incidental or indirect damages.

FCC Statement

This device complies with part 15 of the FCC Rules. Operation is subject to the following two conditions:

(1) This device may not cause harmful interference, and (2) this device must accept any interference received, including interference that may cause undesired operation.

Any changes or modifications not expressly approved by the party responsible for compliance could void the user's authority to operate the equipment.

Note: This equipment has been tested and found to comply with the limits for a Class B digital device, pursuant to part 15 of the FCC Rules. These limits are designed to provide reasonable protection against harmful interference in a residential installation. This equipment generates, uses and can radiate radio frequency energy and, if not installed and used in accordance with the instructions, may cause harmful interference to radio communications. However, there is no guarantee that interference will not occur in a particular installation. If this equipment does cause harmful interference to radio or television reception, which can be determined by turning the equipment off and on, the user is encouraged to try to correct the interference by one or more of the following measures:

- Reorient or relocate the receiving antenna.
- Increase the separation between the equipment and receiver.
- Connect the equipment into an outlet on a circuit different from that to which the receiver is connected.
- Consult the dealer or an experienced radio/TV technician for help.

The device has been evaluated to meet general RF exposure requirement. The device can be used in portable exposure condition without restriction.





Core Innovations intends to make this manual accurate and complete. However, Core Innovations makes no claim that the information contained herein covers all details and conditions. The information in this document is subject to change without notice at any time. Core Innovations assumes no responsibility for accuracy or completeness of the information contained in this manual.