

Welcome to LucereLight™

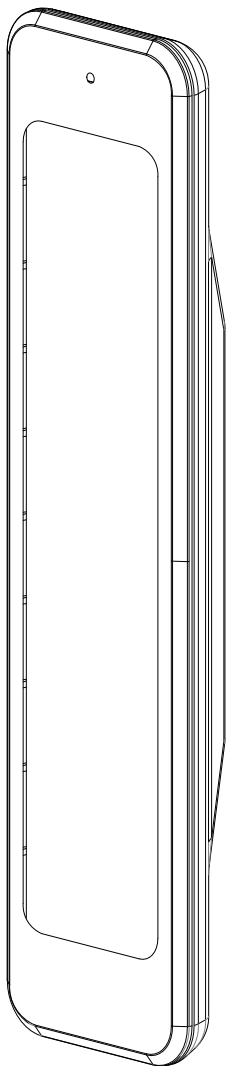

LUCERE 

WHAT'S IN THE BOX

LUCERE LIGHTS (2)
SILICONE BASES (2)
PLASTIC PLATES (2)
USB CHARGER
USB CHARGING CABLES (2)
DOUBLE-SIDED TAPE (4)
USER MANUAL
ONE-YEAR WARRANTY

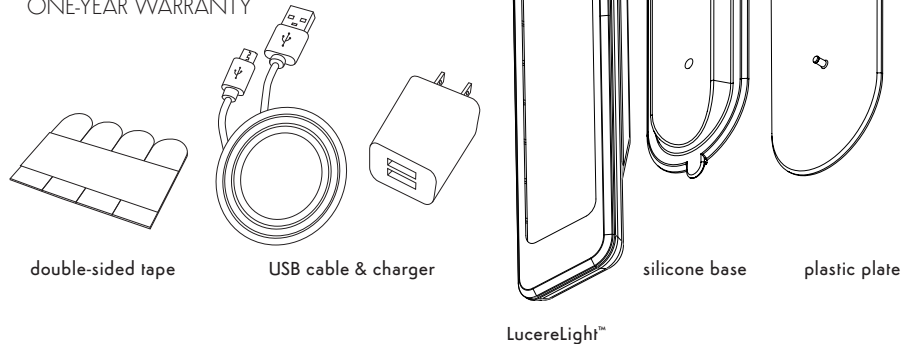

OVERVIEW

Most mirrors do not have adequate lighting. By attaching LucereLight™ to your mirror you will have the best natural lighting when you need it, wherever you need it.

Lighting engineers and optical experts have designed LucereLight to illuminate your face perfectly. LucereLight can be placed at the height of your choosing and can be moved easily for recharging and/or traveling. The light can be dimmed to find the lighting level best suited for you.

LucereLight is available in Icy Blue, Dusty Rose and Metallic Silver.

FEATURES

Note: The power-saving ON/OFF switch located at the back of the light should be turned to the ON/GREEN position for the operation of LucereLight.

ON-OFF BUTTON

To turn the lights on or off press the LucereLight logo light icon on the bottom of the light between the + and — icons. Pressing the + or — icons will also turn on the light.

BRIGHTNESS CONTROL

Adjust brightness by gently tapping the + or — brightness control icons on the bottom of the light. You can also press and hold, and the brightness will ramp in the direction associated with the icon.

NOTE: FOR BEST RESULTS, LEAVE ALL LIGHTS ON IN THE BATHROOM WHEN USING THE LUCERELIGHT.

INDICATOR LIGHTS

The two LucereLights have built-in radio communications, so that when you press the icons on one light to change illumination, the other light will automatically correspond.

An indicator at the top of the light informs you of battery status:

Red (Blink) — battery low, charging required

Yellow — charging

Green — charging complete

POWER SAVER SWITCH

The power-saving ON/OFF slide switch is located on the back of the light. Fully charged, LucereLight has power for continuous operation for one hour at maximum brightness.

In power-save mode the switch disables power consumption and all functions (except charging) so that the unit can be stored or left unattended for a long period and cannot turn on accidentally when packed in luggage or carried in a purse. This ensures the light is ready with a full battery when you need it.

This switch also disables the internal radio transmitter so that it does not cause interference to aircraft systems and meets all Federal Aviation rules.

NOTE: The light constantly uses a small amount of electricity to power the icon sensors and radio receiver.

BEFORE ATTACHING

To ensure correct adhesion, make sure the mirror or glass is totally clean before attaching the silicone base or permanent mount. Also, ensure the back surface of the silicone base is clean. If any dust or lint is on it, rinse under warm water and shake dry or use a lint free microfiber cloth.

ATTACHING

These are the simple steps to attaching LucereLight to your bathroom mirror.

(Click on link xxxx to see instructional on youtube.com)

1. ATTACHING TWO LIGHTS (see illustration)

For optimum effective lighting, LucereLight has been designed for use in pairs. Choose placement of the silicone bases and the lights vertically on the mirror on either side of your face to give maximum illumination.



First, mount the lights by firmly pressing the silicone bases on to the mirror. Then, simply take the lights and place them on to the silicone bases. The LucereLight has a built-in magnet that attracts to a piece of steel inside the silicone base. The curved shape of the mount allows you to easily adjust the angle of the light for optimum illumination.

NOTE: After each use it is recommended to remove LucereLights from the silicone bases in order to protect them. If you are traveling or want the lights in a different location, you simply peel off the silicone bases from the mirror and re-attach the silicone bases to any clean glass surface as described above.

2. ATTACHING ONE LIGHT (see illustration)

If you choose to use only one LucereLight, you may want to place it horizontally on the mirror above your face, or vertically opposite your face and move from side to side to get maximum illumination on both sides of your face. (Follow mounting instructions above)

3. FOR LONG TERM ATTACHMENT (see illustration)

For long term attachment use the enclosed removable two-sided tape and attach the plastic plate(s) directly to your mirror where you desire to have the light(s) on a long-term basis.

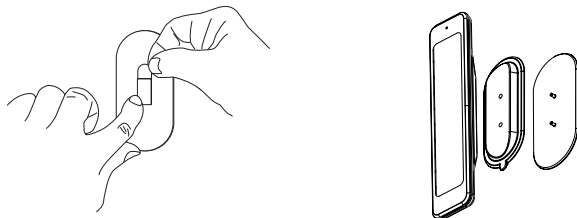

Press the silicone base(s) firmly on to the plastic plate(s). Press all around the periphery. The two holes on the silicone base fit on to the two prongs on the plastic plate. The silicone base is designed to cling to the plastic plate and will stay there permanently until peeled off. (See above instructions for placement of LucereLights for maximum illumination)

PAIRING SINGLE LIGHTS

If you already own a set of LucereLights, or a single light, and want to add lights to your collection, then you can purchase as many lights as you want.

Each LucereLight has the ability to pair radio communication with each other.

Follow these simple steps.

1. Ensure both units are NOT in airplane mode (check that the switch on the back indicates green, not red)
2. On one of the units, simultaneously press and hold the power button and then, increase brightness icon.
3. After about 5 seconds the indicator LED will start to blink green.
4. On the other unit, press and hold the power button and then decrease brightness icon.
5. After about 5 seconds the indicator LED will start to blink red.
6. After a few red blinks it should flash green once and stop. The first blinking green unit will continue to blink.
7. Press any button on the unit with the blinking green LED to make it stop.
8. The units should now be paired. Any input on one unit should also affect the other one.

It's now ready for use.

TAKING CARE OF LUCERELIGHT

MAINTENANCE

To ensure maximum adhesion, make sure the mirror or glass is totally clean before attaching the silicone bases or plastic plates. We recommend not touching the adhesion surface of the silicone bases.

In order to avoid dust & particles in the silicone bases, only remove when wanting to travel with the LucereLight

When traveling with two LucereLights, it is a good idea to attach the two silicone bases to the plastic plates, back-to-back, to keep clean and protect the adhesion surfaces.

It is important that the silicone bases not be thrown loose into luggage among clothing, to avoid getting lint on the silicone mounting surface.

If using original packaging as a travel box, place LucereLights and accessories as originally positioned in the box.

If you wish to move the plastic plates to a different location, remove them carefully from mirror and re-attach with fresh two-sided tape.

If not using original packaging as a travel box, then be sure to wrap lights in a cloth or towel to avoid scratches or damage.

RECHARGING

Remove LucereLights from silicone bases for charging. The charging cords can make them fall from the silicone mounts. The mounts only support the lamps themselves.

The charger supplied is for 110-240 volt input. Recharging takes between 1 and 2 hours.

When the switch is in **ON** position the lithium ion battery will stay charged for 1 month.

When switch is in **OFF** position the battery will stay charged for 6 months.

SAFETY

CAUTION: The light is not tolerant of immersion in water. **Do not** drop in a bathtub or toilet! **Do not** hold under running water. **Do not** use in a shower. **Do not** allow to be exposed to rain or snow.

Do not drop on hard surfaces.

Do not use USB cable if frayed or torn.

LucereLight is safe for air travel. Its lithium battery meets all Aviation Guidelines.

When traveling by air, turn the power saver switch to the **OFF** position.

IMPORTANT SAFETY INSTRUCTIONS

WARNING: To reduce the risk of FIRE, ELECTRIC SHOCK OR INJURY TO PERSONS:

1. Never use the Lucere Light if the lamp housing is damaged, broken or missing.
2. Heed all warnings.
3. Do not look directly at lighted lamp.
4. If the lamp, power supply cord or cord has been damaged in any way, liquid has spilled or objects have fallen into the lamp, the lamp has been exposed to rain or moisture, does not operate normally or has been dropped or damaged, it should not be operated.
5. Read this user manual carefully before you use the Lucere Light and save it for future reference.
6. Water and electricity are a dangerous combination. Be careful not to let the Lucere Light get wet, whether charging or not.
7. Make sure the adapter does not get wet.
8. Do not immerse in water or rinse under the tap.
9. Only use the original adapter. If the adapter is damaged, do not use.
10. This appliance is for indoor use only.
11. Protect the power cord from being walked on or pinched, particularly at plugs, outlet and point where they exit from lamp.

* SAVE THESE INSTRUCTIONS *

FCC REGULATORY STATEMENTS

This device complies with Part 15 of the FCC Rules. Operation is subject to the following two conditions:

(1) This device may not cause harmful interference.

(2) This device must accept any interference received, including interference that may cause undesired operation.

This equipment has been tested and found to comply with the limits for a Class B digital device, pursuant to part 15 of the Federal Communication Commission (FCC) rules. These limits are designed to provide reasonable protection against harmful interference in a residential installation. This equipment generates, uses and can radiate radio frequency energy and, if not installed and used in accordance with the instructions, may cause harmful interference to radio communications. However, there is no guarantee that interference will not occur in a particular installation. If this equipment causes harmful interference to radio or television reception, which can be determined by turning the equipment off and on, the user is encouraged to try to correct the interference by doing one or more of the following measures:

- Reorient or relocate the receiving antenna.
- Increase the separation between the equipment and receiver.
- Connect the equipment into an outlet on a circuit different from that to which the receiver is connected.
- Consult the dealer or an experienced radio/TV technician for help.

NOTE: THE GRANTEE IS NOT RESPONSIBLE FOR ANY CHANGES OR MODIFICATIONS NOT EXPRESSLY APPROVED BY THE PARTY RESPONSIBLE FOR COMPLIANCE. SUCH MODIFICATIONS COULD VOID THE USER'S AUTHORITY TO OPERATE THE EQUIPMENT.

RF EXPOSURE WARNING

This equipment complies with FCC radiation exposure limits set forth for an uncontrolled environment. In order to avoid the possibility of exceeding the FCC radio frequency exposure limits, human proximity to the antenna shall not be less than 20 cm during normal operation and must not be co-located or operating in conjunction with any other antenna or transmitter.

ISED REGULATORY STATEMENTS

This device complies with ISED Canada license-exempt RSS standard(s).
Operation is subject to the following two conditions:

(1) this device may not cause interference, and (2) this device must accept any interference, including interference that may cause undesired operation of the device.

Le présent appareil est conforme avec ISED Canada applicables aux appareils radio exempts de licence. L'exploitation est autorisée aux deux conditions suivantes: (1) l'appareil ne doit pas produire de brouillage, et (2) l'utilisateur de l'appareil doit accepter tout brouillage radioélectrique subi, même si le brouillage est susceptible d'en compromettre le fonctionnement.

CAN ICES-3 (B)/NMB-3(B)

RF EXPOSURE INFORMATION

This equipment complies with ISED RSS-102 radiation exposure limits set forth for an uncontrolled environment. This transmitter must be installed to provide a separation distance of at least 20 cm from all persons and must not be co-located or operating in conjunction with any other antenna or transmitter.

Cet équipement est conforme avec ISED RSS-102 des limites d'exposition aux rayonnements définies pour un environnement non contrôlé. Cet émetteur doit être installé à au moins 20 cm de toute personne et ne doit pas être colocalisé ou fonctionner en association avec une autre antenne ou émetteur.

For inquiries or information:
639 Dupont St, Suite 155
Toronto ON M6G 1Z4
www.lucereinc.com
info@lucereinc.com

FC CE IC 25878-NOMAD