

TROUBLE SHOOTING

IMPORTANT - DO NOT RETURN PRODUCT

We're here to help!

Call us @ 800.336.7745

Monday thru Friday between 8:00 am - 5:00 pm (pacific)

IMPORTANT:

1. Works best on flat, level, hard surfaces.
2. This product is not recommended for use on shag carpet, loose dirt, or wet surfaces.

QUICK TIPS:

1. When your vehicle starts to lose power, it may lose functionality or performance. It's time to recharge the vehicle's LiPo battery. Your vehicle's running time varies depending on your driving style.
2. Interference can affect your vehicle's performance. Interference can be caused by other I/R devices like a TV remote control or other remotes in the house. Try to stay away from these!
3. Don't drive your vehicle in sand or through water or snow. If your vehicle does get wet, wipe it with a towel and allow to dry completely overnight.
4. Don't store your vehicle near heat or in direct sunlight. Always turn switches to OFF and remove all batteries for storage.
5. Do not exceed the specified range.
6. If the vehicle malfunctions, please turn the vehicles and controllers power OFF and ON again. This should reset your vehicle and let you resume normal operation.
7. If Racers are not charging enough to hit top speeds, then replace the AAA batteries in the controllers to ensure adequate vehicle charging.

Keep these instructions for future reference as they contain important information.

IMPORTANT: Please read all instructions before operating your vehicle.

CAUTION: To prevent entanglement, keep all hair away from the wheels.

DO NOT RECHARGE THE CAR IF IT FEELS HOT. ALLOW IT TO COOL BEFORE RECHARGING.

DO NOT ATTEMPT TO USE OR CHARGE THE CAR IF IT SHOWS SIGNS OF LEAKAGE OR CORROSION.

Warranty: Your purchase of RC Knuckle-Headz comes with a one-year limited warranty in the US and Canada. The warranty covers against manufacturing defects. It does not cover abuse, alteration, theft, loss, unreasonable use, or normal "wear and tear". Skullduggery will determine a defect at its sole discretion, will repair or replace the defective part or product with a comparable part. This does not affect your statutory rights.

Skulduggery guarantees your 100% satisfaction with this product. If you have any issues that are not addressed in this instruction booklet, please call us at **800.336.7745**.

Remote control requires

4 AAA batteries (Not included)

For longer life use alkaline batteries

Car includes 1 replaceable LiPo battery

Conforms to ASTM F963

For ages 5 and up

Manufactured by Skullduggery, Inc.

Made in China

CUSTOMER INFORMATION

Skulduggery, Inc. • 5433 East La Palma Ave. • Anaheim, CA 92807
We guarantee the quality of all Skullduggery products. If this product does not perform properly, please contact us. In the USA call (800) 336-7745 M-F 8AM - 4PM Pacific time. International call (714) 777-6425. www.sdtoyz.com © 2019 Skullduggery, Inc.
Knuckle-Headz is a trademark of Skullduggery, Inc.
Patent Pending.

Conforms to ASTM F963
Non-Toxic, Ages 5 & up
patent pending



Includes:

- 1 - RC Car
- 1 - Head
- 1 - Remote control
- 4 - Racing cones
- 1 - USB charging cord



RC RACERS

2.4 GHZ
MULTI-CHANNEL
LONG LIFE BATTERY



POP!



INSTRUCTION MANUAL

Item # 08110

GAME PLAY:

1. Jousting - Set up your battlefield boundaries with the orange cones. Place your cars at each end of the battlefield. See who can knock the other cars heads off without losing its own. The last car with its head on wins the match.

2. Racing - Set up the cones to design your race track. All cars start at the starting line. Race around the cones without losing your head. If you lose your head before you reach the finish line, it is an automatic forfeit. Cross the finish line and be the first to knock your own head off to win.

IMPORTANT

GENERAL BATTERY INFORMATION

Read and follow operating instructions.

1. Do not mix old and new batteries.
2. Do not mix alkaline, standard (carbon-zinc), or rechargeable (Nickel-cadmium) batteries.
3. Only batteries of the same or equivalent type as recommended are to be used.
4. Batteries are to be inserted with the correct polarity.
5. Exhausted batteries are to be removed from the product.
6. The supply terminals are not to be short-circuited.
7. Non-rechargeable batteries are not to be recharged.
8. Rechargeable batteries are to be removed from the product before being charged (if removable)
9. Rechargeable batteries are only to be charged under adult supervision.
10. Dispose of batteries safely.
11. Do not dispose of this product in a fire. The batteries inside may explode or leak.
12. Batteries should be changed by adults only.

CAUTION: Changes or modifications to this unit not expressly approved by the party responsible for compliance could void the user's authority to operate the equipment.

NOTE: This equipment has been tested and found to comply with the limits for a Class B digital device, pursuant to Part 15 of the FCC Rules. These limits are designed to provide reasonable protection against harmful interference in a residential installation. This equipment generates, uses and can radiate radio frequency energy and, if not installed and used in accordance with the instructions, may cause harmful interference to radio communications. However, there is no guarantee that interference will not occur in a particular installation. If this equipment does cause harmful interference to radio or television reception, which can be determined by turning the equipment off and on, the user is encouraged to try to correct the interference by one or more of the following measures:

- Reorient or relocate the receiving antenna.
 - Increase the separation between the equipment and receiver.
 - Connect the equipment into an outlet on a circuit different from that to which the receiver is connected.
 - Consult the dealer or an experienced radio/TV technician for help.
- **This device and its antenna must not be co-located or operating in conjunction with any other antenna or transmitter.

This Class B digital apparatus complies with Canadian ICES-003. Conforms to ASTM F963 standard. Contents and color may vary slightly from these shown. Please retain packaging for future reference. Cet appareil numérique de la classe B est conforme à la norme NMB-003 du Canada. This device complies with Part 15 of the FCC Rules. Operation is subject to the following two conditions (1) this device may not cause harmful interference, and (2) this device must accept any interference received, including interference that may cause undesired operation.

This device meets the government's requirements for exposure to radio waves. This device is designed and manufactured not to exceed the emission limits for exposure to radio frequency (RF) energy set by the Federal Communications Commission of the U.S. Government.

IC statement

This device complies with RSS210 of Industry Canada. Cet appareil se conforme à RSS210 de Canada d'Industrie. This device complies with Industry Canada license-exempt RSS standard(s). Operation is subject to the following two conditions: (1) this device may not cause interference, and (2) this device must accept any interference, including interference that may cause undesired operation of the device. appareils radio exempts de licence. Son fonctionnement est sujet aux deux conditions suivantes: (1) le dispositif ne doit pas produire de brouillage préjudiciable, et (2) ce dispositif doit accepter tout brouillage reçu, y compris un brouillage susceptible de provoquer un fonctionnement indésirable. The device must not be co-located or operating in conjunction with any other antenna or transmitter.

You can purchase replacement batteries at (800) 336-7745 or at sdtoyz.com/rcknuckleheadz/replacementbatteries

BATTERY INSTALLATION

STEP A

1. Unscrew battery door on handle
2. Remove battery door from handle

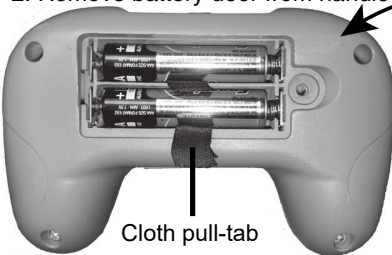

Cloth pull-tab

- REQUIRES 4 AAA BATTERIES

- Do not mix old and new batteries
- Do not mix alkaline, standard (carbon-zinc) or rechargeable (nickel-cadmium) batteries.

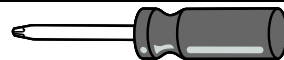

Phillips head screwdriver

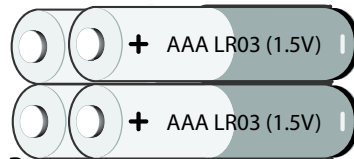

STEP B

1. Insert batteries as shown in diagram.
3. Make sure the cloth pull-tab is inserted under the batteries for easy removal.
2. Replace battery door on handle.

CHARGING / PAIRING INSTRUCTIONS

There are 2 ways to charge your RC Knuckle-Headz

1. Use USB Charger to charge your car. Turn car OFF and plug car into USB charger. Charge car for about 25 minutes. The light on the bottom the car will turn red while charging and will turn green when fully charged.
2. Use plug inside controller. Turn car OFF and controller to OFF to charge. Charge car for about 25 minutes. The light on the bottom the car will turn red while charging and will turn green when fully charged.
3. When fully charged, remove the USB charger or the plug inside controller from the car. TIP: Always hold the plug when disconnecting. Never pull the cable to disconnect; this may cause the cable to break.



TIP:

It is best to use USB charging cord as your AAA batteries will last longer.



Charging Cord

Pairing:

1. Turn controller to on. The red light on the controller will flash red.
2. Turn car to on. The red light on bottom of car will flash red.
3. When both lights turn off the car and controller are paired and ready for use.
4. When storing your Knuckle-Headz RC make sure to fully charge your car and then turn the controller and the car to the off positions. This will help the batteries last longer.

CONTROLLER INSTRUCTIONS

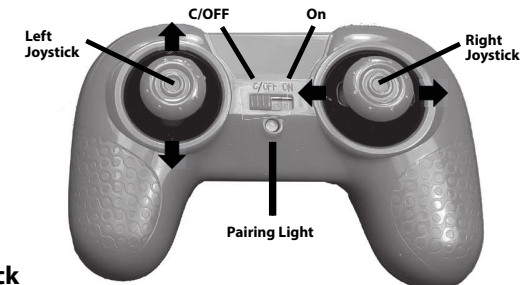

Left Joystick

- ↑ = Forward
- ↓ = Backward

Right Joystick

- ← = Gradual Left Turn
- = Gradual Right Turn

Left + Right Joystick

- ↑ + ← = Forward Sharp Left Turn
- ↑ + → = Forward Sharp Right Turn
- ↓ + ← = Backward Sharp Left Turn
- ↓ + → = Backward Sharp Right Turn

TIP: If car is not working, turn both car and controller to OFF for 5 seconds and then turn both car and controller to ON.