

User guide

c@nnect

In the box

- (A) Gateway
- (B) Antenna
- (C) USB-C cable
- (D) Power supply
- (E) Suction cup
- (F) Wall piece

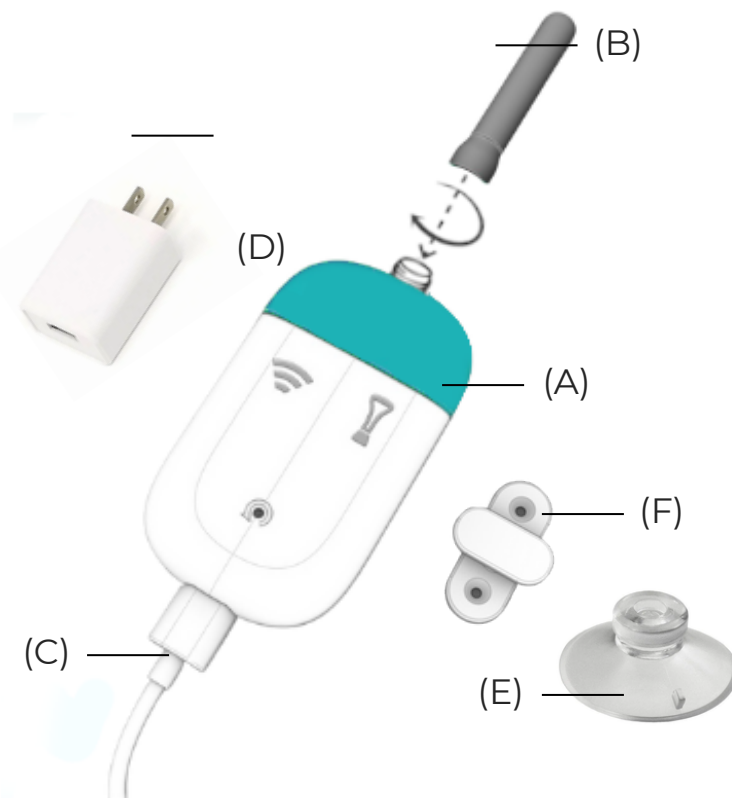

Getting started

Prerequisites: you must have an EcO probe already connected to the iopool app.

1. Take out the gateway from its package and attach the external antenna as shown

Note : *DO NOT connect to any power supply before installing the antenna*

2. Connect the gateway with the power supply near your pool or spa (<15 feet). The area must be covered by your Wi-Fi network.

3. Click on *My pool* or *My spa*. Click on *Devices*. Click on *Gateway*. Click on *Link an iopool gateway*. Follow the instructions in the app. For more information, contact us at hello@iopool.com.

LED and behaviour



Blink red : Not connected to Access Point
Fixed red : Connected to AP. No internet
Fixed green : Connected to the Internet
Blink green : OTA in progress

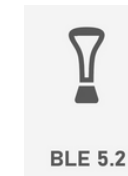

Blink blue : EcO out of range
Fixed blue : EcO in range
Blink green : OTA in progress

Reset button : Press the button for 5 seconds until you hear a double-beep. The gateway will re-start shortly after.

Warranty

- Use a 5V/1A power adapter with a standard USB interface
- This gateway must be placed and used indoors.
- Any damage to the gateway caused by not following the instructions will render the warranty null and void.
- Any damage to the gateway caused by modifying the PCBA, components, or case will render the warranty null and void.
- Any damage to the gateway caused by product misuse shall not be covered by the warranty, including but not limited to improper voltage, operating in high-temperature environments, water damage, or fall damage.
- Operating Temperature: 0-40 °C, Storage Temperature: -20-70 °C

FCC ID: 2AVNQGTV-V3

This device complies with Part 15 of the FCC Rules. Operation is subject to the following two conditions: (1) this device may not cause harmful interference, and (2) this device must accept any interference received, including interference that may cause undesired operation.

Warning: Changes or modifications to this unit not expressly approved by the party responsible for compliance could void the user's authority to operate the equipment.

NOTE: This equipment has been tested and found to comply with the limits for a Class B digital device, pursuant to Part 15 of the FCC Rules. These limits are designed to provide reasonable protection against harmful interference in a residential installation. This equipment generates, uses and can radiate radio frequency energy and, if not installed and used in accordance with the instructions, may cause harmful interference to radio communications.

However, there is no guarantee that interference will not occur in a particular installation. If this equipment does cause harmful interference to radio or television reception, which can be determined by turning the equipment off and on, the user is encouraged to try to correct the interference by one or more of the following measures:

- Reorient or relocate the receiving antenna.
- Increase the separation between the equipment and receiver.
- Connect the equipment into an outlet on a circuit different from that to which the receiver is connected.
- Consult the dealer or an experienced radio/TV technician for help.