

① **Press and hold for 2 Seconds** with Remote controller(push button) until it

show 1 LED lights (Low heat).

② Tap ( **click once**) click or push the push button to select your desired temperature

③ **Press and hold** the push button on the remote controller for **2 seconds**  
the Indicator lights will turn off.

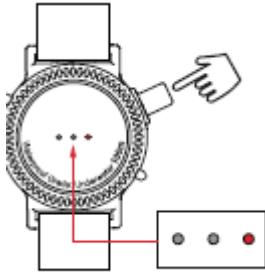

1. Check remote controller battery level:

① Click the push button on the remote controller.

② The indicator light will flash briefly to indicate remaining charge:

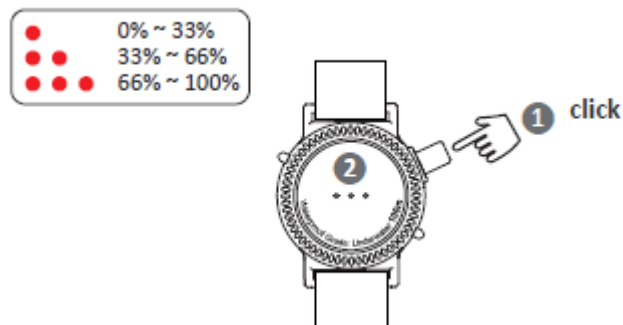

2. Charging your **wristband remote controller**

① Push wristband remote controller onto charging stand.

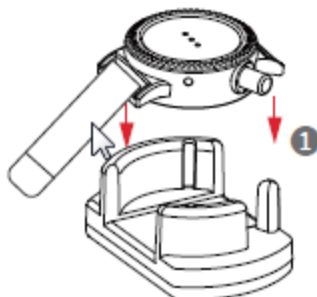

② Connect with USB charging cable.

③ Connect USB charging cable to an adaptor, and plug into a power outlet.

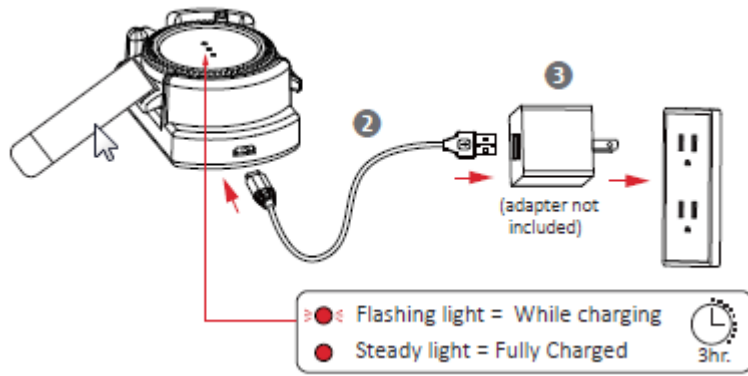

1. When the remote control charge reaches 30%, one of the LEDs will stop flashing (the other two LEDs flash alternately.)
2. When the remote control charge reaches 60%, the two LEDs stop flashing (one LED will remain flashing.)

Caution: The user is cautioned that changes or modifications not expressly approved by the party responsible for compliance could void the user's authority to operate the equipment.

This device complies with Part 15 of the FCC Rules. Operation is subject to the following two conditions: (1) this device may not cause harmful interference, and (2) this device must accept any interference received, including interference that may cause undesired operation.

NOTE: This equipment has been tested and found to comply with the limits for a Class B digital device, pursuant to Part 15 of the FCC Rules. These limits are designed to provide reasonable protection against harmful interference in a residential installation. This equipment generates, uses and can radiate radio frequency energy and, if not installed and used in accordance with the instructions, may cause harmful interference to radio communications. However, there is no guarantee that interference will not occur in a particular installation.

If this equipment does cause harmful interference to radio or television reception, which can be determined by turning the equipment off and on, the user is encouraged to try to correct the interference by one or more of the following measures:

- Reorient or relocate the receiving antenna.
- Increase the separation between the equipment and receiver.
- Connect the equipment into an outlet on a circuit different from that to which the receiver is connected.
- Consult the dealer or an experienced radio/TV technician for help.