

USER MANUAL

BerryBak™



BDC-U

Bluetooth Decoder for Car with USB

Packaging Content

The following items should be placed in the box according to the model you purchased. If there is any missing, please inform the seller or manufacturer as soon as possible.

1



BDC-U Unit

2

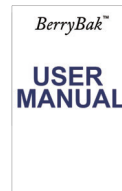

User Manual

3



Bluetooth Antennas

4



Power Cable

5



Optical Cable

Front and Rear Panels

Analog Output

Allows to connect BDC-U to audio devices that have analog inputs.

USB Type-C Data Codec

Allows for digital audio data to be received via USB.

Bluetooth

Unpairing Button

Allow users to easily disconnect the Bluetooth connection with any paired devices.

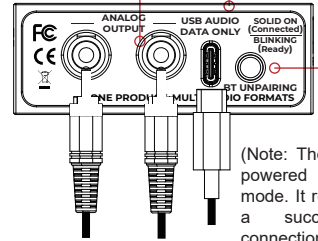

Bluetooth Antenna

Enables BDC-U to send and receive wireless Bluetooth signal.

USB Type-C Power Input

Powered up by using USB Type-C Power Adapter.

Micro-Fit 2x2 CKT Power Input

With Micro-Fit 2x2 CKT cable to power up the BDC-U. The black wire is connected directly to the metal chassis ground. The yellow wire is connected to the positive terminal of the battery while the red wire is connected to the music player of the car.

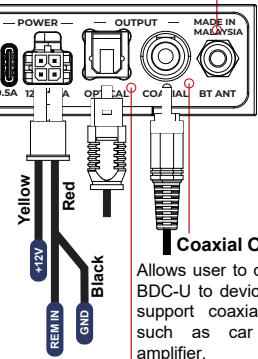

Coaxial Output

Allows user to connect BDC-U to devices that support coaxial input such as car audio amplifier.

Optical Output

Transmits audio via fiber optic cable, connecting the BDC-U to devices with an optical input, like a car audio amplifier.

BDC-U
USER MANUAL

Power Supply

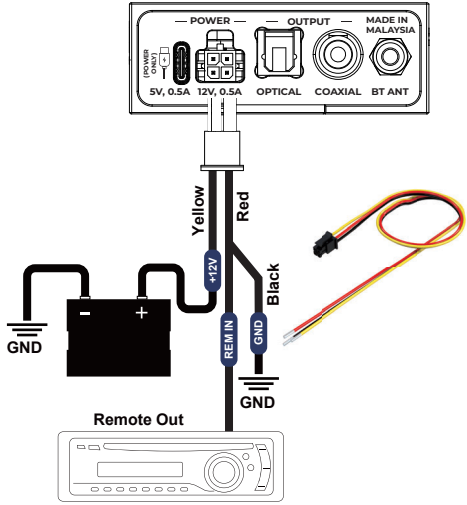

Power Cable Layout for BDC-U

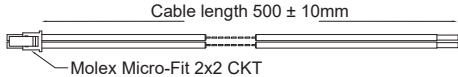

	Typical Wire Colors	Wires Color Code	Functions	AWG (min)
	Red	Red	Remote In	20
	Yellow	Yellow	+12V	
	Black	Black	Ground	

BDC-U

USER MANUAL

Connect Bluetooth to iOS/Android

1. The LED blinks when BDC-U is powered on.
2. Open the settings app on iOS or Android device.
3. Navigate to the 'Connections' option in Android or 'Bluetooth' in iOS device.
4. Enable the 'Bluetooth' option and begin to search for 'BerryBak BDC-U' to begin pairing.
5. The blue LED will light up when pairing is succesful.

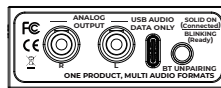

Technical Specifications

Brand	BerryBak
External Power	USB Type-C (5V, 0.5A) & Micro-Fit 2x2 CKT (12V,0.5A)
Input Interface	Bluetooth v5.3 & USB Audio UAC 2.0
Output Interface	RCA (Output Level 2V RMS); Optical / Coaxial (48kHz or 96kHz Related to Audio Encoder)
Power Consumption	0.48W(Bluetooth connected, output start at -8dB) (Bluetooth disconnected, output start at 0dB)
Bluetooth Specification	LDAC, aptX-Lossless, aptX-HD, SBC, AAC, aptX
Size	96.0 x 66.0 x 24.5mm (Not included the antenna and RCA connectors)
Gross Weight	248g (Including the antenna)

BDC-U

USER MANUAL

Installation

External Dimension (mm)

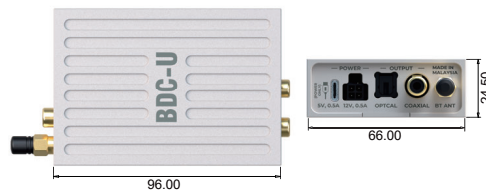

Mounting Size (mm)

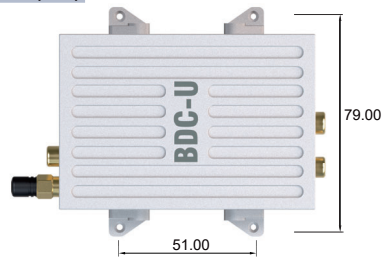

How to Mount



Note: The brackets are necessary for mounting the unit in a desktop application, ensuring it can be installed and function effectively in various setups. Please note that the brackets and screws are not included in the package.

Troubleshooting

Issue	Possible Solutions
The BDC-U work normally under Bluetooth mode, but it cannot work as USB codec and not be able to establish data connection with your phone.	Make sure that the USB cable used is equipped with Data Communication function. Under this circumstances, turn around the USB Type-C connect 180° and try again.
The BDC-U cannot be recognised as USB codec after connect to your phone.	Power Off/On again.
Music playback is interrupted intermittently, and the connection is unstable.	<p>Please check the Bluetooth antenna to ensure it is tightened securely.</p> <p>Check if the BDC-U is within the recommended range of your devices. Maintaining a distance of around 33ft(10m) is generally recommended.</p> <p>Move closer to the Bluetooth unit if you experience sound distortion or interruptions.</p> <p>Additionally, inspect the area around the Bluetooth unit for any substances that may be blocking the Bluetooth signal. Clear away any obstructions to improve the connection quality.</p>
Noise occurs when switching between LDAC and AaptX modes.	This issue may arise when using certain external SPDIF decoders that do not support SRC (Sample Rate Conversion) functionality. We recommend trying a different SPDIF decoder too see if the problem persists.
Intermittent music playback interruptions in LDAC mode.	If you prefer the high audio quality of LDAC with a 990kbps bit, ensure that the BDC-U is positioned close to your device. This proximity helps maintain a stable connection and minimise.

FCC Warning

This device complies with part 15 of the FCC Rules. Operation is subject to the following two conditions: (1) this device may not cause harmful interference, and (2) this device must accept any interference received, including interference that may cause undesired operation. Any changes or modifications not expressly approved by the party responsible for compliance could void the user's authority to operate the equipment.

NOTE: This equipment has been tested and found to comply with the limits for a Class B digital device, pursuant to Part 15 of the FCC Rules. These limits are designed to provide reasonable protection against harmful interference in a residential installation. This equipment generates, uses and can radiate radio frequency energy and, if not installed and used in accordance with the instructions, may cause harmful interference to radio communications. However, there is no guarantee that interference will not occur in a particular installation. If this equipment does cause harmful interference to radio or television reception, which can be determined by turning the equipment off and on, the user is encouraged to try to correct the interference by one or more of the following measures:

- 1.Reorient or relocate the receiving antenna.
- 2.Increase the separation between the equipment and receiver.
- 3.Connect the equipment into an outlet on a circuit different from that to which the receiver is connected.
- 4.Consult the dealer or an experienced radio/TV technician for help.

To maintain compliance with FCC's RF Exposure guidelines, This equipment should be installed and operated with minimum 20cm distance between the radiator and your body: Use only the supplied antenna.

Service and Warranty

Service for BerryBak products must be done by authorized agents. Products include a two-year warranty and over five years of product lifecycle. For replacement, return the product—original packaging is not required but recommended. For service, send the product to your dealer with your contact info and issue description. For out-of-warranty service, contact your dealer.

Legal Statement

The distributor may update BerryBak products or documentation without notice. Customers are responsible for selecting and using the products appropriately. The distributor is not liable for application support or product design.

BerryBak[™]

BerryBak Sdn. Bhd. (1326482-V)
No. 58, 7-2, Jalan Cantonment,
Wisma Fortune Heights,
10250, Georgetown,
Pulau Pinang, Malaysia
info@berrybak.com



Authorised Distributor:

