

# JLT622P

## LTE Enterprise Small Cell

### Installation Manual

Version 1.0 Rev. 2  
December 30, 2019



Copyright©2018 J Plus, Inc

The information contained herein is the property of **J Plus, Inc** and is provided without liability of errors, omissions, and mistakes. No part may be reproduced or copied without written permission or contract.

## Revision History

## Notes, Cautions, and Warnings

NOTE! : A NOTE indicates important information that helps you make better use of JLT622P.



CAUTION : A CAUTION indicates potential damage to hardware if instructions are not followed.



WARNING : A WARNING indicates a potential for property damage, personal injury, or death.

Information in this publication is subject to change without notice.

## Contents

1	Overview.....	5
2	Components for Installation.....	5
3	Installation Mounting Guidelines (per product mount type).....	8
3.1	Wooden Wall & Ceiling Mount Installation .....	8
3.2	Concrete Wall & Ceiling Mount Installation .....	10

## List of Figures

Figure 1 Components for Installation .....	6
Figure 2 Installation Materials .....	7
Figure 3 Proper Location of 4 Holes .....	8
Figure 4 Attaching Bracket to the Wall (Wooden Wall & Ceiling Mount) .....	9
Figure 5 Proper Location of 4 Holes .....	10
Figure 6 Attaching Bracket to the Wall (Concrete Wall & Ceiling Mount) .....	11

# 1 Overview

This document describes the guideline for installing JLT622P (hereafter 'Product'), LTE Enterprise Small Cell.

The document consists of:

- Overview
- Components for Installation
- Installation guideline (per product mount type)
- Wooden wall mount installation
- Concrete Wall & Ceiling mount installation

# 2 Components for Installation

Components needed for product installation consist of:

1. JLT622P (LTE Enterprise Small Cell)
2. Install Bracket (20 mm = ~ 0.787 in)
3. GPS Antenna
4. AC Power Cable
5. AC-DC Adaptor

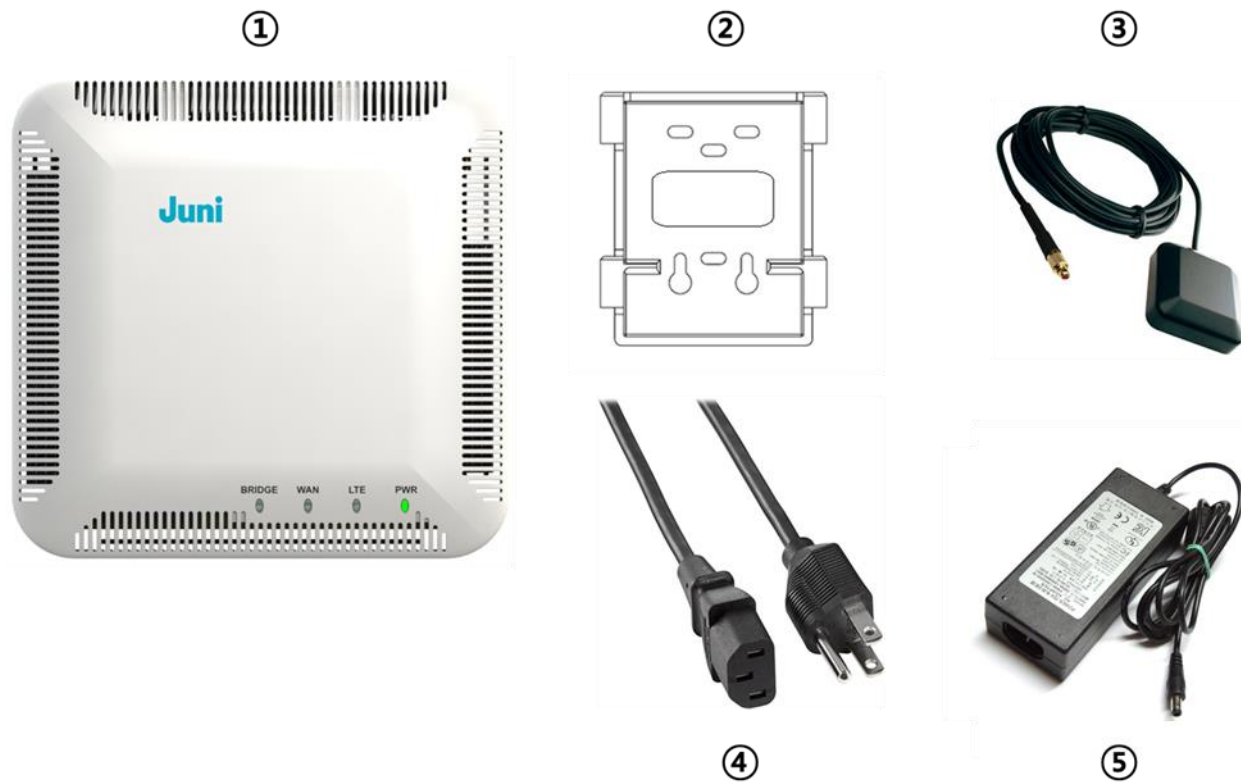
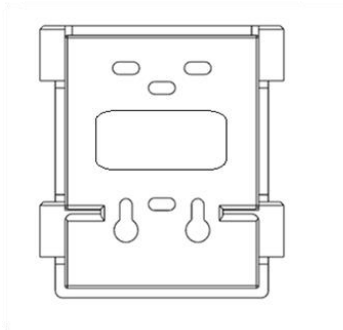

Figure 1 Components for Installation

## • Installation Materials



### Common Materials

- Installation Bracket (Included)



### Wooden Wall / Ceiling Mount

- M6 - 60 mm (~2.362 in) Panhead Cross Screw 4ea (Not Included)

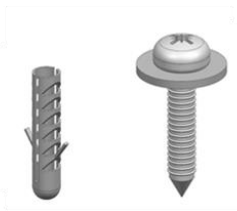

### Concrete Wall Mount

- M5.5 - 60 mm (~2.362 in) Panhead Cross Screw 4ea (Not Included)
- Concrete Anchor Inner 4.5mm (~0.177 in), L 60mm (~2.362 in) 4ea (Not Included)
- M5 Washer 4ea (Not Included)

**Figure 2 Installation Materials**

### 3 Installation Mounting Guidelines (per product mount type)

#### 3.1 Wooden Wall & Ceiling Mount Installation

- ① Requirements on a location of the product to be installed.
  - a. Minimum thickness of the wooden wall: 50mm = ~ 1.969 in
  - b. Use a stud sensor where the required thickness may not be secured in order to find a proper stud location for drilling the hole.



The product may fall when the proper wall thickness is not guaranteed.

- ② With the bracket included, drill 4 holes using  $\Phi 5$  (~0.197 in) drill as described in Figure 3.

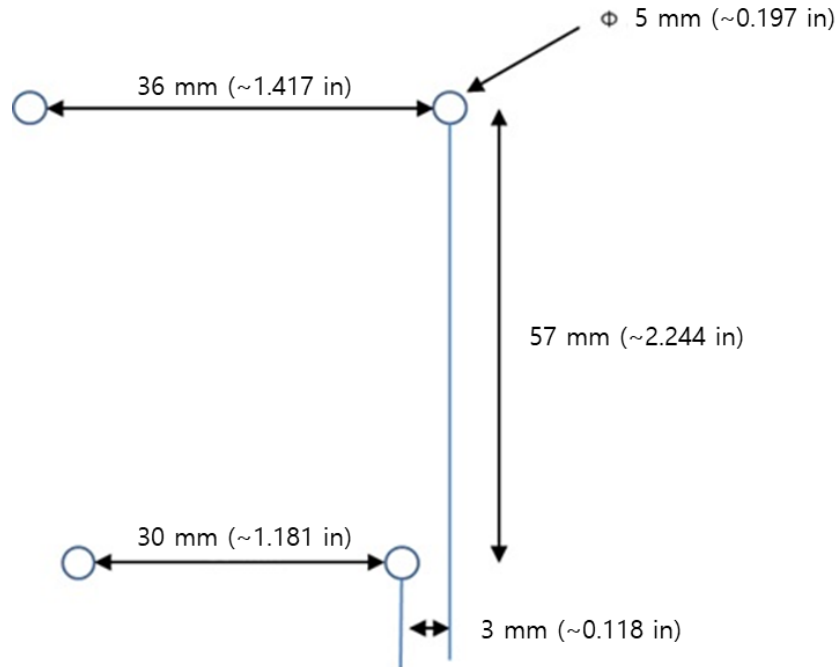
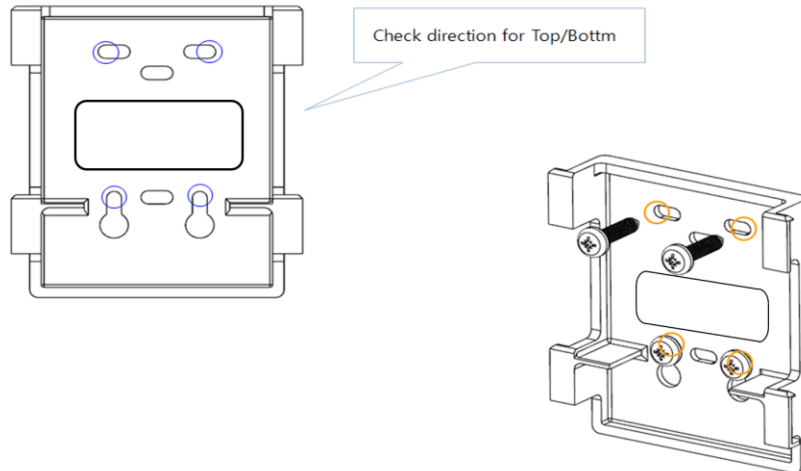

Figure 3 Proper Location of 4 Holes



- ③ Check the direction of top and bottom of the bracket and firmly attach the bracket by using M6-60mm wooden screw onto the wall as described in Figure 4.



**Figure 4 Attaching Bracket to the Wall (Wooden Wall & Ceiling Mount)**

- ④ Attach the product to the bracket. Slide down the product after putting the product into the bracket wings.

### 3.2 Concrete Wall & Ceiling Mount Installation

- ① Requirements on the location of the product to be installed.  
The minimum strength of the wall or ceiling shall be 2000 psi density.



The product may fall when the proper wall strength is not guaranteed.

- ② With the bracket included, drill 4 holes using  $\Phi 7$  (~0.276 in) drill as described in Figure 5.

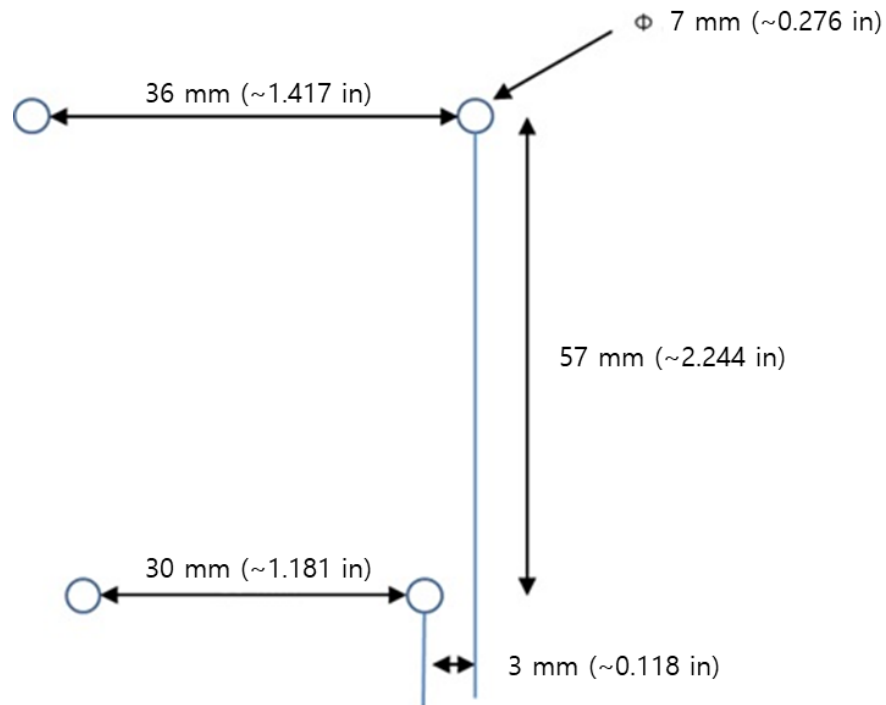
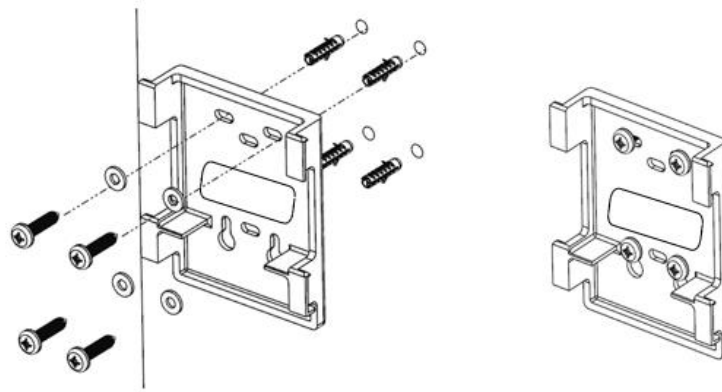

Figure 5 Proper Location of 4 Holes

- ③ After inserting anchor into the holes, attach the bracket onto a wall or ceiling using M6 concrete screw as described in Figure 6.



**Figure 6 Attaching**

RF Exposure installation instruction. This device is shall maintain a 20cm distance from users when installed.

- ④ Installation of the Product thereafter goes the same procedures as those of the wooden wall mount installation.

RF Exposure installation instruction. This device shall maintain a 20cm distance from users when installed.