

SC-30 用户手册（产品说明书）

尺寸：210*100mm 材质：157克铜版纸 双面印刷

15W Fast
Wireless Car Charger
User Manual

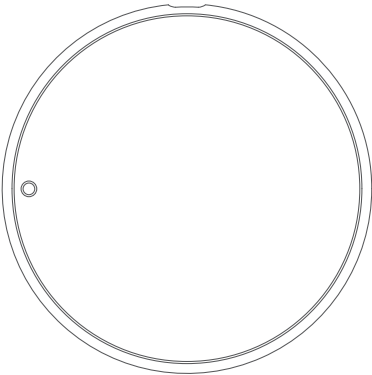

Please use QC2.0 or 3.0 power adapter for fast charging function.

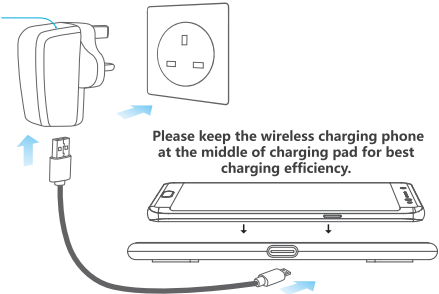

Specifications

Input	DC12V \equiv 1.5A,DC9V \equiv 1.67A,5V \equiv 2A
Output	15W/10W/7.5W/5W
Product Standard	Qi
Charging Distance	\leq 10mm
Charging Efficiency	\leq 80%
Product Dimension	ϕ 93mm*6mm
Product Material	Aluminium alloy+Fluff Coating

5V2A adapter is applicable to 5W standard wireless charging mode.

9V1.67A adapter is applicable to iPhone 7.5W fast wireless charging mode.

9V1.67A adapter is applicable to Samsung 10W fast wireless charging mode.

12V/1.5A adapter is applicable to 15W fast wireless charging mode.

※Fast wireless charging requires QC2.0/3.0 adapter or Samsung original fast charging adapter.

Indicator light Status and Protection Function

Standby: Indicator light keeps green.

Charging: Indicator light keeps blue.

Fully Charged: Indicator light turn off.

FOD: The blue and green indicator light will flashing when put coin, keys, any metal or magnet objects on the charger.

perfect protection function based on over voltage protection, over current protection,over temperature protection and short circuit protection.

The indicator light will flash if the wireless charger not work well.

Attention

- 1.Please do not vigorously extrude or collide.
- 2.Please do not dismantle or put it into fire or water when the product is power on,to avoid short circuit or leakage.
- 3.Please do not use it in severely high temperature,high humidity or corrosive environment,to avoid damage to the circuit leakage.
- 4.Please do not put the magnetic strip or chip card (Such as ID card,bankcard etc.) on the charging pad to avoid to cause magnetic card lose efficacy.
- 5.Please do not put the metal (Such as coin etc.) on the charging pad when charging,to avoid damage from heating.

Note:This product is applicable to all Qi standard wireless charging phones,other phones need an external receiver for wireless charging function.

15W 快速
无线充电器
用户手册

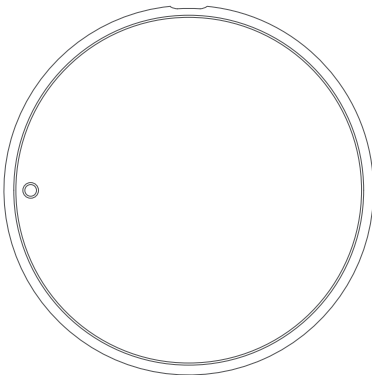

快充模式需使用
QC2.0或3.0适配器

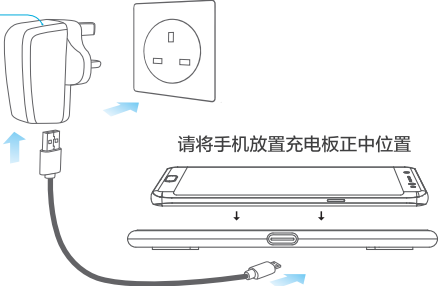

参数规格

输入	DC12V \equiv 1.5A,DC9V \equiv 1.67A,5V \equiv 2A
输出	15W/10W/7.5W/5W
产品标准	Qi
充电距离	\leq 10mm
充电效率	\leq 80%
产品尺寸	ϕ 93mm*6mm
产品材质	铝合金+毛绒漆

5V/2A 适配器适用于普通模式充电（5W输出）

9V/1.67A 适配器适用于苹果手机快充模式充电（7.5W输出）

9V/1.67A 适用于三星手机快充模式充电（10W输出）

12V/1.5A适配器适用于15W功率的手机快充模式充电（15W输出）

※ 快充模式需使用三星原装快充适配器或QC2.0/3.0适配器

指示状态与保护功能

待机模式：LED绿灯常亮。

充电模式：LED蓝光常亮。

充满电后：LED指示灯熄灭。

FOD异物检测：如产品上放入硬币，钥匙等金属或磁性物体，蓝绿灯闪烁。

全方位保护：温度、短路、过压、过流。

出现充电故障时：会出现灯光闪烁。

注意事项

- 1.请勿大力挤压或碰撞。
- 2.请不要在通电状态下自行拆解或投入火中、水中，避免短路漏电。
- 3.请不要在严重高温，高潮湿或腐蚀性环境下使用，避免损坏电路出现漏电。
- 4.请不要将带有磁条或者芯片的磁卡（身份证、银行卡等）放置在充电板上，避免造成磁卡失效。
- 5.请勿在充电的时候将金属（硬币等金属物体）放置在充电板上，以免造成发热损伤。

注：本产品适用于所有Qi标准带无线充电功能的手机，其它手机需另外配接收器。

FCC STATEMENT :

This device complies with Part 15 of the FCC Rules. Operation is subject to the following

two conditions:

- (1) This device may not cause harmful interference, and
- (2) This device must accept any interference received, including interference that may cause undesired operation.

Warning: Changes or modifications not expressly approved by the party responsible for compliance could void the user's authority to operate the equipment.

NOTE: This equipment has been tested and found to comply with the limits for a Class B digital device, pursuant to Part 15 of the FCC Rules. These limits are designed to provide reasonable protection against harmful interference in a residential installation. This equipment generates uses and can radiate radio frequency energy and, if not installed and used in accordance with the instructions, may cause harmful interference to radio communications. However, there is no guarantee that interference will not occur in a particular installation. If this equipment does cause harmful interference to radio or television reception, which can be determined by turning the equipment off and on, the user is encouraged to try to correct the interference by one or more of the following measures:

Reorient or relocate the receiving antenna.

Increase the separation between the equipment and receiver.

Connect the equipment into an outlet on a circuit different from that to which the receiver is connected.

Consult the dealer or an experienced radio/TV technician for help.

FCC Radiation Exposure Statement:

This equipment complies with FCC radiation exposure limits set forth for an

uncontrolled environment. This equipment should be installed and operated
with minimum distance 20cm between the radiator & your body