

Gardyn®

STUDIO



Grow Guide

Welcome to the Gardyn family!

Get ready to discover the joy of growing your own food.

From seed to harvest and beyond, we've got you covered with comprehensive resources, essential accessories, and, of course, Kelby. We are thrilled you're here and can't wait to see your progress!

Inside this guide you'll find tips on:

Gardyn Studio setup	4
The Gardyn essentials to help you grow with peace of mind	22
Your Gardyn's care cycle	24

Let's get Gardyning!





Watch Video

Meet Your Gardyn Studio

- 1 Light protective cap
- 2 Safety straps
- 3 Camera
- 4 LED light bar
- 5 Main switch
- 6 Light switch
- 7 Lower blade
- 8 Water pump
- 9 Upper blade
- 10 Rod connector
- 11 Metal rod
- 12 Columns
- 13 Lid
- 14 Wood cap to watering compartment
- 15 Lid locks
- 16 Water tank

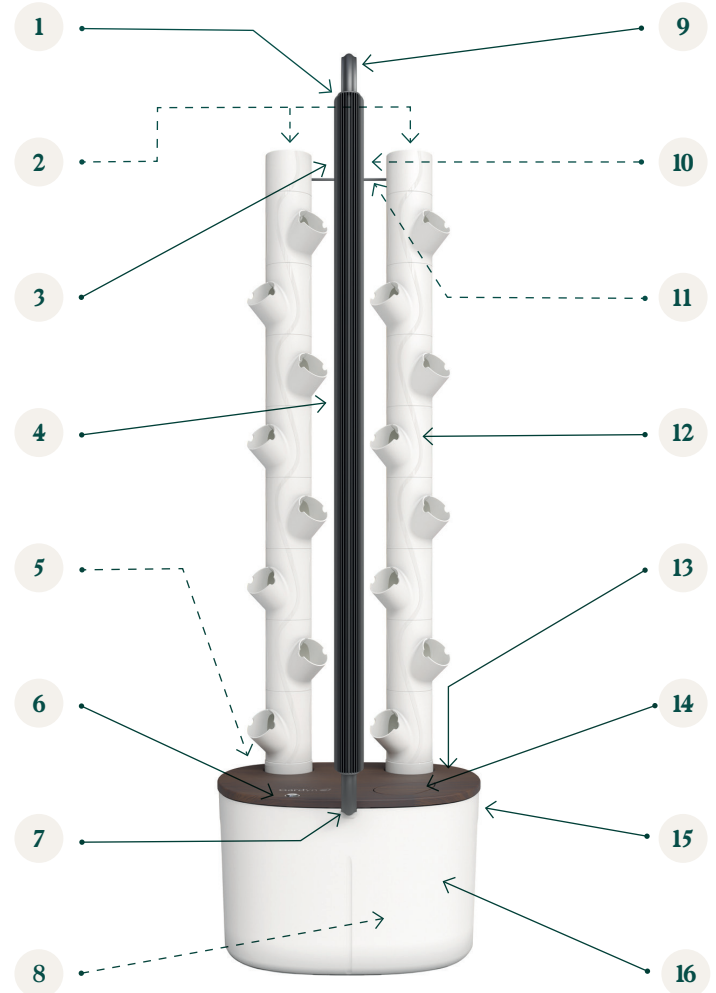

Reminder: Do not plug the device in until instructed to do so.



STEP 1

Unpacking

Watch Video

Carefully unpack the parts following the order in the video.

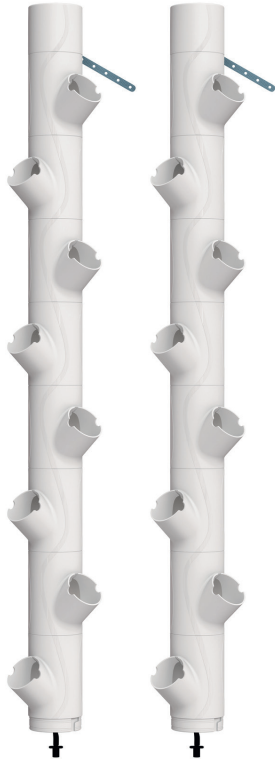

2 columns



LED light bar



Lid with wood cap

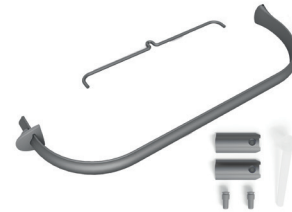

Metal rod, upper blade,
metal plates, plugs, & plant
food spoon



Water tank



Power supply



16 yPods



STEP 2

Mount & lock the lid

[Watch Video](#)

- 1 **Remove the tape** and open the lid locks to mount the lid onto the water tank, then close the lid locks.



- 2 **Remove the cardboard** and lower the water pump.

The cardboard's appearance may vary slightly from the one shown.



Pump in upper position

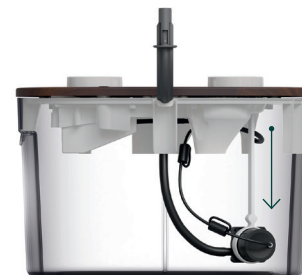

Pump in lower position



Watch Video

STEP 3

Assemble & connect the columns

- 1 **Gently pull on the end** of the irrigation hoses to ensure they are straight inside the columns and avoid any kinks.

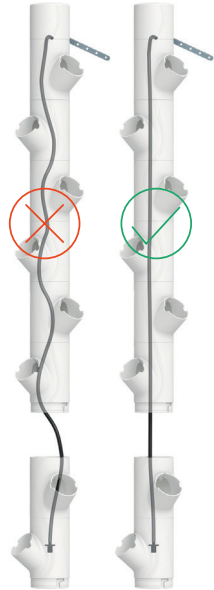

- 2 **Align the arrows, then twist.**
When completed, the arrows will no longer align.



- 3 **Hold the column vertically** and plug the hose connector onto the tube inside the column's base until snug.



- 4 **Twist the column** to secure. When completed, the arrows will no longer align.



- 5 **Ensure all open slots face the front of the lid,** as shown.





STEP 4

Attach light bar & upper blade

- 1 **Insert the metal rod** onto the back of the columns, then slide the metal plates into each column and insert plugs to secure.

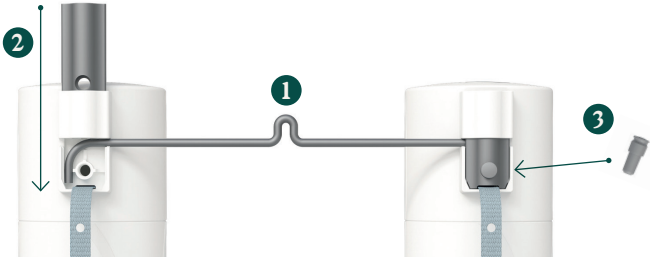

- 2 **Hold the light vertically** so that the camera is near the top. Carefully yet firmly slide the bottom of the light onto the lower blade attached to the lid.

Push until you see the grey post in the notch of the light bar.

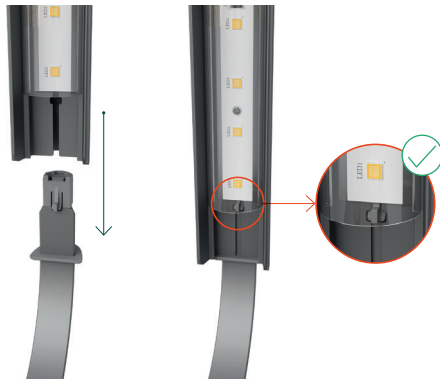

- 3 **Remove** the camera's protective film.



- 4 **Attach the upper blade** to the light bar, then clip it onto the metal rod.



- 5 **Ensure the upper blade** is fully clipped onto the metal rod.



Check progress

At this stage, you should see the following:

- **The camera's** protective film is removed.
- **The 2 columns** have all slots facing the light and all vine designs aligned.
- **The LED light bar** is mounted and the light protective cap is flush with the top of the light bar.
- **The metal rod** is connected to the upper blade and columns by 2 metal plates and plugs.
- **The water pump** is lowered into the tank and the cardboard is removed.
- **The lid locks** are pushed against the sides of the water tank in the locked position.



If you've completed each of these steps, you're ready to secure your device to the wall using the safety straps.



STEP 5

Fill tank & turn on

[Watch Video](#)



DO NOT ADD PLANT FOOD when you start your Gardyn. The app will help you learn when it's time to start feeding your plants later on.

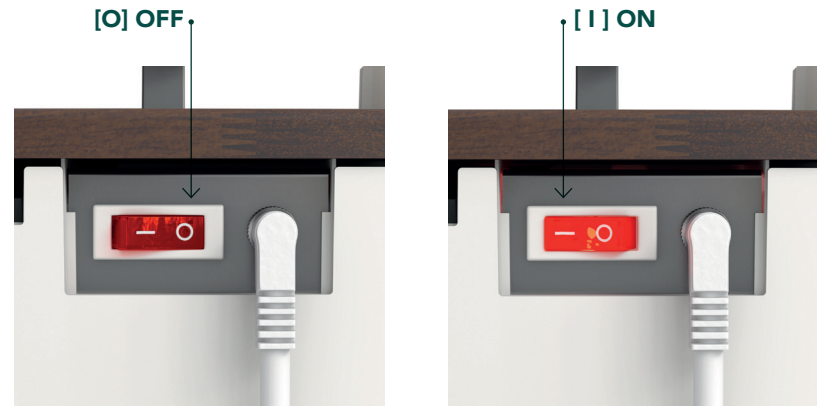

The device is turned ON/OFF by flipping the main switch located on the back of the water tank.

Make sure the main switch is in the OFF [O] position before plugging in or unplugging the device to the power supply. Once the device is plugged in, turn it on by flipping the main switch to the **ON [I] position.**

The main switch will illuminate and your light bar will blink once it is fully powered up.



STEP 6

Install your plants

Watch Video

- 1 **If you haven't already,** open and unpack the box containing the 16 yPods.

- 2 **Insert 1 yPod** into each of the open slots on both columns. To insert, twist each yPod until it sits flush with the column.



yPod

- Tip** Check out our **placement guide** to find your plants' ideal spots based on your starter kit!



Placement Guide

- 3 **Time to plant!** Place the yCubes into the yPods. yCubes are correctly inserted when they sit flush with the yPod.



yCube

No slot should be left open.

Use Gardyn Caps and skip the yPod to close spots without plants.



Shop Gardyn Caps

- 4 **Remove** the cardboard covers on every yCube you plant.



- Tip** Only see one layer of yCubes in the box? Lift the packaging to find all 16!

- Tip** **16 plants or fewer to start?**

The choice is yours! If you plant fewer than 16, be sure to cover open slots with Gardyn Caps, available in the app.

