

Micro SD

1. Load a Micro SD memory card into the appropriate media port.
2. The speaker will automatically switch to SD mode.
3. Use the controls on the speaker to select and play audio from the connected drive.

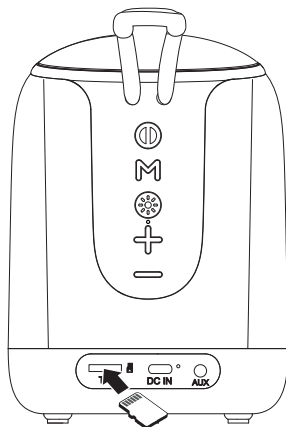

FCC WARNINGS

WARNING: Changes or modifications to this unit not expressly approved by the party responsible for compliance could void the user's authority to operate the equipment.

NOTE: This equipment has been tested and found to comply with the limits for a Class B digital device, pursuant to Part 15 of the FCC Rules. These limits are designed to provide reasonable protection against harmful interference in a residential installation. This equipment generates, uses, and can radiate radio frequency energy and, if not installed and used in accordance with the instructions, may cause harmful interference to radio communications. However, there is no guarantee that interference will not occur in a particular installation. If this equipment does cause harmful interference to radio or television reception, which can be determined by turning the equipment off and on, the user is encouraged to try to correct the interference by one or more of the following measures:

- Reorient or relocate the receiving antenna.
- Increase the separation between the equipment and receiver.
- Connect the equipment into an outlet on a circuit different from that to which the receiver is connected.
- Consult the dealer or an experienced radio/TV technician for help.

This device complies with part 15 of the FCC Rules. Operation is subject to the following two conditions: (1) This device may not cause harmful interference, and (2) this device must accept any interference received, including interference that may cause undesired operation.

ADDITIONAL WARNINGS

- WARNING: To prevent fire or shock hazards, do not expose this unit to rain or moisture.
- WARNING : Where the mains plug or appliance coupler is used as the disconnect device, such disconnect device shall remain readily operable.
- Lithium batteries, like all rechargeable batteries, are recyclable and should be recycled or disposed of according to state and local guidelines. They should never be disposed of in normal household waste and they should never be incinerated, as they might explode. Contact your local government for disposal or recycling practices in your area.



WARNING : This product can expose you to chemicals including lead, which is known to the State of California to cause cancer and birth defects or other reproductive harm. For more information go to: www.P65Warnings.ca.gov. **This product meets and complies with required Federal product guidelines.**

International Support

To download this User's Guide in English, Spanish, or French, or to get answers to frequently asked questions, visit the support section at:
www.iLiveElectronics.com

Para descargar este Manual del Usuario en Inglés, Español y Francés, o para obtener respuestas a preguntas frecuentes, visite la sección de apoyo en:
www.iLiveElectronics.com

Pour télécharger ce guide de l'utilisateur en Anglais, Espagnol ou Français, ou pour obtenir des réponses à des questions fréquemment posées, consultez la rubrique d'assistance sur:
www.iLiveElectronics.com

Contact Information

Website: www.iLiveElectronics.com

Email Support: proinfo@dpiinc.com

Email Parts: partsinfo@dpiinc.com

Phone Support: 1-888-999-4215

Warranty

For Warranty Information and the most up-to-date version of this User's Guide, go to:
www.iLiveElectronics.com.



**Protect for Today
Sustain for Tomorrow**

Specifications are subject to change without notice.
Copyright © 2023 Digital Products International (DPI, Inc.)
All other trademarks appearing herein are the property of their respective owners.



**"Brightside" Wireless
Speaker**

User's Guide for Model ISB143B v3142-01

Features

- Bluetooth wireless 5.3: range approximately 33ft.
- Bluetooth TWS – Pair with another ISB143 speaker
- Micro SD card port
- Aux In
- Digital volume control
- Voice prompts
- Built-in rechargeable battery: approximately 4 hrs of playtime at 50% volume
- USB-C port for battery recharge

Includes

- User's Guide
- USB-C to USB charging cable

Controls

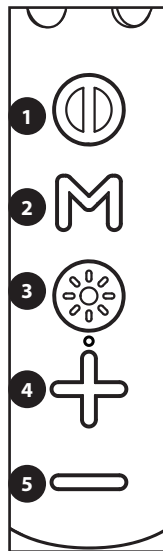

1. **Power/Play/Pair:** Press and hold for 3 seconds to power on your speaker. Press and hold again to power off your speaker. When on, press once to play or pause music tracks. Press twice to connect or disconnect from Bluetooth.
2. **Mode:** Press to change source modes to Bluetooth, AUX, or MicroSD. Press and hold to activate TWS Mode.
3. **Lights:** Press to cycle through LED light modes. Press twice to turn lights off. Press and hold to turn voice prompts on/off.
4. **Vol +/Next:** Press to increase volume level. Press and hold to play the next track.
5. **Vol -/Previous:** Press to decrease volume level. Press and hold to play the previous track.

Inputs

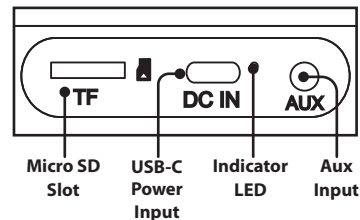

Voice Prompts

Press and hold the **Lights** button for 5 seconds to turn voice prompts on/off.

Charging the Battery

To charge the internal battery, plug the USB charging cable into the DC Power Input on the speaker and a powered-on computer or USB power adapter (not included) and standard power outlet. Charging time is approximately 180 minutes.

When the battery is low, a voice will announce "Low battery," then the unit will automatically power OFF.

While the unit is charging, the Indicator LED will display a solid red light. When the battery is fully charged, the light will turn off.

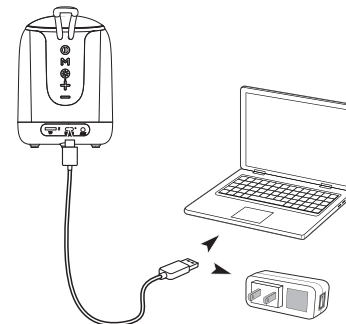

Pairing & Playing Bluetooth Audio

1. When first powered on, the speaker defaults to Bluetooth Mode and is ready to pair automatically. When pairing, remain within 3 feet of the Bluetooth device.
2. Using the controls on your Bluetooth device, select **ISB143** in the Bluetooth Settings to pair. If need be, refer to the user's manual for your specific device for more information.
3. When successfully paired, a voice will announce "Bluetooth connected." Your Bluetooth device will now be heard through the speaker.
4. Use the controls on the connected Bluetooth device to select and play audio. Use the speaker controls or the connected Bluetooth device to play, pause, and adjust the volume level.
5. After initial pairing, the speaker will automatically connect to the last Bluetooth device used whenever it is in Bluetooth Mode.

Note: To disconnect a device, press the Power button twice. The speaker will re-enter pairing mode and can be paired with a different device using the steps above.

Bluetooth TWS

1. When powered on, press and hold the **Mode** button on one of your speakers. This speaker will act as the host and will begin searching for another powered-on **ISB143** speaker. The speakers will connect automatically.
2. You can now connect the paired speakers to a Bluetooth device using the standard set up steps.
3. The two speakers will automatically reconnect the next time they are both on
4. Press and hold the **Mode** button on either speaker to disconnect the speakers and exit TWS mode.